



Installation Guide

Hardie™ Tex Base Sheet

EXTERIORS

Australia March 2024

Make sure your information is up to date.

When specifying or installing Hardie™ products, ensure that you have the current technical information and guides. If in doubt, or you need more information, visit www.jameshardie.com.au or Ask James Hardie™ on 13 11 03.

CONTENTS

1	INTRODUCTION	2
1.1	Applications	2
1.2	Outline of system	3
1.3	Factors to be considered	3
2	FRAMING AND FIXING	4
2.1	Framing	4
2.2	Fixing	5
2.3	Fasteners	5
3	SHEET INSTALLATION	6
3.1	General installation	6
3.2	Orientation	6
3.3	Set jointing	7
3.4	Movement joints	7
3.5	Corners	7
3.6	Sheet layout around openings	7
3.7	Curved walls	7
3.8	Moisture management	7
4	MOVEMENT JOINTS	8
4.1	General	8
4.2	Control joints	8
4.3	Structural joints	8
4.4	Construction joints	8
5	DECORATIVE TREATMENT	8
5.1	Coating	8
5.2	Decorative trims	8
6	SAFE WORKING PRACTICES	9
	Warning	9
	Recommended safe working practices	9
	Working instructions	9
	Hole-forming	10
	Storage and handling	10
	Quality	10
7	PRODUCT INFORMATION	10
7.1	General	10
7.2	Product mass	10
7.3	Durability	10
7.4	Alpine regions	10
8	COMPONENTS	11
9	DETAILS	12
9.1	General	12
9.2	Slab on ground and platform floors	12
9.3	Windows	12
9.4	Eaves lining	12
10	MAINTENANCE	23

MADE IN AUSTRALIA

1 Introduction

1.1 APPLICATIONS

Current design trends in residential construction favour the use of colour and texture for external walls. Hardie™ Tex Base Sheet has been developed to deliver this colour and texture, along with design flexibility and a robust finish, that will withstand many years of exposure to the elements.

The design flexibility of Hardie™ Tex Base Sheet is further enhanced by the use of architectural profiles that provide a wide range of options for architectural detailing.

The freedom of lightweight, versatile Hardie™ Tex Base Sheet makes it easy to turn the most inspiring design into reality, without heavy and often costly engineering detail.

Hardie™ Tex Base Sheet is adaptable, and offers new design and construction possibilities, even with a limited budget. With Hardie™ Tex Base Sheet, you can have design freedom, without compromising quality and cost-effectiveness.

Start with the strong, stable, lightweight and durable Hardie™ Tex Base Sheet. Then sculpt the basic form of your design, whether it is strikingly modern, or monumentally grand.

The lightweight properties of Hardie™ Tex Base Sheet makes it the ideal material for additions. Perfect for second-storey additions, the

Hardie™ Tex Base Sheet allows you to build with a reduced load, compared to building with masonry. This saves time and money.

Hardie™ Tex Base Sheets are designed to be coated with beautiful colours and textures, so it is easy to select a finish that will seamlessly match new areas to an existing building, or complement any materials used in the original structure.

Hardie™ Tex Base Sheets are easily fixed to timber and steel wall frames using relevant recommended fasteners.

The specifier or the party responsible for the project must ensure the details in this guide are appropriate for the intended application and that additional detailing is performed for specific design or any areas that fall outside the scope and specifications of this guide.

1.2 OUTLINE OF SYSTEM

1.2.1 Component 1– Hardie™ Tex™ Base Sheet

Component 1 is the specifically designed 7.5mm thick Hardie™ Tex Base Sheet. These sheets are recessed along their two longer sides to facilitate the construction of concealed joints. The sheets are fixed to timber or steel framing and provide a strong impact-resistant substrate for Component 2, the texture system.

These sheets are supplied pre-primed, ready for the application of the texture system.

Hardie™ Tex Base Sheets can also be used as structural bracing. Refer to the Hardie™ Structural Bracing Application Guide for information on bracing fixing recommendations.

NOTE

Hardie™ Tex Base Sheet are clearly identified by their blue colour and are marked with “HARDIE™ TEX NAIL AT 200mm, SUPPORT ALL JOINTS”.

1.2.2 Component 2 - texture system

Hardie™ Tex Base Sheets must be finished with a specialised texture coat system that incorporates jointing reinforcement and a texture coat.

The coating finish, available in a variety of textures, colours and gloss levels, is site applied. The joint and texture coat used must be from the same manufacturer and must form a complete system that is recommended by that manufacturer over Hardie™ Tex Base Sheets. This will ensure compatibility and availability of system warranties by the texture coat manufacturers.

The texture system must be applied by an applicator approved and trained by the texture coat manufacturer. The manufacturer will be responsible for providing the customer with the warranty for the coating and sheet joints. James Hardie will warrant only the Hardie™ Tex Base Sheet component of the system.

Optional architectural mouldings can be used to provide detailing flexibility.

For information on texture coat manufacturers Ask James Hardie™ on 13 11 03.

1.3 FACTORS TO BE CONSIDERED

Hardie™ Tex Base Sheet is designed to provide a monolithic finish. The success of the system relies on a number of factors outside the control of James Hardie. We recommend that you work closely with texture coat manufacturers and trained applicators, even before installing the Hardie™ Tex Base Sheets to select the right finish and texture coat system for you.

Seeking the advice of the texture coat manufacturer will ensure you select the most appropriate product compatible with Hardie™ Tex Base Sheets. By involving applicators early they can advise of particular texture coat requirements and this can sometimes save you money.

To get the best possible finish we recommend the following:

A straight frame

The final finish is dependent on the straightness of the frame. The frame can be checked and straightened if it is out of tolerance, refer to Section 2 in this guide for the suggested frame straightness tolerances.

Avoiding large unbroken wall areas

Trim, window and door openings break the starkness of a wall elevation, whereas in large unbroken wall elevations, joints can sometimes be visible. The sheet layout around openings is important, refer to Section 3 in this guide for recommended sheet layout.

A minimum 2mm thick texture coat

A high build texture coat will help conceal joints. Heavier texture, such as scratch coats, will also help provide a monolithic finish. For specialist advice contact the texture coat manufacturer.

A low gloss finish

A low gloss finish will help diffuse glancing light. For specialist advice contact the texture coat manufacturer.

Use of light coloured paints

Avoid dark coloured coatings on walls subject to long periods of sun exposure. For specialist advice contact the texture coat manufacturer and refer to section 5 in this guide.

Glancing light

For any number of reasons outside the control of James Hardie, including frame movement, sheet alignment as well as the jointing products and methods used, the actual joint may be slightly (several microns) raised or lowered compared to the adjoining sheets. Such joints may be clearly evident under glancing light, casting visible shadows of the minute and uneven projections of the joints.

We recommend that you install eaves on your house. The eaves will reduce glancing light, highlighting joints. Glancing light is light that is nearly parallel to the surface of the wall and casts visible shadows and uneven projections of the joints. Just like rendered masonry any uneven projections will be highlighted. Including eaves on your house can also dramatically reduce the impact that the sun, wind and rain will have on your home.

It is important to consider all these points to achieve the best results from Hardie™ Tex Base Sheet.

2 Framing and Fixing

2.1 FRAMING

2.1.1 General

Hardie™ Tex Base Sheets can be fixed to either timber or light gauge steel domestic framing. The framing must comply with relevant building regulations and standards and the requirements of this guide.

All Hardie™ Tex Base Sheet edges must be supported. Adequate framing must be provided to ensure all sheet edges can be supported.

All studs and noggings must be checked with a long straight edge for line and face accuracy, to ensure the stud wall has a true and accurate outside face. A suggested maximum tolerance of 3-4mm in 3000mm of the length and height of frame will give best results. See Table 1.

NOTE

Hardie™ Tex Base Sheets will not straighten excessively warped frames and such warping may still be visible after the texture coating is applied.

TABLE 1

SUGGESTED FRAME STRAIGHTNESS TOLERANCES	
STRAIGHT EDGE (MM)	TOLERANCES
600	1 - 2
1200	2 - 3
3000	3 - 4

2.1.2 Timber

'Timber used for house construction must have the level of durability appropriate for the relevant climate and expected service life and conditions including exposure to insect attacks or moisture, which could cause decay.'

Reference AS 1684.2 'Residential Timber Framed Construction'.

Only seasoned timber must be used. When the inter-floor wall height exceeds the sheet length, and horizontal sheet joints need to be introduced, use only kiln dried timber.

NOTE

Unseasoned timber must not be used as it is prone to shrinkage and can cause sheets and frame to move, causing undue stresses on sheet joints.

The timber framing thickness at sheet joints must be a minimum of 42mm. See Figure 1.

35mm wide timber must not be used at any sheet joint because of insufficient sheet landing width. Where timber less than 42mm wide is used, provide double studs at sheet joints. See Figure 2.

Where frames are to be supplied by frame and truss manufacturers, advise the manufacturer that the frames are to be designed for Hardie™ Tex Base Sheet. James Hardie has prepared a frame and truss checklist to help frame and truss manufacturers understand the framing needs of Hardie™ Tex Base Sheet. Contact Ask James Hardie™ on 13 11 03 for more information.

2.1.3 Steel

Use of steel framing must be in accordance with NASH standard for Residential and Low-Rise Steel Framing Part 1: Design Criteria and the framing manufacturer's specifications. Framing members must have a base metal thickness (BMT) between 0.55mm to 1.6mm. The steel framing must have the appropriate level of durability required to prevent corrosion.

Minimum flange width at sheet joints must be 38mm. This will provide adequate support for fixing two Hardie™ Tex Base Sheet edges. Where narrower sections are used, double studs must be provided at sheet joints. See figure 3.

Sheets must not be fixed directly to drawn steel or hot-rolled steel sections. These members must be battened out with 42mm minimum wide finished timber battens or light gauge 38mm wide metal furring channels.

2.1.3.1 Thermal Break

The Building Code of Australia sections J4D6 and H6D2 volumes 1 and 2 respectively, state for both residential and commercial buildings a thermal break with an R 0.2m² K/W must be installed behind external cladding where the cladding and internal lining make direct contact with the same metal frame. For more information on the Hardie™ Break Thermal Strip, please refer to the installation guide at www.jameshardie.com.au

2.1.4 Frame layout

Framing must be laid out to accommodate sheet joints at 1200mm centres.

Framing to suit Hardie™ Tex Base Sheets, must comply with the following maximums:

- Stud spacing 600mm for 1200mm wide sheets.
- Noggings may be staggered, installed flush with the outside face of studs.

NOTE

Double studs are required at vertical movement joints. Refer to Section 4 for locations and details of movement joints.

Where Hardie™ Tex Base Sheets are to be installed in higher wind areas, stud spacings must be reduced. Refer to Table 2 for spacings.

Where framing does not coincide with sheet joints, additional framing must be installed. See Figure 4 for additional framing details.

TABLE 2

MAXIMUM STUD AND FASTENER SPACING FOR WIND CATEGORIES (MM)								
To AS 4055 – 1992	non-cyclonic	N1	N2	N3		N4	N5	N6
	cyclonic				C1	C2	C3	C4
7.5MM HARDIE™ TEX BASE SHEETS								
Stud spacing	within 1200 mm of the external corners of the building	600	600	600	450	450	300	300
	elsewhere	600	600	600	450	450	450	450
Fastener spacing	within 1200 mm of the external corners of the building	200	200	200	200	150	150	125
	elsewhere	200	200	200	200	200	200	150

2.1.5 Stud Setout

It will save time and money if the first stud is set out from the corner of the frame and not from the first stud centre. This will eliminate the need for extra framing as all sheet edges can coincide with framing. See Figure 5.

2.1.6 Framing for curved walls

For maximum stud spacing and allowable radii for curved walls see Table 3.

Greater wall heights may be obtained provided that a trim is used to cover sheet joints.

TABLE 3

CURVED WALLS					
	Min. bending radii concave walls (mm)	Min. bending radii convex walls (mm)	Max. height of wall (mm)	Max. stud spacing (mm)	Max. fixing spacing (mm)
Horizontal sheet fixing	2400	1800	1200	400	200
Vertical sheet fixing	6000	4000	3000	400	200

2.2 FIXING

2.2.1 General

All sheet edges must be supported by framing.

Sheets must be butted hard together, except where movement joints are required.

Where sheets are not used as sheet bracing, locate fasteners at centres given in Table 2 around the perimeter and on the intermediate stud. Fasteners must not be less than 12mm from sheet edges and 50mm from corners, as shown in Figure 6.

It is recommended to fix from the centre of the sheet and work outwards, to ensure sheets are hard against the frame, to avoid drumminess.

2.2.2 Bracing

Hardie™ Tex Base Sheets can also be used as structural bracing. Refer to the Hardie™ Structural Bracing Application Guide or for further information Ask James Hardie™ on 13 11 03.

NOTE

No structural bracing is achieved if a thermal break is used between the frame and cladding.

2.2.3 High wind and cyclonic areas

In high wind and cyclonic areas, the stud and fastener spacings must be reduced in accordance with Table 2.

2.3 FASTENERS

2.3.1 General

Select the fastener suitable for the required framing from the Components. See Section 8.

NOTE

At least Class 3 external grade fasteners must be used for all external applications.

2.3.2 Fastener durability

Fasteners must have the appropriate level of durability required for the intended project. This is of particular importance in coastal areas, areas subject to salt spray and other corrosive environments.

Fasteners must be fully compatible with all other materials that they are in contact with to ensure the durability and integrity of the assembly.

Contact fastener manufacturers for more information.

2.3.3 Fasteners to timber

Hand nailing - use 2.8 x 30mm fibre cement nails for fixing Hardie™ Tex Base Sheets to timber framing.

Adhesives must not be used to attach sheets to the frame.

NOTE

Fasteners must not be overdriven as this can reduce the holding capacity of the sheet. If nailing depth cannot be controlled adequately when gun nailing, under-drive fasteners then tap flush with a hammer. See Figure 7.

When gun nailing, refer to Table 4.

TABLE 4

GUN NAILING NOTES				
COIL NAILER		NAILS		
Manufacturer	Name	Manufacturer	Name	Size
Hikoki	VH650 coil nailer	Otter	Galv. coil nail	38mm x 2.5mm dia 45mm x 2.2mm dia 50mm x 2.2mm dia
Paslode	Impulse compact nailer (B20544)	Paslode	Impulse Dekfast® 50mm Value Pack (B20561V)	50mm x 2.87mm dia
			Impulse Dekfast® 50mm Handy Pack (B20557V)	50mm x 2.87mm dia
Duo-Fast	KD665A coil nailer (Part No. D40040)	Duo-Fast	C27/32 GD coil nail (D41800)	32mm x 2.7mm dia
Stanley-Bostitch	N80C coil nailer	Stanley-Bostitch	AC45P250 gal coil nail	45mm x 2.5mm dia
Senco	SCN-60 coil nailer (fitted with adjustable depth of drive)	Senco	BTN 45 ADB Weatherex gal and Sencoted	45mm x 2.5mm dia

NOTES

1. Fasteners with equivalent dimensions, (ie head size and shape, shank diameter and length to those above) are acceptable for use.
2. All fasteners are to be galvanised or suitably coated for intended external application.
3. Nailing guns must be fitted with flush drive attachments.
4. Some nailing guns incorporate an adjustable head set to control nail depth (eg Duo-Fast coil nailer and Senco coil nailer.)
5. When gun nailing, apply pressure to the face of the cladding by holding the cladding against the stud to reduce blow out at back of the sheet.

Nail gun manufacturers have supplied the information contained in this table. Should a nail gun model or nail shown in the table not be available, please contact the relevant nail gun manufacturer for advice.

If the nail gun overdrives sheets, contact nail gun manufacturer for advice.

2.3.4 Fastening to steel

For steel framing thickness of 0.5mm – 1.6mm BMT – use 41mm Hardie™ Drive Screws.

Fasteners should be screwed as close as possible to the stud corners to avoid deflection of the stud flange. See Figure 8.

2.3.5 Screw gun specification

Use variable speed screw guns with high torque, a maximum speed of 2500rpm, fitted with a depth control attachment.

Set the depth control attachment to avoid overdriving. As the screw thread begins to pull into the steel frame, drop the revs back to bed the head flush with the surface of the sheet.

3 Sheet Installation

3.1 GENERAL INSTALLATION

Planning sheet layout is an essential part of installation to minimise the number of sheet joints and material wastage. The two main areas to be considered are sheet orientation and jointing.

In all cases use full sheets and do not use offcuts to clad walls.

See Figure 9.

Sheets must be fixed vertically, commencing from a corner. Where steel framing is used, ensure studs are placed so sheets can be progressively fixed in the sequence indicated in Figure 6.

Where wall heights between floors are greater than a standard sheet, place small sheets at the top of the full sheet. See Figure 10.

Ensure that Hardie™ Tex Base Sheets are not finished hard against render, tiling, timber decks or concrete slab. Provision must be made for frame and sheet movement.

The bottom edge of Hardie™ Tex Base Sheets must not come into frequent contact with moisture. Ensure bottom edge of sheets are not buried or in an application where they will be exposed to ponding water.

3.2 ORIENTATION

3.2.1 Vertical

Vertical sheet installation layout is recommended for the following reasons:

- The longer sides of the sheets are recessed, facilitating vertical sheet joints, horizontally laid sheet sheets could require significant site grinding.
- Noggings can be staggered rather than in line.
- Vertical sheet installation minimises wastage as sheet lengths and widths suit wall heights and stud spacing.
- After coating, vertical joints are generally less obvious in glancing light conditions than horizontal joints.

3.2.2 Horizontal

Horizontal sheet layout is only recommended where the maximum depth of cladding is 1200mm (one sheet width), horizontal sheet installation is more suitable for applications such as fascias.

When fixing sheets horizontally. Refer to Table 2 for fastener spacings. Ensure sheets are fastened to all studs.

3.3 SET JOINTING

The set (recessed-edge) joint is formed between adjoining vertical edges of Hardie™ Tex Base Sheet refer to Figure 11.

The sheets are butted hard together with no gaps being left between sheets.

Set joints are also required at sheet ends where inter-floor heights are greater than the length of a standard sheet. See Figure 10.

Hardie™ Tex Base Sheets comes with two recessed edges to facilitate easy setting of the joints. If an additional recess is required, the recess can be site ground. See Figure 12.

Where edges have been site recessed, ensure correct primer has been used to pre-prime sheet recess before application of texture coat.

Check with texture coat manufacturer for details on primers that are recommended for the texture coat system selected.

Use a portable angle grinder fitted with a strong thick diamond or carborundum blade or similar and a dust extraction unit. A suitable tool is an angle grinder fitted with the Hitachi Easy Bevel attachment and dust extraction apparatus.

3.4 MOVEMENT JOINTS

Movement joints are joints that control the structural movement between the sheets and frame. Generally these joints are required at wall runs over 5.4m and at floor levels. Refer to Section 4 for an explanation and details of movement joints.

3.5 CORNERS

External corners have either a system of continuous jointing and coating around the corner or are reinforced with a perforated corner angle. Refer to Table 5 for further external corner fixing requirements. Note at corners, both sheets should be either recessed or not recessed. See Figure 13.

An internal corner requires a 6mm gap between sheets that is filled with Hardie™ Joint Sealant. See Figure 14.

TABLE 5

SUGGESTED FRAME STRAIGHTNESS TOLERANCES	
Option	Requirements
PVC corner angle	Fix with fibre cement nails or screws at 200mm centres staggered alternate sides
Taped external corners	Tape and set corners to coating manufacturer's specifications

3.6 SHEET LAYOUT AROUND OPENINGS

At door and window openings, fix sheets around the openings so sheet edges do not coincide with the side of the door or window. This will reduce the possibility of joints cracking due to structural movement. See Figure 15 Option 1.

An alternative method to sheet around openings, is to provide a control joint at the line of an opening edge. Refer to Figure 15, Option 2 and Section 4 for movement joint details.

3.7 CURVED WALLS

Fix the centre of sheets to framing first and work outwards. Ensure sheets are hard against framing before fixing the perimeter of sheet. This will avoid drumminess. For stud and fastener spacing refer to Table 3, for curved wall details see Figure 16.

3.8 MOISTURE MANAGEMENT

3.8.1 General

It is the responsibility of the builders and designers to identify moisture related risks associated with any particular building design.

It is the responsibility of the builder to ensure appropriate moisture management is provided during framed wall construction through effective use of flashings, sealants and vapour permeable membranes such as vapour permeable sarking, building wraps, vapour retarders and damp proof course. Before installing sheeting, all wall openings, penetrations, intersections, connections, window sills, heads and jambs must incorporate appropriate flashing and waterproofing. Materials, components and their installation that are used to manage moisture in framed wall construction must, at a minimum, comply with the requirements of relevant standards, building codes and the manufacturer's specifications.

3.8.2 Weather Barrier

A suitable water control membrane must be installed under Hardie™ cladding in accordance with the AS/NZS 4200.2 'Pliable building membranes and underlays – Installation' and NCC requirements.

James Hardie has tested and certified the use of Hardie™ Wrap Weather Barrier for climate zones 2-8 within Australia. Hardie™ Wrap Weather Barrier is a Class 4 vapour permeable membrane that delivers a triple-shield of protection to help against external weather penetration, internal condensation management and external heat penetration through its safe-glare reflective layer.

If using an alternate product in lieu of Hardie™ Wrap Weather Barrier or the project is located in a hot humid area (Climate Zone 1), the designer must ensure that the product is fit for purpose and it has the following classification in accordance with AS/NZS 4200.1:2017 'Pliable building membranes and underlays – Materials':

WEATHER BARRIER CLASSIFICATION		
Climate Zones	Water Control Classification	Vapour Control Category
2-8	Water Barrier	Vapour Permeable (Class 3 or 4)
1		Vapour Barrier (Class 3 or 4)

Soft compressible insulation installed between the front of the wall studs and directly behind the external cladding can cause installation issues and is thus not recommended.

4 Movement Joints

4.1 GENERAL

Movement joints are designed to take up the structural movement between the sheets and building frame.

4.2 CONTROL JOINTS

4.2.1 Vertical control joints

Vertical control joints must be located in wall runs over 5.4m. For an example of vertical joint layout refer to Figure 17.

In this example the wall run is over 13.2m and requires at least 2 control joints located at a maximum wall run of 5.4m.

The control joints have been positioned to suit window and door openings. There are a number of alternative solutions to the location of vertical control joints. Location of control joints should be considered before installation of sheeting begins.

NOTE

Avoid placing control joints at doors or windows when using architraves.

These control joints require a 6mm gap between sheets. Refer to Figure 18 for details of vertical movement joints.

NOTE

Control joints must be formed using sheets with square cut edges and require a 6mm gap between sheets.

The vertical control joint must be supported on double studs.

See Figure 18.

4.2.2 Horizontal control joints

Horizontal control joints must be located in walls at 3.6m maximum centres. They are also required at floor joist level and at gable ends.

See Figure 17.

For details of horizontal control joints refer to Figure 19. When using architectural trims to cover control joints, ensure that trims are free to float over the bottom sheet by only fixing trim to upper sheet. This will allow for sheet and frame movement.

A horizontal control joint is also required for floor joists that are made from laminated timber "I" beams. These beams should be sufficiently packed out to accommodate fixing of Hardie™ Tex Base Sheets.

4.3 STRUCTURAL JOINTS

Structural movement joints must be provided when required by the designer. They must have total framing separation, including top and bottom plate, lining and cladding to allow for the structural framing expansion and contraction that can occur. See Figure 20.

4.4 CONSTRUCTION JOINTS

4.4.1 Vertical

Vertical construction joints are required where Hardie™ Tex Base Sheets construction intersects with an existing structure (See Figure 21 and Figure 22).

If cement render is applied to masonry wall, do not render hard up against Hardie™ Tex Base Sheet edge. Leave a 6mm joint between the render and Hardie™ Tex Base Sheet and fill with Hardie™ Joint Sealant over bond breaker tape. Coating system must not cover sealant.

4.4.2 Horizontal

Horizontal construction joints are required where upper level Hardie™ Tex Base Sheet construction joins an existing ground floor structure.

See Figure 23.

5 Decorative Treatment

5.1 COATING

Coating systems applied to the Hardie™ Tex Base Sheets must be sufficiently flexible to accommodate stresses across sheet joints. The jointing and coating systems suitable for use with Hardie™ Tex Base Sheet are usually 100% acrylic or pure elastomeric high build texture coatings.

Use texture coating systems that have a minimum thickness of 2mm.

Refer to the coating manufacturer to determine suitable coating for use with Hardie™ Tex Base Sheets.

These systems must be applied by an applicator trained and approved by the coating manufacturer.

Refer to Section 1.3 at the beginning of this guide for further information on factors to be considered.

Where Hardie™ Tex Base Sheets are to be left uncoated for a considerable time, contact the texture coat manufacturer for advice on suitability of texture coat.

It is the responsibility of the applicator to use the appropriate components and compounds sufficient to eliminate cracking under normal building settlement conditions.

For more information regarding coating performance, maintenance and levels of finish refer to Fact Sheet T12 available from and produced by the Australian Paint Manufacturers' Federation Inc. This document is not to be used as a substitute for the manufacturer's requirements.

Hardie™ Tex Base Sheets must be texture coated within 90 days of the installation or within 7 days if located within 1km of a coastal area or corrosive environment.

NOTE

In areas exposed to marine salt spray, it is recommended that texture coatings be applied as soon as possible after sheet fixing to prevent salt build up that could lead to fastener corrosion. For information on texture coats in marine environments contact the texture coat manufacturer.

The texture coat colour applied to both the Hardie™ Tex Base Sheets and PVC accessories, must have a Light Reflective Value (LRV) greater than 40%. Refer to the texture coat manufacturer for the coating's LRV.

James Hardie does not recommend tiling in an external application.

5.2 DECORATIVE TRIMS

Decorative mouldings, refer to Figure 32, can be used to enhance a building, or to create a distinctive style of building facade, eg Tuscan etc. In addition, they can also be strategically placed to hide movement joints.

Mouldings are available for various parts of a building, such as quoining, banding, or to trim windows or doors.

The following types of decorative mouldings are available:

- Cement based profiles (these have superior long-term durability and impact resistance).
- Expanded polystyrene with protective coating (eg fibreglass, polyurethane).

Where moulds are used to hide movement joints they must be allowed to float over the joint. The mould must be attached to one sheet only and must not bridge the joint. See Figure 19.

The moulds must be installed strictly in accordance with the manufacturer's specifications. For further information on moulding suppliers contact Ask James Hardie™ on 13 11 03.

NOTE

Decorative mouldings do not provide effective flashings. Openings and other critical areas must still be flashed using traditional construction methods.

6 Safe Working Practices

WARNING - DO NOT BREATHE DUST AND CUT ONLY IN WELL VENTILATED AREA

Hardie™ products contain sand, a source of respirable crystalline silica. **May cause cancer if dust from product is inhaled. Causes damage to lungs and respiratory system through prolonged or repeated inhalation of dust from product.**

Intact fibre cement products are not expected to result in any adverse toxic effects. The hazard associated with fibre cement arises from the respirable crystalline silica present in dust generated by activities such as cutting, rebating, drilling, routing, sawing, crushing, or otherwise abrading fibre cement, and when cleaning up, disposing of or moving dust.

When doing any of these activities in a manner that generates dust, follow James Hardie instructions and best practices to reduce or limit the release of dust, warn others in the area and consider rotating personnel across the cutting task to further limit respirable silica exposure.

If using a dust mask or respirator, use an AS/NZS1716 P1 filter and refer to Australian/New Zealand Standard 1715:2009 Selection, Use and Maintenance of Respiratory Protective Equipment for more extensive guidance and more options for selecting respirators for workplaces. For further information, refer to our installation instructions and Safety Data Sheets available at www.jameshardie.com.au. FAILURE TO ADHERE TO OUR WARNINGS, SAFETY DATA SHEETS, AND INSTALLATION INSTRUCTIONS MAY LEAD TO SERIOUS PERSONAL INJURY OR DEATH.

JAMES HARDIE RECOMMENDED SAFE WORKING PRACTICES

CUTTING OUTDOORS

1. Position cutting station so wind will blow dust away from the user or others in working area.
2. Warn others in the area to avoid dust.
3. Consider rotating personnel across cutting tasks to further limit respirable silica exposures.
4. Use one of the following methods based on the required cutting rate:
 - Best** ▪ Villaboard™ Knife ▪ Hand guillotine ▪ Fibreshear
 - Better** ▪ Position the cutting station in a well-ventilated area. Use a dust reducing circular saw equipped with Hardie™ Blade Saw Blade or comparable fibre cement blade and well maintained M-class vacuum or higher with appropriate filter for capturing fine (respirable) dust. Wear a properly-fitted, approved dust mask or respirator (minimum P1).

CUTTING INDOORS

- Cut only using Villaboard™ Knife, hand guillotine or fibreshears (manual, electric or pneumatic).
- Position cutting station in a well-ventilated area.

DRILLING/OTHER MACHINING

When drilling or machining you should always wear a P1 dust mask and warn others in the immediate area.

IMPORTANT NOTES

1. For maximum protection (lowest respirable dust production) James Hardie recommends always using best practice cutting methods where feasible.
2. NEVER use a power saw indoors or in a poorly ventilated area.
3. ALWAYS use a dust reducing circular saw equipped with a sawblade specifically designed to minimise dust creation when cutting fibrecement - preferably a sawblade that carries the Hardie™ Blade logo or one with at least equivalent performance - connected to a M class or higher vacuum.
4. NEVER dry sweep - Use wet suppression, or an M class vacuum or higher with appropriate filter.
5. NEVER use grinders.
6. ALWAYS follow tool manufacturers' safety recommendations.
7. ALWAYS wear a properly fitted, approved dusk mask, P1 or higher

DUST MASKS AND RESPIRATORS

As a minimum, an AS/NZS1716 P1 respirator must be used when doing any activity that may create dust. For more extensive guidance and options for selecting respirators for workplaces please refer to Australian/New Zealand Standard 1715:2009 "Selection, Use and Maintenance of Respiratory Protective Equipment". P1 respirators should be used in conjunction with the above cutting practices to minimise dust exposure. For further information, refer to Safety Data Sheet (SDS) available at www.jameshardie.com.au. If concern still exists about exposure levels or you do not comply with the above practices, you should always consult a qualified industrial hygienist or contact James Hardie for further information.

WORKING INSTRUCTIONS

Refer to recommended safe working practices before starting any cutting or machining of product.

Score and snap

Score and snap is a fast and efficient method of cutting Hardie™ building products using the Hardie™ Villaboard™ Knife. Preferably score on the face side of the product. Score against a straight edge and repeat the action to obtain adequate depth for clean break – normally one third of sheet thickness. Snap upwards to achieve break. Smooth any rough edges with a rasp.

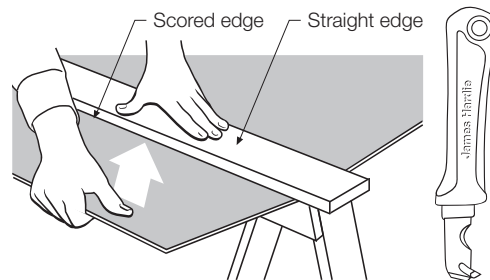

Hand guillotine

Make guillotine cut on the off-cut side of line to allow for the thickness of the blade.

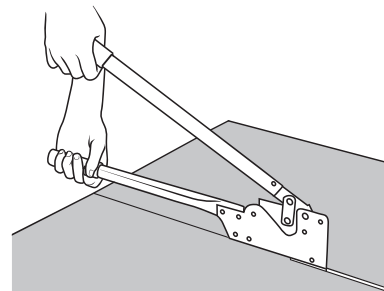

Fibreshear

An electrically powered, fast, clean and effortless way of cutting James Hardie™ building products, especially around curves such as archways. Make fibreshear cut on the 'off-cut' side of the line to allow for the thickness of the shear.

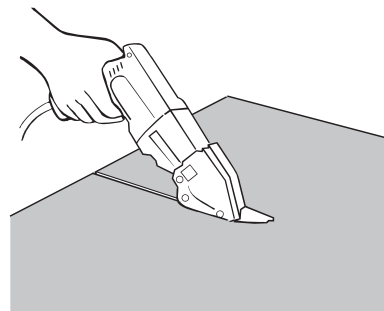

7 Product Information

Hardie™ Blade Saw Blade

The Hardie™ Blade Saw Blade used with a dust-reducing saw and M class or higher vacuum extraction allows for fast, clean cutting of Hardie™ fibre cement products. A dust-reducing saw uses a dust deflector or a dust collector which can be connected to a vacuum system. When sawing, clamp a straight-edge to the sheet as a guide and run the saw base plate along the straight edge when making the cut.

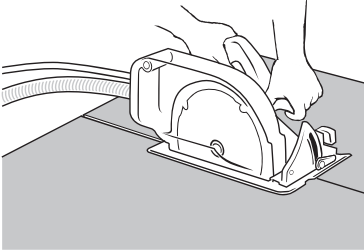

HOLE-FORMING

For smooth clean cut circular holes:

- Mark the centre of the hole on the sheet.
- Pre-drill a pilot hole.
- Using the pilot hole as a guide, cut the hole to the appropriate diameter with a hole saw fitted to a heavy duty electric drill.

For irregular holes:

- Small rectangular or circular holes can be cut by drilling a series of small holes around the perimeter of the hole then tapping out the waste piece from the sheet face.
- Tap carefully to avoid damage to sheets, ensuring the sheet edges are properly supported.

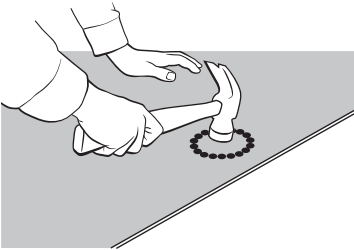

STORAGE AND HANDLING

To avoid damage, all Hardie™ building products should be stored with edges and corners of the sheets protected from chipping.

Hardie™ building products must be installed in a dry state and protected from rain during transport and storage. The product must be laid flat under cover on a smooth level surface clear of the ground to avoid exposure to water, moisture, etc.

QUALITY

James Hardie conducts stringent quality checks to ensure any product manufactured falls within our quality spectrum. It is the responsibility of the builder to ensure the product meets aesthetic requirements before installation. James Hardie will not be responsible for rectifying obvious aesthetic surface variations following installation.

7.1 GENERAL

The basic composition of Hardie™ building products is Portland cement, ground sand, cellulose fibre, water and proprietary additives.

Hardie™ building products are manufactured AS/NZS 2908.2 'Cellulose-Cement Products-Flat Sheet'. These are also compliant with equivalent standard ISO 8336 'Fibre-cement flat sheets - Product specification and test methods'. For product classification refer to the relevant Physical Properties Data Sheet.

7.2 PRODUCT MASS

Based on equilibrium moisture content the approximate mass of Hardie™ Tex Base Sheet is 10.10kg/m².

7.3 DURABILITY

7.3.1 Resistance to moisture/rotting

Hardie™ Tex Base Sheet has demonstrated resistance to permanent moisture induced deterioration (rotting) by passing the following tests in accordance with AS/NZS 2908.2:

- Water permeability (Clause 8.2.2)
- Warm water (Clause 8.2.4)
- Heat rain (Clause 6.5)
- Soak dry (Clause 8.2.5)

7.3.2 Resistance to fire

Hardie™ Tex Base Sheet is suitable where non-combustible materials are required in accordance with C2D10 of the Building Code of Australia.

Hardie™ building products have been tested by CSIRO in accordance with AS/NZS 3837 and are classified as conforming to Group 1 material (highest and best result possible), with an average specific extinction area far lower than the permissible 250m²/kg, as referenced in Specification C2D11 of the National Construction Code (NCC)."

7.3.3 Resistance to termite attack

Based on testing completed by CSIRO Division of Forest Products and Ensis Australia Hardie™ building products have demonstrated resistance to termite attack.

7.4 ALPINE REGIONS

In regions subject to freeze/thaw conditions, all Hardie™ fibre cement external cladding must be installed and painted in the warmer months of the year where the temperature does not create freeze and thaw conditions or paint issues. The cladding must be painted immediately after installation. In addition, fibre cement cladding must not be in direct contact with snow and/or ice build up for extended periods, e.g. external walls in alpine regions subject to snow drifts over winter.

Furthermore, a reputable paint manufacturer must be consulted in regards to a suitable product, specifications and warranty. The paint application must not be carried out if the air temperature or the substrate temperature is outside the paint manufacturer's recommendation including the specified drying temperature range.

Hardie™ external cladding products are tested for resistance to frost in accordance with AS/NZS 2908.2.

8 Components

The following checklist describes the components required to install Hardie™ Tex Base Sheet.

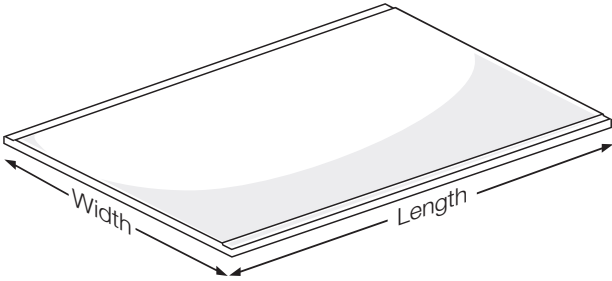
HARDIE™ TEX BASE SHEET 7.5MM THICK		
	Surface: Flat sheet—blue coloured. Edges to long sides of sheets recessed for set jointing. Short sides square edged, to be site recessed where jointing if required. All Hardie™ Tex Base Sheets are clearly marked with: “HARDIE™ TEX NAIL AT 200mm CENTRES, SUPPORT ALL JOINTS” on the front of the sheets.	
	Thickness: 7.5mm Mass: 10.10/kgm ²	
	LENGTH (MM)	WIDTH (MM)
	2440	1200
	2725	1200
	3000	1200
		PRODUCT CODE
		401651
		400294
		400291

*All dimensions and masses are approximate and subject to manufacture tolerances.

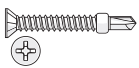
HARDIE™ TEX BASE SHEET COMPONENTS		
	Hardie™ Drive Screw. 41mm long A class 3 self-tapping wing-tipped screw for fastening to 0.5mm to 1.6mm BMT light gauge steel frames.	1000 per box Part No.: 305984
	Hardie™ Drive Collated Screw. 41mm long A class 3 self-tapping wing-tipped screw for fastening to 0.5mm to 1.6mm BMT light gauge steel frames. Suitable for use in most auto feed screw guns.	1000 per box Part No.: 305982
	Hardie™ 7.5mm PVC Starter Strip. 3,000mm long A perforated PVC extrusion, used with Hardie™ Tex Base Sheet to provide a straight edge to finish the texture coating or used with PrimeLine™ Newport Weatherboard to secure the bottom row at the correct angle. See Figure 24 in installation guide.	25 Per Pack Part No.: 305568
	Hardie™ Tex 7.5mm PVC Z Flashing. 3,000mm long A PVC extrusion for use with Hardie™ Tex Base Sheet to provide an alternate detail option at horizontal control joints.	25 Per Pack Part No.: 305569
	Hardie™ Joint Sealant. 300ml cartridge A general purpose, paintable, exterior grade polyurethane joint sealant.	20 Per Pack Part No.: 305534 Detailed information: refer to Figures 14, 18 – 22, 26, 27, 29 and 30
	Villaboard™ Knife A score and snap knife designed to efficiently cut through fibre cement sheets ≤9mm thick.	12 Per Box Part No.: 305915
	Hardie™ Fibreshears. Electric tool for cutting fibre cement sheets.	1 Each Part No.: 300653
	Hardie™ Blade Saw Blade. 185mm diameter A 185mm diameter poly-diamond blade for fast and clean cutting of Hardie™ fibre cement.	1 Each Part No.: 300660
	Hardie™ Break Thermal Strip A building code requirement and is installed behind Hardie™ external cladding over metal framing and Hardie™ Wrap Weather Barrier. Refer to Hardie™ Break Thermal Strip installation guide. Unit size 43 x 12 x 2750mm	45 Per Pack Part No.: 305612
	Hardie™ Wrap Weather Barrier A non-perforated, highly breathable and reflective safe-glare weather barrier designed to be used behind Hardie™ Tex Base Sheets help protect the building. For alternate products, please refer to Hardie™ Wrap Weather Barrier section 3.8.2. Unit size: 2750mm x 3000mm	1 Each Part No.: 305664

COMPONENTS NOT SUPPLIED BY JAMES HARDIE

James Hardie recommends the following products for use in conjunction with its Hardie™ Tex Base Sheet. James Hardie does not supply these products and does not provide a warranty for their use. Please contact the component manufacturer for information on their warranties and further information on their products.

Fibre cement nails. Galvanised nails for timber. NOTE: In coastal and other areas subject to salt spray, contact your fastener manufacturer for fasteners with suitable corrosion resistance.	2.8 x 30mm
PVC perforated external corner Taped and set corners – to satisfy coating manufacture's specifications.	
Textured finish coating systems Proprietary jointing and coating systems applied in accordance with the coating manufacturer's specification by their accredited applicators. Taped and set corners when required- to satisfy coating manufacturer's specification. For detailed information on these systems refer to Sections 1- Introduction and 7- Decorative treatment. NOTE: It is essential that components from different suppliers are not combined or blended, as they may not be compatible.	
Hitachi Easy Bevel attachment fitted to suitable angle grinder, with dust extraction apparatus fitted.	

9 Details

9.1 GENERAL

Various details are outlined below and are also available in CAD format at www.myhardies.jameshardie.com.au

All dimensions are in millimetres unless shown otherwise.

9.2 SLAB ON GROUND AND PLATFORM FLOORS

9.2.1 General

The slab and footings on which the building is situated must comply with AS 2870 'Residential slabs and footings - Construction' and the requirements of the National Construction Code (NCC).

Install Hardie™ external cladding with a minimum 150mm clearance to the earth on the exterior of the building or in accordance with local building codes if greater than 150mm is required.

Maintain a minimum 50mm clearance between Hardie™ external cladding and roofs, decks, paths, steps and driveways.

Adjacent finished grade must slope away from the building in accordance with local building codes, typically a minimum slope of 50mm minimum over the first metre.

Do not install external cladding such that it may remain in contact with standing water.

NOTE

Greater clearance may be required in order to comply with termite protection provisions.

The NCC specifies the requirements for termite barriers and must be complied with. Where the exposed slab edge is used as part of the termite barrier system, a minimum of 75mm of the exposed slab edge must be visible to permit ready detection of termite entry.

9.2.2 Slab on ground

For detail at slab on ground edge refer to Figure 24.

9.2.3 Platform floors

For platform floors, Hardie™ Tex Base Sheet can be used to infill between the floor and the ground, eg on stepped or sloping sites. Refer to Figure 25 as an illustration only.

Ensure sheets are clear of the ground by finishing to a formed masonry kerb, etc or provide a gap. Where masonry plinths are offset outward, use flashing to prevent water ponding at the sheet edge.

Ventilation to the floor space can be provided by a gap at the base of sheets to the ground or by installing wall vents. Ensure adequate sub-floor ventilation is provided around the perimeter of the platform floor.

9.3 WINDOWS

For sheet layout around window openings refer to Figure 15.

For typical aluminium and timber framed window fixing details, refer to Figures 26, 27, 28.

Refer to window manufacturer for appropriate installation and flashing details. Ensure flashing is installed correctly to facilitate water escape from window frames.

Figure 26 includes optional decorative trim that can be used to create a sense of depth around windows just like a rendered masonry wall. Refer to Section 7 for further information on decorative trims.

9.4 EAVES LINING

Hardie™ Tex Base Sheet can stop at the eaves lining (See Figure 29), or alternatively run through to the top plate so as to provide bracing capacity for the wall (See Figure 30).

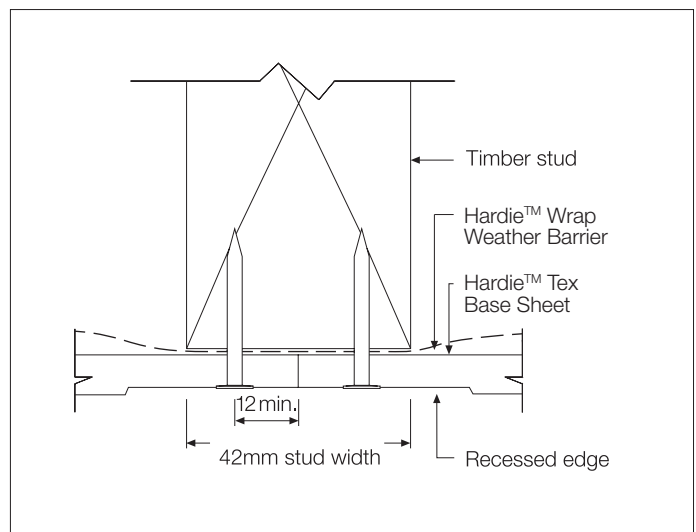

FIGURE 1 SINGLE TIMBER STUD

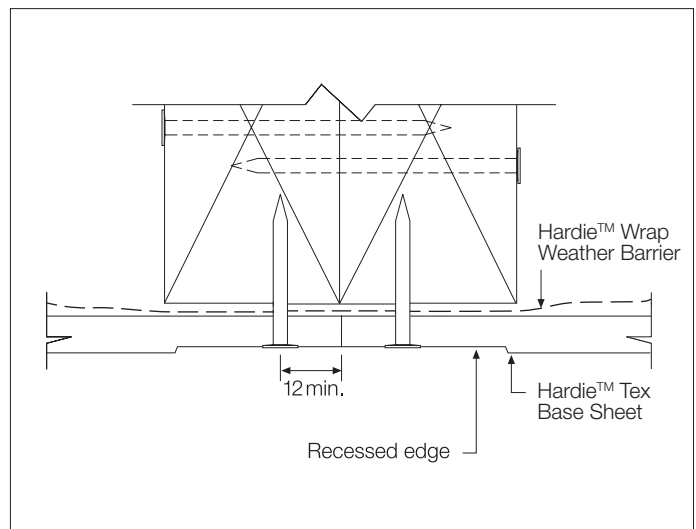

FIGURE 2 DOUBLE TIMBER STUD

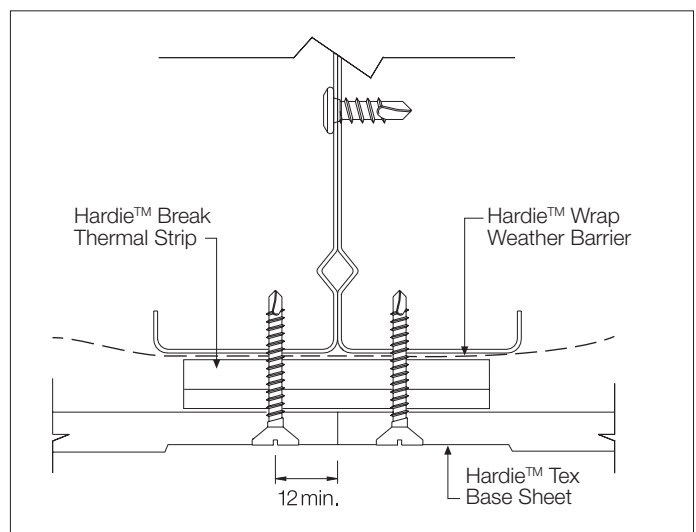

FIGURE 3 DOUBLE STEEL STUD

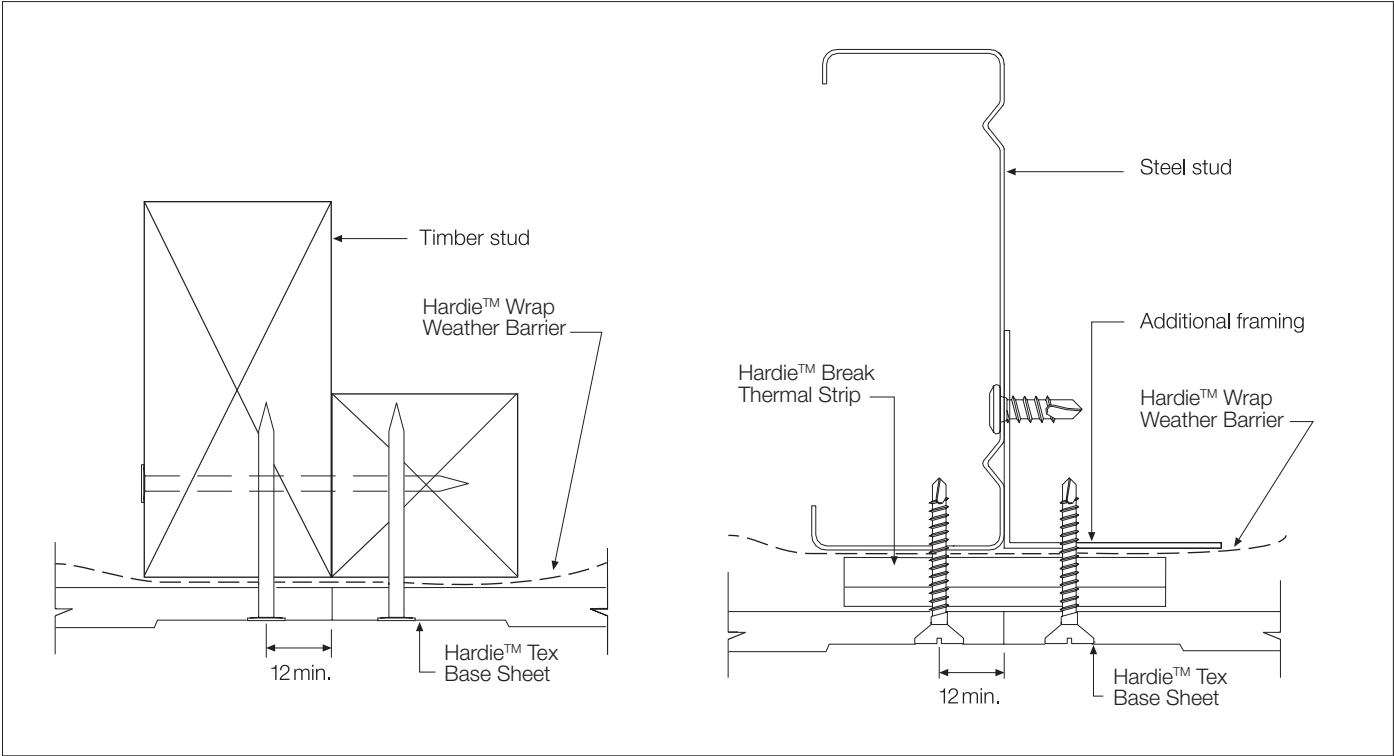

FIGURE 4 ADDITIONAL FRAMING FOR SHEET EDGE SUPPORT

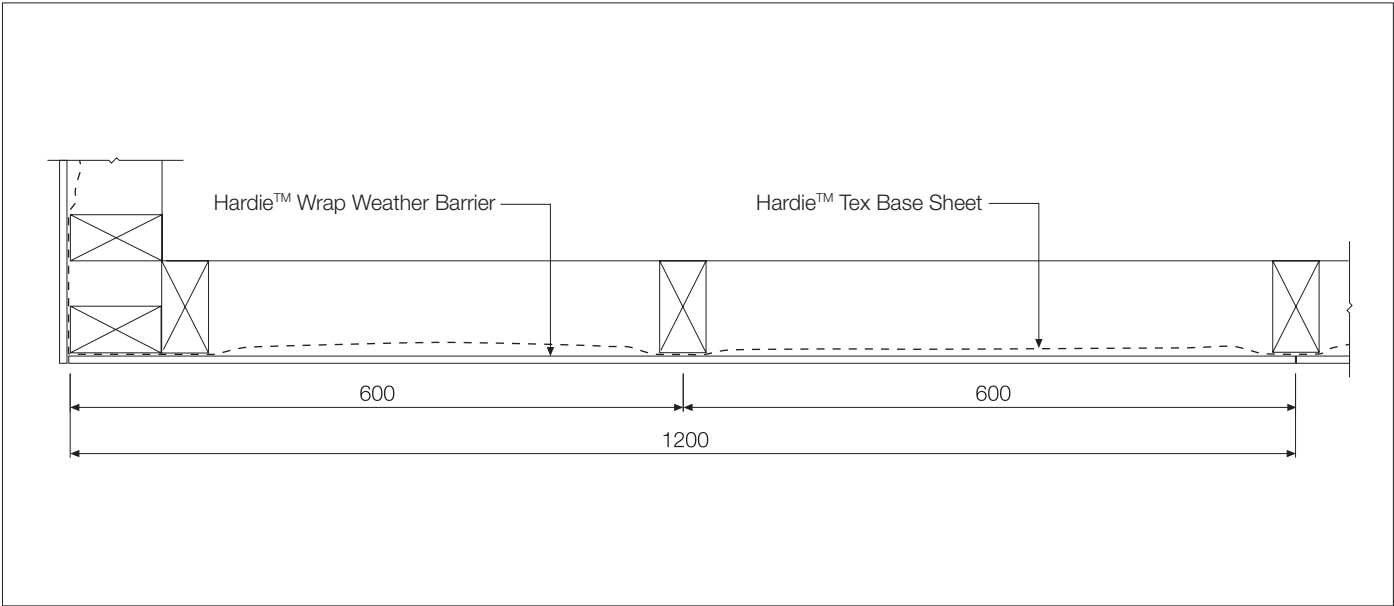

FIGURE 5 TIMBER FRAMING STUD SET OUT

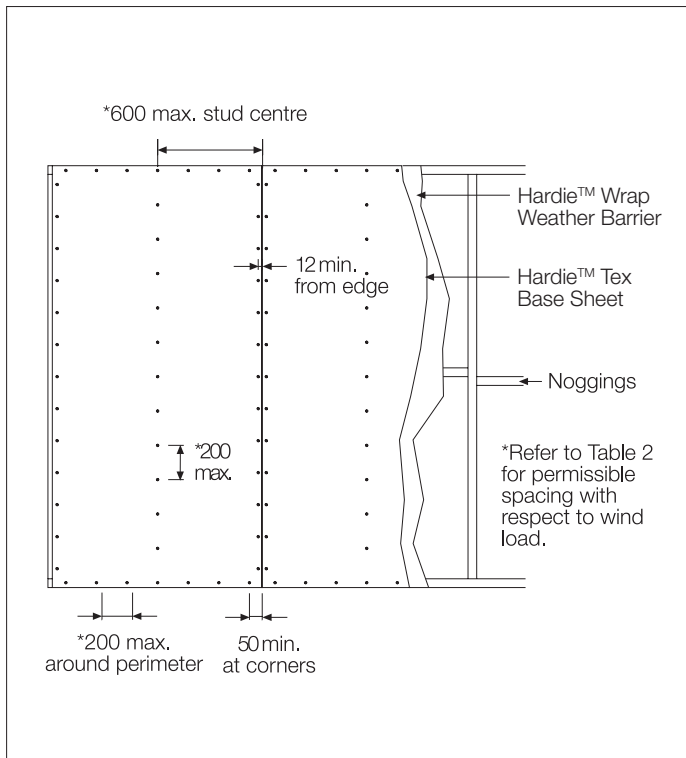

FIGURE 6 VERTICAL SHEET FIXING

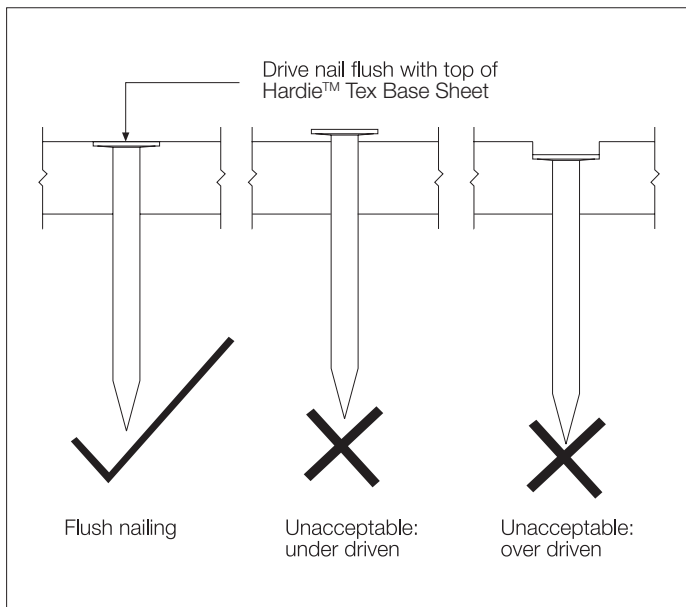

FIGURE 7 NAIL FASTENER DEPTH

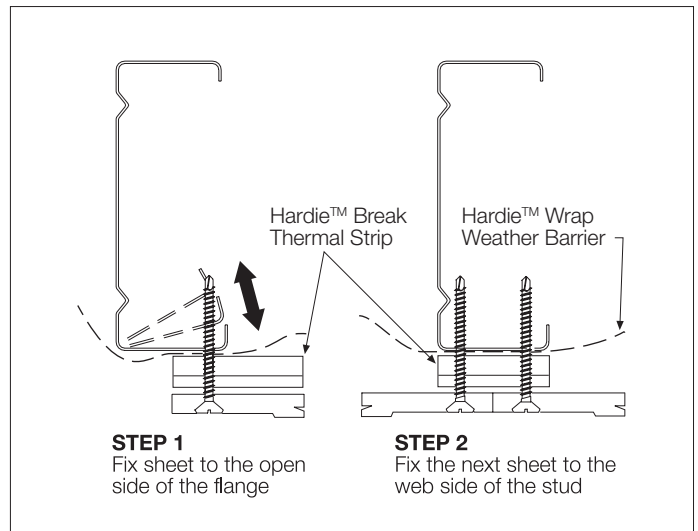

FIGURE 8 SCREW FASTENING

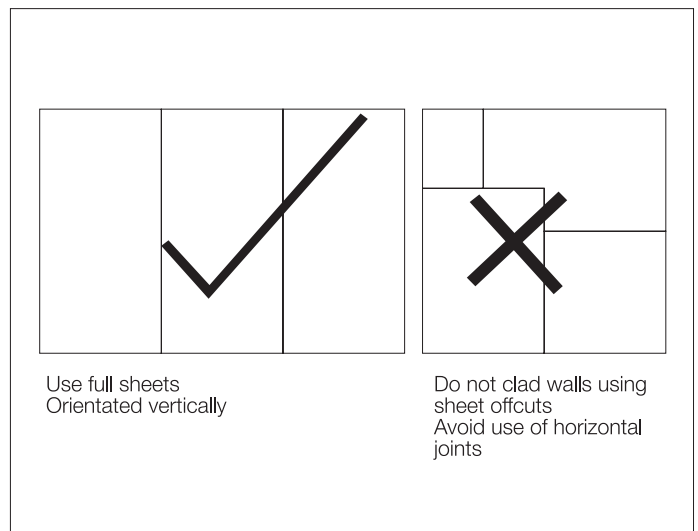

FIGURE 9 USE FULL SHEETS

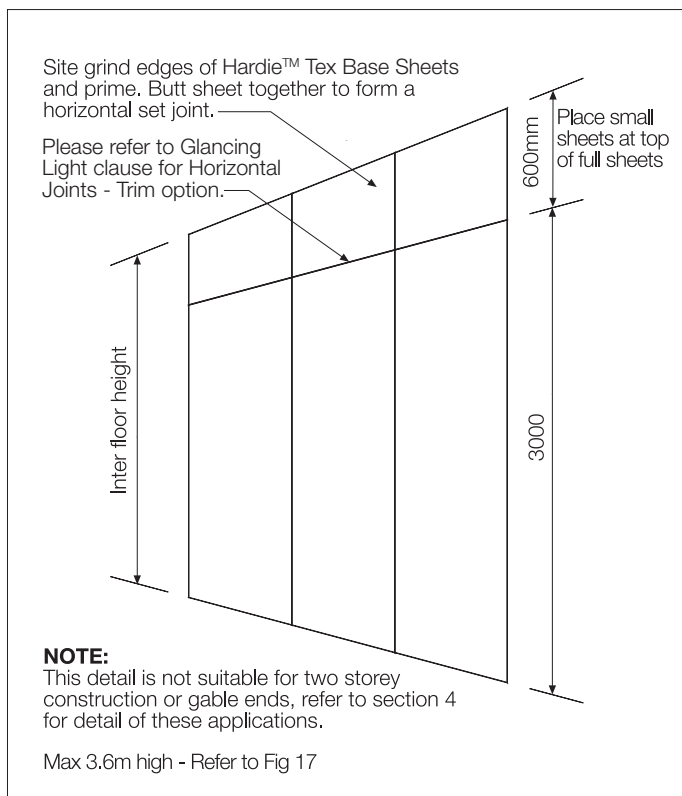

FIGURE 10 PLACE SMALL SHEETS ON TOP

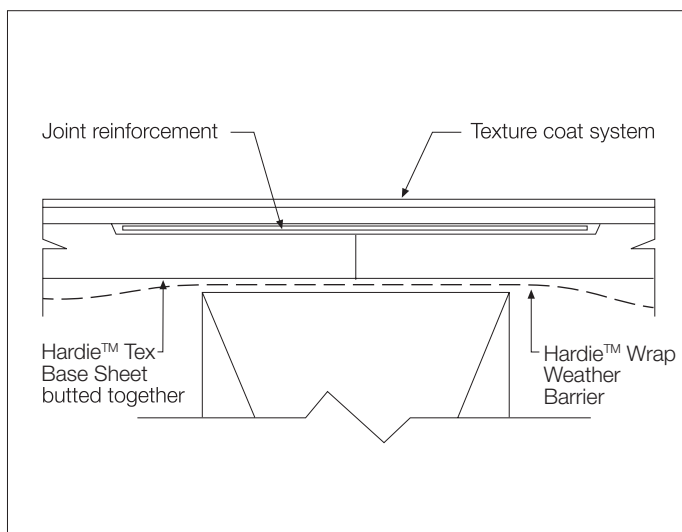

FIGURE 11 FLUSH SET JOINT

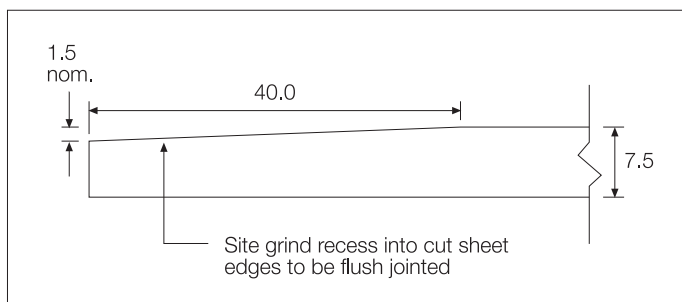

FIGURE 12 SITE GROUND RECESSED EDGE DETAIL

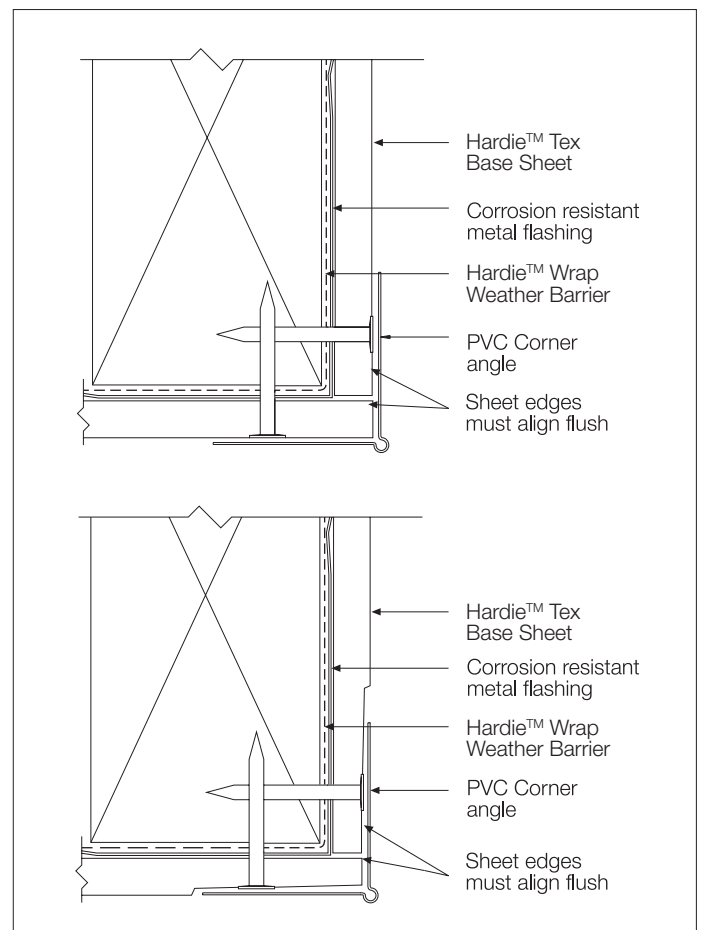

FIGURE 13 EXTERNAL CORNER OPTION 1 AND 2

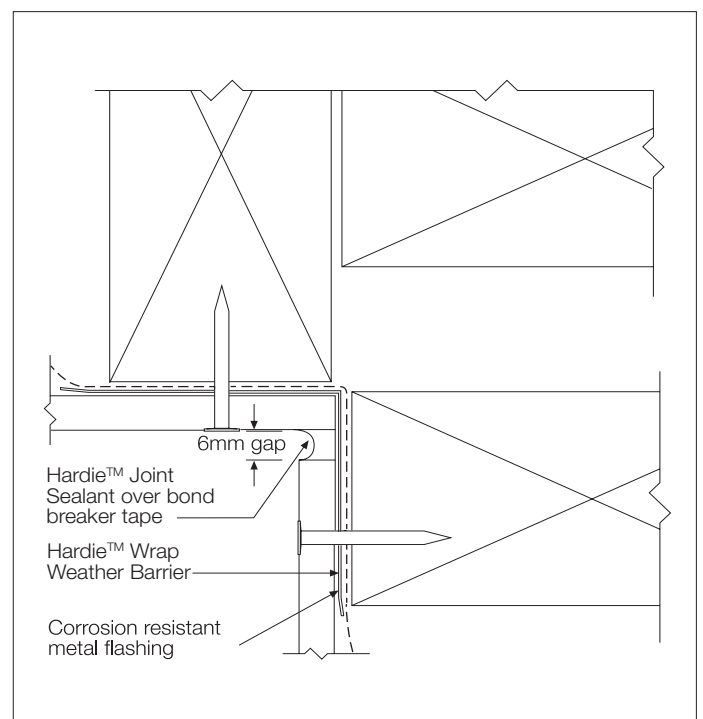

FIGURE 14 INTERNAL CORNER

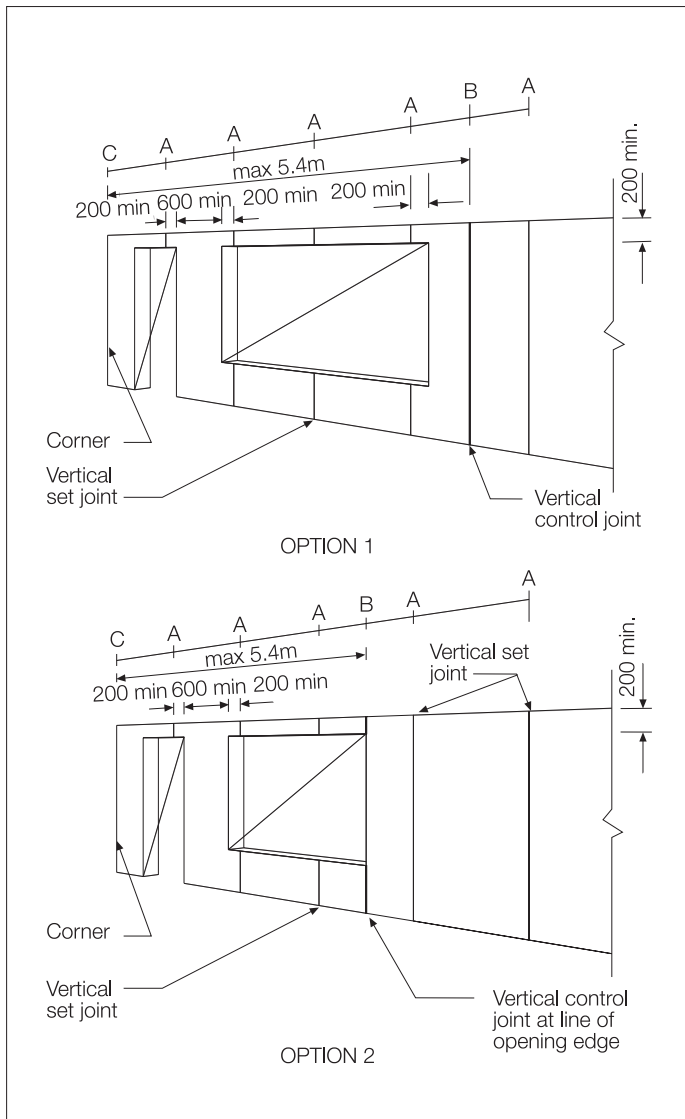

FIGURE 15 SHEET LAYOUT AROUND OPENINGS

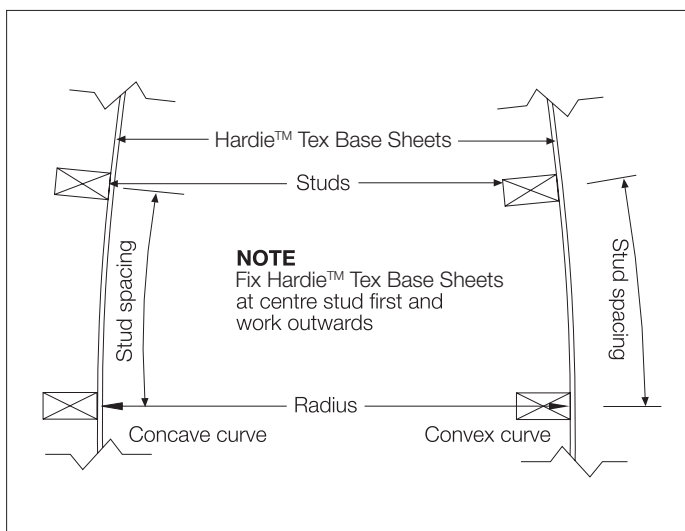

FIGURE 16 CURVED WALLS

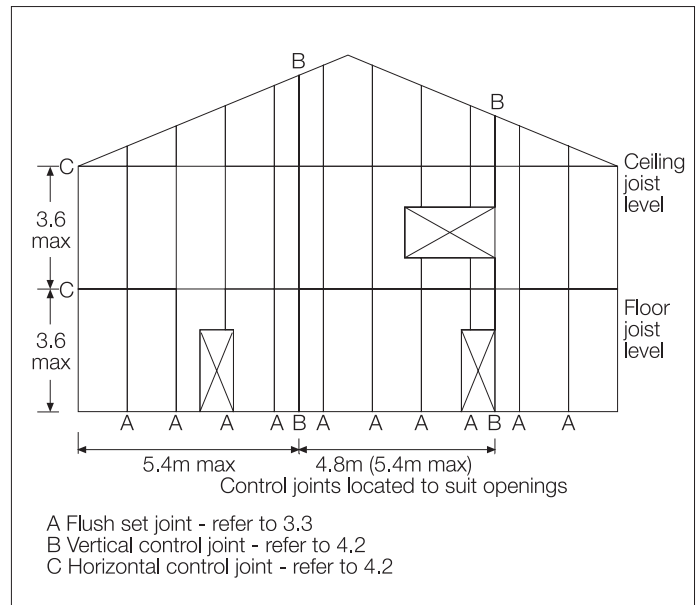

FIGURE 17 AN EXAMPLE OF CONTROL JOINT LAYOUT

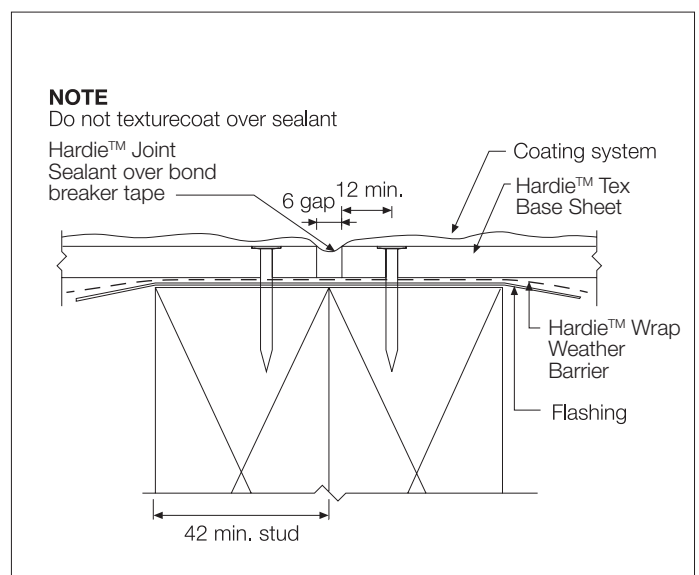

FIGURE 18 VERTICAL CONTROL JOINTS

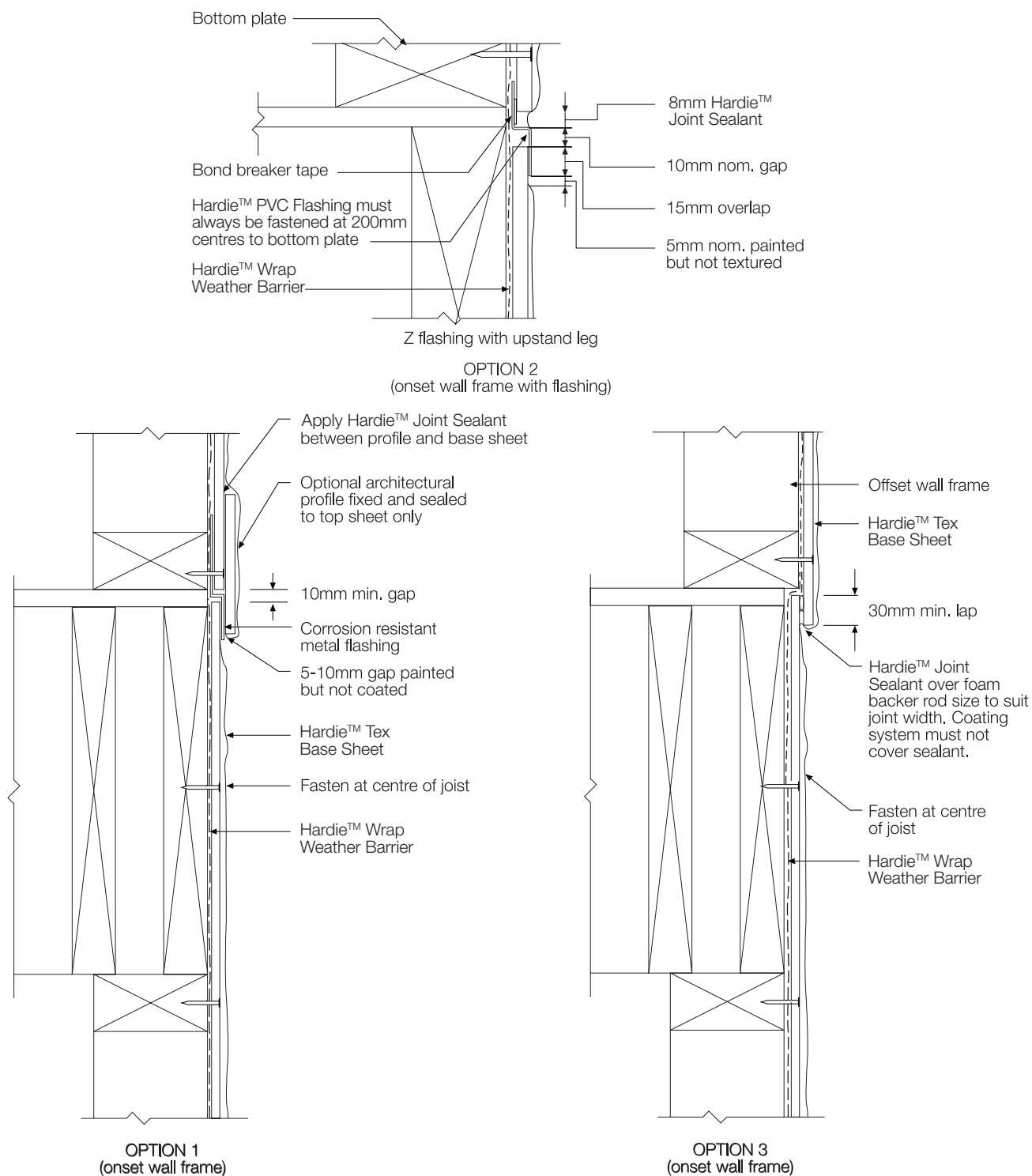

FIGURE 19 HORIZONTAL CONTROL JOINT - FLOOR JUNCTION OF A TWO STOREY HARDIE™ TEX WALL

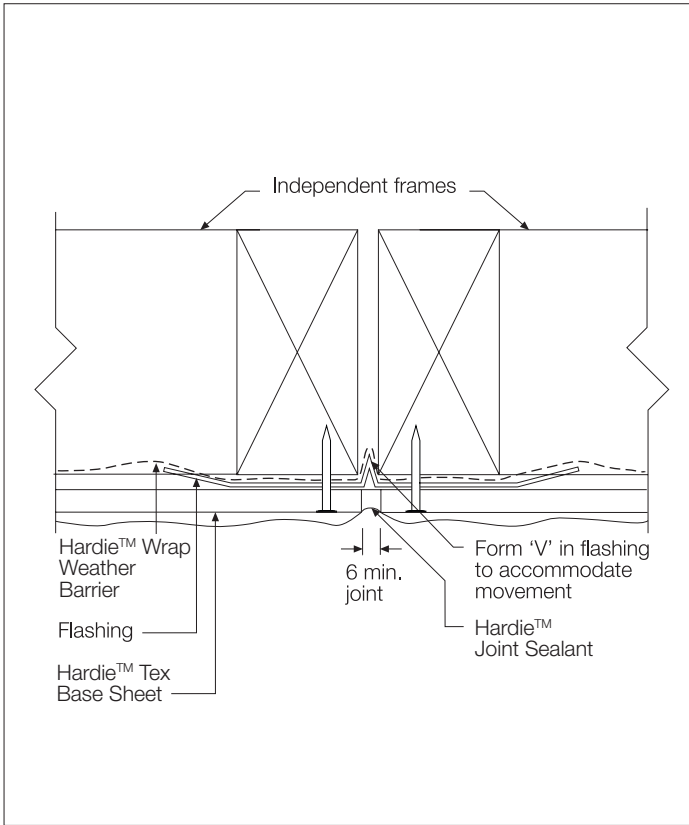

FIGURE 20 VERTICAL MOVEMENT JOINT IN HARDIE™ TEX WALL (CONTROL JOINT REQUIRED BY DESIGN)

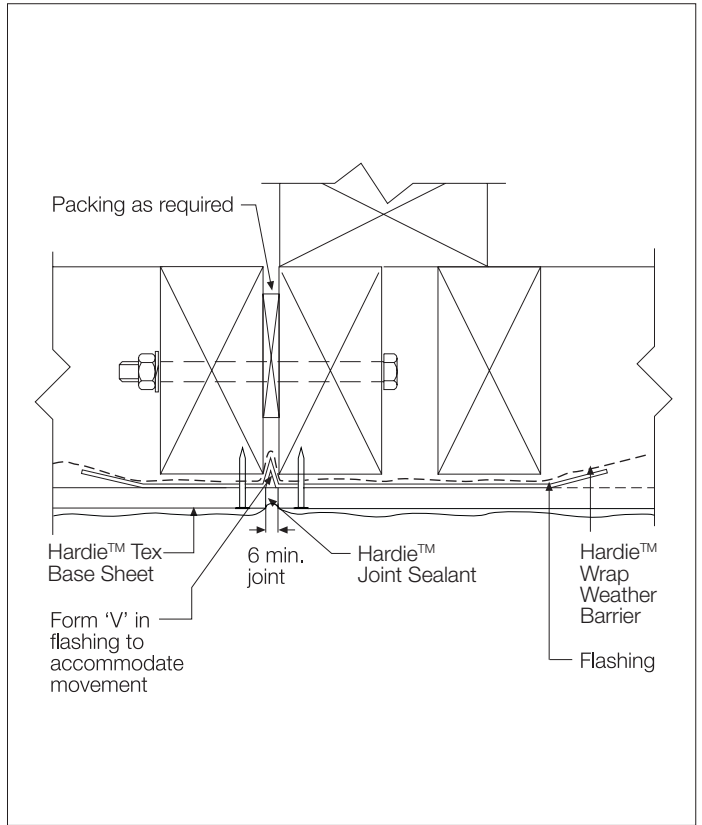

FIGURE 22 VERTICAL MOVEMENT JOINT - INTERSECTION WITH EXISTING CLAD STRUCTURE

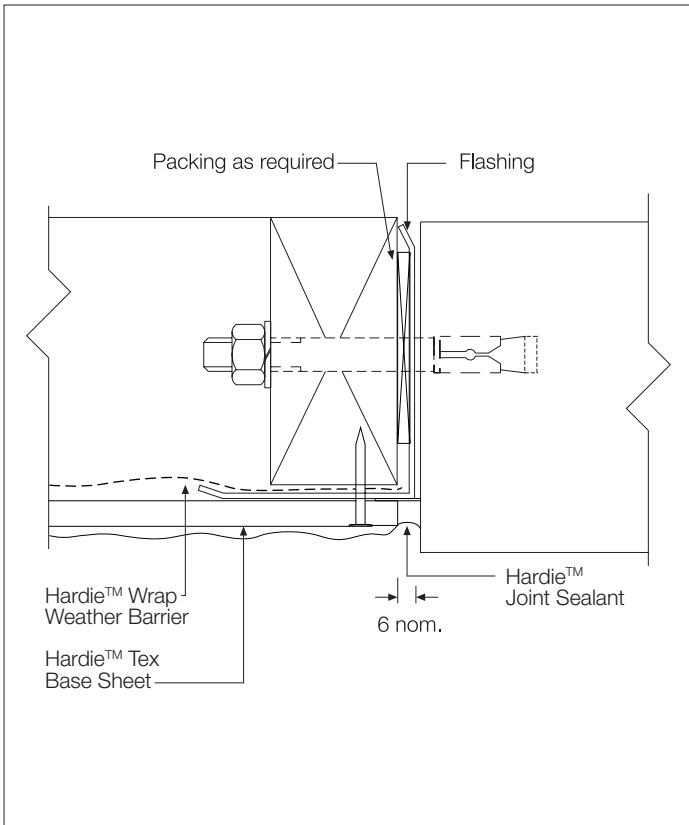

FIGURE 21 VERTICAL MOVEMENT JOINT - INTERSECTION WITH MASONRY STRUCTURE

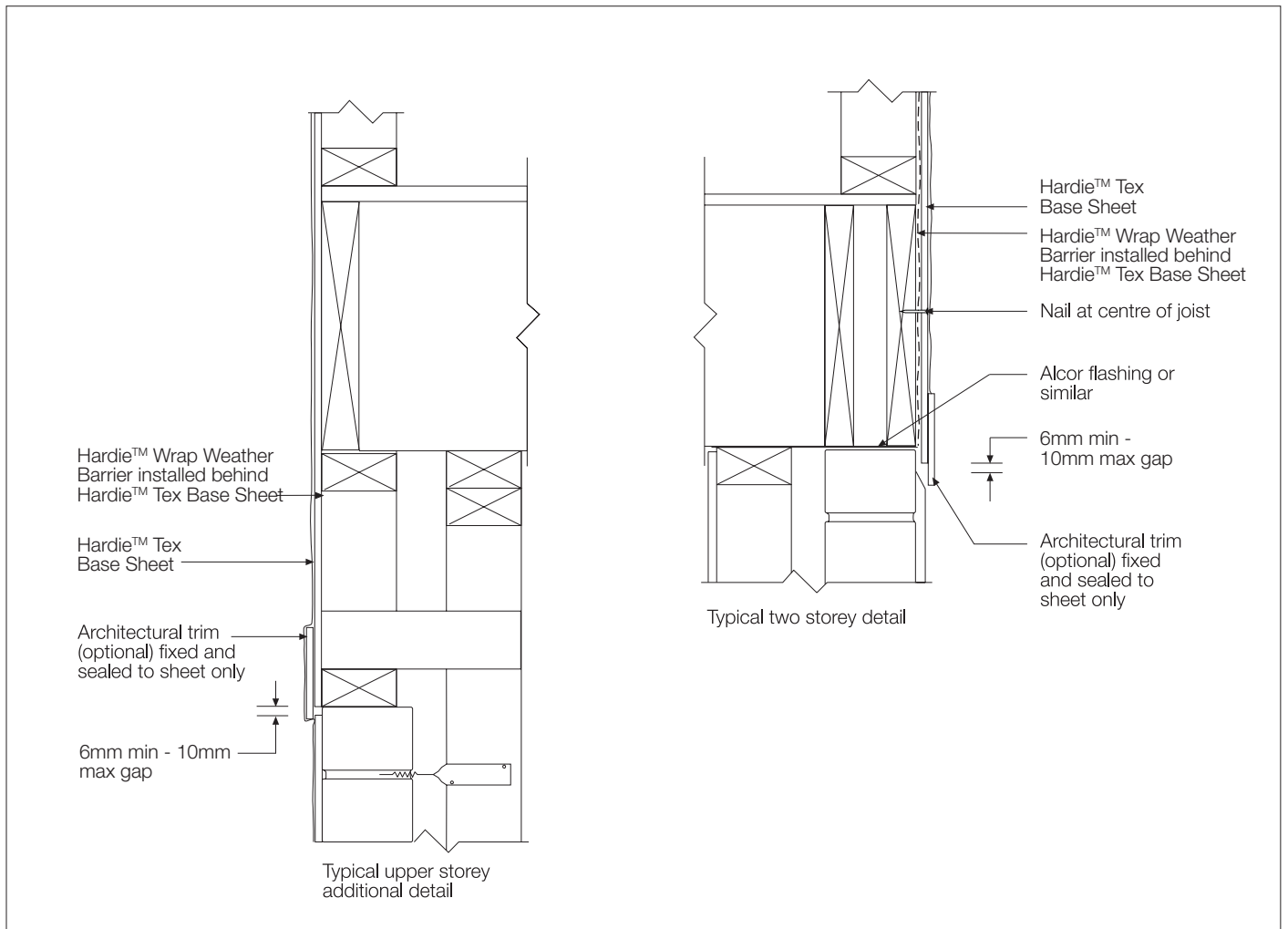

FIGURE 23 HORIZONTAL MOVEMENT JOINT - FLOOR JUNCTION WITH MASONRY GROUND FLOOR

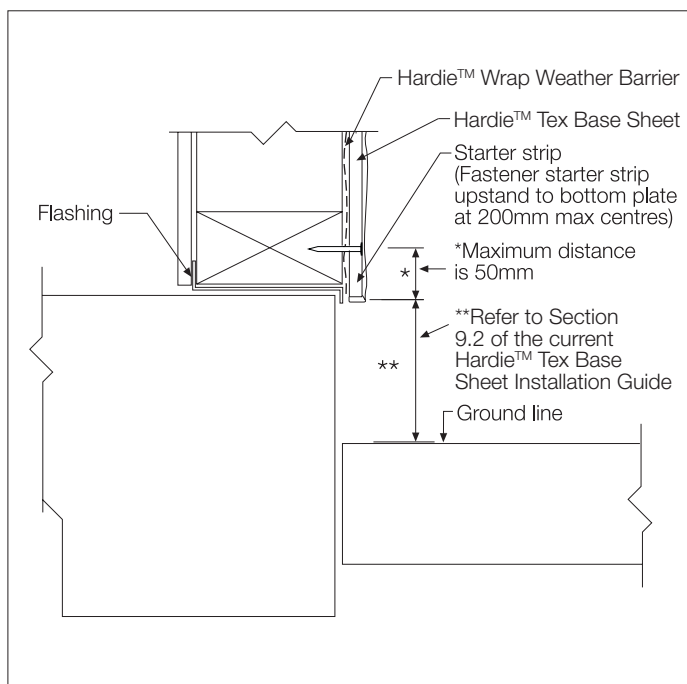

FIGURE 24 SLAB EDGE DETAIL

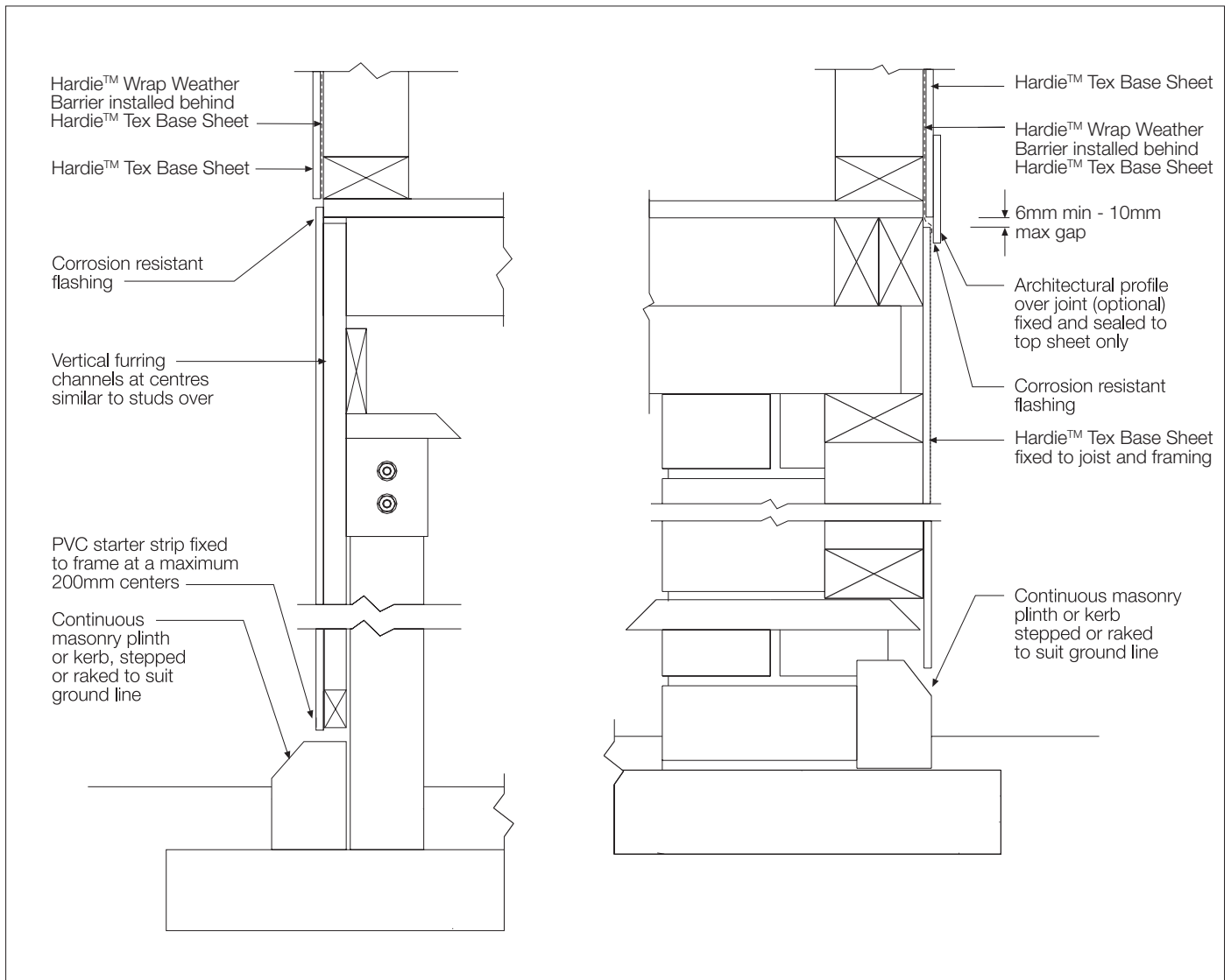

FIGURE 25 PLATFORM FLOOR DETAIL

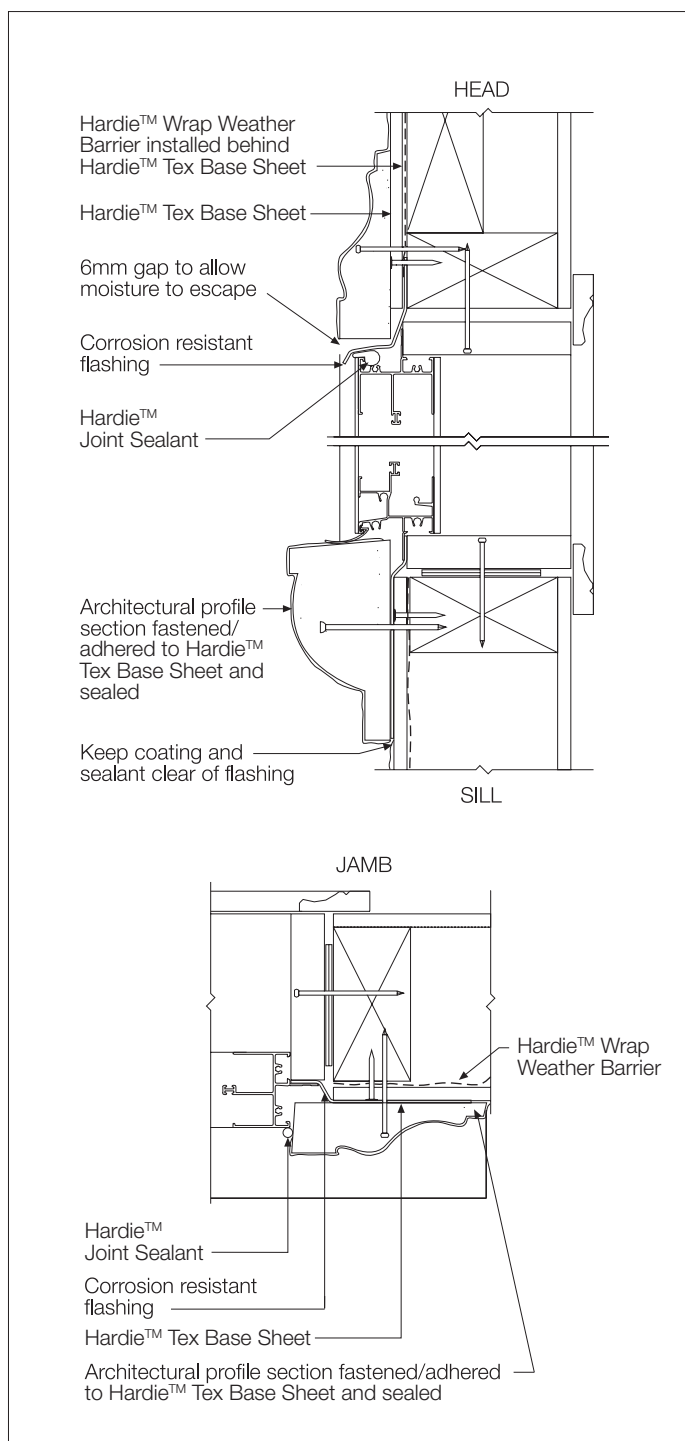

FIGURE 26 ALUMINIUM WINDOW DETAILS - WITH DECORATIVE TRIM

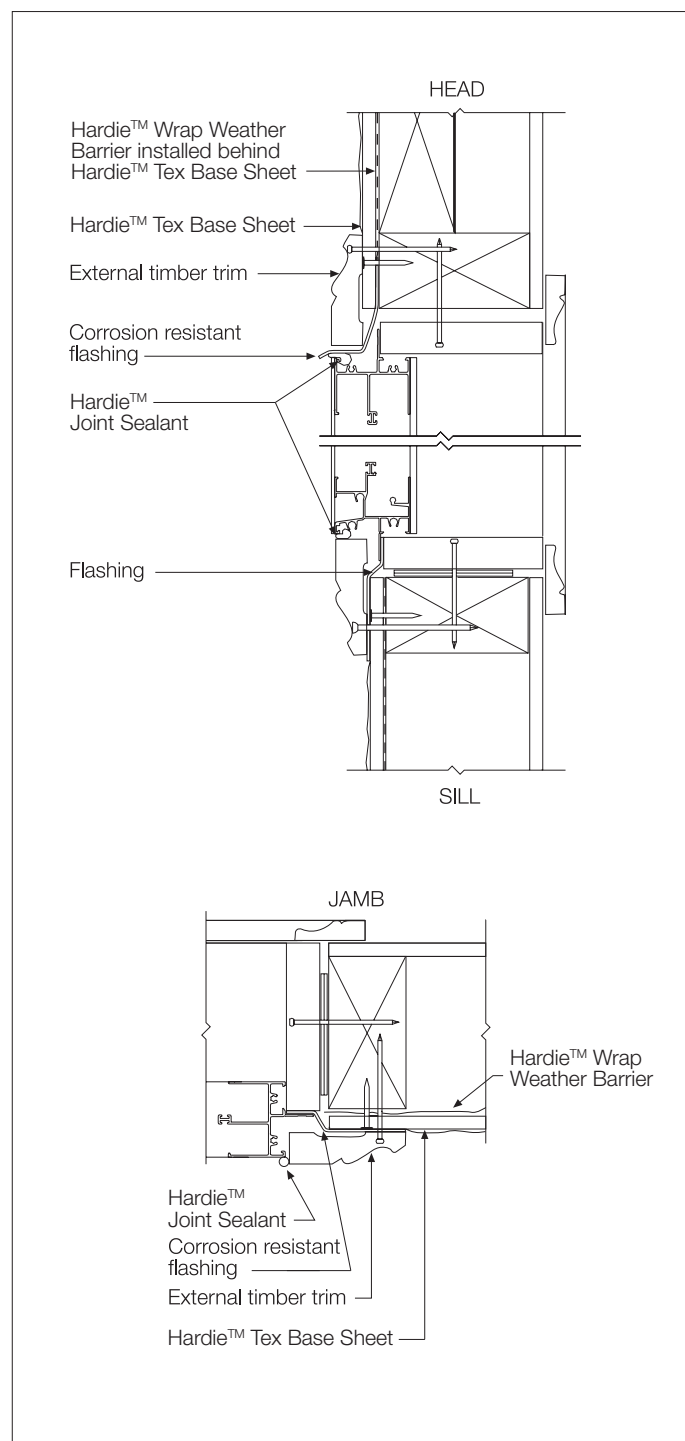

FIGURE 27 ALUMINIUM WINDOW DETAILS - WITH TIMBER TRIM

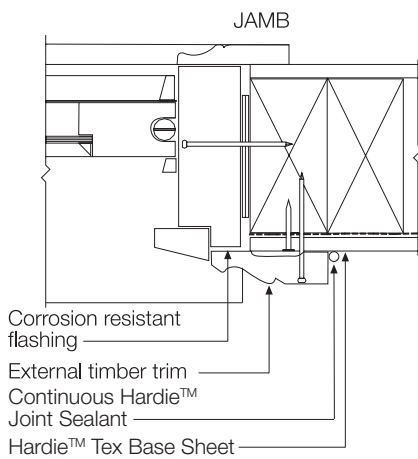
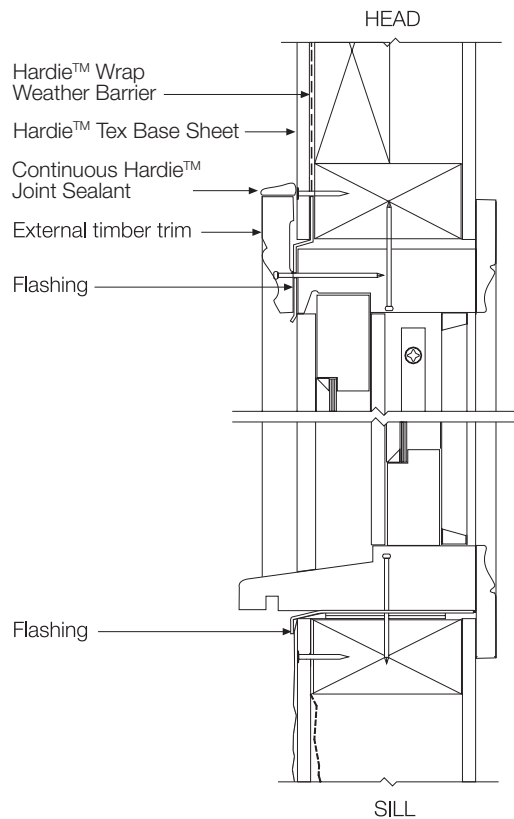

FIGURE 28 **TIMBER WINDOW DETAILS - WITH TIMBER TRIM**

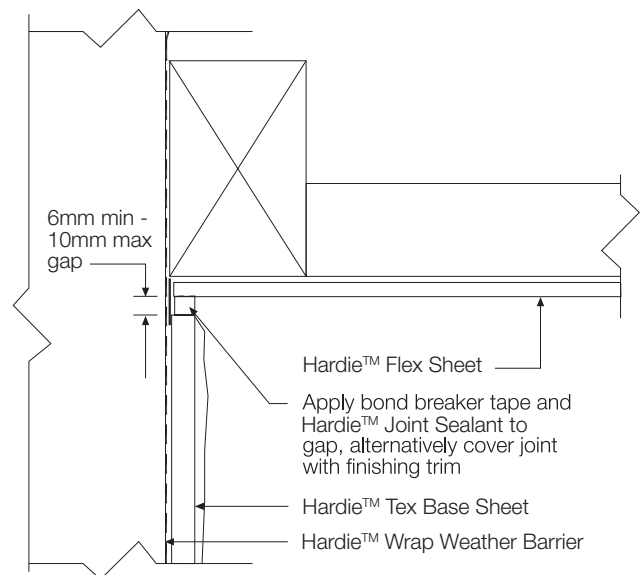

FIGURE 29 **HARDIE™ TEX SHEET STOPS AT EAVES LINING**

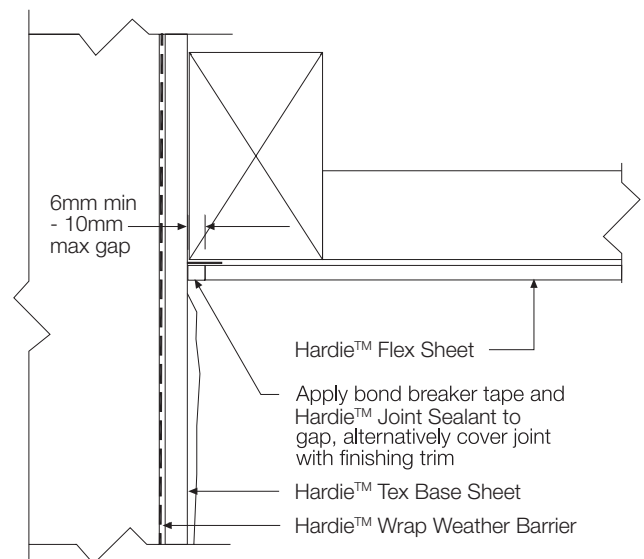

FIGURE 30 **HARDIE™ TEX SHEET CONTINUES PAST EAVES LINING**

10 Maintenance

The extent and nature of maintenance will depend on the geographical location and exposure of the building. As a guide, it is recommended that basic normal maintenance tasks shall include but not be limited to:

- Washing down exterior surfaces every 6-12 months*
- Periodic inspections should be made to ensure fasteners are adequately securing the sheets to framing.
- Re-applying of exterior protective finishes*
- Maintaining the exterior envelope and connections including joints, penetrations, flashings and sealants that may provide a means of moisture entry beyond the exterior cladding.
- Cleaning out gutters, blocked pipes and overflows as required.
- Pruning back vegetation that is close to or touching the building.

*Refer to your paint manufacturer for washing down and recoating requirements related to paint performance.

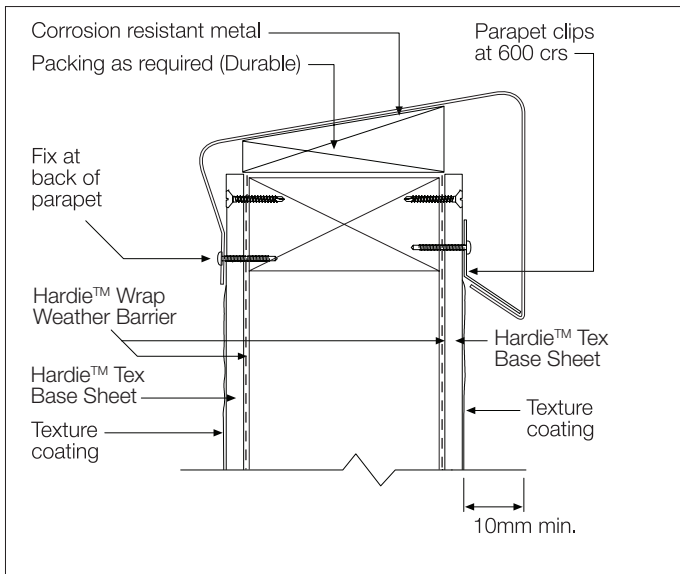

FIGURE 31 PARAPET CAPPING

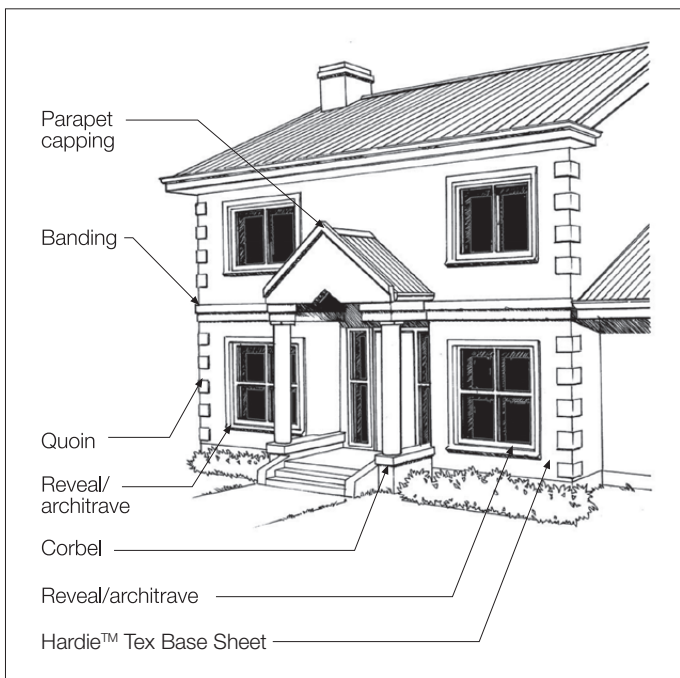

FIGURE 32 EXAMPLE OF USE OF DECORATIVE TREATMENTS

Notes



**For information and advice
call 13 11 03 | jameshardie.com.au**

Australia March 2024