

OPERATING AND MAINTENANCE

INSTRUCTIONS

P/N 112300-001

MODEL 1320 AXIAL BLOWER

TABLE OF CONTENTS

<u>SECTION</u>		<u>PAGE NUMBERS</u>
1.0	GENERAL	1
2.0	SAFETY PRECAUTIONS	1
3.0	MAINTENANCE & REPAIR	1-2
4.0	PRODUCT DESCRIPTION	2
5.0	START-UP AND OPERATING PROCEDURES	2
6.0	PARTS LIST	3-4

ASSEMBLY DRAWINGS
WIRING DIAGRAMS
ACCESSORIES/OPTIONS

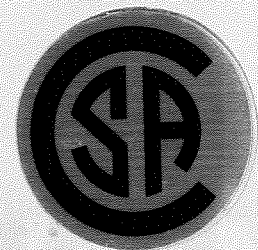

T. A. PELSUE COMPANY
2500 S. Tejon St., Englewood, CO 80110

PELSUE 1320D AXIAL BLOWER

1.0 GENERAL

1.01 This manual covers the description, operation and maintenance of the Pelsue Model 1320 Axial Blower.

PLEASE TAKE THE TIME TO READ THIS MANUAL BEFORE OPERATING BLOWER.

1.02 The 1320 portable blower, is specifically designed to provide a completely portable source of fresh air. This blower is powered by an 120V AC, 60 HZ electrical source.

2.0 SAFETY PRECAUTIONS

FOR YOUR SAFETY

READ THE FOLLOWING SAFETY PRECAUTIONS.

2.01 Do not use the blower for other than its intended use.

2.02 Do not wear loose clothing that can become entangled in operating machinery. Do not operate blower without inlet or outlet screen guards in place. (if guards are missing or damaged, contact factory for replacements).

2.03 Do not place fingers or any other object through inlet or outlet screens.

2.04 GROUND FAULT CIRCUIT INTERRUPTER. Always operate a blower from a 120V AC source supplied through a ground fault circuit interrupter receptacle, test receptacle for ground fault before plugging in the blower.

2.05 WET HANDS. Never handle energized power cords with wet hands.

2.06 WATER. Never let extension cords or plug connection lay in water. Locate the blower so that it cannot fall into water inadvertently.

2.07 EQUIPMENT. Never use cords with frayed ends, or brittle insulation. Check the cord for sound connections to the ground fault interrupter plug.

2.08 EXPLOSIVE ATMOSPHERE. Never use this blower in any explosive environment.

2.09 SAVE THESE INSTRUCTIONS.

3.0 MAINTENANCE AND REPAIR

3.01 Be sure the blower is disconnected from the power source before doing any maintenance or repair work on the blower.

3.02 Check all power cords for cuts, frayed ends, or brittle insulation. See the enclosed parts list for the replacement cord part number.

3.03 For parts or service information, contact:

T.A. Pelsue Service Department
2500 South Tejon Street
Englewood, Colorado 80110
Phone 303-936-7432 or
1-800-525-8460
Fax (303) 934-5581

4.0 PRODUCT DESCRIPTION:

The Pelsue Model 1320 Axial Blower

A. The Model 1320 Blower is a single-speed, fresh-air blower for use in moderate conditions.

4.01 DIMENSIONS & WEIGHTS

Width: 8.5" (216 mm)
Length: 12" (304 mm)
Height: 10.5" (266 mm)
Weight: 15.2 lbs (6.93 kg)

4.02 MODEL SPECIFICATIONS & PERFORMANCE:

Voltage: 120V AC, 60 HZ
Amperage: 1.4
H.P.: 1/6 (.124kw)
Free Air: 809 cfm (22.91 m3/min.)
One 90° Bend: 617 cfm (17.49 m3/min.)
Two 90° Bends: 505 cfm (14.3 m3/min.)

5.0 START UP & OPERATING PROCEDURES

READ ENTIRE START UP & OPERATING PROCEDURE BEFORE OPERATING BLOWER.

5.01 PRE-START PROCEDURE

CAUTION: Read, 2.0 SAFETY PRECAUTIONS.

A. Check blower inlet and outlet guard screens for obstructions. Check immediate area around blower for objects that could be sucked into the blower inlet and remove from area.

B. Extend and place blower hose as required. **BE SURE NO TOXIC FUMES ARE BLOWN INTO A CONFINED SPACE.**

5.02 START PROCEDURE

A. Plug in blower power cord to a GFI protected 120V AC outlet.

B. Do not leave blower plugged in or operating while unattended.

5.03 SHUT-OFF PROCEDURE

When blower operation is no longer required unplug the power cord. Coil and store the power cord in the opening between the base and the blower housing.

6.0 PARTS LIST MODEL 1320 AXIAL BLOWER

<u>ITEM #</u>	<u>PART #</u>	<u>DESCRIPTION</u>	<u>QTY.</u>
3	112293-001	Housing, 1320 blower	1
4	112294-001	Base - 1320 blower	1
5	115309-001	Motor Mount - 1320 blower	1
6	112296-001	Motor Assembly, 1/6 HP, 120VAC, 60 HZ	1
6-3	112299-001	Capacitor, 5MFD, 370 VAC	1
7	112297-001	Fan Blade, 7.625" dia. composite	1
8	112298-001	Grille - Intake, 1320 blower	1
9	102090-001	Handle, Blower, Neoprene	1
10	110000-001	Grille, Blower Outlet	1
11	112301-001	Decal - rating and serial number, 1320 blower	1
12	111837-001	Decal - Arrow, Directional, black	2
13	100188-001	Foot, rubber, 3/4" OD with washer	4
14	112351-001	Bracket, capacitor mounting	1
15	110288-001	Cover, Rubber, Capacitor Connection	1
16	26E-005700	Cord & Plug Set	1
17	100405-004	Strain Relief	1
18	104151-001	Washer, rivet back up	18
19	111841-002	Screw - Truss head, 10-24 x 1/2", black oxide	6
20	112178-001	Locknut, nylon insert, 10-24 UNC, black oxide	8
21	110733-001	Locknut, hex with nylon insert, 10-32, black	2
22	100050-006	Washer - Flat, #10, type A, W, plated	6
23	105558-001	Washer, fender, #10	2

6.0 PARTS LIST MODEL 1320 AXIAL BLOWER

<u>ITEM #</u>	<u>PART #</u>	<u>DESCRIPTION</u>	<u>QTY.</u>
24	111518-002	Rivet, 3/16" dia, .063"-.125" grip range	14
25	111517-001	Rivet, 3/16" dia., .25"-.375" grip range, black zinc plated steel	4
26	68N-004300	Star Washer #10	6
27	112993-001	Ground Wire Assembly	1
28			
29			
30			
31			
32			

ZONE	REV	DESCRIPTION	DATE	APPROVED
0	0	ISSUED FOR FABRICATION	10-8-50	
1	1	ADD ITEM NO. 17	7-9-51	
2	2	ADD ITEM NO. 20, 21, 22, 23 & 24	4-24-52	
3	3	NUMBERS ENLARGED, ARROW POINTS REVISED	10-9-52	
4	4	UPDATES TO CURRENT SPECS	10-28-53	
5	5	ADDED NOTE, DELETED ITEM NOS. THREE AND FOUR	7-8-54	
6	6	BALLOON HAS VAMP SEE SECTION TITLE	7-8-54	

NOTE:
 1. FOR HOSE CANISTER MOUNTING HARDWARE SEE KIT #120965-001.

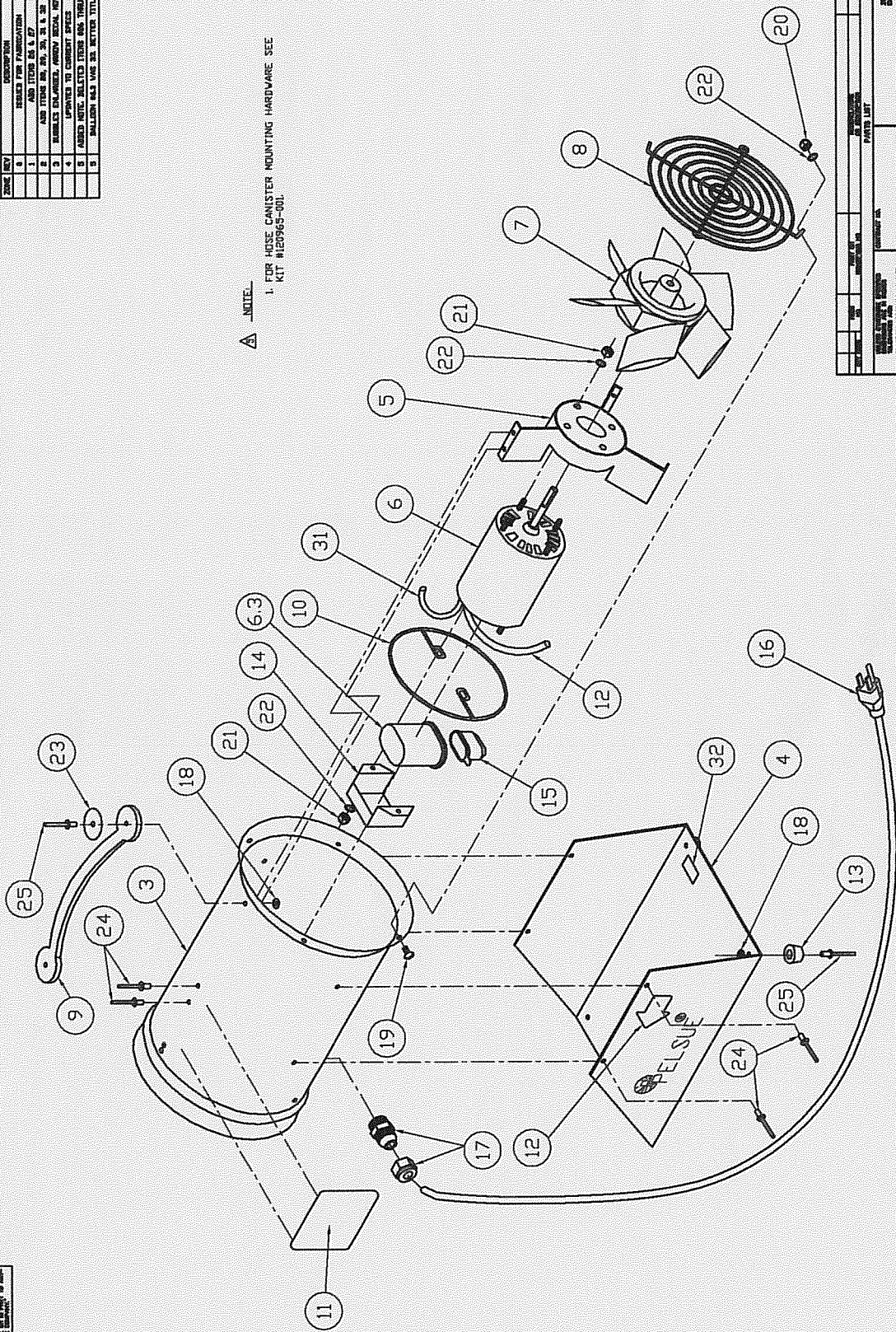

REV	DATE	DESCRIPTION	BY	CHKD
0				
1				
2				
3				
4				
5				

ELECTRICAL SYMBOLS		PARTS LIST	
ASSEMBLY NO.	DATE	REV	DATE
ASSEMBLY MODEL - 1330	10-9-50	0	
AXIAL BLOWER			
120VAC, 60Hz, 1.4Amp, 1/8-Hp.			
REV	DATE	REV	DATE
0		1	11-25-52
1		2	
2		3	
3		4	
4		5	
5		6	
6		7	
7		8	
8		9	
9		10	
10		11	
11		12	
12		13	
13		14	
14		15	
15		16	
16		17	
17		18	
18		19	
19		20	
20		21	
21		22	
22		23	
23		24	
24		25	
25		26	
26		27	
27		28	
28		29	
29		30	
30		31	
31		32	
32		33	
33		34	
34		35	
35		36	
36		37	
37		38	
38		39	
39		40	
40		41	
41		42	
42		43	
43		44	
44		45	
45		46	
46		47	
47		48	
48		49	
49		50	
50		51	
51		52	
52		53	
53		54	
54		55	
55		56	
56		57	
57		58	
58		59	
59		60	
60		61	
61		62	
62		63	
63		64	
64		65	
65		66	
66		67	
67		68	
68		69	
69		70	
70		71	
71		72	
72		73	
73		74	
74		75	
75		76	
76		77	
77		78	
78		79	
79		80	
80		81	
81		82	
82		83	
83		84	
84		85	
85		86	
86		87	
87		88	
88		89	
89		90	
90		91	
91		92	
92		93	
93		94	
94		95	
95		96	
96		97	
97		98	
98		99	
99		100	