

TOURING ITEMS  
**TYPES** Heating Wiper Blade

## User Manual

### PACKAGE CONTAINS:

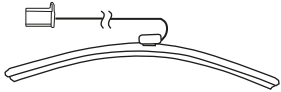

Heating Wiper Blade



Voltage Sensor Control Unit  
with Hardwire Power

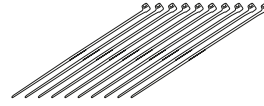

10 x Zip Tie

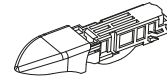

PT Clip

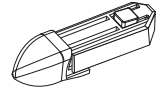

TL Clip

### INSTALLATION:

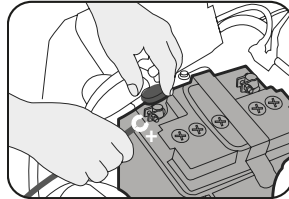

1. Connect the hardwire cables of the Voltage Sensor Control Unit to the vehicle battery posts.

**WARNING:** DO NOT mix up the cables or allow the metal ends to touch together because this may damage the battery, charging system and/or electronics on a vehicle. When installing, please make sure your engine is not running.

Connect the RED wire to positive post of vehicle battery and BLACK to the negative. If the LED of the Voltage Sensor Control Unit flashes RED, it means the connections are reversed. Please disconnect immediately and reconnect to the correct polarity. The LED will stay off if the connections are correct.

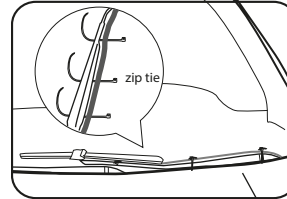

2. Choose the correct adaptor for your car and attach the wiper blade to the wiper arm. See reverse side for adaptor information.

Use zip ties to tie the heating wiper cable to the wiper arm and then cut off the excess zip ties. At least 3 zip ties are recommended to tie the cable to the wiper arm. The most important area is near the end of the wiper arm (Turning Axe). Leave some room near the Turning Axe to allow the wiper arm to move smoothly with the cable. Make sure the wiper cable is NOT stuck between the wiper blade and the windshield.

3. Position the Voltage Sensor Control Unit away from the car engine. Make sure to avoid placing the Control Unit

or cables near any extremely HOT location or next to the car engine. Use zip ties to secure the Control Unit if needed.

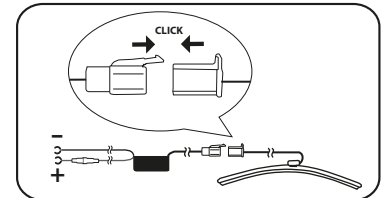

4. Connect the Heating Wiper Blade cables to the Voltage Sensor Control Unit.
5. BLUE light on the Control Unit will be on once vehicle ignition is on and the outside temperature is 37°F (+/-4°F) [3°C (+/-2°C)], or lower. The blue light indicates the heating wiper is functioning. Both criteria are needed to start the heating process.
6. Wiper heating will turn off when the engine shuts off and/or the outside temperature goes above 37°F (+/-4°F) [3°C (+/-2°C)].
7. Avoid touching heated rubber with bare hands, as temperature can rise up to 185°F (+/-9°F) [85°C (+/-5°C)].

## ADAPTOR INSTALLATION:

### U Clip

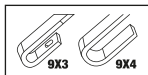

9X3 U-CLIP  
9X4 U-CLIP



Pre-installed on Blade

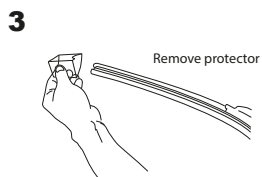
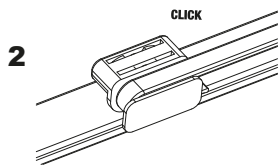
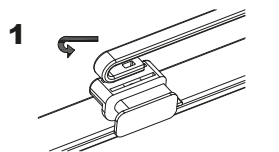

Remove protector

### PT Clip

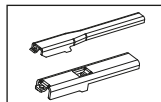

PT Arm

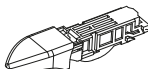

Adaptor Installation

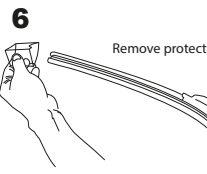
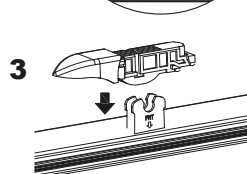
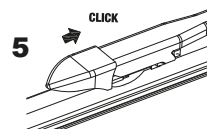
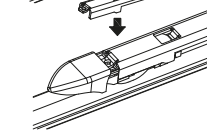
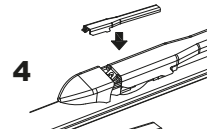
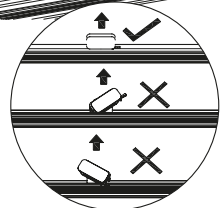
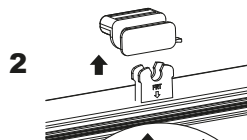
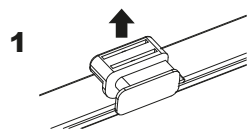

Remove protector

### TL Clip

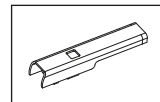

PTB Arm



22mm

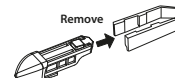

Remove

19mm

Adaptor Installation

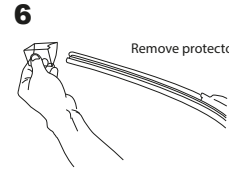
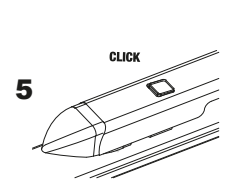
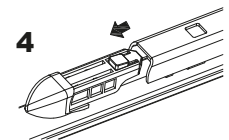
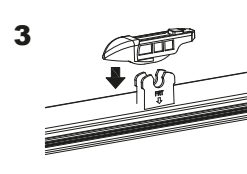
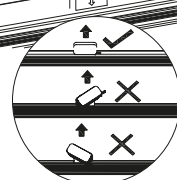
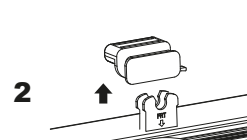
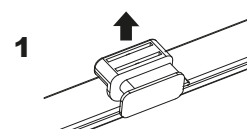

Remove protector

Additional questions?

visit our website [www.winplus.com](http://www.winplus.com)

or call our customer service for support at: 1-866-294-9244