

AVAILABLE FOR LEASE



47548

# KATO ROAD

FREMONT, CA 94538

±110,588 SF INDUSTRIAL BUILDING



STEELWAVE

CBRE

4 7 5 4 8

# KATO ROAD

FREMONT, CA 94538

## PROPERTY OVERVIEW



**±222,600 Vehicles Per Day**

(AADT Caltrans, 2018)



**BUILDING SIZE**  
**±110,588 SF**



**CLEAR HEIGHT**  
**±32'**

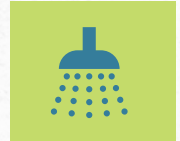

**ESFR**  
**SPRINKLERS**



**CAR PARKING**  
**220 STALLS**



**FREWAY**  
**ACCESS TO**  
**I-880 & I-680**



**AVAILABLE**  
**MAR 2022**

# SITE PLAN

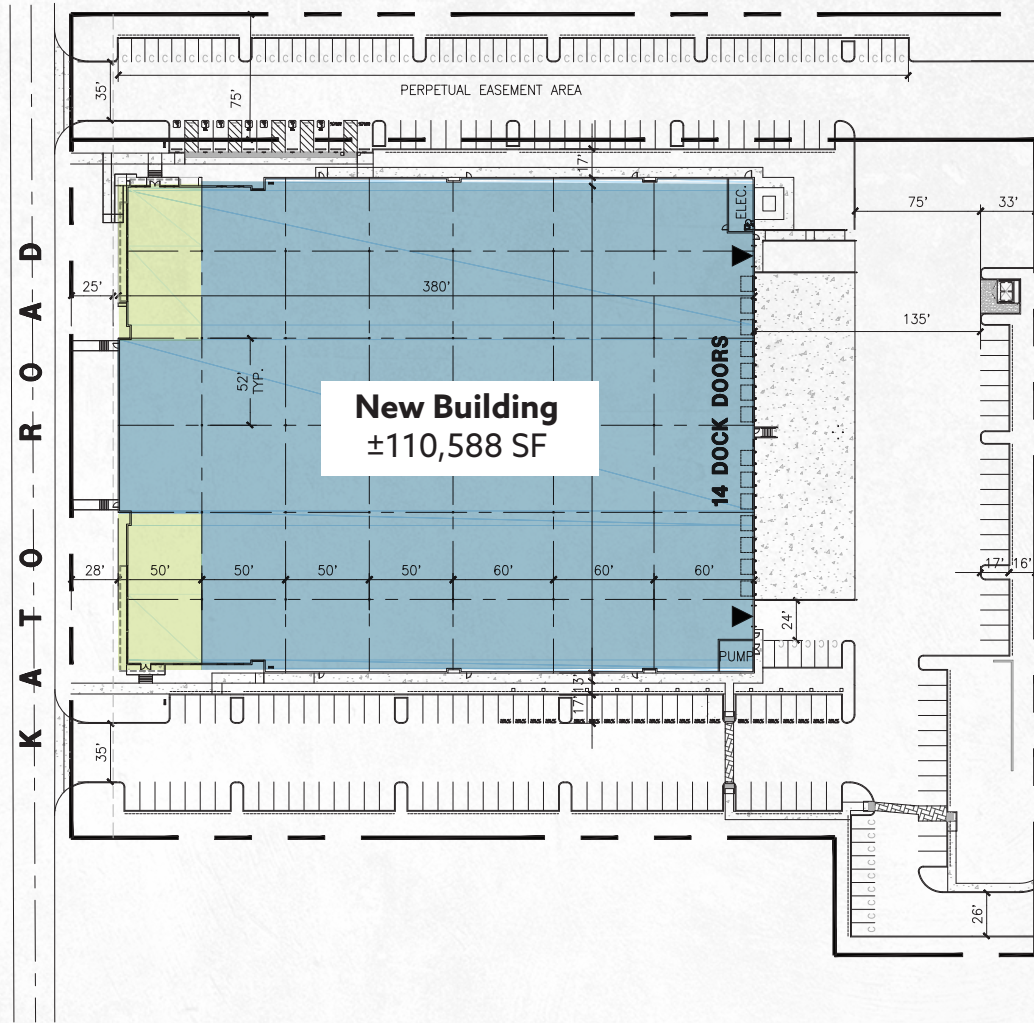

DOCK HIGH  
DOORS  
14



GRADE LEVEL  
DOORS  
2



COLUMN SPACING  
50' X 52' & 60' X 52'



SPEED BAY  
60'



POWER  
4,000 AMPS  
277/480V PANEL



ZONING  
TECH INDUSTRIAL (I-T)



4 7 5 4 8

# KATO ROAD

FREMONT, CA 94538



## CONTACT INFORMATION

### CHIP SUTHERLAND

Vice Chairman  
Lic 01014633  
+1 408 453 7410  
[chip.sutherland@cbre.com](mailto:chip.sutherland@cbre.com)

### BOB STEINBOCK

Senior Vice President  
Lic 01111853  
+1 408 453 7424  
[bob.steinbock@cbre.com](mailto:bob.steinbock@cbre.com)



STEELWAVE

CBRE

© 2023 CBRE, Inc. The information contained in this document has been obtained from sources believed reliable. While CBRE, Inc. does not doubt its accuracy, CBRE, Inc. has not verified it and makes no guarantee, warranty or representation about it. It is your responsibility to independently confirm its accuracy and completeness. Any projections, opinions, assumptions or estimates used are for example only and do not represent the current or future performance of the property. The value of this transaction to you depends on tax and other factors which should be evaluated by your tax, financial and legal advisors. You and your advisors should conduct a careful, independent investigation of the property to determine to your satisfaction the suitability of the property for your needs. CBRE and the CBRE logo are service marks of CBRE, Inc. and/or its affiliated or related companies in the United States and other countries. All other marks displayed on this document are the property of their respective owners. PMStudio\_June\_2023