

CD3790 MEGAFLEX™ SERIES

FLEXIBLE LED LIGHT

CD3793



CD3794

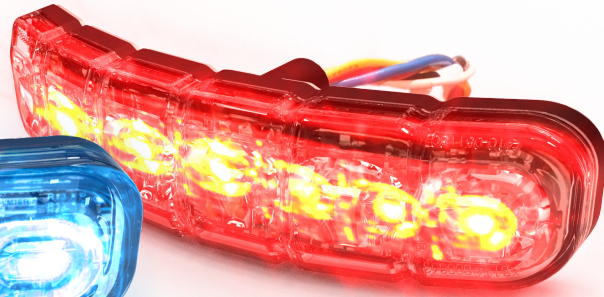

Code 3's CD3790 MegaFlex™ Series is a flexible exterior warning light that can be mounted on flat or curved surfaces up to 120° (CD3794) or 72° (CD3793) self-adhesive, very high bond tape. Its dual- and tri-color LEDs provide exceptional output with combinations of amber, white, blue and red colors available in 3" and 4" lengths. The lightheads are protected in a clear, silicone housing that can flex while resisting yellowing and warping and is ideal for police, fire, EMS or any other emergency vehicle application. A two-bolt bezel is also included for easy installation on flat surfaces. Design and utility patented.

Design & Utility Patented

VOLTS AMPS	12-24V 0.4A (CD3793), 0.8A (CD3794), 0.6A (Tri-Color)
DIMS	CD3793 0.9 H x 2.7 L x 0.4 D (No Bezel) 1.1 H x 3.4 L x 0.5 D (W/ Bezel) CD3794 0.9 H x 3.9 L x 0.4 D (No Bezel) 1.1 H x 4.4 L x 0.4 D (W/ Bezel)
FLASH PATTERNS	69
CERTS	CLASS I (SAE J595), CLASS II (SAE J845 selective coverage, CD3794 only), CA T13, R65 (CD3794 only), R10, RCM, UKCA, CE, IP67, IP69K
DETAILS	<ul style="list-style-type: none"> Flexible housing adapts to curved surfaces up to 120° Clear silicon lens material prevents yellowing or aging VHB tape mount to flat or curved surfaces Optional bezel for flat surfaces and two-end bezels for flat or curved surfaces Temperature range: -40°F to 149°F (-40°C to 65°C)
REPLACE	" _ " with A = Amber, B = Blue, R = Red, W = White

MODEL	TYPE	ILLUMINATION COLORS
CD3793_ _	Dual, 8 LED, Surface Mount	AW, BA, BW, RA, RB, RW
CD3794_ _	Dual, 12 LED, Surface Mount	AW, BA, BW, RA, RB, RW
CD3794_ _ _	Tri, 18 LED, Surface Mount	BAW, RAW, RBA, RBW

CD3793 w/ Bezel

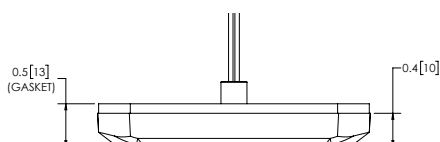
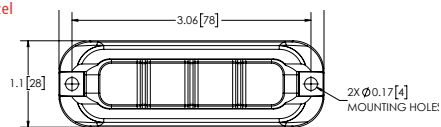

CD3794 w/ Bezel

