



BEACONS



CB7265

LED Mini Pole Mount

Code 3's CB765 Series LED Beacon produces a warning signal that is ideal for industrial applications. The long, maintenance-free service life of LED technology, backed by a 5-year warranty, makes this a perfect replacement solution for existing strobe beacons. This cost-effective light features 12-24V operating range that also makes it ideal for use on electrically powered vehicles and equipment.

Models

PART NO.	LENS COLOR	TYPE	LED COLOR
CB765CR	<input type="checkbox"/>	Single	<input checked="" type="checkbox"/>
CB765CB	<input type="checkbox"/>	Single	<input checked="" type="checkbox"/>

Features and Benefits

- 12-24 VDC, 1.4 Amps
- Geared toward the Motorcycle/ATV/UTV market
- High-intensity illumination
- Sync capability with Chase®, MR6, Mega Thin™, M180™
- 29 flash patterns
- Available in 3 bolt or pole mount
- Temperature Range: -22°F to +122°F (-30°C to +50°C)

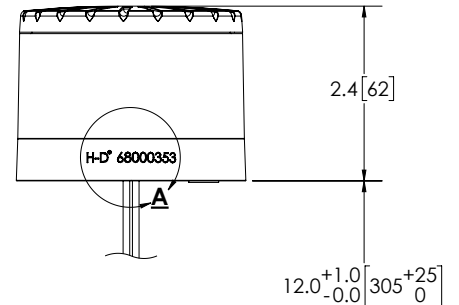

3-18AWG WIRES
RED - COLOR 1
WHITE - COLOR 2
BLACK - GROUND
2-20AWG WIRES
BLUE - PATTERN SELECT
YELLOW - SYNC

