

INSTALLATION & OPERATION MANUAL

2015 FORD F-150
C3100 SPEAKER INSTALLATION

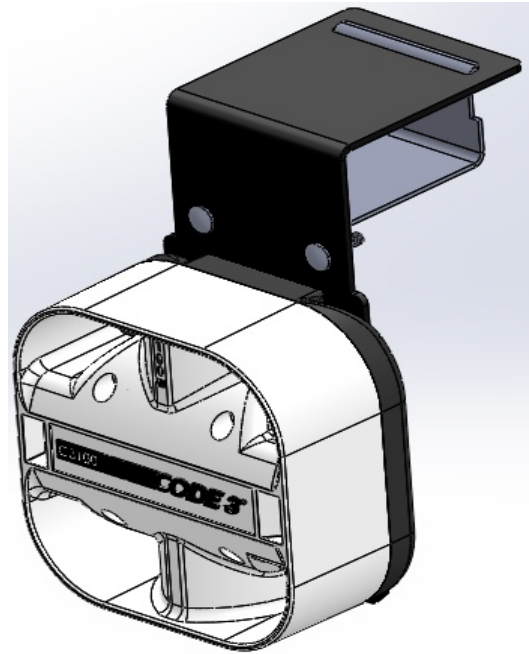

2015 FORD F-150 NO-DRILL INSTALLATION OF C3100 SPEAKER (S)

Table of Contents:

Page No:	Description:
1.	Pre-installation preparation
2.	Installation instructions
3.	Installation notes
4.	Warranty Information

Preparation for Installation:

Hardware provided for this installation will help prevent galvanic corrosion from taking place due to dissimilar metals.

1. The mounting of C3100 speaker using the clamp-on design bracket will avoid the need for drilling into the aluminum body of the new Ford F150 truck.
2. The Loop and Pile Pads at the top of the assembly will prevent lateral movement of the unit once the bracket system is tightened into position.

IMPORTANT: *Read all instructions and warnings before installing and using.*
INSTALLER: *This manual must be delivered to the end user of this equipment.*

**Locate areas under the truck front end at the cross member as pictured.
Two speaker bracket systems can be mounted on this cross member.**

Installation Procedure:

Passenger Side:

1. Install Speaker housing onto L bracket with the housing facing the opposite direction of the short leg on the bracket.
2. Install (2) Hook and Pile pad sections on underside surface of short leg of the bracket (either half of the two piece pad system is acceptable)
3. Locate the area for the L bracket to be installed over the truck cross frame by sliding the short leg of the bracket between the cross frame and the splash guard above the frame. (between the guard fasteners and the outside end of the cross frame.) Mark the area for the second half of the Hook and pile connectors to be installed. (see fig 1)
4. From the front side of the cross member- Slide the L bracket back off the frame and now install the second half of the hook and pile pads to the top of the cross frame in the area marked.
5. Pushing the short leg upward against the splash guard - re insert the L bracket over the frame member and seat the hook and pile connecting pads into each other.
6. Insert tab of clamp bracket into L bracket slot and rotate the clamp over the bottom of the cross frame.
7. Install (2) 1/4- 20 nuts over studs on L bracket and tighten while maintaining upward pressure on the clamp assembly.

View looking up at Passenger side of truck frame.

mark area for pads to be installed on top of cross frame.

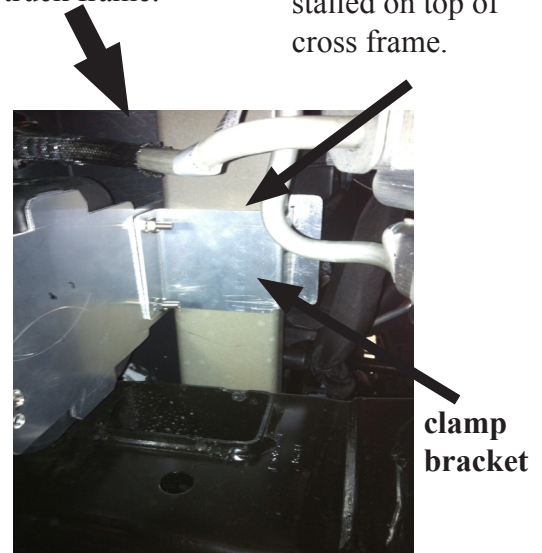

fig 1.



Side view of Passenger side bracket installation:



fig 2.

Installation Procedure:

Driver Side:

1. Locate area forward of the manifold
2. Mark this area for the hook and pile pad installation on the top of the cross frame.
3. Install Speaker housing onto L bracket with the housing facing the opposite direction of the short leg on the bracket.
4. Install (2) Hook and Pile pad sections on underside surface of short leg of the bracket (either half of the two piece pad system is acceptable)



manifold

Installation Procedure:

Driver Side continued:

5. Install opposite sides of the Hook and Pile pads on the top of the cross frame rail where the bracket is to be installed.
6. Pushing the short leg upward against the splash guard - re insert the L bracket over the frame member and seat the hook and pile connecting pads into each other.
7. Insert tab of clamp bracket into L bracket slot. The clamp bracket must be maneuvered under manifold lines.
8. Rotate the clamp bracket over the bottom of the cross frame and seat over studs on L bracket..
9. Install (2) 1/4- 20 nuts over studs on L bracket and tighten while maintaining upward pressure on the clamp assembly.



Parts List:

part no:	Description:	Qty:
1. T56186	L speaker bracket	1
2. T56187	Clamp bracket	1
3. T06139	Keps Nut 1/4-20	2
4. T14563	Carriage Bolt 1/4-20	2
5. T03440	Loop Strip	2
6. T03432	Hook Strip	2

Notes:



WARNING!

Larger wires and tight connections will provide longer service life for components. For high current wires it is highly recommended that terminal blocks or soldered connections be used with shrink tubing to protect the connections. Do not use insulation displacement connectors (e.g. 3M® Scotchlock type connectors). Route wiring using grommets and sealant when passing through compartment walls. Minimize the number of splices to reduce voltage drop. High ambient temperatures (e.g. underhood) will significantly reduce the current carrying capacity of wires, fuses, and circuit breakers. Use "SXL" type wire in engine compartment. All wiring should conform to the minimum wire size and other recommendations of the manufacturer and be protected from moving parts and hot surfaces. Looms, grommets, cable ties, and similar installation hardware should be used to anchor and protect all wiring. Fuses or circuit breakers should be located as close to the power takeoff points as possible and properly sized to protect the wiring and devices. Particular attention should be paid to the location and method of making electrical connections and splices to protect these points from corrosion and loss of conductivity. Ground terminations should only be made to substantial chassis components, preferably directly to the vehicle battery. The user should install a fuse sized to approximately 125% of the maximum Amp capacity in the supply line to protect against short circuits. For example, a 30 Amp fuse should carry a maximum of 24 Amps. **DO NOT USE 1/4" DIAMETER GLASS FUSES AS THEY ARE NOT SUITABLE FOR CONTINUOUS DUTY IN SIZES ABOVE 15 AMPS.** Circuit breakers are very sensitive to high temperatures and will "false trip" when mounted in hot environments or operated close to their capacity.

WARRANTY

Code 3, Inc.'s emergency devices are tested and found to be operational at the time of manufacture. Provided they are installed and operated in accordance with manufacturer's recommendations, Code 3, Inc. guarantees all parts and components except the lamps to a period of 1 year (unless otherwise expressed) from the date of purchase or delivery, whichever is later. Units demonstrated to be defective within the warranty period will be repaired or replaced at the factory service center at no cost.

Use of lamp or other electrical load of a wattage higher than installed or recommended by the factory, or use of inappropriate or inadequate wiring or circuit protection causes this warranty to become void. Failure or destruction of the product resulting from abuse or unusual use and/or accidents is not covered by this warranty. Code 3, Inc. shall in no way be liable for other damages including consequential, indirect or special damages whether loss is due to negligence or breach of warranty.

CODE 3, INC. MAKES NO OTHER EXPRESS OR IMPLIED WARRANTY INCLUDING, WITHOUT LIMITATION, WARRANTIES OF FITNESS OR MERCHANTABILITY, WITH RESPECT TO THIS PRODUCT.

PRODUCT RETURNS

If a product must be returned for repair or replacement*, please contact our factory to obtain a Return Goods Authorization Number (RGA number) before you ship the product to Code 3, Inc. Write the RGA number clearly on the package near the mailing label. Be sure you use sufficient packing materials to avoid damage to the product being returned while in transit.

*Code 3, Inc. reserves the right to repair or replace at its discretion. Code 3, Inc. assumes no responsibility or liability for expenses incurred for the removal and /or reinstallation of products requiring service and/or repair; nor for the packaging, handling, and shipping; nor for the handling of products return to sender after the service has been rendered.

PROBLEMS OR QUESTIONS? CALL OUR TECHNICAL ASSISTANCE HOTLINE (314) 996-2800
WWW.CODE3PSE.COM



Code 3®, Inc.
10986 N. Warson Road
St. Louis, Missouri 63114-2029—USA
Ph. (314) 426-2700 Fax (314) 426-1337

Part No. T56207 Rev. 0 05/2015©2005 Code 3, Inc