

# USER MANUAL

# ST1 | ST2 | ST3 | ST5

ENGLISH

+STROMER-

## COMPONENTS FOR THE STROMER S-PEDELEC

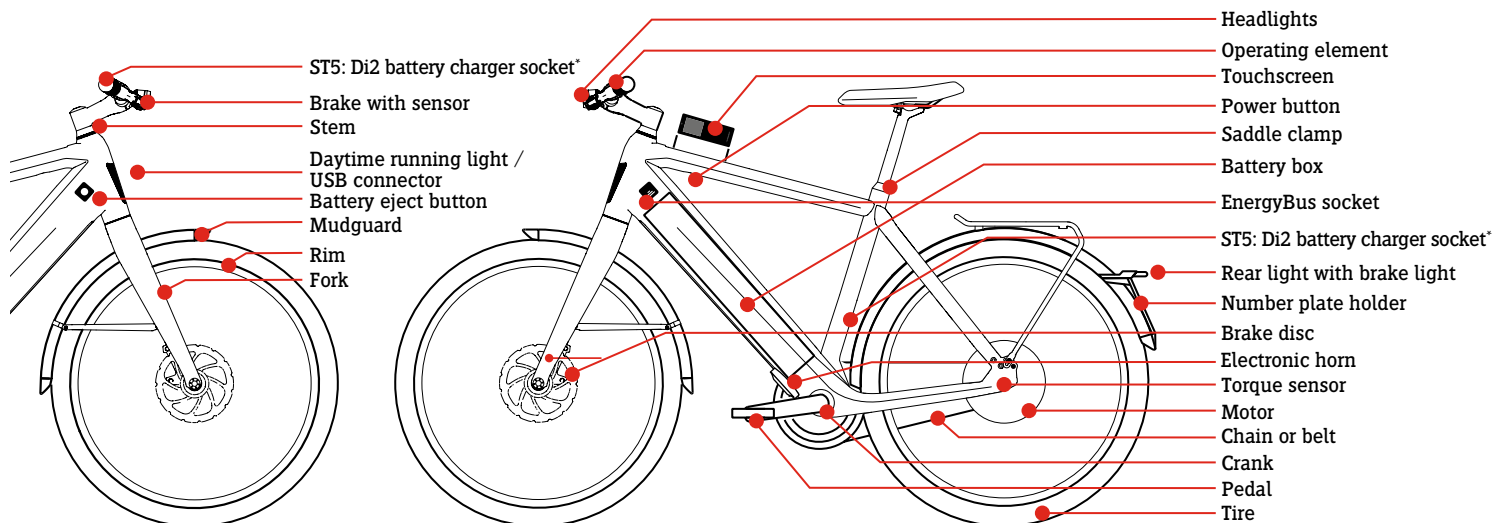

\* Position depends on version

### Delivery scope

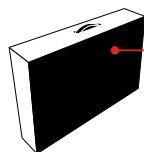

#### Contents:

- Operating instructions
- Stromer S-Pedelec
- Battery charger
- Smartphone holder (ST3, ST5)
- Di2 charging cable (ST5)

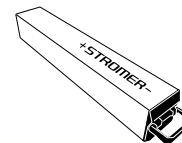
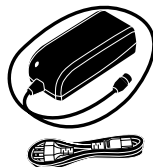

**i** The S-Pedelec bought by you may look different. These instructions describe S-Pedelecs. These operating instructions are part of the S-Pedelec delivery scope and only apply for the models ST1, ST2, ST3 and ST5.

## DEAR CUSTOMER,

We would like to start by congratulating you on your new Stromer and provide you with some important information regarding your new premium vehicle.

It will help you use this technology more effectively and prevent risks. Please carefully read these operating instructions and keep them in a safe place.

The Stromer you have received has been assembled and adjusted according to your body type. If this isn't the case, please contact a Stromer shop to have this necessary work performed on your bike.

It is assumed that the bike's user has acquired the basic and needed knowledge to operate this S-Pedelec. All persons involved in

- using,
- repairing or maintaining,
- cleaning
- or disposing of

this S-Pedelec must have fully read and understood the content and meaning of these operating instructions. Make sure to ask a Stromer dealer if you have any questions or when some issues are not clear to you, to ensure your own safety.

All information in these operating instructions relate to structure, technology, care and maintenance. Please adhere to this information, as it is often safety-related and disregard it may lead to severe accidents and economic damage.

We have only described the most important issues, as modern S-Pedelecs have very powerful technology.

The instructions of the respective manufacturers of the components used must be consulted for special, technical details. They can be found on the Internet at [www.stromerbike.com/support](http://www.stromerbike.com/support)

 Check which driving license you need to ride a Stromer before starting your first ride!

 Know your country's road traffic regulations and follow them accordingly.

Before riding your S-pedelec on public roads, read up on the national regulations applicable in your specific country. The national regulations contain information on how your S-pedelec must be equipped when operated on public roads and which bike permit is required to ride the Stromer.

Some of the information covered includes:

- Which light systems have to be installed or carried with you
- How to properly apply the orange lateral reflector
- Which brakes the S-pedelec must be equipped with
- Possible age restrictions that apply to riding in specific areas
- Possible restrictions regarding children riding on public roads
- Possible requirements about wearing helmets

## SAFETY INFORMATION

Please thoroughly read all of the warnings and instructions in this operating manual before you begin riding the S-Pedelec. Please always store these operating instructions near your S-Pedelec, so that they are accessible at any time.

**Before the first ride, please be sure to read the chapters “Before the first ride” and “Before every ride”!**

Should you hand your S-Pedelec to third parties, make sure to hand over these operating instructions with it. These instructions include symbols that require your special attention. Whenever these symbols are shown, there is a risk that the problem described actually occurs! The area to which the explicit warning applies is identified by red lettering.



**Note:** This symbol provides you with information about handling the product or the part covered in the instruction manual and should be read with attention.



**Attention:** This symbol warns of misuse which could result in damaging the product or the environment.



**Danger:** This symbol indicates a possible risk of injury when the appropriate, required actions are not implemented or the respective precautionary measures are not taken.



**Important screw joint:** Here, you must tighten with the exact torque. To find out the correct tightening torque, you can either look at the bike part itself or in the table listing the tension values, which is found on page 32. A torque wrench must be used to apply the exact tightening torque value. If you don't have a torque wrench, bring your bike to a Stromer shop for repair! Parts that have been installed incorrectly may fall off or break! This may result in severe falls!



**Modern S-Pedelec technology is high-tech! Working on it requires technical knowledge, experience and special tools! Do not work on your S-Pedelec by yourself! Take your S-Pedelec to a specialist workshop when it is in need of repair, maintenance or restoration!**

Regularly check that all screw connections are tight and all components are undamaged.

### Snagging hazard



**Moving and turning parts of your Stromer may lead to danger during use, maintenance and upkeep. Protect yourself by not wearing loose clothes that may get caught. During use, maintenance and upkeep, stay away from turning parts (wheels, brake discs, cassettes). Do not touch moving, sharp or protruding parts (chains, pedals).**

## CONTENTS

<b>Components for the Stromer S-Pedelec</b> _____	<b>2</b>	<b>Legal requirements</b> _____	<b>15</b>	<b>Handling the battery</b> _____	<b>21</b>
<b>Dear customer,</b> _____	<b>3</b>	<b>Appropriate use</b> _____	<b>15</b>	Safety notes concerning the battery _____	21
<b>Safety information</b> _____	<b>4</b>	<b>Replacing parts on your speed pedelec</b> _____	<b>16</b>	Storing the battery _____	21
<b>Quick Start Guide for Stromer</b> _____	<b>6</b>	<b>Riding a Stromer</b> _____	<b>16</b>	Removing the battery _____	22
<b>For your safety</b> _____	<b>8</b>	Power button _____	16	Inserting the battery _____	22
<b>Instructions about electrics and electronics</b> _____	<b>9</b>	Switching on _____	16	Safety information regarding the charger _____	23
<b>Lighting system</b> _____	<b>9</b>	Switching off _____	16	Charging the battery _____	23
<b>Child seats, child trailers and load trailers</b> _____	<b>10</b>	Sleep mode _____	16	<b>Service / Maintenance</b> _____	<b>25</b>
Trailer _____	10	<b>Operating element</b> _____	<b>16</b>	Screws and torque spanners _____	25
Installation _____	10	Support levels _____	16	Chain / Drive _____	26
Instructions for parents and guardians _____	11	Lighting system _____	17	Rims / Tires _____	27
<b>Before the first ride</b> _____	<b>11</b>	Braking mode / Recuperation _____	17	Brakes _____	27
<b>Before each ride</b> _____	<b>13</b>	Electronic bike horn _____	17	Gears _____	28
If you have fallen _____	14	Touchscreen _____	17	S-Pedelec tuning is prohibited _____	29
<b>Luggage and load transport</b> _____	<b>14</b>	<b>USB charging socket</b> _____	<b>18</b>	Inspection plan _____	29
Rack _____	14	<b>Anti-lock braking system with a pinlift on the rear axle</b> _____	<b>19</b>	Lubrication _____	31
		Maintenance and warranty _____	19	Screw connections _____	32
		<b>Menu and settings</b> _____	<b>20</b>	<b>Warranty, defects, wear</b> _____	<b>36</b>
		Menu structure _____	20	Wear _____	36
				<b>Technical data</b> _____	<b>36</b>
				<b>Environmental tips</b> _____	<b>38</b>
				<b>Legal disclosure</b> _____	<b>38</b>

## QUICK START GUIDE FOR STROMER

**i** These are brief operating instructions intended for experienced S-Pedelec riders. You must read the entire original operating instructions to ensure safe riding, even when you already have experience with S-Pedelecs!

Detailed supplementary information regarding the functions and settings are provided by the Stromer app or on the Internet at

[www.stromerbike.com/support](http://www.stromerbike.com/support)

### 1) Completely charge the battery before the first ride, internally or externally.

a) External charging:

Removing the battery

**!** The battery is heavy. Do not drop it. You might hurt yourself or damage the battery. Battery damage caused by an impact will void the warranty and guarantee.

**i** The battery can only be unlocked when stationary.

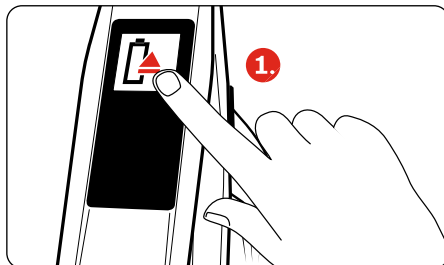

Click the "Eject Battery" icon

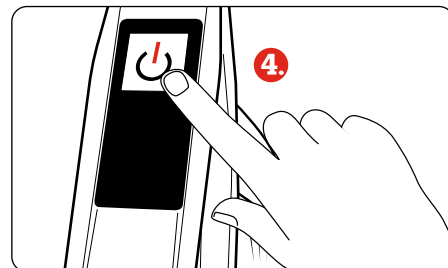

Hold down the "Off" button until the display is no longer lit up.

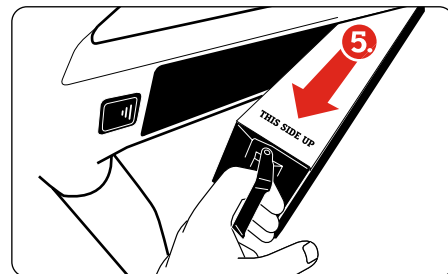
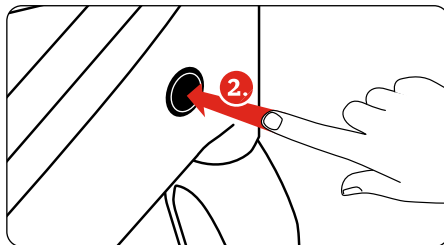

a) Charge battery externally

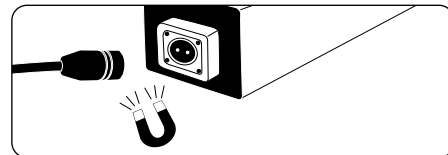
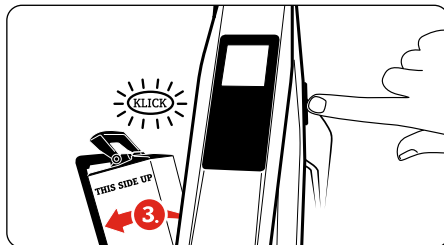

 Only charge the Stromer battery with a Stromer charger.

Inserting the battery

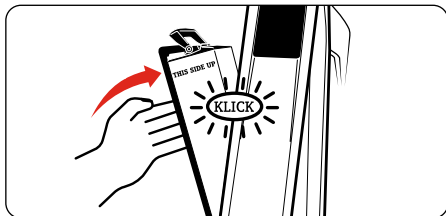
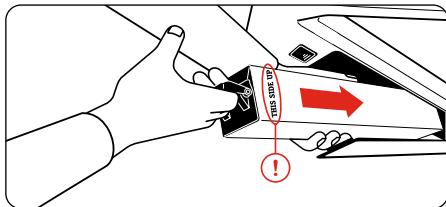

 The writing "THIS SIDE UP" must be visible on the top.

b) Charge battery internally

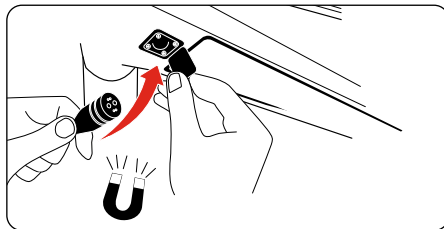
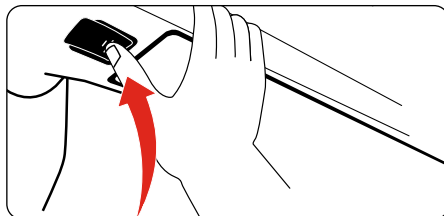



 Only charge the Stromer battery with a Stromer charger.

## 2) Switch on the electrical system

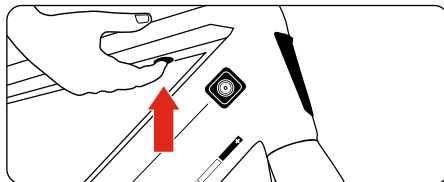
The power button is located at the bottom of the top tube, below the touch screen.



 The motor of the Stromer only starts up once a minimum speed has been reached to ensure your safety. Always keep one brake engaged before placing the first foot onto the pedal. The strong acceleration feels very unfamiliar. Uncontrolled starting up in road traffic or on loose ground can lead to a fall or severe injuries. Practice operating and riding your Stromer in a quiet and safe place before you take to public roads!

 Never ride when the battery is not inserted. The battery compartment can in this case not be locked. This poses an additional risk of falls and injuries.

 The Stromer can obviously also be used like a normal bicycle without a motor.

The motor support depends on the force that acts on the pedals. The more firmly you step onto the pedals, the stronger the support from the motor. The motor support stops when you stop pushing the pedals during the ride. Motor support is only reactivated when you start working the pedals.

## Operating element

Important functions of the Stromer can be controlled while riding and without taking your hands off the handlebar, by using the operating element on the handlebar.

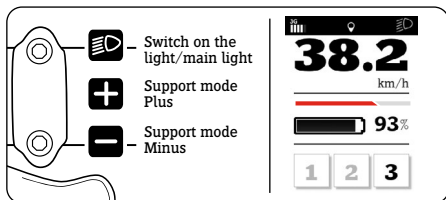

Basic settings Driving mode

Touchscreen display

### 3) Switch the electrical system off after the ride

1. Press the Power button to get to the shortcut display.
2. Select **OFF**

#### Sleep mode

When the Stromer is not switched off, it will switch to sleep mode after approx. 5 minutes of inactivity. The sensor system remains active during sleep mode. The system wakes up by itself as soon as you move the Stromer.

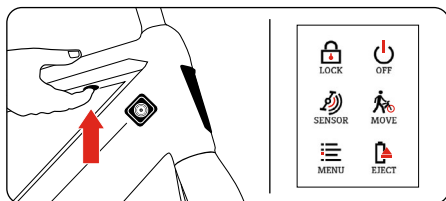

Switching off

Touchscreen display

## FOR YOUR SAFETY

Before riding your S-Pedelec on public roads, you should inform yourself about the applicable national regulations in your specific country. In many countries you will require a driving license for driving an S-Pedelec. Check the legal situation in the respective country before use.

The operating instructions assume that you can ride a bicycle. These instructions are not intended to teach you how to ride an S-Pedelec. They are also not intended to provide information regarding the assembly or repair of an S-Pedelec or how to assemble and repair your Stromer.

Remain aware that riding an S-Pedelec is generally and always associated with risks. You, the rider, are particularly at risk. Always remain aware that you are not as protected as you would be, for example, in a car. You have no airbag and no protective car body. You are nevertheless faster and drive on other parts of the road than pedestrians or many cyclists, who do not have a sufficiently strong auxiliary drive. Pay particular attention to others on the road.

The following information regarding the rider must also be considered:

- Always wear a fitted and suitable S-Pedelec helmet. Use it each time you ride!
- Read the instructions of the helmet manufacturer to learn about fitting the helmet correctly.
- Whenever you ride, wear bright clothing or sports clothes with reflective elements (e.g. reflective vest); This is important to ensure that you are seen in time by other traffic participants.



- Tight clothes and trouser clips are mandatory to wear. Your shoes should have an anti-skid, stiff sole.
- Never ride hands-free!
- Never ride with headphones. Never talk on the phone while riding your S-Pedelec. Never ride your bike if you are not in a situation where you are completely able to control it. You must always be fully fit to ride.
- Under wet and slippery conditions, alter your way of riding accordingly. In this case, you should ride more slowly and apply your brakes earlier and more gradually as the braking distance becomes significantly longer.

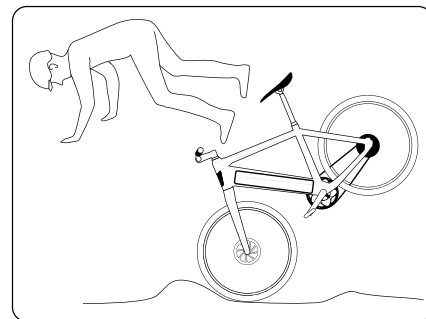

- Ride at an appropriate speed and in accordance with the terrain and your riding capabilities.

Take note that you are exposed to special risks when participating in traffic on an S-Pedelec. Protect yourself and others by riding responsibly and safely!



 Take note that you will be riding much faster on an S-Pedelec than on a bicycle without an electrical drive. Other traffic participants might misjudge that. Only use your S-Pedelec in an appropriate manner. Important, relevant information is provided in the "Appropriate use" section. Ask your Stromer dealer if you are not sure about the purpose of use and the limits of the appropriate use of an S-Pedelec.

## INSTRUCTIONS ABOUT ELECTRICS AND ELECTRONICS

 You can find information about the bike's operation, maintenance, upkeep and technical data in this Instruction Manual, under **www.stromerbike.com/support** and on each of the component manufacturer's websites.

 The electrical installation of your S-Pedelec is very powerful. Correct and safe operation requires you to have your Stromer regularly maintained by a Stromer dealer. Have your S-Pedelec regularly maintained by a Stromer dealer. They will check the current software status and ensure that important updates that affect the safety and riding comfort are installed. Immediately switch off the electrical system and

remove the battery when you notice damage to the electrical system or, for example, when live parts are exposed after a fall or accident. Always contact your Stromer dealer when you require repairs, want to ask a question, experience problems or discover a defect. A lack of technical knowledge can lead to severe accidents or damage!

 Always turn off the electrical system and remove the battery before doing any kind of work on your S-Pedelec. Ensure that the charger is not connected.

 If your Stromer S-Pedelec does not start, although no error message is shown, check whether both brake levers are in their initial position! No motor power is transmitted when one of the brake levers is activated!

## LIGHTING SYSTEM

When the daytime running light is activated, it is on whenever the Stromer is switched on. (See daytime running light [www.stromerbike.com/com/support](http://www.stromerbike.com/com/support)). The daytime running light is dimmed when the headlight is switched on, so that drivers in oncoming vehicles are not blinded. The daytime running light is not legal in certain countries and can accordingly not be activated there. **Please stay informed regarding the legal situation!**

 We recommend activating the daytime running light at all times, **as far as this is permitted in the respective country.** You can then more easily be seen by other traffic participants and thus increase road traffic safety.

 A working lighting system is essential for your safety! Have the installation, inspection and repair performed by a Stromer dealer.

S-Pedelecs used on public roads must be equipped with a dynamo, a battery for a constant battery light or with a rechargeable power storage device as a power source for the front and rear lights to work. The lighting system of the Stromer is powered by the battery or, when this has been drained, by a motor with dynamo function. Stromer S-Pedelecs are provided with lights based on the latest LED technology.

 It is not possible to replace the bulbs in modern LED lights. Clean your reflectors and lights on a regular basis. Warm water with cleaning fluid or washing up liquid is suitable here.

It is recommended to adjust the headlight in such a way that the center of the light does not blind oncoming traffic. The law in Germany prescribes this setting.

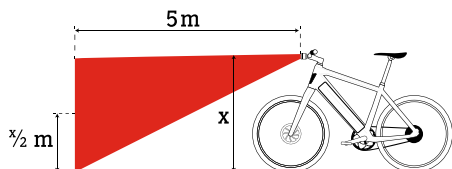

Changes to the lighting system are not permitted and may lead to a loss of warranty, guarantee and insurance cover!

Additional information regarding this issue is provided at [www.stromerbike.com/support](http://www.stromerbike.com/support)

## CHILD SEATS, CHILD TRAILERS AND LOAD TRAILERS

**i** Stromer S-Pedelects may not be operated with child seats!

**!** Do not let children who are unattended ride the S-Pedelect without first thoroughly instructing them in how to use it! Explain to children the dangers of using electrical devices.  
If a child wants to ride the S-Pedelect, check whether the child has reached the prescribed age and has the appropriate driving permit as required!

**i** Always check the applicable national regulations before using child trailers and load trailers.

These may also concern the permitted maximum speed and the permitted total weight! The use of child trailers in combination with S-Pedelects is prohibited in many countries.

## Trailer

**i** For operation with trailers, please research the applicable regulations in your country.

Only use your Stromer with trailers that have explicitly been released for use with S-Pedelects. Take note that many countries prohibit the transport of children in a trailer attached to an S-Pedelect.

Please take note that the driving characteristics of the Stromer change when attaching a trailer. Some trailers tend to tilt in tight bends. Drive carefully and adapt your speed and riding style to the situation.

Some trailers are only approved by their manufacturers for use with bicycles or Pedelects (peddling support up to 25 km/h). It is essential to adhere to the instructions of the respective manufacturer.

### Legal situation in Switzerland

Transporting a trailer is permitted under certain circumstances as long as certain restrictions are adhered to (Swiss federal road traffic regulations (VRV) Art. 68 para. 1 in connection with Art. 68 para. 7).

At most two children in protected seats may be transported in one trailer (VRV Art. 63 para. 3 Letter d).

On fast Pedelects with assisted pedaling of more than 25 km/h, the carrying of children in a trailer is permitted. A child seat and a child trailer must not be operated at the same time. (VRV [German federal

road traffic regulations] Art. 63 para. 3 lett. d. VrV) Children being transported are not obliged to wear a helmet in Switzerland. However, we recommend that children in the trailer always wear a helmet and to buckle them in with the trailer's internal safety belt system.

### Legal situation in the scope of EU law

Pedelects with pedaling support up to 25 km/h may pull a trailer designed for child transport with 2 children of up to 7 years of age (StVO [German road traffic act] Art. 21 para. 3).

The children being transported are usually not obliged to wear a helmet. However, we recommend that children in the trailer always wear a helmet and to buckle them in with the trailer's internal safety belt system.

**i** Please check the legal requirements of your country.

## Installation

**i** Have the trailer and its attachment mounted by a Stromer dealer.

The installation of the following trailer connection systems was tested by Stromer.

- Thule ezHitch, Webber-E and Burley couplings can be mounted on the optional Stromer Trailer Plate Kit. Check other coupling systems before you buy.

## Instructions for parents and guardians

As a legal guardian, you are responsible for watching over the child and his or her safety. This includes taking care of the S-Pedelec's technical state and supervising the rider.

You must be sure that the child has learned safe handling of the S-Pedelec and fulfills all legal and country-specific requirements, e.g. has reached a possibly prescribed minimum age and has the appropriate driving license as required.

Ensure that your child has learned and understood safe and responsible handling of their S-Pedelec in the appropriate environment.

**i** Do not let children who are unattended ride the S-Pedelec without first thoroughly instructing them in how to use it! Explain to children the dangers of using electrical devices.

## BEFORE THE FIRST RIDE

Please thoroughly read all of the warnings and instructions in this operating manual before you begin riding the S-Pedelec.

Please also consider the operating instructions of the individual component manufacturer, which are available on the Internet.

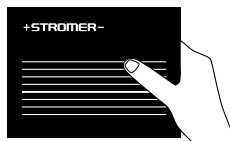

Your specialist Stromer dealer will be happy to answer any further questions you have after reading this manual. Ensure that the S-Pedelec is ready for use and adjusted to fit your body. This includes:

- Setting the position and fixture of the seat and handlebars
  - Checking the assembly and settings of the brakes
  - Securing the wheels into the frame and forks
- To ensure that you enjoy a safe and comfortable riding position, please allow your Stromer dealer to set up your handlebars and stem.
- Adjust the seat to a safe and comfortable position for you (see page 13).
  - Allow your Stromer dealer to set up the brakes so that the brake levers are always within easy reach.
  - Ensure that you know which lever operates which brake. The right brake lever operates the rear wheel brake. The left brake lever operates the front wheel brake.

**i** Familiarize yourself with the new bicycle in a protected area.

**⚡** Modern braking systems can have significantly stronger and different braking effects to the brakes you are familiar with. Please get to know the brakes on a safe piece of land before setting off on your first ride with the bicycle! Also remember that the effectiveness of brakes can be dangerously different in wet conditions or on slippery surfaces. Please take the possibility of longer braking distances and slippery surfaces into account when riding!

**⚡** If rubber or plastic pedal covers have been put on your S-Pedelec, familiarize yourself with their grip. When wet, rubber and plastic pedals are very slippery!

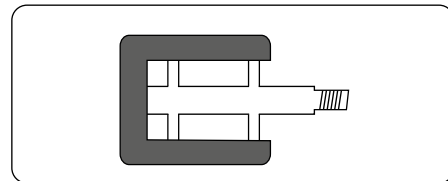

Ensure that the wheels are securely fastened in the frame and fork. Check the firm attachment of the quick-release axles and all important fastening screws and nuts (see section "Screw connections").

If you hear rattling or other unusual noises during operation, have your Stromer dealer determine the cause and remove it before you continue riding. Push the S-Pedelec forwards while pulling the brake lever. The back brake should completely prevent the back wheel from moving, while the front brake should lift the back wheel off the ground with its braking effect. The bicycle's steering should not rattle while braking or exhibit any play.

Please take an initial test ride in a safe place where you can familiarize yourself with the new brakes! Modern brakes have a very strong braking effect.

Check the air pressure in the tires. You will find information as to the correct tyre pressure on a label in the battery case and on the sides of the tyres. Please adhere to the required minimum and maximum pressure!

If you cannot find any recommended pressures, 3 bar/43.5 psi is a suitable pressure for most tires. Hint: As a general rule of thumb when you are out on a ride, you can check the tire pressure by doing the following: If you place your thumb on a pumped up tire, you should not be able to significantly change its shape by applying pressure. Check the tires and rims. Scan them for any damage, cracks or deformations, as well as embedded particles, e.g. shards of glass or sharp stones.

If you should find any cuts, rips or holes, please refrain from riding! First have your S-Pedelec checked by a specialist.

It is also necessary for you to check the following components of your S-Pedelec:

- Check that the battery box is safely closed with the battery inside.

- Check the charging state of the battery to ensure that the charge is sufficient for the drive planned.
- Familiarize yourself with the functions of the operating element.
- Activate the anti-lock braking system (ABS) if available.

 **Always squeeze the brakes of your S-Pedelec before you place a foot on the pedal! The motor starts propelling as you step on the pedal. This boost is unusual and can lead to falls or cause dangerous traffic accidents.**

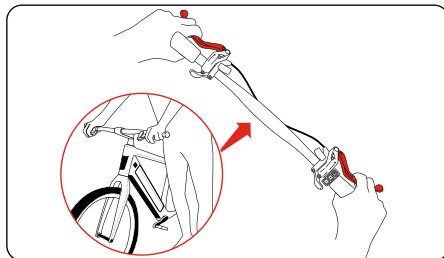

### Setting up the position of the handlebars / stem

 Consider that not every stem is suitable for every steer tube when retrofitting your S-Pedelec! Only use Stromer stems. Only allow Stromer dealers to work on your handlebars and stem!

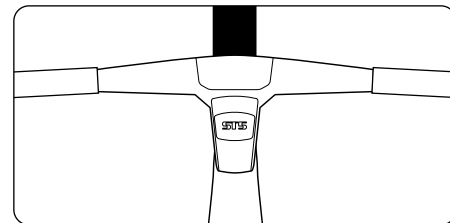

Specially designed Stromer stem.

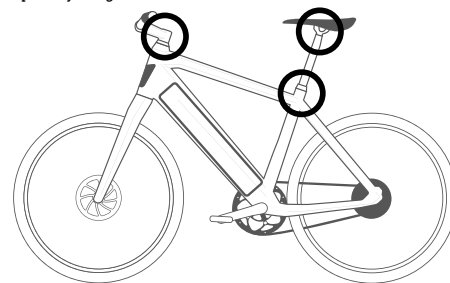

Positions of screw connections for adjusting the sitting position

### Installing pedals

If your S-Pedelec was supplied without the pedals pre-installed, these have to be attached with the correct wrench. Please note that the pedals have to be screwed on in different directions and secured with a high mounting torque (see page 32). Apply assembly grease to both threads.

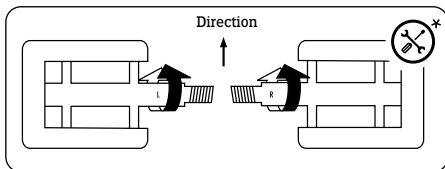

**⚠** Ensure that you have read the manufacturer's instructions before using step-in or clipless pedals.

Practice clipping your shoes in and out of the pedals' locking system before your first ride in a quiet, safe place. Clipless pedals which do not properly release are a safety hazard.

**i** In the case of step-in pedals, you are able to adjust how much force is required to release the shoe from the pedal. Please test this on your first ride with a setting that releases easily! Regularly clean your step-in pedals and keep them in good condition with a suitable spray lubricant.

### Setting up the seating position

Before you use your Stromer S-Pedelec for the first time, the seating position has to be set up to suit your body size. This is vital for riding safely and securely.

To do this, the seat's height, alignment and angle have to be set up, as do the height and alignment of the handlebars with the stem.

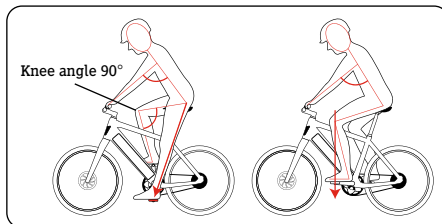

**⚠** When adjusting the height of the seat, never pull the seat post further out than the maximum extension length marked! If your tube does not have a maximum marking, then you must leave a minimum insertion length of 7.5 cm.

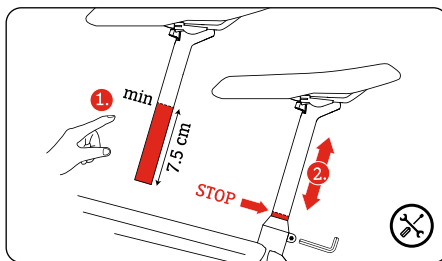

### Setting up the angle of the seat

Once you have set the height of the seat, you have to check that the angle of the seat is suitable. In general, the upper surface of the seat should be horizontal. You can adjust this by loosening the clamping bolts in the seat post.

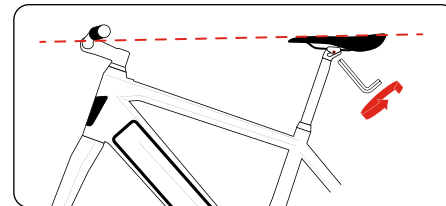

## BEFORE EACH RIDE

Before every ride, please check:

- That the bell/horn, all electrical plug-in connectors and lighting function correctly and are safely attached
- That the brakes and anti-lock braking system (ABS) (if available) are working safely and properly secured
- That the battery box is safely closed with the battery inside.
- The tightness of the pipes and connections
- Tires and rims for damage, eccentricity and penetrating alien objects, particularly after rides off fortified roads
- That the tires have a sufficient tread depth
- That the suspension components are working properly and are safely secured
- The firm attachment of screws and nuts of quick-release axles (see "Screw connections" section), even when the vehicle was only unsupervised for a short time.
- That the frame and forks are not misshapen or damaged
- That the handlebars, stem, seat post and seat are both correctly and securely fastened as well as set up in the right position

- That the seat post and seat are secure. Try turning the seat or tipping it upwards or downwards. It should not move.
- When you are riding with clipless/step-in pedals: Functional testing is required. The pedals must release easily and without problems.

 Do not ride off when you are not completely sure that your S-Pedelec is in flawless condition. Have it inspected by a Stromer dealer.

It is particularly important if you use your S-Pedelec a lot, either for sport or daily use, that you regularly have all the important parts checked by a Stromer dealer.

Frame and forks, suspension components and other parts relevant to your safety such as brakes and wheels are subject to heavy wear, which can impact on the operating safety of these parts.

Components might spontaneously fail when the predetermined usage period or service life is exceeded. This can lead to falls and serious injury!

 Please make these checks before continuing after a fall or if your S-Pedelec falls over! Bent or damaged aluminium parts cannot be safely bent back into shape, and carbon components can sustain damage which is not recognisable to the eye.

## If you have fallen

Check the whole of the S-Pedelec for changes. These may be dents and cracks in the frame and the fork, but also bent components. You must also check the function and safe attachment of parts that have been shifted or twisted, e.g. the handlebars or the seat.

If you notice any changes to your S-Pedelec, DO NOT continue cycling. Do not re-tighten any loose parts without first checking them and always use a torque wrench.

Bring your S-Pedelec to a Stromer dealer, describe the fall and get your S-Pedelec inspected!

## LUGGAGE AND LOAD TRANSPORT

 Attached accessories must always be installed according to the regulations and instructions. You must ensure the correct fastening torques for all screw connections (see “Screw connections” on page 32)

- Only use add-on parts that comply with the respective legal regulations and road traffic regulations.
- The use of unlicensed parts may lead to accidents. You should therefore only use original accessories and add-on parts which fit your S-Pedelec.
- Use the advice of a Stromer dealer.



### Rack

 Only retrofit luggage racks to S-Pedelecs that have been approved by Stromer for this purpose. Use only the intended fixing devices. Ask your Stromer dealer whether and how luggage may be transported when using add-on parts

made of carbon. Don't fix racks to the seat post! It is not constructed for this use. Overloading of the seat post with a luggage rack may break the seat post and lead to serious accidents.

The permitted total weight of the vehicle may not be exceeded, even when a luggage rack with a higher carrying capacity would enable that!

### Front-wheel luggage carriers

Front-wheel luggage carriers may not be installed or operated.

### Safety information for luggage transport

 Luggage loads change the behavior of your S-Pedelec. They extend the braking distance, among other things. This may lead to severe accidents or falls. Adapt your riding style to different driving characteristics, i.e. brake earlier and consider the more sluggish steering properties. Only transport luggage on the luggage rack intended for this purpose! Child seats may not be installed or operated.

Please ensure that nothing can get caught in the spokes and turning wheels.

 If you are riding with luggage, ensure that you do not exceed the maximum permissible weight of the S-Pedelec. Information on the weight capacity of the rack is also stated here. Additional information regarding this issue is provided at [www.stromerbike.com/support](http://www.stromerbike.com/support)

## LEGAL REQUIREMENTS

**i** The regulations and requirements for e-bikes are continuously being revised and may change at any time. Obtain information regarding the valid legal requirements so that you are always up to date.

For S-Pedelecs, special provisions apply for their limit of use. This means that e-bikes are sometimes operated like a bicycle and at other times not.

Before riding on public roads with your Stromer, inform yourself about the current legal requirements enforced in your country.

This information can be found at your Stromer retail store or on the websites of national bike or e-bike associations.

There you can obtain information on how your Stromer must be equipped in order to drive in traffic on public roads. These sources describe, for example, which lighting systems have to be installed and which brakes the S-Pedelec must have.

The currently valid, national regulations also deal with age restrictions and specify from which age people are allowed to drive on which part of the road and whether certain driving permits are required. The regulations for children riding on public roads are also found here. It will be made clear if a helmet is required to be worn by law.

**i** Check whether your private third-party-liability insurance covers possible damage caused by using a Stromer S-Pedelec.

## APPROPRIATE USE

**⚡** S-Pedelecs are means of transport designed to be ridden by one person. It is not permitted to transport children in trailers of S-Pedelecs within the scope of validity of EU law!

Transporting an additional person by using an S-Pedelec, e.g. in a child trailer, can only be permitted within the framework of the respective, national law. We urgently advise against transporting additional persons, even in specific cases where this might be permitted.

If you would like to transport luggage, this requires that your S-Pedelec is fitted with suitable equipment. Children may not be transported by S-Pedelecs within the scope of EU law and they may only be transported in trailers dedicated for this purpose in Switzerland. We recommend not taking any chances when it comes to quality in this area! Please take note of the permitted total weight and the stipulated maximum speed for the trailer.

**i** The total weight of the Stromer S-Pedelec is 150 kg. Permitted total weight: Weight of driver + weight of S-Pedelec, including weight of battery + weight of luggage + weight of trailer (if trailer is permitted). Stromer ST1 and ST2 Weight: 29 kg, ST3 and ST5 Weight: 29,2 kg.

Use as intended also includes adherence to the operating, servicing and maintenance conditions that are described in this manual.

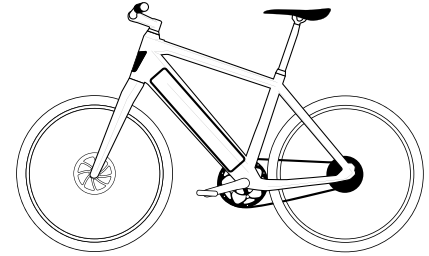

**⚡** **Dangers of improper use**

Only use your Stromer for its intended use. Please read the section "Intended Use" in this original instruction manual.

This also includes adherence to the operating, servicing and maintenance conditions that are described in this manual.

Inform other users of the intended use and the dangers of not adhering to it.

Improper use, overloading and lack of maintenance may lead to accidents and falls involving severe injuries to you and other people!

Stromer S-Pedelecs may be used on public roads and fortified paths when they are equipped as prescribed by national law.

Manufacturers and dealers are not liable for damages resulting from use outside of intended use. This applies particularly to damages resulting from non-adherence to the safety instructions, e.g., in terms of:

- Use on terrain
- Overloading, or
- The incorrect remedying of defects

Stromer S-Pedelects have not been designed for extreme loads, e.g. driving over stairs, rider tricks or jumps.

## REPLACING PARTS ON YOUR SPEED PEDELEC

Specific components are defined in the approvals process which are allowed to be used on this vehicle. In other words, the S-Pedelec is only permitted if your vehicle uses these parts or replacement parts which have been approved for use with your model. If parts are replaced by the user, only original parts or replacements which are approved for use on the S-pedelec may be used, otherwise the user must seek individual permission from the local regulatory authority.

Parts which must only be replaced like-for-like or with approved parts are as follows:

- |                 |                         |
|-----------------|-------------------------|
| 1. Frame        | 9. Front light          |
| 2. Fork         | 10. Rear light          |
| 3. Motor unit   | 11. Number plate holder |
| 4. Battery      | 12. Side stand          |
| 5. Tires        | 13. Handlebars          |
| 6. Rims         | 14. Stem                |
| 7. Brake system | 15. Seat post           |
| 8. Pedals       |                         |

## RIDING A STROMER

### Power button

The power button is located at the bottom of the top tube, below the touch screen.

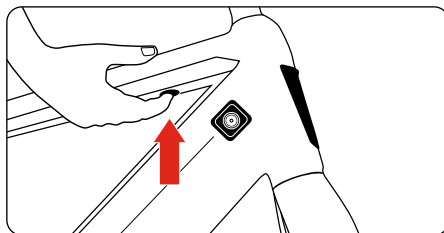

The power button has the following functions:

- Waking up from sleeping mode
- Change from shortcut display to riding display
- Change from riding display to shortcut display
- Change from any point in the menu to the shortcut display

### Switching on

Press the power button to switch on.

**i** When your Stromer has been locked with a PIN, you must unlock your Stromer after switching it on before you can use it. (See “Theft protection” chapter)

### Switching off

1. Press the Power button to get to the shortcut display.
2. Select **OFF**.

## Sleep mode

When the Stromer is not switched off, it will switch to sleep mode after approx. 5 minutes of inactivity. The sensor system remains active during sleep mode. The system wakes up by itself as soon as you move the Stromer.

Alternatively, you can also wake up your Stromer by using the power button.

**i** Always switch off your Stromer by using the touch screen when you want to prevent it from switching itself on.

## OPERATING ELEMENT

Important functions of the Stromer can be controlled while riding and without taking your hands off the handlebar, by using the operating element on the handlebar.

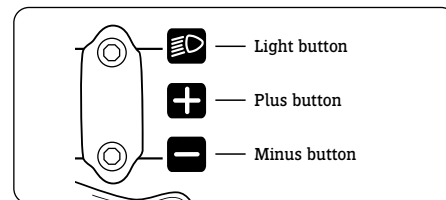

## Support levels

The + and – buttons of the operating element on the handlebar make it possible to change between the following support modes:

**Bicycle mode:** The motor is switched off.



**Support mode 1:** Low motor support, optimized for large driving range.

**Support mode 2:** Medium motor support – this support mode can be fine-tuned by using the Stromer app.

**Support mode 3:** High motor support for maximum speed.

The motor support depends on the force that acts on the pedals. The more firmly you step onto the pedals, the stronger the support from the motor. The motor support stops when you stop pushing the pedals during the ride. Motor support is only reactivated when you start working the pedals.

## Lighting system

A daytime running light is integrated into your Stromer to increase safety in daily traffic.

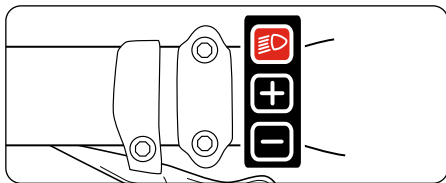

To switch between dipped beam and full beam, press the light button on the control element on the handlebar. The Stromer models ST3 and ST5 are equipped with a lighting system that can switch between dipped beam and main beam. Just like with cars, a brake light is integrated into the rear light.

In some countries, the daytime running light can not be turned off.

## Braking mode / Recuperation

Stromer S-Pedelecs can also generate energy with their motor and thus charge the battery, for example, when driving downhill. In this case the motor acts like a dynamo, i.e. it performs a braking function and thus generates the power that charges the battery. This may significantly extend the driving range for a tour. Recuperation can further be used as a convenient “engine brake” on steep or long declines.

As soon as you brake, the motor switches to recuperation/brake mode and supports your braking effort. The braking energy is stored in your battery and therefore increases the driving range of your Stromer.

The Stromer offers a braking aid for prolonged downhill drives. To use this, keep the minus-button pressed for 2 seconds. The braking force of your Stromer can now be adjusted by again pressing the plus or minus button.

To terminate recuperation, again keep the + or – button pressed for another 2 seconds.

A weak recuperation level brakes less and is therefore suitable for flat declines, while strong recuperation levels brake significantly more. The range is therefore easily and conveniently optimized.

The recuperation is automatically terminated when the speed falls below a certain minimum and you step onto the pedals. This speed varies according to the version of the firmware loaded. It is usually below 10 km/h.

## Electronic bike horn

Your Stromer is equipped with an electronic bike horn. The control button is located on the left handlebar grip. Only use the horn to call attention to yourself in potentially dangerous situations.

## TOUCHSCREEN / DISPLAY

### Touchscreen

The display of the Stromer is equipped with a resistive touch screen.

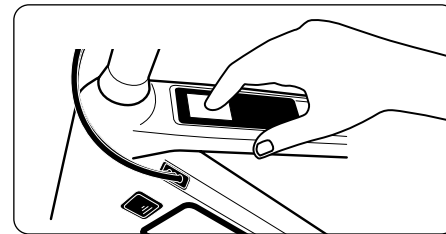

That means that the touch screen does not respond to touch, like capacitive touch screens, but responds to gentle finger pressure and can therefore easily be operated with gloves. Gentle pressure on the touch screen is sufficient to navigate through various menus or change to the riding display.

## Riding display

The touchscreen changes to the driving display as soon as you start riding your Stromer.

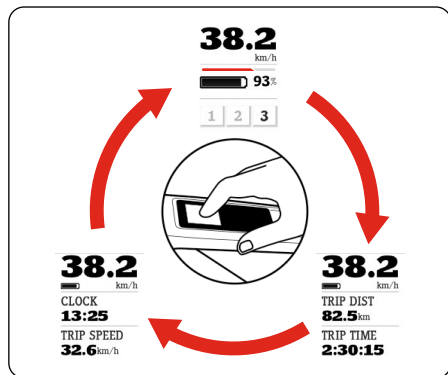

The riding display shows your speed and information regarding the ride. You can change between riding displays by pressing the touch screen until the desired information is being displayed.

## Theft protection

### Activate lock

The Stromer offers optimal theft protection. You can lock the Stromer with a PIN when you switch it off. The Stromer can then only be switched on by re-entering your PIN.

1. Press the Power button to get to the shortcut display.
2. Select **LOCK**.

The theft mode is activated when the locked Stromer is moved.

Your Stromer automatically switches off when it has not been switched off or locked, but has not been used for a prolonged period. However, the lock is not activated in this case.

### Deactivating the lock

Proceed as follows to deactivate the lock:

1. Press the Power button.
2. Enter your PIN using the touch screen.

## Stromer OMNI App

Connected on the go: All Stromer bikes are equipped with the OMNI connect cloud-based platform. You can use OMNI connect directly via your Stromer's touchscreen or via the OMNI app on your smartphone.

[www.stromerbike.com/en/swiss-technology#Connectivity](http://www.stromerbike.com/en/swiss-technology#Connectivity)

## USB CHARGING SOCKET

Is the battery of your smartphone empty? – No problem. The Stromer models ST3 and ST5 are equipped with a USB charging socket. Connect your smartphone to recharge the battery.

The charging socket is located in front on the day-time running light and is sealed by a rubber lip.

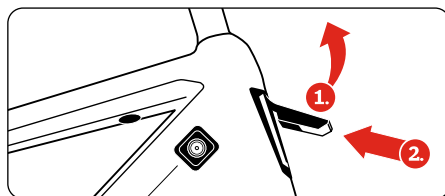

**Only connect your smartphone when the S-Pedelec is standing. Do not change your smartphone while riding.**

## Range

The achievable range per charge is dependent on various factors:

- **Support level:** The higher the support level used, the lower the range.
- **Riding style:** You can save energy with the optimal use of the gear shift. In lower gears you need to use less power, the support will be less and your S-Pedelec's drive consumes less energy.
- **Ambient temperature:** A battery discharges faster in cold weather.
- **Weather and vehicle weight:** In addition to the ambient temperature, wind conditions also have influence on the range. More force has to be applied while riding through strong headwinds. The weight increases with luggage etc. and more power is also then needed.
- **Technical condition of your S-Pedelec:** Too low air pressure in the tires increases the rolling resistance. Dragging brakes also affect range.
- **Battery capacity:** The battery capacity indicates the capacity of a fully charged battery, to store a certain amount of electricity. As the capacity decreases with the increasing age of a battery, the amount of storable energy in a full charge also decreases.
- Road quality and the route profile: Rough pavement or gravel reduce the range. You can ride much further on flat surroundings than when riding on slopes.

## ANTI-LOCK BRAKING SYSTEM WITH A PINLIFT ON THE REAR AXLE

 myStromer cannot be held liable for damage caused by unreasonable, unpredictable and/or inappropriate use of the anti-lock braking system (ABS).

- Use of the S-Pedelec should always be adjusted to the overall situation, including traffic patterns and your riding skills.
- In addition, the anti-lock braking system (ABS) actively influences the braking function of your S-Pedelec. Please bear in mind that, in certain situations, your braking distance may actually be extended.

 The capacities of your anti-lock braking system (ABS) have limits!

- In extreme riding conditions, such as hard braking on a slippery surface, setting off on steep ascents or when panicking, you might not be able to steer your S-Pedelec as you expected. Whenever possible, always try to avoid late and hard braking because you were relying too much on your anti-lock braking system (ABS).

As an additional optional safety measure, your S-Pedelec may also have an anti-lock braking system (ABS) on the front axle with a pinlift on the rear axle. This set-up allows for controlled braking on slippery surfaces and should prevent you from falling over the bicycle in the event of a hard brake. The anti-lock braking system is fully integrated into your S-Pedelec and may only be differentiated using the ABS control light on your OMNI display.

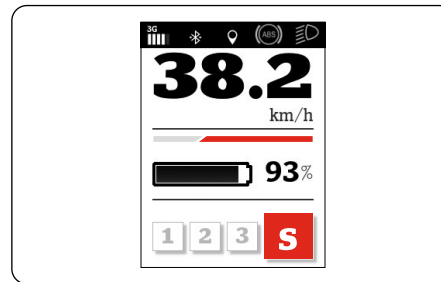

Before you first use the anti-lock braking system (ABS), it is essential that you carefully read the operating manual from the manufacturer, Blubrake, which you can find at [www.stromerbike.com/support](http://www.stromerbike.com/support) and on their own website.

Before the ride:

The anti-lock braking system must be initialized before each use. You can do this by carefully activating the front wheel brake at a speed of at least 5 km/h after the S-Pedelec has been turned on/ woken up/unlocked. The orange ABS control light on the OMNI display should no longer light up after this process. Do not start your ride until you have successfully initialized the system.

During the ride:

If the ABS control light is displayed during the ride, this means there is a problem or malfunction of the system. Restart your S-Pedelec and perform the initialization again.

 If the control light still does not turn off, consult a specialist Stromer bicycle retailer immediately.

As long as the brakes have no mechanical defects, the S-Pedelec can still brake without the anti-lock braking system (ABS).

### Maintenance and warranty

General work on the braking system must only ever be performed by a specialist Stromer bicycle retailer. If the maintenance is not performed in accordance with the specifications and/or if work is performed by unauthorized personnel, the warranty and/or guarantee of the whole anti-lock braking system is immediately voided.

## MENU AND SETTINGS

### Menu structure

Pressing the power button takes you to the shortcut display. Here you have direct access to all functions and settings:

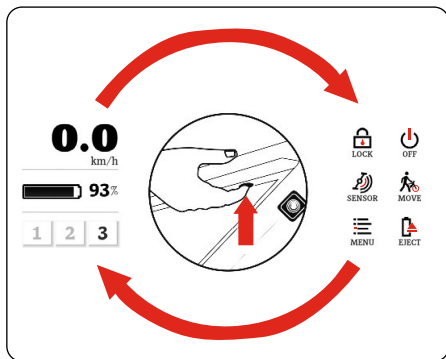

Pressing the power button again brings you back to the driving mode display.

### Time

You can individually set the time and the display format.

1. Go to **MENU** and **SETTINGS**.
2. The **TIME** section can be used to select the desired display format and to set the time.

### Languages

The Stromer supports the following languages: German, English, French, Italian and Dutch.

1. Go to **MENU** and press **SYSTEM**.
2. Select the language required in the **LANGUAGE** section.

### Units (km/miles)

The Stromer supports metric (km; km/h; Wh/km) and imperial (Mi; mph; Wh/Mi) measuring units.

1. Got to **MENU** and press **SYSTEM**.
2. The **UNITS** section can be used to select the preferred measuring units.

**i** Detailed information regarding the individual settings is provided in the respective sub-chapters or online at [www.stromerbike.com](http://www.stromerbike.com).

**i** The function of the settings described may change after a software update. A description of the current functions is provided online at [www.stromerbike.com](http://www.stromerbike.com).

**i** The menu is only available when the Stromer stands still. As soon as you start moving, the touch screen changes to the riding display. You cannot call up the menu during the ride for your own safety.

### Break mode

You can adjust the strength of the motor braking of the Stromer to your driving style with the braking strength.

1. Go to **MENU** and press **BIKE**.
2. The strength of the brake mode can be set in the **BRAKEMODE** section.

### Setting the PIN

1. Press the Power button to get to the shortcut display.
2. Select **MENU** in the shortcut display and then press **SETTINGS**.
3. The **PIN** column can be used to set a new PIN. Your first locking code is randomly generated and will be sent to you by SMS to the registered mobile number and by e-mail to the registered e-mail address when your Stromer is activated.

**i** If your Stromer was locked with a PIN, you must unlock your Stromer after switching it on before you can use it (see "Theft protection" above).

### Torque sensor

You can adapt the response characteristics of your Stromer to your riding style. The ratio between rider power and motor support is controlled by the sensor sensitivity.

1. Go to **MENU** and press **BIKE**.
2. You can set the sensitivity of the sensor in column **TORQ. SENS**.

Higher sensitivity implies that your Stromer will respond more to low pressure on the pedals.

**i** A change of sensor sensitivity influences the response behavior of the Stromer at all support levels. Higher sensitivity reduces the driving range.

## HANDLING THE BATTERY

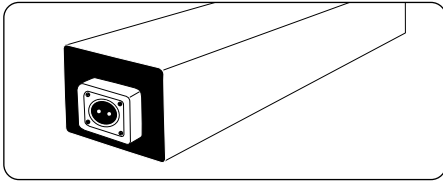

### Safety notes concerning the battery

- Only charge the battery with the charger it belongs to. The use of other chargers poses the risk of fire.
- Do not drop or throw the battery and avoid strong impacts. The battery might otherwise leak fluid, start a fire or explode.
- Do not apply force to the battery. The integrated protection mechanism may be damaged when the battery is deformed. This may result in fire and explosion.
- Do not use the battery when it is damaged. The liquid contained may leak and contact with the eyes may result in blindness! Avoid contact, otherwise rinse off the liquid with lots of water and immediately consult a doctor.
- Obtain information regarding the currently valid regulations when you want to transport the S-pedelec, e.g. by car.
- Remove the battery of your Stromer before transportation and transport it separately.



The battery is considered a hazardous good! Remove the battery when you want to perform any kind of work on the S-Pedelec, e.g. maintenance or assembly. Unintentionally activating the On/Off switch might lead to injury or an electric shock.

- Don't ever open up the battery; This can cause the battery to short circuit. All warranty and guarantee claims expire when the battery was opened.
- Do not store the battery with metal objects that may cause shorts, e.g. office clips, nails, screws, keys, coins. A short circuit may cause burns or fires.
- Keep the battery away from heat, e.g. strong sunlight and fire. There is a risk of explosion.
- Protect the battery from coming into contact with water and other fluids. Contact may damage the protective circuit and the protective mechanism of the battery. This may cause fire and explosions.
- Do not clean the battery with a pressure washer. Use a damp rag when cleaning the battery. Never use corrosive cleaning solutions.
- In the event that fumes escape after inappropriate use or damage, ensure exposure to fresh air and consult a doctor if you experience any medical problems. Before starting a ride, the battery must be fully locked in place in its holder and the battery box must be closed. You may otherwise lose the battery while riding.
- Prevent deep discharging of the battery. It may cause irreversible damage to the cells.

- The battery is exclusively intended for use with Stromer electrical bicycle drives. Inappropriate use or wrong handling may cause injury or a fire. Stromer is not liable for damage caused by inappropriate use.
- Never send a battery in the mail! Batteries are hazardous goods. Only send batteries for your S-Pedelec through your Stromer dealer. The battery may overheat and catch fire under certain circumstances.
- The battery may not be disposed of with domestic waste. The sales outlet will take it back and will ensure appropriate disposal.
- Never store several batteries on top or next to each other. This may lead to overheating and fire.

### Storing the battery

Store the battery in a dry and well-ventilated place. A room temperature of approx. 20 °C is optimal to prevent loss of capacity. Only use the battery for riding the Stromer in cold conditions. Store it in a warm environment, which increases the range. Ensure that the Stromer is switched off when you want to store your battery in your bike. Check its charging level approx. every 4–8 weeks and recharge it as required.

Store the battery with a battery charging state of at least 40% when you do not intend to use it for a prolonged period, e.g. during a winter break. This is the most effective way of preventing deep discharging. Ensure that the battery is never stored in a fully discharged state, as this may lead to deep discharging and irreversible cell damage.

Possible guarantee or warranty claims may then become void.

The battery must be recharged within 2-3 days after it has been fully discharged in order to prevent deep discharging.

**i** Storage at a battery charging level of 40-60% is best suited to preserving your battery. Please consider that this shortens the period after which deep discharging is possible when compared to a fully charged battery! The capacity of a battery decreases with age, even when it is well-maintained.

You should change a battery that has not been used or recharged for a prolonged period before you install it in your S-Pedelec.

## Removing the battery

**i** The battery can only be removed when stationary.

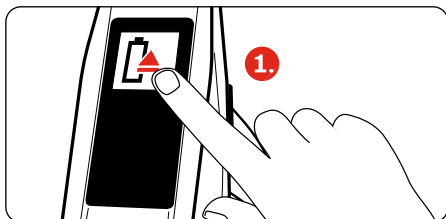

Click the "Eject Battery" icon

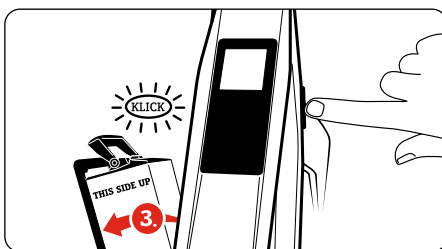
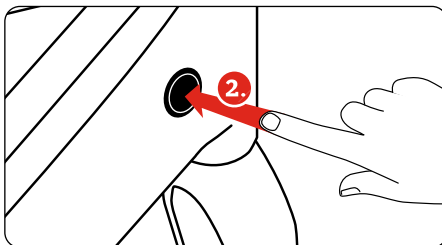

Hold down the "Off" button until the display is no longer lit up.

Remove the battery.

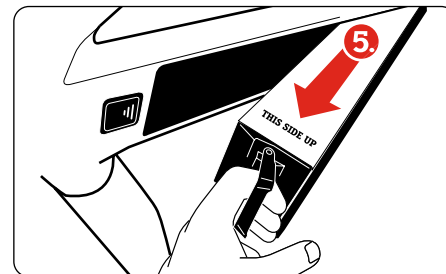

The battery is very heavy, so take care not to drop it. You could get injured and/or the battery might get damaged.

## Inserting the battery

Place the battery into the battery box. Take care that the connector points downwards and that the lettering **THIS SIDE UP** is visible on top. Push the battery downwards until it latches.

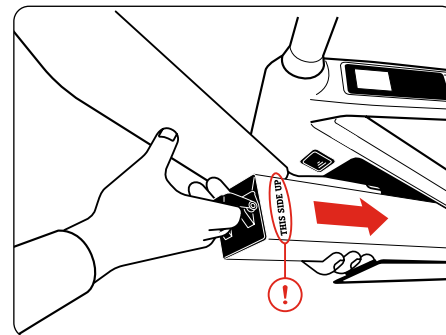

Close the battery box. Press on the cover with the palm of your hand until it snaps into place with a quiet click. and remove the key from the lock.

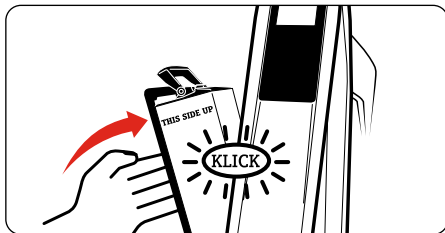

## Safety information regarding the charger

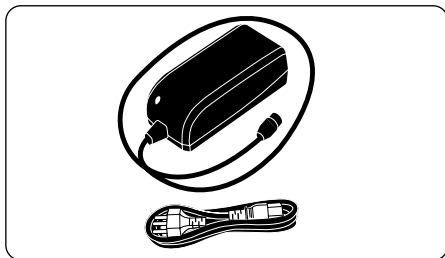

**i** Read the operating instructions for the charger before beginning to charge the battery.

You can change the battery of your Stromer while it is installed in your S-Pedelec. However, you can also remove the battery from the S-Pedelec and charge it in another place. It is particularly advantageous to charge it in a warmer environment (room temperature) when it is cold outside, in order to shorten the charging period. Avoid charging processes below 0 °C or above 30 °C and in tightly sealed spaces. The charging process is automatically stopped at temperatures below 0 °C or above 30 °C.

Please note that a sudden change of temperature from cold to warm can cause condensation to build up in the charger. Avoid this by storing the battery in the same place where it is charged. Only use the charger supplied or a charger released by Stromer to avoid the risk of fire.

Use the charger in a dry room and don't cover it up while it is in use. It could otherwise short circuit or cause a fire.

Check the mains voltage before connecting the charger! The voltage of the power source must correspond to the information on the type plate of the charger.

- Always pull the plug out of the socket before cleaning the charger.
- The charger should be disconnected from the mains once the charging process has been completed.

**⚠** For safety reasons, always place the charger on a dry, non-flammable surface.

**⚠** A defective battery should neither be charged nor used any further. A battery can become warm while charging. It must not get hot. When the battery heats up strongly, immediately terminate the charging process.

**⚠** Never ride when the battery is not inserted. The battery compartment can in this case not be locked. This poses an additional risk of falls and injuries.

## Charging the battery

**i** Always read the charger information first.

**i** The battery is fitted with a practical magnetic connection. The magnets will help you to position the plug correctly. Hold the charging cable loosely in your hands and slowly move it near the battery socket.

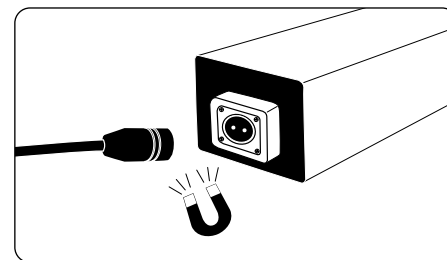

## Changing the battery externally, outside the S-Pedelec

### CR245 charger

1. Connect the charger to the power mains. The integrated LEDs light up in red and green.
2. Now connect the Stromer charger to the battery. The LEDs in the charger light up in orange and green during the charging process. If the LEDs flash red, the charging temperature is above the authorized range. When the battery is fully charged, the LEDs light up green.
3. Separate the battery from the charger and then the charger from the mains connector.

### Charger CR246

1. Connect the charger to the power mains.
2. Now connect the Stromer charger to the battery. The LED in the charger flashes green during the charging process. If the LED flashes red, the charging temperature is above the authorized range. If the LED lights up in red, there was an error during the charging process. When the battery is fully charged, the LED lights up green.
3. Separate the battery from the charger and then the charger from the mains connector.

## Charging the battery internally, in the S-Pedelec

The connection for the charging cable is located on the left side of the down tube, slightly below the connection to the head tube.

### Charger CR245

1. Connect the charger to the power mains. The integrated LEDs light up in red and green.
2. Open the cover of the charging socket. Connect the Stromer charger to the Stromer. The LEDs in the charger light up in orange and green during the charging process. If the LEDs flash red, the charging temperature is above the authorized range. When the battery is fully charged, the LEDs light up green.
3. Separate the battery/Stromer from the charger and then the charger from the mains connector.

### Charger CR246

1. Connect the charger to the power mains.
2. Open the cover of the charging socket. Connect the Stromer charger to the Stromer. The LED in the charger flashes green during the charging process. If the LED flashes red, the charging temperature is above the authorized range. If the LED lights up in red, there was an error during the charging process. When the battery is fully charged, the LED lights up green.
3. Separate the battery/Stromer from the charger and then the charger from the mains connector.

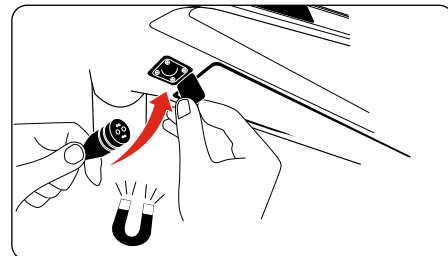
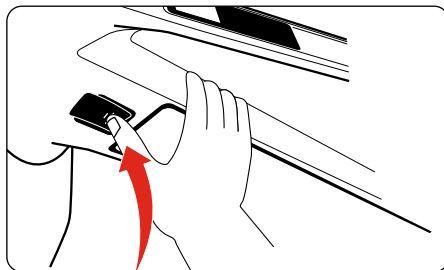

## Charging duration

The charging time may vary according to the version and the model of the battery and the charger. Accurate charging times are provided in the information at [www.stromerbike.com/service](http://www.stromerbike.com/service).

## Charging status indicator

The driving display provides the option of tracking the battery charge status of your Stromer. The battery charge status is shown in the form of a bar and a percent value. The Stromer automatically switches off the motor and changes to bicycle mode (no support) when the battery is empty. The bar above the battery charge status indicates the current energy flow. The display helps to ride in an energy-saving way with a large driving range. The longer the bar, the higher the energy flow.

The bar points from right to left as soon as the motor provides support.





The battery is charged during brake mode, so the dark bar points from left to right.



A small part of the battery energy is saved in order to sustain the basic functions of your Stromer and keep you safe. The lighting and display still work for approximately another hour when the battery is empty and the motor support has stopped.

## SERVICE / MAINTENANCE

**i** Regularly have your S-Pedelec inspected by a Stromer dealer. These experts can identify damaged and worn parts and are able to advise you in selecting replacements. They will also check the current software status and ensure that important updates that improve safety and riding comfort have been installed.

Refrain from repairing key parts yourself (frame, forks, handlebars, stem, headset, brakes, lights).

**i** Your S-Pedelec can only function safely and effectively if you replace parts with suitable, authorized replacements. Please consult your manufacturer, importer or Stromer dealer for advice on suitable replacement parts.

**i** Only replace broken or worn parts with original replacement parts from the manufacturer or parts approved by your manufacturer. This is prescribed for some components and an appropriate list is provided in the "Exchange of components of the fast Pedelec" section.

In this case, using non-original or non-approved parts also invalidates the registration of the S-Pedelec. The use of other non-approved parts generally invalidates the warranty and guarantees with the manufacturer for other parts.

**⚠** If you install non-original or the incorrect replacement parts, this can lead to a severe loss of function! Tires with bad grip or tires that were not designed for use in S-Pedelecs, brake pads with inappropriate friction coefficient and wrongly used or badly designed light-weight components can cause accidents with the most severe of consequences. The same applies for improper assembly!

## Screws and torque spanners

**⚠** When working on the S-Pedelec, please ensure that all screws are tightened to the correct torque. The required torque is printed on many parts with a screwed connection. This amount is stated in Newton meters (Nm) and this work should be carried out using a torque wrench. Best suited are torque wrenches that slip and provide an acoustic signal when the predefined fastening torque is reached. Otherwise, screws may snap or break. If you don't own a torque wrench then you should always leave this work to a Stromer dealer! A table with the most important fastening torques for screw connections is provided in the "Screw connections" section.

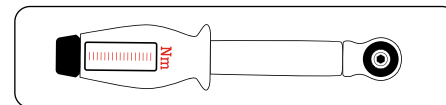

Torque spanners

- Open live parts should only be maintained and cleaned at a Stromer dealer!
- Remove the battery before cleaning your S-Pedelec. Ensure that the battery box is again completely closed.
- Ensure that you do not touch and thus possibly connect contacts when cleaning the battery. You risk being hurt and the battery may suffer damage if the contacts are live.
- Cleaning with a high-pressure cleaner may damage the electrical system. The high pressure might also push cleaning liquid into sealed parts and thus damage them.
- Avoid damage to cables and electrical components. When this has happened, the S-Pedelec must be deactivated until it has been inspected by a Stromer dealer!

 **Switch off the electrical system, remove the battery and close the battery box before performing any kind of work on your S-Pedelec.**

## Chain / Drive

### Chain system

The drive chain must be regularly cleaned and lubricated to ensure appropriate functioning (see the “Deadlines and inspection work” section). Dirt can be removed with the normal S-Pedelec wash. Otherwise you can clean the chain by rubbing it with an oily cloth. When the chain is clean, it should be greased at the joints with suitable lubricant. After being left to soak, the excess lubricant should then be removed.

### Chain tension

To ensure that the chain and gears can work safely, the chain must have a certain level of tension. Otherwise it can come off and lead to a fall. Chain gear systems tense the chain automatically.

 Dirt and permanent strain wear the chain. The chain should be replaced as soon as it can be significantly lifted (approx. 5 mm) from the front chain ring with your fingers.

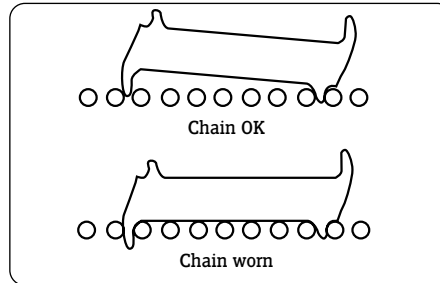

Many modern chains for derailleur gear systems no longer have chain connectors. Special tools are required to open/exchange/close them. They should be exchanged by a Stromer dealer. Other chains are supplied/mounted with chain joints. In some cases, these can be opened without the need for tools. These chain connectors can also be used to repair a damaged chain on a ride, if they have the correct width for the drive train.

### Belt drive

Your ST2 is equipped with a belt drive (Gates carbon belt drive). The automatic tensioning roller saves you from having to check and retensionify the belt, making it almost maintenance free.

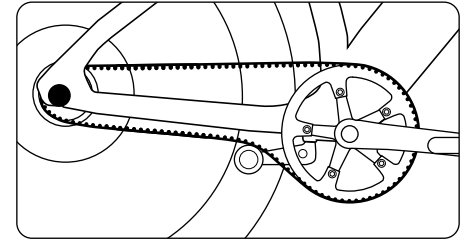

 **Please refer to the following handling instructions to extend the belt's lifespan. Improper handling can cause damage to the belt which may mean it needs replacing!**

- Do not bend or twist it.
- Do not turn it inside out.
- Do not bunch or coil it.
- Do not use as a belt whip
- Do not use tools or sharp instruments when handling the belt.
- Do not push down onto the belt pulley.
- Do not oil.

In order to extend its lifespan, we recommend cleaning the belt with water or a hand brush after riding through mud or dirt. Residue on the belt or belt pulleys can result in increased wear and noise such as squeaking or creaking.

Use in winter: The belt does not rust, but salt crystals may be left behind on the pulley system if salt water is allowed to dry on it. Even if no dirt is visible, you should wash your bike and belt regularly when using it during winter. Use warm water and a gentle detergent or cleaning product.

Check your belt drive for damage, deformation or cracks each time you clean it. If you have any doubts, visit your Stromer dealer. If you still notice any noise despite a thorough cleaning, a thin layer of dry silicone spray can be applied to the inside of the belt. This protects it against further build-up, reduces friction on the belt and reduces noise.

## Rims / Tires

 Rims are subject to a great deal of strain and are vital to your safety on the bike. They wear during riding. Do not ride with a rim once you can see damage. Have them checked by a Stromer dealer and replaced, as required. Wear can weaken rims and lead to falls and serious accidents.

 Also check the tyres of your S-Pedelec regularly. The lowest and highest authorised pressures can be found on the side of the tyre. Please adhere to them, otherwise the tyre may detach from the rim of the wheel or burst. If differing pressures are specified for the rim and the tyres, the lower maximum pressure and the higher minimum pressure are to be taken into account.

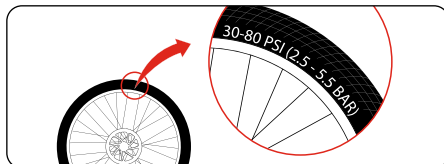

 For Stromer tyres in sizes e 57–584 (ST1 and ST2 54-584) a pressure of 2.2 bar/32 psi is recommended.

 Tires are wear parts. You should therefore regularly check the pressure, tread and condition of your tires. Not every tire is designed for every type of use. The tires of an S-Pedelec may only be exchanged for authorized products that were approved by the manufacturer. Here it is important to ensure the correct size. Seek advice from your Stromer dealer when selecting tyres. It is essential to get advice from a Stromer dealer when selecting tires.

 There are special tires for use in winter. Ask your Stromer dealer for tires with a special profile and a suitable rubber compound.

The following tire dimensions are permitted for the Stromer:

### Customs designation ETRTO size

27.5 x 2.25" (650b) e 57–584

ST1, ST2, ST3 and ST5: 57-584

ST1 and ST2: 54-584

## Dealing with punctures

 Contact your Stromer dealer or an authorised S-Pedelec workshop to fix flat tyres.

## Brakes

Your Stromer is equipped with a hydraulic disk brake.

 Only authorized replacement parts for the relevant bicycle or authorized components as per EU regulation No. 90 may be used.

 Brakes are vital to your safety on the bike. You should therefore maintain them on a regular basis. This requires specialist knowledge and special tools. Leave all work on your S-Pedelec to your Stromer dealer! Work that is improperly carried out endangers your safety on the S-Pedelec!

 Brake discs and brake pads are particularly subject to wear. Please allow a specialist retailer to check these key parts on a regular basis and replace any worn parts if necessary.

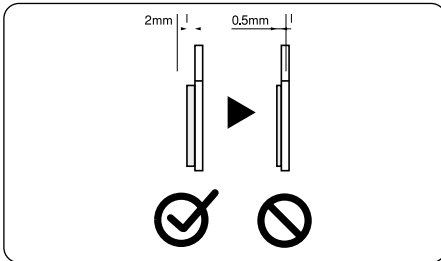

Source: Shimano® techdocs

 Do not touch the brake disk while it is rotating or directly after braking. This could result in injury or burns.

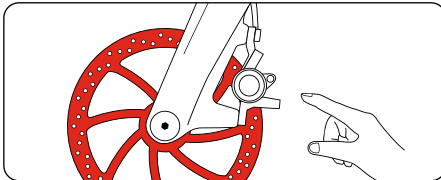

## Safety instructions for hydraulic disk brakes

 Avoid permanently braking for longer periods, as can be the case during long, steep descents. Otherwise this can allow vapor bubbles to form and cause a complete failure in the braking system. This could result in serious falls and injury.

The brake lever must not be applied if the S-Pedelec is on its side or upside down. Otherwise air bubbles can enter the hydraulic system which could cause the brakes to fail. After transporting the bicycle, check if the pressure point of the brakes seems softer than it was before. Slowly apply the brakes several times. This allows the braking system to discharge any bubbles.

If the pressure point remains soft, please refrain from riding. The Stromer dealer must bleed the brake.

 You can avoid this problem by applying the brake lever before transport and then fixing it in this position using a strap. This prevents any air from entering the hydraulic system.

When you come to clean the braking system, please first read the instructions provided by the component manufacturer.

 You can get more information about your S-Pedelec's brakes as well as cleaning and maintenance in the operating manual provided by your manufacturer or on the manufacturer's website: [www.stromerbike.com/support](http://www.stromerbike.com/support)

## Gears

 Gears are vital to your safety on the bike! Please read the operating instructions supplied to you by your manufacturer and familiarize yourself with how to operate the S-Pedelec and switch gears before your first ride. Allow your Stromer dealer to undertake any work on your bicycle's gears! Work that is improperly carried out endangers your safety on the S-Pedelec!

 Information regarding the gears of your S-Pedelec can be found in the manufacturer's instructions at [www.stromerbike.com/support](http://www.stromerbike.com/support) and on their websites on the Internet

## S-Pedelec tuning is prohibited

 Do not modify the S-Pedelec's technology in any way. Manipulating the bike in any way to increase performance or speed can lead to legal problems and/or make the bike less safe to ride.

Possible legal implications:

- The S-Pedelec is required by law to be registered for approval and insured. All legal requirements regarding the bike's configuration and as stated by the road traffic licensing authority must be adhered to.
- The manufacturer does not offer any kind of guarantee, warranty or liability.
- Criminal consequences cannot be ruled out. For instance, a negligent bodily injury may result in a legal offence.
- Termination of bicycle insurance.

Possible technological implications:

- Tampering with the bike's technology may limit its capabilities, cause defects or break the bike parts.
- The motor and battery may become overloaded and overheat. Consequences: Irreparable damages and risk of fire.

The brakes and other parts may become overworked. Consequences: Malfunction, overheating, increased wear and tear.

## Inspection plan

 Modern S-Pedelec technology provides high performance, but must be regularly maintained by qualified persons. This requires specialist knowledge and specialist tools. Leave the work on your S-Pedelec to your Stromer dealer!

Work that you can safely perform yourself is highlighted in **bold**. To ensure that your bicycle remains in a safe condition and fulfills the conditions of the warranty, the following terms apply:

- Clean your S-Pedelec after every ride and check it for possible damage.
- Have inspections carried out by the Stromer dealer.
- Check your S-Pedelec every 300 – 500 km or every three to six months.
- Check that all screws, nuts and quick release axles are secure.
- Use a torque wrench to tighten screw joints!
- Clean and grease moving parts (excluding brake surfaces) according to the manufacturer's instructions.
- Have paintwork touched up.
- Ask a specialist retailer to replace any broken and worn parts.

 You can get more information about your bicycle's parts as well as cleaning and maintenance in the operating manual provided by your manufacturer or on the manufacturer's website:

[www.stromerbike.com/support](http://www.stromerbike.com/support)

## Schedule and inspection work

 Ask your Stromer dealer for suitable lubricants! Not all lubricants are designed for all purposes. Using the wrong lubricants can lead to damage and impact the part's performance!

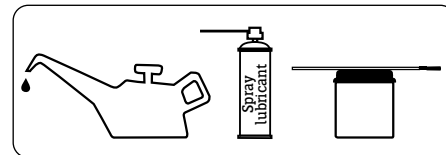

### Work to be undertaken

Check the following:

- Tires and wheels

Torques:

- Handlebars
- Cranks

Make any adjustments to the following components:

- Headset
- Brakes
- Pedals
- All mounting screws
- Seat post
- Seat
- Gear system
- Suspension elements

### **Before each use of the S-Pedelec**

#### **Work to be undertaken**

Maintenance / Inspection:

Check the following:

- **Spokes**
- **Rims for wear and concentricity**
- **Tires for damage and foreign bodies**
- **Quick release axles**
- **The functionality of the gear system**
- **The functionality of the brakes**
- **Hydraulic brakes: Tightness**
- **Lighting**
- **Bell or horn**
- **Tires: Safe seat and correct air pressure**

### **Every 300 to 500 kilometers**

#### **Work to be undertaken**

Check the following:

- **Drive chain**
- Check the brake pads for wear, replace them if required

Clean:

- **Drive chain**

Grease:

- **The chain with suitable lubricant**

Check the following:

- All screw joints are secure

### **Every 3000 kilometers**

#### **Work to be undertaken**

To be checked, cleaned,

and possibly replaced by the Stromer dealer:

- Hubs
- Pedals
- Brakes
- Headset
- Gear system
- Chain

### **After rides in the rain**

#### **Work to be undertaken**

- Remove humidity, dry

Cleaning and greasing:

- **Gears**
- **Chain**



The first inspection is particularly important for ensuring that your S-Pedelec remains safe and problem-free! Cables and spokes stretch, while bolted connections can loosen. Therefore always allow a Stromer dealer to carry out the first inspection.

## Lubrication



Working on the S-Pedelec requires special knowledge, experience and special tools! Only allow Stromer dealers to work or check key parts of the bicycle!

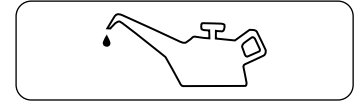

### Lubrication schedule

What must be lubricated?	At what intervals?	With which lubricants?
<b>Chain</b>	after removing dirt, after riding in the rain, every 250 km	chain oil
<b>Gear cables</b>	when not functioning well, once a year	silicon-free grease
<b>Wheel bearings, pedal bearings, inside bearing</b>	once a year	bearing grease
<b>Thread during mounting</b>	during mounting	mounting grease
<b>Contact surfaces of carbon parts</b>	during mounting	carbon mounting paste
<b>Sliding surfaces of screw joints</b>	once a year	grease, spray oil
<b>Metal seat post in metal frame</b>	during mounting	grease
<b>Gear joints</b>	when not functioning well, once a year	spray oil

## Screw connections



It is vital that all bolted connections on the S-Pedelec have the correct torque in order to ensure that they are secure. Too much torque can damage the screw, nut or component. Always use a torque spanner to tighten screw joints. You are not able to correctly tighten these bolted connections without this specialist tool!



If a component specifies a torque for its bolted connections, then this should be strictly adhered to. Please read the instructions provided by the manufacturer, which often list the correct mounting torques.



When a screw connection was treated with threadlocking adhesive (screw adhesive, e.g. Loctite), threadlocking adhesive must be used whenever this connection is opened, loosened or re-tightened.

Component	ST1	ST2	Torque
Clamping handles (Grips GP10 black) – handlebar	*	*	4 Nm
Clamping brake lever right	*	*	5 Nm
Clamping brake lever left	*	*	2 Nm
Clamping gear lever (microshift RD 942) – handlebar	*	*	5 Nm
Clamping stem - handlebar	*	*	5 – 6 Nm
Clamping stem – steer tube (aluminum)	*	*	5 – 6 Nm
Clamping headset top cap – steer tube (handlebar stem unit)	*	*	3 Nm
Clamping saddle underframe	*	*	12 – 14 Nm
Clamping saddle angle	*	*	12 – 14 Nm
Clamping seat rails and seat angle	*	*	12 – 14 Nm
Seat post clamp	*	*	10 Nm
Front axle	*	*	20 Nm
Rear axle	*		20 Nm
Rear axle		*	28 Nm
Brake disk (6-hole, VR-hub)	*		4 – 6 Nm
Brake disk (4-hole, HR-hub)	*		9 – 11 Nm
Bottom bracket	*		40 – 50 Nm
Pedal crank arm	*		38 – 41 Nm
Pedals	*		40 Nm
Gear changer	*		8 – 10 Nm
Lower channel Cover	*		3 Nm
Cable channel upper Guide	*		3 Nm



Component	ST1	ST2	Torque
Cable channel lower guide	*		3 Nm
Wicket Axle	*		3 Nm
Horn	*		4.5 Nm
Drinks bottle holder	*		3,5 Nm
Caliper	*		6 – 8 Nm
Brake pad pins			0.8 – 1.2 Nm
Belt tensioner mounting on frame		*	6 Nm
Anchor cable		*	3 – 4 Nm
Frame lock on the fork end		*	4.5 Nm
Switch handle handlebar clamp		*	1.5 – 2.5 Nm

### Special items

Screw – mudguard to frame bridge	*	*	5.5 Nm
Side stand	*	*	30 Nm
Screws – rear mudguard stays to frame	*	*	4 Nm
Screw – number plate holder to mudguard	*	*	2 Nm
Screw – light to number plate holder	*	*	2 Nm
Screw – luggage carrier stays to frame	*	*	5.5 Nm
Screw – front of luggage carrier to mudguard	*	*	3.5 – 4 Nm
Screw – rear of luggage carrier to mudguard	*	*	3.5 – 4 Nm
Screws – mudguard stays to fork	*	*	1,3 Nm
Screw – upper mudguard to fork	*	*	5 Nm
Screws – front light to stem	*	*	3 Nm

Component	ST3	ST5	Torque
Grip clamp (Ergon GS1-L) – handlebar stem unit/handlebar	*	*	5 Nm
Brake lever clamp right	*	*	5 – 7 Nm
Brake lever clamp left	*	*	2 Nm
Gear lever clamp (Shimano Alfine Di2) – handlebar stem unit		*	1.5 Nm
Gear lever clamp (Microshift) – handlebar	*		5 Nm
Stem clamp – handlebar	*		6 Nm
Stem clamp – fork tube (aluminium) Top/bottom screw		*	10 Nm/10 Nm
Stem clamp – fork tube (aluminium) Top/bottom screw	*		9 Nm/8 Nm
Headset top cap clamp – fork tube (handlebar stem unit)	*	*	3,5 Nm
Plastic cover on stem	*	*	0,5 Nm
SP gadget adapter	*	*	0,5 Nm
Saddle subframe clamp	*	*	13 – 15 Nm
Seat angle clamp	*	*	10 – 12 Nm
Seat post clamp	*	*	10 Nm
Front axle	*	*	20 Nm
Rear axle	*	*	20 Nm
Brake disc (6-hole, front hubs)	*	*	4 – 6 Nm
Brake disc (4-hole, rear hubs)	*	*	9 – 11 Nm
Inner bearing, FSA MegaExo	*	*	40 – 50 Nm
Foot pedal arm, FSA MegaExo	*	*	38 – 41 Nm
Pedals	*	*	40 Nm

Component	ST3	ST5	Torque
Rear derailleur	*	*	8 – 10 Nm
Battery box	*	*	0.5 Nm
Drinking bottle holder	*	*	3.5 Nm
Brake calliper	*	*	6 – 8 Nm
Brake pad pins	*	*	0.8 – 1.2 Nm
<b>Special items</b>			
Screw – mudguard to frame bridge	*	*	5.5 Nm
Side stand	*	*	30 Nm
Screw – mudguard adapter to rear bottom bracket	*	*	1 Nm
Screw – rear mudguard stays to frame	*	*	4 Nm
Screw – number plate holder to mudguard	*	*	2 Nm
Screw – light to number plate holder	*	*	2 Nm
Screw – baggage carrier stays to frame	*	*	5,5 Nm
Screw – front baggage carrier to mudguard	*	*	3.5 – 4 Nm
Screw – rear baggage carrier to mudguard	*	*	3.5 – 4 Nm
Screws – mudguard stays to fork	*	*	1,3 Nm
Screw – upper mudguard to fork	*	*	5 Nm
Screws – front light to stem (Supernova)		*	5 – 6 Nm
Screws – front light to stem (Roxim)	*		3 Nm

## General torque for bolted connections

### Steel screws in aluminum thread

M3	1.4 Nm
M4	2.0 Nm
M5	3.9 Nm
M6	6.7 Nm
M8	15.3 Nm
M10	31.5 Nm

### Steel screws in steel thread

M4	2.2 Nm
M5	4.3 Nm
M6	7.4 Nm
M8	17.0 Nm
M10	35.0 Nm

## WARRANTY, DEFECTS, WEAR

You were given the warranty and limitation of liability separately at the time of purchase of your S-pedelec. You can also consult them anytime at [www.stromerbike.com/support](http://www.stromerbike.com/support).

### Wear

Take note that the components of the S-pedelec are subject to higher wear than the components of a bicycle without an additional drive. This is due to the greater weight of the vehicle and the higher average speed that is achieved through the propulsion.

This higher wear is not a defect and is not subject to warranty.

Typical components affected are:

- Tires
- Drive components
- Brake pads
- Spokes

The battery is subject to aging and therefore a wearing part. Please take note that age and duration of use affect the battery, e.g. result in a clearly reduced driving range. This must be considered when planning trips. Exchange our battery in due time for a new one. Replacement batteries are available from your Stromer dealer.

## TECHNICAL DATA

Permitted total weight of Stromer S-Pedelec: 150 kg  
Vehicle including battery + driver + luggage + trailer  
Stromer ST5 and ST3 Weight: 29.2 kg

	ST5	ST3	ST2	ST1
<b>MOTOR</b>	SYNO Drive Sport*	SYNO Drive II*	Cyro Drive IG*	Cyro Drive II*
MOTOR SUPPORT	up to 45 km/h	up to 45 km/h	up to 45 km/h	up to 45 km/h
POWER	850 W	820 W	750 W	670 W
POWER USA	650 W	600 W	570 W	550 W
TORQUE	48 Nm	44 Nm	40 Nm	35 Nm
RANGE	up to 180 km	up to 180 km	up to 180 km	up to 180 km

\* Depending on the location of use, a driving permit and insurance/number plate may be required.  
The A-weighted emission sound pressure levels at the rider's ears is below 70 dB(A).

<b>CHARGERS</b>	CR245	CR246**
INPUT	100-240VAC ~ 50-60 Hz 3A	230-240VAC ~ 50-60 Hz 1,8A
OUTPUT	54.6VDC / 4.5A 11.2VDC / 1A	54.6VDC / 4.5A 12VDC / 0,75A
OPERATING TEMPERATURE RANGE [°C]	0...40°C	0...40°C

\*\* Only in the EU

**LI-ION BATTERIES**

	BQ500	BQ618	BQ814	BQ983 Model ST1306AC	BQ983 Model ST983
VOLTAGE [V]	48	47.45	48	48	47.06
CAPACITY [AH]	10.5	12.3	17.1	20.6	20.4
ENERGY [WH]	500	618	814	983	983
CHARGING TIME WITH CHARGER CR190 [H:MIN]	3:55	4:50	5:30	6:30	6:30
CHARGING TIME WITH CHARGER CR245 [H:MIN]	3:40	4:00	4:45	5:30	5:30
CHARGING TIME WITH CHARGER CR246 [H:MIN]	3:40	4:00	4:45	5:30	5:30
CHARGING TIME WITH CR65 CHARGER [H:MIN]	11:00	12:00	15:00	18:00	18:00
PERMITTED STORAGE TEMPERATURE RANGE [°C] SHELF LIFE: 1 MONTH	-20...60°C	-20...50°C	-20...60°C	-20...60°C	-20...50°C
PERMITTED DISCHARGING TEMPERATURE RANGE [°C]	-20...67°C	-20...70°C	-20...67°C	-20...67°C	-20...70°C
PERMITTED CHARGING TEMPERATURE RANGE [°C]	0...45°C	0...45°C	0...50°C	0...50°C	0...45°C
APPROXIMATE WEIGHT [KG]	3	4	5	5	5



If the charging time indicated is clearly exceeded, discontinue the charging process. Have the battery and the charger checked by the Stromer distributor.

## ENVIRONMENTAL TIPS

Take care to dispose of all packaging material according to the regulations and sorted by waste type.

### General care and cleaning products

Please take the environment into account when caring for and cleaning your S-pedelec. You should use care and cleaning products which are biodegradable wherever possible.

Please ensure that no cleaning fluid enters the drainage system. When cleaning the chain, use a suitable chain cleaning tool and dispose of chain lubricant properly at a suitable waste disposal site.

### Brake cleaner and lubricants

Take the same approach to using brake cleaner and lubricants as you do to general care and cleaning products.

### Tires and inner tubes

Tires and inner tubes are not residual waste or domestic rubbish and have to be disposed of at your local recycling center.

### S-pedelec batteries

Batteries belonging to S-pedelecs should be treated as hazardous and are therefore subject to compulsory special labeling. They have to be disposed of by Stromer dealers or manufacturers.

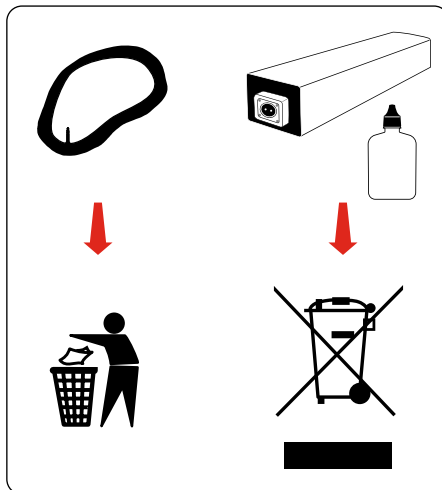

## LEGAL DISCLOSURE

myStromer AG  
Freiburgstrasse 798  
CH-3173 Oberwangen

### Europe:

info@stromerbike.com

### USA:

serviceusa@stromerbike.com

Responsible for distributing and marketing the operating instructions: inMotion mar.com  
Rosensteinstr. 22, D-70191 Stuttgart

info@inmotionmar.com, www.inmotionmar.com  
Content and images: Veidt Anleitungen, Friedrich-Ebert-Strasse 32, 65239 Hochheim, Germany  
Veidt-Anleitungen@email.de

Legal inspection by a lawyer's office specializing in intellectual property

These operating instructions cover the requirements and the scope of DIN EN ISO 4210 and DIN EN ISO 15194:2017-12.

In case of delivery and use outside of this scope, the manufacturer of the vehicle must supply the required manuals.

© Copying, reprinting and translation as well as any commercial use (including extracts, in printed or digital form) is only permitted if specifically granted in writing in advance.

Stromer ST1 ST2 ST3 ST5 Version 2.1 October 2022



Stromer FAQ

### **Stromer FAQ**

Do you have questions about maintenance, features or settings for your Stromer Speed Pedelec? Would you like some tips and tricks for looking after your Stromer and keeping it in perfect condition? Then you're in the right place.



Stromer OMNI App  
IOS

### **Stromer OMNI App**

With the Stromer OMNI app, you can find out at any time exactly how and when you used your Stromer. Detailed statistics will show you when and for how long you rode your Stromer. You can also adjust the behavior of your E-bike to your own needs, tune the support to you personally and keep track of the servicing. And thanks to the clever, integrated anti-theft protection, you can be worry-free while on the move. You can always check where your Stromer is and how it is doing. With the Stromer OMNI app, you and your Stromer will be inseparable. It's like riding a bike.



Stromer OMNI App  
Android

## SERVICE SCHEDULE

### 1st Inspection:

Work done:

---

---

---

---

Materials used:

---

---

---

---

Date: \_\_\_\_\_

Signature: \_\_\_\_\_

Retailer stamp

### 2nd Inspection:

Work done:

---

---

---

---

Materials used:

---

---

---

---

Date: \_\_\_\_\_

Signature: \_\_\_\_\_

Retailer stamp

### 3rd Inspection:

Work done:

---

---

---

---

Materials used:

---

---

---

---

Date: \_\_\_\_\_

Signature: \_\_\_\_\_

Retailer stamp



**4th Inspection:**

Work done:

---

---

---

---

Materials used:

---

---

---

---

Date: \_\_\_\_\_

Signature: \_\_\_\_\_

Retailer stamp

**5th Inspection:**

Work done:

---

---

---

---

Materials used:

---

---

---

---

Date: \_\_\_\_\_

Signature: \_\_\_\_\_

Retailer stamp

**6th Inspection:**

Work done:

---

---

---

---

Materials used:

---

---

---

---

Date: \_\_\_\_\_

Signature: \_\_\_\_\_

Retailer stamp

## SERVICE SCHEDULE

### 7th Inspection:

Work done:

---

---

---

---

Materials used:

---

---

---

---

Date: \_\_\_\_\_

Signature: \_\_\_\_\_

Retailer stamp

### 8th Inspection:

Work done:

---

---

---

---

Materials used:

---

---

---

---

Date: \_\_\_\_\_

Signature: \_\_\_\_\_

Retailer stamp

### 9th Inspection:

Work done:

---

---

---

---

Materials used:

---

---

---

---

Date: \_\_\_\_\_

Signature: \_\_\_\_\_

Retailer stamp

**10th Inspection:**

Work done:

---

---

---

---

Materials used:

---

---

---

---

Date: \_\_\_\_\_

Signature: \_\_\_\_\_

Retailer stamp

**11th Inspection:**

Work done:

---

---

---

---

Materials used:

---

---

---

---

Date: \_\_\_\_\_

Signature: \_\_\_\_\_

Retailer stamp

**12th Inspection:**

Work done:

---

---

---

---

Materials used:

---

---

---

---

Date: \_\_\_\_\_

Signature: \_\_\_\_\_

Retailer stamp

Version 2.1  
Artikel Nr. 403352

**myStromer AG**

Freiburgstrasse 798 | CH-3173 Oberwangen | Switzerland  
stromerbike.com | info@stromerbike.com

**+STROMER-**