

# USER MANUAL

**ST1 | ST2 | ST3 | ST5 | ST7**

English

**+STROMER-**

## STROMER SPEED-PEDELEC ST1 ST2 ST3 ST5 PARTS

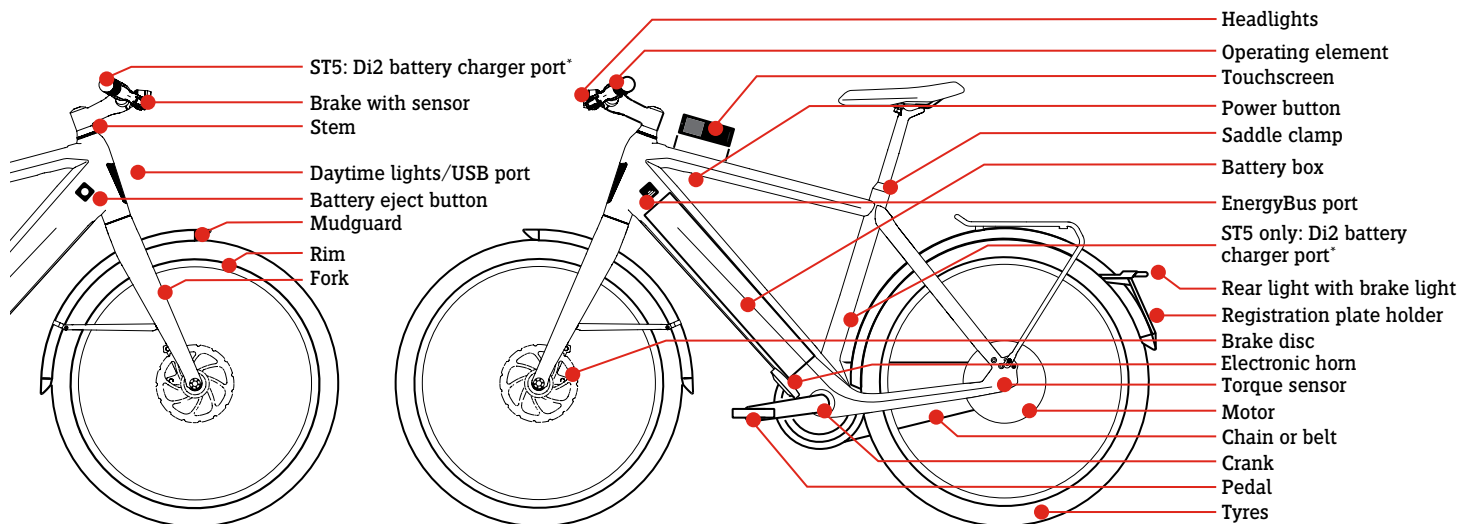

### Delivery contents

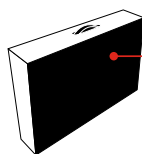

- Contents:**
- User manual
  - for the Stromer Speed-Pedelec
  - Battery charger
  - Smartphone holder (ST3, ST5)
  - Di2 charging cable (ST5)

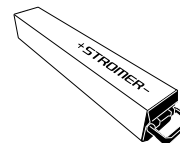
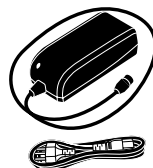

\* Position depends on version

**i** The speed-pedelec you have purchased may look different from the one shown in this manual. This guide describes speed-pedelecs. This user manual is part of the speed-pedelec delivery contents and only applies to the models ST1, ST2, ST3 and ST5.

## ST5 PINION PARTS

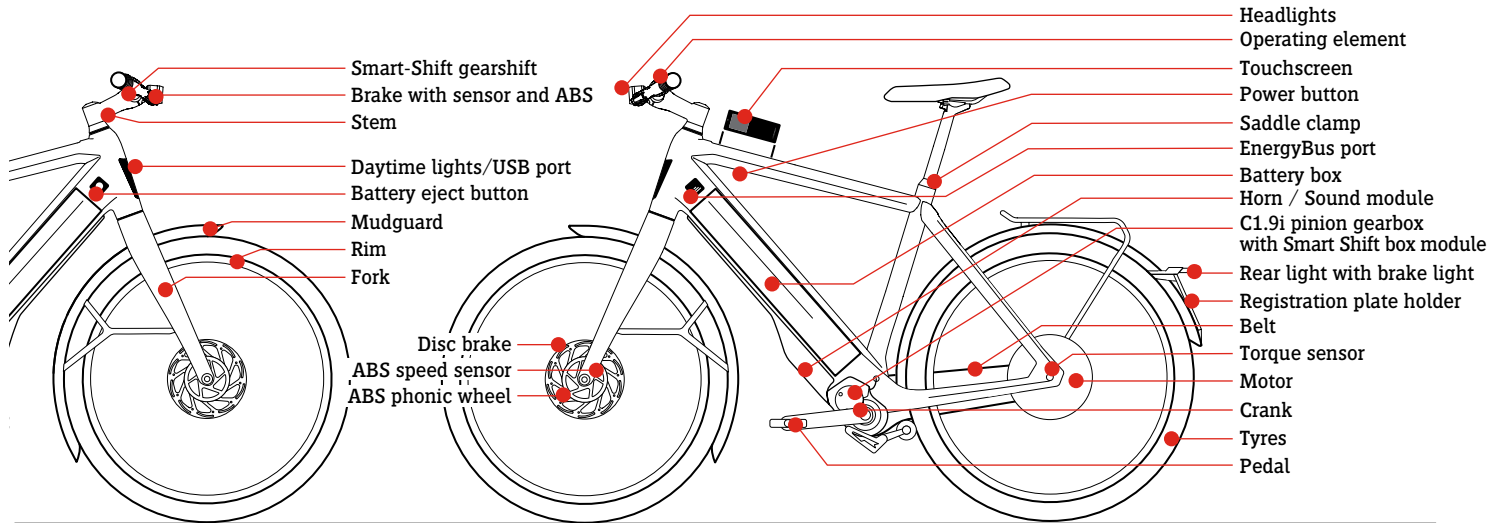

### Delivery contents

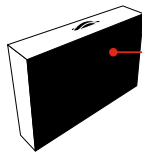

- Contents:**
- User manual for the Stromer Speed-Pedelec
  - Battery charger
  - Smartphone holder
  - Pedals
  - Sideview mirror

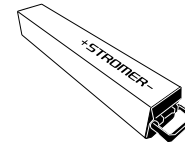
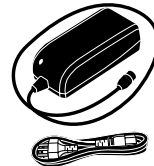

**i** The speed-pedelec you have purchased may look different from the one shown in this manual. This guide describes speed-pedelecs. This user manual is part of the speed-pedelec delivery contents and only applies to the ST5 Pinion model.

## STROMER SPEED-PEDELEC ST7 PARTS

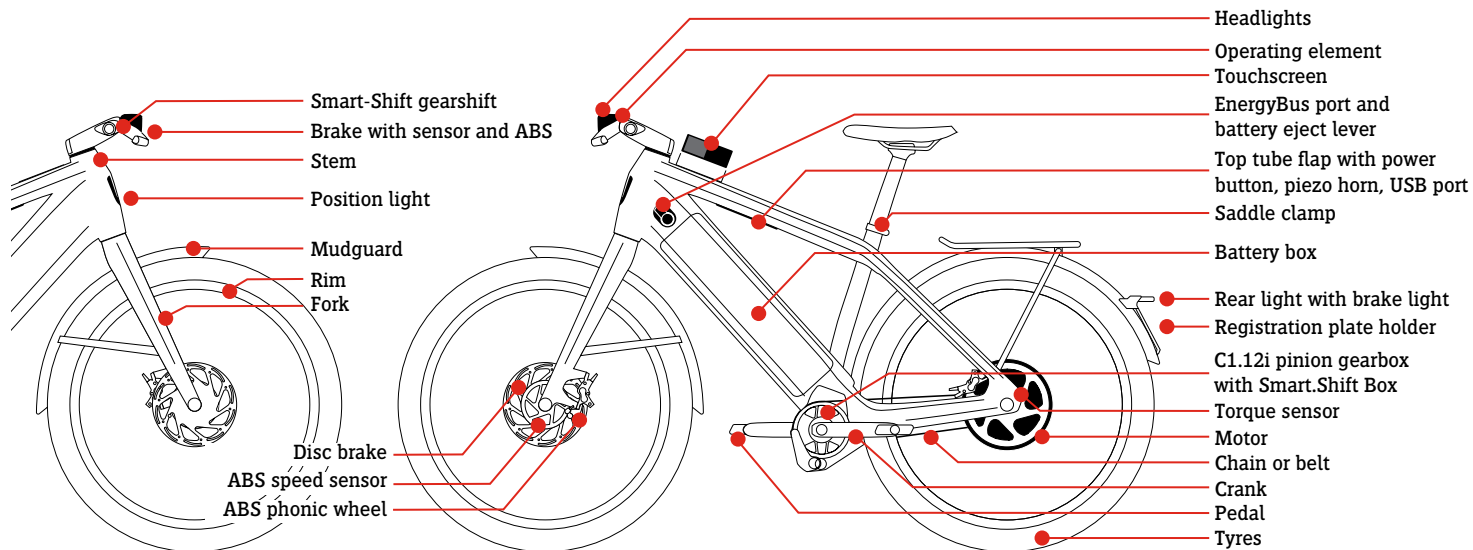

### Delivery contents

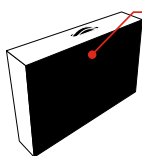

#### Contents:

- Pinion gearbox user manual
- Pinion Smart.Shift user manual
- Suspension Saddle Post user manual
- Wren Suspension Fork user manual
- Blubrake user manual
- Battery charger
- Smartphone holder
- Pedals
- Sideview mirror

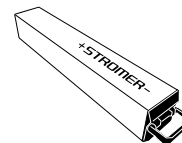
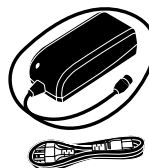

**i** The speed-pedelec you have purchased may look different from the one shown in this manual. This guide describes speed-pedelecs. This user manual is part of the delivery of your speed-pedelec.

## DEAR CUSTOMER

First of all, we would like to congratulate you on the purchase of your new Stromer. We would like to take this opportunity to share some important information about your new premium vehicle with you.

This will help you to get the most out of your new vehicle and avoid risks. Please read this user manual carefully and adhere to the instructions that it contains. Keep it in a safe place.

Your Stromer should arrive fully assembled and set up. If this isn't the case, please contact your Stromer dealer to take care of this important task. It is assumed that the user of this speed-pedelec has sufficient knowledge of how to operate bicycles. Anyone that

- uses
- repairs or services
- cleans
- or disposes

of this speed-pedelec must have read and fully understood the contents and meaning of this manual. If you have any further questions or have not quite understood certain points, you should contact a Stromer retailer for your own safety.

This manual contains information about the construction, technology, maintenance and servicing of this speed-pedelec. Please take note of this information, as much of it is relevant to safety. Failure to take this information into account can cause serious accidents and economic damages. As modern speed-pedelec technology is incredibly powerful, we have chosen to only describe the most important points.

Always refer to the information and instructions provided by part manufacturers for specific technical details. You can find them online at **[www.stromerbike.com/support](http://www.stromerbike.com/support)**

**i** Find out whether and which type of driver's licence you need before using the Stromer for the first time! Only use the speed-pedelec if you have the required driving licence.

**i** Make sure that you are familiar with your country's road traffic regulations and follow them accordingly.

Before riding your speed-pedelec on public roads, read up on the national regulations applicable in your specific country. The national regulations contain information on how your speed-pedelec must be equipped when operated on public roads and which driver's license is required to ride the Stromer.

Some of the information covered includes:

- Which light systems have to be installed or carried with you.
- How to properly apply the orange lateral reflector.
- Which brakes must the speed-pedelec be equipped with.
- Any age restrictions that apply to riding in specific areas.
- The restriction of children riding the speed-pedelec on public roads.
- Any obligation to wear a helmet.

## SAFETY INSTRUCTIONS

Please carefully read all warnings and advice in this user manual before using your pedelec and stick to them. We recommend keeping the manual close to your speed-pedelec so that it is always at hand.

**Before using your speed-pedelec for the first time, be sure to read the chapters “Before the First Ride” and “Before Every Ride”!**

If you lend your speed-pedelec to someone else, please give them this user manual too. In this manual you will find symbols that indicate that there is information that requires your particular attention. When you see these symbols, there is always a risk that the danger that they describe may occur! The area for which the respective warning applies is highlighted in red.

 **Note:** This symbol provides information about how to use the product or highlights specific parts of the user manual that are particularly important.

 **Warning:** This symbol warns of misuse which could result in damage to the product or the environment.

 **Danger:** This symbol indicates possible dangers to your health and life that could arise if specific actions or appropriate care is not taken.

 **Important bolt connection:** The precise torque must be applied here when tightening. The correct tightening torque is either indicated on the part or listed in the table of tightening torques on page 38. To apply a precise tightening torque, you must use a torque spanner. Leave this work to your Stromer dealer if you do not have a torque spanner or if the correct tightening torque is not specified! Parts that have not be tightened correctly can loosen or break! This can result in serious falls!

 **Modern speed-pedelecs are very high-tech!** Working on one requires expert knowledge, experience and specialist tools! Do not carry any work on your speed-pedelec yourself. Take your speed-pedelec to a specialist workshop if it is in need of repair, maintenance or servicing!

 Regularly check that all parts are intact and that all bolt connections are tight. Bolt connections must never be loose. Only check them with a torque spanner and the correct tightening torque. Leave this task to your Stromer dealer if you do not have a torque spanner or do not know the correct tightening torque.

 During use, servicing and maintenance the moving and turning parts of your Stromer may pose a hazard. Protect yourself by not wearing loose clothes that may get caught. During use, servicing and maintenance, stay away from any turning parts (wheels, brake discs, cogs) and do not touch any moving, sharp or protruding parts (cranks, pedals).

## CONTENTS

<b>Stromer Speed-Pedelec ST1 ST2 ST3 ST5 parts</b> _____	2	Switching off	19	<b>Battery</b> _____	26
<b>ST5 pinion parts</b> _____	3	Sleep mode	19	Battery sleep mode	26
<b>Stromer Speed-Pedelec ST7 parts</b> _____	4	<b>Operating element</b> _____	19	Removing and inserting the battery	26
<b>Dear Customer</b> _____	5	Assistance levels	20	Battery eject button on the Stromer ST7	26
<b>Safety instructions</b> _____	6	Light	20	<b>Safety information regarding the charger</b> _____	27
<b>Stromer quick start guide</b> _____	8	<b>Gear-shifting system</b> _____	20	<b>Charging the battery</b> _____	27
<b>For your safety</b> _____	11	Grip shifter	20	Charging the battery externally, outside of the speed-pedelec	28
<b>Information about electrical and electronic systems</b> _____	12	Gear lever / shift button	21	Charging the battery internally while installed in the speed-pedelec	28
<b>Lighting system</b> _____	12	Pinion Smart.Shift	21	Charge status display	29
<b>Note for parents and legal guardians</b> _____	13	<b>Braking mode / Recuperation</b> _____	21	<b>Service / Maintenance</b> _____	30
<b>Before the first ride</b> _____	13	<b>Electronic horn</b> _____	22	Chain / Belt	31
<b>Before every ride</b> _____	16	<b>Stromer Sound</b> _____	22	Rims/Tyres	32
If you have a fall _____	16	<b>Touchscreen / Display</b> _____	22	Repairing a flat tyre	32
<b>Legal requirements</b> _____	16	Touchscreen	22	Brakes	32
<b>Intended use</b> _____	17	Driving display	22	Gear-shifting system	33
Permitted parts _____	17	Gear indicator - Pinion Smart.Shift	22	Ban on speed-pedelec tuning	34
<b>Child transportation and trailers</b> _____	18	<b>Anti-theft protection</b> _____	22	Luggage and load transport	34
Child transportation	18	<b>Stromer OMNI App</b> _____	22	Lighting system	35
Cargo and child trailers	18	<b>USB charging port</b> _____	23	Anti-lock braking system (ABS) with lift-off control on the rear axle	35
Attaching a trailer	19	Stromer ST3/ST5	23	Inspection schedule	35
<b>Switching your Stromer on and off</b> _____	19	Stromer ST7	23	Lubrication	37
Power button	19	<b>Range</b> _____	23	Bolted connections	38
Switching on	19	<b>Anti-lock braking system (ABS) with lift-off control on the rear axle</b> _____	23	<b>Warranty</b> _____	38
		<b>Menu and settings</b> _____	24	<b>Warranty, defects, wear and tear</b> _____	38
		Shortcut and driving mode display	24	Wear and tear	38
		Settings in the menu	24	<b>Technical specifications</b> _____	39
				<b>Environmental tips</b> _____	40
				<b>Legal notice</b> _____	40

## STROMER QUICK START GUIDE

**i** This is a quick guide aimed at experienced speed-pedelec riders. Even if you already have experience with speed-pedelecs, you must read the entire original user manual to ensure safe operation!

Detailed additional information on the various functions and settings can be found on the Stromer app or online at

[www.stromerbike.com/support](http://www.stromerbike.com/support)

**1) Before using the speed-pedelec for the first time, fully charge the battery, either while it is installed or not.**

a) To charge externally:

Removing the battery

**!** The battery is heavy. Do not drop it. You could injure yourself and/or the battery could be damaged. Battery damage caused by an impact will void the warranty and guarantee.

**i** The battery can only be unlocked when stationary.

Removing the battery (Stromer ST1/ST2/ST3/ST5)

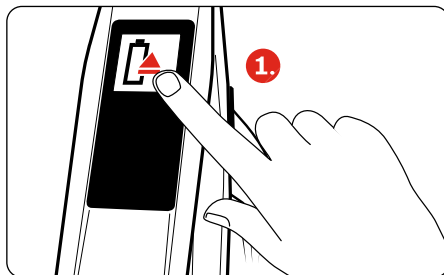

Tap the "Eject Battery" icon

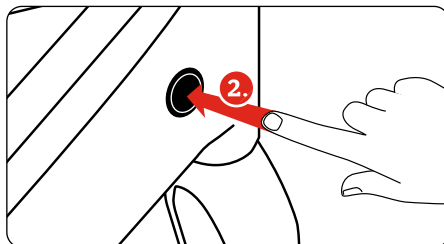

Press the eject battery button

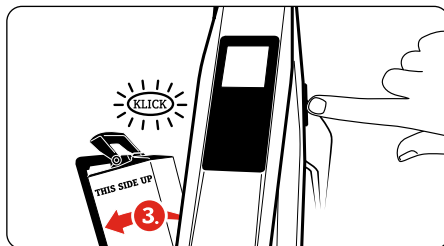

The battery compartment will swing open

**!** The battery compartment swings open dynamically. The battery is very heavy! Secure the battery compartment cover by hand when opening it.

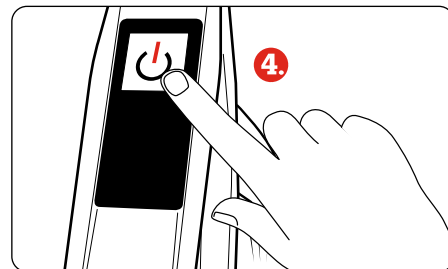

Tap the "Off" button and hold until the display is no longer lit up.

Pull out the battery.

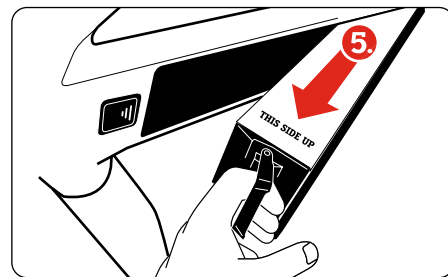



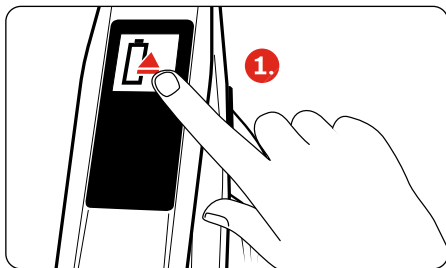

## Removing the battery (Stromer ST7)

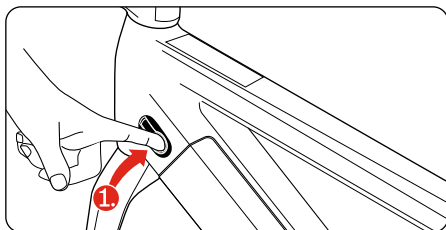

Tap on the "Eject Battery" icon



Pull the battery eject button out.

 **The battery compartment swings open dynamically. The battery is very heavy! Secure the battery compartment cover by hand when opening it.**

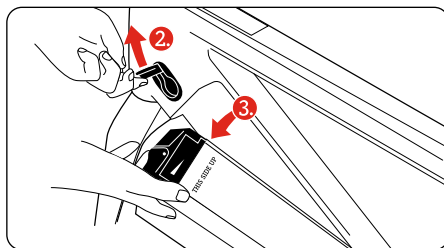

Open the battery eject button beyond the first stop/resistance. You can now pull out the battery. The battery is very heavy, do not drop it. You might hurt yourself or damage the battery.

## Charging the battery externally

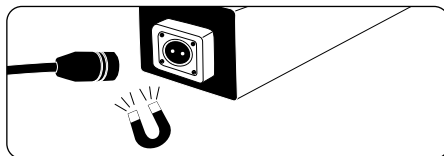

 **Only charge the Stromer battery with a suitable Stromer charger.**

## Inserting the battery

Place the battery in the battery box. Make sure that the plug is pointing downwards and that the **THIS SIDE UP** lettering is visible at the top. Push the battery down until it clicks into place.

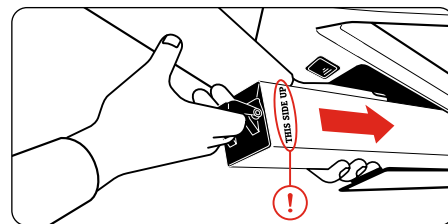

Close the battery box. Press on the cover with the palm of your hand until it snaps into place with a quiet click.

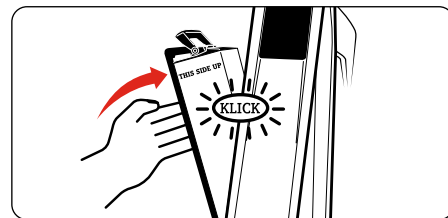

 **The "THIS SIDE UP" lettering must be visible on the top side.**

## b) Charging the battery when installed

 Only charge the Stromer battery with a suitable Stromer charger.

Stromer ST1/ST2/ST3/ST5:



Open the charging port flap

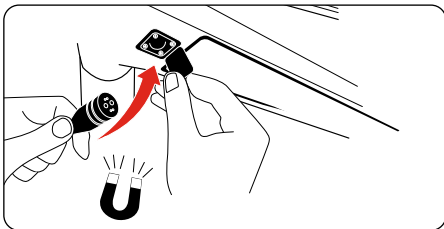

Stromer ST7:

The port for the charging cable is located in the battery eject button. It becomes visible when the battery eject button is open.

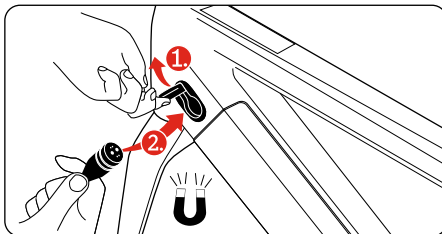

Open the battery eject button until you reach the first stop/resistance. The port will now be freely available.

 If you open the button beyond the first stop/resistance, the battery compartment will swing open dynamically.

Charge the battery fully before using the speed-pedelec for the first time.

### 2) Switch on the electrical system

The power button is located on the underside of the top tube below the touchscreen.

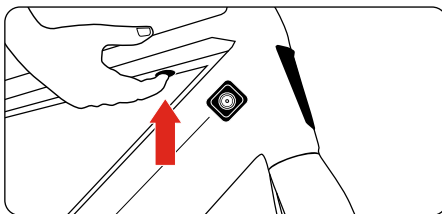

 For your safety, the Stromer's motor only starts to run when you have reached a minimum speed. However, always keep one brake applied before you put your first foot on the pedal. The quick acceleration can take some getting used to. Starting off uncontrollably in traffic or on loose surfaces can lead to a fall or serious injury. Practice using and riding your Stromer in a quiet and safe place before using it on public roads with traffic.

 Never use the speed-pedelec without the battery inserted. The battery compartment cannot be locked if the battery is not inserted. The battery compartment may then open unexpectedly. This can result in a risk of falls and injuries.

 The Stromer can also be ridden like a normal bike without motor assistance.

The level of motor assistance depends on the force applied to the pedals. The harder you pedal, the more support will be provided by the motor. If you stop pedalling during the ride, the motor will stop assisting you. The motor assistance only reactivates when you start pedalling again.

## Operating element

Important functions of the Stromer can be controlled while riding and without you having to take your hands off the handlebar by using the operating element on the handlebars.

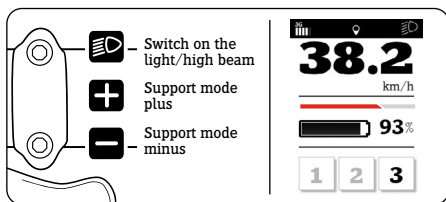

Basic settings Driving mode

Touch screen display

## 3) Switch the electrical system off after finishing your ride

1. Press the power button to access the shortcut display.
2. Select **OFF** while you are in the shortcut display.

## Sleep mode



Switching off

Touchscreen display

If you do not switch off your Stromer, it will go into sleep mode after around 5 minutes of inactivity. The sensors remain active while in sleep mode. The system wakes up automatically when you move your Stromer.

## FOR YOUR SAFETY

Before riding on public roads, read up on the applicable national regulations in your country.

In many countries, you need a driving licence to ride a speed-pedelec. Check the legal situation in the respective country before using your speed-pedelec.

This user manual assumes that you know how to ride a bicycle. It will not teach you how to ride a speed-pedelec. It will also not teach you how to assemble or repair the speed-pedelec or how to carry out assembly and repair work on your Stromer.

Be aware that there are always dangers and risks involved with using speed-pedelecs, especially to riders themselves. Always be aware that you are not as protected as you would be in a car, for example. You have no airbag and no car body. Nevertheless, with a speed-pedelec you are travelling faster and on different areas of the road than a pedestrian or many cyclists without a correspondingly powerful auxiliary drive. Pay particular attention to other road users.

First, however, a few pointers that the person using the speed-pedelec should consider before starting a ride:

- Always wear a fitted and suitable bicycle helmet and use it every time you ride.
- Read the instructions supplied by your helmet manufacturer to ensure that your helmet fits properly.



- Any time you ride, always wear bright clothing or sports clothes with reflective elements (e.g. a reflective vest). This is vital to ensure that other road users can see you.
- Tight clothing is mandatory; use trouser clips if necessary. Your shoes should be slip-resistant and have hard soles.
- Never cycle with your hands off the handlebars!
- Never ride with headphones in and never use your phone while riding your speed-pedelec.
- Never cycle if you are unable to control your speed-pedelec completely. It must be in road-worthy condition at all times. Under no circumstances should you ride your speed-pedelec if you have taken medicine or are under the influence of alcohol or drugs.
- In wet or slippery conditions, adapt your riding style accordingly. You should cycle slower and brake more carefully and gradually, as the braking distance is significantly longer.

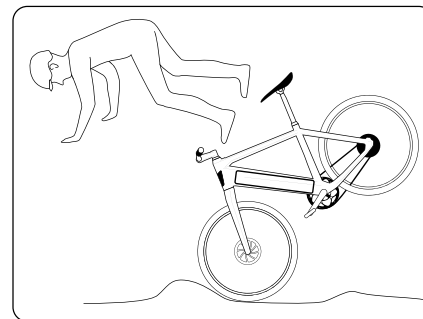



- Ride at an appropriate speed for the terrain and your riding capabilities.

Please note that as a speed-pedelec rider, you are particularly at risk on public roads. Ensure that you protect yourself and others by riding your speed-pedelec responsibly and safely!

 **Keep in mind that you are travelling much faster on a speed-pedelec than you would be on a bicycle without an electric drive. Other road users may misjudge your speed. Only use your speed-pedelec for the intended use. Important information on this can be found in the section "Intended use". If you are unsure about the intended use and the limits of the intended use of the speed-pedelec, ask your Stromer dealer.**

## INFORMATION ABOUT ELECTRICAL AND ELECTRONIC SYSTEMS

 Information about the operation, maintenance and care of electric and electronic systems as well as technical data can be found in this user manual, under: **[www.stromerbike.com/support](http://www.stromerbike.com/support)** and on the websites of the respective part manufacturers.

 **The electrical system of your speed-pedelec is very powerful. For a correct and safe operation, you must have your Stromer maintained regularly by a specialist retailer. They will check the current software status and make sure that any important updates for safety and driving comfort are installed.**

 **Switch off the electrical system and remove the battery immediately when you notice damage to the electrical system, particularly when live parts are exposed after a fall or an accident. Please always contact your Stromer dealer for repairs, if you have a question or problem, or if you discover a defect. A lack of technical knowledge can result in severe accidents and damage!**

 **Always remove the battery before doing any kind of work on the electrical system of your speed-pedelec. Make sure that the charger is not connected.**

 **If your Stromer speed-pedelec does not move off even though there is no error message displayed, check that both brake levers are in the starting position! If a brake lever is actuated, then no motor power will be transmitted!**

## LIGHTING SYSTEM

The Stromer lighting system is equipped with state-of-the-art LED technology. If the daytime lights are activated, it will light up as soon as the Stromer is switched on (see Daytime lights [www.stromerbike.com/support](http://www.stromerbike.com/support)). Daytime lights are not legally authorised in some countries and so cannot be activated there. **Find out what the legal situation is in your country with regards to the lights and adhere to it!**

 We recommend that you always activate the daytime lights, **when permitted in the country you are riding in**. This makes you more visible to other road users and increases your safety on the road.

 **Well-functioning lighting is a matter of life or death! Have them installed, checked and repaired by your Stromer dealer.**

Speed-pedelecs used on public roads must be equipped with a dynamo, a battery for a constant battery light or with a rechargeable power storage device as a power source for the front and rear lights. The Stromer's lighting system is powered by the battery or, if it is empty, by the motor with dynamo function.

## NOTE FOR PARENTS AND LEGAL GUARDIANS

As your child's legal guardian, you are responsible for their actions and safety. This includes taking care of the speed-pedelec's technical condition and adjusting it to the rider.

You must also ensure that the child has learnt how to use the speed-pedelec safely and that all legal and country-specific requirements have been met, e.g. that the legally prescribed minimum age has been reached and that the child has the relevant driving licence, if necessary.

They should know how to ride the speed-pedelec properly and responsibly in the environment in which it will be used.

**i** Do not let children ride the speed-pedelec unattended without first thoroughly instructing them on how to use it! Explain the dangers of using electrical devices to the children.

## BEFORE THE FIRST RIDE

Please carefully read all warnings and advice in this user manual and always adhere to them before using the speed-pedelec.

Please consult the user manuals of the individual part manufacturers, which were supplied with your speed-pedelec or which can be found online.

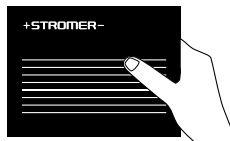

Your Stromer retailer will be happy to answer any further questions you have after reading the documentation. Before the first ride, the speed-pedelec must be ready for use and adjusted to the rider. This means:

- Checking the position and attachment of the saddle and handlebars
- Installing and adjusting the brakes
- Fastening the wheels securely onto the frame and the fork

To ensure that you enjoy a safe and comfortable riding position, please allow your Stromer dealer to set up your handlebars and stem.

- Adjust the saddle to a safe and comfortable position for you (see page 14).
- Have your Stromer retailer set up the brake levers so they are always within easy reach.
- Ensure that you know which lever operates which brake. Usually, the right brake lever operates the rear wheel brake and the left brake lever operates the front wheel brake.

**i** Familiarise yourself with your new speed-pedelec in a safe area.

**⚡** Modern braking systems may be more powerful or have a different braking effect to that on other bicycles that you have used in the past. Practice operating the brakes in a safe area without traffic before you use your speed-pedelec for the first time!

Also remember that the effectiveness of brakes can be dangerously different in wet conditions or when riding on slippery surfaces. Adapt the way you cycle to slippery surfaces and braking distances which may be longer.

**⚡** If rubber or plastic pedal covers have been put on your speed-pedelec, familiarise yourself with how they grip. When wet, rubber and plastic pedals are very slippery.

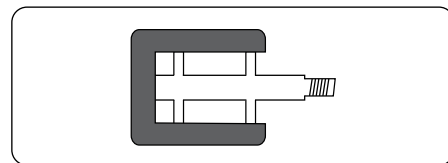

The wheels must be securely fastened to the frame and fork. Check that the thru axles and all important nuts and bolts are secure (see section "Bolt connections"). Have your Stromer dealer carry out regular inspections to ensure that all bolt connections are tight.

If it rattles or makes another unusual noise while you are using your speed-pedelec, ask a Stromer dealer to identify and fix the problem before you continue using it.

Try to roll the speed-pedelec forwards while applying the brakes. The rear brake, when operated, must allow the rear wheel to lock, the front brake must lift the rear wheel off the ground. The pedelec's steering should not rattle or exhibit any play.

Check the air pressure in the tyres. You will find information as to the correct tyre pressure on a label in the battery box and on the sides of the tyres. Please adhere to the stated minimum and maximum pressure!

If you cannot find the recommended pressure values, 3 bar/43.5 PSI is a suitable pressure for most tyres.

Tip: As a general rule of thumb when you are out on a ride, you can check the tyre pressure by doing the following: If you place your thumb on a pumped-up tyre, you should not be able to significantly change its shape when you apply pressure. Check the tyres and rims. Look for any damage, tears and deformations, foreign objects, such as glass splinters or sharp-edged stones, etc.

Never ride your speed-pedelec if you notice any cuts, tears or holes in your tyres. First have it checked over in a specialist workshop.

You must also check the following parts of your speed-pedelec:

- The battery box must be securely closed when the battery is inserted.
- Make sure that the battery is sufficiently charged for the planned ride.
- Familiarise yourself with the various functions of the operating element.
- Activate the anti-lock braking system (ABS) if available.



**Do not set off if your speed-pedelec is not in perfect condition or if you are unsure as to whether it is in perfect condition or not. Have it checked by a Stromer dealer before your next journey.**



**Always apply the brakes before placing a foot on the pedal! The motor starts working as soon as you start pedalling. The thrust from the motor can take some getting used to and can lead to falls, hazards or accidents if used on public roads.**

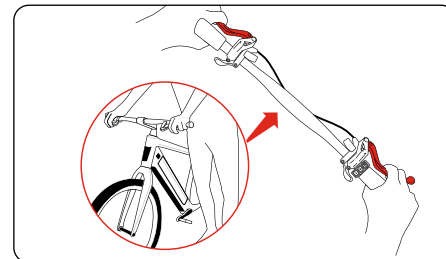

### Handlebar position/adjusting the stem



Please note that not every stem is suitable for every steer tube! Only use Stromer stems. Only allow Stromer dealers to work on your handlebars and stem.

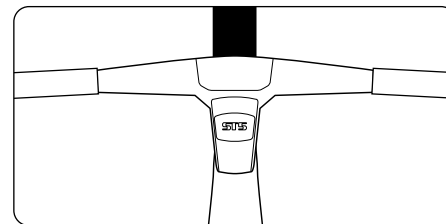

Specially designed Stromer stem.

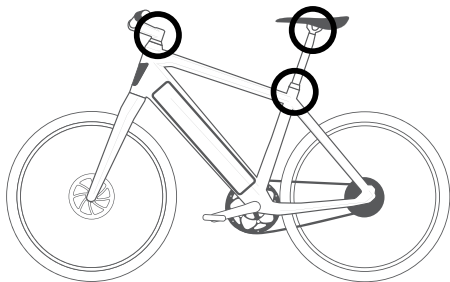



Positions of bolt connections for adjusting the sitting position

### Installing the pedals

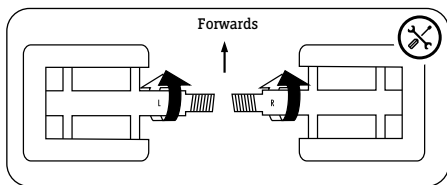
If your speed-pedelec was supplied without the pedals pre-installed, these have to be attached with the correct spanner. Please note that the pedals have to be screwed in in different directions and secured with a high tightening torque (see page 34). Coat the threads of both pedals with assembly grease.





 Ensure that you have read the manufacturer's instructions before using click-in pedals. Practice clipping your shoes in and out of the pedals' locking system before your first ride in a quiet, safe place. Any trouble releasing from click-in pedals is a safety risk.

 With system pedals, you can adjust how much force you need to release the shoe from the pedal. Please test this on your first ride with a setting that releases very easily! Clean your system pedals regularly and keep them in good condition with a suitable spray lubricant.

### Adjusting the sitting position

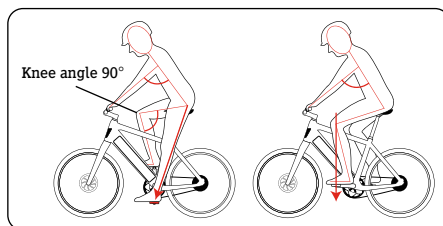
Before using your pedelec for the first time, you must adjust the sitting position to suit your height. This will allow you to ride your bike safely. The height, horizontal orientation and inclination of the saddle and the height and orientation of the stem for the handlebars must be adjusted.



 Never pull the saddle post out further than the maximum mark on the frame tube! If there is no maximum mark, the saddle post should always be at least 7.5 cm deep in the tube frame.

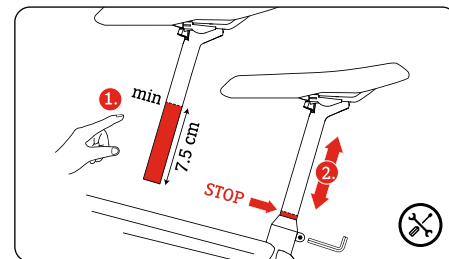

### Adjusting the saddle tilt

Once you have adjusted the saddle height, you must check and adjust the inclination as well. The surface of the saddle should always be level. You can carry out this adjustment when the saddle post clamps are open.

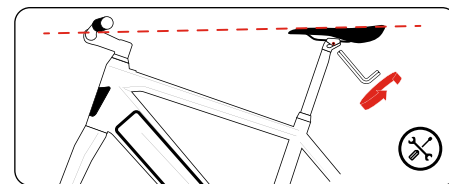

## BEFORE EVERY RIDE

Before every ride, please check that:

- The bell / horn, all electrical connectors and all lighting is working properly and is properly secured
- The brakes and anti-lock braking system (ABS) (if available) are working and are properly secured
- The battery box is securely closed when the battery is inserted
- The lines and connections are properly sealed and not leaking
- The tyres and rims are free of foreign objects, are not damaged and turn smoothly, particularly after riding off-road
- The tyres have a sufficient tread depth
- The suspension elements are working and safely secured
- All bolts, nuts and thru axles are secure (see section “bolt connections”), even if the speed-pedelec was only left unattended for a short period of time
- There is no deformation or damage to the frame or fork.
- The handlebars, stem, saddle post and saddle are correctly and securely fastened and in the right position
- The saddle post and saddle are secure. Try turning the saddle or tipping it up and down. The saddle should not move
- If you are using click-in or system pedals, please check that they are working properly. The pedals should release easily and smoothly



**Do not use your speed-pedelec if you think it may not be in perfect condition. Have it checked by a Stromer dealer.**

**If you use your speed-pedelec a lot, either for sports or daily use, you should have all the important parts checked regularly by a Stromer dealer. The frame and fork, suspension components and other parts relevant to your safety such as the brakes and wheels are subject to heavy wear, which can impact their operational safety.**

**A part may begin to malfunction unexpectedly if you use it beyond its service life. This can result in falls and serious injuries.**



Please also carry out these checks before riding after an accident or if your speed-pedelec falls over. Bent or damaged aluminium parts cannot be safely bent back into shape, and carbon components can sustain damage which is not visible to the eye.

### If you have a fall

Check the entire speed-pedelec for any damage. This may be dents and cracks in the frame and fork but also bent parts. In addition, if any parts such as the handlebars or saddle have shifted or twisted you need to ensure that these parts are working and secured.

If you notice any changes to your speed-pedelec, DO NOT continue to use it. Do not screw any loose parts back on without checking them first. Only use a torque spanner to retighten loose bolt connections and always adhere to the correct tightening torque. Take your speed-pedelec to a Stromer dealer. Tell them about the fall and have them check over the speed-pedelec!

## LEGAL REQUIREMENTS



The rules and regulations for e-bikes are constantly being revised and changed. Stay informed about the legislation that is applicable to you in order to remain up-to-date.

For pedelecs and speed-pedelecs, special provisions apply to the limits of use. This means that they are sometimes operated like a bicycle and other times not.

Before using your Stromer on public roads, read up on the current legal requirements in force in your country.

You can either get this information from your Stromer dealer or find it on the websites of national bike or e-bike associations.

You can find out how your Stromer must be equipped in order for it to be used on public roads. The legal requirements will also describe which lighting systems must be installed and what sort of brakes the speed-pedelec must be equipped with.



By reading the national legislation, you can also obtain information about the current age restrictions for using the speed-pedelec, what age riders have to be to ride the pedelec in different places and which driver's licenses are required. The regulations for children riding on public roads can also be found here. If helmets are compulsory, this will also be indicated

**i** Third-party liability insurance for speed-pedelecs is mandatory in many countries. This will cover possible damage that may occur when using the speed-pedelec. Always take out an adequate insurance policy.

## INTENDED USE

**⚡** Speed-pedelecs are means of transport designed to be ridden by one person. The transportation of children in trailers with speed-pedelecs is not permitted under EU law!

The transportation of an additional person with a speed-pedelec, e.g. a child trailer, is only permitted within the framework of the respective national legislation. Even if this is permitted in individual cases, we strongly advise against transporting additional people.

If you would like to transport baggage, your speed-pedelec must be fitted with suitable equipment. Children may not be transported on speed-

pedelecs under EU law. In Switzerland, they may only be transported with trailers specially designed for this purpose. Pay attention to the quality of the trailer you choose here! Always observe the permissible total weight and the specified maximum speed of the trailer.

**i** The permissible total weight of Stromer speed-pedelecs is 150 kg.

Permissible total weight:

Weight of the rider + weight of the speed-pedelec incl. weight of the battery + weight of the baggage + weight of the trailer (if the trailer is permitted)

Weight of the Stromer incl. battery:

ST1: 31.8 kg / ST2 ST3 ST5: 32.8 kg / ST7: 37.0 kg.

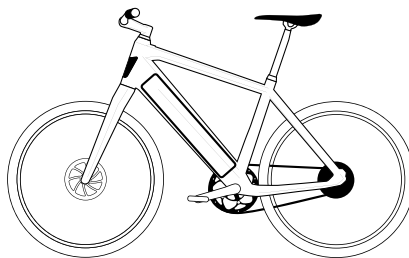

Stromer speed-pedelecs may be used on public roads and paved roads if they are properly equipped in accordance with national regulations. The manufacturer and dealer cannot be held liable for damages resulting from any use that is outside the scope of intended use. This particu-

larly applies to damage resulting from a failure to comply with the safety instructions, such as:

- Use on terrain
- Overloading
- An improper repair of defects

Stromer speed-pedelecs are not designed for extreme loads, such as riding up and down stairs, tricks or jumps.

**⚡** **Dangers of improper use**

Only use your Stromer for its intended use.

The intended use also includes adherence to the operating, servicing and maintenance conditions described in this manual.

You must also inform anyone else using the speed-pedelec of the intended use and the dangers of not adhering to it.

Improper use, overloading and lack of maintenance can lead to accidents and falls resulting in serious injuries to you and other people!

## Permitted parts

During the approval process, certain parts are authorised for use on this speed-pedelec. In other words, the speed-pedelec is only authorised for use if it has these parts or replacement parts which have been approved for use with your specific model.

If parts are replaced by the user, only original parts or replacements which are approved for use on the speed-pedelec can be used, otherwise the user must seek individual permission from the local regulatory authority.

Attachment parts that may only be replaced by identical parts or parts that have been approved:

- |                 |                               |
|-----------------|-------------------------------|
| 1. Frame        | 9. Front light                |
| 2. Fork         | 10. Rear light                |
| 3. Motor unit   | 11. Registration plate holder |
| 4. Battery      | 12. Side stand                |
| 5. Tyres        | 13. Handlebars                |
| 6. Rim          | 14. Stem                      |
| 7. Brake system | 15. Saddle post               |
| 8. Pedals       |                               |

Only use attachment parts that satisfy the requirements of the applicable legal guidelines and road traffic regulations.

Using unauthorised accessories can cause accidents. You should therefore only use original accessories and attachment parts that fit your speed-pedelec.

## CHILD TRANSPORTATION AND TRAILERS

### Child transportation

 Stromer speed-pedelecs must not be used with child seats!

 **Do not let children ride the speed-pedelec unattended without first thoroughly instructing them on how to use it! Explain the dangers of using electrical devices to the children. If children want to ride the speed-pedelec themselves, find out whether the child is of the required age and has the necessary driving licence, if necessary!**

 Always find out about the applicable national regulations for the use of child trailers. In many countries, the use of child trailers with speed-pedelecs is prohibited.

#### Legal situation in Switzerland

The use of trailers is permitted under certain conditions and subject to certain restrictions (VRV [Swiss Road Traffic Regulations] Art. 68 Para. 1 in conjunction with Art. 68 Para. 7).

A maximum of two children may be transported in protected seats in a trailer (VRV Art. 63 Para. 3 (d)). Children may be carried in a trailer on speed-pedelecs with pedal assistance of more than 25 km/h. You cannot use a child seat and a child trailer at the same time. (VRV Art. 63 Para. 3 (d)) In Switzerland, helmets are not compulsory for any children travelling with you. However, we recommend always putting a helmet on the children in the trailer and fastening them with the trailer's belt system.

#### Helmet requirement for children under EU law

Helmets are not usually compulsory for any children travelling with you. However, we strongly recommend always putting a helmet on any children in the trailer and fastening them with the trailer's belt system.

### Cargo and child trailers

 Always read up on the applicable national regulations for the use of child trailers and cargo trailers. These regulations may affect the maximum authorised speed and the maximum authorised total weight!

Only use trailers that are expressly approved for use with speed-pedelecs with your Stromer.

Please note that the driving behaviour of the Stromer changes when a trailer is attached. Some trailers tend to tip over in tight bends. Drive carefully and adapt your speed and driving style according.

Some trailers are only approved by their manufacturers for use on bicycles or pedelecs (pedal assistance up to 25 km/h). These types of trailers must not be attached to your Stromer speed-pedelec. Always follow the instructions provided by the respective manufacturer.

**i** Always stay informed about the applicable national traffic regulations in your country.

## Attaching a trailer

**i** Always have your trailer and its coupling fitted by a Stromer dealer.

The installation of the following trailer systems has been tested on the Stromer:

Thule ezHitch, Webber-E and Burley couplings can be fitted to the optional Stromer trailer plate kit. Before purchasing additional coupling systems, ask your Stromer dealer whether they are suitable for safe operation.

## SWITCHING YOUR STROMER ON AND OFF

### Power button

The power button is located on the underside of the top tube below the touchscreen.

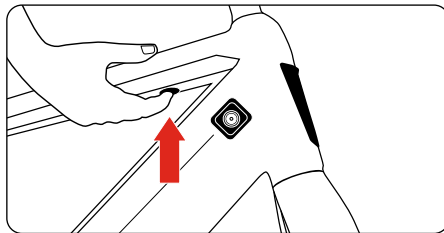

The power button has the following functions:

- Wake up from sleep mode Switch on
- Switch from shortcut display to driving display
- Switch from driving display to shortcut display
- Switch from any point in the menu to the shortcut display

### Switching on

To switch on your Stromer, press the power button.

**i** If your Stromer has been locked with a PIN, you must unlock the Stromer after switching it on so that you can use it (see chapter Anti-theft protection).

### Switching off

1. Press the power button to access the shortcut display.
2. Select **OFF** while you are in the shortcut display.

### Sleep mode

If you do not switch off your Stromer, it will go into sleep mode after around 5 minutes of inactivity. The sensors remain active while in sleep mode. The system wakes up automatically when you move your Stromer.

You can also wake up the Stromer using the power button.

**i** Always switch off the Stromer via the touchscreen if you want to prevent it from switching itself on.

## OPERATING ELEMENT

Important functions of the Stromer can be controlled while riding and without you having to take your hands off the handlebar by using the operating element on the handlebars.

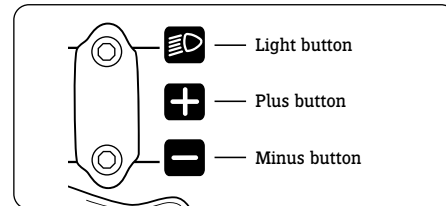

## Assistance levels

You can switch between the following assistance modes by pressing the + and - buttons on the control element on the handlebars.

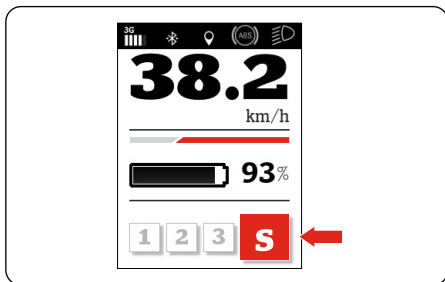

**Cycle mode:** The motor is switched off.

**Support mode 1:** Low motor support optimised for long distances.

**Support mode 2:** Medium motor support - you can fine-tune this support mode via the Stromer app.

**Support mode 3:** High motor support for maximum speed.

**Support mode S (only for ST5 Pinion and ST7 models):** Very high motor assistance for maximum short-term support.

The level of motor assistance depends on the force applied to the pedals. The harder you pedal, the more support will be provided by the motor. If you stop pedalling during the ride, the motor will stop assisting you. The motor assistance only reactivates when you start pedalling again.

## Light

Daytime lights are integrated in your Stromer for your safety in everyday traffic.

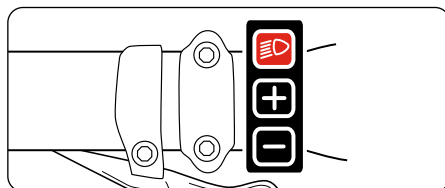

Your Stromer is equipped with a lighting system that provides dipped beam lights. The Stromer models ST2, ST3, ST5 and ST7 are also equipped with full beam lights. To switch between dipped beam and full beam, press the light button on the control element on the handlebars. Just like with cars, a brake light is integrated into the rear light. In some countries, the daytime lights cannot be switched off.

## GEAR-SHIFTING SYSTEM

With the gear-shifting system, you can regulate the necessary power input and achievable speed. Using lower gears makes cycling uphill easier and reduces physical exertion when pedalling. Riding in higher gears requires more physical exertion to pedal, allowing you to reach higher speeds with a lower pedalling rate. As a general rule, you should aim to ride with a higher pedalling rate and in lower gears.

If your gears ever fail to shift cleanly, avoid riding any further if possible. Take your Stromer back to the dealer for a check-up.



Gears are parts that are vital to your safety. Read the manufacturer's operating instructions and familiarise yourself with the operation of your speed-pedelec's gears before riding. Information can also be found at <https://pinion.eu>.



The belts and pulleys are optimally coordinated to each other. Do not change the transmission ratio. The warranty and guarantee only apply to the original parts.

## Grip shifter

To change gear, turn the movable part of the handle forwards or backwards.

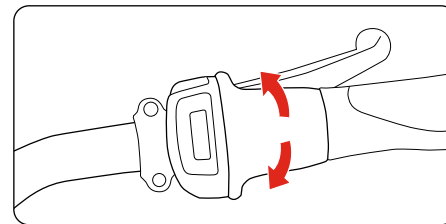

When you change gear, you should briefly take your weight off the pedals.

More detailed information on the gears can be found here:

<http://service.pinion.eu/de/support/home>

## Gear lever / shift button

To change gear, press the lever/button until you feel them engage. One lever/button is used to shift into higher gears. The other lever/button is used to shift into lower gears.

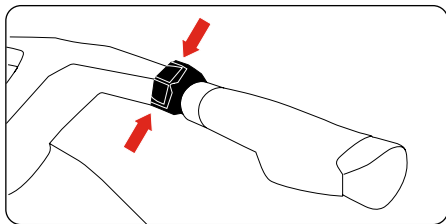

## Pinion Smart.Shift

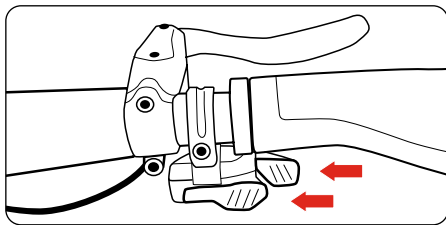

If your speed-pedelec is equipped with the Pinion Smart.Shift system, it is operated via the Smart.Shift automatic gearshift (hereinafter referred to as the “trigger”). The Pinion trigger is an electronic system powered by the speed-pedelec battery.

To change gear, press one of the gear levers. To shift up a gear, press the shorter front lever once. To shift down a gear, press the longer rear lever once. Press several times to change several gears in succession. Shifting while pedalling is possible, but not if the load is too high.

More detailed information can be found in the instructions included in the delivery:

Trigger: Pinion Smart.Shift User Manual

Gearbox: Pinion C or P-Line User Manual  
or on the website: [pinion.eu/smartshift](http://pinion.eu/smartshift)

 You can freely adjust the gear lever assignment. Please read the chapter “Setting the trigger”.

 **Have all installation and repair work on the Smart.Shift gearbox and Smart.Shift box carried out by an authorised specialist workshop.**

## BRAKING MODE / RECUPERATION

Stromer speed-pedelecs can use their motors to generate energy and to charge the battery when travelling on a downward slope, for example. Here, the motor acts like a dynamo, slowing you down and generating electricity to recharge the battery. This allows you to significantly extend the possible range of a ride. The recuperation system can also be used as a “motor brake” on steep or long inclines.

When you brake, the motor switches to recuperation/braking mode and assists you when braking. The braking energy is stored in your battery and can be used to increase the range of your speed-pedelec.

The Stromer has a braking aid for longer descents.

## Switching on the brake assist / recuperation

Press and hold the minus operating button for 2 seconds.

## Setting the recuperation levels

You can adjust the braking force of your Stromer by briefly pressing the plus or minus button again. The weak recuperation level brakes less and is therefore suitable for flat inclines, while the strong recuperation levels have a significantly higher braking effect. It is a convenient and inconspicuous way to optimise the range of your speed-pedelec.

## Switching off the recuperation

Press and hold the + or - button again for 2 seconds.

The recuperation ends automatically when the speed falls below a certain minimum level and you start pedalling. This speed differs depending on the version of the firmware installed. The minimum speed is usually less than 10 km/h.

## ELECTRONIC HORN

Your Stromer is equipped with an electronic horn. The control button is located on the left handlebar. Only use the horn to call attention to yourself in potentially dangerous situations.

## STROMER SOUND

Your Stromer ST5 Pinion is equipped with an integrated loudspeaker (4 Ohm). An acoustic signal should sound when you switch your Stromer on and off and when your battery reaches a charge level of 100%.

## TOUCHSCREEN / DISPLAY

### Touchscreen

The Stromer's display is equipped with a resistive touchscreen.

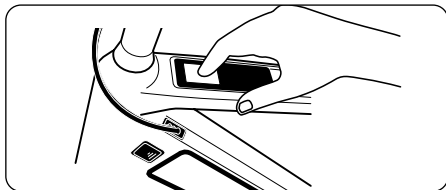

This means that the touchscreen does not react to touch like capacitive touchscreens, but to light finger pressure and can therefore also be operated with gloves. You can navigate through the various menus and change the driving display by lightly pressing the touchscreen.

## Driving display

As soon as you set off, the touchscreen switches to the driving display.

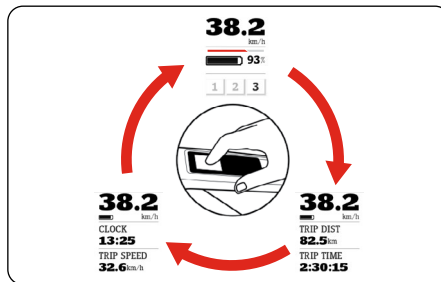

The driving display shows you your speed and information about your journey. You can switch from one driving display to the next by pressing the touchscreen and thus see the information that you want.

## Gear indicator - Pinion Smart. Shift

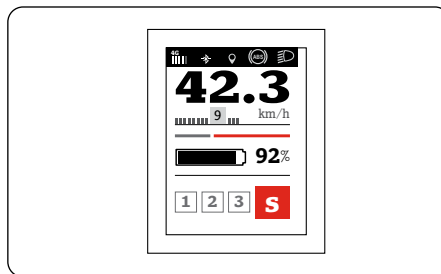

The Pinion gearbox has 9 or 12 gears. The driving mode display shows you which gear is currently engaged.

## ANTI-THEFT PROTECTION

### Activating the lock

The Stromer has optimum anti-theft protection. You can lock your Stromer with a PIN when you switch it off. The Stromer can then only be switched on when you enter your PIN again.

1. Press the power button to access the shortcut display.
2. Select the shortcut display **LOCK**.

If the locked Stromer is moved, the anti-theft mode is activated.

If your Stromer has not been switched off or locked, but is not used for a longer period of time, it will switch itself off. However, the lock will not be activated in this case.

### Deactivating the lock

To deactivate the lock, proceed as follows:

1. Press the power button.
2. Then enter your PIN on the touchscreen.

## STROMER OMNI APP

Connected on the go: All Stromer bikes are equipped with the cloud-based OMNI connect platform

You can access OMNI connect directly via the touchscreen of your Stromer or via the OMNI app on your smartphone.

<https://www.stromerbike.com/en/swiss-technology#Connectivity>

## USB CHARGING PORT

Is your phone out of battery? No problem. Your speed-pedelec may be equipped with a USB charging port. Plug in your smartphone to re-charge it.

### Stromer ST3/ST5

The charging port is located at the front of the daytime light and is covered with a rubber lip.

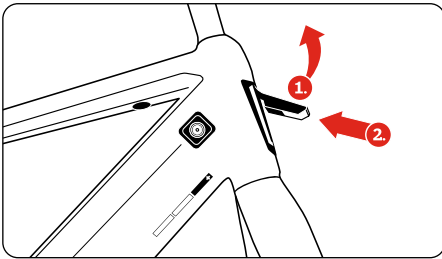

### Stromer ST7

The USB charging port is located in the top tube on the underside (next to the power button).

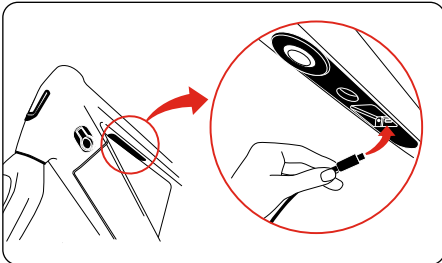

Only plug in your smartphone when you are not moving. Do not charge your smartphone while riding.

## RANGE

The achievable range per battery charge depends on various different factors:

- **Assistance level:** The higher the assistance mode used, the lower the range.
- **Riding style:** You can save energy by shifting gears at the right time. In lower gears you have to use less force, less assistance is provided and your speed-pedelec drive consumes less energy.
- **Ambient temperature:** Batteries discharge more quickly in cold outside temperatures.
- **Weather conditions and vehicle weight:** In addition to the ambient temperature, wind can also have an impact on the range of your speed-pedelec. Strong headwinds may mean you have to use more force when riding. Luggage etc. can increase the weight, meaning that more force is needed too.
- **Technical condition of your pedelec:** Under-inflated tyres increase rolling resistance. Grind-iron brakes also reduce the range.
- **Battery capacity:** The battery capacity indicates how much energy can be stored. As the capacity of a battery decreases with age, the amount of energy that can be stored on a full charge also decreases.

- **Road surface quality** and track profile: Riding on rough road surfaces or gravel reduces the range. You can travel much further on flat terrain than when cycling uphill.

## ANTI-LOCK BRAKING SYSTEM (ABS) WITH LIFT-OFF CONTROL ON THE REAR AXLE



The company myStromer cannot be held liable for any damage resulting from the unreasonable, unforeseeable and/or improper use of the anti-lock braking system (ABS)

- How you use your speed-pedelec should always be adapted to the overall situation, including the surrounding traffic and your riding skills.
- The anti-lock braking system (ABS) actively influences the braking function of your speed-pedelec. Please bear in mind that, in certain situations, your braking distance may be longer than usual.



There are limits to the performance of your anti-lock braking system (ABS)!

- In extreme riding conditions, such as hard braking on a slippery surface, setting off on steep ascents or when panicking, your might not be able to steer your speed-pedelec as you expected. Whenever possible, always try to avoid late and hard braking because you were relying too much on your anti-lock braking system (ABS).

As an additional optional safety measure, your speed-pedelec may also have an anti-lock braking system (ABS) on the front axle with lift-off control on the rear axle. This set-up allows for controlled braking on slippery surfaces and should prevent you from falling over the handlebars of the bicycle in the event of a hard brake. The anti-lock braking system is fully integrated into your speed-pedelec and may only be differentiated using the ABS control light on your OMNI display.

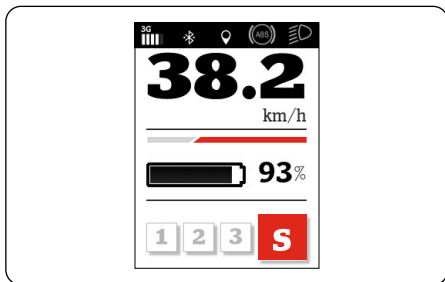

Before starting up and using the anti-lock braking system (ABS) for the first time, please familiarise

yourself with the operating instructions provided by the manufacturer Blubrake, which can be found at [www.stromerbike.com/support](http://www.stromerbike.com/support) and on their website.

Before the ride:

The anti-lock braking system must be initialized before each use. You can do this by carefully activating the front wheel brake at a speed of at least 5 km/h after the speed-pedelec has been turned on/woken up/unlocked. The orange ABS control light on the OMNI display should no longer light up after this process. Do not start your ride until you have successfully initialised the system.

During the ride:

If the ABS control light appears while you are riding your speed-pedelec, this means there is a problem with the system or that it is malfunctioning. Restart your speed-pedelec and carry out the initialisation again. If the light does not disappear, do not continue to use your speed-pedelec if possible. Have the speed-pedelec checked by your Stromer dealer.

 **If the control light still does not disappear, consult a Stromer specialist dealer immediately.**

As long as the brakes have no mechanical defects, the speed-pedelec can still brake without the anti-lock braking system (ABS).

## MENU AND SETTINGS

### Shortcut and driving mode display

Pressing the power button takes you to the shortcut display. From here, you can directly access all functions and settings:

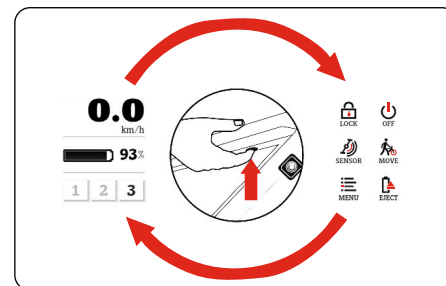

Press the power button again to return to the driving mode display.

### Settings in the menu

#### Time

You can set the time and its display format individually.

1. Press the power button to go to the shortcut display.
2. While in the shortcut display, select **MENU** then **SETTINGS**.
3. In the **TIME** section, you can select the desired display format and set the time.



## Language

Stromer supports the following languages: German, English, French, Italian and Dutch.

1. Press the power button to go to the shortcut display.
2. While in the shortcut display, select **MENU** then **SYSTEM**.
3. In the **LANGUAGE** section, you can set the desired language.

## Units (km/miles)

Stromer supports both metric (km; km/h; Wh/km) and imperial (Mi; mph; Wh/Mi) units of measurement.

1. Press the power button to go to the shortcut display.
2. While in the shortcut display, select **MENU** then **SYSTEM**.
3. You can set the desired unit of measurement in the **UNITS** section.

 More detailed information on the individual settings can be found in the corresponding sub-chapters or online at [www.stromerbike.com](http://www.stromerbike.com).

 The functionality of the settings described may change after software updates. You can find a description of the current functions online at [www.stromerbike.com](http://www.stromerbike.com).

 The menu can only be accessed when your Stromer is stationary. As soon as you start driving, the touchscreen switches to the driving display. For your safety, you cannot call up the menu while driving.

## Braking mode

With the braking mode, you can adjust the strength of the Stromer's motor brake to suit your riding style.

1. Press the power button to go to the shortcut display.
2. While in the shortcut display, select **MENU** then **BIKE**.
3. In the **BRAKE MOD.** section, you can set the strength of the braking mode.

## Torque sensor

You can adapt the response behaviour of the Stromer to your driving style. You can use the sensor sensitivity to control the ratio between rider power and motor assistance.

1. Press the power button to go to the shortcut display.
2. While in the shortcut display, select **MENU** then **BIKE**.
3. You can set the sensor sensitivity in the **TORQUE SENS.** section.

Greater sensitivity means that your Stromer will react to even the slightest pressure on the pedals.

 Changing the sensor sensitivity impacts the response behaviour of the Stromer in all support levels. Using a higher sensitivity setting will reduce the range of your Stromer.

## Setting the PIN

1. Press the power button to go to the shortcut display.
2. While in the shortcut display, select **MENU** and then **SETTINGS**.
3. You can set a new PIN in the **PIN** section. Your first PIN is generated at random and sent by SMS to your registered phone number and by email to your registered email address when you activate your Stromer.

 If your Stromer has been locked with a PIN, you must unlock the Stromer after switching it on so that you can use it (see "Anti-Theft protection").

## Trigger adjustment – Pinion Smart.Shift

The assignment of the gear levers is freely selectable.

1. Press the power button to go to the shortcut display.
2. While in the shortcut display, select **MENU**, then **BIKE** and then **SMART.SHIFT**.
3. You can set the assignment of the gear levers in the **TRIGGER** section.

**Standard:** The front gear lever shifts up.  
The rear gear lever shifts down.  
**Inverse:** The front gear lever shifts down.  
The rear gear lever shifts up.

### Setting the gear for starting off – Pinion Smart.shift

When starting off after a standstill, the ST7 automatically shifts to gear 4.

You can set the gear yourself in the settings.

1. Press the power button to go to the shortcut display.
2. While in the shortcut display, select **MENU**, then **BIKE** and then **SMART.SHIFT**.
3. You can set the gear in the **START.SELECT** section.

Switch the automatic gear for starting on or off: "ON/OFF":

Change gear with "+/-".

Save the setting with "OK".

 **The drive system and the battery are subjected to greater stress when you set off in a high gear. It is better to select a low gear as the starting gear.**

### Setting the Stromer Sound system

In the menu of the Stromer display you can switch Stromer Sound on or off and also adjust the volume of the acoustic signals.

1. Press the power button to go to the shortcut display.
2. While in the shortcut display, select **MENU** and then **SETTINGS**.

3. You can set the volume in the **SOUND** section. Press + or – to set the volume or set it to 0 or switch it off.  
Save your settings by pressing "OK".

## BATTERY

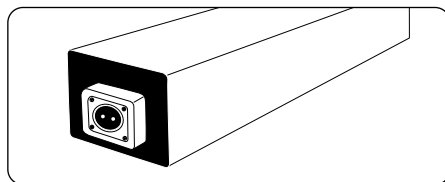

Read and follow the instructions on the supplementary sheet: Stromer battery safety information

Remove the battery from your Stromer before transportation and transport it separately.

 You can buy battery bags made of non-flammable material from your Stromer dealer. They protect the battery during transport, storage and external battery charging.

## Battery sleep mode

The BQ1440 battery goes into a protective sleep mode depending on the charge level and idle time.

Sleep mode starts after:

- 7 days if the charge level is < 10 % or
- 90 days if the charge level is < 80 %

Sleep mode can only be switched off when you connect the device to the charger.

## Removing and inserting the battery

Read the "Quick start" chapter.

## Battery eject button on the Stromer ST7

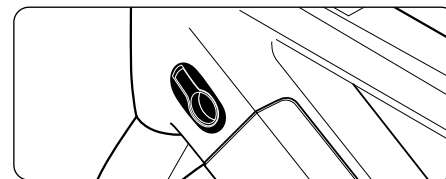

The battery eject button is located on the left side of the down tube, slightly below where it connects to the head tube. The battery eject button can be pulled out in two steps with a finger.

If you open the button to the first stop/resistance, the charging port will be exposed. If you pull the button out past the first stop/resistance, the battery will pop out.

## SAFETY INFORMATION REGARDING THE CHARGER

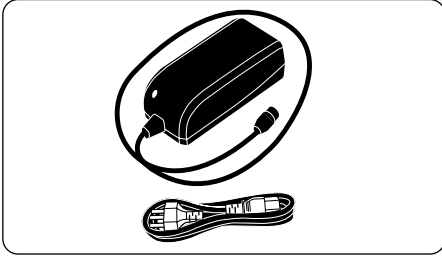

**i** Read the instructions on the charger before you start charging the battery.

You can charge the battery of your Stromer while it is inserted or you can remove the battery and charge it at a different location. Especially in cold weather, it is better to charge it in a warmer environment (room temperature) as this reduces the charging time.

- Avoid charging at temperatures below 0 °C and above 30 °C and in enclosed spaces. The charging process stops automatically at temperatures below 0 °C or above 30 °C.
- If there is a sudden change in temperature from cold to warm, condensation may form on the battery. This can cause the battery to short circuit.

- Only use the supplied cable or a charging device approved by us to charge your speed-pedelec, otherwise there is a risk of fire.
- Only use the charger in dry areas and do not cover it during operation. Otherwise it could short circuit or cause a fire.
- Observe the mains voltage when connecting the charger! The voltage of the power source must match the specifications on the charger's rating plate.
- Always remove the plug from the socket before cleaning the charger.
- Disconnect the charger from the power supply when charging is complete.

**⚡** For safety reasons, the charger must be placed on a dry and non-flammable surface.

**⚡** A defective battery must not be charged or used. A battery can become warm when charging. However, it should not become hot. If the battery becomes very hot while charging, stop the charging immediately.

**⚡** Never use your Stromer without the battery inserted. The battery compartment cannot be locked if the battery is not inserted. This can result in a risk of falls and injuries.

## CHARGING THE BATTERY

**i** Always read the instructions on the charger first.

**i** The battery is fitted with a practical magnetic connection. The magnets will help you to position the plug correctly. Hold the charging cable loosely in your hands and slowly move it near the battery socket.

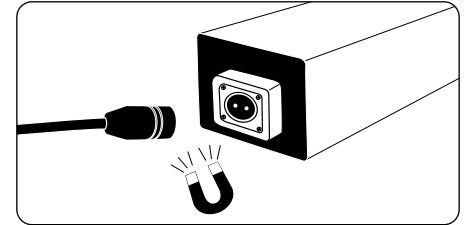

## Charging the battery externally, outside of the speed-pedelec

### CR245 charger

1. Connect the charger to the mains. The integrated LEDs will light up red and green.
2. Now connect the Stromer charger to the battery. The LEDs in the charger will light up in orange and green during the charging process. If the LEDs flash red, the charging temperature is above the authorised range. Stop the charging process immediately and disconnect the charger and battery from the mains. If the error occurs again, have the battery and charger checked by your Stromer dealer. When the battery is fully charged, the LEDs will light up green.
3. Disconnect the battery from the charger and then the charger from the mains plug.

### CR246 charger

1. Connect the charger to the mains.
2. Now connect the Stromer charger to the battery. The LED in the charger flashes green during the charging process. If the LED flashes red, the charging temperature is above the authorised range. If the LED lights up in red, there was an error during the charging process. Stop the charging process immediately and disconnect the charger and battery from the mains. If the error occurs again, have the battery and charger checked by your Stromer dealer. When the battery is fully charged, the LED lights up green.

3. Disconnect the battery from the charger and then the charger from the mains plug.

## Charging the battery internally while installed in the speed-pedelec

The port for the charging cable is located on the left side of the down tube, slightly below where it connects to the head tube.

### Charging port Stromer ST1/ST2/ST3/ST5

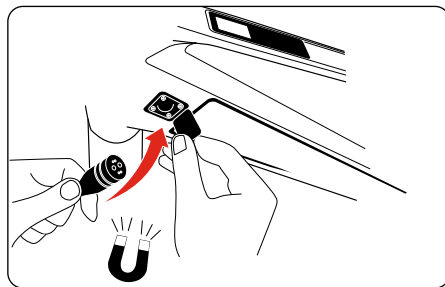
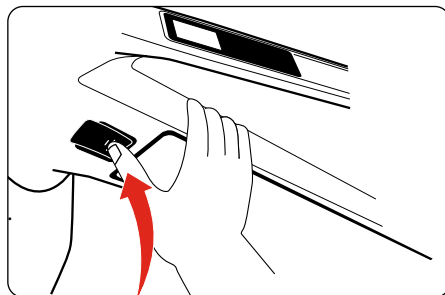

## Charging port (battery eject button) Stromer ST7

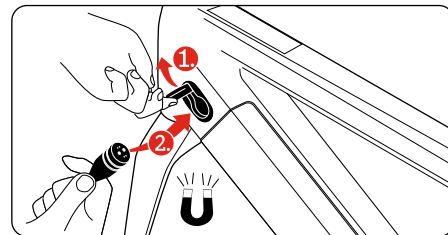

### CR245 charger

1. Connect the charger to the mains. The integrated LEDs will light up red and green.
2. Open the cover of the charging port or the battery eject button as far as the first stop/resistance.
3. Connect the Stromer charger to the Stromer. The LEDs in the charger will light up in orange and green during the charging process. If the LEDs flash red, the charging temperature is above the authorised range. Stop the charging process immediately and disconnect the charger and battery from the mains. If the error occurs again, have the battery and charger checked by your Stromer dealer. When the battery is fully charged, the LEDs will light up green.
4. Disconnect the battery/Stromer from the charger and then the charger from the mains.

### CR246 charger

1. Connect the charger to the mains.
2. Open the cover of the charging port or the battery eject button as far as the first stop/resistance.
3. Connect the Stromer charger to the Stromer. The LED in the charger flashes green during the charging process. If the LED flashes red, the charging temperature is above the authorised range. If the LED lights up in red, there was an error during the charging process. Stop the charging process immediately and disconnect the charger and battery from the mains. If the error occurs again, have the battery and charger checked by your Stromer dealer. When the battery is fully charged, the LED lights up green.
4. Disconnect the battery/Stromer from the charger and then the charger from the mains.

### Charging time

The charging time may vary depending on the design and model of the battery and charger. For more precise information about charging times, please refer to the information available at [www.stromerbike.com/service](http://www.stromerbike.com/service) or the supplementary sheet: Stromer battery safety information

 If the specified charging time is significantly exceeded, stop the charging. Have the battery and charger checked by your Stromer dealer.

### Charge status display

You can see the battery charge level of your Stromer in the driving display. The battery charge level is displayed in the form of a bar and in per cent. If the battery is empty, your Stromer will automatically switch off the motor and switches to bike mode (no assistance).

The bar above the battery charge level shows the current energy flow. This display will help you to ride in an energy-efficient way with a long range. The longer the bar, the greater the energy flow.

As soon as the motor starts providing assistance, the bar (red in the following illustration) points from right to left.



In braking mode, the battery is charged and the bar (red in the following illustration) points from left to right.

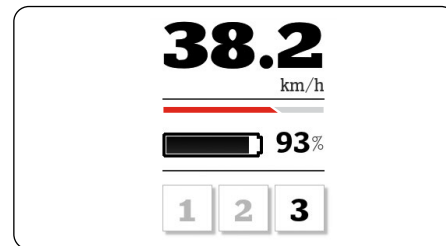

For your safety, a small amount of battery energy is saved so that the basic functions of your Stromer can be maintained. The lights and display will continue to work for around an hour when the battery is empty and the motor assistance stops.

### Display on the BQ1440 battery

The BQ1440 battery has small LEDs that act as a charge status indicator.

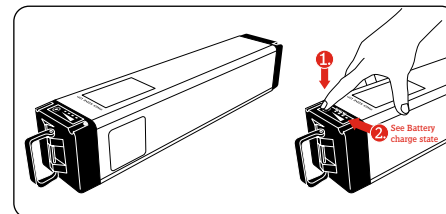

Press the "ON/OFF" button on the battery. The LEDs will light up and indicate the current charge status.

## SERVICE / MAINTENANCE

Always have any installation and maintenance work carried out by a Stromer dealer. You should only carry out work yourself if it is described here in the manual, e.g. adjusting the saddle position. All bolts must be tightened to the correct torque.

**i** Have your speed-pedelec checked by a specialist dealer on a regular basis. Specialist dealers can identify damage and worn components and can advise you on the choice of a replacement. They will also check the current software status and ensure that important updates for safety and driving comfort are installed.

Do not repair any safety-relevant parts (frame, fork, handlebars, stem, headset, brakes, lights) yourself.

**i** Your speed-pedelec can only function safely and effectively if you replace parts with suitable and authorised spare parts. Please consult your manufacturer, importer or Stromer dealer for advice on suitable spare parts.

**i** Only replace broken or worn safety-relevant parts with original spare parts from the manufacturer or parts approved by your manufacturer. This is mandatory for some parts. You can find a list of these parts in the "Authorised parts" section.

Replacing broken or worn safety-relevant parts with non-original or non-approved parts invalidates the speed-pedelec authorisation. In the case of other parts, the manufacturer's warranty and guarantees are usually invalidated if non-approved spare parts are used.

**⚡** If you install non-original or incorrect spare parts, this can result in a severe loss of function! Tyres with poor grip or that have not been designed for use on speed-pedelecs, brake pads with insufficient friction and incorrectly installed or poorly made lightweight parts can all cause accidents with serious consequences. The same applies for improper installation!

**⚡** When working on the pedelec, please ensure that all bolts and screws are tightened to the correct torque. This information is printed on many parts. Measurements are given in Newton metres (Nm) and should be applied with a torque spanner. The best sort of torque spanner for this is one that clicks when it reaches the prescribed torque. If you do not own a torque spanner then you should always leave this work to your Stromer dealer! Bolts can snap or break. A table listing the most important torques for bolted connections is provided in the section "Bolted connections".

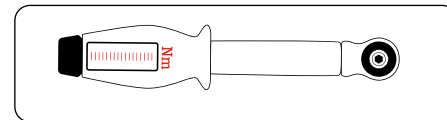

Torque spanner

**!** Have all installation and repair work on the Smart.Shift gearbox and Smart.Shift box carried out by an authorised specialist workshop.

- Open live parts should only be maintained and cleaned by your Stromer dealer!
- Before cleaning your speed-pedelec, remove the battery if possible. Make sure that the battery box is completely closed again.
- Make sure that you do not touch or accidentally connect contacts when cleaning the battery. You are at risk of injuring yourself or damaging the battery if these are live.
- Cleaning with a high-pressure device may result in damage to the electrical system. The high pressure can cause cleaning fluid to seep into sealed parts and damage them.
- Only clean your S-Pedelec if the electronic components, e.g. battery box or charging port, are fully assembled, closed and plugged in.
- Avoid damaging cables and electrical parts. If this does happen, the speed-pedelec must not be used until a Stromer dealer has examined it!

 Always switch off the electrical system before carrying out any work on your speed-pedelec. Remove the battery and close the battery box again.

## Chain/ Belt

### Chain drive

The drive chain must be cleaned and lubricated regularly to ensure proper functioning (see section "Inspection intervals and work"). Dirt can be removed from the chain when washing the rest of the speed-pedelec. Otherwise you can clean the chain by rubbing it with an oily cloth. The cleaned joints can then be oiled with a suitable lubricant. The excess lubricant should be wiped off after being left on the chain for a short amount of time.

### Chain tension

To ensure that the chain and gears work safely, the chain has to have a certain level of tension. Otherwise it may jump off the gears and lead to a fall. Derailleur gear systems tension the chain automatically.

 Dirt and permanent strain can wear the chain. The chain should be replaced as soon as it can be significantly lifted (approx. 5 mm) from the front chain ring with your fingers.

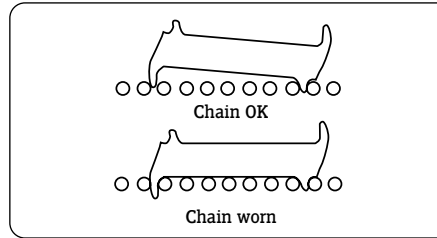

Some modern chains for derailleur gear systems no longer have chain joints. Specialised tools are needed to open/change/close them. This work should be carried out by a Stromer dealer. Other chains are supplied/assembled with chain joints. In some cases, these can be opened without tools. These chain joints can also be used to repair a damaged chain on a ride if they have the correct width for the drivetrain.

### Belt drive

If your Stromer is equipped with a belt drive (Carbon Belt Drive from Gates), the automatic tensioning pulley eliminates the need for frequently checking and re-tensioning of the belt and is virtually maintenance-free.

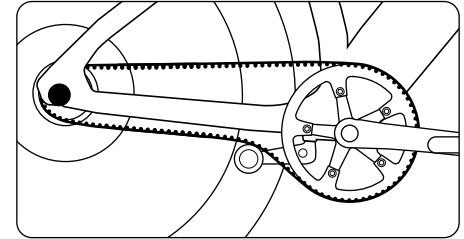

 Please observe the following handling instructions to extend the belt's lifespan. Improper handling may result in damage to the belt and lead to you needing to replace it!

- Do not bend or twist it
- Do not turn it inside out
- Do not bunch or coil it
- Do not use it as a whip
- Do not use tools or sharp instruments when handling the belt
- Do not push down on the belt pulley
- Do not oil

In order to extend its lifespan, we recommend cleaning the belt with water or a hand brush (e.g. after riding through mud or dirt). Residue on the belt or belt pulleys can result in increased wear and noise (e.g. squeaking or creaking).  
Use in winter: The belt does not rust, but salt crystals may be left behind on the pulley system if salt water is allowed to dry on it. Even if no dirt is vis-

ible, you should wash your bike and belt regularly when using it during winter. Use warm water and a gentle detergent or cleaning product.

Check your belt drive for damage, deformation or cracks each time you clean it. If you have any doubts, visit your Stromer dealer. If your belt is still making noise despite a thorough cleaning, a thin layer of dry silicone spray can be applied to the inside of the belt. This protects it against further build-up, reduces friction and reduces noise.

## Rims/Tyres

 Rims are subject to high stress and are safety-relevant parts. They will become worn from riding. If you notice that a rim is damaged, do not keep riding with this rim. Have it checked and replaced by a Stromer dealer. Wear can weaken rims and cause falls and serious accidents.

 Regularly check the tyres of your speed-pedelec. The lowest and highest permitted pressures can be found on the side of the tyre. Please stick to these values; otherwise the tyre may detach from the rim or burst! If differing pressures are specified on the rim and the tyres, the lowest maximum pressure and highest minimum pressure should be taken into account.

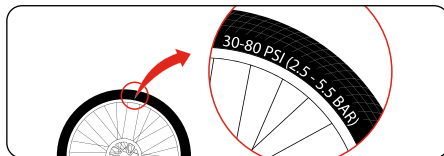

 Tyres with dimensions 57– 584 (ST1 and ST2 54-584) with 2.2 bar / 32 psi running pressure are recommended for the Stromer.

 Tyres are wear parts. You should therefore regularly check the pressure, tread and condition of your tyres. Not every tyre is suitable for every purpose.

On a speed-pedelec, the tyres should only be replaced with authorised tyres that have been approved by the manufacturer. Attention must be paid to ensure that you choose the correct size. Seek advice from your Stromer dealer when selecting tyres.

 Special tyres are available for winter. Ask your Stromer dealer for tyres with a special profile and rubber compound.

The following tyre dimensions are approved for Stromer speed-pedelecs:

ST1, ST2, ST3 and ST5: 27.5 x 2.25" (650b)e / 57-584

ST1 and ST2: 27.5 x 2.25" (650b)e / 54-584

ST5 Pinion and ST7: 27.5 x 2.35" (650b)e / 57-584

## Repairing a flat tyre

 Contact your Stromer dealer or an authorised speed-pedelec specialist workshop to repair flat tyres.

## Brakes

Your Stromer is equipped with a hydraulic disc brake.

 Only authorised replacement parts for the relevant bicycle or authorised components as per EU Regulation No. 90 may be used.

 Brakes and braking systems are safety-relevant parts. They should be serviced on a regular basis. Specialist knowledge and special tools are required for this. Have your Stromer dealer carry out this type of work on your speed-pedelec! Work that is carried out incorrectly can impact the operational safety of your speed-pedelec!



**i** Brake discs are particularly subject to wear. Have these safety-relevant parts checked regularly for wear by your dealer and replace them as required.

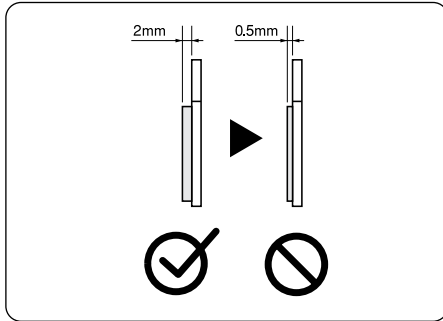

Source: Shimano® techdocs

**⚡** Please do not touch the brake disc while it is rotating or directly after braking. This can cause injuries or burns.

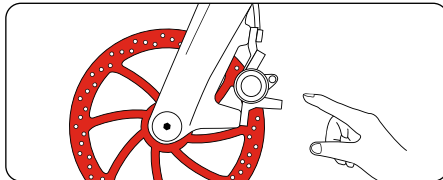

### **Safety instructions for hydraulic disc brakes**

**⚡** Avoid continuously braking for long periods, such as during long and steep descents. This can cause vapour locking which can result in a total failure of the braking system. This in turn can cause serious falls and injuries.

The brake lever should not be applied if the speed-pedelec is on its side or upside down. Air bubbles can enter the hydraulic system and cause the brakes to fail. After transporting the pedelec, always check to see whether the pressure point of the brakes seems softer than before. Then slowly apply the brake a few times. This can discharge air from the braking system.

If the pressure point remains soft, please do not use your speed-pedelec. A Stromer dealer must discharge the air from the brake system.

**i** You can avoid this problem by applying the brake lever before transporting your speed-pedelec and fixing it in this position using a strap. This prevents air from entering the hydraulic system.

If the brake system needs to be cleaned, please read the instructions supplied by the component manufacturer.

**i** You can find more information about the brakes on your speed-pedelec in the manufacturer's instructions at [www.stromerbike.com/support](http://www.stromerbike.com/support) and on their website.

### **Gear-shifting system**

**⚡** Gears are safety-relevant parts! Please read the enclosed operating manual supplied by the manufacturer and familiarise yourself with how to operate the speed-pedelec's gear-shifting system and how to change gears before your first ride. Leave system repairs to your Stromer dealer! Work that is carried out incorrectly can impact the operational safety of your speed-pedelec!

**i** You can find more information about the gear-shifting system on your speed-pedelec in the manufacturer's instructions at [www.stromerbike.com/support](http://www.stromerbike.com/support) and on their website.



You can extend the warranty for the Pinion C-Line gearbox to three years and the warranty for the Pinion P-Line gearbox to five years.

You can find Pinion's warranty conditions at <https://pinion.eu/service/> or by scanning this QR code

Scan:



## Ban on speed-pedelec tuning



Do not make any technical modifications to your speed-pedelec. Manipulating the bike in any way to increase the power or speed can lead to serious legal problems and make the bike less safe to ride.

Possible legal implications:

- The manufacturer does not offer any kind of guarantee, warranty or liability.
- Criminal consequences cannot be ruled out. For instance, causing negligent bodily injury may result in a legal offence.
- Expiration of the insurance.

Possible technological implications:

- Technical modifications can impact the function of the speed pedelec and cause defects or cause parts to break.
- The motor and battery may become overloaded and overheat. Consequences: Irreparable damages and risk of fire.

The brakes and other parts may be put under more strain. Consequences: Malfunction, overheating, increased wear and tear.

## Luggage and load transport



The retrofitting of a luggage rack may only be carried out by a Stromer dealer. Work that is not carried out properly and professionally jeopardises the operational safety of the speed-pedelec or can cause damage to the speed-pedelec! Check with your Stromer dealer or the relevant registration office as to whether you need a separate individual licence for the conversion.

### Luggage rack



Never attach luggage racks to the saddle post! It has not been designed for this purpose. Overloading of the saddle post by a luggage rack can cause it to break and lead to serious accidents.

The permissible total weight of the vehicle must not be exceeded, even if a luggage rack with a higher load capacity would make this possible!

### Front-wheel luggage racks

Front luggage racks cannot be used with the speed-pedelec.

### Safety instructions for transporting luggage



The luggage load can alter the handling of your speed-pedelec. Among other things, it extends the braking distance. This can result in serious accidents or falls. Please adjust your riding style according, i.e. brake earlier and anticipate more sluggish steering. Only transport luggage on racks intended for this purpose! Do not use child seats on this speed-pedelec.

Please ensure that nothing can get caught in the spokes and spinning wheels.



If you are riding with luggage, make sure that you do not exceed the maximum permissible weight of the speed-pedelec. Information on the load-bearing capacity of the rack is usually stated on the rack.

More information about this can be found at [www.stromerbike.com/support](http://www.stromerbike.com/support)

## Lighting system

**i** It is not possible to replace the bulbs in modern LED lights. Clean your reflectors and lights on a regular basis. Use warm water and a cleaning agent or washing up liquid.

It is recommended to adjust the headlight so that the centre of the light does not blind oncoming traffic. In Germany, this is required by law.

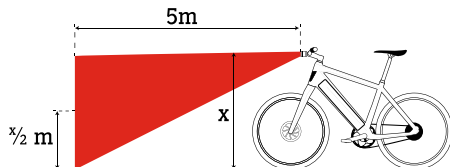

Modifications to the lighting system are not permitted and may result in the loss of warranty, guarantee and insurance coverage!

More information can be found at [www.stromerbike.com/support](http://www.stromerbike.com/support).

## Anti-lock braking system (ABS) with lift-off control on the rear axle

All work on the anti-lock braking system must be carried out by a Stromer specialist dealer. If the maintenance is not performed in accordance with the specifications and/or if work is performed by unauthorised personnel, the warranty and/or guarantee of the whole anti-lock braking system is immediately voided.

## Inspection schedule

**i** Modern speed-pedelec technology is powerful, but requires regular maintenance by qualified personnel. Specialist knowledge and special tools are required. Leave system repairs to your Stromer dealer!

Sustainable safe function and retention of warranty claims require that you:

- Clean your speed-pedelec after every ride and check it for possible damage.
- Have your Stromer dealer carry out any inspections.
- Check your speed-pedelec every 300 - 500 km or every three to six months.
- Check that all bolts, nuts and thru axles are secure.
- Use a torque spanner to tighten any bolts!
- Service and lubricate moving parts (except the brake surfaces) according to manufacturer information.
- Have paintwork touched up.
- Have defective and worn parts replaced.

**i** You can find more information about your speed-pedelec's parts and how to clean and maintain them in the manufacturer's instructions at [www.stromerbike.com/support](http://www.stromerbike.com/support) and on their website.

## Inspection intervals and work

**i** Ask your Stromer dealer about which lubricants are suitable! Not all lubricants are suitable for all purposes. Using the wrong lubricant may lead to damage and may impair the functionality of your speed-pedelec!

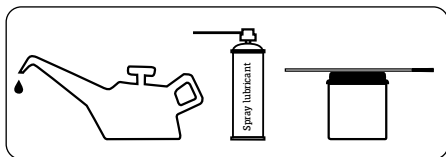

Work which you can carry out yourself with no risk to safety is printed in **bold**.

**Work to be carried out**

### Check:

#### • **Tyres and wheels**

Tightening torques:

- Handlebars
- Cranks

Adjust the following parts:

- Headset
- Brakes
- Pedals
- All fastening bolts
- Saddle post
- Saddle
- Gears
- Suspension elements

## Before using your speed-pedelec

**Work to be carried out**

Servicing/Checks

Check the following:

- **Spokes**
- **Rims for wear and concentricity**
- **Tyres for damage and foreign bodies**
- **Thru axles**
- **Gear-shifting system function**
- **Brake function**
- **Hydraulic brakes: Leaks**
- **Lights**
- **Bell or horn**
- **Tyres: properly secured and correct pressure**

## Every 300 to 500 kilometres

**Work to be carried out**

Check the following:

- **Drive chain or belt**
- Brake pads for wear, replace if necessary

Clean:

- **Drive chain or belt**

Lubricate:

- **Chain (with suitable lubricant)**

Check:

- All bolted connections are tight (if no tightening torque is specified, carry out a simple check by hand to see if the bolt connection has loosened)

## Every 3000 kilometres / at least once a year

**Work to be carried out**

Inspection and cleaning by Stromer dealer, replace if necessary:

- Hubs
- Pedals
- Brakes
- Headset
- Gears
- Chain or belt

## After riding in wet weather

**Work to be carried out**

- Remove moisture, dry off

Clean and lubricate:

- **Gear-shifting system**
- **Chain**

**i** The first inspection is particularly important when it comes to ensuring that your speed-pedelec remains safe to use and problem-free! Cables and spokes stretch and bolted connections can come loose. Please always have the first inspection carried out by a Stromer dealer.

## Lubrication



Working on the speed-pedelec requires special knowledge, special tools and experience! Have all work on safety-relevant parts carried out or checked by your Stromer dealer!

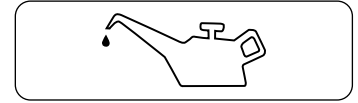

### Lubrication schedule

What must be lubricated?	At what intervals?	With which lubricant?
<b>Chain</b>	After removing dirt, after having ridden in the rain, every 250 km	Chain oil
<b>Shifter cable</b>	When performance deteriorates, once a year	Silicone-free grease
<b>Wheel bearings, pedal bearings, inner bearings</b>	Once a year	Bearing grease
<b>Threads during assembly</b>	During assembly	Assembly grease
<b>Contact surfaces of carbon fibre parts</b>	During assembly	Carbon assembly paste
<b>Sliding surfaces of bolts</b>	Once a year	Grease, spray lubricant
<b>Metal saddle posts on the metal frame</b>	During assembly	Grease
<b>Gear-shifting system joints</b>	When performance deteriorates, once a year	Spray lubricant

## Bolted connections



All bolted connections on the speed-pedelec must be tightened with the correct tightening torque to ensure that they are secure. Using too much tightening torque can damage the bolt, nut or part. You must use a torque spanner. You cannot properly tighten the bolted connections without this special tool!



Adhere to any specified tightening torque values for parts. Please read the instructions provided by the manufacturer, they often list the correct tightening torques.



If a bolted connection is equipped with a bolt locking agent (bolt adhesive, e.g. Loctite), this must also be used each time that the bolted connection is opened, loosened or tightened again.



The following table lists the bolted connections that you may work on yourself. These bolted connections may only be tightened or checked with a torque spanner and the specified torque. If a different torque is listed on the part, use this. Bolted connections not listed here may only be tightened or machined by a Stromer specialist dealer.

Parts	Torque
Clamping saddle base and saddle bracket	12 – 14 Nm
Saddle post clamp	10 Nm
Drinking bottle holder	3.5 Nm
SP gadget adapter	0.5 Nm

## WARRANTY

Under EU law, the seller is liable for material defects for at least the first two years following the date of purchase. This includes defects that were present at the time of purchase or handing over. In addition, during the first twelve months it is assumed that any defects already existed at the time of purchase.

In Switzerland, liability is limited to two years from the date of purchase.

If a defect occurs, you can choose between cancellation the delivery, a reduction in the purchase price, subsequent delivery or, if necessary, subsequent improvement.

Liability for material defects does not extend to normal wear and tear within the scope of the intended use of the speed-pedelec.

## WARRANTY, DEFECTS, WEAR AND TEAR

The warranty conditions and limitation of liability were given to you separately when you purchased your speed-pedelec. You can also view this information at any time at [www.stromerbike.com/support](http://www.stromerbike.com/support).

In the case of a defect/possible liability claim, please contact your Stromer dealer. We recommend keeping all purchase receipts and inspection reports as proof for your records.

## Wear and tear

Keep in mind that speed-pedelec parts are subject to greater wear than those of a bicycle without an additional drive. This is due to the greater weight of the speed-pedelec and the higher average speeds that are achieved thanks to the drive.

This higher level of wear is not a material defect and is not covered by the warranty.

Typical parts affected by this are:

- Tyres
- Brake pads

The battery is subject to wear and tear and is therefore also classed as a wear part. Please note that the battery gradually loses its capacity depending on its age and service life. Take this into account when planning journeys and ensure that you switch to a new battery in good time. You can purchase replacement batteries from your Stromer dealer.

## TECHNICAL SPECIFICATIONS

Permissible total weight Stromer speed-pedelec: 150 kg

Speed-pedelec incl. battery + rider + luggage + trailer

Weight of the different Stromer models:

Model	Weight without battery	Battery weight	Total weight	Maximum permissible load
ST1	27 kg	4.8 kg	31.8 kg	118.2 kg
ST2 ST3 ST5	28 kg	4.8 kg	32.8 kg	117.2 kg
ST7	30 kg	7.0 kg	37.0 kg	113.0 kg

	ST7	ST5	ST3	ST2	ST1
<b>MOTOR</b>	SYNO Drive Sport II*	SYNO Drive Sport*	SYNO Drive II*	Cyro Drive IG*	Cyro Drive II
MOTOR ASSISTANCE	up to 45 km/h	up to 45 km/h	up to 45 km/h	up to 45 km/h	up to 45 km/h
POWER	940 W	850 W	820 W	750 W	670 W
POWER USA	750 W	650 W	600 W	570 W	550 W
TORQUE	52 Nm	48 Nm	44 Nm	40 Nm	35 Nm
RANGE	up to 260 km	up to 180 km	up to 180 km	up to 180 km	up to 180 km

\* Depending on where the Stromer will be used, a driving licence and insurance/registration plate may be required.

<b>CHARGER</b>	CR245	CR246**
INPUT	100-240 VAC ~ / 50-60 Hz / 3A	230-240 VAC ~ / 50-60 Hz / 1.8 A
OUTPUT	54.6VDC / 4.5A 11.2VDC / 1A	54.6VDC / 4.5A 12 VDC/0.75A
PERMISSIBLE CHARGING TEMPERATURE RANGE [°C]	0...40 °C	0...40 °C

## ENVIRONMENTAL TIPS

Make sure that you dispose of all packaging in accordance with regulations and according to the type of packaging.

### General cleaning and maintenance

Please take the environment into account when maintaining and cleaning your speed-pedelec. You should use biodegradable maintenance and cleaning products wherever possible.

Please make sure that no cleaning agents are disposed of in the sewage. When cleaning the chain, use a suitable chain cleaning tool and properly dispose of any chain lubricant used at a suitable waste disposal site.

### Brake cleaners and lubricants

Brake cleaners and lubricants should be treated like general maintenance and cleaning agents.

### Tyres and inner tubes

Tyres and inner tubes cannot be thrown away with domestic waste. They must be disposed of at your local recycling centre.

### Speed-pedelec batteries

Speed-pedelec batteries should be treated as hazardous materials and are subject to special labelling requirements. They must be disposed of by the dealer or the manufacturer.

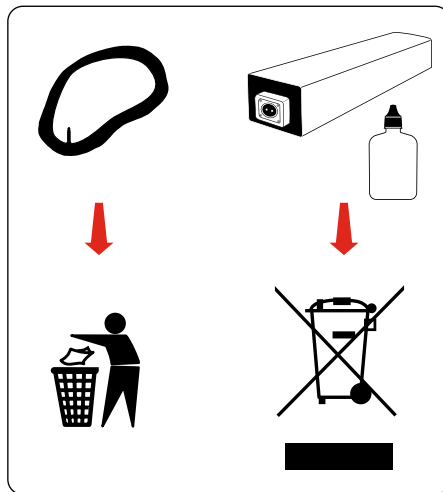

## LEGAL NOTICE

myStromer AG  
Freiburgstrasse 798  
CH-3173 Oberwangen

### Europe:

info@stromerbike.com

### USA:

serviceusa@stromerbike.com

Responsible for distributing and marketing the user manual: inMotion mar.com  
info@inmotionmar.com, www.inmotionmar.com  
Contents and illustrations: Veidt-Anleitungen  
anleitungen@thomas-veidt.de  
www.veidt-anleitungen.de

Legal inspection by a lawyer's office specialising in intellectual property

This operating manual covers the requirements and scope of DIN EN ISO 4210 and DIN EN ISO 15194:2017-12.

In case of delivery and use outside of this scope, the manufacturer of the speed-pedelec must provide the necessary manuals.

© Before reproducing, reprinting, translating or using this document for any commercial purpose (even in part, printed or electronic form), you must first receive written consent.

Stromer ST1 ST2 ST3 ST5 ST7 EN Edition 3.0  
February 2024





Stromer FAQ

### **Stromer FAQ**

Do you have questions about maintenance, features or settings for your Stromer speed-pedelec? Would you like some tips and tricks for looking after your Stromer and keeping it in perfect condition? Then you've come to the right place.



Stromer OMNI App  
iOS

### **Stromer OMNI App**

With the Stromer OMNI app, you can keep track of what you have done with your Stromer and when. Comprehensive statistics show you how far you have travelled with your Stromer and when. You can also adjust the behaviour of your e-bike to your needs, tune to assistance provided to meet your requirements and monitor the service entries. Thanks to the clever, integrated anti-theft protection, you can travel carefree. You can keep an eye on the position and status of your Stromer at all times.

With the Stromer OMNI app, you and your Stromer will be inseparable. And safe.



Stromer OMNI App  
Android

## SERVICE SCHEDULE

### 1st inspection:

Work done:

---

---

---

---

Materials used:

---

---

---

---

Date: \_\_\_\_\_

Signature: \_\_\_\_\_

Retailer stamp

### 2nd inspection:

Work done:

---

---

---

---

Materials used:

---

---

---

---

Date: \_\_\_\_\_

Signature: \_\_\_\_\_

Retailer stamp

### 3rd inspection:

Work done:

---

---

---

---

Materials used:

---

---

---

---

Date: \_\_\_\_\_

Signature: \_\_\_\_\_

Retailer stamp

**4th inspection:**

Work done:

---

---

---

---

Materials used:

---

---

---

---

Date: \_\_\_\_\_

Signature: \_\_\_\_\_

Retailer stamp

**5th inspection:**

Work done:

---

---

---

---

Materials used:

---

---

---

---

Date: \_\_\_\_\_

Signature: \_\_\_\_\_

Retailer stamp

**6th inspection:**

Work done:

---

---

---

---

Materials used:

---

---

---

---

Date: \_\_\_\_\_

Signature: \_\_\_\_\_

Retailer stamp

## SERVICE SCHEDULE

### 7th inspection:

Work done:

---

---

---

---

Materials used:

---

---

---

---

Date: \_\_\_\_\_

Signature: \_\_\_\_\_

Retailer stamp

### 8th inspection:

Work done:

---

---

---

---

Materials used:

---

---

---

---

Date: \_\_\_\_\_

Signature: \_\_\_\_\_

Retailer stamp

### 9th inspection:

Work done:

---

---

---

---

Materials used:

---

---

---

---

Date: \_\_\_\_\_

Signature: \_\_\_\_\_

Retailer stamp

**10th inspection:**

Work done:

---

---

---

---

Materials used:

---

---

---

---

Date: \_\_\_\_\_

Signature: \_\_\_\_\_

Retailer stamp

**11th inspection:**

Work done:

---

---

---

---

Materials used:

---

---

---

---

Date: \_\_\_\_\_

Signature: \_\_\_\_\_

Retailer stamp

**12th inspection:**

Work done:

---

---

---

---

Materials used:

---

---

---

---

Date: \_\_\_\_\_

Signature: \_\_\_\_\_

Retailer stamp

Version 3.0  
Article no. 405019

**myStromer AG**

Freiburgstrasse 798 | CH-3173 Oberwangen | Switzerland  
stromerbike.com | info@stromerbike.com

**+STROMER-**