

# Lifecycle Twin

Building X



**Lifecycle Twin is a Building X offering that provides a single pane of glass for data related to equipment, other assets and location from different stages of a building's lifecycle integrated via APIs. Customers can create data quality reports to check data quality and refine data. Using the 2D and 3D visualization and navigation customers can maintain and manage their buildings and can create and manage documents and tasks in correlation to the assets.**

- An integrated 'Single Source of Truth' database with a visual 2D, 3D interfaces for data collection, analysis, and asset data maintenance over the whole facility lifecycle.
- ISO 19650-compliant Common Data Environment (CDE).
- Support for open information standards, for example COBie IFC.
- Maintain and visualize entire systems, components, and location relations including, quality check of data.
- Maintain and manage document workflows and versions.
- Create tasks for documents, and components and manage task workflows for predictive and reactive maintenance.
- Virtually navigate the building with a possibility to have different views based on discipline and store viewpoints of interest.
- Quick information retrieval by bar code scan of device on mobile.
- Locate assets and evaluate condition by display of live values, and historical information.
- Highlighting areas and components of interest based on custom conditions and animations.

**Common Data Environment**

The CDE offers flexibility in defining customer specific properties for location and assets to make available the complete information about the infrastructure in a single place.

Customer can correlate structured data including BIM and other information about assets coming from 3rd party tools via APIs.

The quality check and reporting help Customer refine and maintain the quality of data throughout the lifecycle of the building.

Relationship between various entities including location information, systems, associated documents and tasks can be stored in a single place allowing the complete overview for facility managers and owners.

**Tasks for Asset Maintenance**

Tasks can be scheduled to maintain and manage building assets using the recurring tasks. The history of the maintenance activities for the tasks can be used for analysis and maintenance planning. Tasks can also be created and managed for current asset failure or damage including repair/ replacement and assigned to personnel. Service engineers and Operators can easily locate assets using the 3D visualization, add comments and interact with each other using the mobile application. Any related information about the impacted system, documents or related components can be pulled in for assistance.

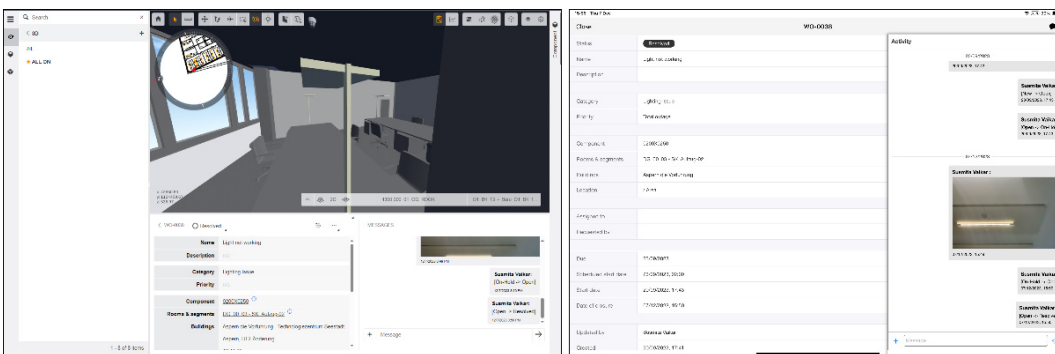

The facility managers can access information about the status and information on the tasks added by operators on field to change assignment, give suggestions or plan additional activities.

**Navigation for Inspections and Maintenance**

Facility managers and operators can remotely navigate buildings using the options available for 2D and 3D navigations. Layers such as HVAC, Electrical, Fire can be enabled and disabled, and views and viewpoints can be created as per different needs if available from BIM. Customer can search and isolate an entire system or asset for maintenance and troubleshooting.

A correlated visualization of the 2D and 3D floor plan is available when navigating the areas also allowing an easy switch between 2D and 3D including 2D overlays. User can easily visualize the floor, hide ceilings, walls etc. to look at the assets behind these and jump between floors using simple navigation options for remote diagnostics.

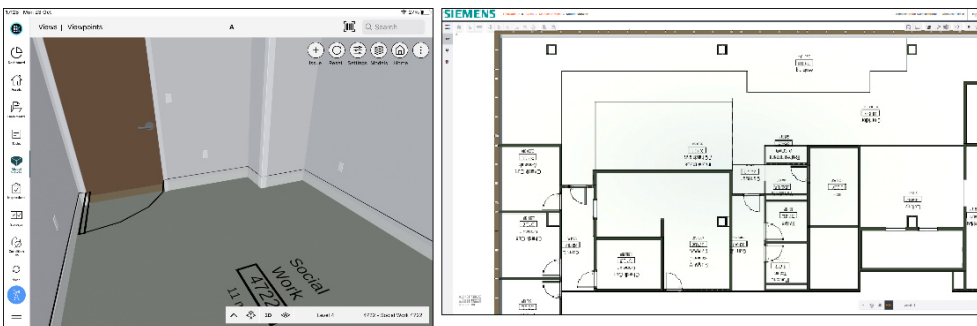

**Real Time Information and Visualization**

Lifecycle Twin integrates real time values using mapping assets to equipment connected via devices and data setup in Building X. Time series information can be visualized for historical analysis and for predictions based on the data connected.

Rooms and components can be colored based on custom conditions to represent various aspects including space utilization and areas that need attention depending on the use cases.

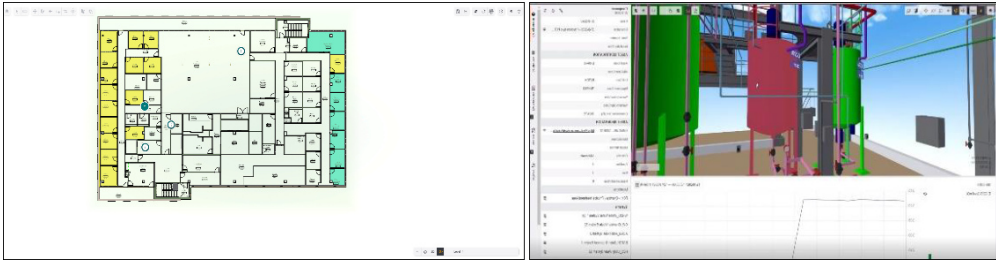

### Information Handover and Workflows

Documents are a critical part of an end-to-end project delivery and operations. Lifecycle Twin facilitates information handover, inspections and operations inline with ISO19650 by providing various mechanism of versioning, maintaining and modifying documents including workflow definition and management. Workflows can be defined at the project level and be associated to both tasks and documents.

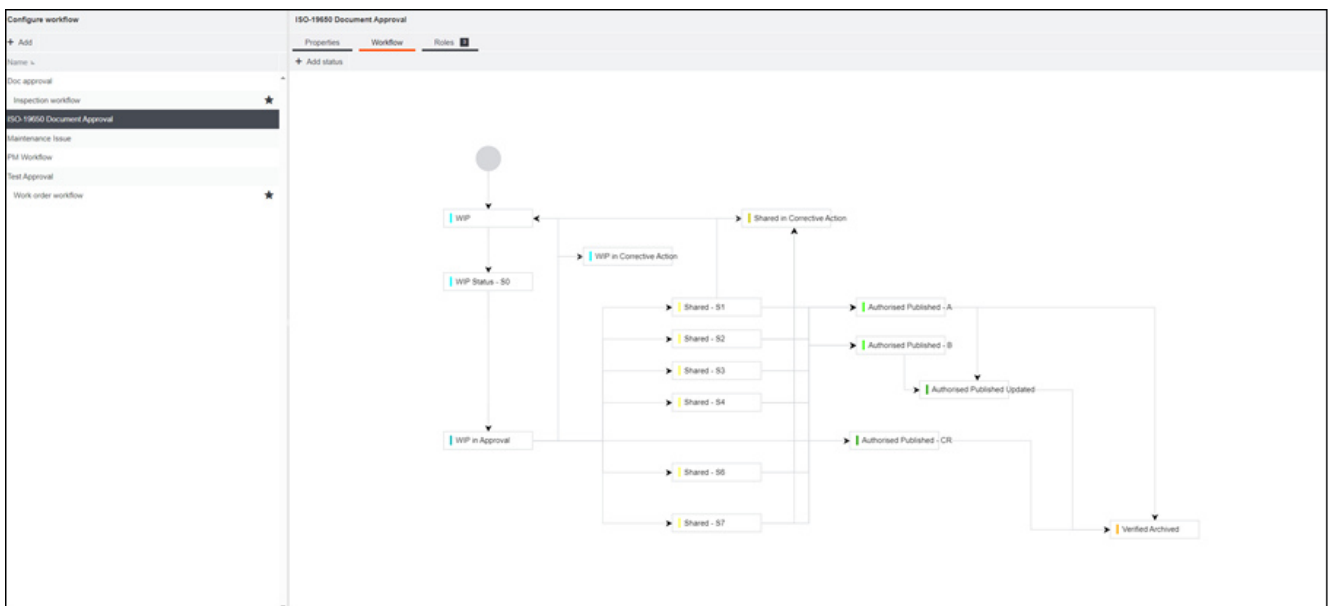

### Data Hosting and Data Usage

Hosts and processes data in a data center located in Ireland. For information regarding processing of personal data Customer may refer to the Data Processing Terms.

### Data Export and Import

BIM information can be imported into Lifecycle Twin using the IFC and Revit BIM connector tools. These tools offer various options to select the information to be imported including the metadata and geometry information and if Lifecycle Twin or BIM is to be considered as the source of truth. Lifecycle Twin also supports import and export via COBie spreadsheets for data and import and export of documents.

### Ask Building X

Ability to ask questions in different languages about Building X technical information, utilizing GenAI.

Customer documents uploaded to the Lifecycle Twin document management system can be queried with Ask BX, our AI assistant. Please ensure all documents / folders have the necessary access permissions set and approvals are in place for third party documents uploaded in the Lifecycle Twin document management system and used in conjunction with Ask BX. Ask BX follows fine granular permissions and access levels for documents, set in the Lifecycle Twin document management system (refer to the user guide for details).

Customer documents uploaded to the Lifecycle Twin document management system can be queried with Ask Building X. Please ensure all documents / folders have the necessary access permissions set and approvals are in place for 3rd party documents uploaded in the

Lifecycle Twin document management system and used in conjunction with Ask Building X. Ask Building X follows fine granular permissions and access levels for documents, set in the Lifecycle Twin document management system (refer to the user guide for details).

\* *The images in this document are examples for the purpose of explanation only and not an exact representation of the offering.*

## Subscription

### 1) Standard Subscription Plan Cloud

	Lifecycle Twin	
	Lifecycle Twin Base	Lifecycle Twin Add-on API
<b>Subscription metric</b>	Packages of named users and storage 10 users, 50 GB data 25 users, 125 GB data 50 users, 250 GB data 100 users, 500 GB data 250 users, 1 TB data	per API integration per year
<b>Subscription term</b>	Annually	
<b>Billing term</b>	Annually, payment in advance	
<b>Upscale</b>	Effective immediately, pro-rated billing	
<b>Downscale/Cancellation</b>	Effective with end of subscription term	

The base package of Lifecycle Twin needs to be correctly selected during the first time of purchase and is not reversible. In case live data connectivity or other Building X applications are used together with Lifecycle Twin they should be ordered in the same subscription and belong to the same partition.

The service is available as a base unit of 1 user, 5GB and can only be purchased starting from 10 users and 50 GB storage and available in bands as stated in the above table.

For custom uses cases, long term enterprise contracts, and/or for very large number of users or size requirement, (e.g., more than 250 users and/or 1 TB data) Customer may contact their sales representative for custom subscription plan.

The Lifecycle Twin subscription plan is the regular, scalable Offering for this Cloud Service. The subscription term is twelve (12) months with automatic renewal; the Cloud Service fee is paid in advance. The subscription plan can be upscaled at any time and Cloud Service fees for upscales are calculated on a pro-rated basis. The Customer can also scale down the Cloud Service effective with the end of the current subscription term. The subscription fee will be adjusted for the upcoming billing term. The Cloud Service can be cancelled any time, effective with the end of the current subscription term.

Extended Use entitles Customer to authorize its Affiliates and third parties to access and use the Cloud Services in accordance with the rights set out in the Terms and Conditions.

### 3) Custom Subscription Plan

Any subscriptions that are not purchased via a Siemens online store are Custom Subscription Plans. Under a Custom Subscription Plan the details regarding functions, subscription metric, term, billing, up- and downscaling, Connected Devices as well as Permitted Users are set out in the agreement between the Customer and Siemens.

## Prerequisites

### Web browser and Viewing Devices

Chrome is recommended to use the Cloud Service, but other standard browsers might also serve this function. Screen resolution of 1920x1080 pixels or higher is recommended for best user experience.

## Internet Connection

The bandwidth of Customer's internet connection determines the performance of the Cloud Service.

## Ordering

To order a subscription plan and connected devices, Customer must request a quote from its Siemens sales representative.

## Product Documentation

### 1) Product Documentation under a Standard Subscription Plan

General Contractual Documents	Links
Building X - Lifecycle Twin Data Sheet	<a href="http://www.siemens.com/buildingx/data-sheet/lifecycle-twin">www.siemens.com/buildingx/data-sheet/lifecycle-twin</a>
Supplemental Terms for Buildings	<a href="http://www.siemens.com/buildingx/data-sheet/supplemental-terms">www.siemens.com/buildingx/data-sheet/supplemental-terms</a>
General Software Terms and Cloud Supplemental Terms	<a href="https://www.siemens.com/global/en/general/terms-of-sale/supplemental-terms.html">https://www.siemens.com/global/en/general/terms-of-sale/supplemental-terms.html</a>
Base Terms International	<a href="https://www.siemens.com/si/cloud/terms">https://www.siemens.com/si/cloud/terms</a>
Siemens Acceptable Use Policy	<a href="https://www.siemens.com/si/cloud/terms">https://www.siemens.com/si/cloud/terms</a>
Minimum Terms On-Cloud	<a href="http://www.siemens.com/buildingx/data-sheet/minimum-terms">www.siemens.com/buildingx/data-sheet/minimum-terms</a>
Building X Lifecycle Twin Mobile - End User License Agreement IoS	<a href="https://siemens.com/download?A6V15041473">https://siemens.com/download?A6V15041473</a>
Data Privacy Terms	<a href="https://www.siemens.com/dpt/si">https://www.siemens.com/dpt/si</a>
Data Privacy Terms Annexes Building X	<a href="https://www.siemens.com/dpt/si">https://www.siemens.com/dpt/si</a>
EU Data Act	<a href="https://www.siemens.com/buildingx/terms">https://www.siemens.com/buildingx/terms</a>

### 2) Product Documentation under a Custom Subscription Plan

The contractual documents and the Product Documentation are set out in Siemens' offer to the Customer.

### 3) Technical Documents

Technical Documentation	Link
Building X - Online help	<a href="http://www.siemens.com/buildingx/sid">www.siemens.com/buildingx/sid</a>

## Specific Terms

### High-Risk Use

Customer acknowledges and agrees that:

- the Offerings are not designed to be used for the operation of or within a High-Risk System if the functioning of the High-Risk System is dependent on the proper functioning of the Offerings; and
- the outcome from any processing of data through the use of the Offerings is beyond Siemens' control.

### Service Level Agreement

Siemens shall use commercially reasonable efforts to make the Cloud Services available for a monthly uptime percentage of ninety-eight percent (98%).

Except for:

- Planned downtime, agreed downtime, routine and emergency maintenance,
- Cyberattacks,
- the public, third party and/or customer's internet and communications networks,
- data, software, hardware, telecommunications, infrastructure, power, build-packs or net-working equipment not provided by Siemens,
- Customers and Users negligence or failure in using the Cloud Service and/or in not

- following the instructions of published documentation,  
f) system configurations and platforms not supported by Siemens,  
g) system administrations, action, commands and file transfers of Customer or User,  
h) modifications or alterations not made by Siemens,  
i) unauthorized access via Customer's credentials and/or  
j) any other failure outside of Siemens reasonable control.

#### **Gen AI disclaimer**

This offering is based on artificial intelligence technology, i.e. customer documents uploaded to the Lifecycle Twin document management system can be queried with Ask Building X, our AI assistant.

Do not upload confidential data or personal data to Lifecycle Twin knowledgebase or Ask Building X.

AI generated or based Content, results and responses may not be entirely accurate or reliable. For details on GenAI services, refer to Siemens' "[Artificial Intelligence Terms of Use | Siemens Software](#)".

#### **Customer Support**

Siemens offers helpdesk support. Customer may contact its local Siemens representative for support requests. Customers can also submit a support request online: <https://www.siemens.com/support-request>.