



Ciel Covid-19 Updates

Updated on 1.11.2021

Health is our top priority. With our updated COVID-response, we ensure to keep our space sanitized and safe. This is a live document, please check back for updates.

To keep you safe, we are doing the following:

- Ciel Staff Members are tested regularly.
- Our staff is trained on CDC, state and local health guidelines and is C19CO and SafeSet certified.
- Masks are mandatory in the building.
- With 30' high ceilings, expansive studios stretching over 44,000 square feet and windows that reach the ceiling, we are able to provide air ventilation throughout our space.
- Hand sanitizer is located at the entrances of all common areas and studios.
- High touch points & surfaces in common areas are sanitized hourly using disinfectants and UV light wands. Exterior high contact areas, such as handles, keys and lock boxes, are sanitized regularly.
- With the help of our partners, equipment is cleaned and disinfected upon return. UV lights are used on close contact equipment, such as radios, headsets, and craft service items.
- We have sanitation kits and PPE available onsite.
- Touchless Thermometers are available on site for personal use, and temperatures are taken for all visitors to the site.
- Wayfinding signage can be found throughout our common areas. You'll notice arrows and pathways to ensure safe movement throughout the space.

SOCIAL DISTANCE GUIDELINES:

We are operating at 20% capacity. We require socially-distanced headcounts per studio, as per CDC guidelines. Headcounts for crews must be additionally reduced to accommodate sets, equipment, and other obstacles that impact the available square footage:

2611 STUDIOS

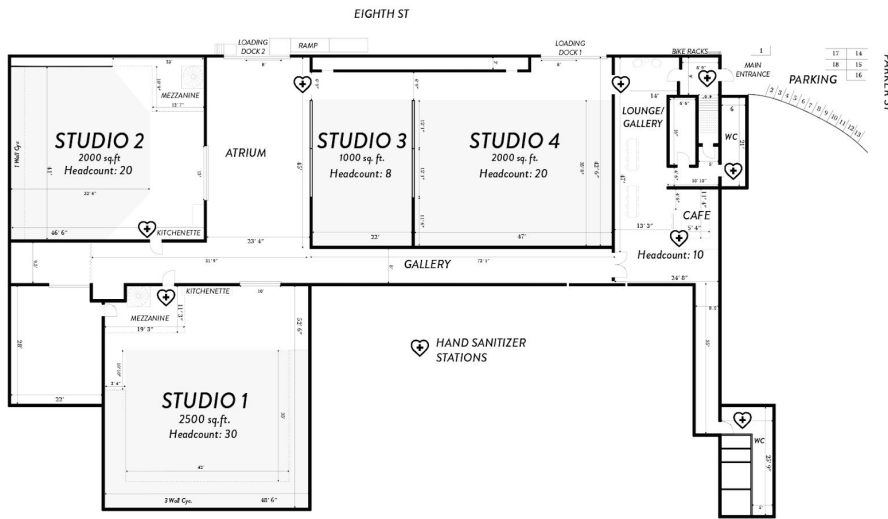

2603 STUDIOS



ATELIER

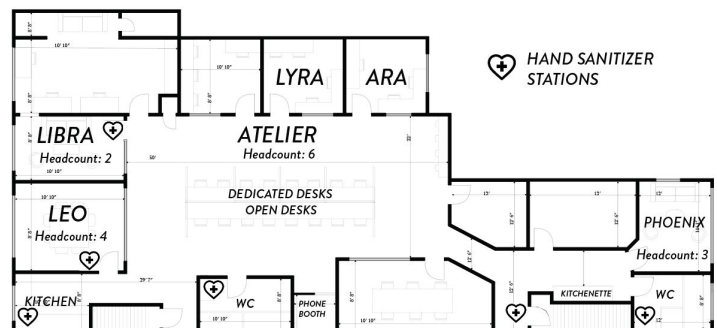

PRODUCTIONS AND VIRTUAL EVENTS:

Health & Safety guidelines

- As part of our health and safety procedures, BEFORE entering the building we require the following:
 - One mandatory on-site antibodies test at the start of production for all crew and talent aged 16 and over *for a one (1) to three (3) day shoot*. Please contact us for a list of preferred, local testing partners.
 - Mandatory PCR tests for all crew and talent aged 16 and over for *shoots more than three (3) days*. Testing to be done within three (3) days prior of production and results to be provided to Ciel prior to entering space. Please contact us for a list of preferred, local testing partners with 24-48 hour turnaround time.
 - For anyone aged 16 and younger, the parent or guardian must be tested under the criteria above.
 - Completion of our survey [Ciel Creative Space | Symptom Screening](#) . A representative for a production/event may complete the survey on behalf of your team, and serve as the person responsible for contact tracing.
- Your team should prioritize what roles are required on set (client, creative, crew)
- MEALS should be taken outside
- Determine what roles can be supported via remote streaming
- PPE is required for all visitors to Ciel Creative Space
- Front access door to Ciel is unlocked remotely by Ciel staff
- Private loading dock access for product/props
- Social distance of 6 feet maintained while on-site

EQ rentals

- EQ partners use PPE & guarantee sanitized gear
- EQ must be rented through our partners to ensure gear is sanitized and delivered in your studio(s) before your production.
- Production EQ & G&E rental link:
 - [Ciel EQ](#)

FAQs:

- What are your social distancing guidelines?
 - See our floor plan for recommended crew sizes and headcounts per space
- How often do you clean/sanitize?
 - High touch points & surfaces in common areas are sanitized hourly. Sanitation kits are also available for sale.
- How strong is your wifi?
 - Dedicated wifi connections are included for each studio, as well as dedicated wifi for our coworking space. On average, download is 120-250 mgbs and upload is 220-280 mgbs. Access to our ethernet is available for fee .
- Do I have to sign a release form or do an assessment?
 - Yes. As part of our health and safety procedures, before entering the premise we require completion of our survey [Ciel Creative Space | Symptom Screening](#) . A representative for a production/event may complete the survey on behalf of your team, and serve as the person responsible for contact tracing.

REFERENCES:

[Berkeley Health Dept](#)

[Alameda County Health Ordinance](#)

[CDC](#)

[California Health Ordinance](#)