



# PGE Foundation Impact Report 2023



Foundation



# A year of transformation

2023 was a year of collaboration and listening to the community as PGE Foundation renewed its focus on career-connected learning and workforce development—two key levers that promote greater economic mobility for all Oregonians.

We introduced our first-ever Career Pathways grants, awarding more than \$400,000 to support organizations like Northwest Native Chamber, Constructing Hope, New Avenues for Youth and Micro Enterprise Services of Oregon, to name a few, who are working to equip Oregonians with the essential tools, skills and knowledge needed to enhance their economic prospects and contribute to the overall prosperity of their communities.

This strategic shift reflects more than a year of listening and conversation with our community partners with the intention of making deeper investments that deliver outcomes across the education and workforce development continuum. This includes our commitment to funding Project Zero, PGE’s community-driven initiative dedicated to expanding meaningful work opportunities for underserved youth in the increasingly diverse green jobs sector.

We continue to invest in arts and culture organizations working to expand access to arts and creative learning experiences that not only provide educational and

economic value, but they also lift spirits, contribute to emotional well-being, and connect people from all walks of life.

As a foundation dedicated to improving the lives of Oregonians, we believe in the benefits of connection and place-based community building. In 2023, we devoted \$135,000 in capital-related grants to Heart of Oregon Corps, Latino Network, Artists Repertory Theatre, Literary Arts, Portland Art Museum, and Museum at Warm Springs to support new and reimagined spaces that bring people together to learn and build community.

As we reflect on the year before, we look forward to the year ahead with a sense of renewal, excitement and determination to continue improving this place we’re so honored to call home. We give our sincerest thanks to those who help pave an equitable way forward for all Oregonians and who work to make Oregon a place that’s known for its kindness, unwavering hope, and perseverance.

Sincerely,



**Angelica Espinosa**  
Chair



**Kregg Arntson**  
Executive Director

## Peggy Fowler's legacy



In 2023, we said farewell to Peggy Fowler, founding member of the PGE Foundation board of directors who served for 26 years, the last four as chair. As former CEO and President of Portland General Electric, Peggy played a key role in creating the Foundation, known for its dedication to improving the quality of life for Oregonians through investments in education, workforce development, arts and culture, and social services.

In 2020, Peggy was elected chair just in time to lead the Foundation in its response to global and local events, including the COVID-19 pandemic, racial unrest, and the impact of Oregon wildfires on our most vulnerable communities. That year, PGE Foundation increased grantmaking by 50% to \$1.7 million to address the unprecedented challenges our communities were facing.

During her tenure, PGE Foundation invested more than \$29 million in grants to community organizations across the state, and then went deeper, creating award-winning signature programs such as Community 101—a student grantmaking program now run by Oregon Community Foundation—and Project Zero, an internship program creating opportunities for underserved youth in the green jobs sector. Further, she led the Foundation to look internally, diversifying the makeup of the board to better reflect our community and bring new voices to the table.

We extend our heartfelt appreciation to Peggy for her years of service and know the values she embodies will be present in our philanthropic commitment to Oregon for years to come.

**Building on Peggy Fowler's extraordinary leadership as the previous chair and founding board member, I am eager to carry forward the Foundation's legacy by strengthening community partnerships and deepening our investments in resources and programs that enhance educational and workforce opportunities for the next generation.**

**– Angelica Espinosa, Chair**



## Project Zero

### BUILDING PATHWAYS TO OPPORTUNITY

The Pacific Northwest has been called “home” by many people and cultures for thousands of years, yet not all communities have had equal access to share in its prosperity. PGE Foundation is honored to work alongside the community to improve the landscape of prosperity, wealth and success through the levers of workforce development and job readiness.

PGE Project Zero successfully completed its fourth year of impact in 2023, engaging young people disconnected from work and school in green job internships. By working in collaboration with dedicated environmental nonprofits and youth development organizations like Portland Opportunities Industrialization Center and Outside In, Project Zero has graduated 53 interns, creating pathways to good jobs and increasing representation of Oregonians of color and underserved youth in the green jobs sector.



Photo credit: Project Zero



Photo credit: Project Zero



Photo Credit: Columbia Slough Watershed Council

Project Zero fills an important niche for opportunity youth interested in exploring and/or pursuing a career in the natural resource and environmental fields. It helps gently usher them into a field that has, for generations, been closed to them, opening the door to new career possibilities.

–Leigh Rappaport, Career Development Coach, POIC



# Black Oregon Land Trust

## SEWING SEEDS FOR CHANGE

Through the launch of PGE Foundation’s Career Pathways grants, PGE Foundation expanded its reach to new organizations working in creative ways to empower Oregonians to prosper. Founded and led by a team of Black women, with a focus on land access and preservation, farming and food justice and cultural sovereignty, Black Oregon Land Trust (BOLT) is building thriving, sustainable food systems, reclaiming pre-colonial traditions of connecting to the land and ensuring future generations have access to housing, food, land, and community stability.

In the 2023-2024 season, BOLT is working to increase the size of their Black farmer apprenticeship program to support 14 aspiring Black farmers in Multnomah and Washington Counties, helping to support them with the skills, tools, and knowledge to succeed in their chosen field. They are building upon their existing youth education program to include a high school cohort of twelve youth interns at the BOLT farm. The interns study regenerative livestock, produce production, beekeeping and forestry conservation, thus ensuring that the next generation of Black farmers is able to build on the foundation laid by its founders.



Photo Credit: Black Oregon Land Trust

We believe that land-based communities in relationship with their environments will protect our future. We know that Black farmers exist and can thrive -- including here in Oregon. We orient to the truth that when mothers and children are cared for, whole communities thrive.

-Black Oregon Land Trust



## Artists Repertory Theatre



Photo Credit: Artists Repertory Theatre

### A NEW SPACE FOR ARTS TO THRIVE

As the dust settles on several years of distancing and isolation, PGE Foundation is committed to supporting organizations helping to revitalize Portland as a thriving center for arts and culture. Organizations like Artists Repertory Theatre (ART), that is working to reimagine their Pearl District building as a community arts center with performance, rehearsal, backstage and collaborative spaces.

ART exists to produce intimate, provocative theatre, and to provide a home for a diverse community of artists and audiences to take creative risks. ART will resourcefully use the building lobby as an initial performance space, jump-starting activities and performances.

The impact of this revitalized space will be felt by the broader community. It will help meet the challenge of affordable performance and rehearsal space in Portland. It will also provide programs and services that help smaller arts organizations and expand opportunities for students of all ages to engage with the power of telling their own stories.

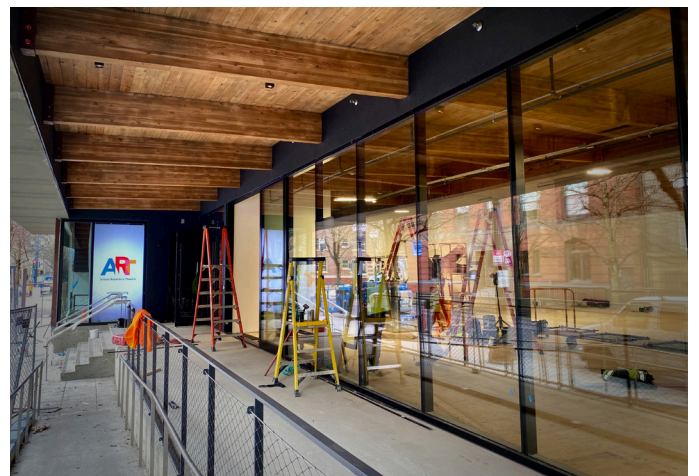

Photo Credit: Artists Repertory Theatre

**“ART’s audiences will once again get to enjoy plays together at our theatre home, and we will get to share this beautiful resource with many others as a flexible, affordable venue. We’re excited to provide a welcoming space for multiple communities to come together and share their stories.”**

**- Aiyana Cunningham, Managing Director**



# Education

## Oregon MESA

### UNLEASHING POTENTIAL THROUGH INVENTION AND CREATIVITY

All young people want an opportunity to make their mark on the world. Some students have more opportunity to develop those skills than others— and that’s where Oregon MESA steps in. Since 1985, Oregon MESA (Mathematics, Engineering, Science Achievement) has provided students underrepresented in the fields of science, technology, engineering, and mathematics with the skills, supports, and opportunities to develop their talents, explore technology-based careers, enter college, and compete successfully in the workforce.

Oregon MESA empowers students through invention and engineering design programs that let them create and have their voices be heard. Students are successful because they are led by MESA-trained teachers and mentored by local university students and STEM professionals throughout the program. MESA engages families to provide ongoing support for the participants’ newly emerging interests.

PGE Foundation’s support is helping Oregon MESA expand their programming to five additional chapters, transforming the lives of students in even more communities.



Photo Credit: Oregon MESA



Photo Credit: Oregon MESA

**“MESA was a major game-changer for me from an educational perspective. It allowed me to expand, explore, and build upon this fascination with invention I already had. It also broadened my understanding of what STEAM is, and how invention can change the lives of the people around me.”**

**- Essey Shimbahri, Oregon MESA alumna**



Photo Credit: Higher Education Coordinating Commission

### OREGON CONSERVATION CORPS

In response to recent devastating wildfire seasons, the Oregon Legislature established the Oregon Conservation Corps (OCC) to train and employ our youth in clearing hazardous fuels that contribute to the spread of wildfires, such as overgrown vegetation and small trees. Through their work, the OCC not only helps to protect our communities but provides valuable job skills and training for young people in Oregon. In 2023, the state provided a unique opportunity for a 5:1 match on private donations to Oregon Conservation Corps, and PGE stepped up to help lead fundraising efforts. The PGE Foundation, PGE employees and other funders met the challenge to unlock \$1.2 million for OCC from the State of Oregon.



# 2023 by the numbers

<p><b>\$1,421,360</b></p> <p>Total grants paid in 2023</p>	<p><b>\$415,000</b></p> <p>Investment in culturally specific/BIPOC organizations</p>	
<p><b>\$29+ million</b></p> <p>Grants paid since 1997</p>	<p><b>\$137,500</b></p> <p>46 college scholarships</p>	
<p><b>53%</b></p> <p>Dollars granted supporting Communities of Color</p>	<p><b>54%</b></p> <p>Project Zero interns identifying as BIPOC</p>	<p><b>17%</b></p> <p>Dollars granted outside tri-county, exceeding 15% goal</p>
<p><b>25</b></p> <p>Grants given by Community 101 students at 10 PGE Foundation funded schools in 2022-2023</p>		

# 2023 grants by focus area

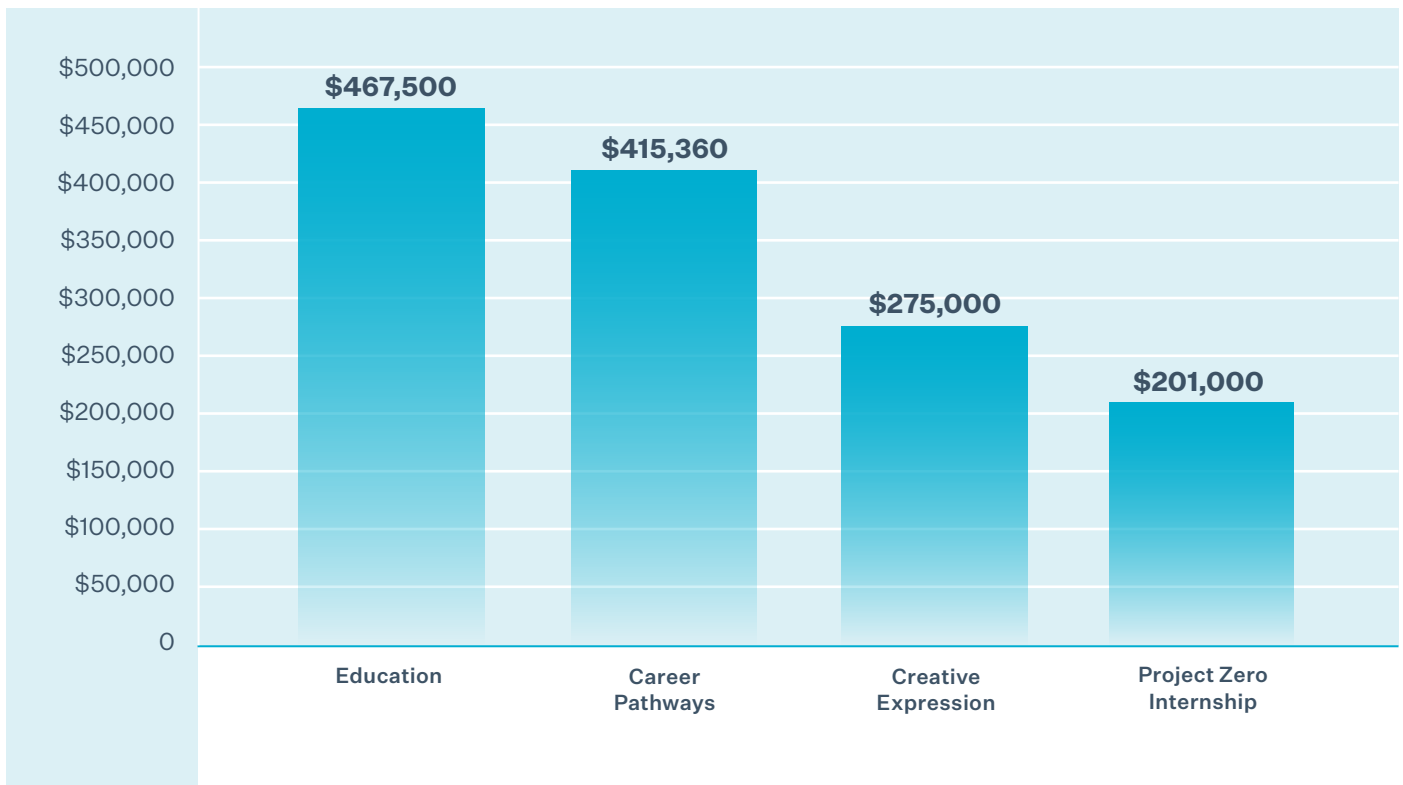



# Grants

## Career Pathways

### \$25,000+

- Centro Cultural
- Constructing Hope Pre-Apprenticeship Program
- Heart of Oregon Corps (capital grant, year 1 of 3-year commitment)
- Immigrant And Refugee Community Organization (IRCO) (year 1 of 2-year commitment)
- Micro Enterprise Services Of Oregon (MESO)
- Our Just Future (formerly Human Solutions)
- Outside In

### \$20,000+

- Impact NW

### \$15,000+

- Willamette Workforce Partnership
- Antfarm
- Black Parent Initiative (BPI)
- Business Impact NW
- Community Action Organization
- Latinobuilt Foundation
- New Avenues For Youth
- VertueLab

### \$10,000+

- Ahivoy
- Black Oregon Land Trust
- Incight Company
- Latino Business Alliance
- Livelihood NW
- Northwest Native Chamber
- Portland YouthBuilders
- The Black United Fund Of Oregon
- TiE Oregon Foundation
- Warm Springs Community Action Team

## Creative Expression

### \$25,000+

- Artists Repertory Theatre (capital grant)
- Arts for Learning Northwest (year 1 of 2-year commitment)
- Literary Arts (capital grant, year 1 of 3-year commitment)
- Portland Art Museum and Northwest Film Center (capital grant, year 2 of 3-year commitment)

### \$10,000+

- Arts Council of Pendleton
- Caldera
- Confluences
- EngAGE Northwest
- iUrban Teen
- Metropolitan Youth Symphony
- p:ear
- PassinArt: A Theatre Company
- Portland Center Stage
- Portland Opera Association
- Portland Playhouse
- The Museum at Warm Springs (capital grant)
- Wonderfolk
- World Stage Theatre
- Yamhill Enrichment Society

### \$5,000+

- Michael Allen Harrison's Play It Forward
- North Pole Studio
- OK You, Inc.
- One World Chorus
- Steps for Youth

## Education

### \$25,000+

- Adelante Mujeres
- All Hands Raised (Year 2 of 2 year commitment)
- Latino Network (Year 2 of 3 year commitment)
- Portland Opportunities Industrialization Center & RAHS

### \$20,000+

- Elevate Oregon
- Friends of Saturday Academy
- Oregon STEM

### \$15,000+

- Better Together Central Oregon
- Camp ELSO
- Chemeketa Community College Foundation
- ChickTech
- College Possible
- Oregon Business Council Charitable Institute
- Oregon Health & Science University Foundation
- Portland Community College Foundation - OMIC
- Portland State University Foundation - Oregon MESA
- Project LEDO

### \$10,000+

- Girls Inc. of the Pacific Northwest
- Open School

## Scholarships

### \$35,000+

- Oregon Alliance of Independent Colleges & Universities

### \$25,000+

- Oregon State University Foundation
- Portland State University Foundation

### \$15,000+

- Oregon Tech Foundation

### \$10,000+

- University of Oregon Foundation

### \$5,000+

- Black United Fund
- Hispanic Metropolitan Chamber
- Pride Foundation
- The Skanner
- United Negro College Fund

### \$2,500+

- PSU Foundation Governor Roberts scholarship

## Director's Grants

### \$5,000+

- Friends of Lincoln High School

### \$2,500+

- World Oregon

## Community 101

### \$35,000

- Oregon Community Foundation (Year 2 of 3 year commitment)

## PGE Project Zero

### \$200,000+

- In4All

## Responsive Philanthropy Fund

### \$20,000

- Oregon Conservation Corps



## About the foundation

PGE Foundation is the philanthropic arm of Portland General Electric. Founded in 1997, the foundation was created through an endowment with the expressed purpose of improving the quality of life for Oregonians. Since its inception, more than \$29 million has been awarded to community organizations across the state.

## Officers



**Angelica Espinosa**  
Chair  
Senior Vice President, Chief Legal and Compliance Officer, PGE



**Gregg Arntson**  
Executive Director  
Director of Community Impact, PGE



**Jardon Jaramillo**  
Treasurer  
Senior Director, Strategic Markets Development, PGE



**Julie Franz**  
Secretary  
Executive Assistant, Public Affairs, PGE

## Board of directors



**Verlea Briggs**  
Senior Manager, Strategic Asset Management, Supply Chain Fleet Storeroom, PGE



**James F. Lobdell**  
Retired CFO and Sr. VP Finance and Treasurer, PGE



**Randolph L. Miller**  
President, Produce Row Property Management



**Maria Pope**  
President & CEO, PGE



## Board of directors, cont.



**Ian Preddy**  
Director, Supply Chain, PGE



**Serena Stoudamire Wesley**  
Director, Community Engagement,  
PGE



**Melissa Dubois**  
Program Officer



**Michele Keever**  
Grants Administrator

## Staff





Foundation