



Siding Installation Guide



ARBOR
WOOD CO

THERMALLY MODIFIED WOOD

STORAGE & HANDLING

Arbor Wood Co. products should be stored indoors when possible and/or remain covered with a waterproof tarp until ready for installation. Boards must be stacked uniformly and elevated off the ground.

Exposure to UV can cause the boards to become lighter in tone

Always remember to handle with care. Arbor Wood has a lower moisture content and the expansion/contraction is much less than standard wood, but it is still a good practice to ensure the wood has properly acclimated to local site conditions. It is recommended to have Arbor Wood Co. Products on site for one week prior to installation to acclimatize to the moisture of the environment.

COLOR

Thermal modification changes the naturally occurring sugars in the wood resulting in beautiful, rich tones which extend through the full thickness of the material. Since Arbor Wood is still a natural product and is subject to variations in weight, density, color, and grain. In an exterior environment, unfinished Arbor Wood products will move to gray. This does not impact the performance characteristics of the wood itself. The speed of this graying process depends on the intensity of exposure to environmental elements like the sun and rain combined with the type of application. To maintain the original color we recommend applying Cutek Extreme® along with a UV Colortone as Cutek Extreme® by itself is not UV resistant. A light sanding or application of Cutek Proclean will remove the surface silvering and restore the original wood tones. Product color and factory applied finishes are not covered under the product warranty.

FINISHING

Pre-finishing all siding boards prior to assembly is the only way to ensure that all 4 sides are coated evenly. It is highly recommended to coat all wood siding with Cutek Extreme® along with a UV Colortone prior to installation. This process helps the wood acclimate more slowly and minimizes surface checking and wood movement. Even if your goal is to allow the wood to naturally gray or silver out over time, finishing at this point will help protect the wood when it is most vulnerable.

GRAIN PATTERN, CHECKS, & HAIRLINE CRACKS

As Arbor Wood is a natural wood product, there may be a variance in grain from board to board. It is also possible to observe some small surface checking and/or hairline cracks in the wood. These instances are a natural occurrence and are not a reason for a claim. Regular application of Cutek Extreme® can help minimize the occurrence of surface hairline cracks.

CARE & MAINTENANCE

It is important to ensure the surface of your wood remains clean. Black surface stains can be caused by dirt, debris, pollen and other airborne and microscopic elements resting on the surface of the material. Certain environments provide exceptional growing conditions for mold and fungus, conditions that often fall within, but are not limited to shaded decks or siding. This does not impact the integrity of the wood but it does mean you should be clearing the surface of your deck more often and taking additional preventative care considering surrounding conditions. It is important to remember the same occurrence can happen on any surface, such as rocks, glass, PVC, and composite products. This staining is removable with light pressure washing and a renewing/cleaning agent.



WUI COMPLIANT INSTALLATION

When installing Arbor Wood siding in a WUI (Wildland Urban Interface) zone it is imperative to install the siding directly to the sheathing and to forego the use of furring strips in order to have a compliant wall assembly. It is recommended to install Arbor Wood Siding products over gypsum board or another fire rated sheathing material. Please consult the local building code in your area for a full list of requirements and to ensure your walls are compliant with requirements for ignition-resistant construction in WUI areas. For more information on WUI and requirements please visit fire.ca.gov

WARRANTY

Arbor Wood Co. Products are covered under a limited 20-year Warranty. This Arbor Wood Co. warranty is made to the original purchaser of the Product(s) (the "Purchaser"); the original owner of the structure on which the Product(s) are installed; and to the next owner of that structure (together "Owner"). Arbor Wood Co. express warranties may not be assigned to any subsequent owners of the structure. Arbor Wood Co. warrants that the Product(s) will remain free from fungal degradation, buckling, structural failure, separating, and rupturing for a period of 20 years from the date the installation is completed. When the Product(s) have been stored, handled, applied, finished and maintained in accordance with Arbor Wood Co.'s installation, application, finishing and maintenance instructions in effect at the time of application. Color and applied finishes are not warranted. These warranties apply only to above-ground installations made in accordance with the instructions. Be sure to consult full product warranty for specific questions.

FOR MORE INFORMATION, INCLUDING FULL WARRANTY,
HOW-TO VIDEOS & MORE, FOLLOW THE QR CODE BELOW



Siding Installation

DISCLAIMER

Consult your local building code to ensure your project is installed in accordance with local requirements and consult your local building office to understand permitting requirements. Drawings and schematics used to show where to place screws and nails are for reference purposes only. Safety glasses and a dust mask should always be worn when working with Arbor Wood. Drilling, sawing, sanding or machining wood products generates wood dust. Avoid inhaling wood dust or use a dust mask or other safeguards for personal protection. Arbor Wood Co. recommends end-sealing cut boards with a clear, water-resistant penetrating oil such as Cutek Extreme®.

Warning: Do not use a mallet or hammer to install Arbor Wood Co. siding products, doing so will void the warranty. Arbor Wood Co. siding is designed to have an expansion gap to allow the product to acclimate to the installation location.

STANDARD TONGUE AND GROOVE INSTALLATION

- Arbor Wood Co. recommends siding products to be installed with proper furring strips and rain screen to allow for necessary airflow. **NOTE:** *Arbor Wood tongue & groove siding not secured to proper furring will void the warranty.*
- Arbor Wood can provide the furring strips (3/4" x 2" random length), though it is not required to use Arbor Wood as furring. General plywood or OSB lumber is commonly recommended.
- The furring should be hung in a way that the siding can be fastened every 16" OC and the seams break on furring. Seams may require a double furring to ensure there is enough to fasten both pieces of siding properly.
- Thermally Modified Siding will expand slightly in the width as it adapts to your specific climate and location. This is a one-time event. Once adapted, the boards will remain stable, but care must be taken during installation to allow for this expansion. A 3/16" reveal gap should be provided between each board along with a 1/16" gap on the back side to allow for proper expansion and contraction during acclimation.
- A minimum 2-1/2" #8 stainless steel trim head screw is recommended to be driven at an angle at the base of the tongue so that it passes through the full thickness of the siding. This is not a completely blind fastening; the head of the screw may be slightly visible in the 1/8" groove of the board. This is a very subtle detail. If installing siding wider than nominal 6" a face fastened screw should be added to the bottom of installed board in addition to the tongue. NOTE: Even if using self tapping screws, Arbor Wood recommends predrilling to greatly reduce the chance of splitting.
- Vertical installation calls for a counter-batten furring method -OR- Quarrix ProTect Furring Strips. This allows for convection airflow and water drainage to occur behind the siding.
- Arbor Wood Co. recommends ground clearance of at least 12" for all cladding projects. At the very least the ventilation gap behind the cladding must stay open from below to ensure air circulation.
- Top and bottom must not be obstructed, leave at least 1/4" of gap from soffit on top or water table on bottom.
- In order to avoid splitting, secure fastener a minimum of 3/4" of space from edge of the board.



Standard Horizontal Tongue & Groove Installation - Side View

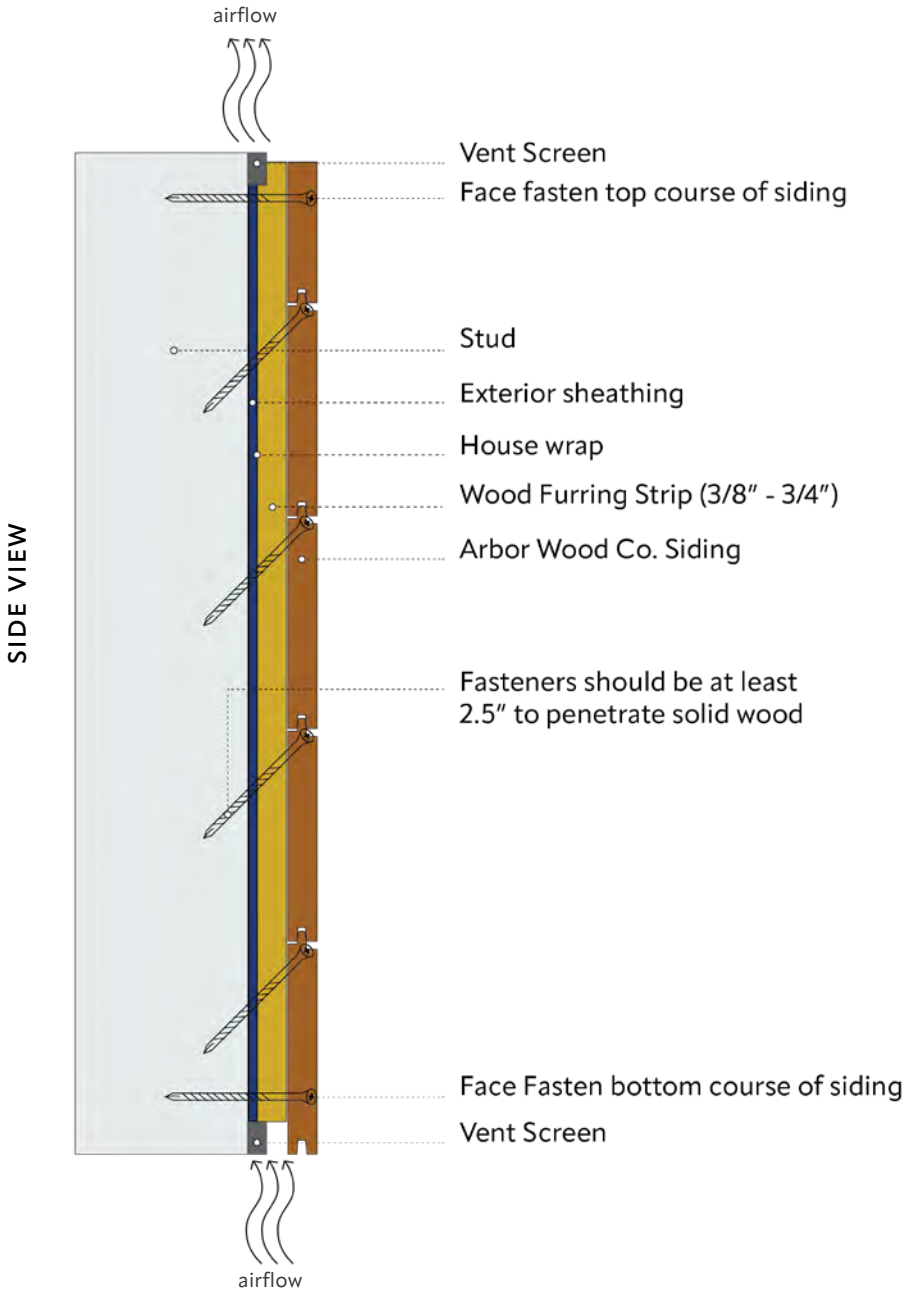

Cladding Spacing

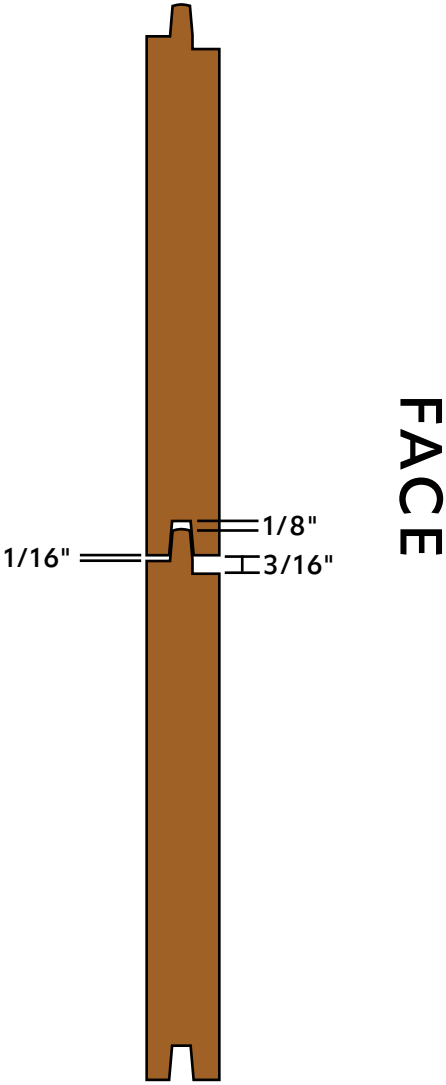

Thermally Modified Siding will expand slightly in the width as it adapts to your specific climate and location. This is a one-time event. Once adapted, the boards will remain stable, but care must be taken during installation to allow for this expansion. A $3/16"$ reveal gap should be provided between each board along with a $1/16"$ gap on the back side to allow for proper expansion and contraction during acclimation. Do not use a mallet or hammer to force boards into place. Failure to install with proper gaps may cause siding to buckle during expansion.



Standard Tongue & Groove Horizontal Installation - Wood Furring, Front View

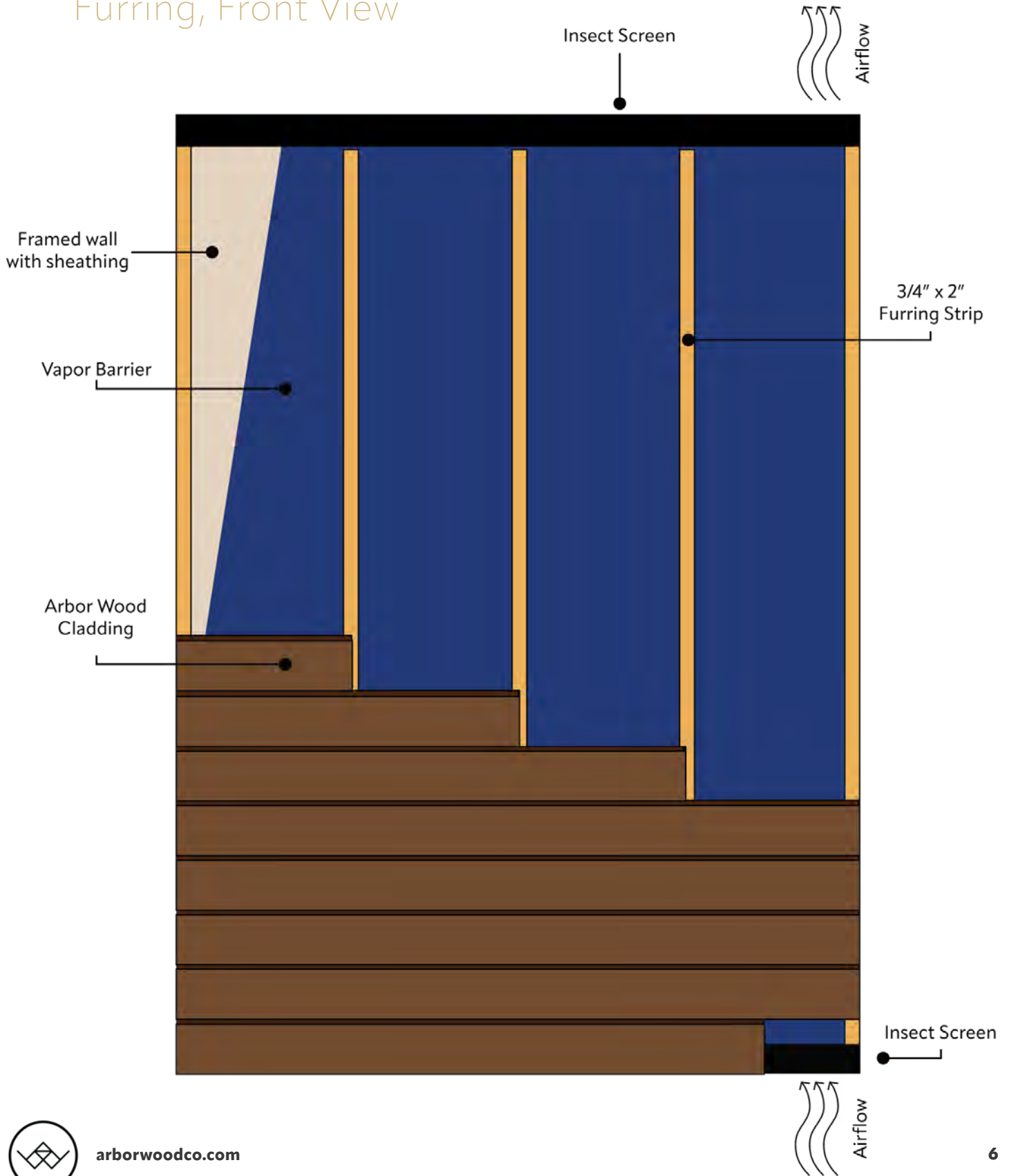

Standard Tongue & Groove Horizontal Installation - Quarrix ProTect, Front View

Please refer to the appendix for manufacturer recommendations

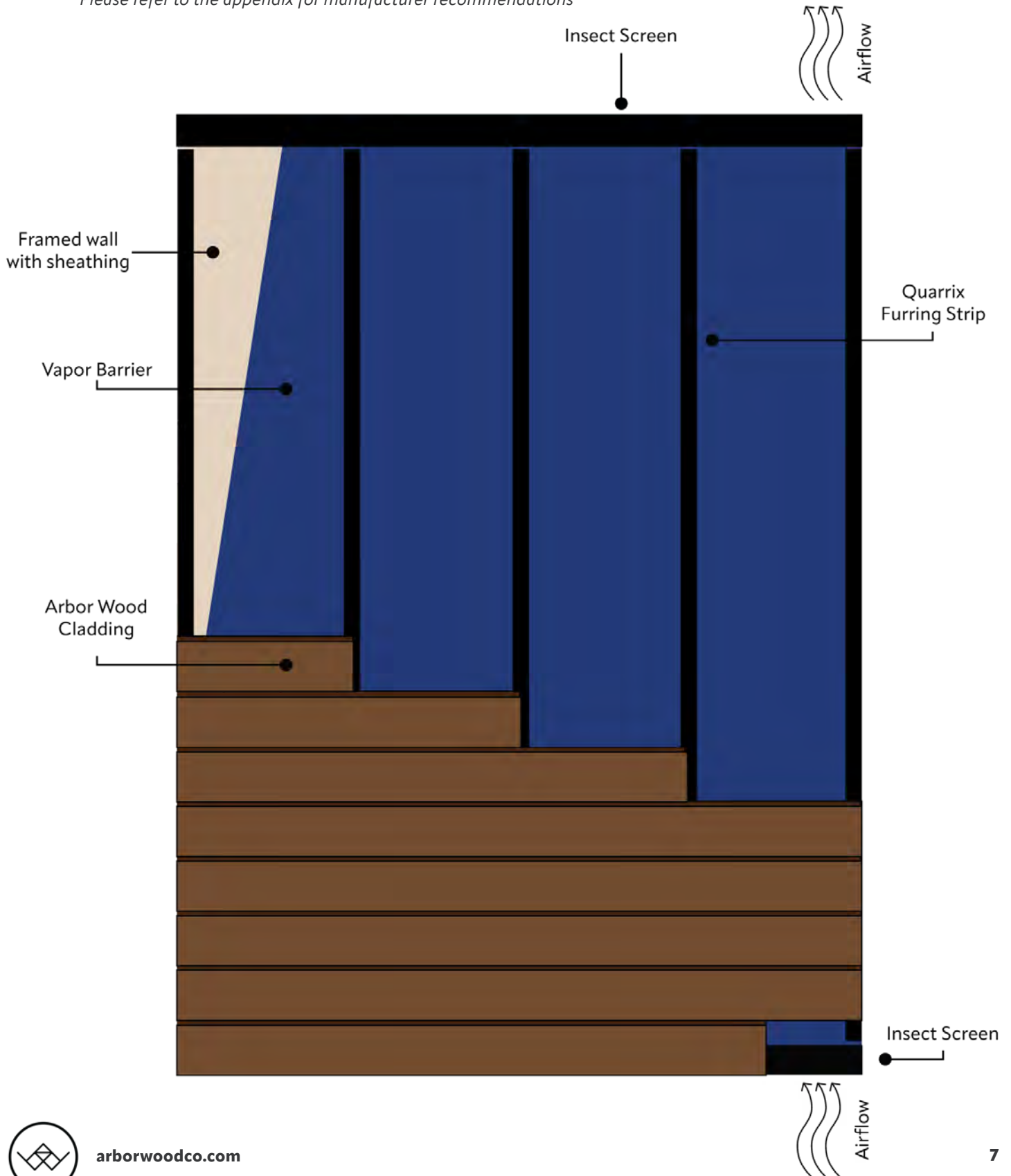

Standard Tongue & Groove Vertical Installation - Quarrix ProTect, Front View

Please refer to the appendix for manufacturer recommendations

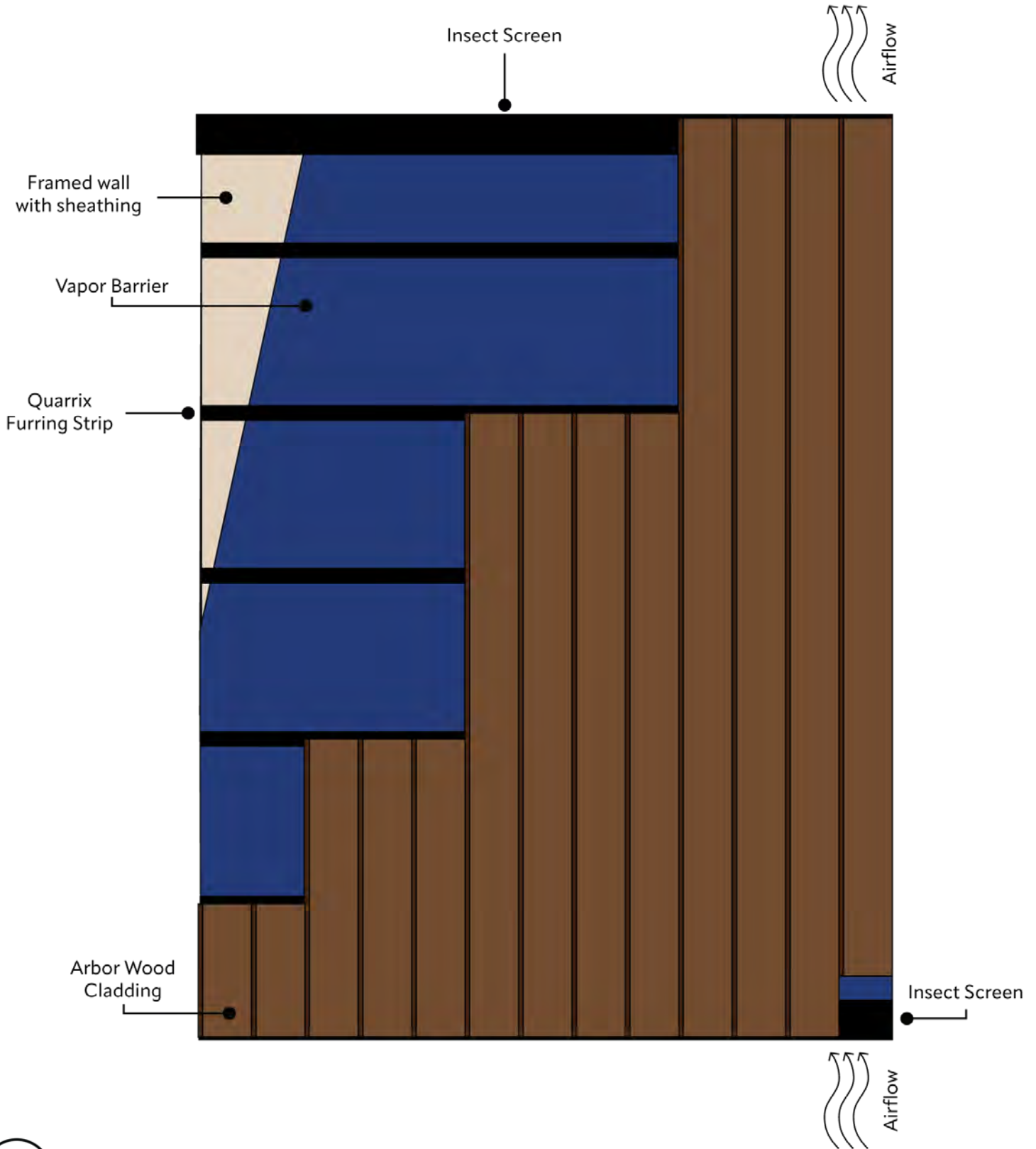

Standard Tongue & Groove Vertical Installation – Counter-Batten Wood Furring, Front View

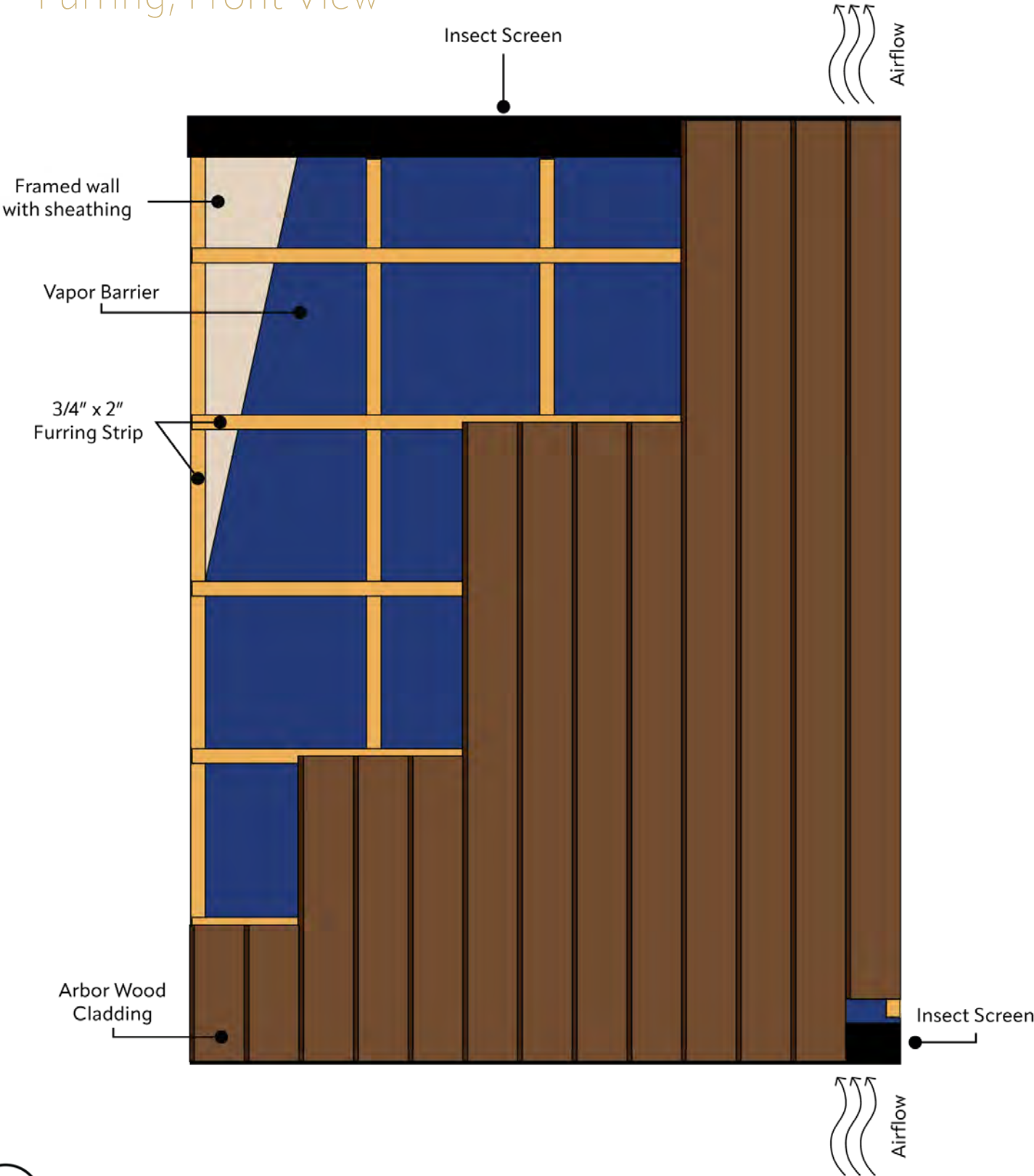

Portal Opening Recommendations

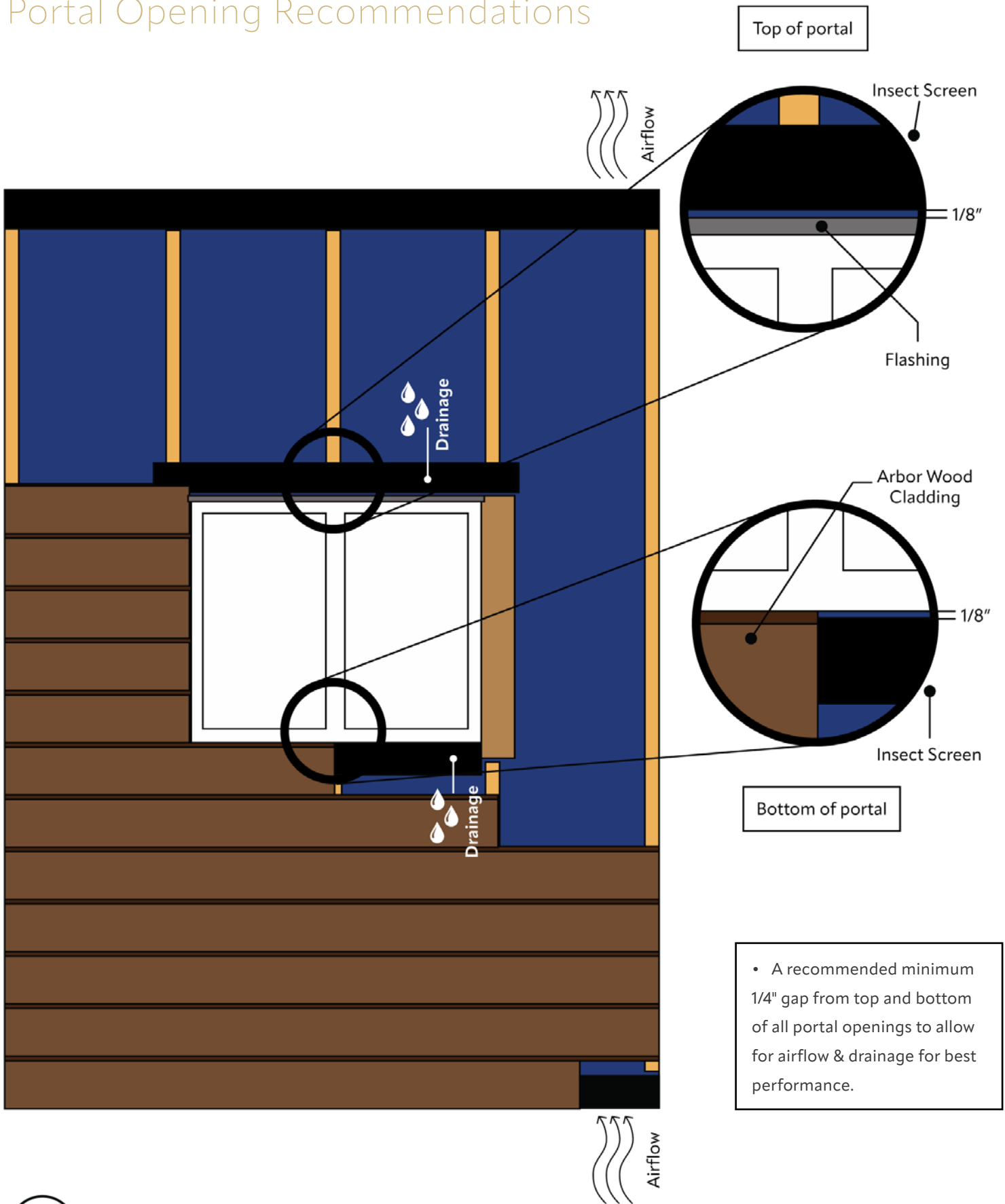

Corner Detail Installation

Arbor Wood Co. provides a variety of potential options for corner detailing during installation of our siding products. The following options are not an exhaustive list, rather, a guide to the potential options available for your consideration.



Corner Detail – Butting with 5/4 & 2x Material

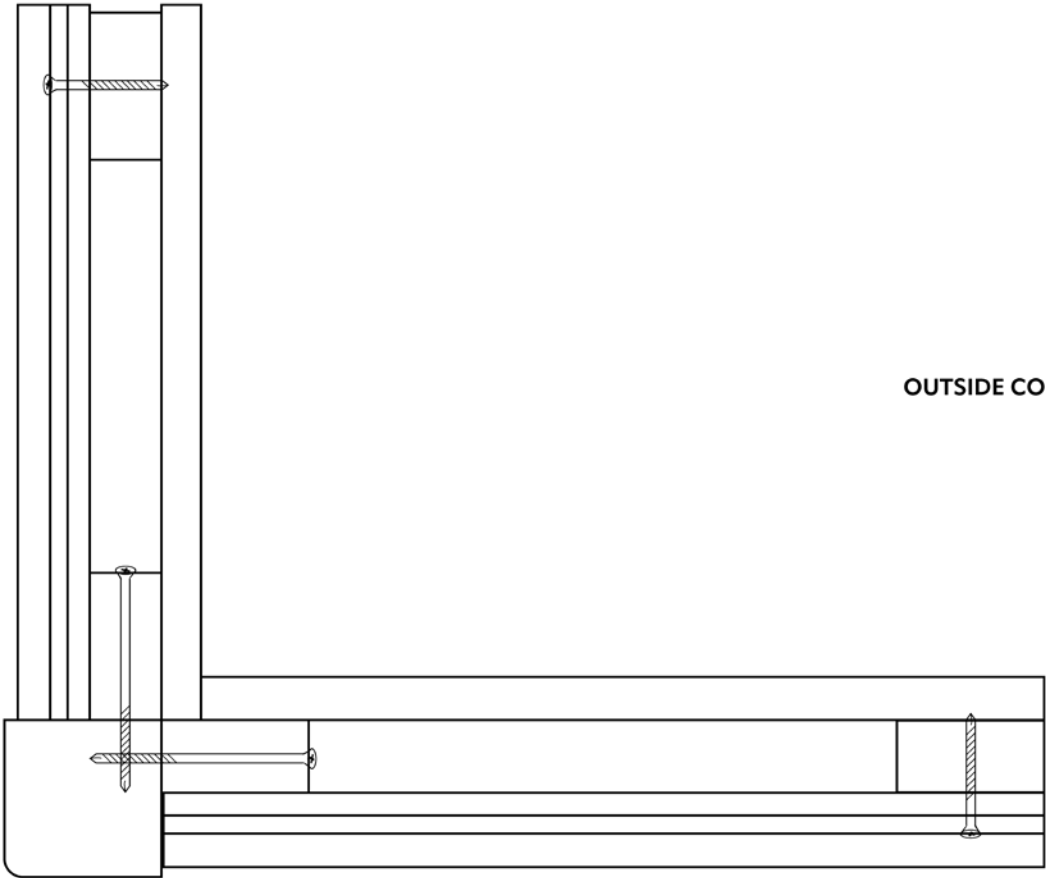

OUTSIDE CORNER

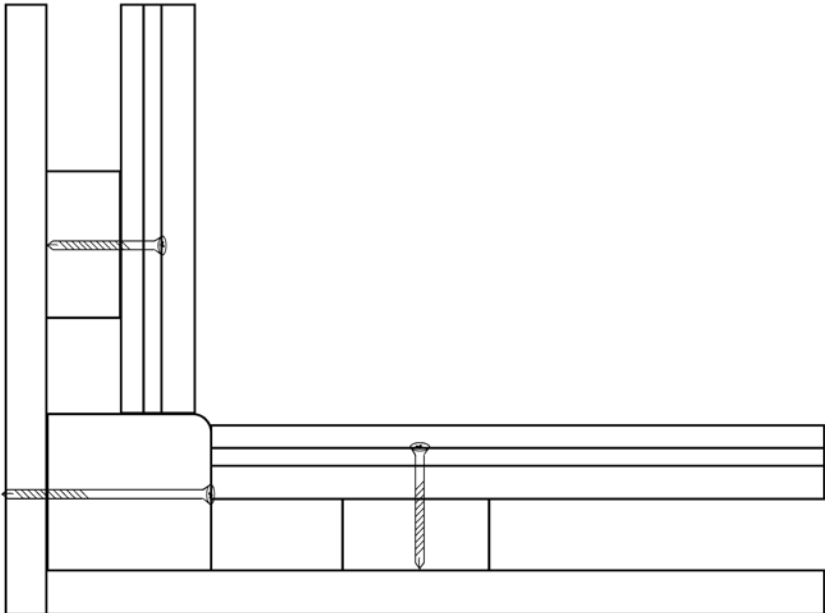

INSIDE CORNER



Corner Detail – Miter Gap

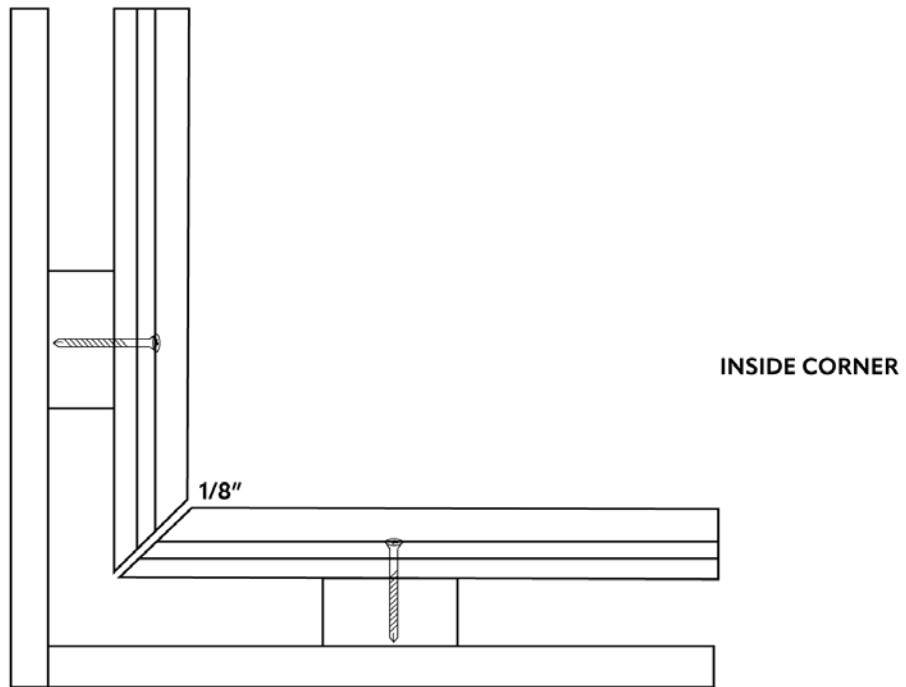
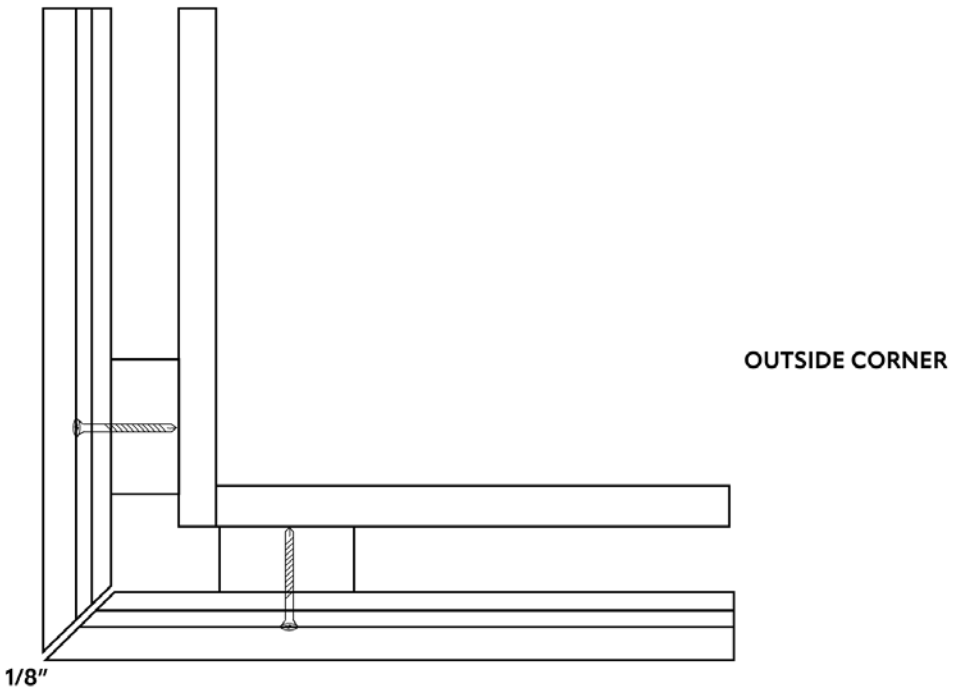

Soffit Detail

Top & bottom should not be obstructed. Allow for a minimum 1/4" gap from soffit.

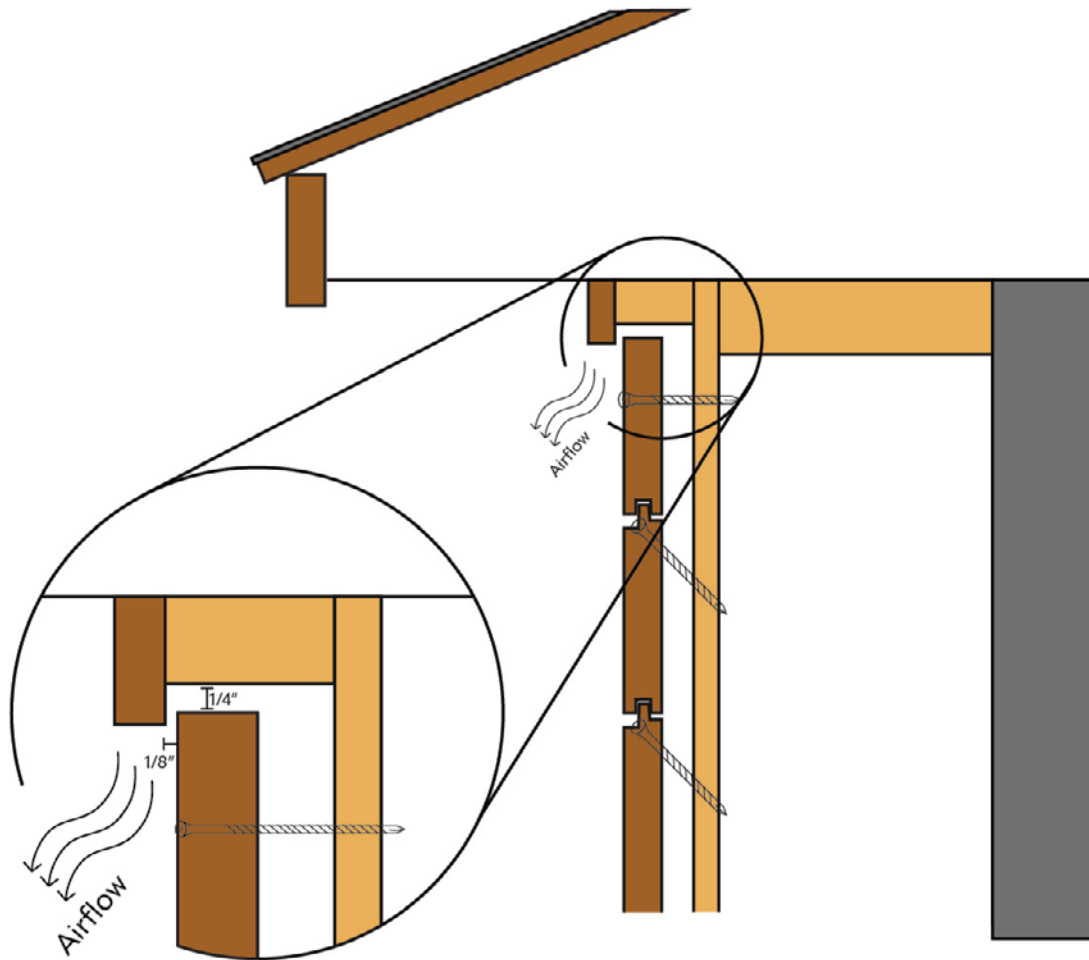

FURRING STRIPS

Overview

Protecting homes from trapped moisture is critical. Quarrix Furring Strips allow moisture and air to pass freely behind siding, creating a natural rain screen system. Made of plastic, Quarrix Furring Strips will not warp or split like similar wood products. They're also lighter and stronger than wood – making installation quick and easy – and are dimensionally die cut for identical pieces every time. Available in 1 1/2" wide sections.

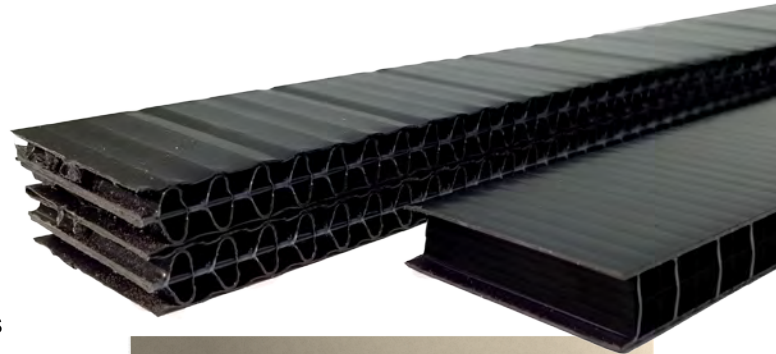

Quarrix Furring Strips Benefits

- More durable and lighter than wood furring strips; Quarrix Furring Strips won't warp or split.
- Extend life of siding and paint by eliminating heat and moisture build-up.
- Gun-nailable for fast installation.
- Can be used as a starter course strip with no need for a bug screen.
- Compatible with wood, fiber-cement, vinyl, stucco and EIFS systems.

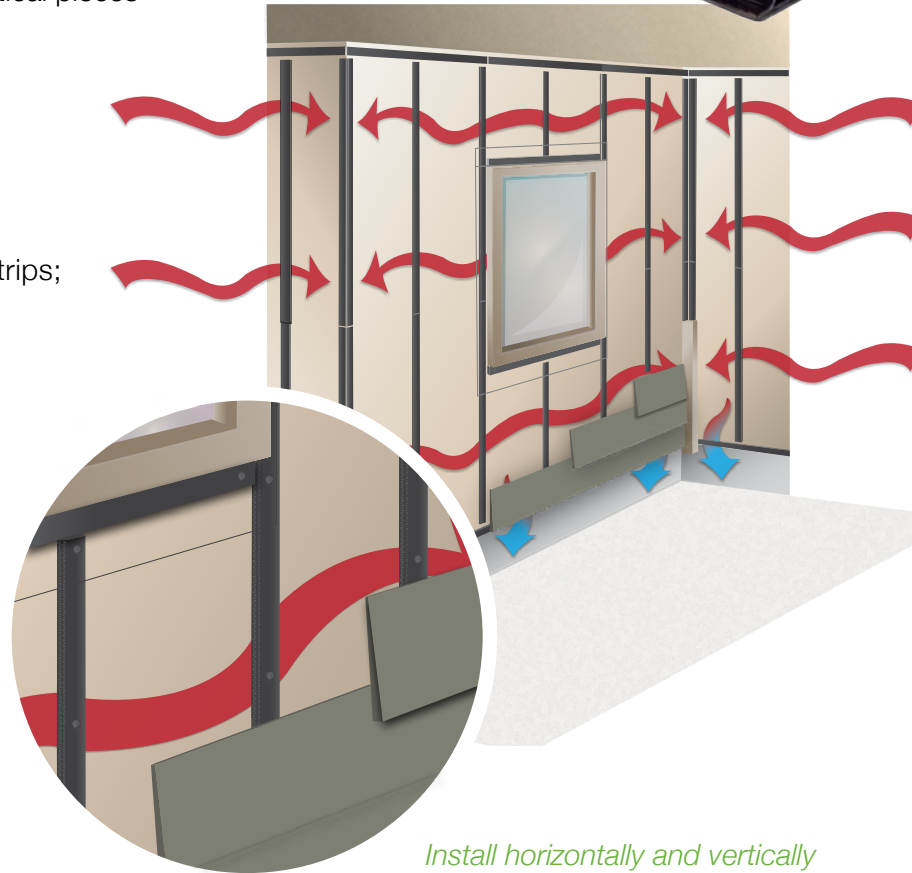

Install horizontally and vertically

FURRING STRIPS SPECIFICATIONS

Part #	Width	Length	Profile Height	Qty/Bundle	NFA	Material	Warranty
61106	1-1/2" (38 mm)	4' 4" Sections (1321 mm)	3/8" (10mm)	48	3.8 sq in/lineal ft (80.4 cm ² /lineal m)	Plastic	Lifetime Manufacturer's
40247	1-1/2" (38 mm)	8' 8" Fold-out Sections (2642 mm)	3/4" (19mm)	12	5.6 sq in/lineal ft (118.5 cm ² /lineal m)		

Quarrix Furring Strips Patents: 6,938,383; 7,117,649.

SS-FS13-1.10.17



Arbor Wood. **For Good.**

Arbor Wood Co.
1025 London Road
Duluth, MN 55802
855-414-2727

arborwoodco.com



**MADE IN
THE USA**