

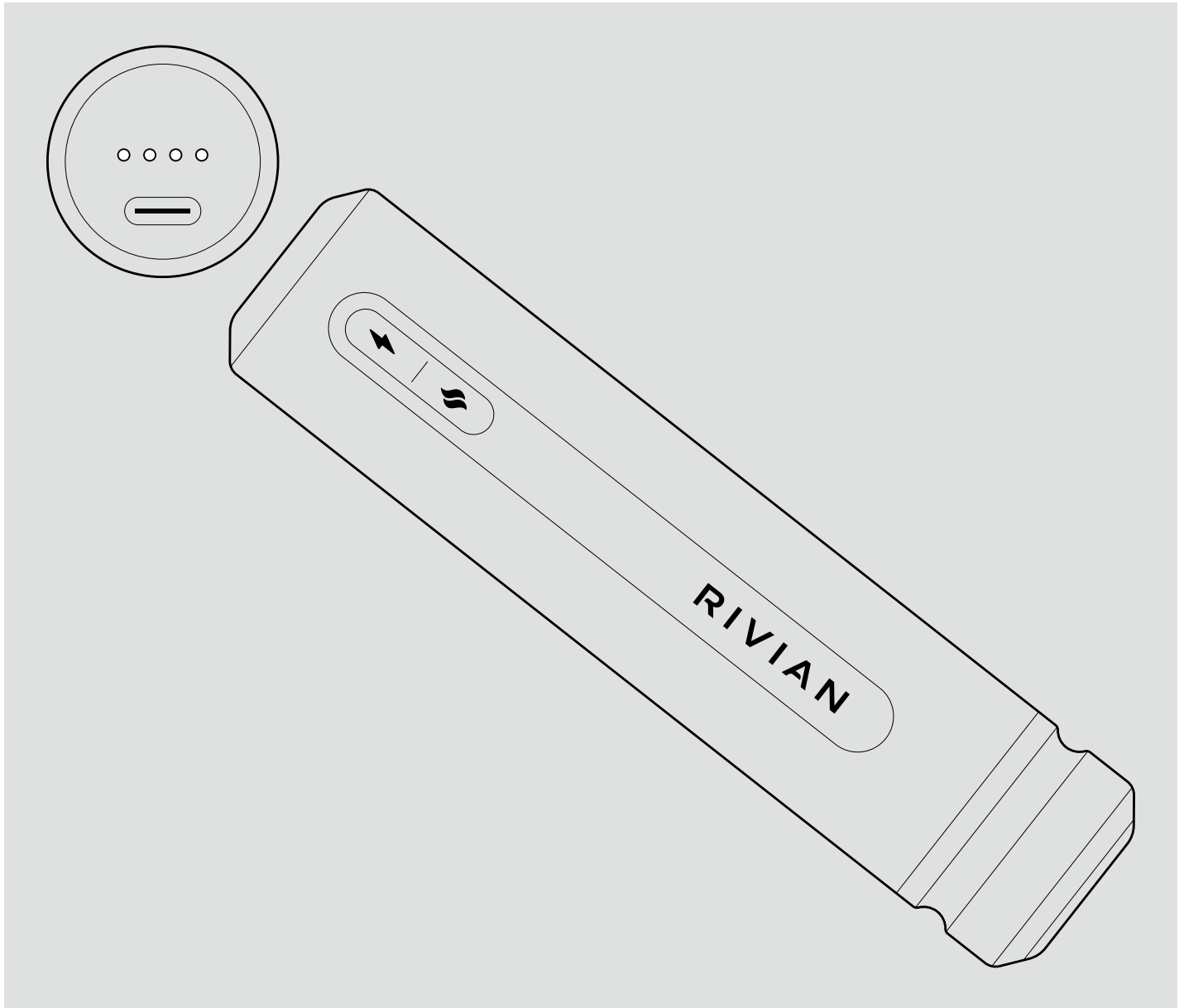

# Power Bank Guide



# RIVIAN

© 2024 Rivian Automotive, LLC. All rights reserved.

All information in this document and all Rivian software is subject to copyright and other intellectual property rights of Rivian Automotive, LLC, its affiliates, or its licensors. This material may not be modified, reproduced, or copied, in whole or in part, without the prior written permission of Rivian Automotive, LLC, its affiliates, or its licensors. Unless indicated otherwise, all trademarks are owned and registered by Rivian Automotive, LLC, its affiliates, or its licensors in the United States and/or other countries. Please visit <https://www.rivian.com/legal/brand> for Rivian's trademarks and service marks.

The images provided in this document are for illustrative purposes only. Depending on the product details and market region, the information in this document may appear slightly different from your product.

# Contents

<b>Safety Statements</b> .....	<b>4</b>
<b>About the Power Bank</b> .....	<b>5</b>
<b>Power Bank Specifications</b> .....	<b>5</b>
<b>Use the Power Bank</b> .....	<b>6</b>
Power Bank Mode .....	6
Hand Warmer Mode .....	6
<b>Charge the Power Bank</b> .....	<b>7</b>
Charge in Door Compartment .....	7
Charge with USB-C .....	7
Battery Charge Behavior .....	8
Battery Check .....	8
<b>Clean the Power Bank</b> .....	<b>9</b>
<b>Regulatory Information</b> .....	<b>9</b>
FCC Statement .....	9
<b>Adventure Gear Limited Warranty</b> .....	<b>9</b>
<b>Customer Service</b> .....	<b>10</b>

# Safety Statements



## **DANGER**

Use the power bank only in a dry location. Exposure to moisture or liquids may cause electric shock or fire.



## **DANGER**

Keep the power bank away from high heat sources and fire.



## **WARNING**

- To charge the power bank, use only the charging compartment on the driver-side door of a Rivian vehicle or a USB-C cable with a compatible power adapter.
- Don't use the power bank if there is any damage to it, the USB-C cable, or the power adapter.

## **IMPORTANT**

The rechargeable battery isn't replaceable. When the battery can no longer hold a charge, follow local regulations for the disposal of household hazardous waste.

# About the Power Bank

## NOTE

This is an optional Adventure Gear product. Learn more at [rivian.com](https://rivian.com).

The Power Bank can be used as a hand warmer, as well as to charge a device using its USB-C connection. It can be charged in the driver-side door compartment, or by using a USB-C cable connected to a power source.

## Power Bank Specifications

Specification	Description
Dimensions (length x width x height)	5.7 in x 1.2 in x 1.2 in (144.1 mm x 31.3 mm x 31.3 mm)
Weight	7.1 oz (202 g)
Charging time (0 to 100%)	<ul style="list-style-type: none"><li>• 5.2 hours from vehicle door compartment</li><li>• 3.2 hours from USB-C</li></ul>
Hand warmer battery life	<ul style="list-style-type: none"><li>• 5.5 hours on high</li><li>• 8 hours on low</li></ul>
IP rating	IP67
Max power	5 V/2 A input from vehicle charging compartment 5 V/3 A, 9 V/2 A, 12 V, 1.5 A, 7000 mAh from USB-C
Operating temperature range	-4°F to +140°F (-20°C to +60°C)
Storage temperature range	23°F to +95°F (-5°C to +35°C)
Charging temperature range	32°F to 113°F (0°C to 45°C)
Product number	PT01107933

# Use the Power Bank

## Power Bank Mode

The power bank has a USB-C connection that can be used to charge another device.

## Hand Warmer Mode

The power bank can be used as a hand warmer by single-pressing the **Heat** button (2) to cycle through the heat levels.

### NOTE

The hand warmer mode can't be used if the power bank is charging a device or being charged.

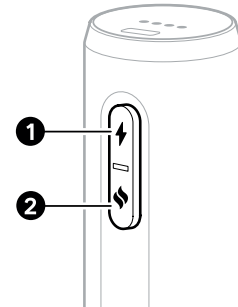

State	Action	LED Behavior	LED Status
Max heat	While hand warmer is off, press (2) for maximum heat	Second and third LEDs are solidly lit	
Low heat	While hand warmer is on maximum heat, press (2) for low heat	Second LED is solidly lit	
Off	While hand warmer is on low heat, press (2) to turn off hand warmer	All LEDs are off	

# Charge the Power Bank

## Charge in Door Compartment

The power bank can be charged when inserted into the driver-side door compartment.



### CAUTION

If the power bank is in the charging compartment, ensure that the power bank is completely seated before closing the driver-side door. If you close the door while the power bank sticks out, this may damage the door, door frame, or power bank.

1. Insert the power bank in the charging compartment of the driver-side door. Ensure that the end with the USB-C port is facing outside.
2. Press firmly until it clicks into place.

### NOTE

To release the power bank from the charging compartment, press firmly until the power bank pops out.

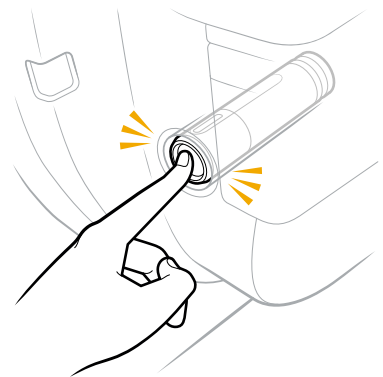

## Charge with USB-C

The power bank can be charged using a cable that attaches to its USB-C port.

1. Connect the USB-C end of the cable to the power bank.
2. Connect the other end of the cable to a power outlet.

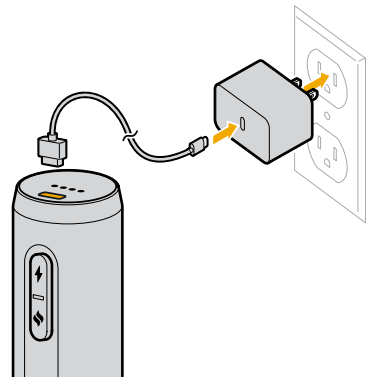



# Battery Charge Behavior

The following table shows the charging options and what the LED lights indicate.

State	LED Behavior	LED Status
<ul style="list-style-type: none"><li>• USB-C cord is inserted into power bank USB-C port</li><li>• Power bank is being docked in vehicle door compartment</li></ul>	LEDs flash in sequence	
<ul style="list-style-type: none"><li>• Power bank is being charged by USB-C</li><li>• Power bank is being charged in vehicle door compartment</li></ul>	<ul style="list-style-type: none"><li>• LEDs blink the percentage that's being charged</li><li>• LEDs stay solid when a corresponding percentage completes charging</li></ul>	
Power bank is charging a device by USB-C	<ul style="list-style-type: none"><li>• LEDs display battery level as solidly lit percentage</li><li>• LEDs turn off after 5 seconds</li></ul>	

# Battery Check

Check the battery level by single-pressing the **Battery** button (1).

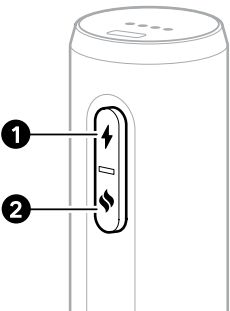

State	LED Behavior	LED Status
<ul style="list-style-type: none"><li>• Power bank is off</li><li>• Power bank is charging a device</li><li>• Power bank is in hand warmer mode</li></ul>	<ul style="list-style-type: none"><li>• LEDs flash in sequence</li><li>• LEDs display battery level</li><li>• LEDs time out after 1.5 seconds</li></ul>	
Power bank is in low battery mode	LEDs blink twice	
Power bank is charging	No action	

# Clean the Power Bank

Maintain the power bank by occasionally cleaning it with a damp cloth.



## **DANGER**

- Before cleaning, unplug the power bank from the power outlet to avoid the risk of electric shock.
- Don't use compressed air to clean the power bank.

# Regulatory Information

## FCC Statement



## **CAUTION**

Changes or modifications not expressly approved by the manufacturer could void the user's authority to operate this equipment.

This device complies with Part 15 of the FCC Rules. Operation is subject to the following two conditions:

1. This device may not cause harmful interference, and
2. This device must accept any interference received, including interference that may cause undesired operation.

# Adventure Gear Limited Warranty

Refer to the *Adventure Gear Limited Warranty Guide* for warranty information.

**RIVIAN**

Still need help? Connect with us.

## **Customer Service**

Call (888) RIVIAN1 / (888) 748-4261

[customerservice@rivian.com](mailto:customerservice@rivian.com)

[rivian.com](https://rivian.com) Support Center and Chat