



PARK LANE, MAYFAIR, W1K
£895 per week*

Carter Jonas

FLAT 68, PARK LANE, MAYFAIR, LONDON, W1K

- Prime Mayfair location opposite Hyde Park
- Refurbished to a high standard and presented in excellent condition
- Prestigious portered building with 24-hour concierge
- Third-floor apartment with lift access
- Excellent transport links nearby

THE PROPERTY

Situated within one of Mayfair's most sought-after residential buildings, this beautifully presented one-bedroom apartment offers approximately 531 sq ft of stylish and well-appointed living accommodation.

Located on the third floor and accessed via lift, the apartment has been refurbished to a high standard and is presented in excellent condition throughout. The accommodation comprises a bright and spacious reception room, a well-equipped kitchen, a generously sized double bedroom, and a contemporary bathroom finished to a high specification.

Residents benefit from the convenience and security of a 24-hour concierge service, while the building's prime position opposite Hyde Park places one of London's most iconic green spaces directly on the doorstep.

Mayfair remains one of London's most prestigious and desirable neighbourhoods, renowned for its elegant architecture, luxury hotels, Michelin-starred restaurants, exclusive boutiques and vibrant cultural scene. The area offers a unique blend of village charm and cosmopolitan living, with the amenities of Oxford Street, Bond Street and Park Lane all within easy reach.

Excellent transport connections are available from nearby Marble Arch Underground Station and Hyde Park Corner Underground Station, providing convenient access across London and beyond.

A beautifully presented one-bedroom apartment extending to approximately 531 sq ft, positioned on the third floor of one of Mayfair's most prestigious residential buildings. Benefitting from lift access and a 24-hour concierge service.



ADDITIONAL INFORMATION

Viewing Strictly by appointment

Local Authority Westminster City Council - Council Tax Band F

APT

The deposit will be £4,475 at a rental value of £895 (asking price).

Holding deposit = 1 weeks rent of £895

Deposit is 5 weeks rent (£895 pw = £4,475 deposit)

Council Tax Band F

Hot water - communal

Heating – air source heat pump, warm air electric

Copper Broadband

Energy Efficiency Rating		Current	Potential
Very energy efficient - lower running costs			
(92+)	A		
(81-91)	B		
(69-80)	C	71	73
(55-68)	D		
(39-54)	E		
(21-38)	F		
(1-20)	G		
Not energy efficient - higher running costs			
England, Scotland & Wales		EU Directive 2002/91/EC	



Flat 68

55 Park Lane, W1K

Gross internal area (approx)

49.33 sq m (531 sq ft)

For Identification purposes Only. Not To Scale.

All Calculations include Any/All Areas Under 1.5m Head Height.
* As Defined by RICS - Code of Measuring Practice.

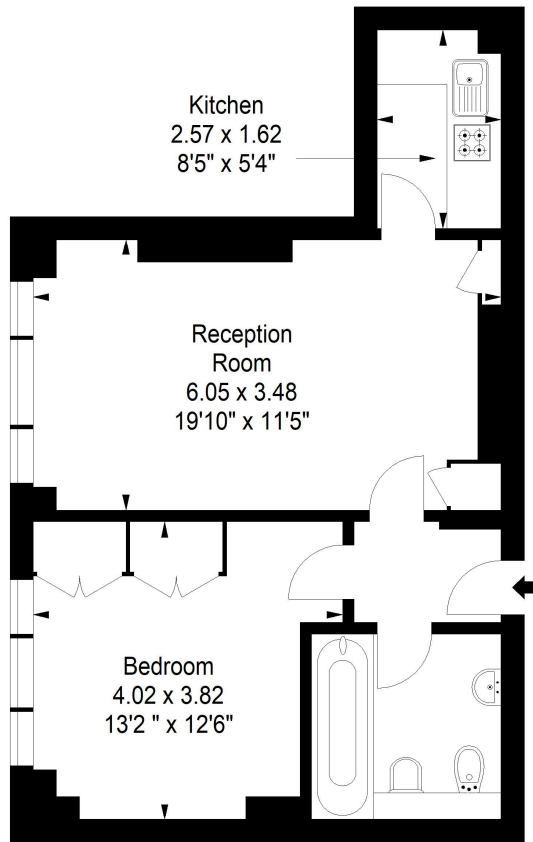

Third Floor

T: 020 7493 0676

18 Davies Street, Mayfair, London, W1K 3DS

E: mayfair.lettings@carterjonas.co.uk



Exclusive UK affiliate of

CHRISTIE'S
INTERNATIONAL REAL ESTATE

Classification L2 - Business Data



IMPORTANT INFORMATION

These particulars are for general information purposes only and do not represent an offer or contract or part of one. Carter Jonas or anyone in their employment has made every attempt to ensure that the particulars and other information provided are as accurate as possible and they are not intended to amount to advice on which you should rely as being factually accurate. Full information which may be relevant to your decision regarding the property can be found on the property listing on carterjonas.co.uk or a separately available material information sheet, and we would advise you to confirm the details of any material information prior to any offer being submitted. You should not assume that the property has all necessary planning, building regulations or other consents and Carter Jonas has not tested any services, facilities, or equipment. Any measurements and distances given are approximate only. Where Carter Jonas has been provided with a floorplan by a third party, we cannot guarantee that the floorplan has been measured in accordance with IPMS. Purchasers or prospective tenants must satisfy themselves of all of the aforementioned by independent inspection or otherwise. Our images only represent part of the property as it appeared at the time they were taken and do not represent the furnishings included; these are confirmed in a separate inventory. If you require further information, please contact us. *Administration fees may apply depending on tenancy type. Please contact your local branch for this information.