



Land at Ashley Heath

Ashley Heath, Dorset

Carter Jonas

Land at Ashley Heath Horton Road Dorset

Mixed amenity land adjacent to Moors Country Park let on two Landlord and Tenant 1954 Act agreements.

A unique opportunity to acquire a parcel of land let on two Landlord and Tenant 1954 act agreements to Dorset Council with a total rent passing of £8,217.61 p.a. The land includes mixed rough pasture and a children's 4x4 track run in conjunction with the adjacent Moors Country Park.

In all extending to 13.75 acres (5.56 hectares).

For sale by private treaty as a whole.

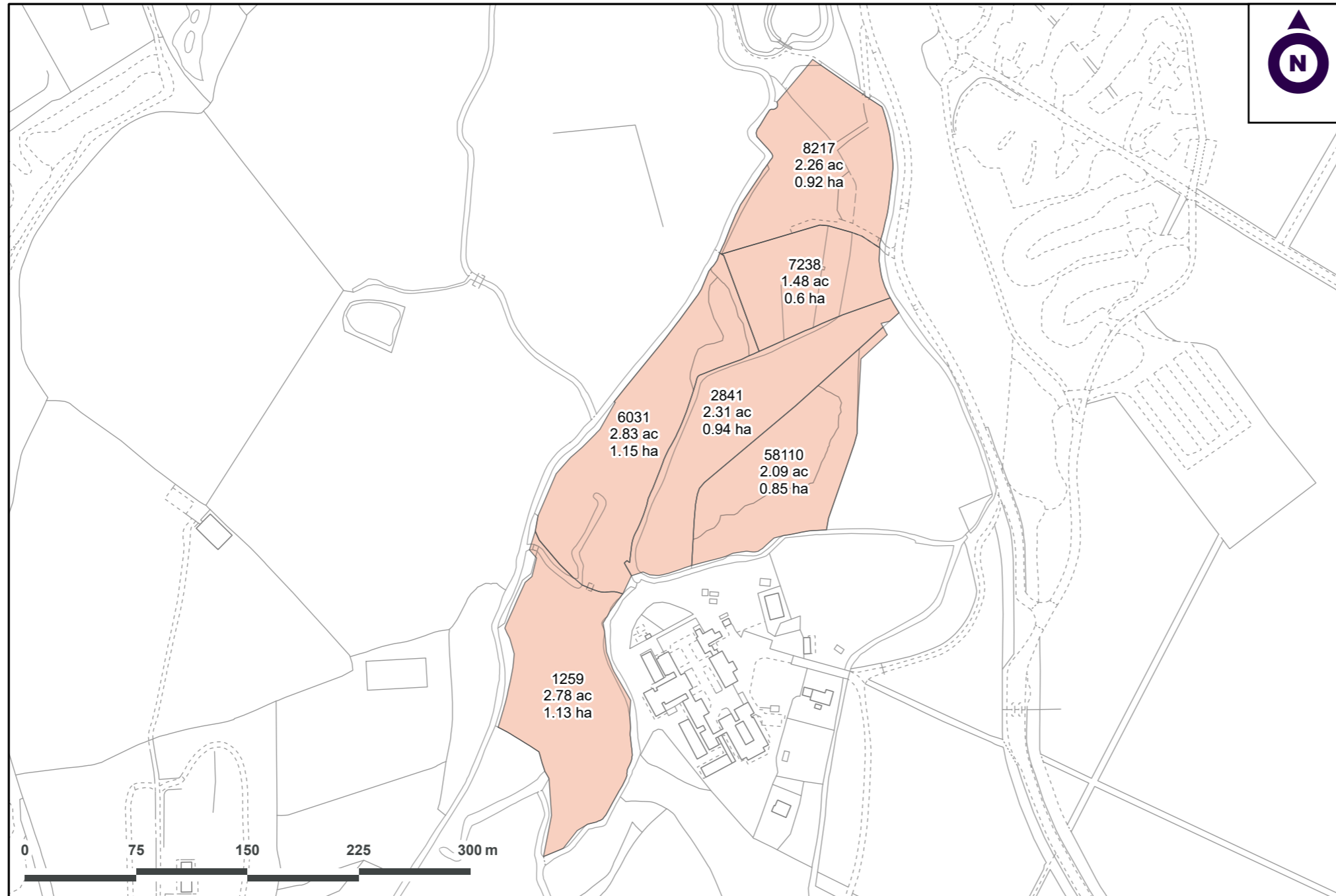

Location

Ashley Heath is a small village in Dorset. It lies 2 miles west of Ringwood and 12 miles north east of Bournemouth.

The land is accessed through the entrance to Moors Valley Country Park.

Amenities

Ashley Heath offers the basic range of amenities. The nearby Bournemouth offers a full range of amenities including but not limited to shops, restaurants and petrol stations.

Land

The land comprises 13.75 acres (5.56 ha) of mainly pasture with some shelter belts and small parcels of woodland.

The land is bordered to the west by Moors River and therefore large parts of the land are liable to flooding in the autumn and winter months.

The land currently benefits from a children's 4x4 track to the north which we understand is a tenant's fixture.

The land is seen as an investment opportunity but also, subject to obtaining possession, has the potential for agricultural and amenity uses.

Method of Sale

For sale as a whole by private treaty.

Tenure & Possession

The land is for sale subject to the benefit of two Landlord and Tenant 1954 Act agreements to Dorset Council with a total rent passing of £8,217.61 p.a.

More information is available upon request.

Designations

Part of the land sits within the Moors River System Site of Special Scientific Interest, and the whole sits within a Site of Special Scientific Interest Impact Zone.

Parts of the land sit within Flood Zones 2 and 3.

Services

There are no services to the property that we are aware of.

Wayleaves Easements & Rights of Way

The property is sold subject to the benefit of all rights including rights of way, whether public or private, light, support, drainage, water and electricity supplies and other rights and obligations, easements and proposed wayleaves from masts, pylons, stays, cables, drains, water, gas and other pipes, whether specifically referred to or not.

There are poles across the land for which we assume there are wayleave agreements in place for.

Health & Safety

All viewings are carried out at the sole risk of the viewer and neither the selling agents nor the vendor takes responsibility.

Sporting, Timber & Mineral Rights

The sporting, mineral and timber rights are included in the sale of the freehold in so far as that are owned.

Local Authority

Dorset Council
www.dorsetcouncil.gov.uk

Viewings

Viewings are unaccompanied but on prior notification to the selling agent.

Parties should note that access is through Moors Valley Country Park and therefore all appropriate parking charges will apply.

Directions

From Ashley Heath, head west on the Horton Road for approximately 0.5 miles. Turn right at the sign to Moors Valley Country Park. Continue straight over the roundabout and through the barriers. Take the next left and continue for 0.1 miles. The entrance gate is on the left.



///itself.refusals.winks

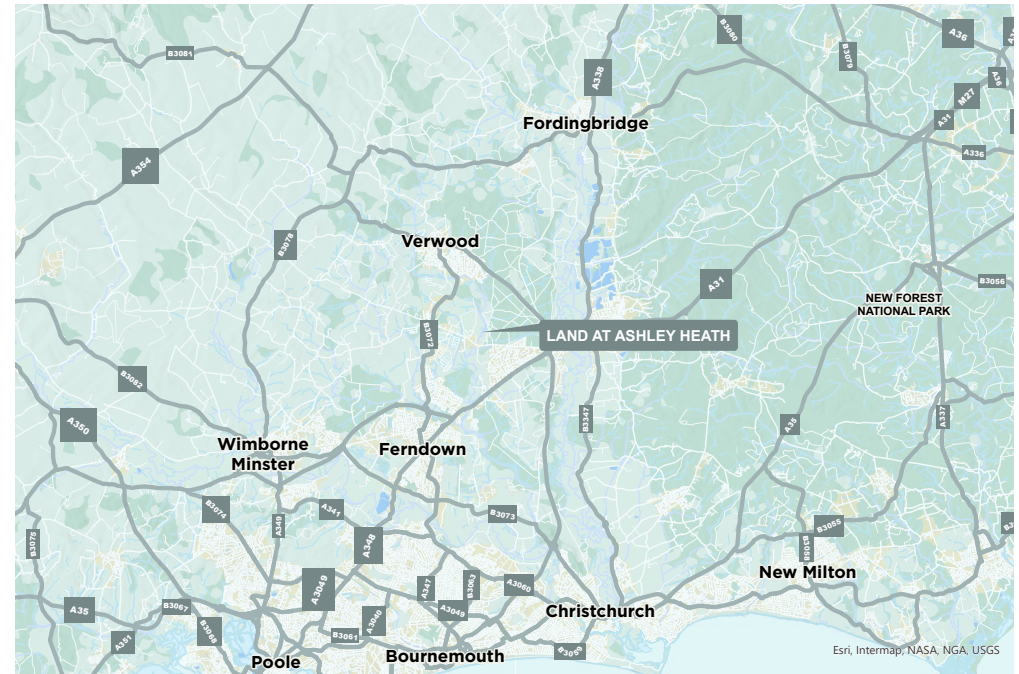

Winchester

07977 705 276 | megan.stacey@carterjonas.co.uk
07880 084 633 | andrew.chandler@carterjonas.co.uk
3 Royal Court, Kings Worthy, Winchester, SO23 7TW

Important Information

These particulars are for general information purposes only and do not represent an offer of contract or part of one. Carter Jonas has made every attempt to ensure that the particulars and other information provided are as accurate as possible and are not intended to amount to advice on which you should rely as being factually accurate. You should not assume that the property has all necessary planning, building regulations or other consents and Carter Jonas have not tested any services, facilities or equipment. Any measurements and distances given are approximate only. Purchasers must satisfy themselves of all of the aforementioned by independent inspection or otherwise. Although we make reasonable efforts to update our information, neither Carter Jonas LLP nor anyone in its employment or acting on its behalf makes any representations warranties or guarantees, whether express or implied, in relation to the property, or that the content in these particulars is accurate, complete or up to date. Our images only represent part of the property as it appeared at the time they were taken. If you require further information please contact us.

carterjonas.co.uk

Offices throughout the UK



Carter Jonas

Exclusive UK affiliate of
CHRISTIE'S
INTERNATIONAL REAL ESTATE