



MAGDALEN ROAD, LONDON, SW18

£1,650,000

Carter Jonas

MAGDALEN ROAD, LONDON, SW18

A beautifully renovated five-bedroom house with a fantastic south facing 60ft garden in the highly sought-after Magdalen Estate. It is also within walking distance to Wandsworth Common and the existing catchment of Beatrix Potter School.

This lovely wide and extended house benefits from a welcoming and spacious hallway with an elegant ground floor living space overlooking an enviably large garden. The house also benefits from off-street parking. On the first floor the house comprises of 3 bedrooms and a family bathroom. The top floor (also recently renovated by the current owners) comprises of two further bedrooms and guest bathroom.

Magdalen Road runs from Trinity Road/Wandsworth Common to Earlsfield offering easy access to Wandsworth Common (0.6 miles) and Earlsfield (0.8 miles) mainline stations. The area is popular with families and is known for offering wider houses with larger gardens and close to good schools both in the State and Independent sector

AMENITIES

- Five-bedroom house
- Fully extended loft and ground floor
- Large kitchen-family room
- Approximately 60 ft south facing garden
- Approximately 2,000 + sq ft
- Garden studio
- Off-street parking including EV charging unit
- Close to Wandsworth Common and Earlsfield
- Within catchment of Beatrix Potter School

TENURE Freehold

LOCAL AUTHORITY London Borough of Wandsworth

EPC BAND E

A BEAUTIFULLY RENOVATED FIVE BEDROOM HOUSE WITH A FANTASTIC SOUTH FACING 60FT GARDEN IN THE HIGHLY SOUGHT-AFTER MAGDALEN ESTATE. IT IS ALSO WITHIN WALKING DISTANCE TO WANDSWORTH COMMON.





Magdalen Road, SW18

Approximate Gross Internal Area = 166.2 sq m / 1790 sq ft
 (Excluding Areas With Reduced Headroom & Eaves)
 Garden Room / Shed = 18.1 sq m / 195 sq ft
 Reduced Headroom & Eaves = 21.5 sq m / 231 sq ft
 Total = 205.8 sq m / 2216 sq ft



Ground Floor
80.7 sq m / 869 sq ft

This marketing plan is for layout guidance only. Not drawn to scale unless stated. Windows and door openings are approximate. Whilst every care is taken in the preparation of this plan, please check all dimensions, shapes and compass bearings before making any decisions reliant upon them.



Second Floor
49.8 sq m / 536 sq ft

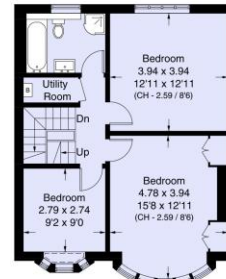

First Floor
57.2 sq m / 616 sq ft

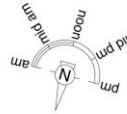

Carter Jonas

Exclusive UK affiliate of
CHRISTIE'S
 INTERNATIONAL REAL ESTATE

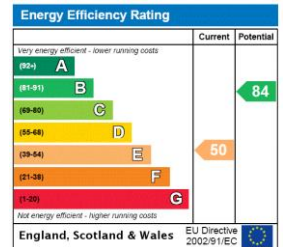

Wandsworth Sales 020 8767 7711

wandsworthresales@carterjonas.co.uk
 19 Bellevue Road, London, SW17 7EG

carterjonas.co.uk
 Offices throughout the UK

Exclusive UK affiliate of
CHRISTIE'S
 INTERNATIONAL REAL ESTATE

IMPORTANT INFORMATION

These particulars are for general information purposes only and do not represent an offer or contract or part of one. Carter Jonas or anyone in their employment has made every attempt to ensure that the particulars and other information provided are as accurate as possible and they are not intended to amount to advice on which you should rely as being factually accurate. Full information which may be relevant to your decision regarding the property can be found on the property listing on carterjonas.co.uk or, (including off market properties) on the brochure or a separately available material information sheet. We would advise you to confirm the details of any material information prior to any offer being submitted. You should not assume that the property has all necessary planning, building regulations or other consents and Carter Jonas has not tested any services, facilities or equipment. Any measurements and distances given are approximate only. Where Carter Jonas has been provided with a floorplan by a third party, we cannot guarantee that the floorplan has been measured in accordance with IPMS. Purchasers must satisfy themselves of all of the aforementioned by independent inspection or otherwise. Our images only represent part of the property as it appeared at the time they were taken and do not represent the furnishings included; these are confirmed in a separate inventory. If you require further information, please contact us.