



WALTON CRESCENT, OXFORD, OX1

£2,000 per month*

Carter Jonas

WALTON CRESCENT, OXFORD, OX1 2JQ

A split-level apartment in a Victorian converted house located in central Jericho with a private entrance and private garden.

- 2 bedrooms
- 1 reception
- 1 bathroom
- kitchen/breakfast room
- private entrance
- private garden
- split level
- unfurnished
- Victorian conversion
- Professionally managed

THE PROPERTY

The property is accessed via a pathway to the private rear garden with steps down into the kitchen/breakfast room. The kitchen is well equipped with integrated appliances and space to dine and a spiral staircase to the upper floor. Sitting room with natural light from the large sash windows. The upper floor has a large main bedroom with built in storage, a single bedroom/study and a modern bathroom with a shower over the bath.

The property is available mid July on an unfurnished basis and is eligible for on-street parking permits.

Jericho is a vibrant and lively place to live and highly desirable with its close proximity to the city centre.

Mains electricity, mains gas, mains water and drainage.

Internet & Mobile: Further information on availability and speeds can be found at checker.ofcom.org.uk

Council Tax Band: D - please check with Oxford City Council for current charges

EPC: D

Unfurnished

Flood risk: Low



Holding deposit = 1 weeks rent £461

Deposit is 5 weeks rent = £2307

ADDITIONAL INFORMATION

Viewing Strictly by appointment

Local Authority Oxford City Council - Council Tax Band D

Directions



Approximate Gross Internal Area 657 sq ft - 61 sq m

Lower Ground Floor Area 344 sq ft – 32 sq m

Ground Floor Area 313 sq ft – 29 sq m

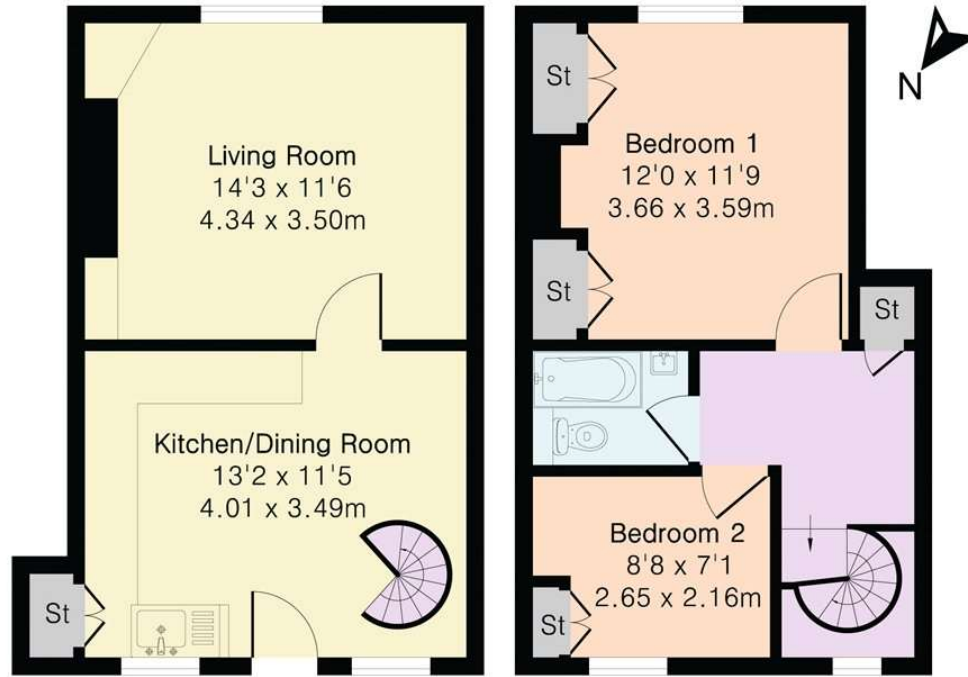

Lower Ground Floor

Ground Floor



Floor plan produced in accordance with RICS Property Measurement 2nd Edition. Although Pink Plan Ltd ensures the highest level of accuracy, measurements of doors, windows and rooms are approximate and no responsibility is taken for error, omission or misstatement. These plans are for representation purposes only and no guarantee is given on the total square footage of the property within this plan. The figure icon is for initial guidance only and should not be relied on as a basis of valuation.

Carter Jonas

T: 01865 511444

Mayfield House, 256 Banbury Road, Oxford, Oxfordshire, OX2 7DE

E: oxford.lettings@carterjonas.co.uk

A member of



Exclusive UK affiliate of

CHRISTIE'S
INTERNATIONAL REAL ESTATE

Classification L2 - Business Data



IMPORTANT INFORMATION

These particulars are for general information purposes only and do not represent an offer or contract or part of one. Carter Jonas or anyone in their employment has made every attempt to ensure that the particulars and other information provided are as accurate as possible and they are not intended to amount to advice on which you should rely as being factually accurate. Full information which may be relevant to your decision regarding the property can be found on the property listing on carterjonas.co.uk or a separately available material information sheet, and we would advise you to confirm the details of any material information prior to any offer being submitted. You should not assume that the property has all necessary planning, building regulations or other consents and Carter Jonas has not tested any services, facilities, or equipment. Any measurements and distances given are approximate only. Where Carter Jonas has been provided with a floorplan by a third party, we cannot guarantee that the floorplan has been measured in accordance with IPMS. Purchasers or prospective tenants must satisfy themselves of all of the aforementioned by independent inspection or otherwise. Our images only represent part of the property as it appeared at the time they were taken and do not represent the furnishings included; these are confirmed in a separate inventory. If you require further information, please contact us. *Administration fees may apply depending on tenancy type. Please contact your local branch for this information.