



SOUTH AUDLEY STREET, LONDON, W1K
£1,200,000

Carter Jonas

SOUTH AUDLEY STREET, LONDON, W1K

A BEAUTIFULLY REFURBISHED LATERAL APARTMENT SET WITHIN THE DISTINGUISHED CHESTERFIELD HOUSE

This elegant lower ground residence has been meticulously finished to a high standard throughout. The property features a generously proportioned double bedroom, a contemporary family bathroom, and a spacious open plan kitchen, dining and reception room that enjoys serene views over the communal garden.

Chesterfield House is regarded as one of Mayfair's most prestigious residential buildings. Constructed in the 1930s, it stands on the historic site of the original Georgian mansion built between 1748 - 49, from which it takes its name. Upon completion, the building was celebrated as "Mayfair's finest flats," a reputation it continues to uphold as one of the West End's most distinguished portered addresses.

Perfectly positioned in the heart of Mayfair, Chesterfield House is moments from Curzon Street and parallel to the world renowned Park Lane, with the vibrant offerings of Piccadilly just a short stroll away. Its exceptional location, combined with its heritage and level of service, makes this one of the area's most desirable residences.

* The apartment is virtually staged, the furniture in these images is computer generated (CGI).

Service Charge: £5,318 approx per annum (2025/26)

Ground Rent: £25 per annum

Heating and Hot Water: Community Scheme

Parking: On street may be available:
<https://www.westminster.gov.uk/parking/parking-residents>

Mobile phone coverage and speeds can be checked here:
checker.ofcom.org.uk, however, all providers are predicted to have good levels of service inside at this property.

Broadband speeds can be checked here: checker.ofcom.org.uk.

TENURE Leasehold (Expiry 25/03/3017)

LOCAL AUTHORITY Westminster City Council





Chesterfield House, W1K 1HA

Approx Gross Internal Area = 60.6 sq m / 652 sq ft

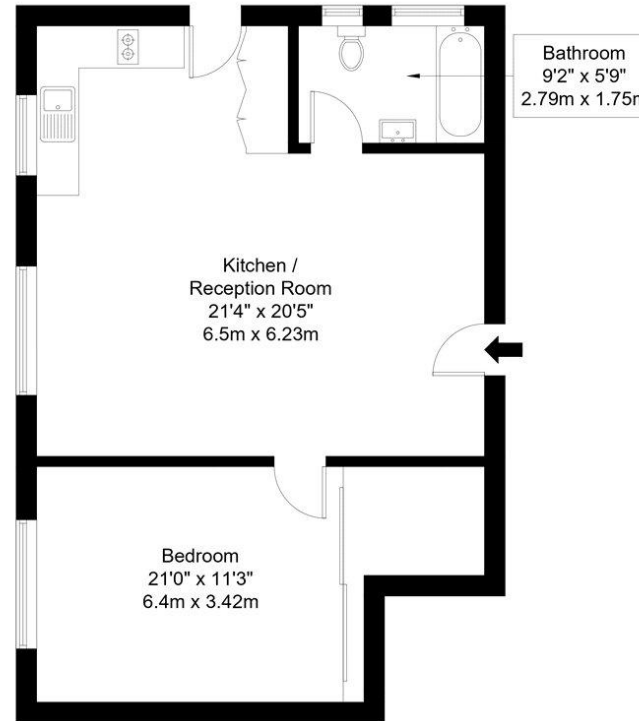

Lower Ground Floor

Ref :

Copyright **BLEU
PLAN**

The Floor plan is not to scale and measurements and areas shown are approximate and therefore should be used for illustrative purposes only. The plan has been prepared in accordance with the RICS code of Measuring Practice and whilst we have confidence in the information produced it must not be relied on. Maximum lengths and widths are represented on the floor plan. If there is any aspect of particular importance, you should carry out or commission your own inspection of the property.
Copyright © BleuPlan

Score	Energy rating	Current	Potential
92+	A		
81-91	B		
69-80	C		
55-68	D	63 D	73 C
39-54	E		
21-38	F		
1-20	G		

Mayfair 020 7493 0676

mayfair.sales@carterjonas.co.uk
18 Davies Street, Mayfair, London, W1K 3DS

carterjonas.co.uk
Offices throughout the UK

Exclusive UK affiliate of
CHRISTIE'S
INTERNATIONAL REAL ESTATE

IMPORTANT INFORMATION

These particulars are for general information purposes only and do not represent an offer or contract or part of one. Carter Jonas or anyone in their employment has made every attempt to ensure that the particulars and other information provided are as accurate as possible and they are not intended to amount to advice on which you should rely as being factually accurate. Full information which may be relevant to your decision regarding the property can be found on the property listing on carterjonas.co.uk or, (including off market properties) on the brochure or a separately available material information sheet. We would advise you to confirm the details of any material information prior to any offer being submitted. You should not assume that the property has all necessary planning, building regulations or other consents and Carter Jonas has not tested any services, facilities or equipment. Any measurements and distances given are approximate only. Where Carter Jonas has been provided with a floorplan by a third party, we cannot guarantee that the floorplan has been measured in accordance with IPMS. Purchasers must satisfy themselves of all of the aforementioned by independent inspection or otherwise. Our images only represent part of the property as it appeared at the time they were taken and do not represent the furnishings included; these are confirmed in a separate inventory. If you require further information, please contact us.