



SKIRSGILL LANE, EAMONT BRIDGE, CA10
£3,500 per month*

Carter Jonas

COACH HOUSE, SKIRSGILL LANE, EAMONT BRIDGE, PENRITH, CUMBRIA, CA10 2BQ

A 6 bedroom detached two storey barn conversion set in approximately 5.05 acres of gardens and paddocks.

- 6 Bedrooms
- 3 Receptions
- Kitchen
- Conservatories
- Utility
- Store Rooms
- 3 Bathrooms
- Workshop
- Stables
- Summer House
- 5 acres of gardens and paddocks
- Large driveway
- Off-street parking

THE PROPERTY

Accommodation comprises - Ground Floor: Entrance hall, 3 reception rooms, kitchen, 2 conservatories, various store rooms, bathroom. First Floor: Landing, 6 bedrooms and 2 bathrooms.

The property is set within approximately 5 acres of agricultural land with various outbuildings. In addition to the main house, land and gardens there are three additional buildings at the property comprising of stables, workshop and a summer house.

Pets considered. No access to Loft. No white goods. Mains electricity and water. Ground source heat pump. Private drainage via a Septic Tank. Flood Risk - Low.

Internet & Mobile: Further information on availability and speeds can be found at checker.ofcom.org.uk

Available unfurnished from early March 2026 for an initial 12 month term.

EPC Rating D. Council Tax Band E (please see Westmoreland and Furness Council Website for current cost)



At a rent of £3,500 per calendar month

Holding deposit of 1 week's rent £807

Security deposit of 5 weeks rent £4,038

ADDITIONAL INFORMATION

Offers	Available for an initial term of 12 months longer terms will be considered
Viewing	Strictly by appointment
Local Authority	Westmorland and Furness Council, Kendal - Council Tax Band E



Approximate Gross Internal Area 4283 sq ft - 398 sq m
 (Excluding Outbuilding/Gallery/Void/Eaves)
 Ground Floor Area 2478 sq ft - 230 sq m
 First Floor Area 1805 sq ft - 168 sq m
 Outbuilding Area 3142 sq ft - 292 sq m

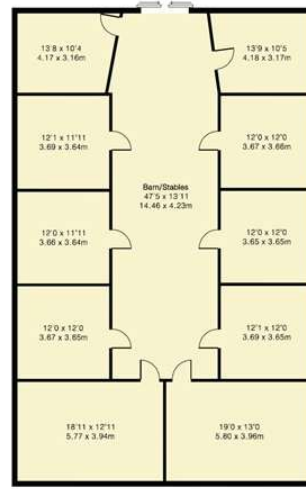

Floor plan produced in accordance with RICS Property Measurement 2nd Edition. Although Pink Plan Ltd ensures the highest level of accuracy, measurements of doors, windows and rooms are approximate and no responsibility is taken for error, omission or misstatement. These plans are for representation purposes only and no guarantee is given on the total square footage of the property within this plan. The figure icon is for initial guidance only and should not be relied on as a basis of valuation.

Carter Jonas

T: 01865 511444

Mayfield House, 256 Banbury Road, Oxford, Oxfordshire, OX2 7DE

E: oxfordresiletings@carterjonas.co.uk

A member of



Exclusive UK affiliate of

CHRISTIE'S
INTERNATIONAL REAL ESTATE

IMPORTANT INFORMATION

These particulars are for general information purposes only and do not represent an offer or contract or part of one. Carter Jonas or anyone in their employment has made every attempt to ensure that the particulars and other information provided are as accurate as possible and they are not intended to amount to advice on which you should rely as being factually accurate. Full information which may be relevant to your decision regarding the property can be found on the property listing on carterjonas.co.uk or a separately available material information sheet, and we would advise you to confirm the details of any material information prior to any offer being submitted. You should not assume that the property has all necessary planning, building regulations or other consents and Carter Jonas has not tested any services, facilities, or equipment. Any measurements and distances given are approximate only. Where Carter Jonas has been provided with a floorplan by a third party, we cannot guarantee that the floorplan has been measured in accordance with IPMS. Purchasers or prospective tenants must satisfy themselves of all of the aforementioned by independent inspection or otherwise. Our images only represent part of the property as it appeared at the time they were taken and do not represent the furnishings included; these are confirmed in a separate inventory. If you require further information, please contact us. *Administration fees may apply depending on tenancy type. Please contact your local branch for this information.