



**FULLERTON, ANDOVER, SP11**  
£3,950 per month\*

**Carter Jonas**

# FULLERTON, ANDOVER, SP11

Occupying an entire private wing of a beautifully converted manor house, this exceptional residence seamlessly blends refined period architecture with thoughtfully curated modern interiors. Set amid expansive, manicured grounds with far-reaching views of open countryside, the property offers a rare opportunity to enjoy elegant country living with outstanding living space and character throughout.

The home is approached through a grand reception hall, featuring an original tiled floor and sweeping staircase. At the heart of the home is an impressive sitting room, centred around an ornate fireplace and framed by classical pillars, creating a magnificent yet comfortable space for entertaining. Adjacent lies a formal dining room, perfectly positioned to enjoy views of the gardens.

The kitchen is beautifully appointed in a traditional style, with shaker cabinetry, a ceramic sink, an electric Aga, and ample dining space. It flows naturally into a cosy snug with garden access.

The property offers four well-proportioned double bedrooms, two of which benefiting from en-suites, each individually styled with tasteful décor. The principal bedroom features bespoke storage and delightful garden views. The bathrooms are finished to a luxurious standard, combining period charm with high-quality fixtures.

French doors open onto private seating areas and the shared formal gardens, offering serene views across open fields. The wider grounds of the manor are beautifully maintained, with lawns, mature planting, and generous outdoor space for residents to enjoy. Generous private parking with a single garage.

EPC Rating E. Council Tax Band E - Test Valley (Please check Government website for current cost) Mains Electric. Oil Heating & Mains water supply. Internet - Included within rental cost. Mobile: Further information on the Ofcom website.

At a rent of £3,950.00 per calendar month:  
Holding deposit of 1 week's rent £911.00  
Security deposit of 5 weeks rent £4,557.00

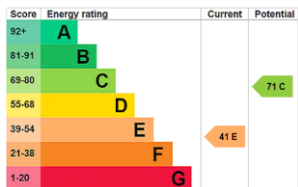

- Council Tax Band = E
- EPC = E

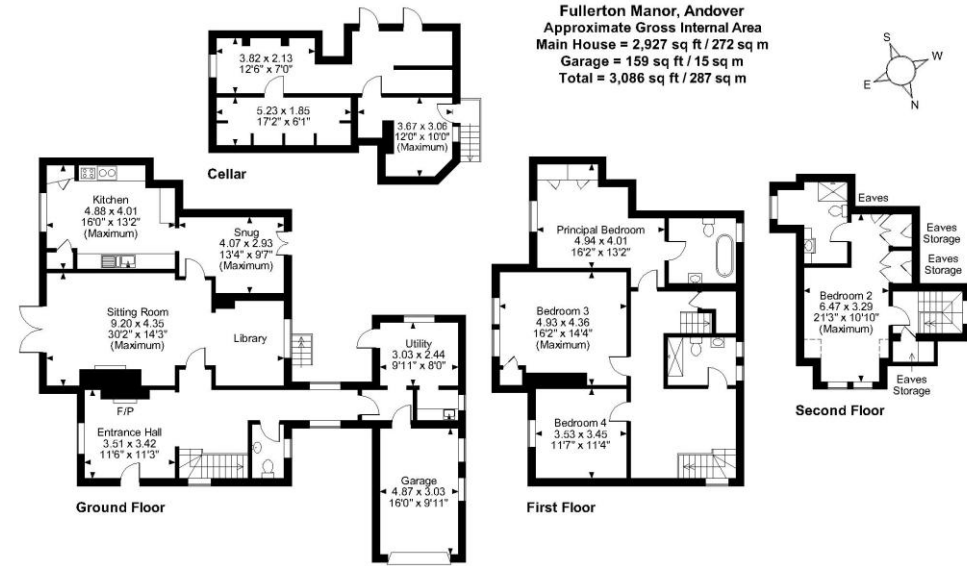

FOR ILLUSTRATIVE PURPOSES ONLY - NOT TO SCALE  
The position & size of doors, windows, appliances and other features are approximate only.  
□ Denotes restricted head height  
© ehoush. Unauthorised reproduction prohibited. Drawing ref. dig/848719/SS

Winchester 01962 842742  
winchester.sales@carterjonas.co.uk  
9a Jewry Street, Winchester, SO23 8RZ



Exclusive UK affiliate of  
**CHRISTIE'S**  
INTERNATIONAL REAL ESTATE  
Classification L2 - Business Data

**IMPORTANT INFORMATION**  
These particulars are for general information purposes only and do not represent an offer or contract or part of one. Carter Jonas or anyone in their employment has made every attempt to ensure that the particulars and other information provided are as accurate as possible and they are not intended to amount to advice on which you should rely as being factually accurate. Full information which may be relevant to your decision regarding the property can be found on the property listing on carterjonas.co.uk or a separately available material information sheet, and we would advise you to confirm the details of any material information prior to any offer being submitted. You should not assume that the property has all necessary planning, building regulations or other consents and Carter Jonas has not tested any services, facilities, or equipment. Any measurements and distances given are approximate only. Where Carter Jonas has been provided with a floorplan by a third party, we cannot guarantee that the floorplan has been measured in accordance with IPMS. Purchasers or prospective tenants must satisfy themselves of all of the aforementioned by independent inspection or otherwise. Our images only represent part of the property as it appeared at the time they were taken and do not represent the furnishings included; these are imagined in a separate inventory. If you require further information, please contact us. \*Administration fees may apply depending on tenancy type. Please contact your local branch for this information.