



RICHMOND COURT, 200 SLOANE STREET, SW1X
£1,050 per week*

Carter Jonas

FLAT 53, RICHMOND COURT, 200 SLOANE STREET, LONDON, SW1X 9QU

A one-bedroom apartment of approximately 667 square feet

- Furnished
- 1 Bedroom
- 1 Reception room
- 1 Kitchen
- 1 Bathroom

THE PROPERTY

This smart apartment is situated on the sixth floor of this well-maintained block with lift and 24 hour porter. Located within walking distance of Hyde Park, Sloane Square and Harrods it also the additional benefit of hot water, central heating and wifi included within the rent.

LOCATION

Stylish Belgravia is located on the edge of Hyde Park. It encompasses London's prime residential garden squares and is packed with Michelin-starred restaurants, specialist shops, historic buildings and residential dwellings.

Nearest Tube: Knightsbridge

AST

The deposit will be £5,250 at a rental value of £1,050 (asking price)

Holding deposit = 1 weeks rent of £1,050

Deposit is 5 weeks rent (£1,050 pw = £5,250 deposit)



ADDITIONAL INFORMATION

Offers	Available for a minimum term of 12 months longer terms will be considered
Viewing	Strictly by appointment
Local Authority	Kensington & Chelsea Borough Council - Council Tax Band F

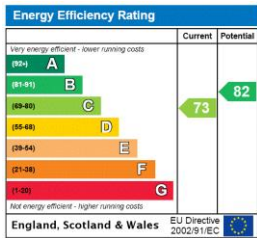

53 Richmond Court, SW1X 9QU

Approximate Gross Internal Area
61.95 sq m / 667 sq ft

(CH = Ceiling Heights)

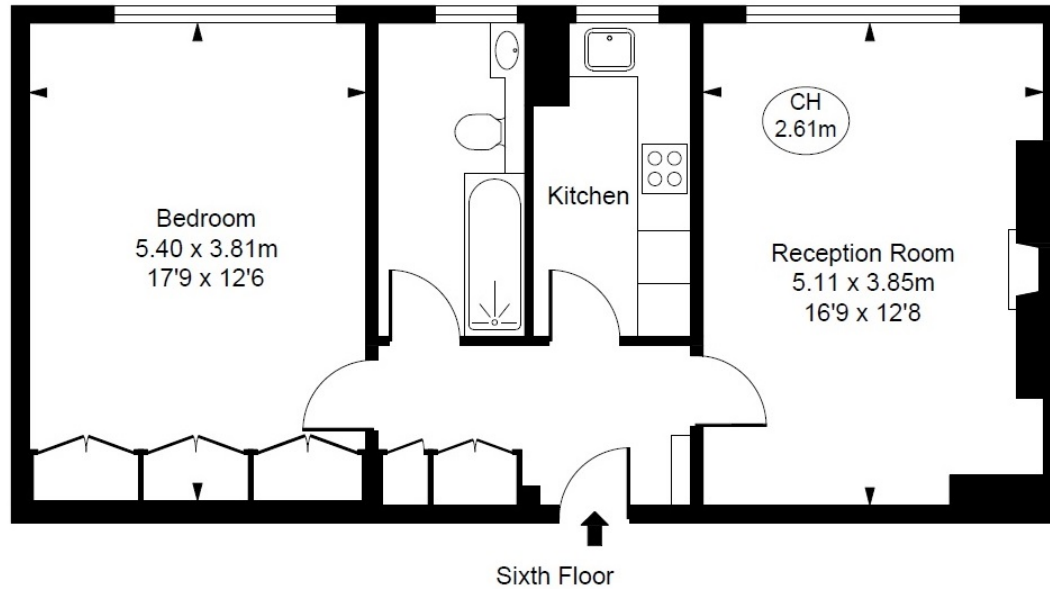

This plan is not to scale. It is for guidance and not for valuation purposes.
All measurements and areas are approximate only, and have been prepared in accordance with the current edition of the RICS Code of Measuring Practice.
© Fulham Performance



T: 020 7493 0676

18 Davies Street, Mayfair, London, W1K 3DS

E: mayfair@carterjonas.co.uk



Exclusive UK affiliate of

CHRISTIE'S
INTERNATIONAL REAL ESTATE

Classification L2 - Business Data

IMPORTANT INFORMATION

Our property particulars do not represent an offer or contract, or part of one. The information given is without responsibility on the part of the agents, seller(s) or lessor(s) and you should not rely on the information as being factually accurate about the property, its condition or its value. Neither Carter Jonas LLP nor anyone in its employment or acting on its behalf has authority to make any representation or warranty in relation to this property. We have not carried out a detailed survey, nor tested the services, appliances or fittings at the property. The images shown may only represent part of the property and are as they appeared at the time of being photographed. The areas, measurements and distances are approximate only. Where Carter Jonas have been provided with a floorplan by a third party, we can not guarantee that the floorplan has been measured in accordance with IPMS. Any reference to alterations or use does not mean that any necessary planning permission, building regulation or other consent has been obtained. The VAT position relating to the property may change without notice. Administration fees may apply depending on tenancy type. Please contact your local branch for this information.