

Doohooky

Weight (lbs.)
.15-.26

Load Capacity (lbs.)
150

A

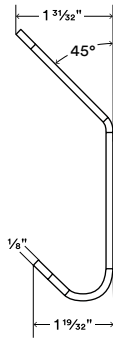
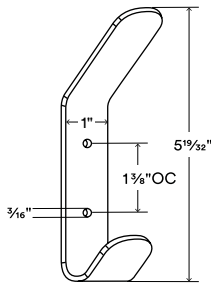

B

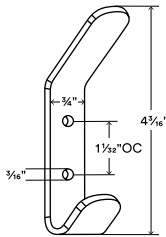

Doohooky and Mini Doohooky Hook

Made from 1/8" thick hot-rolled steel

Screw holes are 3/16" outside diameter (OD)

Upper and lower prong angles are 45°

Supports 150lbs per hook when correctly mounted*

*

WARNING: All hooks must be installed into studs, posts, or dry wall anchors. Failure to do so may result in saggy hooks, falling objects, or even injury.

**

Drawings are representations only and not to scale.

© Shelfology 2020

Figure	Model	Material	Thickness	Height	Width	Depth	Weight (lbs)	Load (lbs)
A	Doohooky	Steel	1/8"	5 19/32"	1"	1 3/32"	.26	150
B	Mini Doohooky	Steel	1/8"	4 3/16"	3/4"	1 1/4"	.15	150