

Home Audio

Active Loudspeakers



GENELEC®



Our Roots



For over forty years, Genelec has been setting quality standards for music studios and film and broadcast production facilities around the world. Whether it's music, TV or movies, many of your favourites are produced using Genelec active loudspeakers - quality that the professionals rely on every day.

ALL GENELEC SPEAKERS ARE MADE HERE IN IISALMI, FINLAND



Professional Sound Quality at Home

Have you ever thought about how much time, care and effort artists and sound engineers put into their masterpieces? A single piece of music can take countless days and several production phases before it reaches your ears.

Since 1978, Genelec has been helping artists to reach the highest possible standards as well as creating the art of sound production along the way. Our Home Audio Series brings that same professional quality into your home—making music, movies and web broadcasting come alive like never before.



G Series

Imagine listening to your favourite music in the privacy of your own home with a sound as clear and precise as if you were in a studio or a concert hall. The Genelec G Series is a range of loudspeakers that combine the finest sound quality, unique minimalistic design, reliability and ease of use – all in one package. These loudspeakers are a long-term investment, and will provide you with the most exquisite sound quality for many years to come.

AVAILABLE IN WHITE AND BLACK





The Harmony of Sound and Design

The active principle of all Genelec loudspeakers makes great sound easily accessible and extremely reliable. Because the amplifiers are integrated within the loudspeakers themselves, you won't need any external amplifiers. Instead, you simply connect the loudspeaker to any device and just press play. Each internal amplifier is optimised to power a specific driver, and this fully integrated system design ensures that you get outstanding performance day after day, year after year. These loudspeakers are made to last.

Accuracy is a key feature of all Genelec loudspeakers. This means that the sound you hear through our loudspeakers is as faithful as possible to the original - just as the creators intended it to be. And if the speaker's response is ever compromised by non-ideal

positioning within your room (such as being placed against a wall or in a corner), our simple rear panel room response controls let you adjust for this, and restore a natural and neutral playback response - wherever the speaker is located. What you get is a flawless, truthful audio experience without compromises. Quality that fulfils the needs of high-end hi-fi systems and home theatres as well as computer, TV and audio server requirements.

Minimalistic Nordic design makes Genelec loudspeakers a natural match with different interiors. Our long-standing collaboration with the renowned industrial designer Harri Koskinen has resulted in a design that matches functionality and elegance with professional acoustic excellence.

F Series

If you want a home theatre that is equivalent to a real theatrical experience, you will need a subwoofer to bring low frequency content alive with both clarity and precision. This enables you to fully experience all the different dimensions of the soundscape - from the deep power of the sea to the awakening volcano.

Traditionally, subwoofers are sometimes avoided due to their large size and stark appearance, which clashes with some interior decors. The Genelec F Series, however, offers a solution to this issue by bringing you compact yet powerful subwoofers with award-winning aesthetic design that blends in beautifully with any space and style.

The F Series includes both room response controls and bass management - allowing you to precisely tailor the low frequency performance of your system to your room.

Additionally, both models now feature higher SPL, analogue plus optical and coaxial digital inputs, automatic input detection and a range of remote control options - making the F Series a beautiful sounding hub for your home audio system.

AVAILABLE IN WHITE AND BLACK



Now with stereo digital inputs



G Series Active Loudspeakers



G One

Maximum sound pressure level¹	96 dB
Free field frequency response	67 Hz – 25 kHz (-6 dB)
Accuracy of frequency response	± 2.5 dB (74 Hz – 20 kHz)
Drivers	Woofer 3 inch + Tweeter 3/4 inch metal dome + DCW™
Amplifier power per channel	Woofer 25 W + Tweeter 25 W (both Class D)
Dimensions H x W x D	195 x 121 x 115 mm, 7 ¹¹ / ₁₆ x 4 ³ / ₄ x 4 ¹ / ₂ inch, with Iso-Pod™
Weight	1.7 kg / 3.7 lb
Connectors	1 x RCA analogue input



G Two

Maximum sound pressure level¹	100 dB
Free field frequency response	56 Hz – 25 kHz (-6 dB)
Accuracy of frequency response	± 2.5 dB (62 Hz – 20 kHz)
Drivers	Woofer 4 inch + Tweeter 3/4 inch metal dome + DCW™
Amplifier power per channel	Woofer 50 W + Tweeter 50 W (both Class D)
Dimensions H x W x D	242 x 151 x 142 mm, 9 ¹ / ₂ x 6 x 5 ⁵ / ₈ inch, with Iso-Pod™
Weight	3.2 kg / 7.0 lb
Connectors	1 x RCA analogue input



G Three

Maximum sound pressure level¹	104 dB
Free field frequency response	47 Hz – 25 kHz (-6 dB)
Accuracy of frequency response	± 2 dB (54 Hz – 20 kHz)
Drivers	Woofer 5 inch + Tweeter 3/4 inch metal dome + DCW™
Amplifier power per channel	Woofer 50 W + Tweeter 50 W (both Class D)
Dimensions H x W x D	299 x 189 x 178 mm, 11 ¹³ / ₁₆ x 7 ⁷ / ₁₆ x 7 inch, with Iso-Pod™
Weight	5.0 kg / 11 lb
Connectors	1 x RCA analogue input, 1 x XLR analogue input



G Four

Maximum sound pressure level¹	105 dB
Free field frequency response	41 Hz – 25 kHz (-6 dB)
Accuracy of frequency response	± 2 dB (48 Hz – 20 kHz)
Drivers	Woofer 6 1/2 inch + Tweeter 3/4 inch metal dome + DCW™
Amplifier power per channel	Woofer 90 W + Tweeter 90 W
Dimensions H x W x D	365 x 237 x 223 mm, 14 ³ / ₈ x 9 ³ / ₈ x 8 ¹³ / ₁₆ inch, with Iso-Pod™
Weight	9.4 kg / 20.7 lb
Connectors	1 x RCA analogue input, 1 x XLR analogue input



G Five

Maximum sound pressure level¹	110 dB
Free field frequency response	32 Hz – 25 kHz (-6 dB)
Accuracy of frequency response	± 2.5 dB (38 Hz – 20 kHz)
Drivers	Woofer 8 inch + Tweeter 1 inch metal dome + DCW™
Amplifier power per channel	Woofer 150 W + Tweeter 120 W
Dimensions H x W x D	452 x 286 x 278 mm, 17 ¹³ / ₁₆ x 11 ¹ / ₄ x 10 ¹⁵ / ₁₆ inch, with Iso-Pod™
Weight	14.4 kg / 31.7 lb
Connectors	1 x RCA analogue input, 1 x XLR analogue input

F Series Active Subwoofers



F One

Maximum sound pressure level²	100 dB
Free field frequency response	35 Hz – 85 Hz (-6 dB) / LFE 35 Hz – 120 Hz (-6 dB)
Woofer	6 1/2 inch
Amplifier power	40 W
Dimensions H x D	251 x 305 mm, 9 ⁷ / ₈ x 12 inch
Weight	5.6 kg / 12.3 lb
Remote control	Yes
Connectors	2 x digital inputs (coaxial and optical), 4 x analogue inputs (L, R and LFE RCA, 3.5 mm stereo jack). 2 x analogue outputs (L, R RCA)



F Two

Maximum sound pressure level³	103 dB
Free field frequency response	27 Hz – 85 Hz (-6 dB) / LFE 27 Hz – 120 Hz (-6 dB)
Woofer	8 inch
Amplifier power	150 W
Dimensions H x D	300 x 362 mm, 11 ¹³ / ₁₆ x 14 ¹ / ₄ inch
Weight	8.5 kg / 18.7 lb
Remote control	Yes
Connectors	2 x digital inputs (coaxial and optical), 4 x analogue inputs (L, R and LFE/LINK RCA, 3.5 mm stereo jack). 5 x analogue outputs (L, R XLR and L, R and LINK RCA)

1) Maximum short term sine wave SPL output averaged from 100 Hz to 3 kHz, measured on axis in half space at 1 metre

2) Maximum short term sine wave SPL output averaged from 40 to 85 Hz, measured in half space at 1 metre

3) Maximum short term sine wave SPL output averaged from 30 to 85 Hz, measured in half space at 1 metre

Streaming Music

Access to huge collections of music has never been easier than it is today. Multiple streaming devices and internet radios offer countless songs and possibilities, and whether it's a tiny streamer or a high end device, the solution is simple - just cable the streamer to your Genelec speakers or subwoofer.

And since the new F Series subwoofers now feature digital inputs, you can choose to bypass the analogue outputs of your music source, giving you one of the finest and most future-proof music streaming solutions available.

RECOMMENDATION

Stereo	G One	G Two	G Three	G Four	G Five
F One	1	1			
F Two	1	1	1	2 X	2 X

Stereo

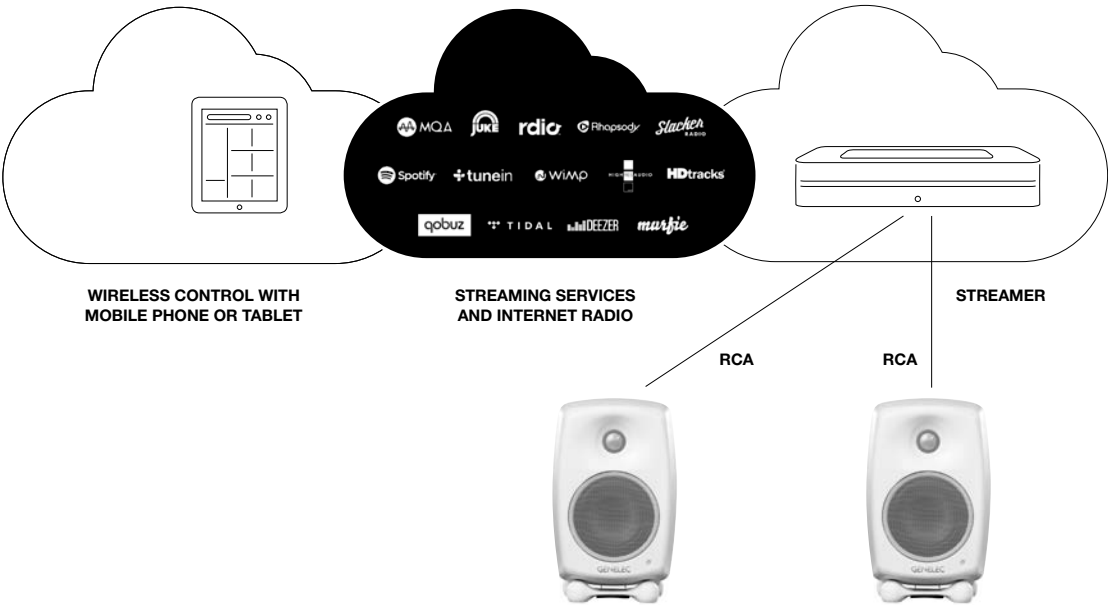

Stereo with subwoofer

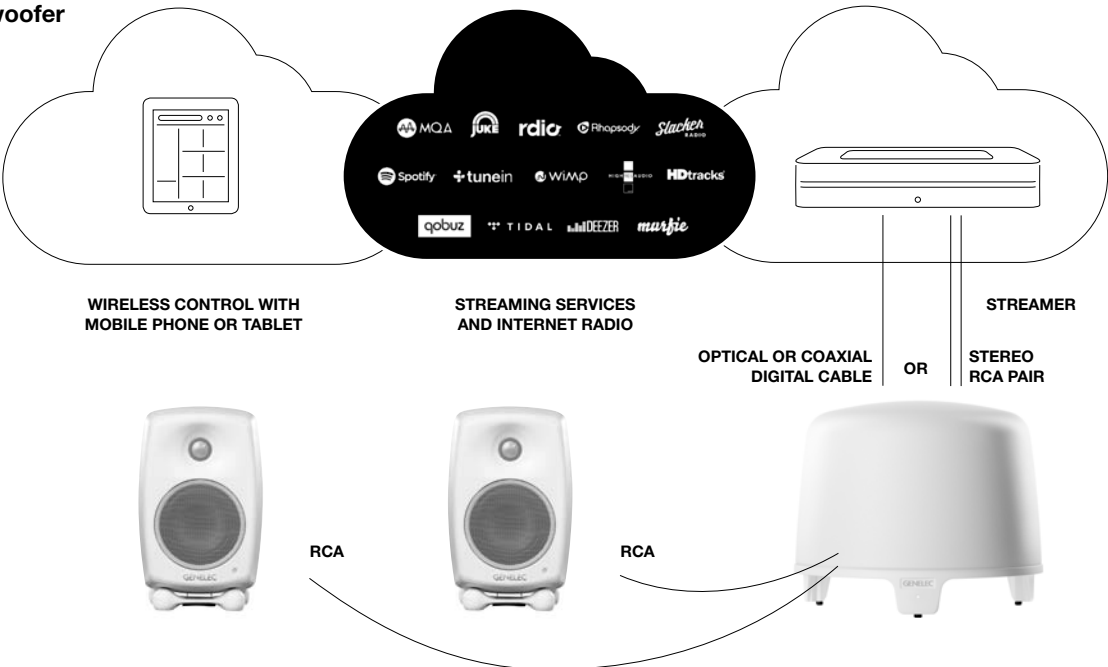

TV and Surround Sound

A great TV picture deserves great sound. Just hook up the optical output of your TV set to an F Series subwoofer, which will bass manage the sound and feed your G Series speakers too.

And for sublime surround sound, simply feed the pre-outputs from your Home Theatre processor into both the subwoofer and speakers directly.

You'll be amazed at how your favourite movies are suddenly brought to life, with the detail and dynamics of the soundtrack being totally transformed.

RECOMMENDATION

Surround	G One	G Two	G Three	G Four	G Five
F One	1				
F Two	1	1	2 X		

TV

Note: in case the TV optical out doesn't support volume control, it can be controlled from the subwoofer either with learning IR function or with RF remote control.

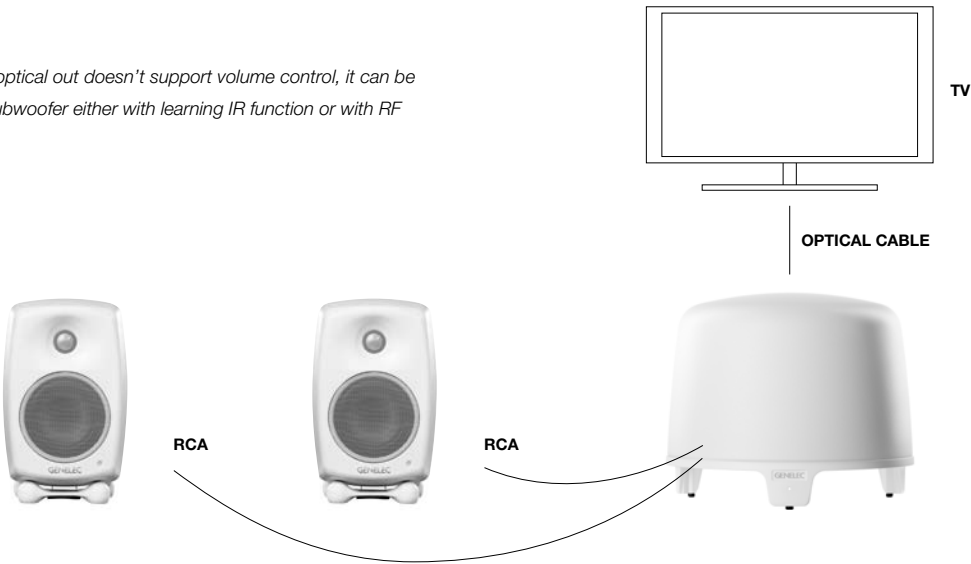

5.1 Surround Sound

Note: Volume controlled from the preamplifier.

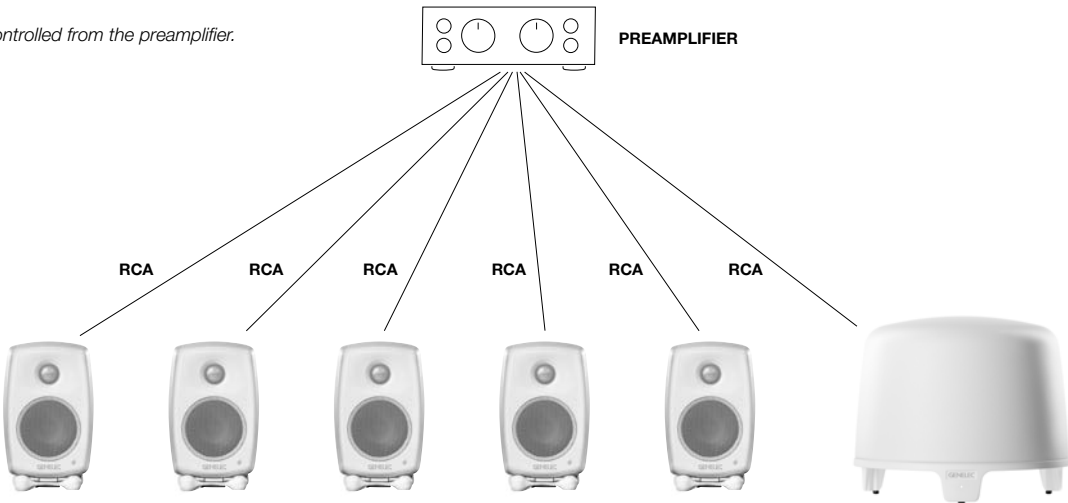





Architectural Loudspeakers

Premium quality sound from hidden loudspeakers? This can seem like a major challenge but it's not as impossible as you might think. Genelec loudspeakers are designed to deliver professional quality sound in any environment - with or without loudspeaker cabinets. These architectural models are equally happy in a wall or ceiling, and you can even paint the bezels and grilles without compromising their performance.

In-wall and In-ceiling Loudspeakers

Each and every Genelec loudspeaker uses active technology, including our architectural models. With remote-mounting amplifier modules, these in-wall and in-ceiling systems are carefully designed to offer optimal sound with hassle-free installation.



AIW25

Maximum sound pressure level¹	100 dB
Free field frequency response	62 Hz - 25 kHz (-6 dB)
Accuracy of frequency response	± 3 dB (68 Hz - 20 kHz)
Drivers	Woofer 5 inch + Tweeter 3/4 inch metal dome
Amplifier power per channel	Woofer 40 W + Tweeter 40 W
Loudspeaker H x W x D	360 x 267 x 6 mm*, 14 ³ / ₁₆ x 10 ¹ / ₂ x 1 ¹ / ₄ inch
RAM2 Amplifier H x W x D	177 x 47 x 260 mm, 6 ³¹ / ₃₂ x 2 ¹ / ₈ x 10 ¹ / ₄ inch
Loudspeaker weight	3.7 kg with grille / 8.1 lb
Amplifier weight	2.2 kg / 4.8 lb



AIW26B

Maximum sound pressure level¹	110 dB
Free field frequency response	39 Hz - 25 kHz (-6 dB)
Accuracy of frequency response	± 2.5 dB (45 Hz - 21 kHz)
Drivers	Woofer 6 1/2 inch + Tweeter 1 inch metal dome
Amplifier power per channel	Woofer 120 W + Tweeter 120 W
Loudspeaker H x W x D	598 x 374 x 15 mm*, 21 ¹ / ₂ x 13 ¹ / ₈ x 3 ¹ / ₂ inch
RAM2 Amplifier H x W x D	130 x 145 x 309 mm, 5 ¹ / ₈ x 5 ³ / ₄ x 12 ³ / ₁₆ inch
Loudspeaker weight	8.7 kg with grille / 19.2 lb
Amplifier weight	4.6 kg / 10.1 lb



AIC25

Maximum sound pressure level¹	100 dB
Free field frequency response	62 Hz - 25 kHz (-6 dB)
Accuracy of frequency response	± 3 dB (68 Hz - 20 kHz)
Drivers	Woofer 5 inch + Tweeter 3/4 inch metal dome
Amplifier power per channel	Woofer 40 W + Tweeter 40 W
Loudspeaker diameter x D	284 x 158 mm, 11 ³ / ₁₆ x 6 ³ / ₁₆ inch
RAM2 Amplifier H x W x D	117 x 54 x 260 mm, 6 ³¹ / ₃₂ x 2 ¹ / ₈ x 10 ¹ / ₄ inch
Loudspeaker weight	3.0 kg with grille / 6.6 lb
Amplifier weight	2.2 kg / 4.8 lb



5041A

Maximum sound pressure level²	105 dB
Free field frequency response	30 Hz - 95 Hz (-6 dB)
Accuracy of frequency response	± 3 dB (30 Hz - 95 Hz)
Drivers	2 x 6 1/2 inch
Amplifier power per channel	125 W
Loudspeaker H x W x D	1170 x 346 x 82 mm, 46 ¹ / ₁₆ x 13 ⁵ / ₈ x 3 ¹ / ₄ inch
Grille H x W x D	373 x 267 x 3 mm, 14 ¹¹ / ₁₆ x 10 ¹ / ₂ x 1 ¹ / ₈ inch
RAM3 Amplifier H x W x D	177 x 54 x 260 mm, 6 ¹⁵ / ₁₆ x 2 ¹ / ₈ x 10 ¹ / ₄ inch
Loudspeaker weight	15 kg / 33 lb
Amplifier weight	1.4 kg / 3.1 lb
Recommended main loudspeakers AIW25 and AIC25 stereo	

1) Maximum short term sine wave sound pressure level averaged from 100 Hz to 3 kHz, measured on axis in half space at 1 metre *Visible part of installed loudspeaker
2) Maximum short term sine wave sound pressure level averaged from 40 Hz to 85 Hz, measured in half space at 1 metre

Accessories

Your listening space is also your living space, so you'll usually want to position your loudspeakers somewhere convenient. Fortunately, we have a huge range of accessories that enable you to place your speakers in most locations - whether that's a floor, table, ceiling or wall.

And as well as speaker mounts, you'll also find a wide selection of cables, bags, and controls in our accessories catalogue at www.genelec.com

Table stands



Short ceiling mounts



Soft carrying bags



Wall mounts



Long ceiling mounts



Twin cables



Rack mounts



Floor stands



Volume controls





Innovative Technologies



Directivity Control Waveguide (DCW™) Technology

Directivity Control Waveguide (DCW™) for flat on- and off-axis response.



Iso-Pod™ Stand

Vibration decoupling Iso-Pod™ stand improves sound image definition.



Minimum Diffraction Enclosure (MDE™) Technology

Minimum Diffraction Enclosure (MDE™) for uncoloured sound reproduction.



Reflex Port Design

Advanced reflex port design for extended low frequency response.



Versatile Mountings

Versatile mounting options for all installation needs.



Active Crossovers

Provide more precision and lower distortion than passive designs.



Bass Management System

Optimises LF system performance to improve headroom and lower distortion.



Intelligent Signal Sensing (ISS™) Technology

Absence of audio triggers stand-by mode to reduce power consumption.



Optimised Amplifiers

Each transducer is driven by its own optimised amplifier.



Protection Circuitry

Sophisticated drive unit protection circuitry for safe operation.



Room Response Compensation

Allows the user to tune each speaker for optimum performance in any room.

Genelec Home Audio Loudspeakers and Subwoofers feature rear panel DIP switches that compensate for effects on the frequency response caused by your room and the placement of your speakers. For even more precise adaptation to your listening environment, use Genelec's line of SAM speakers with the complementary GLM calibration software. For more information, visit www.genelec.com



For the Sake of a Better Future

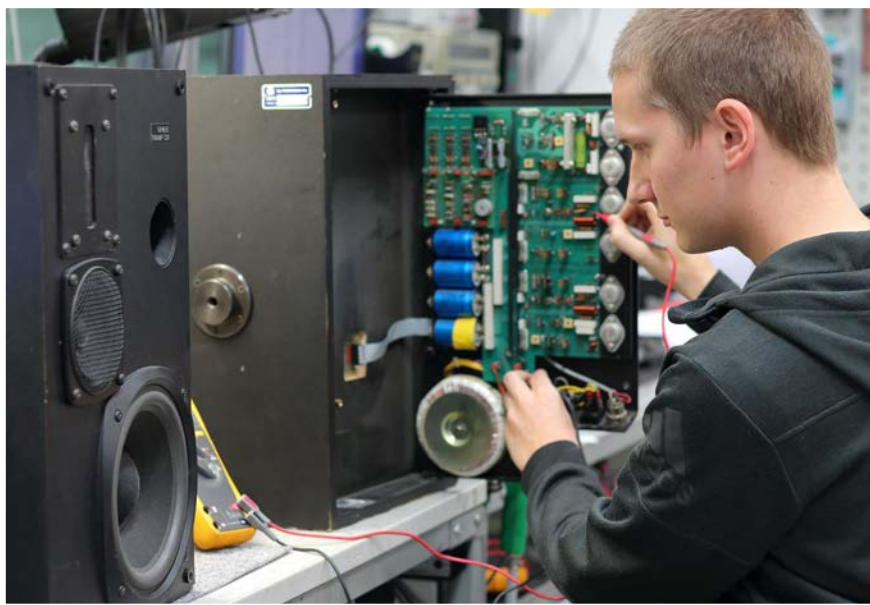

Sustainable development has always been a hugely important issue for Genelec. We constantly strive to reduce our carbon footprint, use recycled materials and recycle almost all of our waste.

Disposable culture is not part of our thinking, and our aim is always to produce loudspeakers that have very long lifecycles and can still be

supported and serviced decades later. We consider this approach essential in respecting nature and following the path towards a cleaner future.

**Factory and Headquarters**

Genelec Oy
Olivitie 5
FI-74100 Iisalmi
Finland
T +358 17 83 881
Email genelec@genelec.com

USA

Genelec Inc.
7 Tech Circle
Natick MA 01760
USA
T +1 508 652 0900
Email genelec.usa@genelec.com

Sweden

Genelec Sweden
Ellipsvägen 10A
SE-141 75 Kungens Kurva
Sweden
T +46 8 449 5220
Email sweden@genelec.com

China

Beijing Genelec Audio
Room 101, Building B33
Universal Business Park
No.10 Jiuxianqiao Road
Chaoyang District
Beijing 100015
China
T +86 10 5823 2014
T +86 400 700 1978
Email genelec.china@genelec.com

Japan

Genelec Japan Inc
2-22-21 Akasaka
Minato ku
JP-107-0052 Tokyo
Japan
T +81 3 6441 0591
Email genelec.japan@genelec.com

Denmark

Genelec Denmark
Danmarksvej 32D
8660 Skanderborg
Denmark
T +45 71 741 641
Email denmark@genelec.com

Genelec Document BBAGE187b.
Copyright Genelec Oy 04.2019.

All data subject to change. Detailed data sheets of all Genelec models, Quick Setup Guides and other useful information can be downloaded at

www.genelec.com