



YOUR ELECTRICAL EXPERTS

Essential Industrial Solutions



MCG[®]
INDUSTRIAL

May 2026 - V1



Scan and shop with the App.

The easy way to order.

Download now for FREE

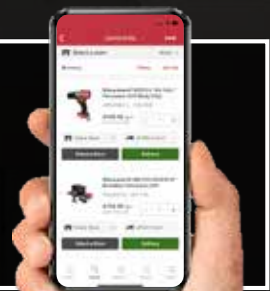

PVC GROMMET STRIP

Transparent Grommet Strip

- Protects against sharp edges in sheet metal work or in panels
- Operating temperature: -50 to 85°C
- Ultimate elongation greater than 550%
- Dielectric strength: 60 kV / mm
- Good chemical resistance



MCG Ref	Code	Panel Thickness	Length
Plain [For Square or Rectangular Cut Outs]			
DX1P/35NL	0189-5773	0.8 - 1 mm	35 m
DX1.5P/30NL	0189-5767	1.1 - 1.5 mm	30 m
DX2P/25NL	0203-3728	1.6 - 2 mm	25 m
DX3P/20NL	0189-5785	2.1 - 3 mm	20 m
Crenulated [For Circular or Irregular Cut Outs]			
DX1C/35NL	0189-5770	0.8 - 1 mm	35 m
DX1.5C/30NL	0189-5764	1.1 - 1.5 mm	30 m
DX2C/25NL	0203-3725	1.6 - 2 mm	25 m
DX3C/20NL	0189-5782	2.1 - 3 mm	20 m
DX4C/15NL	0189-5788	3.1 - 4 mm	15 m

SWITCHGEAR & DISTRIBUTION

Paxolin Sheet

- Good mechanical and electrical insulation properties in low voltage applications
- Paxolin sheet is also known as SRBP sheet or bakelite sheet
- BS EN60893-3-4 PFPC201



MCG Ref	Code	Length	Width	Depth
PAX6/126	2838-8116	1200 mm	600 mm	6 mm

PVC ADAPTABLE BOXES - GROMMET ENTRY

Empty Enclosures IP44

- Snap closing cover
- 4 x 23 mm Grommet cable entries



MCG Ref	Code	Depth	Ø
001	2095-3081	35 mm	65 mm
002	2095-3084	40 mm	80 mm

Empty Enclosure IP44

- Snap closing cover
- 6 x Grommet cable entries



MCG Ref	Code	Length	Width	Depth
003	2095-3087	80 mm	80 mm	40 mm



Check local branches & online for latest pricing

PVC ADAPTABLE BOXES - PLAIN SIDED

Empty Enclosures IP66

- Screw-on flat lid
- Plain sides



MCG Ref	Code	Colour	Length	Width	Depth
Stainless Steel Screws					
005.PL BLACK	2094-6730	Black	100 mm	100 mm	50 mm
005.PL	1868-7337	Grey	100 mm	100 mm	50 mm
006.PL	2095-3093	Grey	100 mm	100 mm	70 mm
008.PL	1866-0130	Grey	110 mm	150 mm	70 mm
009.PL	1900-2097	Grey	145 mm	190 mm	72 mm
010.PL	1868-7352	Grey	190 mm	243 mm	90 mm
Nylon Screws					
009.A.PL	1868-7343	Grey	140 mm	190 mm	75 mm
010.A.PL	1868-7349	Grey	190 mm	238 mm	90 mm
012.A.PL	1829-8504	Grey	220 mm	300 mm	120 mm
014.A.PL	1868-7364	Grey	300 mm	376 mm	120 mm

PVC ADAPTABLE BOXES - DEEP LID

Empty Enclosures IP66

- Screw-on deep lid
- Plain sides



MCG Ref	Code	Length	Width	Depth
Stainless Steel Screws				
008.CA.G	2095-3096	110 mm	150 mm	135 mm
009.CA.G	2095-3099	145 mm	190 mm	135 mm
010.CA.G	2095-3102	190 mm	243 mm	155 mm

DIN RAIL ENCLOSURES

Plastic DIN Rail Enclosure IP40

- Manufactured from tough, flame retardant ABS
- Screw on cover with open front
- BS EN 60529



Includes:

- DIN rail

MCG Ref	Code	No. of Modules	Height	Width	Depth
90.02	1868-7403	2	133 mm	53 mm	78 mm

Plastic DIN Rail Enclosures IP65



- Manufactured from tough, flame retardant ABS
- Multiple knockouts for cable entry
- Snap closing top hinged, tinted front window
- Will fit a range of modular devices
- BS EN 60529



Includes:

- DIN rail

MCG Ref	Code	No. of Modules	Height	Width	Depth
940.02	1868-7433	2	156 mm	102 mm	100 mm
92.04	1868-7415	5	158 mm	118 mm	92 mm

Metalclad DIN Rail Enclosures IP20



- Non-combustible metalclad enclosure
- Multiple knockouts for cable entry
- Raised keyholes for easy installation
- Top hinged door
- BS EN 61439-3



Includes:

- DIN rail
- Earth bar

MCG Ref	Code	No. of Modules	Height	Width	Depth
ME2S	2191-0537	2	145 mm	80 mm	82 mm
ME2L	2191-0534	2	225 mm	80 mm	82 mm
ME4S	2191-0543	4	175 mm	110 mm	82 mm
ME4L	2191-0540	4	225 mm	115 mm	82 mm

SHEET STEEL ENCLOSURES AND ACCESSORIES

Sheet Steel Enclosures with Mounting Plates IP65



- Galvanised sheet steel enclosure with polyurethane gasket
- Recessed gland plate, top or bottom, and reversible door with T-bar lock
- KEMA Certification
- BS EN 60529



Includes:

- Zinc plated backplate [2 mm]
- Mounting kit
- Key

MCG Ref	Code	Height	Width	Depth
M32150	1434-9439	300 mm	200 mm	150 mm
M33150	1434-9442	300 mm	300 mm	150 mm
M33200	1434-9445	300 mm	300 mm	200 mm
M43200	1434-9454	400 mm	300 mm	200 mm
M44200	1434-9457	400 mm	400 mm	200 mm
M54200	1434-9460	500 mm	400 mm	200 mm
M64200	1367-5453	600 mm	400 mm	200 mm

Replacement T-Bar Lock



- Designed for use with the MCG Industrial range of sheet steel enclosures
- Simple to use T-bar locking handle
- BS EN 60529



MCG Ref	Code
MLOCK	1367-5456

METER BOXES AND ACCESSORIES

Meter Boxes



- Suitable for all domestic electricity meters
- Fitted baseboard
- Pre-drilled cable entry positions to the bottom left
- Manufactured with glass reinforced plastic - won't rot or corrode
- IP55
- Fire retardant to E.S.I. Standard 12-3



Surface

Recessed



Included

Includes:

- Meter box key

MCG Ref	Code	Mounted	Height	Width	Depth
METER/F	0859-7080	Recessed	595 mm	409 mm	210 mm
METER/S	0860-5600	Surface	560 mm	400 mm	230 mm

Cable Protector [Hockey Stick]



- Suitable for flush and surface electricity meter boxes [0859-7080] and [0860-5600]



MCG Ref	Code	Length	Ø
METER/HS	0859-7083	1400 mm	38 mm

PANEL TRUNKING

Open Slotted Panel Trunking

- Ideal for cable management in panels
- 8 mm Gap and 12 mm finger width
- Maximum space for cables, with good heat dissipation
- Exit cables at terminal or base level
- Conforms to BS EN 50085 and UL 94 V0

Includes:

- Clip-on lid

MCG Ref	Code	Height	Width	Length
CC40X40OST	2073-9097	40 mm	40 mm	2 m

FLEXIBLE CONDUIT CONTRACTOR PACKS

Polypropylene Contractor Packs

- Self-extinguishing, low smoke and fume
- UV Stabilised
- Temperature range: 0 - 95°C
- IP51
- BS 4607



Pack contents:

- 10 m Conduit
- 10 x Glands and locknuts

MCG Ref	Code	Ø	Colour
N20/10MCP	0013-6879	20 mm	Black
N20/10MCPW	1728-0337	20 mm	White
N25/10MCP	0013-6885	25 mm	Black
N25/10MCPW	1728-0346	25 mm	White

PVC Covered Steel Contractor Pack

- Highly flexible galvanised steel conduit with a PVC coating
- Crush resistant
- Temperature range: -40 to 90°C
- BS EN 61386



Pack contents:

- 10 m Conduit
- 10 x Fixed glands

MCG Ref	Code	Ø
GSF20/10MCP	2199-3040	20 mm



Check local branches & online for latest pricing

PVC Covered Steel Contractor Pack

- Highly flexible galvanised steel conduit with a PVC coating
- Crush resistant
- Temperature range: -40 to 90°C
- BS EN 61386



Pack contents:

- 10 m Conduit
- 10 x Swivel glands

MCG Ref	Code	Ø
GSF20/10MCP	2233-7452	20 mm

Steel Contractor Packs

- Highly flexible galvanised steel conduit
- Crush resistant
- Low fire hazard
- Temperature range: -50 to 300°C
- IP40
- BS EN 61386



Pack contents:

- 10 m Conduit
- 10 x Fixed glands and collars
- 10 x Locknuts

MCG Ref	Code	Ø
GSFB20/10MCP	2793-5434	20 mm
GSFB25/10MCP	2793-5437	25 mm

PVC Covered Steel Contractor Pack

- Highly flexible galvanised steel conduit with a PVC coating
- Crush resistant
- Flammability to CEI 23-14/V-1971 with 10 second flame resistance
- Temperature range: -15 to 80°C
- IP55
- BS EN 61386



Pack contents:

- 10 m Conduit
- 10 x Fixed glands and collars
- 10 x Locknuts

MCG Ref	Code	Ø
GSF25/10MCP	2793-5431	25 mm

Same day range

Almost 3,000 everyday essential products available in branch to take away today



FLEXIBLE CONDUIT AND ACCESSORIES

PVC Covered Steel Flexible Conduit - GSF Range

- Galvanised steel with a black-profiled PVC coating
- Flammability to CEI 23-14/V-1971 with 10 second flame resistance
- Temperature range: -15 to 80°C
- IP55
- BS EN 61386



MCG Ref	Code	Ø	Length
GSF20/10	0013-5862	20 mm	10 m
GSF20/30	0013-5865	20 mm	30 m
GSF20/50	2805-7324	20 mm	50 m
GSF25/10	0013-5868	25 mm	10 m
GSF25/30	0013-5871	25 mm	30 m
GSF25/50	2805-7327	25 mm	50 m

Steel Flexible Conduit - GSFB Range

- Galvanised steel conduit
- Low fire hazard
- Temperature range: -50 to 300°C
- IP40
- BS EN 61386



MCG Ref	Code	Ø	Length
GSFB20/10	0055-6945	20 mm	10 m
GSFB20/30	0055-6948	20 mm	30 m
GSFB20/50	2805-7330	20 mm	50 m
GSFB25/10	0055-6951	25 mm	10 m
GSFB25/30	0055-6954	25 mm	30 m
GSFB25/50	2805-7333	25 mm	50 m

Conduit Glands - GSFB / GSF Ranges

- For GSF / GSFB flexible conduit
- Male thread
- IP55



MCG Ref	Code	Ø
Fixed		
GSM20	0013-5883	20 mm
GSM25	0013-5886	25 mm
Swivel		
GSS20	0013-5895	20 mm
GSS25	0013-5898	25 mm

Polypropylene Flexible Conduit - N Range

- Self-extinguishing, low smoke and fume
- Smooth inner lining for easy cable feed
- UV Stabilised
- Temperature range: 0 - 95°C
- IP51
- BS 4607



MCG Ref	Code	Ø	Length
N20/50M	0097-8961	20 mm	50 m
N20/100M	2805-8347	20 mm	100 m
N25/50M	1167-7861	25 mm	50 m
N32/50M	0097-8967	32 mm	50 m

Conduit Glands - N Range

- For N range flexible conduit
 - IP51
 - BS 4607
- Includes:
- Locknut



MCG Ref	Code	Ø
N20G	0013-6882	20 mm
N25G	0856-8100	25 mm
N32G	0108-0973	32 mm

Liquid Tight PVC Covered Steel Flexible Conduit - GSFLT Range

- Liquid tight covered steel
- High flexibility
- Crush resistant
- Temperature range: -40 to 90°C
- IP Rating dependent on fittings used
- EN 61386



MCG Ref	Code	Ø	Length
GSFLT20/10M	2793-5443	20 mm	10 m

Liquid Tight Conduit Gland - GSFLT Range

- For GSFLT liquid tight PVC covered steel conduit
- Nickel plated brass
- IP68
- EN 61386

- Includes:
- Locknut



MCG Ref	Code	Ø
Fixed		
GSFLT20	2793-5440	20 mm

Flexible Conduit Clips

- Plated steel fixing p-clip with a PVC liner
- Temperature range: -25 to 90°C



MCG Ref	Code	Ø
PCLIP20	2793-5449	20 mm
PCLIP25	2793-5452	25 mm
PCLIP32	2793-5455	32 mm

UNDERGROUND FLEXIBLE DUCTING

Underground Flexible Ducting

- Double-walled ducting to protect underground cable runs
- Smooth inner lining and pre-installed draw string for easy cable feed
- Crush resistant
- High resistance to water and chemicals
- BS EN 61386-24



MCG Ref	Code	Ø	Length
TWU5063BL	2821-4728	50 mm	50 m

COMPRESSION GLANDS

Nylon Glands with Locknut IP68



- For use with round cable only
- Supplied with washer and locknut
- Operating temperature: -40 to 100°C [intermittent to 120°C]
- BS EN 62444



MCG Ref	Code	Thread Size	Colour	Cable Size Ø	Pack
M16GB	0070-2517	16 mm	Black	4 - 8 mm	10
M16G	0013-6681	16 mm	Grey	4 - 8 mm	10
M20GB	0070-2535	20 mm	Black	6 - 12 mm	10
M20G	0013-6687	20 mm	Grey	6 - 12 mm	10
M20GR	0070-2538	20 mm	Red	6 - 12 mm	10
M20GW	0070-2541	20 mm	White	6 - 12 mm	10
M25GB	0070-2553	25 mm	Black	13 - 18 mm	10
M25G	0013-6699	25 mm	Grey	13 - 18 mm	10
M25GW	0070-2559	25 mm	White	13 - 18 mm	10
M32GB	0070-2571	32 mm	Black	16 - 21 mm	10
M32G	0013-6705	32 mm	Grey	16 - 21 mm	10
M32GW	0070-2577	32 mm	White	16 - 21 mm	10
M40G	0070-2589	40 mm	Grey	22 - 32 mm	1
M50G	0260-9725	50 mm	Grey	32 - 38 mm	1

Long Thread Nylon Glands with Locknut IP68



- Nitrile rubber hermetic seal
- Supplied with washer and locknut
- Long thread: 15 mm
- Operating temperature: -40 to 100°C [intermittent to 120°C]
- BS EN 62444



MCG Ref	Code	Thread Size	Cable Size Ø	Pack
M20GSLB	2293-1053	20 mm	6 - 12 mm	10
M20GWLB	2293-1062	20 mm	10 - 14 mm	10

DIN RAIL

DIN Rail



- Galvanised steel construction, zinc-plated and dichromated
- Length: 2 m
- BS EN 60715

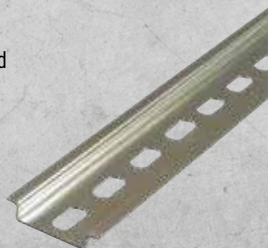

MCG Ref	Code	Description	Width	Depth
TS35P	0013-8247	Plain	35 mm	7.5 mm
TS35S	0013-8250	Slotted	35 mm	7.5 mm



Check local branches & online for latest pricing

MODULAR DIN RAIL TERMINALS

DIN Rail Terminals



- Mounted: DIN rail and G-rail
- BS EN 60947

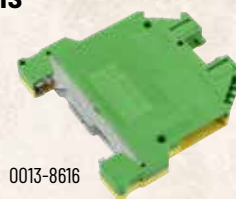

0013-8616

MCG Ref	Code	Nominal Cross Section	Current Rating	Colour
Standard Feed-Through Terminals				
WK2.5U	0013-8496	2.5 mm ²	24A	Grey
WK4U	0013-8547	4 mm ²	32A	Grey
WK6U	0013-8568	6 mm ²	41A	Grey
WKN10U	0013-8589	10 mm ²	57A	Grey
WKN16U	0013-8601	16 mm ²	71A	Grey
WKN35U	0013-8610	35 mm ²	124A	Grey
Green / Yellow Earth Terminals - DIN Rail Only				
WKN4SLU	0013-8613	4 mm ²	-	Green / Yellow
WKN6SLU	0013-8616	6 mm ²	-	Green / Yellow
WKN10SLU	0013-8586	10 mm ²	-	Green / Yellow
WKN16SLU	0013-8598	16 mm ²	-	Green / Yellow
Fuse Disconnect Terminals				
WK4THSI5U	0013-8538	4 mm ² G - Fuse 5 x 30 mm	6.3A	Grey
WK10SI5X20	0013-8487	10 mm ² G - Fuse 5 x 20 mm	10A	Grey

Universal Stop End



- Universal end clamp with U-foot
- Mounted: DIN rail and G-rail
- BS EN 60947



MCG Ref	Code	Width
WE1/U	0013-8481	10 mm

Stop End



- Mounted: DIN rail
- BS EN 60947



MCG Ref	Code	Width
2S35	0013-3225	8 mm

End Plates



- Protects against electric shock
- Pack of 10
- BS EN 60947

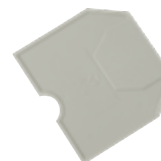

MCG Ref	Code	Suitable For
AP2.5/4	0013-4467	WK2.5 / 4U Terminals
AP6	0013-4506	WK6U Terminals
APN10	0013-4512	WKN10U Terminals
APN16	0013-4515	WKN16U Terminals

PLUG-IN RELAYS AND ACCESSORIES

Changeover Plug-In Relays



- High electrical endurance
- Lockable push-to-test button, flag indicator and built-in LED as standard
- Industry standard round plug-in terminals
- RoHS Compliant
- BS EN 61810-1



JQX10 Series relay bases sold separately:

- 8 Pin [0217-7308]
- 11 Pin [0217-7311]

MCG Ref	Code	Coil Voltage	No. of Pins	Current Rating
JQX10 Series - 2 Pole				
JQX10-012-2	0217-7338	12V DC	8	10A
JQX10-A024-2	0217-7356	24V AC	8	10A
JQX10-024-2	0217-7344	24V DC	8	10A
JQX10-A240-2	0217-7368	240V AC	8	10A
JQX10 Series - 3 Pole				
JQX10-012-3	0217-7341	12V DC	11	10A
JQX10-A024-3	0217-7359	24V AC	11	10A
JQX10-024-3	0217-7347	24V DC	11	10A
JQX10-A240-3	0217-7371	240V AC	11	10A

Relay Bases

- Operating temperature: -40 to 70°C
- Mounted: DIN rail
- IP20
- Approvals UL and CE

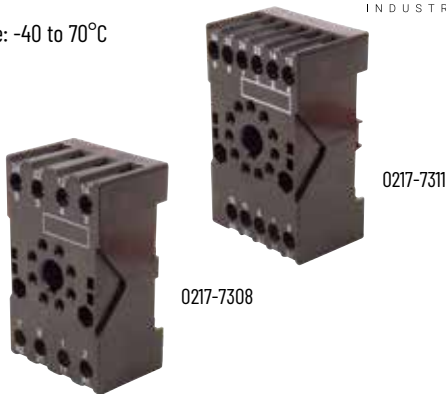

MCG Ref	Code	No. of Pins	Current Rating
JQX10 Series			
10-2Z-C3	0217-7308	8	10A
10-3Z-C3	0217-7311	11	10A

Changeover Plug-In Relays



- General purpose relay
- Lockable test button and mechanical flag indicator
- BS EN 61810-1

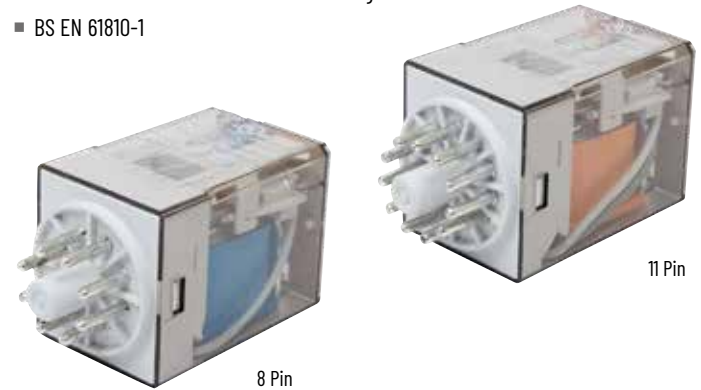

Series 60 base required for 35 mm DIN rail mounting [BS EN 60715] sold separately:

- 8 Pin [2786-1835]
- 11 Pin [2786-1838]

MCG Ref	Code	Coil Voltage	No. of Pins	Current Rating
Series 60 - 2 Pole				
6012-9012-0040	0013-3906	12V DC	8	10A
6012-8024-0040	0013-3897	24V AC	8	10A
6012-9024-0040	0013-3909	24V DC	8	10A
6012-8230-0040	0013-3903	230V AC	8	10A
Series 60 - 3 Pole				
6013-8024-0040	0013-3921	24V AC	11	10A
6013-9024-0040	0013-3936	24V DC	11	10A
6013-8230-0040	0013-3930	230V AC	11	10A

Sub-Miniature Plug-In Relays



- Power relay for direct PCB or socket mount
- BS EN 61810-1



Series 40 base required for 35 mm DIN rail sold separately:

MCG Ref	Code	Coil Voltage	No. of Pins	Current Rating
Series 40 - Single Pole				
4061-7012	0035-0983	12V DC	8	16A
Series 40 - 2 Pole				
4052-7012	0035-0968	12V DC	8	8A
4052-7024	0035-0971	24V DC	8	8A
4052-8230	0035-0980	230V AC	8	8A

Relay Bases

- Supplied with metal retaining clip
- Operating temperature: -40 to 70°C
- Mounted: Panel or DIN rail [BS EN 60715]
- IP20
- BS EN 61984

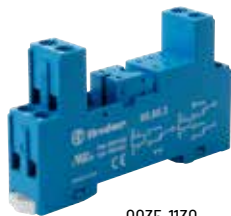

0035-1130



2786-1835



2786-1838

MCG Ref	Code	No. of Pins
Series 40		
9585	0035-1130	8
Series 60		
9020SMA	2786-1835	8
9021SMA	2786-1838	11

Miniature Changeover Plug-In Relays



- Lockable test button
- Built-in LED indicator
- BS EN 61810-1

Series 56 base required for 35 mm DIN rail mounting [BS EN 60715] sold separately:

- 8 Pin [0013-4182]



0013-3855



0013-3858

MCG Ref	Code	Coil Voltage	No. of Pins	Current Rating
Series 56 - 2 Pole				
5632-9012-0094	0013-3858	12V DC	8	12A
5632-8230-0054	0013-3855	230V AC	8	12A

MOTOR STARTERS AND ACCESSORIES

Direct On Line Starters [Without Overload]

- Robust plastic enclosure with large Start / Stop buttons
- Suitable for applications where a metal enclosure is not required
- Overloads sold separately - see page 10
- Prewired contactor
- Cable entries: Multiple knockouts
- Mounted: Surface
- IP55
- BS EN 60947

MCG Ref	Code	kW Rating	Coil Voltage	Metric hp	Approx. Full Load Current
DL4 240V	0462-8686	3.7 kW	240V AC	5 hp	22A
DL11 415V	0462-8518	11 kW	415V AC	15 hp	22A



Direct On Line Starters [Without Overload]

- Robust, pressed steel enclosure with removable lid and large Start / Stop buttons
- Prewired and tested prior to despatch
- Compatible Crompton overload devices sold separately - see page 10
- Cable entry: Multiple knockouts
- Mounted: Surface
- IP55
- BS EN 60947



MCG Ref	Code	kW Rating	Voltage	No. of Phases	Compatible Overloads	Full Load Current
Direct On Line Starters without Overload [No Isolator]						
3DL1CZS10	1037-0857	1.5 kW	230V	1	CR09, CR12	12A
3DL2CZS10	1033-3072	2.2 kW	230V	1	CR16	18A
3DL1EZS	1033-3060	5.5 kW	400V	3	CR09, CR12	12A
3DL2EZS	1033-3081	7.5 kW	400V	3	CR16	18A



Mini Contactor

- For use with heating and lighting applications
- Max. Voltage rating: 660V
- Coil fitted as standard
- Operating temperature: -5 to 40°C
- Cage type cable terminals
- Mounted: DIN rail or panel
- BS EN 60947-4-1



MCG Ref	Code	Contact Configuration	Auxiliary Contact	Coil Voltage	kW Rating	Metric hp	Current Rating AC1	Current Rating AC3	1+
3 Pole - Dimensions: 58 mm[H] x 45 mm[W] x 58 mm[D]									
DL09-30-10 240V	0462-8491	3 NO	1 NO	240V AC	4 kW	5.5 hp	20A	9A	£33.56

Contactors

- Max. Voltage rating: 660V
- Coil fitted as standard
- Cage type cable terminals
- Mounted: DIN rail or panel
- BS EN 60947-4-1
- Use 'Ref No.' for compatible overloads on page 10



MCG Ref	Code	Ref No.	Contact Configuration	Auxiliary Contact	Coil Voltage	kW Rating	Metric hp	Current Rating AC1	Current Rating AC3
3 Pole: For use with motors, heating and lighting applications - Dimensions: 70 mm[H] x 45 mm[W] x 80 mm[D]									
DL9-30-10 240V	0462-8743	DL9	3 NO	1 NO	240V AC	4 kW	5.5 hp	20A	9A
DL9-30-10 415V	0462-8746	DL9	3 NO	1 NO	415V AC	4 kW	5.5 hp	20A	9A
DL12-30-10 240V	0462-8533	DL12	3 NO	1 NO	240V AC	5.5 kW	7.5 hp	25A	12A
DL18-30-10 240V	0462-8566	DL18	3 NO	1 NO	240V AC	9.3 kW	12.5 hp	32A	18A
DL18-30-10 415V	0462-8569	DL18	3 NO	1 NO	415V AC	9.3 kW	12.5 hp	32A	18A
Dimensions: 80 mm[H] x 56 mm[W] x 93 mm[D]									
DL25-30-10 240V	0462-8650	DL25	3 NO	1 NO	240V AC	11 kW	15 hp	40A	25A
Dimensions: 80 mm[H] x 56 mm[W] x 93 mm[D]									
DL32-30-10 240V	0462-8665	DL32	3 NO	1 NO	240V AC	15kW	20 hp	50A	32A

Contactors

- Coil fitted as standard
- Cage type cable terminals
- Mounted: DIN rail or panel
- BS EN 60947
- Use 'Ref No.' for compatible overloads on page 10



MCG Ref	Code	Ref No.	Contact Configuration	Auxiliary Contact	Coil Voltage	kW Rating	Metric hp	Current Rating AC1	Current Rating AC3
3 Pole: For use with motors, heating and lighting applications									
Dimensions: 74 mm[H] x 45 mm[W] x 80 mm[D]									
CC0910 230V	1037-1046	CC09	3 NO	1 NO	230V AC	5.5 kW	7.5 hp	25A	12A
CC1210 230V	1037-1070	CC12	3 NO	1 NO	230V AC	7.5 kW	10 hp	25A	18A
CC1210 400V	1037-1079	CC12	3 NO	1 NO	400V AC	7.5 kW	10 hp	25A	18A
Dimensions: 74 mm[H] x 45 mm[W] x 85 mm[D]									
CC1810 230V	1033-3279	CC18	3 NO	1 NO	230V AC	11 kW	15 hp	32A	25A
Dimensions: 84 mm[H] x 56 mm[W] x 93 mm[D]									
CC2510 230V	1037-1091	CC25	3 NO	1 NO	230V AC	15 kW	20 hp	40A	32A

MOTOR STARTERS AND ACCESSORIES

Overloads



- For use with DL range of DOL starters and contactors
- Adjustable overload range
- 1 NO and 1 NC auxiliary as standard
- Red stop plunger and manual / automatic reset
- Mounted: Direct to contactor or with mounting bracket – sold separately
- BS EN 60947-4-1



MCG Ref	Code	Overload Rating
Suitable for DL9 Contactors		
DL2-2.5	0462-8602	1.6 - 2.5A
DL2-4	0462-8611	2.5 - 4A
DL2-6	0462-8620	4 - 6A
DL2-8	0462-8629	5.5 - 8A
DL2-10	0462-8590	7 - 10A
Suitable for DL12 Contactors		
DL2-13	0462-8593	9 - 13A
Suitable for DL18 Contactors		
DL2-18	0462-8596	12 - 18A
Suitable for DL18 - DL25 Contactors		
DL2-25	0462-8605	17 - 25A

Overloads



- For use with CC range of DOL starters and contactors
- Adjustable overload range
- 1 NO and 1 NC auxiliary as standard
- Red stop plunger and manual reset
- Mounted: Direct to contactor or with mounting bracket – sold separately
- BS EN 60947-4-1

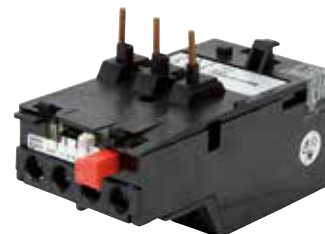

MCG Ref	Code	Overload Rating
Suitable for CC09 - CC32 Contactors		
CR09/2.5	1033-3330	1.6 - 2.5A
CR09/4	1033-3333	2.5 - 4A
CR09/6	1033-3339	4 - 6A
CR09/8	1033-3342	5.5 - 8A
CR09/10	1033-3321	7 - 10A
CR12/13	1033-3348	10 - 13A
CR16/18	1033-3354	13 - 18A
CR25/25	1033-3360	18 - 25A

10A Auxiliary Contacts



- For front mounting on to DL range of contactors
- Cage type cable terminals
- BS EN 60947-5-1



MCG Ref	Code	Contact Configuration
DL1-11	0462-8500	1 NO + 1 NC
DL1-22	0462-8509	2 NO + 2 NC

10A Auxiliary Contacts



- For front mounting on Crompton range of contactors
- Cage type cable terminals
- BS EN 60947



MCG Ref	Code	Contact Configuration	Mounted
CBF11	1033-3249	1 NO + 1 NC	Front
CBF22	1037-1031	2 NO + 2 NC	Front

PUSHBUTTONS AND STATIONS

Roller Shutter Door Key Switch

- Tough aluminium enclosure
- Three position spring return to centre action
- Mounted: Surface
- BS EN 60947
- IP54

Includes:

- Contact blocks
- 3 x Keys



MCG Ref	Code	Current Rating	Contact Configuration	1+
ROLLER16A	1442-5999	16A	2 NO	£68.33



Empty Pushbutton Stations IP65

- Numerous cable entries
- Accepts 22.5 mm[Ø] pushbuttons and indicators
- Not suitable for illuminated pushbuttons
- Mounted: Surface
- IP65 [when assembled]
- BS EN 60947-5-1



0048-9184



0013-6984



MCG Ref	Code	No. of Holes	Colour
Plastic			
PBS1/Y	0048-9184	1	Yellow
PBS2	0013-6984	2	Grey
PBS1	0013-6951	1	Grey

Empty Pushbutton Stations IP65

- Accepts 22.5 mm[Ø] pushbuttons, selector switches and key operated switches
- Not for use with illuminated pushbuttons
- Numerous cable entries
- Mounted: Surface
- IP65 [when assembled]
- BS EN 60947-5-1



MCG Ref	Code	No. of Holes	Colour
Plastic			
PB050CBP	1736-8843	1	Grey
PB046CBP	1736-8840	1	Yellow
PB051CBP	1736-8846	2	Grey

Made Up Pushbutton Stations IP65

- Pre-assembled pushbutton stations complete with contact block
- 10A at 230V AC, 3A at 24V DC
- Mounted: Surface
- BS EN 60947-5-1



0013-6954



0013-6960

Includes:

- 2 x Keys [key operated switch only]



MCG Ref	Code	Contact Configuration	Operation
Plastic			
PBS1 ES	0013-6954	1 NC	Emergency Stop, Twist Release
PBS1 ESK	0013-6960	1 NC	Emergency Stop, Key Release

10A Standard Pushbutton Switches IP65

- Suitable for panel door or enclosed control station mounting
- Switch operation: Momentary
- Complete with mounting coupler and contact block
- Cut out: 22.5 mm[Ø]
- IP65 [when assembled]
- BS EN 60947-5-1



0043-7587



0043-7395



MCG Ref	Code	Colour	Contact Configuration
GPB 10	0043-7395	Green	1 NO
RPB 01	0043-7587	Red	1 NC

Standard Pushbuttons IP65

- Complete pushbutton assemblies with mounting coupler and contact block
- Suitable for panel door and enclosed control station mounting
- Cut out: 22.5 mm[Ø]
- IP65 [when assembled]
- BS EN 60947-5-1



2217-6931



2217-6934



MCG Ref	Code	Colour	Contact Configuration	Operation
PB013CN0BP	2217-6931	Green	1 NC	Momentary
PB017CN0BP	2217-6934	Red	Momentary	1 NC

Emergency Stop Pushbutton IP65

- Complete pushbutton assembly with mounting coupler and contact block
- Suitable for panel door and enclosed control station mounting
- Cut out: 22.5 mm[Ø]
- IP65 [when assembled]
- BS EN 60947-5-1



MCG Ref	Code	Contact Configuration	Operation
PB088CNCBP	2217-6949	1 NC	Twist Release

10A Emergency Stop Pushbuttons IP65



- Suitable for panel door and enclosed control station mounting
- Mushroom head
- Complete with mounting coupler and contact block
- Cut out: 22.5 mm[Ø]
- IP65 [when assembled]
- BS EN 60947-5-1

0043-7377

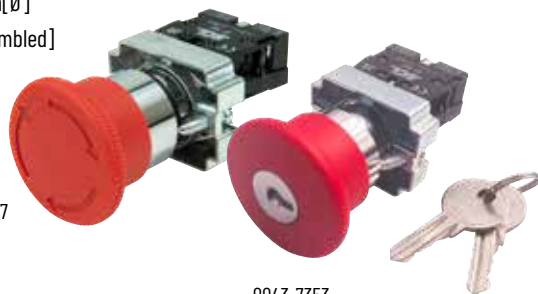

0043-7353

Includes:

- 2 x Keys [0043-7353] only

MCG Ref	Code	Contact Configuration	Operation
ETR 01	0043-7377	1 NC	Twist Release
EKR 01	0043-7353	1 NC	Key Release

Switches IP65



- Complete assemblies with mounting coupler and contact block
- Suitable for panel door and enclosed control station mounting
- Cut out: 22.5 mm[Ø]
- IP65 [when assembled]
- BS EN 60947-5-1

2217-6943



2217-6937

Includes:

- 2 x Keys [key operated switch only]

MCG Ref	Code	No. of Positions	Contact Configuration	Operation
Key Operated Switch				
PB031CNOBP	2217-6937	2	1 NO	Latching
Rotary Selector Switches				
PB036CNOBP	2217-6946	2	1 NO	Latching
PB035C2NOBP	2217-6943	3	2NO	Latching

LED Indicators IP65



- High-visibility LED
- Flame retardant ABS
- Vibration resistant
- Cut out: 22.5 mm[Ø]
- Ambient temperature: -5 to 40°C
- Lamp life: 30,000 hrs
- BS EN 60947



0055-6987

0055-6996

MCG Ref	Code	Colour	Voltage Rating
PL22-240G	0055-6987	Green	230V AC
PL22-240R	0055-6996	Red	230V AC
PL22-240W	0055-7005	White	230V AC



Check local branches & online for latest pricing

10A Switches IP65



- Suitable for panel door or enclosed control station mounting
- Complete with mounting coupler and contact block
- Cut out: 22.5 mm[Ø]
- IP65 [when assembled]
- BS EN 60947-5-1



0043-7593

0043-7599

Includes:

- 2 x Keys [key operated switch only]

MCG Ref	Code	No. of Positions	Contact Configuration	Operation
Key Operated Switch				
S2PK 10	0043-7599	2	1 NO	Stay Put
Rotary Selector Switches				
S2P 10	0043-7593	2	1 NO	Stay Put
S3P 20	0043-7605	3	2NO	Stay Put

10A Front Mounting Contact Blocks



- Suitable for use with panel mount pushbuttons, switches and complete pushbutton stations
- Screw terminals
- Requires front mounting coupler - sold separately
- Voltage rating: 600V
- BS EN 60947-5-1



0043-7317

0043-7323

MCG Ref	Code	Contact Configuration
CB NO	0043-7323	1 NO
CB NC	0043-7317	1 NC

10A Contact Blocks



- Suitable for use with panel mount pushbuttons and switches
- Screw terminals
- Voltage rating: 240V
- BS EN 60947-5-1

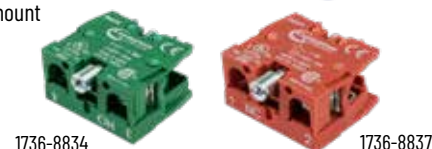

1736-8834

1736-8837

MCG Ref	Code	Contact Configuration
PB039CBP	1736-8834	1 NO
PB040CBP	1736-8837	1 NC

LED Indicator Light Assemblies IP65



- High-visibility LED
- Low power consumption
- Vibration resistant
- Cut out: 22.5 mm[Ø]
- IP65 [when assembled]
- BS EN 60947-5-1



2217-6952

2217-6955

MCG Ref	Code	Colour	Voltage Rating
PB106CBP	2217-6952	Green	230V AC
PB107CBP	2217-6955	Red	230V AC
PB110CBP	2217-6964	White	230V AC

INDUSTRIAL PLUGS AND SOCKETS

110V Plugs and Sockets IP44

- Corrosion and impact-resistant thermoplastic
- Operating temperature: -25 to 50°C
- IEC 60309-1 and 2



MCG Ref	Code	Current Rating	Type
2P+E 3 Pin			
CXN163P110P	2070-9208	16A	Plug - Cable Gland
CXN163P110C	2070-9223	16A	Coupler - Cable Gland
CXN163P110W20	2297-1400	16A	Wall Socket - Cable Gland
CXN323P110P	2070-9217	32A	Plug - Cable Gland
CXN323P110C	2070-9241	32A	Coupler - Cable Gland

230V Plugs and Sockets IP44

- Corrosion and impact-resistant thermoplastic
- Operating temperature: -25 to 50°C
- IEC 60309-1 and 2



MCG Ref	Code	Current Rating	Type
2P+E 3 Pin			
CXN163P240P	2073-6742	16A	Plug - Cable Gland
CXN163P240C	2070-9226	16A	Coupler - Cable Gland
CXN163P240W20	2297-1403	16A	Wall Socket
CXN323P240P	2070-9220	32A	Plug - Cable Gland
CXN323P240C	2070-9244	32A	Coupler - Cable Gland
CXN323P240W25	2302-9585	32A	Wall Socket - Cable Gland

415V Plugs and Sockets IP44

- Corrosion and impact-resistant thermoplastic
- Operating temperature: -25 to 50°C
- IEC 60309-1 and 2

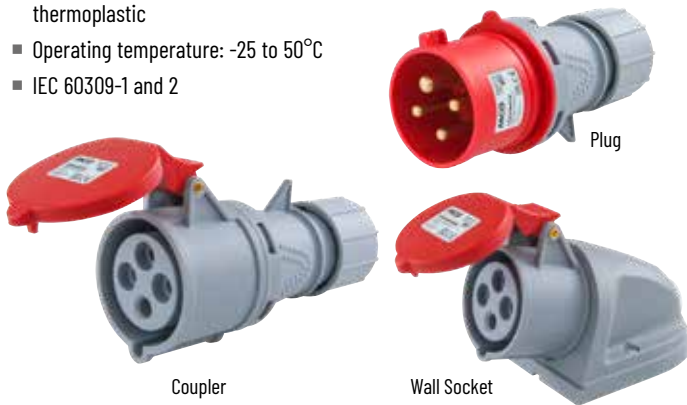

MCG Ref	Code	Current Rating	Type
3P+E 4 Pin			
CXN164P415P	2070-9211	16A	Plug - Cable Gland
CXN164P415C	2070-9235	16A	Coupler - Cable Gland
CXN164P415W20	2300-8096	16A	Wall Socket
CXN324P415P	2070-9229	32A	Plug - Cable Gland
CXN324P415C	2070-9247	32A	Coupler - Cable Gland
CXN324P415W25	2299-8733	32A	Wall Socket
3P+N+E 5 Pin			
CXN165P415P	2070-9214	16A	Plug - Cable Gland
CXN165P415C	2070-9238	16A	Coupler - Cable Gland
CXN165P415W25	2299-8727	16A	Wall Socket
CXN325P415P	2070-9232	32A	Plug - Cable Gland
CXN325P415C	2070-9250	32A	Coupler - Cable Gland
CXN325P415W25	2299-8736	32A	Wall Socket

415V Plugs and Sockets IP67

- Corrosion and impact-resistant thermoplastic
- Operating temperature: -25 to 50°C
- IEC 60309-1 and 2



MCG Ref	Code	Current Rating	Type
3P+N+E 5 Pin			
CXN635P415P67	2073-6895	63A	Plug - Cable Gland
CXN635P415C67	2073-6892	63A	Coupler - Cable Gland



110V Plugs and Sockets IP44

- High-impact thermoplastic housing
- Operating temperature: -25 to 40°C
- IEC 60309-1 and 2

Walthers



MCG Ref	Code	Current Rating	Type
2P+E 3 Pin			
210304	0013-2943	16A	Plug - Flexible Grommet Entry
310304	0013-3243	16A	Coupler - Flexible Grommet Entry
110304	0013-2760	16A	Wall Socket
230304	0013-3057	32A	Plug - Cable Gland
330304	0013-3297	32A	Coupler - Flexible Grommet Entry

230V Plugs and Sockets IP44

- High-impact thermoplastic housing
- Operating temperature: -25 to 40°C
- IEC 60309-1 and 2

Walthers



MCG Ref	Code	Current Rating	Type
2P+E 3 Pin			
210306	0013-2949	16A	Plug - Flexible Grommet Entry
310306	0013-3249	16A	Coupler - Flexible Grommet Entry
110306	0013-2763	16A	Wall Socket
230306	0013-3060	32A	Plug - Flexible Grommet Entry
330306	0013-3300	32A	Coupler - Flexible Grommet Entry
130306	0013-2841	32A	Wall Socket

Need a product datasheet?
Download at cef.co.uk

Check local branches & online for latest pricing

415V Plugs and Sockets IP44

- High-impact thermoplastic housing
- Operating temperature: -25 to 40°C
- IEC 60309-1 and 2

Walthers



MCG Ref	Code	Current Rating	Type
3P+E 4 Pin			
210406	0013-2961	16A	Plug - Cable Gland
310406	0013-3258	16A	Coupler - Flexible Grommet
110406	0013-2772	16A	Wall Socket
230406	0013-3069	32A	Plug - Cable Gland
330406	0013-3306	32A	Coupler - Cable Gland
130406	0013-2847	32A	Wall Socket
3P+N+E 5 Pin			
210	0013-2940	16A	Plug - Cable Gland
310	0013-3240	16A	Coupler - Cable Gland
110	0013-2757	16A	Wall Socket
230	0013-3054	32A	Plug - Cable Gland
330	0013-3294	32A	Coupler - Cable Gland
130	0013-2835	32A	Wall Socket

415V Plug and Sockets IP67

- High-impact thermoplastic housing
- Operating temperature: -25 to 40°C
- IEC 60309-1 and 2

Walthers

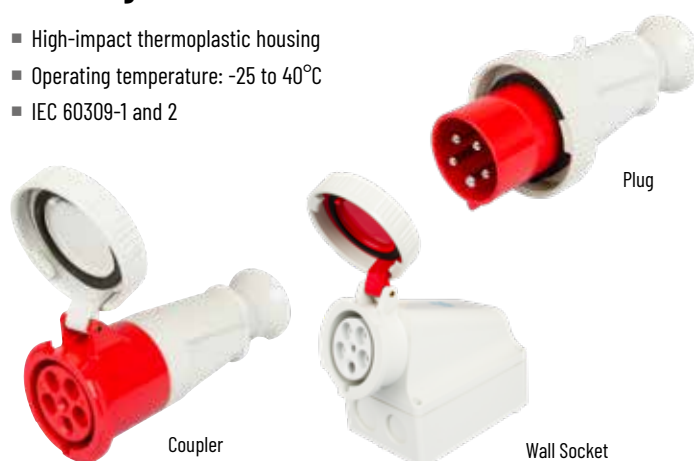

MCG Ref	Code	Current Rating	Type
3P+N+E 5 Pin			
269	0013-3147	63A	Plug - Cable Gland
369	0013-3345	63A	Coupler - Cable Gland
169	0013-2892	63A	Wall Socket

110V Interlocked Switched Socket IP44



- Corrosion and impact-resistant thermoplastic
- Padlockable rotary switch
- Operating temperature: -25 to 40°C
- IIEC 60309-1, 2 and 4



MCG Ref	Code	Current Rating
2P+E 3 Pin		
CX163P110SIS	1453-9162	16A

230V Interlocked Switched Sockets IP44



- Corrosion and impact-resistant thermoplastic
- Padlockable rotary switch
- Operating temperature: -25 to 40°C
- IEC 60309-1, 2 and 4



MCG Ref	Code	Current Rating
2P+E 3 Pin		
CX163P240SIS	1453-9165	16A
CX323P240SIS	1453-9174	32A

415V Interlocked Switched Sockets IP44



- Corrosion and impact-resistant thermoplastic
- Padlockable rotary switch
- Operating temperature: -25 to 40°C
- IEC 60309-1, 2 and 4



MCG Ref	Code	Current Rating
3P+E 4 Pin		
CX164P415SIS	1453-9168	16A
CX324P415SIS	1453-9177	32A
3P+N+E 5 Pin		
CX165P415SIS	1453-9171	16A
CX325P415SIS	1453-9180	32A

SITE EQUIPMENT

110V Site Extension Leads - 14 m



- Arctic grade cable
- Fitted with 16A 2P+E plug and coupler
- IP44
- BS EN 60309



MCG Ref	Code	Cable Size
SEL1415 110V	0013-7491	1.5 mm ²
SEL1425 110V	0013-7497	2.5 mm ²

16A Floor Standing Cable Reels



- Open reel with metal frame and gripped carry handle
- Thermal overload and power reset button
- Max. Current [full wound]: 5A
[fully unwound]: 16A
- IP44
- BS EN 61242



Includes:

- 110V 16A 2P+E Plug
- 2 x 110V 16A 2P+E Sockets

MCG Ref	Code	Cable Length	Cable Size	No. of Sockets
CX2515FSTS 110V	2704-3081	25 m	1.5 mm ²	2
CX5015FSTS 110V	2704-3084	50 m	1.5 mm ²	2



**Easy ways
to pay**

Cash, card or trade account

16A 2P+E 110V 3 Way Y Splitter



- Manufactured from thermoplastic - suitable for general use
- Conforms to IEC 60309-1/2
- Ergonomic grip
- Corrosion and impact resistant
- Colour coded for fast identification of operating voltage
- Safe and reliable
- Typical operating temperature -25°C to 50°C
- IP44



MCG Ref	Code	Voltage	Current Rating
CX163P110YS	1477-7521	110V	16A
CX163P110YSL	1488-7171	110V	16A

Site Extension Socket Splitter Box



- Strong metal construction
- IP44
- BS EN 60309



Includes:

- 110V 16A 2P+E Plug
- 4 x 16A 2P+E 110V Sockets

MCG Ref	Code	Cable Length	Cable Size	No. of Sockets
EOU1415	0013-5529	5 m	1.5 mm ²	4

LED Rechargeable Floodlights with Power Bank



- Tough polycarbonate housing and arm with strong magnetic body
- 50% and 25% Dimmable function
- Power bank function for your USB devices
- Run time: 3 hrs [12 hrs low power]
- Lumen outputs [10W]: 800 lm
[200 lm low power]
[20W]: 1,600 lm
[400 lm low power]
- Beam angle: 120°
- Colour temperature: Daylight 6500K
- Lamp life: 25,000 hrs
- IP54
- Guarantee: 1 Year



Visit cef.co.uk for video demonstration

Power bank function

Includes:

- Micro USB cable
- Rechargeable battery: Li-Ion

MCG Ref	Code	Wattage	Run Time	Lumens
CXFLR10	2704-3093	10W	3 hrs	800 lm
CXFLR20	2704-3099	20W	3 hrs	1600 lm



Check local branches & online for latest pricing

16A Portable Tool Transformers



- Fibreglass-reinforced plastic construction
- Tool rated for intermittent use: 5 mins On, 15 mins Off
- 230V Input to 110V output
- Thermal safety cut out
- IP44
- BS EN 61558



MCG Ref	Code	VA Rating	No. of Sockets
CM15002/CL	0326-3350	1500 VA	2
CM33002/CL	0326-3353	3300 VA	2

LED Tripod Lights



- Foldable, easily transportable die-cast aluminium frame
- Telescopic tripod extendable up to 1.6 m
- Beam angle: 120°
- Colour temperature: Daylight 6500K
- Lamp life: 25,000 hrs
- IP54
- Guarantee: 1 Year



Includes:

- 3 m Prewired cable
- 16A 110V 2P+E Plug

MCG Ref	Code	No. of Heads	Wattage	Lumens
CXFL20X2	2704-3090	2	2 x 20W	3600 lm

LED Festoon GLS Kit 110V



- Suitable for indoor or outdoor use
- Polycarbonate LED lamps remove the risk of broken glass
- Lampholder spacing: 2 m
- IP44
- Guarantee: 1 Year



Kit contents:

- 10 x Lampholders
- 10 x Plastic guards
- 10 x 10W LED Lamps
- 16A 110V 2P+E Plug

MCG Ref	Code	Cap	No. of Lampholders	Length
25MFKESLPK	2584-8613	ES / E27	10	25 m

METALCLAD CONSUMER UNIT & ACCESSORIES

10kA Single Pole Single Module MCBs

- Incoming cables can be connected at the top or bottom with bi-directional protection
- Trip indicator
- Mounted: DIN rail
- BS EN 60898-1



MCG Ref	Code	Current Rating
B Curve 10 kA		
6A1PB10	2123-7112	6A
16A1PB10	2123-6863	16A
20A1PB10	2123-6905	20A
32A1PB10	2123-6965	32A
40A1PB10	2123-6998	40A
50A1PB10	2123-7043	50A

RCD Type B 30mA

- 2 & 4 Pole Options
- Insulated DIN rail clips
- Sensitivity 30mA [10kA]
- Test 'T' operating test button on the front panel
- Fault tripping indicator window
- Guarantee: 1 Year



MCG Ref	Code	Pole	Current Rating
63A2P30BT	2577-8734	2	63A
63A4P30BT	2577-8737	4	63A

Bi-Directional 2 Pole RCDs

- Interrupting capacity: 6 kA
- Incoming cables can be connected at the top or bottom with bi-directional protection
- Test button and trip indicator
- Terminal capacity: 35 mm²
- Mounted: DIN rail
- BS EN 61008-1



MCG Ref	Code	Current Rating	Tripping Sensitivity
Type A			
40A2P30AT	2579-4535	40A	30 mA
63A2P30AT	2579-4559	63A	30 mA
80A2P30AT	2579-4574	80A	30 mA
100A2P30AT	2579-4493	100A	30 mA

Single Pole Single Module Compact RCBOs

- Integrates residual and overcurrent protection in one device
- Test button and trip indicator
- Sensitivity: 30 mA [6 kA]
- Mounted: DIN rail
- BS EN 61009-1



Includes:

- 400 mm Neutral cable

MCG Ref	Code	Current Rating
B Curve 6 kA - Type A		
6A2P30B6MAT	2704-6396	6A
10A2P30B6MAT	2704-6360	10A
16A2P30B6MAT	2704-6366	16A
20A2P30B6MAT	2704-6372	20A
32A2P30B6MAT	2704-6384	32A
40A2P30B6MAT	2704-6390	40A

Bi-Directional Single Pole Single Module Compact RCBOs

- Integrates residual and overcurrent protection in one device
- Incoming cables can be connected at the top or bottom with bi-directional protection
- Built-in switched neutral
- Test button and trip indicator
- Sensitivity: 30 mA [6 kA]
- Mounted: DIN rail

MCG Ref	Code	Current Rating
B Curve 6 kA		
6ARSN6B	2797-8712	6A
10ARSN6B	2797-8694	10A
16ARSN6B	2797-8697	16A
20ARSN6B	2797-8700	20A
32ARSN6B	2797-8706	32A
40ARSN6B	2797-8709	40A



The CEF Trade App

FREE
to download

Like your music app, but **with more AC and DC**

Search and order **thousands of products** from your pocket

- Check stock levels
- Pay securely
- Scan catalogue pages using your smartphone
- Create a trade account
- Check invoices, statements and credit notes
- Get delivery alerts direct to your phone
- Quotations

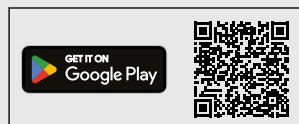
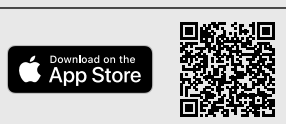

METAL CLAD CONSUMER UNIT & ACCESSORIES

Bi-Directional Double Pole Single Module AFDDs

- Combines arc fault detection with RCBO functions
 - Series and parallel arc fault detection
 - LED Trip indicator shows fault status and trigger type
 - Test button
 - Sensitivity: 30 mA [6 kA]
 - Mounted: DIN rail
 - BS EN 62606
- Includes:
- Prewired neutral cable



18th EDITION

MCG Ref	Code	Current Rating
B Curve 6 kA - Type A		
16A2P30BAFDD	2577-8704	16A
32A2P30BAFDD	2577-8722	32A

Surge Protection Device with Backup MCB

- Suitable for use with most brands of consumer units
- Protects against indirect lightning effects and transient surges
- Prolongs the life of appliances and sensitive electronic equipment
- Visual and remote end-of-life indication
- Backup MCB rating: 32A
- Mounted: DIN rail
- BS EN 61643-11
- Warranty: 1 Year



18th EDITION



Visit cef.co.uk for video demonstration

MCG Ref	Code	Type	Suitable For
Device with Cables and 32A B Curve MCB [6 kA]			
SPDT2PACK-M	2696-8078	2	TN-S, TN-C-S and TT Earthing

MODULAR CONTACTORS

Modular Contactors

- Ideal for switching heating and lighting applications
- Coil voltage: 230V AC
- Mounted: DIN rail
- BS EN 61095



MCG Ref	Code	Current Rating	No. of Modules	Contact Configuration
2 Pole				
MC120	1469-6029	20A	1	2 NO
4 Pole				
MC225	1469-4562	25A	2	4 NO
MC340	1462-6381	40A	3	4 NO
MC363	1462-6384	63A	3	4 NO



Check local branches & online for latest pricing

Modular Contactors

- Ideal for switching heating and lighting applications
- Coil voltage: 230V AC
- Mounted: DIN rail
- BS EN 61095



MCG Ref	Code	Current Rating	No. of Modules	Contact Configuration
2 Pole				
CC20A1MC2N0BP	2296-3882	20A	1	2 NO
4 Pole				
CC25A2MC4N0BP	2296-3897	25A	2	4 NO
CC40A3MC4N0BP	2296-3909	40A	3	4 NO

Double Pole Two Module Isolator

- Mounted: DIN rail
- EN 60947-3



MCG Ref	Code	Current Rating
100A2PI	2163-3175	100A

Metal Blanking Piece

- Pack of 4
- Designed for use with metal consumer units



MCG Ref	Code
MBP	2195-5240

Single Module Blanking Piece

- Will fit most modern boards and top hat DIN rail



MCG Ref	Code
BM1P	2020-1194

METAL ENCLOSURES

SP+N Mains Isolator Switch Fuse

- Robust metal-clad enclosure
- M20 and M25 knockouts top & bottom
- Five terminal earth bar
- Terminal capacity: 35 mm²
- IP20
- BS EN 61439-3

Includes:

- 100A 2 Pole Isolator
- Fuse carrier
- 63A HRC ME Fuse
- 80A HRC ME Fuse
- 100A HRC ME Fuse



MCG Ref	Code	Current Rating	Height	Width	Depth
MCGSFML	2302-9522	63A / 80A / 100A	225 mm	115 mm	82 mm

METAL CLAD CONSUMER UNITS & ACCESSORIES

Isolator Incomer Consumer Units



- Non-combustible metalclad consumer units
- Knockouts: M25, M32 and M40
- IP20
- BS EN 61439-3



Includes:

- 100A 2 Pole isolator

MCG Ref	Code	No. of Ways	Height	Width	Depth
MMSB4	2073-7348	4	235 mm	161 mm	110 mm
MMSB8	2073-7378	8	235 mm	233 mm	110 mm
MMSB10	2646-0604	10	235 mm	269 mm	110 mm
MMSB14	2403-3820	14	235 mm	341 mm	110 mm

Isolator Incomer Consumer Units – Surge Protected



- Non-combustible metalclad consumer units
- Ferruled cable ends for secure connections
- Knockouts: M25, M32 and M40
- IP20
- BS EN 61439-3



SPD Fitted

Includes:

- 100A 2 Pole isolator
- Type 2 surge protection device [40 kA] – [2696-8078]
- Backup 32A B curve MCB [6 kA]

MCG Ref	Code	No. of Ways	Height	Width	Depth
MMSB8SPDM	2711-1379	8	235 mm	305 mm	110 mm
MMSB10SPDM	2713-0024	10	235 mm	341 mm	110 mm
MMSB12SPDM	2713-0027	12	235 mm	377 mm	110 mm
MMSB14SPDM	2713-0030	14	235 mm	377 mm	110 mm
MMSB18SPDM	2799-8299	18	235 mm	450 mm	110 mm

Garage Units



- Non-combustible metalclad enclosure
- Knockouts [IP20]: Multiple M25 and M40 knockouts and rear aperture [IP65]: Multiple M20 knockouts and rear aperture
- BS EN 61439-3



Includes:

- 63A 30 mA RCD – Type A
- 6A and 16A B Curve MCBs [6 kA]

MCG Ref	Code	No. of Ways	Height	Width	Depth
IP20					
MGU63AT616	2646-0598	2	183 mm	125 mm	110 mm
IP65					
MGU63AT616IP65	2646-0601	2	220 mm	140 mm	100 mm

MCB DISTRIBUTION BOARDS & DEVICES

125A 4 Pole Incoming Isolator



- Terminal capacity: 35 mm²
- Mounted: DIN rail
- EN 60947-3



MCG Ref	Code
125A4PI	2123-6860

Branch

opening hours

Mon-Fri 7:30-5:30 Sat 8:30-12:00

[local exceptions may apply]

MCB DISTRIBUTION BOARDS & DEVICES

Single Pole Single Module MCBs

- Incoming cables can be connected at the top or bottom with bi-directional protection
- Trip indicator
- Mounted: DIN rail
- BS EN 60898-1



MCG Ref	Code	Current Rating
C Curve 10 kA		
6A1PC10	2123-7118	6A
10A1PC10	2123-6830	10A
16A1PC10	2123-6869	16A
20A1PC10	2123-6911	20A
32A1PC10	2123-6971	32A
40A1PC10	2123-7004	40A
50A1PC10	2123-7049	50A
63A1PC10	2123-7082	63A

3 Pole 3 Module MCBs

- Incoming cables can be connected at the top or bottom with bi-directional protection
- Trip indicator
- Mounted: DIN rail
- BS EN 60898-1



MCG Ref	Code	Current Rating
C Curve 10 kA		
6A3PC10	2123-7139	6A
10A3PC10	2123-6851	10A
16A3PC10	2123-6890	16A
20A3PC10	2123-6932	20A
32A3PC10	2123-6992	32A
40A3PC10	2123-7028	40A
50A3PC10	2123-7070	50A
63A3PC10	2123-7103	63A



Check local branches & online for latest pricing

Full Height RCBOs

- Integrates residual and overcurrent protection in one device
- Suitable for vertical busbars
- Sensitivity: 30 mA [10 kA]
- Mounted: DIN rail
- 3 Module options also available
- Also available on B & D Trip Curve
- BS EN 61009-1



Includes:

- 1 m Pre-wired neutral and earth cables

MCG Ref	Code	Current Rating
Single Pole B Curve 10 kA - Type A		
6A2P30BSMTP	2579-4565	6A
10A2P30BSMTP	2579-4496	10A
16A2P30BSMTP	2579-4502	16A
20A2P30BSMTP	2579-4511	20A
32A2P30BSMTP	2579-4526	32A
40A2P30BSMTP	2579-4538	40A
50A2P30BSMTP	2579-4550	50A
Single Pole C Curve 10 kA - Type A		
6A2P30CSMTP	2579-4568	6A
10A2P30CSMTP	2579-4499	10A
16A2P30CSMTP	2579-4505	16A
20A2P30CSMTP	2579-4514	20A
32A2P30CSMTP	2579-4529	32A
40A2P30CSMTP	2579-4541	40A
50A2P30CSMTP	2579-4553	50A

Single Module Blanking Piece



MCG Ref	Code
BM1P	2020-1194



Click & collect
At any branch in the UK

MCB DISTRIBUTION BOARDS & DEVICES

125A TP+N Distribution Boards with Mains Incomer – Surge Protected



- Non-combustible metalclad enclosure
- Reversible metal door and removable gland plates top and bottom for ease of installation
- IP3X
- BS EN 61439-3

Includes:

- 125A 4 Pole isolator
- Type 2 surge protection device with 32A 3 pole MCB

MCG Ref	Code	No. of Ways	Height	Width	Depth
Type B Board					
TPN4-125SPD	2840-6953	4	510 mm	450 mm	135 mm
TPN6-125SPD	2840-6956	6	564 mm	450 mm	135 mm
TPN8-125SPD	2840-6959	8	618 mm	450 mm	135 mm
TPN12-125SPD	2840-6947	12	726 mm	450 mm	135 mm



16 Module Extension Box



- Non-combustible metalclad enclosure
- Removable gland plates top and bottom
- IP3X
- BS EN 61439-3



Includes:

- Neutral and earth terminals
- Cable box

MCG Ref	Code	Height	Width	Depth
TPN-EXTB	2840-6932	500 mm	450 mm	135 mm

Cable Extension Box



- Offers additional space to tidy larger cables
- IP3X



MCG Ref	Code	Height	Width	Depth
TPN-CABB	2840-6923	100 mm	444 mm	123 mm

ROTARY ISOLATOR SWITCHES

Enclosed Rotary Isolators IP65

- Flame retardant ABS plastic
- Easy access and switch removal
- Current rating: AC21 [resistive loads]
- Padlockable in the Off position
- Cable entry: 20 mm[Ø] Knockouts
- Mounted: Surface
- BS EN 60947-3

MCG Ref	Code	Current Rating	Height	Width	Depth
3 Pole					
SMI20-3	0576-1585	20A	125 mm	100 mm	74 mm
SMI32-3	0433-2007	32A	125 mm	100 mm	74 mm
SMI63-3	0433-2019	63A	175 mm	125 mm	90 mm
4 Pole					
SMI20-4	0576-1588	20A	125 mm	100 mm	74 mm
SMI32-4	0433-2013	32A	125 mm	100 mm	74 mm
SMI32-4L	1462-6471	32A	175 mm	125 mm	90 mm
SMI63-4	0433-2025	63A	175 mm	125 mm	90 mm



ROTARY ISOLATOR SWITCHES

Enclosed Rotary Isolators IP66

Sälzer

- Insulated polycarbonate enclosure
- Current rating: AC21 [resistive loads]
- Padlockable in the Off position: 3 Lock positions
- Cable entry: Multiple knockouts
- Mounted: Surface
- BS EN 60947-3



MCG Ref	Code	Current Rating	Height	Width	Depth	1+
3 Pole						
3P20ASM	0013-3411	20A	100 mm	80 mm	65 mm	£23.41
3P32ASM	0013-3453	32A	125 mm	100 mm	85 mm	£35.73
3P63ASM	0013-3483	63A	175 mm	115 mm	100 mm	£63.48
4 Pole						
4P20ASM	0013-3648	20A	100 mm	80 mm	65 mm	£27.73
4P32ASM	0013-3672	32A	125 mm	100 mm	85 mm	£40.23
4P63ASM	0013-3690	63A	175 mm	115 mm	100 mm	£68.88
4P100ASM	0013-3633	100A	250 mm	160 mm	95 mm	£124.88

Enclosed Rotary Isolator IP65

MCG INDUSTRIAL

- Flame-retardant ABS plastic
- Easy access and switch removal
- Current rating: AC21 [resistive loads]
- Padlockable switch
- Cable entry: 20 mm[Ø] Knockouts
- Mounted: Surface
- BS EN 60947-3



MCG Ref	Code	Current Rating	Height	Width	Depth
4 Pole					
SMI100-4	1462-6426	100A	280 mm	190 mm	130 mm

DC Enclosed Rotary Isolator IP66

MCG INDUSTRIAL

- Easy access and switch removal
- Suitable for photovoltaic - isolators, inverter applications, DC solar pumps
- Padlockable in the Off position
- Cable entry: 20 mm[Ø] Knockouts
- Mounted: Surface
- BS EN 60947-3



MCG Ref	Code	Current Rating	Height	Width	Depth
4 Pole					
SMI16-4DC	2781-7849	20A	160 mm	100 mm	74 mm
SMI20-4DC	2781-7852	25A	160 mm	100 mm	74 mm
SMI32-4DC	2781-7858	40A	160 mm	100 mm	74 mm



Check local branches & online for latest pricing

SURGE PROTECTION DEVICES

Single Module Surge Protection Device

MCG INDUSTRIAL

- Suitable for use with most brands of consumer units
- Protects against indirect lightning effects and transient surges
- Prolongs the life of appliances and sensitive electronic equipment
- Visual end-of-life indication
- Recommended backup MCB: 16 - 32A
- Mounted: DIN rail
- BS EN 61643-11 and BS EN 62305
- Warranty: 10 Years



18th EDITION

MCG Ref	Code	Type	Suitable For	1+
SY2-D	2433-7003	2 + 3	TN-S, TN-C-S and TT	£49.98

ELECTRICITY METERS

100A Single Phase Electricity Meter

MCG INDUSTRIAL

- Accurately measures and displays active energy consumption [kWh] in a compact, surface mounted enclosure
- Large, easy-to-read LCD can be configured to cycle any of the available registers or remain static
- Optical port for configuration or meter reading
- Highly reliable and capable of withstanding high voltage events and overcurrent without failure
- Tamper resistant with reverse-energy fraud detection and sealing for life
- MID Certified
- EN 50470-1-3



MCG Ref	Code	Height	Width	Depth
MI PHMIDMETER	2027-1052	91 mm	125 mm	40 mm

100A Single Phase Dual Rate kWh Meter with LCD Display Direct Connection

MCG INDUSTRIAL

- Single phase meter for residential and small commercial users, for revenue measuring of active power in two wire systems
- Energy measurement: Standard (as a mechanical meter), double direction, always positive (absolute)
- Communication optical port for semi-automatic meter reading
- Real time internal clock generates a tariff program, season changeover, transition to day light saving period and vice-versa
- LCD Display with automatic and manual scroll modes
- LED Indicators to show meter status
- No need for recalibration in meters life-time
- Polycarbonate, self extinguishable enclosure
- IP53



MCG Ref	Code	Height	Width	Depth
ISK/ME162	0433-1965	97 mm	130 mm	43 mm

ELECTRICITY METERS

120A 3 Phase 4-Wire Dual Electricity / Pulsed Meter

- Large LCD display
- Does not require recalibration for the lifetime of the device
- OFGEM Approved
- LED Indicators show meter status
- IP54



MCG Ref	Code	Height	Width	Depth
ISK/MT174DC	1629-7411	250 mm	178 mm	55 mm

SAFETY LOCKOUTS KITS AND ACCESSORIES

Personal Lockout Kit

Kit contents:

- Red safety padlock [1 key]
- Aluminium MCB toggle lockout
- Universal MCB lockout
- Reusable lockout tag
- 5 x Cable ties
- Mini pouch



Visit cef.co.uk for video demonstration

MCG Ref	Code
LOTO KIT B	2483-8705

No Tool MCB Lockout Kit

- Quick and easy to install
- Compact universal design fits a wide variety of single, double and triple pole MCBs
- Padlockable once secured in place

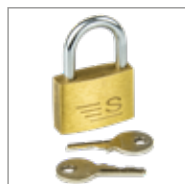

Kit contents:

- MCB lockout
- Brass padlock [2 keys]

MCG Ref	Code
LOTO KIT A	2483-8702

Domestic Installer Lockout Kit



Kit contents:

- Red safety padlock [1 key]
- Plunge MCB lockout [pin-in]
- Plunge MCB lockout [pin-out]
- Universal MCB lockout
- Steel lockout hasp
- Reusable lockout tag
- Cable tie
- Non-permanent pen
- Mini pouch



Visit cef.co.uk for video demonstration

MCG Ref	Code
LOTO KIT C	2483-8708

Contractor Lockout Kit



- Ideal for a contractor working on commercial, industrial or domestic installations and routine maintenance schedules



Kit contents:

- Red safety padlock [1 key]
- Grip tight MCB lockout [over toggle]
- Grip tight MCB lockout [sideways]
- Plunge MCB lockout [pin-in]
- Plunge MCB lockout [pin-out]
- Universal MCB lockout
- Steel lockout hasp
- 5 x Reusable lockout tags
- 5 x Cable ties
- Non-permanent pen
- Zipped carry bag



Visit cef.co.uk for video demonstration

MCG Ref	Code
MCB-KITIN	2483-8717

Stay ahead with CEF

From inbox to toolbox: power up your business
with **charged-up deals and current news**



✓ Exclusive offers
and discounts

✓ Latest technology
updates

✓ Expert tips to boost
your business



Don't miss out on savings
and insights tailored for you
Sign up today at cef.co.uk/subscribe



**YOUR
ELECTRICAL
EXPERTS**

Contact your local branch for more details

