



CASA DEL MAR®

HOTEL BY THE SEA

MEDITERRANEAN-INSPIRED LUXURY

"Casa Del Mar harkens to a grander, more opulent era." – The New York Times

etc
HOTELS

LEGEND
Preferred
HOTEL OWNERS



DISCOVER CASA



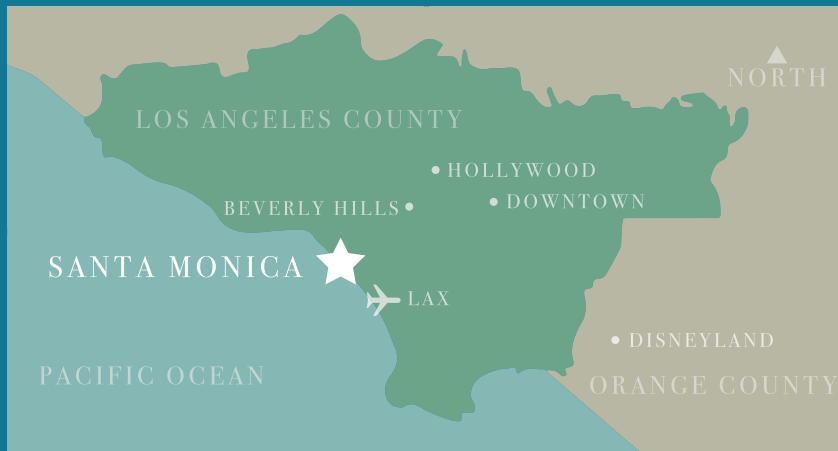
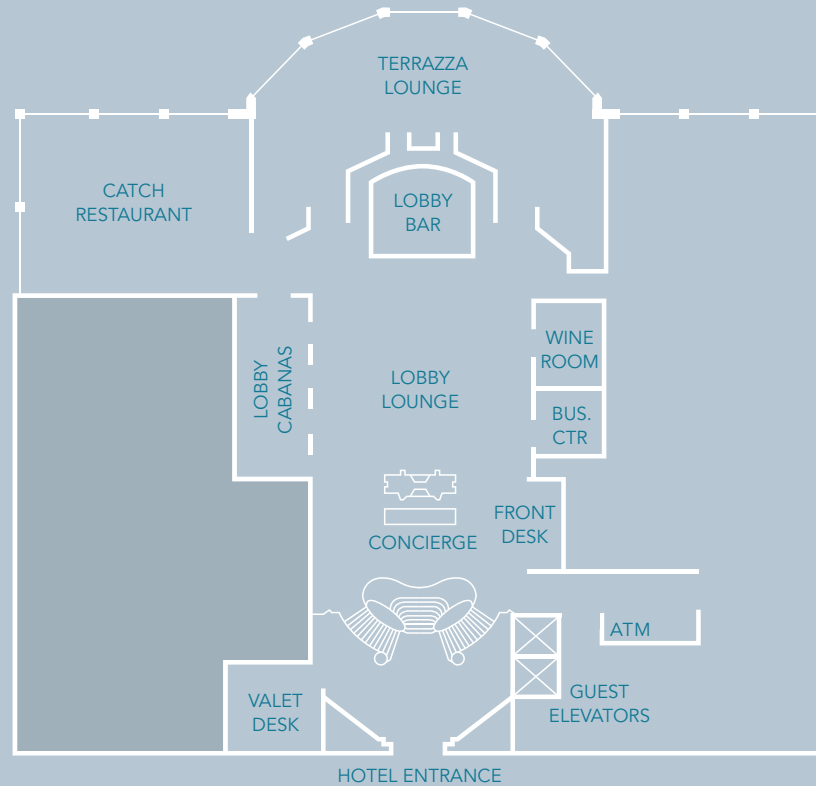

DISCOVER CASA DEL MAR

- 129 Guestrooms
- 16 Suites
- Restaurants - Catch & Terrazza
- Lobby Cabanas & Bar | 24-Hour In-Room Dining
- Sea Wellness Spa | Fitness Center
- Outdoor Heated Pool | Whirlpool Spa | Beach Activity Center
- Located on the world-renowned Santa Monica Beach, walking distance to Santa Monica Pier, Third Street Promenade and Santa Monica Place
- 8 miles to LAX and Beverly Hills; 15 miles to Downtown LA
- Valet Parking



etc
HOTELS

LEGEND
Preferred
HOTELS & RESORTS

ACCOMMODATIONS

Mediterranean-Inspired Luxury.

CASA DEL MAR
HOTEL BY THE SEA



etc
HOTELS

LEGEND
Preferred
HOTELS & RESORTS



ACCOMMODATIONS

KING BED GUESTROOM

*Superior and Deluxe are Non-Ocean View
Partial Ocean View, Ocean View and Premier Ocean View Kings*

- 400 square feet
- Residential feel with Area Rugs and Built-in Entertainment Cabinet
- Handcrafted California King Bed
- Bathroom includes Hydrothermal Massage Tub and Separate Shower
- LCD Flatscreen TV and Bluetooth Speaker System
- Keurig Coffee Machine

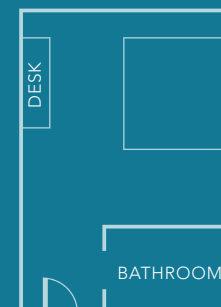

400 SQUARE FEET (not to scale)



etc
HOTELS

LEGEND
Preferred
HOTELS & RESORTS



CASA DEL MAR
HOTEL BY THE SEA

ACCOMMODATIONS

PALM TERRACE KING GUESTROOM

- 400 square feet
- Residential feel with Area Rugs and Built-in Entertainment Cabinet
- Handcrafted California King Bed
- Bathroom includes Hydrothermal Massage Tub and Separate Shower
- LCD Flatscreen TV and Bluetooth Speaker System
- Keurig Coffee Machine
- Outdoor Patio, opening onto Pool Deck

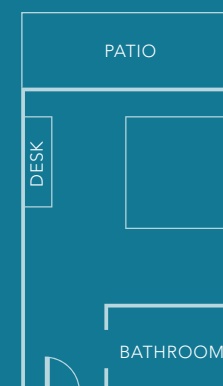

400 SQUARE FEET (not to scale)



etc
HOTELS

LEGEND
Preferred
HOTELS & RESORTS



CASA DEL MAR
HOTEL BY THE SEA

ACCOMMODATIONS

DOUBLE BED GUESTROOM

Deluxe Doubles are non-ocean view

- 400 square feet
- Residential feel with Area Rugs and Built-in Entertainment Cabinet
- Handcrafted California King Bed
- Bathroom includes Hydrothermal Massage Tub and Separate Shower
- LCD Flatscreen TV and Bluetooth Speaker System
- Keurig Coffee Machine

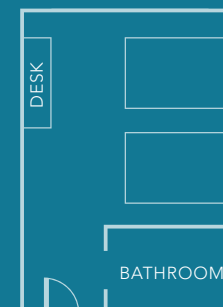

400 SQUARE FEET (not to scale)



etc
HOTELS

LEGEND
Preferred
HOTELS & RESORTS



CASA DEL MAR
HOTEL BY THE SEA

ACCOMMODATIONS

SANTA MONICA ONE BEDROOM SUITES

- 600 square feet
- Santa Monica city views (non-ocean view)
- Bedroom features Handcrafted California King Bed
- Italian Marble Bathroom featuring Hydrothermal Massage Tub and Separate Shower
- Living Room with Pull Out Sofa and Work Desk
- LCD Flatscreen TVs and Bluetooth Speaker System
- Nespresso Coffee & Espresso Machine

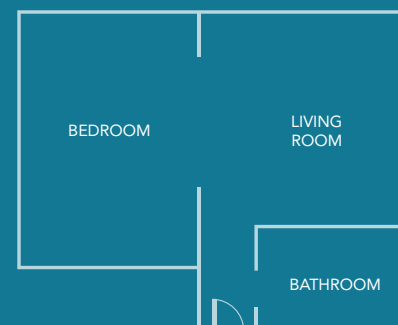

600 SQUARE FEET (not to scale)



etc
HOTELS

LEGEND
Preferred
HOTELS & RESORTS



CASA DEL MAR
HOTEL BY THE SEA

ACCOMMODATIONS

PARTIAL OCEAN VIEW ONE BEDROOM SUITES

- 700 square feet
- Located on the 2nd floor of the Hotel
- Bedroom features Handcrafted California King Bed
- Italian Marble Bathroom featuring Hydrothermal Massage Tub and Separate Shower
- Living Room with Pull Out Sofa and Work Desk
- Window Seats
- LCD Flatscreen TVs and Bluetooth Speaker System
- Nespresso Coffee & Espresso Machine



700 SQUARE FEET (not to scale)



etc
HOTELS

LEGEND
Preferred
HOTELS & RESORTS



CASA DEL MAR
HOTEL BY THE SEA

ACCOMMODATIONS

ONE BEDROOM

OCEAN VIEW SUITES

- 700 square feet
- Full Views of the Ocean and California Coastline
- Bedroom features Handcrafted California King Bed
- Italian Marble Bathroom featuring Hydrothermal Massage Tub and Separate Shower
- Living Room with Pull Out Sofa and Work Desk
- LCD Flatscreen TVs and Bluetooth Speaker System
- Nespresso Coffee & Espresso Machine



700 SQUARE FEET (not to scale)



etc
HOTELS

LEGEND
Preferred
HOTELS & RESORTS



CASA DEL MAR
HOTEL BY THE SEA

ACCOMMODATIONS

TWO BEDROOM OCEAN VIEW SUITES

- 1,100 square feet
- Full Views of the Ocean and California Coastline
- Two Adjoining Rooms Connected by Foyer
- Bedrooms featuring Handcrafted California King Beds
- Two Italian Marble Bathrooms featuring Hydrothermal Massage Tubs and Separate Showers
- Living Room with Pull Out Sofa and Work Desk
- LCD Flatscreen TVs and Bluetooth Speaker System
- Nespresso Coffee & Espresso Machine

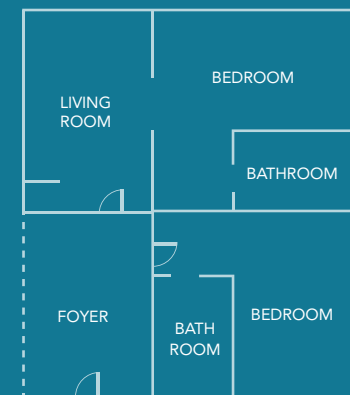

1,100 SQUARE FEET (not to scale)



etc
HOTELS

LEGEND
Preferred
HOTELS & RESORTS



CASA DEL MAR
HOTEL BY THE SEA

ACCOMMODATIONS

THREE BEDROOM OCEAN VIEW SUITES

- 1,700 square feet
- 180 degree views of the Ocean and California Coastline
- Two Living Rooms with Fireplaces, Pull Out Sofas and Work Desks
- Three Adjoining Rooms Connected by Foyer
- Bedrooms featuring Handcrafted California King Beds
- Three Italian Marble Bathrooms featuring Hydrothermal Massage Tubs and Separate Showers
- LCD Flatscreen TVs and Bluetooth Speaker System
- Nespresso Coffee & Espresso Machine



1,700 SQUARE FEET (not to scale)



etc
HOTELS

LEGEND
Preferred
HOTELS & RESORTS

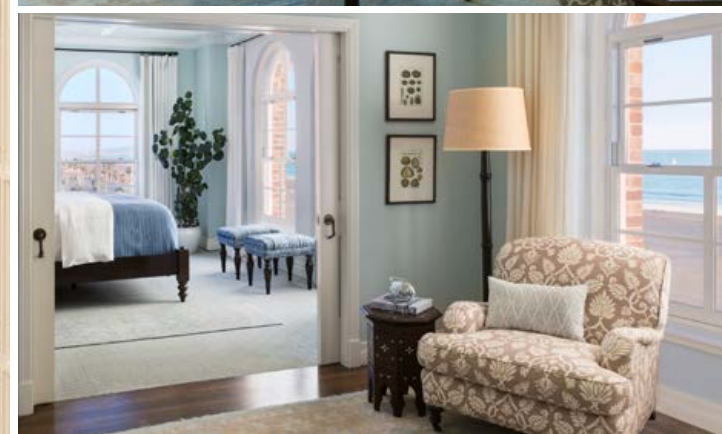

FOUR BEDROOM

OCEAN VIEW SUITES

- 1,900 square feet
- Views of the Ocean and California Coastline
- Four Adjoining Rooms Connected by Foyer
- Bedrooms featuring Handcrafted California King Beds
- Four Italian Marble Bathrooms featuring Hydrothermal Massage Tubs and Separate Showers
- Two Outdoor Patios
- LCD Flatscreen TVs and Bluetooth Speaker System
- Nespresso Coffee & Espresso Machine

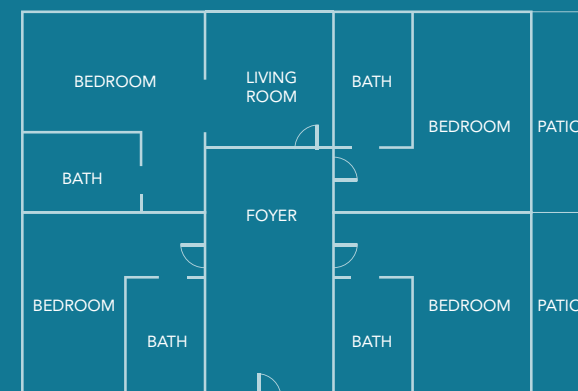

1,900 SQUARE FEET (not to scale)



etc
HOTELS

LEGEND
Preferred
HOTELS & RESORTS

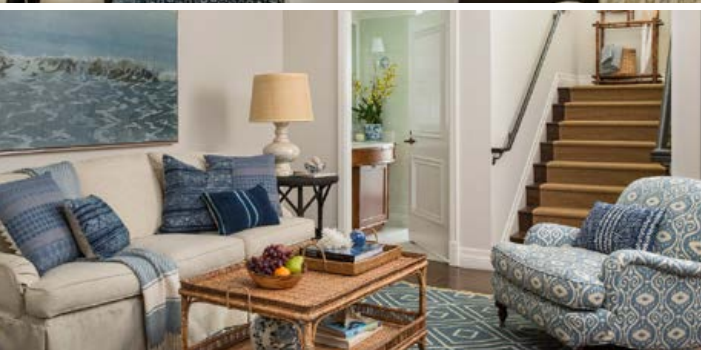

ACCOMMODATIONS

PENTHOUSE 801

ONE BEDROOM PENTHOUSE SUITE

- 1,700 square feet
- Full Views of the Ocean, California Coastline, City and Mountains
- Located on the Top Floor of the Hotel
- Two Levels
- Bedroom features Handcrafted California King Bed
- Two Italian Marble Bathrooms. Hydrothermal Massage Tub and Separate Shower in Master Bath
- Downstairs Sitting Room with Pull Out Sofa
- Wet Bar with Wine Fridge
- Upstairs Living Room with Pull Out Sofa and Work Desk
- Separate Dining Area
- LCD Flatscreen TVs and Bluetooth Speaker System
- Nespresso Coffee & Espresso Machine

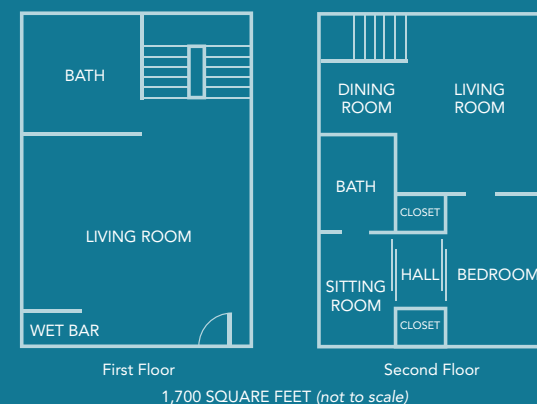

etc
HOTELS

LEGEND
Preferred
HOTELS & RESORTS

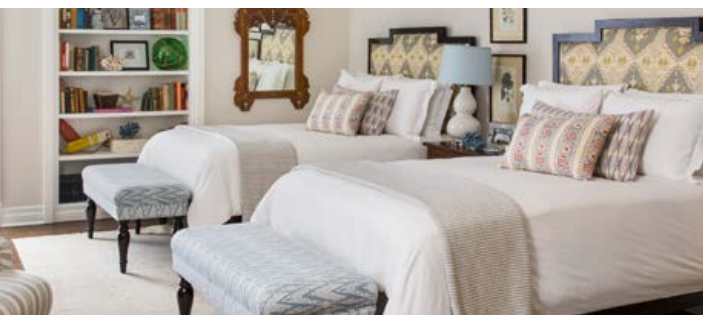

ACCOMMODATIONS

PENTHOUSE 802 TWO BEDROOM PENTHOUSE SUITE

- 1,600 square feet
- Full Views of the Ocean, California Coastline, City and Mountains
- Located on the Top Floor of the Hotel
- Two Levels
- Resting Nook with Skylight
- Master Bedroom features Handcrafted California King Bed
- Second Bedroom features Two Double Beds
- Two Italian Marble Bathrooms. Hydrothermal Massage Tub and Separate Shower in Master Bath
- Wet Bar with Wine Fridge
- Upstairs Living Room and Dining Area with Pull Out Sofa and Fireplace
- Connects to One Bedroom Penthouse Suite to make a Three Bedroom Suite
- LCD Flatscreen TVs and Bluetooth Speaker System
- Nespresso Coffee & Espresso Machine

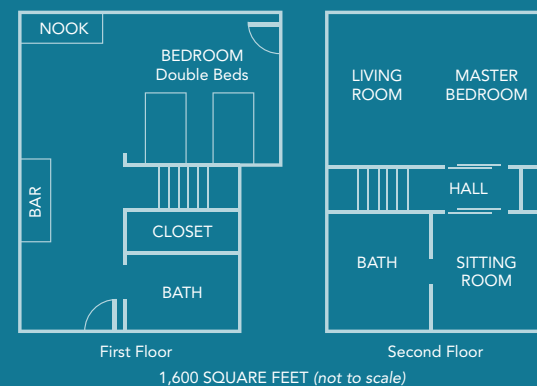

etc
HOTELS

LEGEND
Preferred
HOTELS & RESORTS



PENTHOUSE 803

ONE BEDROOM PENTHOUSE SUITE

- 1,700 square feet
- Full Views of the Ocean, California Coastline, City and Mountains
- Located on the Top Floor of the Hotel
- Two Levels
- Resting Nook with Skylight
- One Bedroom features Handcrafted California King Bed
- Two Italian Marble Bathrooms. Hydrothermal Massage Tub and Separate Shower in Master Bath
- Downstairs Dining Room and Living Room with Pull Out Sofa
- Wet Bar with Wine Fridge
- Upstairs Living Room and Dining Area with Pull Out Sofa and Fireplace
- Connects to Two Bedroom Penthouse Suite
- LCD Flatscreen TVs and Bluetooth Speaker System
- Nespresso Coffee & Espresso Machine

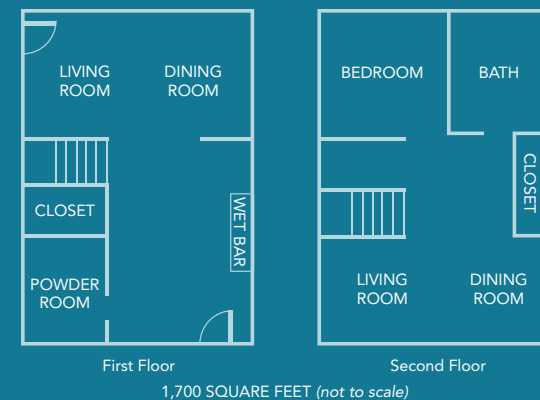

CASA DEL MAR
HOTEL BY THE SEA

ACCOMMODATIONS



etc
HOTELS

LEGEND
Preferred
HOTELS & RESORTS



ACCOMMODATIONS

PACIFIC VIEW SUITE

- 1,900 square feet
- Full Views of the Ocean, California Coastline and Santa Monica Pier
- Two Fireplaces
- Two Master Bedrooms featuring Handcrafted California King Beds
- 2½ Italian Marble Bathrooms featuring Hydrothermal Massage Tub and Separate Showers in Master Baths
- Living Room and Dining Room with Fireplace, Pull Out Sofa, Dining Table and Work Desk
- LCD Flatscreen TVs and Bluetooth Speaker System
- Nespresso Coffee & Espresso Machine



1,900 SQUARE FEET (not to scale)



etc
HOTELS

LEGEND
Preferred
HOTELS & RESORTS

EVENT SPACES

Our variety of indoor and outdoor event spaces are perfect for your meeting, wedding or social occasion... just steps from the sand.



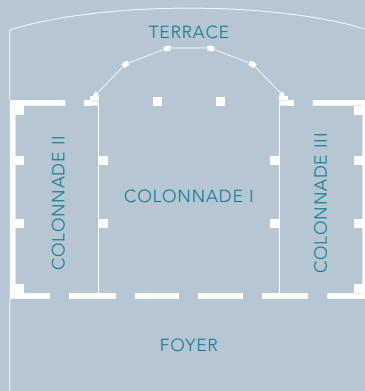

EVENT SPACES

COLONNADE BALLROOM

The only ballroom in Los Angeles located right on the beach, Colonnade is a breathtaking backdrop for Cocktail Receptions, Dinners, Wedding Ceremonies and Meetings

- Ballroom divides into three sections, featuring natural light and 13' ceilings
- Two foyers offering ample pre-function space
- Private outdoor terrace for receptions
- Music amplification not permitted outdoors

ROOM	DIMENSIONS	SQ FT	CEILING	CLASSROOM	CONFERENCE	SQUARE	U-SHAPE	ROUNDS	THEATER	RECEPTION
Colonnade Ballroom	73.5' x 57.3'	4207	13	225	90	60	60	360	400	450
Colonnade I	50' x 62.5'	3125	13	150	50	60	60	200	310	330
Colonnade II	16' x 62.5'	1000	8	40	30	16	16	50	60	100
Colonnade III	16' x 62.5'	1000	8	40	30	16	16	50	60	100



etc
HOTELS

LEGEND
Preferred
HOTELS & RESORTS

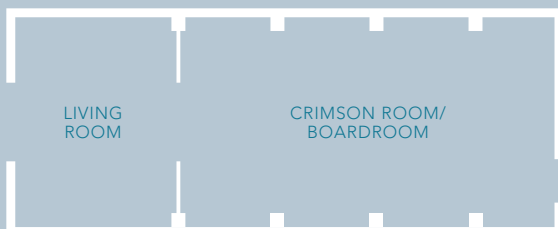

EVENT SPACES

CRIMSON ROOM & BOARDROOM

Our smaller breakout rooms feature modern décor and adjacent "living rooms" that are perfect for pre-function space or meal displays

- Boardroom features a fixed boardroom table and boardroom-style chairs for 18 people
- An additional foyer adjoins the two spaces
- Rooms can be used together or separately

ROOM	DIMENSIONS	SQ. FT.	CEILING	CLASSROOM	CONFERENCE	SQUARE	U-SHAPE	ROUNDS	THEATER	RECEPTION
Crimson Room	17.6' x 33.3'	581	8	36	30	25	20	50	60	50
Crimson Living Room	20.5' x 16'	328	8	-	-	-	-	-	-	30



etc
HOTELS

LEGEND
Preferred
HOTELS & RESORTS

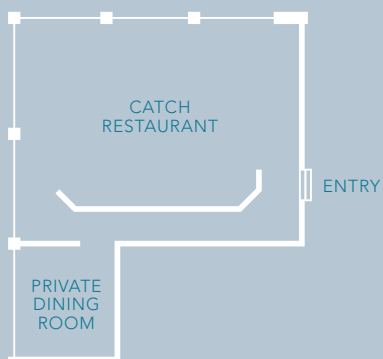

EVENT SPACES

CATCH & PRIVATE DINING ROOM

Catch restaurant can be used during the day for banquet meal space. Featuring 14' ceilings and an abundance of natural light, it is a beautiful setting for group breakfasts, lunches or hospitality space. The adjoining private dining room, also offering natural light, can seat up to 16 people for meetings or meals.

- Restaurant capacity – 85 with existing seating
- Limited amplification permitted
- Private dining room capacity – 16 with existing seating
- Audio-visual equipment is permitted in the private dining space



etc
HOTELS

LEGEND
Preferred
HOTELS & RESORTS

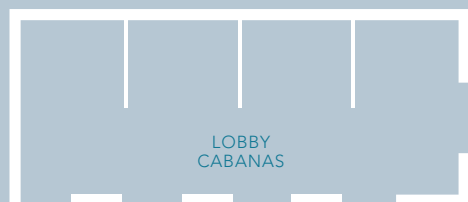

LOBBY
CABANAS

TO LOBBY



EVENT SPACES

LOBBY CABANAS

Our four indoor lobby cabanas are perfect for hospitality space, cocktail receptions or as a post-event lounge. Each cabana can seat up to 10 guests, with a maximum capacity of 50 for a standing reception. The cabanas offer the vivacious energy of the hotel lobby and entertainment, while being exclusively removed in semi-private space.

- Private bar and bartenders available
- Bottle service offered



etc
HOTELS

LEGEND
Preferred
HOTELS & RESORTS

DINING

Offering breathtaking views of the ocean, our restaurants feature California-fresh cuisine in a relaxed, Mediterranean-inspired setting.





DINING

CATCH

Catch restaurant serves fresh, local seafood, sushi, farmer's market vegetables and a wine list recognized by Wine Spectator's Award of Excellence.

- Open for dinner nightly
- Seats up to 85 guests
- Available to groups for daytime dining space or dinner buy-outs
- Catch private dining room seats up to 16 guests

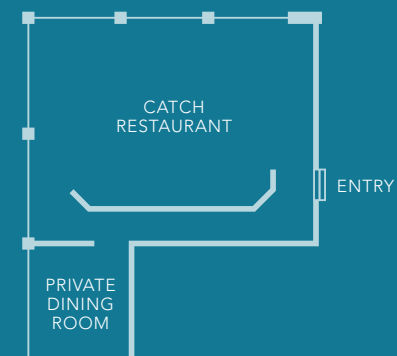

etc
HOTELS

LEGEND
Preferred
HOTELS & RESORTS



DINING

TERRAZZA

Terrazza lounge features Mediterranean cuisine driven by fresh, seasonal products and local ingredients

- Open for breakfast and lunch daily
- Small bites lounge menu offered in the evenings
- Weekend brunch
- Seats up to 130 guests

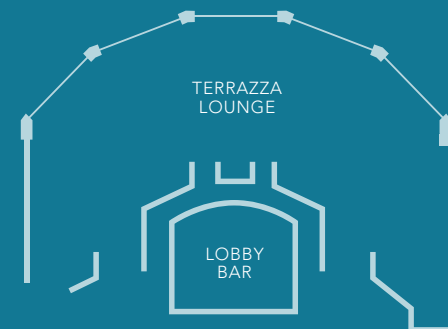

etc
HOTELS

LEGEND
Preferred
HOTELS & RESORTS

SPA & FITNESS

Our spa and fitness center will help you make wellness a part of your life while you are in Santa Monica.





SPA & FITNESS

SEA WELLNESS SPA

Eco-friendly Sea Wellness Spa features six multi-purpose treatment rooms and offers luxury skincare, body care and HydraFacial systems. Natural woods and stone combined with subtle tones of sand and sea evoke the healing powers of the Pacific.

- Featuring custom treatments by Kerstin Florian, emerginC, Intraceuticals and Scientific Organics skincare and body care
- Features relaxation lounge and steam shower



etc
HOTELS

LEGEND
Preferred
HOTELS & RESORTS



SPA & FITNESS

FITNESS CENTER

Featuring cardio equipment, resistance machines and free weights, our comprehensive fitness center has everything you need to maintain your workout routine.

- Open 24 hours



etc
HOTELS

LEGEND
Preferred
HOTELS & RESORTS

POOL & THE BEACH





POOL & THE BEACH

THE POOL

Our boutique pool and heated whirlpool feature full poolside service

- Open seasonally from 6:00 a.m. to 10:00 p.m.
- Offering views of the beach and the Santa Monica Pier
- Palm Terrace patio may be reserved for events.



etc
HOTELS

LEGEND
Preferred
HOTELS & RESORTS



POOL & THE BEACH

BEACH CONCIERGE

Located next door in front of our sister property, Shutters on the Beach, our friendly beach concierge is here to assist you with your every need. They can arrange for beach chairs and umbrellas, bicycle rentals, surf lessons or boogie boards. Offering a beachside refreshment menu, they will serve you right on the sand.



etc
HOTELS

LEGEND
Preferred
HOTELS & RESORTS



Photo credit: Bob Gail Events



Photo credit: Christine Bentley Photographers



POOL & THE BEACH

EVENTS ON THE BEACH

Wedding ceremonies and meetings are permitted on the beach in front of the hotel, on a first come, first serve basis. Your planner can assist in arranging all the details for your breathtaking beach event.



etc
HOTELS

LEGEND
Preferred
HOTELS & RESORTS

AUDIO VISUAL

PSAV offers the latest audiovisual equipment and innovative event technology services, such as developing customized mobile express apps for smart phones, global video conferencing, and extended bandwidth for your meeting or event.



MEDIA

We continue to make headlines.



etc
HOTELS

LEGEND
Preferred
HOTELS & RESORTS



**TRAVEL+
LEISURE**

goop



**COASTAL
LIVING**

BRIDES



the knot



etc
 HOTELS

LEGEND
Preferred
 HOTELS & RESORTS