

CLASSYC LEGS

FOR GRYD

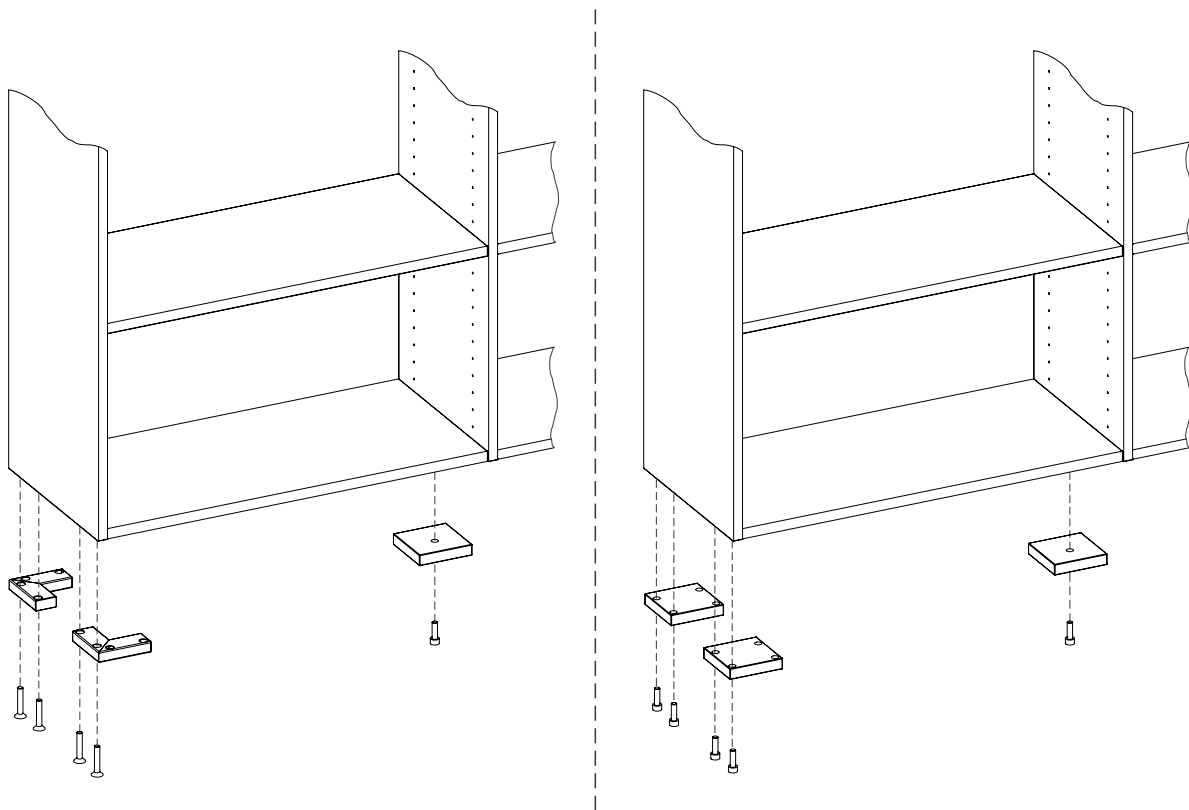

You will build something similar to this.

Here are the parts you will need.

P20

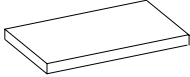

Square felt pad
902.100.19

P27

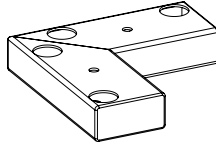

CLASSYC Leg (Metal)
101.169.xx

P28

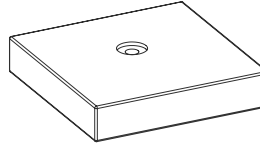

CLASSYC Support Leg
101.170.00

P33

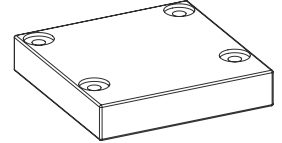

CLASSYC Leg
101.168.xx/101.479.xx

P29

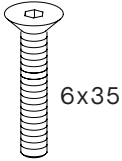

Screw 6 x 35mm
902.100.34

P30

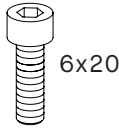

Screw 6 x 20mm
902.100.25

P31



Hex Key Size 4
902.300.01

P32



Hex Key Size 6
902.300.02

P34

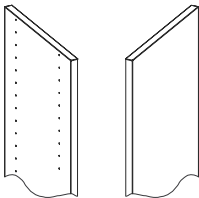

Outer Sidewalls
101.100-105.xx, 101.400-406.xx

P35

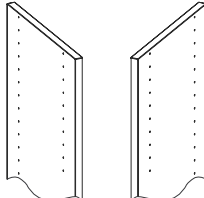

Inner Sidewalls
101.106-111.xx, 101.407-413.xx

