

MONIER

KENYIR 230L
3-IN-1 RWHS



Part of **BMI**

Kenyir 230L 3-in-1 RWHS Filter FFD-Tank, Harvesting the Promise of a Green Future

The compact and efficient system is designed to filter, divert the first flush of contaminated water and collect clean rainwater in an integrated HDPE tank. Debris, leaves and dirt rinses to the sides and continue to flow in the rainwater downpipe to the drain without restriction during storms.

Suitable for connection to roof areas of up to 100m² and for fitting to 110mm diameter (4") downpipes, it has a large flow-through bore to prevent blockages. The Filter, First Flush and Tank components are designed and matched as a set and is available in a few standard colour options.

Features:

- Integrated High efficiency filter collector (above 90%)
- Integrated true 8-litre First Flush Diverter
- Fully UV and weather-resistant PP and HDPE materials
- Simple installation - hung on wall or placed on the floor
- Steel installation brackets for wall mounting are provided
- Simple connection - rainwater inlet & clean water outlet
- Built-in Overflow function and DN25 (1") socket outlet
- Removeable Filter Screen and easy First Flush cleaning
- First Flush automatic drain to downpipe

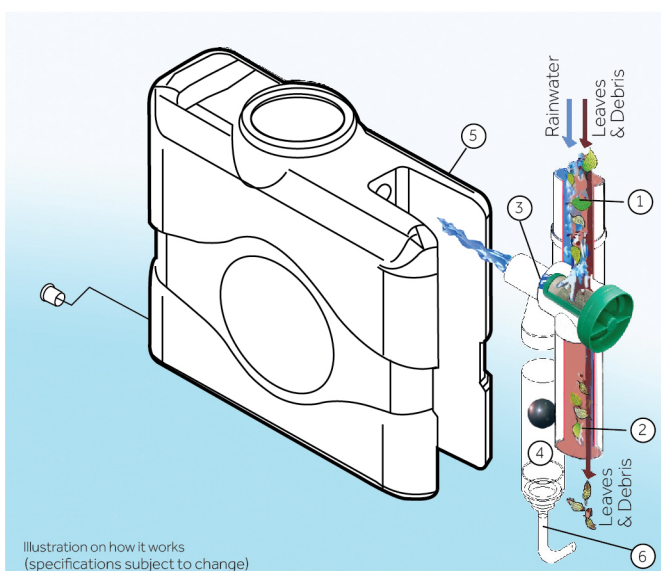

1. Rainwater & debris from the downpipe is channelled into the filter.
2. Leaves & debris get rinsed to the sides and continue down below the filter screen to the drain.
3. Water after passing through the Filter Screen is led to the First Flush container.
4. Contaminated water fills the First Flush container and lifts the ball float which closes the port.
5. Clean water then continue to flow into the tank.
6. First Flush container will drain dry automatically after the rain.

3-in-1 Rainwater Harvesting Filter / First Flush / Tank, the smart all-in-one solution for residential houses.

PRODUCT & TECHNICAL DATA

System Capacity	230 Litres
Filter Body Material	Polypropylene (UV resistant PP)
Filter Screen Material	Stainless steel SS304
Mesh Size	# 30 mesh - 0.6mm
Connection (Downpipe)	110mm downpipe / 56mm outlet
Connection (Tank)	56mm (2" rubber gasket) to tank
First Flush Capacity	8 Litres
First Flush Autorain	3mm
Tank Material	UV resistant HDPE
Tank Outlet	DN25mm (1" threaded socket)
Clean Water Capacity	1.0 Litres / s
Flow Through Capacity	9.0 Litres / s**
Total Dry Weight	30kg

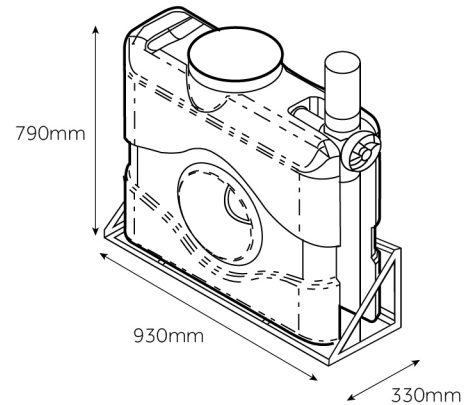

**based on peak rainfall intensity of 300mm/hr and connected roof area of 100m²

In view of innovation, the specifications are subject to change without any prior notice and in the event of such changes, Monier shall ensure that the new specifications are equivalent if not better.

COMPONENTS & INSTALLATION DIAGRAM

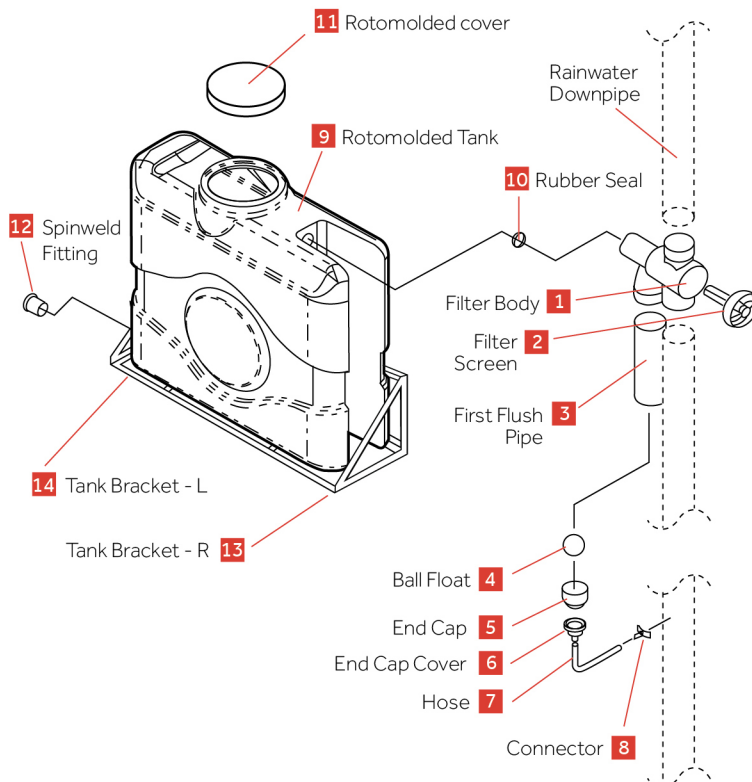

ITEM NAME	DESCRIPTION
01) Filter Body	PP Filter Housing (White)
02) Filter Screen	PP Filter Screen (Green)
2a) Filter Mesh*	Stainless Steel Mesh (0.6mm)
2b) O-Ring*	NBR O-Ring Ø 90mm x Ø 2.0mm
03) First Flush Pipe	PVC Pipe Ø 110 x 500mm (White)
04) Ball Float	PE Ball Ø 75mm
05) End Cap	PP End Cap (White)
06) End Cap Cover	PP End Cap Cover (White)
6a) O-Ring*	NBR O-Ring Ø 70mm x 2.0mm
07) Hose	Hose Ø 10 x Ø 6 (ID) x 300mm (L)
08) Connector	Drain Hose Connector (White)
09) Rotomolded Tank	HDPE Tank - 930 x 330 x 790 (H) mm Overall Size
10) Rubber Seal	Tank Inlet Rubber Seal (2" / DN 50)
11) Rotomolded Cover	HDPE Tank Cover (Ø 300mm)
12) Spinweld Fitting	HDPE Spin Weld Outlet - 25mm(1")
13) Tank Bracket - R	MS Wall Bracket Right Side
14) Tank Bracket - L	MS Wall Bracket Left Side

*Specifications subject to change

MONIER



Awarded Corporate Excellence Award at the prestigious Asia Pacific Enterprise Awards (APEA) 2024



The Best Brands in Roof Systems by The BrandLaureate Awards for 6 Consecutive Years 2008, 2009, 2010, 2011, 2012 and 2015



Scan QR Code for BMI Malaysia



Recognized for our CSR efforts, Monier was honoured with an Asia Responsible Entrepreneur Award 2011



Member of the Malaysia Green Building Confederation



Scan QR Code for Showroom & Sales office location

BMI ROOFING SYSTEMS SDN. BHD.

Registration No.197401002179 (19163-M)
(Formerly known as Monier Malaysia Sdn. Bhd.)
Suite 11.02, 11th Floor, Menara JKG,
No. 282, Jalan Raja Laut,
50350 Kuala Lumpur, Malaysia
T (+60) (3) 21760600
Toll Free: 1800 88 0865
roofing-malaysia@bmigroup.com

bmigroup.com/my



ABOUT BMI GROUP

BMI Group was born out of a recognition that customers now expect a single point of expertise to help them find their ideal roof. Bringing together some of the industries most trusted brands to become the largest supplier of both flat and pitched roofing and waterproofing solutions throughout Europe, BMI Group has over 173 years of experience and innovation to offer its clients.

As a **Standard Industries** company, BMI Group, headquartered in London, has the support, reach and resources of a global enterprise. With over 120 production facilities across Europe, Africa and Asia, and more than 9,500 employees worldwide, the business is well positioned to provide an unparalleled level of service to homeowners, specifiers, contractors, property owners and developers.

Find out more at www.bmigroup.com