

# MS POLARLYS

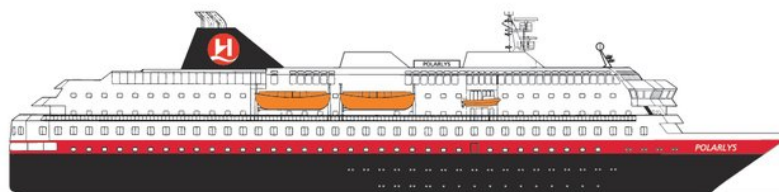

DECK7  
DECK6  
DECK5  
DECK4  
DECK3  
DECK2  
DECK1

MS Polarlys was built in 1996, and she is the third Hurtigruten ship to have this name. Polarlys is the Norwegian word for polar light, a name given to the special Arctic phenomenon we chase in our winter programme "Hunting the Light". MS Polarlys is a stylish ship, furnished with mahogany panelling, polished brass, and a choice selection of Norwegian contemporary art. Together with the extensive use of wood in the public areas, this has created a unique maritime atmosphere.



DECK7

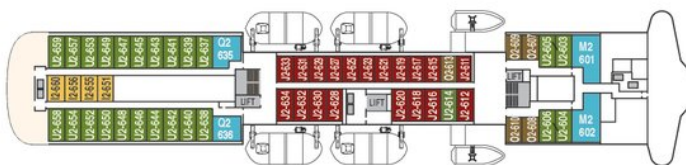

DECK6

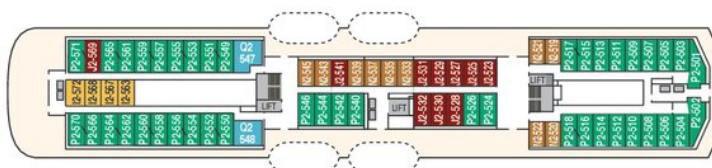

DECK5

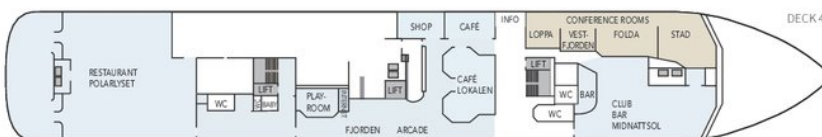

DECK4

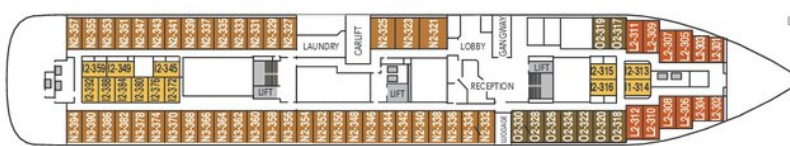

DECK3

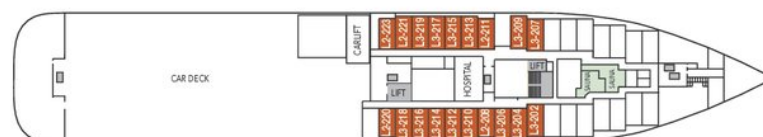

DECK2

SHIP YARD: ULSTEIN MEK. VERK., (N)  
 FLAG: NORWAY  
 YEAR OF CONSTRUCTION: 1996  
 GROSS TONNAGE: 11 341  
 PASSENGERS: 619  
 BEDS: 471  
 OVERALL LENGTH: 123 M  
 BEAM: 19,5 M  
 CAR CAPACITY: 35  
 SERVICE SPEED: 15 KNOTS

EXPEDITION SUITES	
M	Suite
Q	Mini suite
ARCTIC SUPERIOR	
U	Outside cabin
P	Outside cabin
POLAR OUTSIDE	
O	Outside cabin
N	Outside cabin
L	Outside cabin
J	Outside cabin
POLAR INSIDE	
I	Inside cabin

Cabins 321, 323 and 325 adapted for guests with disabilities. Category J and some L grade cabins have limited or no view. Subject to change. Please see our website for 360° impressions of the ship facilities and cabins.