

MS KONG HARALD



DECK 7
DECK 6
DECK 5
DECK 4
DECK 3
DECK 2
DECK 1

Although this ship is named after today's King of Norway, Harald, you will find other famous Norwegians on board as well: The bar is named after Nobel Peace Laureate, the Norwegian polar pioneer Fridtjof Nansen and the café is named after explorer Roald Amundsen. As with MS Richard With, MS Kong Harald was launched in 1993 to mark Hurtigruten's centenary. In the ship's interior you will see decorative details of the King's Crown emblem.



DECK 7

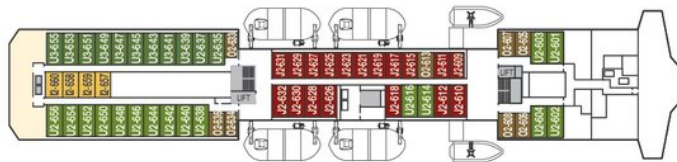

DECK 6

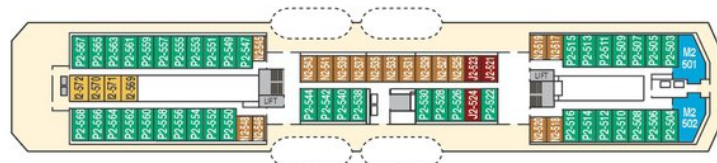

DECK 5

SHIP YARD: VOLKSWERFT (D)
FLAG: NORWAY
YEAR OF CONSTRUCTION: 1993
GROSS TONNAGE: 11 204
PASSENGERS: 622
BEDS: 469
OVERALL LENGTH: 121,8 M
BEAM: 19,2 M
CAR CAPACITY: 12
SERVICE SPEED: 15 KNOTS

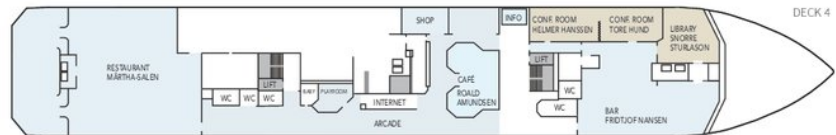

DECK 4

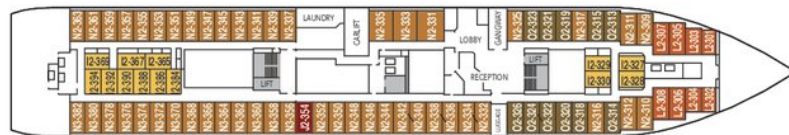

DECK 3

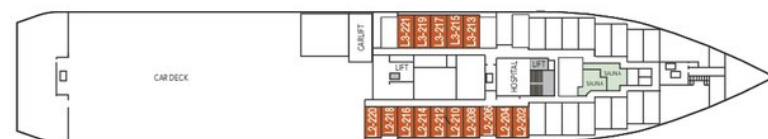

DECK 2

EXPEDITION SUITES	
M	Suite
ARCTIC SUPERIOR	
U	Outside cabin
P	Outside cabin
POLAR OUTSIDE	
O	Outside cabin
N	Outside cabin
L	Outside cabin
J	Outside cabin
POLAR INSIDE	
I	Inside cabin

Cabins 331, 333 and 335 adapted for guests with disabilities. Category J and some L grade cabins have limited or no view. Subject to change. Please see our website for 360° impressions of the ship facilities and cabins