

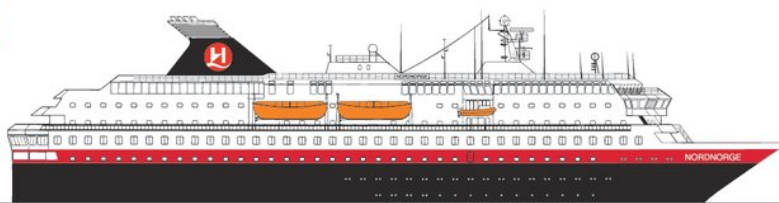

MS NORDNORGE



DECK7
DECK6
DECK5
DECK4
DECK3
DECK2
DECK1

Nord-Norge means the northern part of Norway, mostly situated inside the Arctic Circle. MS Nordnorge was built in Norway in 1997 and is the fourth Hurtigruten ship to have this name. Between 2002-2007 MS Nordnorge gave her guests memorable experiences in Antarctica. On board MS Nordnorge guests can admire the work of artists such as Johanne Marie Hansen-Krone, Ellen Lenvik and Dagfinn Bakke. The interior décor very much reflects an Art Nouveau and Art Deco influence.

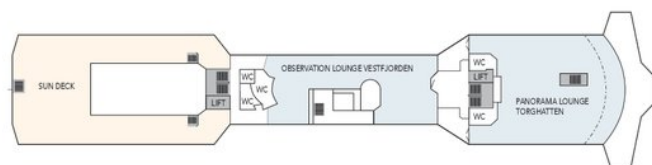

DECK 7

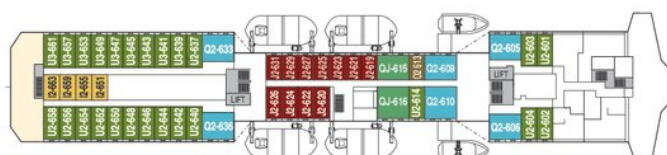

DECK 6



DECKS

SHIP YARD: KVÆRNER KLEVEN, (N)
FLAG: NORWAY
YEAR OF CONSTRUCTION: 1997
GROSS TONNAGE: 11 384
PASSENGERS: 623
BEDS: 451
OVERALL LENGTH: 123,3 M
BEAM: 19,5 M
CAR CAPACITY: 35
SERVICE SPEED: 15 KNOTS

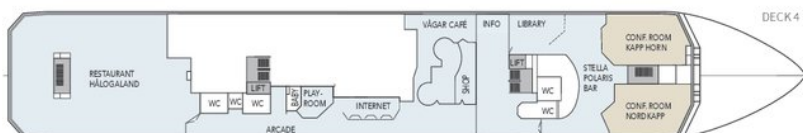

DECK 4

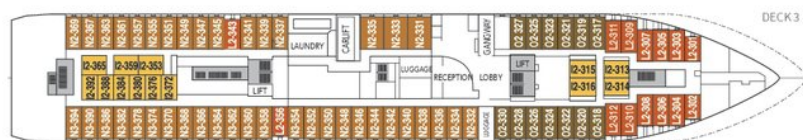

DECK 3



DECK 2

EXPEDITION SUITES	
M	Suite
Q	Mini suite
ARCTIC SUPERIOR	
QJ	Outside cabin
U	Outside cabin
P	Outside cabin
POLAR OUTSIDE	
O	Outside cabin
N	Outside cabin
L	Outside cabin
J	Outside cabin
POLAR INSIDE	
I	Inside cabin

Cabins 331, 333 and 335 adapted for guests with disabilities. Category J and QJ and some L grade cabins have limited or no view. Subject to change. Please see our website for 360° impressions of the ship facilities and cabins.