

PART 4 MOUNTAIN BIKE

version on 01.01.2023

TABLE OF CONTENTS

Chapter I	GENERAL RULES	3
§ 1	Race types	3
§ 2	Age categories and participation	3
§ 3	Calendar	5
§ 4	Technical delegate	6
§ 5	Marshals	7
§ 6	Event procedure	7
§ 7	Equipment	9
§ 8	Installations	10
§ 9	Course	10
Chapter II	CROSS-COUNTRY EVENTS	11
§ 1	Race characteristics	11
§ 2	Course	14
§ 3	Course marking	15
§ 4	Start and finish zones	17
§ 5	Feed/Technical Assistance zone	18
§ 6	Technical assistance	20
§ 7	Safety	20
§ 8	Event procedure	21
§ 9	Stage races	22
Chapter III	DOWNHILL EVENTS	24
§ 1	Organisation of competition	24
§ 2	Course	24
§ 3	Clothing and protective accessories	25
§ 4	Marshals	27
§ 5	First aid (minimum requirements)	28
§ 6	Training	28
§ 7	Transport	28
Chapter IV	FOUR CROSS EVENTS	29
§ 1	Nature	29
§ 2	Organisation of competition	29
§ 3	Course	31
§ 4	Transport	32
§ 5	Clothing and protective accessories	32
§ 6	First aid (minimum requirements)	32
§ 7	Training - competition	33
§ 8	Card procedure	33
Chapter V	ENDURO EVENTS	34
§ 1	Race characteristics	34
§ 2	Technical assistance	34
Chapter VI	PUMP TRACK	37
§ 1	Definition and nature	37
§ 2	Categories	37
§ 3	Equipment	37
§ 4	Course	38
§ 5	Competition Format	38
Chapter VII	SNOW BIKE	44

§ 1 General.....	44
Chapter VIII E-MOUNTAIN BIKE.....	45
§ 1 General.....	45
Chapter IX UCI MOUNTAIN BIKE WORLD SERIES.....	46
§ 1 General.....	46
Chapter X UCI CROSS-COUNTRY WORLD CUP	47
Chapter XI UCI DOWNHILL WORLD CUP.....	54
Chapter XII UCI MARATHON WORLD CUP	63
Chapter XIII UCI ENDURO WORLD CUP	65
Chapter XIV UCI E-MTB CROSS-COUNTRY WORLD CUP	66
Chapter XV UCI ELIMINATOR WORLD CUP	67
Chapter XVI UCI MOUNTAIN BIKE RANKING	68
Chapter XVII MASTERS WORLD CHAMPIONSHIPS.....	71
Chapter XVIII UCI ELITE MTB TEAMS	72
§ 1 Identity	72
§ 2 Legal and financial status.....	75
§ 3 Registration.....	75
§ 4 Contract of Employment.....	76
§ 5 Dissolution of a team.....	76
§ 6 Penalties	77
§ 7 Model contract between a rider and a UCI ELITE MTB TEAM	77
Chapter XIX UCI MTB TEAMS	78
§ 1 Identity	78
§ 2 Legal and financial status.....	79
§ 4 Contract of employment	80
§ 5 Dissolution of a team.....	80
§ 6 Penalties	80
§ 7 Model contract between a rider and a UCI MTB TEAM	80
Chapter XX MTB RACE INCIDENTS TABLE.....	82
ANNEX 1 - Model contract between a rider and a UCI MTB TEAM.....	88
ANNEX 2 - UCI MTB XCO points.....	91
ANNEX 2a - UCI MTB XCC points	93
ANNEX 2b - UCI MTB XCM points	94
ANNEX 3 - UCI MTB DHI points	95
ANNEX 4- UCI MTB 4X points	97
ANNEX 5 – XCE SCHEDULE (32 riders, 4 per heat).....	98

PART 4 MOUNTAIN BIKE

Chapter I GENERAL RULES

§ 1 Race types

4.1.001 The mountain bike discipline includes the following events comprising the formats listed below:

- A. Cross-country: XC (Chapter II cross-country events)
 Cross-country Olympic: XCO
 Cross-country marathon: XCM
 Cross-country point-to-point: XCP (point to point)
 Cross-country short track: XCC (Short Track)
 Cross-country eliminator: XCE
 Cross-country time trial: XCT (Time Trial)
 Cross-country team relay: XCR (Team Relay)
 Cross-country stage race: XCS (Stage races)
- B. Downhill: DH (downhill) (Chapter III downhill events)
 Downhill individual: DH1
 Downhill marathon: DHM
- C. Four cross: 4X (Chapter IV four cross events)
- D. Enduro: **EDR / EDR-E** (Chapter V enduro events)
- E. Pump track: PUM (Chapter VI pump track events)
- F. Snow Bike: SNO (Chapter VII snow bike events)
- G. E-Mountain Bike: E-MTB (Chapter VIII E-mountain bike events)
(text modified on 1.10.13; 1.01.16; 1.01.19; 1.01.20; 1.01.23)

§ 2 Age categories and participation

4.1.002 Participation in races is organised on the basis of the age categories set out in articles 1.1.034 to 1.1.037.

4.1.003 Women under 23
 [article abrogated on 1.01.18]

4.1.004 Cross-country Olympic – XCO
 Except in the UCI world championships, continental championships and, at the discretion of national federations, national championships, under 23 men and women can ride the events for elite men and women respectively, even if a separate event is being run for under 23 riders.

Separate under 23 XCO world cup events are organised for men and women. The first 5 men under 23 and the first 5 women under 23 of the last UCI XCO individual ranking of the preceding year can decide whether they want to race the entire world

cup season as elite or under 23. All other under 23 riders must race the world cup season in the under 23 category.

Separate under 23 XCO hors class and class 1 events may be organized for men and women, in this case separate results must be submitted for both categories. If the under 23 events are organised on a different day from the elite events, under 23 riders may take part in both events. During class 2 and class 3 XCO events under 23, men and women, will compete with the elite categories. As such no separate results must be submitted for the under 23 categories at class 2 and class 3 XCO events.
(text modified on 1.10.13; 1.01.22)

4.1.005 Cross-country marathon – XCM

Cross-country marathon events are open to all riders aged 19 or over and include masters categories. No separate results must be submitted for under 23 or masters categories.

Cross-country short track – XCC

Cross-country short circuit events are open to all riders aged 19 or over.

At the UCI World Championships (as from 2024) and UCI World Cup, separate under 23 events are organized for men and women.

For other events no separate results must be submitted for the under 23 or elite categories.

Cross-country eliminator - XCE

Cross-country eliminator events are open to all riders aged 17 or over. No separate results must be submitted for the juniors, under 23 or elite categories.
(text modified on 1.01.17; 1.01.20, 1.01.21; 1.01.23)

4.1.006 Downhill – DH

Except for the world championships, downhill events are open to all riders aged 17 or over.

At the world championships and at the world cup, separate junior events are organized for men and women (aged 17 and 18).

For all other downhill events on the international calendar, the UCI points are awarded in relation to the riders' time and not to their category. To ensure that this rule is correctly applied, only one combined result needs to be sent to the UCI.

Comment: When a junior downhill rider would score the best time at the national championships, (s)he must wear the elite jersey. The junior jersey is not awarded in this case.
(text modified on 1.07.12; 1.10.13; 4.04.14; 1.01.17)

4.1.007 Four cross – 4X

4X events are open to all riders aged 17 or over. No separate results must be submitted for the juniors, under 23 or elite categories.

4.1.007 Enduro - EDR

bis Enduro events are open to all riders aged 17 or over. No separate results must be submitted for the juniors, under 23 or elite categories.
(article introduced on 1.10.13; 1.01.23)

Stage races - XCS

- 4.1.008** Stage races are open to all riders aged 19 or over. No separate results must be submitted for the under 23 categories.

Masters

- 4.1.009** All riders aged 35 or over who hold a masters licence are allowed to ride mountain bike events on the UCI international masters calendar, apart from:
1. riders who, during the current season starting January 1st, have scored 1 or more UCI points during the same calendar year as a UCI masters event;
 2. riders who during the current year have been a member of a team registered with the UCI.
- (text modified on 1.01.18; 1.01.20, 1.01.21)*

- 4.1.010** In cross-country marathon events **and** enduro events, master riders may ride with a temporary or day licence issued by the competent national federation.

The licence sets out clearly the start and end dates of the period for which it is valid. The national federation ensures that a holder of a temporary or day licence benefits for the duration of that licence from the same insurance coverage and other advantages as those granted with an annual licence.

To compete at the masters world championships, master riders must hold an annual masters licence.

(text modified on 1.10.13; 1.01.23)

§ 3 Calendar

- 4.1.011** International mountain bike races are registered on the **UCI** international calendar in accordance with the following classification:

- Olympic Games (OG)
 - No other international mountain bike event of cross-country (XC) may be organised during the mountain bike competition of the Olympic Games.
- UCI World Championships (CM)
 - No other international mountain bike event of the same format may be organised during the UCI World Championships.
- UCI World Cup (CDM)
 - No hors class or class 1 event of the same format may be organised on the same continent on the same day as a UCI World Cup event.
 - The continental championships (CC) **and national championships (CN)** in a format may not be organised during a world cup event in the same format.
- UCI Masters World Championships (CMM)
- Continental championships (CC)
 - No hors class or class 1 event of the same format may be organised on the same continent **on the same day** as a continental championships.
- Stage races
 - Class: Hors class (SHC) / Class 1 (S1) / Class 2 (S2)
 - No stage race hors class may be organised during the mountain bike competition of the Olympic Games, or the UCI World Championships cross-country (XC) or marathon, UCI World Cup events in the concerned continent.
 - No stage-race, **in HC or C1**, may be organised during the Continental championships **on the same day(s) as any cross-country (XC) race**, on the concerned continent.
- One-day races

- Class: Hors class (HC) / Class 1 (C1) / Class 2 (C2) / Class 3 (C3)
- UCI XCO junior series:
The UCI will appoint a certain number of UCI XCO junior series events every year.
- National Championships:
 - National championships cannot be run during the mountain bike competition at the Olympic Games, UCI World Championships or UCI World Cup of the same format and cannot be run during continental championships of the same format on the concerned continent.
 - Cross-country Olympic (XCO) or cross-country short track (XCC) national championships cannot be run during an international mountain bike race. For all other formats, in the event a national championship is incorporated in an international mountain bike race, a rider can only receive points once. The riders with the sporting nationality of the national federation will receive the national championships points according to their rank in the race (i.e. including all riders regardless of their sporting nationality) and other riders will receive the class event points according to their rank in the race.

The events status for stage races and one-day races are allocated to each event annually by the UCI on the basis of the commissaires race report from the preceding year and any other information at disposal of the UCI. A new event may only be given class 2 or 3 status in its first year.

HC status can only be given with the following cumulative conditions: event registered for at least three years as C1 on the UCI International Calendar, a separate under 23 race registered for both genders, at least eight riders from the top 50 of the UCI ranking for both genders, at least ten nations represented in the last edition of the event.

A detailed technical guide for HC events, stage races and new events—must be presented to UCI during the calendar registration process. A template for such technical guide is provided by UCI upon request. All events registered on the UCI international calendar must respect the UCI financial obligations (in particular calendar fee, prize money) approved by the UCI and published on the UCI website.

Race entry fees for events on the international calendar are waived for any rider belonging to a UCI ELITE MTB TEAM. This applies only to the format in which the team has elite status and does not apply to stage races, eliminator and enduro events.

(text modified on 1.02.12; 1.10.13; 4.04.14; 1.01.16; 1.01.17; 1.01.19, 1.01.21; 1.01.22; 1.01.23).

§ 4 Technical delegate

- 4.1.012 For the Olympic Games, world championships, world cup events and continental championships a technical delegate is appointed by the UCI.
- 4.1.013 Without prejudice to the responsibility of the organiser, the technical delegate supervises the preparation of the technical aspects of the event and serves as a link with UCI headquarters in this respect.
- 4.1.014 If an event is promoted at a new venue, the technical delegate must carry out an inspection in advance (course, distance, location of feed/technical assistance zones, installations, safety, event race schedule, etc.). He meets the organiser and prepares an inspection report without delay for submission to the UCI mountain bike coordinator.
- 4.1.015 The technical delegate must be on site at least one day prior to the first official training session and must carry out an inspection of the venue and course in conjunction with the organiser and the president of the commissaires' panel. He coordinates the

technical preparations for the event and ensures that the recommendations made in the inspection report are implemented. The definitive version of the course and any changes are the responsibility of the technical delegate. In cases where a technical delegate does not have to be appointed under article 4.1.012, this task falls to the president of the commissaires' panel.

4.1.016 The technical delegate must attend the team managers' meetings.

§ 5 Marshals

4.1.017 All organisers must employ a marshal coordinator, who must speak one of the two official languages of the UCI. The president of the commissaires' panel and, where applicable, the UCI technical delegate meet the marshal coordinator before the event in order to optimise the procedure for giving instructions to the marshals (emergency plans, equipment, whistles, flags, radios, etc.)

The race organiser must provide enough marshals to ensure the safety of the riders and spectators during competition and official training sessions.

All organisers must establish a detailed marshal map for their event. For events where a technical delegate is appointed by UCI, article 4.1.012, a marshal map must be submitted to UCI for approbation prior to the event. For events where no technical delegate is appointed a marshal map must be submitted for prior approbation to the appointed UCI president of the commissaires' panel.

4.1.018 The minimum age for marshals is the age of legal majority of the country where the competition takes place.

4.1.019 The marshals must be readily identifiable by a badge or distinctive uniform.

4.1.020 Marshals must all be equipped with a whistle and those located at strategic points (to be defined by the organiser) must be equipped with a radio. They must be positioned so as to provide a radio link covering the whole course.

4.1.021 Marshals must be properly briefed on their role and issued with course maps which provide simple reference points for locating accidents.

§ 6 Event procedure

Safety

4.1.022 The course must only be ridden by the riders during the events and official training periods. During official training periods marshals and medical covering will be present. All other persons must be kept clear of the course.
(text modified on 1.02.12).

Cancellation

4.1.023 In the event of bad weather the president of the commissaires' panel may decide to cancel the event after consulting the organiser and, where appointed, the UCI technical delegate.

Before the start

4.1.024 The course of each event must be clearly defined before the start, and displayed at registration. Access to the course is under UCI control from the time that the UCI technical delegate or, where applicable, the president of the commissaires' panel appointed for the event arrives (course inspection).

Before they arrive, access to the course must be subject to the laws in force and local rules governing the event venue. The organiser may not refuse access to the course for any other reason.

4.1.025 Before the official training periods start, the UCI technical delegate must check that the course is properly and safely marked. A report of this check is made to the president of the commissaires' panel and the organiser. In the absence of the UCI technical delegate the course check and report is made by the president of the commissaires' panel.

4.1.026 At the Olympic Games, world championships, continental championships, hors class events and all stage races team managers or their representative must attend the team managers meeting(s) **in case such a meeting is indicated on the official program of the event.**
(text modified on 1.01.23).

4.1.027 The checking and control of licences and the signing on take place in an office at the event. Official training is only permitted after licences have been checked, other registration formalities completed and handlebar numbers distributed.

4.1.028 The definitive list of starters must be drawn up before the start of the race. As well as the riders' names, it must also accurately list their UCI team, UCI ID, category, the race type and the start time.

4.1.029 The organiser of the event must provide at least six (6) radio sets to the commissaires' panel, one (1) for the UCI technical delegate if applicable and one (1) for the UCI secretary, to allow the commissaires to communicate properly. These radio sets must have one channel reserved for the sole use of the commissaires' panel and another with which it is possible for the commissaires to contact the director of the organisation. For 4X events the organiser must provide headsets for the radios.

4.1.030 The start
For Olympic Games, world championships, world cup, continental championship events and hors class events the organiser must make provision for a call-up area which is sufficiently large for riders to warm up in, close to the start zone. Other organisers are also encouraged to install a call-up area.

4.1.031 In mass start events, riders must be called to the start no earlier than 20 minutes before the scheduled start of the race. This period can be reduced where the number of riders allows.

The riders line up in the order in which they are to be called to the start line. The number of riders on each line is decided by the president of the commissaires' panel and supervised by a commissaire. The rider himself decides which position on the line to take.

Once the riders are lined up, warm-up (by rollers, turbo trainer, etc.) is excluded inside or outside the start area.

The start is given by the commissaire using the following procedure: warnings 3, 2, 1 minutes and 30 seconds before the start, then a final announcement that the start is given within the next 15 seconds.

A starting pistol or start lights, if none is available, a whistle, is used to give the start.

(text modified on 1.01.20; 1.01.23).

4.1.032 [article abrogated on 1.01.20]

4.1.033 The start briefing is given in at least one of the official languages of the UCI.

Conduct of riders

4.1.034 A rider must act in a sporting manner at all times and must permit any faster rider to overtake without obstructing.

4.1.035 If a rider exits the course for any reason, he/she must return to the course between the same two course markers where he/she exited.

In case a rider fails to return to the course as provided for in this article, the commissaires' panel can disqualify the rider.
(text modified on 1.01.16; 1.01.19).

4.1.036 The riders must respect nature and must make sure that they do not pollute the course venue.

4.1.037 Anyone who is found to have altered the course has his/her accreditation removed or, in case of a rider, is disqualified (DSQ).

§ 7 Equipment

4.1.038 The use of radio links or other remote means of communication with riders is forbidden **except at UCI World Cups and subject to UCI authorisation.**
(text modified on 1.01.23).

4.1.039 The use of tyres fitted with metal spikes or screws is not permitted, except for Snow Bike and should not exceed 5mm (excluding rubber).
(text modified on 1.01.19).

4.1.040 During MTB races no traditional road handlebars may be used. Clips-on extensions or inner bar ends are forbidden but traditional bar ends are authorized.
(article introduced on 1.02.12; text modified on 1.01.16; 1.01.22).

4.1.041 During MTB races no **riders registered for the event** are permitted to use an E-Mountain Bike on the course at any time during training and competition. **E-Mountain Bikes are allowed at the** E-Mountain Bike competitions as specified in Chapter VIII.
(article introduced on 1.01.18, text modified on 1.01.19; 1.01.20; 1.01.23).

4.1.042 Cameras are not permitted during final for cross-country and during qualifying rounds and final for downhill/four cross/cross-country eliminator. The riders are responsible for securing the fixation of the cameras in order to avoid any danger. The UCI can decide to allow a camera during final but only for the usage of the TV production company
Comment:

1. *see also, in particular, articles 1.3.001-1.3.003 and 1.3.031 Part 1 of the UCI Regulations*
2. *cameras may be used during training sessions in DHI (article 4.3.021) under the conditions laid down in this article.*

(article introduced on 1.01.18; 1.01.19)

- 4.1.043** When an electronic device is provided to riders for their identification or their geolocation by the timing service provider, the riders shall be under the obligation to wear it in addition to the identification numbers listed at article 1.3.073.

The electronic device provided by the timing service provider shall be identical for all riders participating in the same event. It shall be considered as an identification number similar to the materials listed at article 1.3.073. Articles 1.3.076, 1.3.077, 1.3.080 and points 2.6, 3 and 15 of the table of race incidents in Chapter XX remain applicable. *(article introduced on 1.01.18; text modified on 1.01.23).*

- 4.1.044** For Mountain Bike downhill and enduro events, as opposed to the general rule defined in article 1.3.007, the two wheels can be of a different diameter.

For Mountain Bike downhill, the bicycle may be driven either by a chain or a belt of one-piece construction.
(article introduced on 1.01.19; text modified on 1.01.23).

§ 8 Installations

- 4.1.045** Inflatable arches crossing the course are prohibited, unless held up by a solid structure. *(text modified on 1.01.16).*

- 4.1.046** The organiser must provide a bike washing area.

§ 9 Course

- 4.1.047** As far as possible, the course for cross-country, four cross and downhill events must be totally separate from that of all other events organised on the same site. If this is not the case, the training and race timetable must be drawn up so that the courses cannot be used simultaneously.

- 4.1.048** There must not be any obstacles which might cause a crash or a collision in the start and finish zones.

Chapter II CROSS-COUNTRY EVENTS

§ 1 Race characteristics

Cross-country Olympic – XCO

4.2.001 The duration and lap length of cross-country Olympic event in the different race classifications in the table below must lie within the following ranges or as close as possible to the race length (in hours and minutes).

	UCI World championships, UCI World cup, Continental championships, Hors class Class 1 events		Class 2 events		Class 3 events	
	Race time	Lap length	Race time	Lap length	Race time	Lap length
Men juniors	1:00 - 1:15	3.5km - 6km	1:00 - 1:15	4km - 10km	1:00 - 1:15	No restriction, and any race format
Women juniors	1:00 - 1:15		1:00 - 1:15		1:00 - 1:15	
Men under 23	1:15 - 1:30		N/A*		N/A*	
Women under 23	1:15 - 1:30		N/A*		N/A*	
Men elite	1:20 - 1:40		1:30 - 2:00		No restriction	
Women elite	1:20 - 1:40		1:30 - 2:00			

*under 23 compete with elite

(text modified on 1.10.13; 4.04.14; 1.01.17; 1.01.23)

4.2.002 The course for a cross-country Olympic event should use an attractive lay-out to encourage easy viewing for spectators and any television coverage.

Double feed/technical assistance zones are strongly recommended.

(text modified on 1.10.13; 1.01.17; 1.01.23)

4.2.003 Riders must start in a single group.

Cross-country marathon – XCM

4.2.004 The cross-country marathon format races must respect the minimum distance of 60km and maximum 160km.

Any organiser wishing to use distances outside those stated must obtain preliminary permission from UCI.

The course must be marked every ten kilometres by a sign indicating the distance remaining to be raced.

The race can be run over a single lap, or multi-lap with a maximum number of laps of three (3).

In the event of a single lap the course may not include any section to be covered twice. Only the start and finish lines may be located at the same place.
(text modified on 1.02.12; 1.10.13; 4.04.14; 1.01.21; 1.01.23).

- 4.2.005** Riders must start in a single group, divided into categories (women and men) with a sufficient gap between the two starts so neither event will interfere with the other.
(text modified on 1.02.12; 4.04.14, 1.01.21).

Cross-country point-to-point - XCP

- 4.2.006** The course for a cross-country point to point event must start in one place and finish elsewhere.

XCP format is only used during stage races (XCS).
(text modified on 1.02.12; 1.10.13; 1.01.16, 1.01.21).

- 4.2.007** Riders must start in a single group.

Cross-country short track – XCC (Short Track)

- 4.2.008** The start and finish must be in the same area. The distance of the course must not be more than 2 km with a race duration of 20 to 30 minutes.

Apart from XCC world championships, XCC continental championships and XCC national championships, all XCC events will be considered as Class 3 events on the international calendar.

The XCC national champions must wear their XCC national champion jersey, and the XCC world champions their XCC world champions jersey.
(text modified on 1.02.12; 1.07.12; 1.10.13; 1.01.16; 1.01.17; 1.01.20, 1.01.21; 1.01.22)

- 4.2.009** Natural and/or artificial obstacles are only permitted if their use has been preliminary approved by the UCI technical delegate or in his absence, the president of the commissaires' panel.

Cross-country eliminator – XCE
Course

- 4.2.010** The course for a cross-country eliminator race must be between 500m and 1000m and include natural and/or artificial obstacles, in conformity with article 4.2.009. The whole course must be 100% rideable, single track sections normally are avoided and where possible the course normally has not more than one 180° turn. The start and finish area must be separated in order to allow short race program.
Obstacles such as trees, stairs (up/down), drops, bridges or wooden constructions can create a dynamic short race.

The course must be marked according to articles 4.2.020 to 4.2.029. The start/finish zones must be respected as per articles 4.2.030 to 4.2.034

Apart from XCE world championships and XCE world cup, all other XCE events will be considered as Class 3 events.
(text modified on 1.10.13; 4.04.14; 1.01.16; 1.01.21; 1.01.22).

Organisation of competition
Qualifying round

- 4.2.011** At least 6 riders must be entered for the qualifying round, otherwise no XCE event may be held.

The complete program, qualifying round and main event shall be organized on the same day. Upon reasoned request, the UCI may allow the race program to be split over 2 different days (one day for the qualifying round and one day for the main event).

The qualifying round takes the form of an individual timed run of one lap of the course. The best 32 riders (8x4) go through to the main event.

In case of a tie between riders during the qualifying round, their order is determined by the last UCI XCO individual ranking. If the riders are not ranked in the UCI XCO individual ranking, lots are drawn to determine their order.

Race numbers for the qualifying round are in sequence starting from 33 on the basis of the most recent **UCI XCE World Cup standing and UCI XCO individual ranking** and in the following order:

1. **riders ranked in the top 32 men and the top 16 women of the most recent UCI World Cup standing (for the first event, as per the final UCI World Cup standing of the previous year)**
2. **standings of the previous year**
3. classified elite and under 23 riders with ascending rank
4. classified juniors with ascending rank
5. unclassified elite and under 23 riders random
6. unclassified juniors random

The riders start in sequence by their race number, the highest number starting first. The women ride before the men.

(text modified on 1.02.12; 1.07.12; 1.01.21; 1.01.22; 1.01.23)

Main event

4.2.012

The race numbers for the main event are allocated on the basis of the results of the qualifying round, starting with the number 1 for the winner of the qualifying round.

The main event comprises elimination heats in which the groups of riders are matched as shown in the tables in Annexes 5 - XCE competition formats.

Heat order:

- men first until women come to equal heat system;
- finals: women small final followed by;
- men small final followed by women big final and followed by men big final.

Intentional contact by pushing, pulling or other means which causes another competitor to slow down, fall or exit the course is not allowed and results in disqualification for breach of UCI rules (DSQ) of the originator.

At the sole discretion of the commissaires' panel, a rider can be announced relegated (REL) and will be given a heat position different to that of his actual finish.

Riders who are DNF, DSQ or DNS in the semi-finals may not enter the small final.

The final classification of the competition is drawn up in groups in the following order:

1. all riders competing in the big final, except for riders DSQ.
2. all riders competing in the small final, except for riders DSQ.
3. riders DNF or DNS in the semi-finals.
4. the classification of the other riders is determined by the round reached, then by the classification in their heat, then by their race number.

Within each of the above-mentioned groups, riders DNF are classified before DNS. In case of multiple DNF or DNS, the tiebreaker is the race number.

Riders DNF or DNS in the first round of the main event are listed without classification.

Riders DSQ in the main event are listed without classification.

All riders ranked after a rider DSQ are re-ranked one place higher within the affected phase only. No rider eliminated in an earlier phase can move up in the final classification. For example, in case of a DSQ in the big final, all riders ranked after the DSQ rider will be ranked one place higher and the rank four in the final classification will remain unallocated.

Riders not qualified for the main event are not listed in the final classification.
(text modified on 1.02.12; 1.01.19; 1.01.22)

Specific rules

- 4.2.013** A start grid must be drawn on the ground. The riders must be lined up next to each other on one line. The riders in each heat may choose their starting position in order of their race number. The rider with the lowest race number gets first choice.

The XCE national champions must wear their XCE national jersey, and the XCE world champions their XCE world champions jersey.
(text modified on 1.02.12; 1.07.12; 1.10.13).

Cross-country time trial - XCT

- 4.2.014** XCT events are only used during stage races (XCS).
(text modified on 1.10.13; 4.04.14)

Cross-country team relay - XCR

- 4.2.015** Cross-country team relay must be organised at the world championships and may be organised at continental championships as described in articles 9.2.032 and 9.2.033.

Only during world championships and continental championships UCI points are allocated. A minimum of 5 nations must compete in the XCR for UCI points to be awarded. The UCI points are allocated to the nation and not to the riders individually.
(text modified on 1.10.13)

§ 2 Course

- 4.2.016** The course for a cross-country race normally includes a variety of terrain such as road sections, forest tracks, fields, and natural or gravel paths, and include significant amounts of climbing and descending. Paved or tarred/asphalt roads cannot exceed 15% of the total course.
(text modified on 1.01.21)

- 4.2.017** The course must be wholly rideable even in difficult weather conditions. Parallel sections must be provided on sections of the course likely to deteriorate easily.

- 4.2.018** Extended single-track sections must have periodic passing sections.

- 4.2.019** On the course for a cross-country event at world championships, continental championships, world cup and hors class events, provision must be made for at least 6 crossing points for spectators. The crossings must be marshalled on each side.

§ 3 Course marking

4.2.020 The complete course must be marked and indicated according to the following system.

4.2.021 Direction arrows (black arrows on white or yellow panels) indicate the route to be followed showing changes of course, intersections, and all potentially dangerous situations. The minimum dimensions of direction arrows must be 40 cm by 20 cm and they must not be sited more than 1.5m above ground level.

4.2.022 The arrows must be on the right-hand side of the course except for right turns in which case arrows before and at the turn must be on the left-hand side of the course.

4.2.023 An arrow is located 10 m before each junction, at the junction and 10 m after the junction to confirm that the correct route has been followed.

A clearly visible "X" sign is used to mark wrong directions.

4.2.024 In a potentially dangerous situation, one or more arrows pointing downwards are placed 10 m to 20 m before the obstacle or potential danger, and also where the obstacle or potential danger is.

Two arrows pointing downwards are used for a more dangerous situation.

A serious hazard requiring great caution must be marked with three arrows pointing downwards

4.2.025 Copies of the following signs must be used:

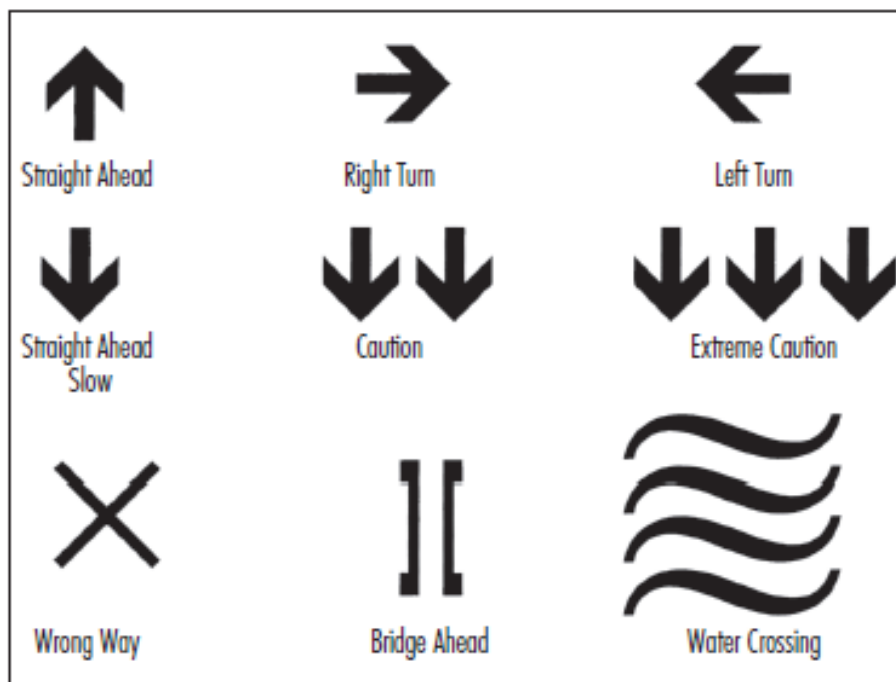

4.2.026 The sections of a cross-country course that involve steep or potentially dangerous slopes must be marked and protected with safe and visible course markers that present no safety risks to riders.

In very fast sections of the course where the riders' line is close to the course boundary, B lines must be installed as per diagram:

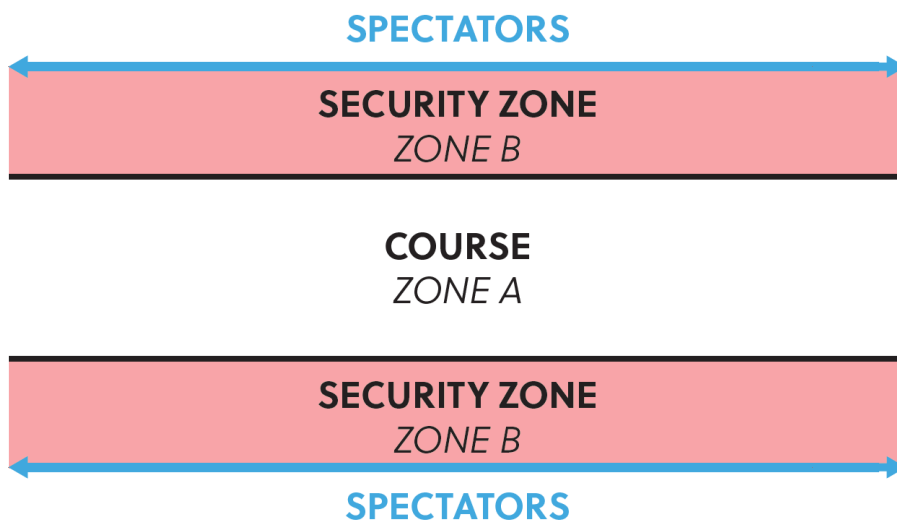

(text modified on 1.01.17; 1.01.23)

- 4.2.027** Where course sections involve obstacles such as walls, tree stumps or tree trunks or suitable padding must be used to protect the riders. Such protective measures must not restrict the rideability of the course.

In appropriate areas, such as along the edge of steep drops, catch nets which comply with safety standards must be used. Nets or mesh fencing with openings greater than 5 cm x 5 cm may not be used, unless covered.

Any wooden bridges or ramps must be covered with non-slip surface (carpet, chicken wire or special anti-slip paint).
(text modified on 1.01.16; 1.01.23).

- 4.2.028** For Olympic format races at the Olympic Games, world championships, continental championships, world cup and hors class events, the course must be marked out and protected for its entire length.

For all marathon format races, the course must be marked out well enough to ensure that it can be followed without problems.
(text modified on 1.10.13; 1.01.23)

- 4.2.029** Wherever possible, roots, tree stumps, protruding rocks, etc. should be highlighted in biodegradable fluorescent paint.
(text modified on 1.01.16).

§ 4 Start and finish zones

4.2.030 The start and/or finish banners must be placed immediately above the start and finish lines at least 2.5 metres above ground level.

(text modified on 1.01.23)

4.2.031 The start zone for a cross-country event (massed start events) must:

a) for world championships and world cup events:

- be at least 8 metres wide for at least 50 metres before the start line;
- be at least 8 metres wide for at least 100 metres after the start line;

b) for all other events:

- be at least 6 metres wide for at least 50 metres before the start line;
- be at least 6 metres wide for at least 100 metres after the start line;

For all events the start must be on a flat or uphill section of the course.

The first narrowing after the start must allow riders to pass through together easily.

(text modified on 1.10.13)

4.2.032 The finish zone for a cross-country event (massed start event) must:

- be at least 4 metres wide for at least 50 metres before the finish line; for world championships and world cup events this zone is at least 8 metres wide for at least 80 metres.
- be at least 4 metres wide for at least 20 metres after the finish line; for world championships and world cup events this zone is at least 8 metres wide for at least 50 metres.
- be on a flat or uphill section of the course.

4.2.033 Barriers must be in place on both sides of the course for a minimum of 100 metres before and 50 metres after the start and finish line(s).

4.2.034 The final kilometre of the race must be clearly and precisely indicated.

§ 5 Feed/Technical Assistance zone

DIAGRAM 1 : FEED/TECHNICAL ASSISTANCE ZONE ONE SIDE

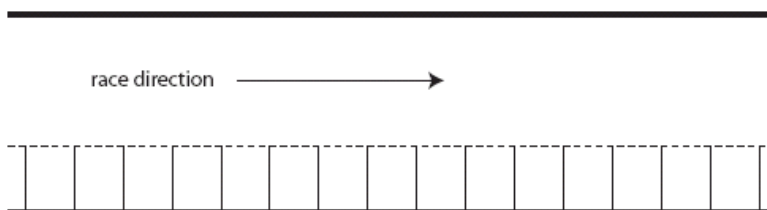

DIAGRAM 2 : FEED/TECHNICAL ASSISTANCE ZONE OPPOSITE SIDES

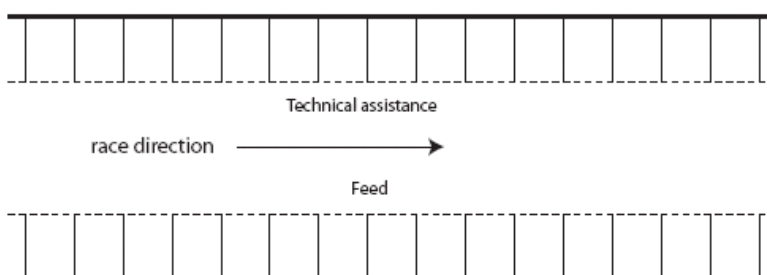
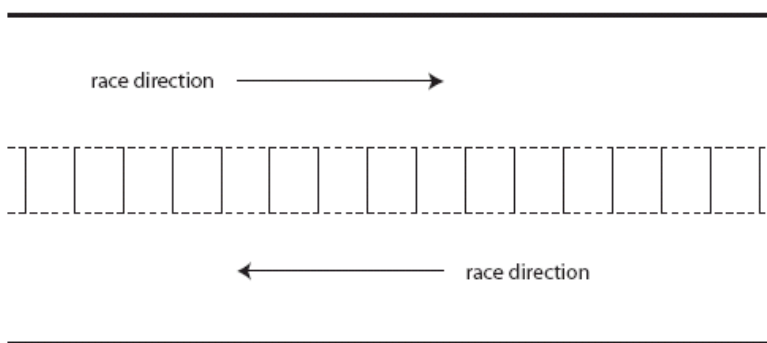

DIAGRAM 3 : DOUBLE FEED/TECHNICAL ASSISTANCE ZONE



4.2.035 Feeding is permitted only in the zones designated for that purpose, which are also used as technical assistance zones. The zone is called feed/technical assistance zone.

4.2.036 Each feed/technical assistance zone must be located on flat or uphill sections which are slow and wide enough for the purpose. The zones must be long enough and reasonably evenly spaced around the course. Double feed/technical assistance zones are recommended.

For Olympic format cross-country events (XCO) **at least 1 single feed/technical assistance zone shall** be set up. For marathon format cross-country events (XCM) at least 3 feed/technical assistance zones **shall be** set up. Organisers must anticipate on the team staff access possibilities during cross-country marathon events.

For the cross-country team relay event during the world championships and, if applicable, during the continental championships, a feed/technical assistance zone can be set up for technical support only, at the discretion of the president of the commissaires' panel. For the sake of clarity, feeding from the feed/technical zone is not permitted for the cross-country team relay events.

(text modified on 1.01.17; 1.01.23)

4.2.037 The UCI technical delegate or, in his absence, the president of the commissaires' panel, in collaboration with the organiser, decides on the distribution and location of feed/technical assistance zones.

4.2.038 The feed/technical assistance zones must be wide and long enough to allow the passing of riders not stopping in the zone.

For world cup events they must furthermore include the following four areas:

- one part for **UCI ELITE MTB TEAMS**;
- one part for **UCI MTB TEAMS**;
- one area for national teams;
- another area for individual riders or members of teams not registered with the UCI (who are treated as individual riders).

Staff working for riders must wear readily identifiable team clothing.

(text modified on 1.01.20; 1.01.23).

4.2.039 The feed/technical assistance zones must be clearly identified and numbered. They must be in an enclosure completely separated from spectators. Access must be strictly controlled by commissaires and/or marshals.

4.2.040 For the Olympic Games, world championships, world cup events and continental championships nobody may enter a feed/technical assistance zone without accreditation. This rule does not apply for the marathon world championships.

For the Olympic Games, world championships and continental championships, accreditations are issued by the commissaires' panel at the end of the team managers' meeting.

For world cup events season long accreditations issued to the **UCI ELITE MTB TEAMS** and **UCI MTB TEAMS**. For the national federations or individual riders passes are prepared by the organiser and handed out at registration: they obtain 1 accreditation per registered rider per zone. Note that for a double feed/technical assistance zone they only obtain 1 accreditation per registered rider.

(text modified on 1.01.20; 1.01.23).

4.2.041 Physical contact between feeders/mechanics and riders is permitted only in feed/technical assistance zones.

Water bottles and food must be passed up to the rider by hand by the feeder or the mechanic. The feeder or mechanic is not permitted to run alongside his rider.

4.2.042 The spraying of water on riders or bicycles by the feeders or mechanics is forbidden.

4.2.043 Eyewear may only be changed in the feed/technical assistance zones. An area where glasses may be exchanged may be set up at the end of the zone.

- 4.2.044** No rider may turn back on the course to reach a feed/technical assistance zone. Any rider doing so is disqualified. Only within the feed/technical assistance zone itself, a rider may turn back without obstructing other competitors.
(text modified on 1.02.12).

§ 6 Technical assistance

- 4.2.045** Technical assistance during a race is permitted subject to the conditions below.
- 4.2.046** Authorised technical assistance during a race consists of repairs to or the replacement of any part of the bicycle other than the frame. Bike changes are not permitted and the rider must cross the finish line with the same handlebar number plate that he had at the start.
- 4.2.047** Technical assistance can only be given in the feed/technical assistance zones.
- 4.2.048** Spare equipment and tools for repairs must be kept in these zones. Repairs and equipment changes can be carried out by the rider himself or with the help of a team-mate, team mechanic or neutral technical assistance.
(text modified on 1.01.16).
- 4.2.049** In addition to technical assistance in feed zones, technical assistance is permitted outside these zones only between riders who are members of the same **UCI ELITE MTB TEAM**, **UCI MTB TEAM** or of the same national team. For the world championships, technical assistance is permitted only between riders of the same national team.
- Riders may carry tools and spare parts provided that these do not involve any danger to the rider himself or the other competitors.
(text modified on 1.01.20; **1.01.23**)

§ 7 Safety

- Marshals
- 4.2.050** Wherever possible each marshal is located in direct line of sight of the next. They signal the arrival of riders with a short, loud blast on a whistle.
- 4.2.051** All marshals working on potentially hazardous sections of the course must carry a yellow flag which is waved in the event of a crash in order to warn other riders.
- First aid (minimum requirements)
- 4.2.052** At least one ambulance and one basic first aid post are required at all races.
- For each event, at least one (1) doctor and at least six (6) people qualified to perform first aid under the laws of the country must be present at the venue.
- 4.2.053** The first aid post must be centrally located and readily identifiable by all participants.
- 4.2.054** The first aid posts and the members of the first aid service must be in radio communication with each other, the organisers, the marshal coordinator and the president of the commissaires' panel.
- 4.2.055** All first aid personnel must be easily identifiable with an appropriate mark or uniform. This must be unique.

4.2.056 First aid personnel must be placed in key locations on the courses that are in use for each day of competition.

There must also be a first aid crew in place for official training days.

4.2.057 The organiser must take the measures required to facilitate the rapid evacuation of injured persons from any point of the course. All-terrain vehicles (motorcycles, quads, etc.) and experienced drivers must be available to reach difficult areas quickly.

Potential hazard areas must be clearly identified and must be accessible by ambulance (four-wheel drive if necessary).

4.2.058 A briefing with the organising director, the persons in charge of the first aid and marshalling services and the president of the commissaires' panel must be held before the event. The organiser must issue maps of the course to the staff of the first aid service.

4.2.059 The organiser must provide for cross-country marathon events a motorcycle to mark the front of the race ("lead bike"), and a motorcycle to mark the rear of the race ("sweep bike"). For Olympic format events, only a lead bike must be provided and display on its front the number of laps remaining in the race.
(text modified on 1.10.13)

§ 8 Event procedure

Training

4.2.060 The organiser must make the courses available and fully marked for training at least 24 hours before the start of the first race. For world cup XCO events the deadline is at least 48 hours before the start of the first race.

Riders must display their handlebar numbers during training sessions.

Starting grid

4.2.061 The start order is determined as follows:

A. XCO events (other than world championships and world cup events)

- 1 as per the last published UCI XCO individual ranking;
- 2 unclassified riders: by drawing lots.

B. XCM events

- 1 as per the last published UCI XCM individual ranking;
- 2 as per the last published UCI XCO individual ranking;
- 3 unclassified riders: by drawing lots.

(text modified on 1.02.12; 1.01.21)

Classification

4.2.062 Riders who abandon the race are marked on the result sheet as "DNF" (did not finish) and are not awarded any points for this event.

4.2.063 Lapped riders must complete the lap during which they were lapped and leave the event via an exit located before the finishing straight or in the "80%" zone as described in article 4.2.064, if that rule applies. They are listed in the results in the order in which they are pulled out of the race showing the number of laps down.

(text modified on 1.02.12).

- 4.2.064** The decision as to whether the 80% rule is to be applied for Olympic cross-country events (XCO) is made by the president of the commissaires' panel after discussion with the organiser. Any rider whose time being 80% slower of that of the race leader's first lap is pulled out of the race. He is required to leave the race at the end of his lap in the zone provided for the purpose (the "80% zone") except when the rider is on his final lap. For Olympic cross-country events at continental championships, world cups, world championships and the Olympic Games, the 80% rule must be applied.
- 4.2.065** Riders pulled out of the race under article 4.2.064 are listed in the results in the order in which they are pulled out of the race showing the number of laps down.
(text modified on 1.02.12).

§ 9 Stage races

General rules

- 4.2.066** A stage race is a series of cross-country races in which teams, national federation riders and individual riders may take part. Riders must complete each stage according to the specific procedures for the event in order to be eligible for the next stage.
- 4.2.067** Organisers must provide the detailed technical guide of their event to the UCI for approval during the international calendar registration process. In the absence of such approval the event will not be included in the international calendar.
A template for such technical guide is provided by UCI upon request.
(text modified on 1.10.13)
- 4.2.068** A stage race may take place on the territory of several countries provided that the national federations of the countries concerned have approved the organisation and the course. Evidence of such approval must be submitted with the application to have the race included on the calendar.
- 4.2.069** Teams are composed of at least two and a maximum of 6 riders.
- 4.2.070** Stages races are assimilated to XCM, therefore XCM world champions and national XCM champions must wear their champion jersey on the occasion of stage races.
(text modified on 1.02.12, 1.01.21).

Duration and stages

- 4.2.071** Unless decided otherwise by the UCI, Stage races are run over at least four days, with a maximum of nine days.
Only one stage per day may be run.
In addition, the **events must include at least** one long distance stage that meet the minimum distance of a cross-country marathon event as per article 4.2.004.
(text modified on 1.01.23).
- 4.2.072** The different types of cross-country events mentioned in articles 4.2.001 to 4.2.009 and 4.2.014, except cross-country eliminator (XCE) can be chosen for the stages.
- 4.2.073** For each race type (XCO, XCM, XCP, XCC, XCT), distances are as per the technical guide. Regarding team time trial, the team time is that of the second rider and counts towards the team general classification.
(text modified on 4.04.14; 1.01.21)

Classifications

- 4.2.074** The individual men's and women's general classification on time are obligatory. UCI points are awarded for the general classification only. *
- * For stage races which are competed with teams of 2 riders, example Cape Epic, the UCI points are allocated to both riders (not distributed between riders).
- The individual general classification is based on an individual competitor's cumulative time for each stage.
- Where two or more riders make the same time in the general individual time classification, the fractions of a second registered during individual time trials (including the prologue) are added back into the total time to decide the order.
- If the result is still tied or if there are no individual time trial stages the classifications obtained in each stage are added and, as a last resort, the place obtained in the last stage ridden is taken into consideration.
- (text modified on 4.04.14)*
- 4.2.075** Other general classifications for men and women, such as points general classification, mountains general classification, and the men's and women's team general classifications are optional.
- In stage races where there is a team general classification, there are only three types of teams that may compete for the classification:
- UCI ELITE MTB TEAMS
 - UCI MTB TEAMS
 - National teams.
- Except in the case of team time trials, both the men's and women's team general classification is established by adding the times of the two best riders in each stage.
- (text modified on 1.01.23).*
- 4.2.076** Bonuses and time penalties are taken into account. Bonuses are shown only in individual general classifications by time. No bonuses are awarded for individual or team time trial events.
- Technical arrangements
- 4.2.077** A stage event may not include more than one vehicle transfer per three days of event. The duration of each of vehicle transfer may not exceed three hours. A transfer less than one hour is not taken into account.
- 4.2.078** Neutralised linking sections may be included in no more than 75% of the stages. No linking section may exceed 35 km in length. A lead vehicle must control the speed of the field until the start line is reached. The start must take place from a stationary position at the start line. The start must be given within 30 minutes following the arrival of the lead vehicle.
- 4.2.079** There must be two motorcycles (a lead bike and a 'sweep' bike) for all stages except the individual time trial.
- 4.2.080** The organiser must provide clothing for the leader of the individual men's and women's general classification.

Chapter III DOWNHILL EVENTS

§ 1 Organisation of competition

- 4.3.001** A single run format **for the final** must be used. This shall involve either:
- a qualifying run, called the qualifying round following which a predetermined number of riders set by the particular race regulations are admitted to **a semi-final or final**. The fastest rider of the final is declared the winner.
 - a seeding run that determines the start order for a single run in which the rider with the fastest time wins.

Mass start events are composed of a:

- qualifying round (time trial where a number of riders qualify for the final, number of riders to qualify must be set by the organiser in his technical guide), **which** will also serve to determine the start order.
- marathon downhill (mass start downhill)

Each organizer should state in their technical guide which one of the two options will be applied to their event.

(text modified on 1.07.12; 1.10.13; 4.04.14; 1.01.23)

- 4.3.002** A two runs system (with the fastest single time from either run counting to the result) may be acceptable under exceptional circumstances subject to prior authorisation from the UCI.

- 4.3.003** A system based on two runs using the average or combined times of both is not permitted.

- 4.3.003 bis** Any rider whose time being 100% slower of that of the first established time is listed in the results as DNF (did not finish) and is not awarded any points. This rule is applied for qualifying round and finals.

Under exceptional circumstances, the maximum allowed time limit for finishing may be altered during the race. This decision is made by the president of the commissaires' panel after consultation with the technical delegate.

(article introduced on 1.02.12).

§ 2 Course

- 4.3.004** The course for a downhill must follow a descending route.

- 4.3.005** The course comprises varied terrain sections: narrow and broad tracks, woodland roads and paths, field paths and rocky tracks. There normally are a mixture of fast and technical sections. The emphasis of the course is to test the riders' technical skills and their physical ability.

- 4.3.006** The length of the course and the duration of the event are determined as follows:

	Maximum
Course length	3500 m
Duration of the event	5 minutes

	World championships, world cup, continental championships, class 1 events		Class 2 events		Class 3 events
	Minimum	Maximum	Minimum	Maximum	
Duration of the event	2 minutes	5 minutes	1 minute	5 minutes	No restriction

(text modified on 1.01.16)

- 4.3.007** The entire downhill course must be marked and protected with **safe and visible course markers that present no safety risks to riders**.

In very fast and dangerous sections, where the riders line is close to the course boundary, B lines must be installed as per diagram:

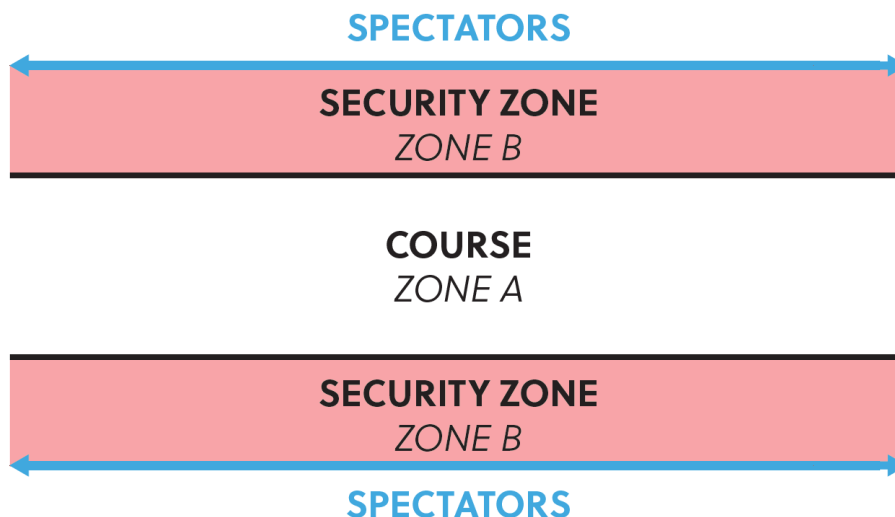

(text modified on 1.01.17; 1.01.19; **1.01.23**)

- 4.3.008** The use of straw bales to mark off the course is not permitted.
- 4.3.009** The start area must be at least 1 meter and no more than 2 meters wide. A suitable handrail must be installed, the floor must be covered with a non-slip surface and the start area must be covered.
- 4.3.010** The finish area must be at least 6 meters wide.
There must be a braking area of minimum 35-50 m after the finish line with adequate protection and completely cordoned off from the public. The riders exit must be designed in that way that the speed is kept to a minimum.

This area must be free of obstacles.

§ 3 Clothing and protective accessories

- 4.3.011** Jersey

The jersey shall be a long-sleeved shirt whose sleeves extend down to the rider's wrists. Jerseys used in downhill events should be of a type specifically designed and sold for use in BMX Racing or Mountain Bike downhill events. Jerseys designed for road cycling, skinsuits, or one-piece suits comprising the jersey and the pants/shorts are not permitted for use in downhill events.

The jersey must be either close fitting around the waist or must be tucked into the pants before the start to not cause interference.

Pants

Long pants or short pants combined with suitable knee and shin protection are authorised. Such long or short pants should be of a type that is specifically designed and sold for use in BMX Racing or Mountain Bike downhill events. Long pants of the type described above must be of one-piece construction and made of tear-resistant material. They should cover the entire length of both legs until just above the shoe or ankle. Short pants of the type described above must be of one-piece construction and made of tear-resistant material. They should be worn together with suitable leg protection, that covers the entire knee and the entire shin until just above the ankle.
(text modified on 1.01.23).

4.3.012 A full-face helmet must be worn properly both when racing and when training on the course. The helmet must be fitted with a peak. Open-face helmets may not be worn.

4.3.013 The UCI strongly recommends that riders wear the following protection:

- back, elbow, knee and shoulder protectors made of rigid materials;
- protection for the nape of the neck and the cervical vertebrae;
- padding on shins and thighs;
- broad full-length trousers made from rip-resistant material incorporating protection for the knees and calves, or broad-cut shorts made from rip-resistant material plus knee and calf protectors with a rigid surface;
- long sleeved shirt;
- full finger gloves.

National federations may impose in their national regulations and under their responsibility the use of other protections than helmets including for international events on their territory. The national federations are responsible for monitoring compliance with such regulations to the exclusion of UCI.

A rider not wearing the protection imposed by the national federation in an international event shall be banned from the race by the commissaires' panel only at the request of a representative of the national federation and under the responsibility of the latter.

Comment:

The riders shall inquire about any applicable national federation regulation. The use of protective gear other than helmets may also be imposed by national legislation. The rider shall inquire about this. Compliance with such legislation is the exclusive responsibility of the rider.

A wide variety of equipment is available on the market that is presented and sold as protective gear.

Some of these are provided by reputable manufacturers that may be expected to produce quality products.

Yet, and except for helmets, there seem to exist no official technical norms for protective gear as referred to in the above article.

Therefore, it is not known at this time to what extent items that are sold as protective gear provide effective protection, as the concept, the quality, etc. have not been tested and compared with an applicable official technical standard.

It is not known either whether gear that provides protection in a certain type of crash might provide or fail to provide the expected protection in another type of crash.

Likewise, the combination of different types of protections may not be adequate. For example, a neck protection may not fit with a back protector.

Therefore, riders must pay attention to the quality and characteristics of the gear, seek advice of experienced riders, coaches or technicians, procure the gear from professional and reliable suppliers and rely on their own judgment.

*The rider shall be responsible for the choice of the gear and for its use, in accordance with articles 1.3.001 to 1.3.003.
(text modified on 1.07.12)*

4.3.014 [article abrogated on 1.01.18]

§ 4 Marshals

4.3.015 Each marshal must be located in direct line of sight of the next. They signal the arrival of riders with a short, loud blast on a whistle.

4.3.016 The marshals must be provided with flags so that the safety system below can be used.

4.3.017 During official training every marshal must carry a yellow flag which must be waved in the event of a crash to warn other riders who must slow down.

4.3.018 Some marshals specifically appointed by the organiser and the marshal coordinator must carry a red flag and have a radio link on the same frequency as those of the president of the commissaires' panel, the organising director, the medical team, the marshal coordinator and, where present, the UCI technical delegate. They must be stationed at strategic points on the course such that they are in direct line of sight with their two closest colleagues earlier and later on the course.

The red flags are used in training and racing.

Red flag marshals who see a serious accident must immediately notify the marshal coordinator by radio, who must as soon as possible notify the president of the commissaires' panel, the organising director, the medical team and, where present, the UCI technical delegate.

Red flag holders must immediately assess the situation of the crashed rider and continue reporting by radio to the marshal coordinator.

Red flag marshals who are not directly affected by an accident must follow the relevant radio transmissions. If they note that one of their colleagues further down the course is waving their red flag, they must immediately do the same.

4.3.019 Riders observing a waving red flag during the race must stop immediately.

A stopped rider must continue calmly to the finish and request a re-start from the finish line commissaire and wait for further instruction.

§ 5 First aid (minimum requirements)

- 4.3.020** The first aid service must be organised in accordance with articles 4.2.052 to 4.2.058 it being understood that the number of people qualified under the laws of the country to give first aid must be at least seven.
A medic must be stationed at the exit of the finish bowl during racing.
The organiser must submit an evacuation and medical plan to UCI prior to world championships, world cup and continental championships. The organisers medical coordinator must meet the technical delegate if applicable or the president of the commissaires' panel before the first training.
(text modified on 1.02.12).

§ 6 Training

- 4.3.021** The following training sessions must be organised:
- an on-foot inspection of the course must be organised before the first training session. No bikes are allowed on the course during the on foot downhill course inspection.
 - a training session, the day before competition.
 - a training session on the morning of the race day.
- No training is permitted whilst a race is in progress.
(text modified on 1.01.20).
- 4.3.022** Each rider must complete at least two training runs **or they will be disqualified from the race**. The start commissaire must ensure that this rule is applied.
(text modified on 1.01.23).
- 4.3.023** Riders must start all training runs at the official start gate. Any rider starting a training run below the start line must be disqualified from the competition.
- 4.3.024** Riders must display their handlebar number while training as well as their back number during the qualifying round and the final.

§ 7 Transport

- 4.3.025** The organiser must provide transport capable of carrying 100 riders and their bikes per hour to the top of the course.

Chapter IV FOUR CROSS EVENTS

§ 1 Nature

- 4.4.001** Four cross is an elimination event where three or four riders (called a heat) compete side by side on the same downhill course. The nature of this competition is such that there may be some unintentional contact between the riders. This is tolerated if the president of the commissaires' panel considers that it remains within the spirit of the event, fair play and a sporting attitude to other competitors.

§ 2 Organisation of competition

- 4.4.002** Practice runs must take place on the same day as the finals.

- 4.4.003** A qualifying round is organised, preferably the same day as the main event.

- 4.4.004** The qualifying round takes the form of a timed run over the course by each rider. In the event of a tie between riders during the qualifying round, their order is determined by the most recent UCI 4X individual ranking. If the riders are not ranked, lots are drawn to determine their order.

Riders who are DNF, DSQ or DNS in the qualifying round cannot enter the main event.

The riders start on the start commissaire's orders, in the sequence determined by the start list. The women ride before the men.

The race numbers used for the qualifying round are in sequence starting from 33 or 65 on the basis of the most recent UCI 4X individual ranking.

- 4.4.005** The number of riders qualifying for the first round of the main event is determined by the number of heats of three or four that can be made up.

A maximum of 16 heats is possible (maximum 64 riders).

If fewer than 64 riders ride the qualifying round, the number of heats can be 16, 8, 4 or 2, respecting the minimum of three riders per heat.

Heat order (men first until women come to equal heat system, finals: women small final followed by women big final, then men small final followed by men big final).

Number of classified riders in the qualifying round	Ladder
48+	64 riders
24-47	32 riders
12-23	16 riders
6-11	8 riders

The number of riders in the qualifying round may not be fewer than six, otherwise no 4X event may be held.

The race numbers for the main event are allocated on the basis of the results of the qualifying round; starting with number 1 for the rider with the best time during the qualifying round and so on.

4.4.006

The main event comprises elimination heats in which the groups of riders are matched as shown in the table below, in order to ensure that the first and second in the qualifying round can only meet in the final.

Men

Women

- 4.4.007** The riders in each heat ride only once per round. The third and the fourth rider in each heat are eliminated. The first and the second qualify for the next round.
- 4.4.008** In addition to the final, a small final round is held for the riders ranked third and fourth in the semi-finals. Riders who are DNF, DSQ or DNS in the semi-finals may not enter the small final.
- 4.4.009** The final classification of the competition is drawn up in groups in the following order:
1. all riders competing in the small final, except for riders DSQ.
 2. riders DNF or DNS in the semi-finals.
 3. all riders competing in the big final, except for riders DSQ.
 4. the classification of the other riders is determined by the round reached, then by the classification in their heat, then by their race number.

Within each of the above-mentioned groups, riders DNF are classified before DNS. In case of multiple DNF or DNS, the tiebreaker is the race number.

Riders DNF or DNS in the first round of the main event are listed without classification.

Riders DSQ in the main event are listed without classification.

All riders ranked after a rider DSQ are re-ranked one place higher within the affected phase only. No rider eliminated in an earlier phase can move up in the final classification. For example, in case of a DSQ in the big final, all riders ranked after the DSQ rider will be ranked one place higher and the rank four in the final classification will remain unallocated.

Riders not qualified for the main event are not listed in the final classification.

When for any reason the 4X main event (elimination heats) needs to be cancelled the results of the qualifying round stands as final result.
(text modified on 1.01.19)

- 4.4.010** The riders in each heat may choose their starting position in order of their race number. The rider with the lowest race number gets first choice.
- 4.4.011** The riders take the start from a stationary position.
- If a part of the front wheel passes the start line before the starting signal the rider is relegated (classified in a heat different from the actual finish).
- 4.4.012** The riders are required to pass through each gate without straddling it, i.e. both wheels of the bicycle must trace a path inside each gate. This is determined by judges located along the course or in the TV compound if applicable. A missed or straddled gate in the main event results in relegation unless the rider goes to the trouble of returning to pass it correctly.
- 4.4.013** If all the riders in heat fall or fail to cross the finish line in a preliminary round, the winner is the rider who covered the greatest distance.

§ 3 Course

- 4.4.014** Ideally, the course is set up on moderate slopes with regular gradients. It must also include a mixture of jumps, humps, banked turns, berms, dips, natural tables and other

special features. It may also include unbanked turns. There is normally no climbing requiring the riders to pedal.

The course must also be wide enough to allow four riders to line up side by side, and to enable overtaking.

The course must be fully marked out in accordance with the diagram in article 4.2.026 (zone A and zone B). Zone A must be at least 2 meters from the course and is at least 2 meters wide.

4.4.015 The duration of the race must be between 30 seconds and 60 seconds with an optimum time between 45 and 60 seconds for the winner of the qualifying round.

4.4.016 For the first 5 meters of the course, four lanes of an equal width must be marked by white lines (using tape, biodegradable paint or flour). Any rider crossing or riding on these white lines is relegated. In case a rider is crossing or riding on these white lines when he is placed behind his neighbour riders and does not hinder them and has no advantage the relegation can be transformed in a warning.

4.4.017 The start straight must be at least 30 metres long. Obstacles in the first 30 meters must be the same across the entire width of the course.

4.4.018 The gates on the course must be made of non-metallic stakes (slalom stakes), preferably in PVC, 1.5 to 2 metres high.

The gates must be set up with the lower part inwards and the higher part outwards.

4.4.019 The last gate on the course must be located at least 10 meters from the finish line.

4.4.020 The organiser must provide a raised platform from which the 4X judge has an unobstructed view of the entire course. The platform must be located in a zone to which spectators do not have access.

§ 4 Transport

4.4.021 The organiser must provide transport which is capable of bringing the riders to the start of the course promptly. A course running alongside a useable ski lift or cable car run is to be preferred.

§ 5 Clothing and protective accessories

4.4.022 A full-face helmet must be worn properly both when racing and when training on the course. The helmet must be fitted with a visor. Open-face helmets may not be worn.

4.4.023 The UCI strongly recommends the wearing of the clothing and protective accessories specified in article 4.3.011 and 4.3.013 to 4.3.014 during 4X events.

§ 6 First aid (minimum requirements)

4.4.024 The first aid service must be organised in accordance with articles 4.2.052 to 4.2.058, it being understood that the number of people qualified under the laws of the country to give first aid must be at least eight.

A medic must be stationed at the exit of the finish bowl during racing.

The organiser must submit an evacuation and medical plan to UCI prior to world championships, world cup and continental championships. The organiser's medical

coordinator must meet the technical delegate if applicable or the president of the commissaires' panel before the first training session.

§ 7 Training - competition

- 4.4.025** The following training sessions must be organised:
- a training session, the day before competition.
 - a training session on the race day.

When the 4X event is taking place at night, a night practise session must be provided for the riders.

No training is permitted whilst a race is in progress.

- 4.4.026** Riders must display their handlebar number while training and their back number during 4X finals.

§ 8 Card procedure

- 4.4.027** During the main event, a system of coloured cards is used by a commissaire at the finish. His decisions must be confirmed by the president of the commissaires' panel.

Card	Meaning	Code	Penalty
Yellow	Warning Rider gained NO advantage but behaviour was against regulations.	WRN	1 st time > no penalty.
Blue	Relegation Specified in articles: 4.4.011, 4.4.012 and 4.4.016	REL	a heat classification different from the actual finish.
Red	Disqualification Specified in article 4.2.012	DSQ	excluded from further competition, no classification

- A rider who receives a second card, whatever the colour, in the same event is disqualified.
- Cards must be shown by the designated commissaire (card commissaire) after confirmation by the president of the commissaires' panel and must be communicated directly via TV and the event speaker.

Chapter V ENDURO EVENTS

(chapter introduced on 1.10.13)

§ 1 Race characteristics

4.5.001 The race includes several liaison stages and timed stages.

The times achieved in all timed stage will be accumulated to a total time.

An enduro course comprises varied off-road terrain. The track should include a mixture of narrow and wide, slow and fast paths and tracks over a mixture of off-road surfaces. Each timed stage must be predominately descending but small pedaling or uphill sections are acceptable.

Liaison stages can include either mechanical uplift (e.g. chairlift), pedal powered climbs or a mixture of both. The emphasis of the track must be on rider enjoyment, technical and physical ability.

Any other system may be acceptable only under exceptional circumstances and subject to prior authorisation from the UCI.

§ 2 Technical assistance

4.5.002 A technical assistance zone can be provided by the organizer. Outside technical assistance is only allowed in this area.
(text modified on 1.01.20)

4.5.003 Only one frame, one front fork and one pair of wheels can be used by a competitor during a competition. Frame, fork and wheels will be individually marked by the officials before the start of the race and checked at the finish. Broken parts can eventually be replaced upon approval with a 5 min penalty if approved by race official.
(text modified on 1.01.20).

§ 3 Equipment

4.5.004 Riders must wear a helmet at all times during competition. In very technical terrain or on courses that feature steep mountainsides or very high-speed trails, the organiser can specify in his particular rules that competitors must wear a full-face helmet (either fixed or detachable).

The UCI strongly recommends that riders wear the protections as indicated in art.
(text modified on 1.01.20).

§ 4 Course map

4.5.005 A course map must be produced by the organizer and made available to all competitors before the first training session begins. On longer courses or in terrain that is hard to navigate through, course maps should be available for riders to carry with them.

§ 5 Course marking

4.5.006 The entire enduro courses must be marked and protected with safe and visible course markers that present no safety risks to riders.

In very fast and dangerous sections, where the riders' line is close to the course boundary, B lines must be installed as per diagram:

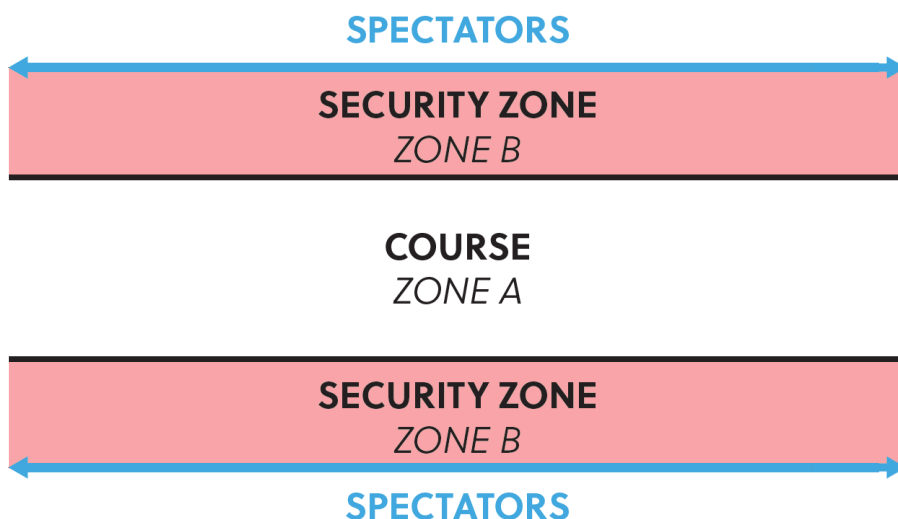

(text modified on 1.01.23).

- 4.5.007** Extra care must be taken by the organiser to make sure that the course is clearly and no shortcuts are possible.
- 4.5.008** In sections of the course that are marked by course tape, both sides of the track must be marked.
- 4.5.009** Road crossing and dangerous area must be marked on both sides.
(text modified on 1.01.20).

§ 6 Organisation of competition

- 4.5.010** The organizer must provide the start times for each timed stage
- 4.5.011** Each rider takes an individual start, the start interval between the riders must be of 10 seconds at least.
(text modified on 1.01.20).
- 4.5.012** A minimum of 3 timed stages must be raced.
The total time for each rider shall correspond to a minimum of 10 minutes
- 4.5.013** A minimum of 2 different courses for the timed stages must be used. Under unforeseen and exceptional circumstances (e.g. weather), the UCI commissaire may, after consulting the organizer, cancel a stage or remove it from the general classification.
- 4.5.014** There are no restrictions on the nature of liaison stages. Uplift of riders can be either by mechanical means (chairlift, truck etc) or by pedalling or a mixture of both.
- 4.5.015** Adequate training must be provided by the organiser for all timed stages.

§ 7 Results

- 4.5.016** The events general classification will be calculated by adding all special stage times together for each rider.

§ 8 Infractions

- 4.5.017** A rider must act in a sporting manner at all times and must permit any faster rider to overtake without obstructing.

- 4.5.018** The president of the commissaries' panel can consider a rule violation that has not been witnessed by a race official if it has been reported by at least two riders who are part of two different teams (e.g. rider getting assistance outside technical assistance zone, rider cutting course)

§ 9 Marshals

- 4.5.019** For marshals, refer to the articles 4.1.017 to 4.1.021.

A small number of special trained marshals or commissaires should move around the course during competition to undisclosed points. Quad bike can be used to check rules infringements.
(text modified on 1.01.20).

§ 10 Medical service

- 4.5.020** For first aid (minimum requirements), refer to the articles 4.2.052 to 4.2.059. The organizer must set up an adequate medical service. The organizer must supply each competitor with emergency contact details.
(text modified on 1.01.20).

Chapter VI PUMP TRACK

(chapter introduced on 1.01.19)

§ 1 Definition and nature

- 4.6.001** A pump track is a track that consists of rollers and steep turns in various sizes and shapes. The rollers and turns are used to generate speed by pumping the bike, not by pedalling. A pump track is built in a way that promotes technical skills. Speed on a pump track is generated by pumping the bike - not by pedalling and not by gravity. Large flat sections that promote pedalling are to be avoided.

§ 2 Categories

- 4.6.002** International categories are “open men” and “open women”. Riders must be 17 years of age in order to compete.

All Pump Track events will be considered as Class 3 events.

Event organisers are free to have either age or ability categories for other riders.

Categories for children shall follow any age limits set by the local laws.

For participation in events on the international calendar, riders' categories are determined by the age of those competing as defined by the difference between the year of the event and the year of birth of the rider.

(text modified on 1.01.20).

§ 3 Equipment

- 4.6.003** **Bike**
A minimum wheel size of 20 inches is required for the men and women open categories. Children's categories can use smaller wheels.
The bike should have at least 1 rear brake.
No bikes with any kind of automatic transmission, pedal assist motors or engines are allowed.
No protruding parts on the bike, which can injure other riders (such as pegs) are permitted.

Riders are not allowed to use pedals where their shoes are fixed to the pedal through a clipless system. Flat pedals only.

(text modified on 1.01.21)

- 4.6.004** **Clothing and protective accessories**
The following clothing and protective gear should be worn by all riders:
- A helmet must be worn properly both when racing and when training on the track. An open face helmet is mandatory while a full-face helmet is strongly recommended.
 - A shirt is mandatory while long sleeve shirt and elbow pads are recommended.
 - Regular shoes are mandatory, sandals or other open shoes are not permitted.
 - Full finger gloves are recommended.
 - Long pants and/or knee protection is recommended
- (text modified on 1.01.21)*

§ 4 Course

- 4.6.005** A pump track can be defined by either a start and a finish, or by a closed circuit design. It is recommended that a pump track has a compact, hard surface that withstands weather and erosion.

Generally, the pump track should be on a flat ground or on a moderate slope. It should include a mixture of rollers and banked turns. The design is free and can include uphill and downhill, as long as “pumping” is more efficient than pedalling. Pedalling shall not be an advantage.

§ 5 Competition Format

Race Formats

- 4.6.006** A competition consists of a free practice session, qualification and elimination heats.

At the start riders are positioned at least 10 meters from the start/finish line and get ready with one foot on the ground. The distance between the starting point and start/finish line shall contain an adequate number of rollers and turns to gain maximum speed (without pedaling). The starting point should be a marked rectangular area, adequate to fit a bike in length and width. Alternatively, a BMX type start gate may be used. If so, it should be used without the automated start procedure (no lights, nor sound) and still with one foot on the ground for the rider. The only start procedure notification should be a verbal “Riders Ready” from the starter.

(text modified on 1.01.21; 1.01.22)

- 4.6.007** Free practice session
A free practice session can take place the day before or on the same day as the competition. The duration of the practice session depends on the race schedule.
(text modified on 1.01.21)

- 4.6.008** Qualification
The qualification shall consist of one or several timed runs by each rider that shall be run in a flying lap format: The rider gets up to speed, time starts running as soon as the rider crosses the start / finish timing unit, time stops when the rider crosses the unit again.
(text modified on 1.01.21)

- 4.6.009** Timed runs can be either solo runs or managed in an open session format. The starting order of the timed run is determined:
- A. according to the order in which riders registered for the race on-site, or
 - B. by the overall standings of the series
 - C. women’s category will be run first, followed by men.
 - D. Each rider shall get at least 1 timed run. Starting in all timed runs is mandatory

Other qualifying formats are allowed. The qualifying formats must be described in the technical guide.

If a rider shortcuts the track, the rider will be scored as a DNF (did not finish). The parameters of the track will be defined by the commissaire and communicated to all riders on the day of the competition. This is especially important on tracks that have different line options.

If a rider does not complete a full run, rider will be scored as a DNF and placed last in that phase of the competition.

The commissaire has the final decision on rider disqualification.

The timed run rankings can be determined by the fastest single run time of a rider or by the sum of all run times, if several timed runs are held.

The fastest 32 riders per category progress to the elimination heats.

- If there are 31 and less riders in a category, the fastest 16 riders advance to elimination heats.
- If there are 15 and less riders in a category, the fastest 8 riders advance to the elimination heats.
- If there are 7 and less riders in a category, the fastest 4 riders advance to the elimination heats.

(text modified on 1.01.21)

Elimination heats

4.6.010

The main event comprises of elimination heats. Riders advancing from the qualification will go head-to-head in the main event heats.

The elimination heats can be run with all kinds of race formats explained below.

Rider pairings will be determined based on their ranking following the qualification. The fastest rider (1st placed) will go head-to-head against the slowest rider (8th / 16th / 32nd placed).

The fastest rider from each heat advances to the next round, until there are only 2 riders remaining who will compete in the final.

The main event heats can be run in 4 formats:

- Head-to-head – Pursuit
- Head-to-head – Dual
- Solo runs
- Open Session

(text modified on 1.01.21)

Head-to-head - Pursuit

4.6.011

The track needs to be equipped with 1 or 2 timing units (depending on the track layout). The timing units shall be placed in co-operation with the commissaire.

- Riders will go head-to-head riding on the track at the same time, starting at different positions and ride in the same direction.
- The rider with the fastest qualification time has priority on their start position (1 or 2).
- The rider must line up at the start line, with one foot on the ground.
- The time starts running as soon as the riders cross their start / finish timing line and stops when they cross it again.
- The fastest rider will advance to the next round.
- If a rider does not complete a full run, rider will be scored DNF without re-run.

Example of track and timing layout.

(text modified on 1.01.21)

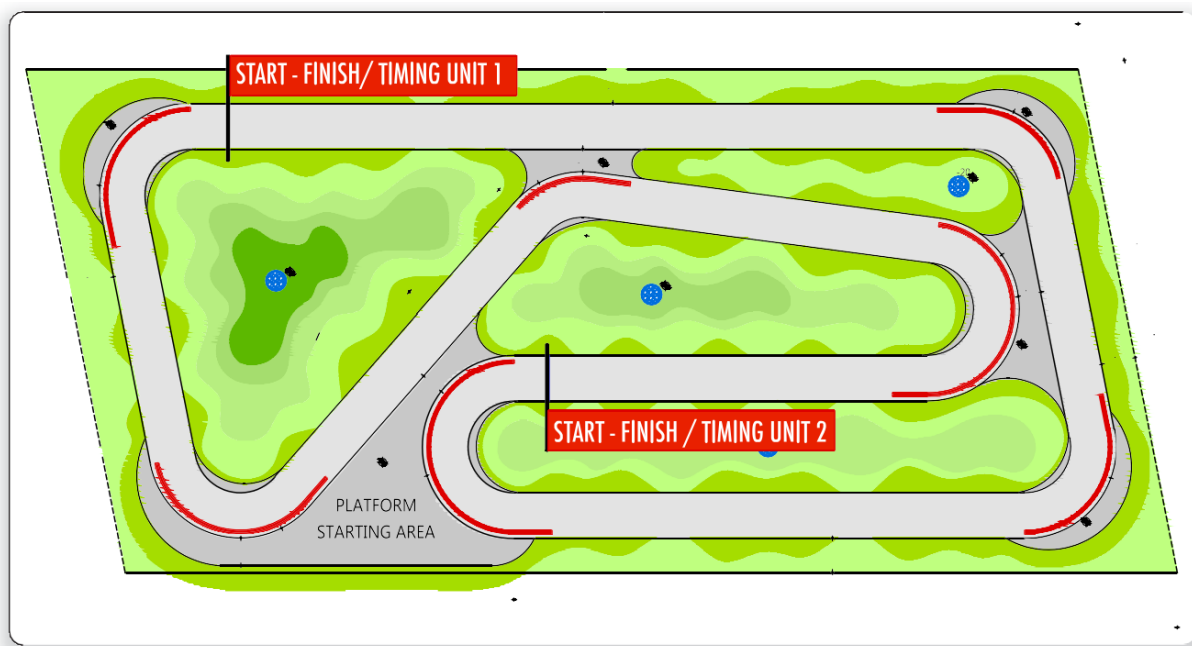

Head-to-head - Dual

4.6.012

The track needs to be equipped with 1 timing unit and 2 start mechanisms (preferred). The timing units shall be placed in co-operation with the commissaire.

- Riders will go head-to-head at the same time.
- The rider with the fastest qualification time has priority on its start position (1 or 2)
- The rider must line up at the start line, with one foot on the ground.
- The race starts as soon as the start mechanism starts the time and stops when the riders cross the finish line.
- The rider who crosses the finish line 1st advances to the next round
- Depending on the track layout, this format requires 2 runs per elimination heat (to be defined by the commissaire).
- Run 1: The rider with the fastest timed run will start on the left course, at the same time the other rider starts on the right course. The riders go head-to-head and they both set a time. The maximum time difference / penalty is 1.5 sec (for example if a rider crashes).
- Run 2: Both riders switch lanes. The riders go head-to-head for the second time and they both set a 2nd time.
- The combination of both times (left and right course) per rider determines the riders overall time.
- The winner of the heat is the rider with the fastest combined time and they advance to the next round.

Example of track and timing layout.

(text modified on 1.01.21)

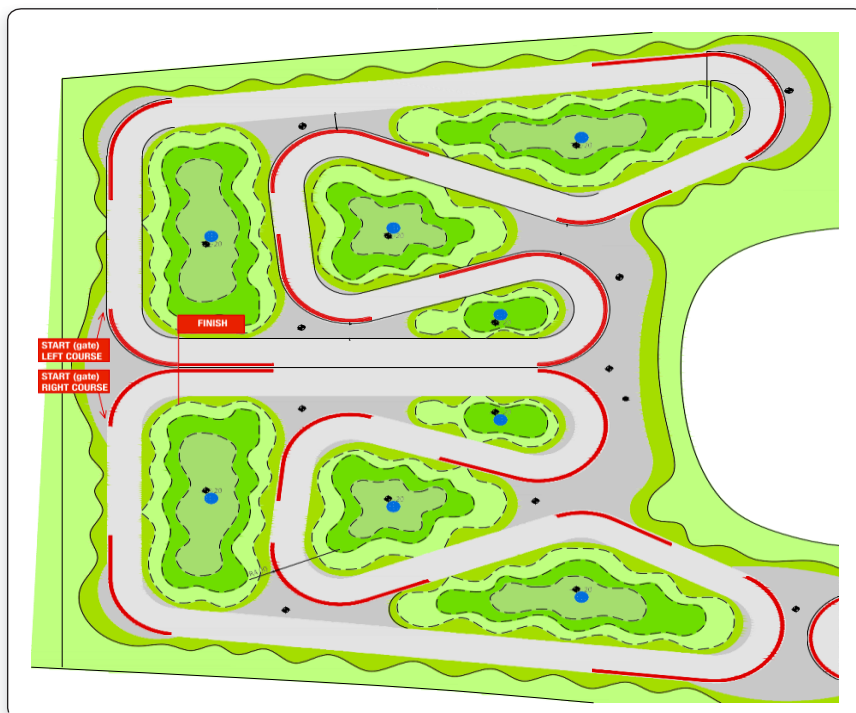

Solo runs

4.6.013

The track needs to be equipped with 1 timing unit. Timing units to be placed in co-operation with the commissaire.

- 2 riders will race against each other, in a separate run on the exact same track.
- The rider must line up at the start line, with one foot on the ground.
- The rider with the slower qualification time starts first in each of the rounds in the elimination heats down to the finals.
- The riders only have 1 run to set a time.
- The rider with the fastest time advances to the next round.
- If a rider does not complete a full run, rider will be scored DNF without re-run.
(article modified on 1.01.21)

4.6.014

(article abrogated on 1.01.21)

4.6.015

Running order

- Women's rounds followed by men's rounds of 32nd rider
- Starting with rounds of 32nd rider
- Round of 16, round of 8
- Semi-final
- Women small final
- Men small final
- Women big final
- Men big final

Example of competition grid.

EVENT: _____
CLASS: _____

LOCATION: _____
DATE: _____

1st ROUND

Heat 401

1	
8	

1/4 FINALE

Heat 403

3	
6	

BIG FINALE

Heat 201

1/2 FINALS

Heat 201

1/2 FINALE

Heat 202

SMALL FINALE

Heat 101

Heat 402

4	
5	

1

Heat 404

2	
7	

EVENT: _____
CLASS: _____

LOCATION: _____
DATE: _____

1st ROUND

Heat 801

1	
16	

1/4 FINALE

Heat 401

Heat 802

6	
11	

1/2 FINALS

Heat 201

BIG FINALE

Heat 201

1/2 FINALE

Heat 202

SMALL FINALE

Heat 101

Heat 803

5	
12	

Heat 402

2ND ROUND

Heat 805

3	
14	

1/4 FINALE

Heat 403

Heat 806

8	
9	

Heat 807

7	
10	

Heat 404

Heat 804

4	
13	

1

Heat 808

2	
15	

EVENT: _____ CLASS: _____	LOCATION: _____ DATE: _____
--	--

1ST ROUND Heat 1601 <table border="1" style="width: 100%;"><tr><td>1</td><td></td></tr><tr><td>32</td><td></td></tr></table> Heat 1602 <table border="1" style="width: 100%;"><tr><td>9</td><td></td></tr><tr><td>24</td><td></td></tr></table> Heat 1603 <table border="1" style="width: 100%;"><tr><td>16</td><td></td></tr><tr><td>17</td><td></td></tr></table> Heat 1604 <table border="1" style="width: 100%;"><tr><td>8</td><td></td></tr><tr><td>25</td><td></td></tr></table> Heat 1605 <table border="1" style="width: 100%;"><tr><td>5</td><td></td></tr><tr><td>28</td><td></td></tr></table> Heat 1606 <table border="1" style="width: 100%;"><tr><td>13</td><td></td></tr><tr><td>20</td><td></td></tr></table> Heat 1607 <table border="1" style="width: 100%;"><tr><td>12</td><td></td></tr><tr><td>21</td><td></td></tr></table> Heat 1608 <table border="1" style="width: 100%;"><tr><td>4</td><td></td></tr><tr><td>29</td><td></td></tr></table>	1		32		9		24		16		17		8		25		5		28		13		20		12		21		4		29		2ND ROUND Heat 801 <table border="1" style="width: 100%;"><tr><td></td><td></td></tr></table> Heat 802 <table border="1" style="width: 100%;"><tr><td></td><td></td></tr></table> Heat 803 <table border="1" style="width: 100%;"><tr><td></td><td></td></tr></table> Heat 804 <table border="1" style="width: 100%;"><tr><td></td><td></td></tr></table> 1/4 FINALE Heat 401 <table border="1" style="width: 100%;"><tr><td></td><td></td></tr></table> 1/2 FINALS Heat 201 <table border="1" style="width: 100%;"><tr><td></td><td></td></tr></table> SMALL FINALE Heat 101 <table border="1" style="width: 100%;"><tr><td></td><td></td></tr></table> BIG FINALE Heat 201 <table border="1" style="width: 100%;"><tr><td></td><td></td></tr></table> 1/2 FINALE Heat 202 <table border="1" style="width: 100%;"><tr><td></td><td></td></tr></table> Heat 402 <table border="1" style="width: 100%;"><tr><td></td><td></td></tr></table> Heat 403 <table border="1" style="width: 100%;"><tr><td></td><td></td></tr></table> Heat 404 <table border="1" style="width: 100%;"><tr><td></td><td></td></tr></table>																									1ST ROUND Heat 1609 <table border="1" style="width: 100%;"><tr><td>3</td><td></td></tr><tr><td>30</td><td></td></tr></table> Heat 1610 <table border="1" style="width: 100%;"><tr><td>11</td><td></td></tr><tr><td>22</td><td></td></tr></table> Heat 1611 <table border="1" style="width: 100%;"><tr><td>15</td><td></td></tr><tr><td>18</td><td></td></tr></table> Heat 1612 <table border="1" style="width: 100%;"><tr><td>6</td><td></td></tr><tr><td>27</td><td></td></tr></table> Heat 1613 <table border="1" style="width: 100%;"><tr><td>7</td><td></td></tr><tr><td>26</td><td></td></tr></table> Heat 1614 <table border="1" style="width: 100%;"><tr><td>14</td><td></td></tr><tr><td>19</td><td></td></tr></table> Heat 1615 <table border="1" style="width: 100%;"><tr><td>10</td><td></td></tr><tr><td>23</td><td></td></tr></table> Heat 1616 <table border="1" style="width: 100%;"><tr><td>2</td><td></td></tr><tr><td>31</td><td></td></tr></table>	3		30		11		22		15		18		6		27		7		26		14		19		10		23		2		31	
1																																																																																										
32																																																																																										
9																																																																																										
24																																																																																										
16																																																																																										
17																																																																																										
8																																																																																										
25																																																																																										
5																																																																																										
28																																																																																										
13																																																																																										
20																																																																																										
12																																																																																										
21																																																																																										
4																																																																																										
29																																																																																										
3																																																																																										
30																																																																																										
11																																																																																										
22																																																																																										
15																																																																																										
18																																																																																										
6																																																																																										
27																																																																																										
7																																																																																										
26																																																																																										
14																																																																																										
19																																																																																										
10																																																																																										
23																																																																																										
2																																																																																										
31																																																																																										

4.6.016 Open session

An active transponder timing system and a screen are required to run this format.

Qualification session

- The track is open for a fixed pre-determined session time (length of session is based on average lap time, track layout and number of riders).
- Start order for the first run (in session) determined by plate number.
- Riders can do as many laps as they want during the session.
- The fastest lap of each rider counts.
- After the open session, the fastest 32 riders advance to the elimination session.
- If there are 31 and less riders in the open session, the fastest 16 advance to the elimination session.
- If there are 15 and less riders in the open session, the fastest 8 advance to the elimination session.
- If there are 7 and less riders in the open session, the fastest 4 advance to the elimination session.

Elimination heats

- The track is open for a fixed pre-determined session time during elimination (length of session is based on average lap time and track layout).
 - Start order for the first run (in session) determined by results from the qualification session. Fastest qualifier starts first in each round and session.
 - Top32 - fastest 16 riders advance to the next round.
 - Top16 - fastest 8 riders advance to the next round.
 - Quarter final - fastest 4 riders advance to the semi-final.
 - Semi-final - fastest 2 riders advance to the big final - slowest 2 riders to the small final.
 - Small final - 2 riders, one run each - fastest rider got 3rd overall.
 - Big final - 2 riders, one run each - fastest rider wins overall.
- (text modified on 1.01.21).

Chapter VII SNOW BIKE

(chapter introduced on 1.01.19)

§ 1 General

4.7.001 The snow bike is a downhill mountain bike snow event.

The events will be considered as class 3 events. UCI points are awarded in relation to the rider's time. To ensure that this rule is correctly applied, only one combined result need to be sent to the UCI.

4.7.002 Age Category
The snow bike events are open to all riders from aged 17 or over. All riders therefore enter in the Men Elite and Women Elite categories.

For participation in events on the international calendar, riders' categories are determined by the age of those competing as defined by the difference between the year of the event and the year of birth of the rider.

4.7.003 Registration
The riders' registration for the events is handled by the organiser.

The number of riders registered is regulated by the organiser.

4.7.004 Clothing and protective accessories
The protective accessories are recommended to all competitors according to articles 4.3.012 and 4.3.013.

4.7.005 Events formats characteristics
The characteristics and format of each event will be determined in the technical guide for each event.

4.7.006 Tyres
The day before the competition, the organiser will give information and recommendations about the tyres to be used according to the snow characteristics.

Chapter VIII E-MOUNTAIN BIKE

(chapter introduced on 1.01.19)

(text modified on: 11.02.20)

§ 1 General

- 4.8.001** The events
An E-Mountain Bike, is a bike operated with two energy sources, human pedal power and an electric engine, which only provides assistance when the rider is pedaling. Only "Pedelec" type of bikes are allowed in UCI event.
- E-Mountain bike events must be organised in accordance with the following bike standards:
- Engine with a maximum continuous rated power of 250 watts
 - Engine assistance up to 25km/h
 - Pedalling assistance only, although a start-up assistance not exceeding 6km/h without pedalling is allowed
- 4.8.002** Age category
Except if stated otherwise in the UCI Regulations for specific events or series, E-Mountain Bike events are open to all riders aged 19 and over and include Masters categories. No separate results must be submitted for the Under 23, Elite or Masters categories.
(text modified on 1.01.23)
- 4.8.003** Events format and characteristics
E-Mountain Bike events will be organised in the cross-country and Enduro formats and will be registered as Class 3 events. No UCI points will be awarded for E-Mountain Bike events.
- The bikes specifications and check procedures as well as the characteristics and format of each event will be determined in the technical guide for each event. The technical guide officiates as regulation reference for each specific event.
- 4.8.004** Registration
Bike The rider's registration procedure is handled by **the UCI appointee** of an E-Mountain event.
- 4.8.005** Battery
Riders can only use the battery in place on their bike and cannot carry an additional battery during the competition.

Chapter IX UCI MOUNTAIN BIKE WORLD SERIES

(Chapter reviewed on 1.01.23).

§ 1 General

4.9.001 The UCI Mountain Bike World **Series** is the exclusive property of the UCI.

The UCI Mountain Bike World Series is made up of the UCI World Cup in the race types:

- Cross-country (see Chapter X);
- Downhill (see Chapter XI);
- Marathon (see Chapter XII);
- Enduro (see Chapter XIII).

The UCI World Cups of each of the above-mentioned race types are the exclusive property of the UCI.

4.9.002 Each year the UCI designates the **rac**es, types of events and the age categories for each UCI World Cup which is part of the UCI mountain bike World Series.

Registration

4.9.003 All riders must be registered using the UCI on-line registration system. **UCI ELITE MTB TEAMS** and **UCI MTB TEAMS** register their riders. National federations register the other riders who qualify under **provisions on participation**.

A table showing the opening and closing dates for entries is published on the UCI website.

4.9.004 All riders or their team managers must attend the riders' confirmation presenting the rider licenses and picking up the race numbers within the deadlines indicated on the official program published on the **dedicated website for the UCI World Series**. Riders who are not confirmed before the indicated deadline are considered not to have completed the registration procedure and will not be allowed to compete in the event.

4.9.005 Late entries from **UCI ELITE MTB TEAMS**, **UCI MTB TEAMS**, national federations and **riders** are refused unless authorised and subject to **compliance with provisions for participation as well as** payment of a fine of **EUR 300**.

Late entries are entries handled after the on-line registration deadline and before the riders' confirmation deadline. Passed the riders' confirmation deadline late **are not considered**.

Press conference

4.9.006 At the request of the organiser, the three **best** placed riders in the event and the leader in the world cup standings must attend the press conference.

Leader's jersey

4.9.007 The **leader's jersey is compulsory for the** rider leading a UCI World Cup standing.

4.9.008 The colours and the design of the leaders' jerseys shall be communicated to the riders concerned once approved by the UCI.

Chapter X UCI CROSS-COUNTRY WORLD CUP

(Chapter reviewed on 1.01.23).

- 4.10.001** Participation
 UCI Cross-country World Cup events (XCO and XCC) are open to riders corresponding to the following categories and criteria:

Category	One of the below mentioned criteria needs to be fulfilled
XCO - men elite (aged 23 and over) XCO - women elite (aged 23 and over)	<ol style="list-style-type: none"> 1. Having obtained at least 60 UCI points in the UCI XCO individual reference ranking (*). 2. The national federations may enter a maximum of 6 supplementary riders per category. These riders must wear national team clothing.
XCO - men under 23 (aged from 19 to 22)	<ol style="list-style-type: none"> 1. Having obtained at least 80 UCI points in the UCI XCO individual reference ranking (*) 2. The national federations may enter a maximum of 6 supplementary riders per category. These riders must wear national team clothing. 3. The national federation of the organizing country may register a supplementary team B of 6 maximum riders (wearing national team clothing) 4. Riders belonging to a UCI ELITE MTB TEAM or a UCI MTB TEAM
XCO - women under 23 (ages aged from 19 to 22)	<ol style="list-style-type: none"> 1. Having obtained at least 20 UCI points in the UCI XCO individual reference ranking (*) 2. The national federations may enter a maximum of 6 supplementary riders per category. These riders must wear national team clothing. 3. The national federation of the organizing country may register a supplementary team B of maximum 6 riders (wearing national outfit required) 4. Riders belonging to a UCI ELITE MTB TEAM or a UCI MTB TEAM
XCC – men elite (aged 23 and over) XCC – women elite (aged 23 and over) XCC – men under 23 (aged from 19 to 22) XCC – women under 23 (aged from 19 to 22)	<p>A maximum of 40 riders per gender (40 men elite and 40 women elite) already registered and confirmed for the elite XCO event taking place during the same weekend shall be allowed to start in the XCC event. The riders shall be selected as per article 4.10.003 to reach a total number of 40 riders per gender. No online registration is required for the XCC event.</p> <p>The same bike must be used for XCC and XCO. For XCC, the minimum tyre width must be 45mm.</p>

(*)The date of such reference rankings is fixed and communicated by the UCI for each event of the UCI mountain-bike World Cup on the UCI website.

Riders registration can be done only by a UCI ELITE MTB TEAM, a UCI MTB TEAM or a national federation.

If a rider that confirmed his participation to the XCC event is not starting, he will not be allowed to start the XCO event on the same world cup round unless if the rider has

been declared incapable of taking the start of the XCC event by the organiser's chief medical officer or the team doctor.

4.10.002 Riders must display their handlebar numbers during training sessions and also their back number during the race.

A coach of a national team or a **UCI ELITE MTB TEAM** or a **UCI MTB TEAM** wishing the reconnoitre the course must ~~who holds a licence, must~~ request a handlebar number to use when reconnoitring the course. The coach must also hold a licence ~~As well as the handlebar number he must and~~ wear a helmet.

4.10.003 The start order is determined as follows:

A. XCC men elite and women elite, **XCC men under 23 and women under 23**

1. riders ranked in the top 16 of the most recently published XCO World Cup standings (not applicable for the first UCI World Cup round of the season)
2. as per the most recently published UCI XCO individual ranking

B. XCO men elite and women elite

1. the riders ranked in the top 24 of the XCC race **of the same UCI World Cup round**
2. the place 25th to 32nd will be allocated as per the most recently published UCI XCO individual ranking.
3. The place 33rd to 40th will include any riders ranked in the top 10 of any individual UCI world ranking of any cycling discipline.
4. as per the most recently published UCI XCO individual ranking.
5. unclassified riders: by drawing lots.

Riders with injury status shall be integrated in the start order in accordance with article 4.10.011.

C. XCO men under 23 and women under 23:

1. **the riders ranked in the top 24 of the XCC race of the same UCI World Cup round**
2. as per the most recently published UCI XCO individual ranking
3. unclassified riders; by drawing lots

Riders with injury status shall be integrated in the start order in accordance with article 4.10.011.

Teams and national federations who submitted a late registration which was approved by the UCI are allocated the next available highest race number, with the exception of the riders ranked in the top 16 (men elite, women elite, men under 23, women under 23) of the most recent UCI XCO World Cup standings for whom the race number is reserved (not applicable for the first UCI World Cup round of the season). However, they are called to the start line in the order specified earlier in this article.

4.10.004 In cross-country Olympic (XCO) and cross-country short track (XCC), any rider whose time being 80% slower of that of the race leader's first lap is pulled out of the race. He is required to leave the race at the end of his lap in the zone provided for the purpose (the "80% zone") except when the rider is on his final lap.

4.10.005 Lapped riders must complete the lap on which they were lapped and then leave the race via 80% zone.

4.10.006 Riders pulled out of the race under article 4.10.004 and lapped riders are listed in the results in the order in which they are pulled out of the race showing the number of laps down.

4.10.007 Official ceremony
The official ceremony takes place immediately after each race. Riders arriving later than 5 minutes after they finished their race are fined.

The following riders must attend:

- the first five riders in the elite **XCO** events;
- **the first three riders in the elite XCC events;**
- the leader of the elite UCI World Cup standings after the event in question (**XCO, XCC**);
- the first three riders in the under 23 events (**XCO, XCC**);
- the leader of the under 23 UCI World Cup standings after the event in question (**XCO, XCC**);
- the team leading the team standings after the event in question (specified in article 4.10.009);
- the team of the day.

N.B - Bicycles cannot be taken onto the podium. However, an area is provided in front of the podium to display the bicycle of the winner during the official ceremony.

4.10.008 World cup standings
The UCI World Cup standings are drawn up on the basis of the points won by each rider in accordance with the table in article 4.10.010.

For the sake of clarity, the cross-country world cup standings are drawn up by summing the points scored in the XCC and XCO events.

Riders tying on points are ranked by the greatest number of 1st places, 2nd places, etc. (total points in the standings of the concerned round) taking account only of places for which points are awarded for the UCI World Cup. If they are still tied, the points scored in the most recent UCI World Cup event are used to separate them.

In the event of a tie on points for cross-country after the XCC and XCO events, the riders' positions are determined by the result in the XCO event.

4.10.009 A team standing is drawn up for each round of the UCI World cup. Only riders registered in a **UCI ELITE MTB TEAM** or a **UCI MTB TEAM** can score points for their team in accordance with the team standing table in article 4.10.010.

For cross-country, a team classification for men elite and a team classification for women elite is drawn up. The team classification is drawn up by summing the total points (XCC and XCO) of the 3 highest scoring riders of each team. Teams with only one or two riders scoring points are also included in the team classification. Tied teams will have their relative positions determined by their best ranked rider within the top 30 of the XCO event. Should there still be a tie, the order is determined by the best ranked rider within the top 30 of the XCC event.

After each round of the UCI World Cup, the team standings is drawn up by adding the points won in the team classification per event. Ties are **separated** by the largest

number of 1st places, 2nd places, etc. Should there still be a tie, the order is determined by the team classification for the most recent UCI World Cup round.

The riders of the team leading the **UCI-MTB** team **world-cup** standings are given **yellow leaders** handlebar number plates which must be used during the UCI World Cup.

4.10.010

Points scale

A. Cross-country Olympic (XCO) and cross-country short track (XCC) events

Position	XCO elite points	XCO under 23 points	XCC elite points	XCC elite (points allocated to the XCO standing)	XCC under 23 points	XCC under 23 (points allocated to the XCO standing)
1	250	125	250	80	125	40
2	200	100	200	65	100	30
3	160	80	160	50	80	25
4	150	75	150	40	75	20
5	140	70	140	38	70	19
6	130	65	130	37	65	18
7	120	60	120	36	60	17
8	110	55	110	35	55	16
9	100	52	100	34	52	15
10	95	51	95	33	51	14
11	90	50	90	32	50	13
12	85	49	85	31	49	12
13	80	48	80	30	48	11
14	78	47	78	29	47	10
15	76	46	76	28	46	9
16	74	45	74	27	45	8
17	72	44	72	26	44	7
18	70	43	70	25	43	6
19	68	42	68	24	42	5
20	66	41	66	23	41	4
21	64	40	64	22	40	
22	62	39	62	21	39	
23	60	38	60	20	38	
24	58	37	58	19	37	
25	56	36	56	18	36	
26	54	35	54	17	35	
27	52	34	52	16	34	
28	50	33	50	15	33	
29	48	32	48	14	32	
30	46	31	46	13	31	
31	44	30	44	12	30	
32	42	29	42	11	29	
33	40	28	40	10	28	
34	38	27	38	9	27	
35	36	26	36	8	26	
36	34	25	34	7	25	

37	32	24	32	6	24	
38	30	23	30	5	23	
39	29	22	29	4	22	
40	28	21	28	3	21	
41	27	20				
42	26	19				
43	25	18				
44	24	17				
45	23	16				
46	22	15				
47	21	14				
48	20	13				
49	19	12				
50	18	11				
51	17	10				
52	16	9				
53	15	8				
54	14	7				
55	13	6				
56	12	5				
57	11	4				
58	10	3				
59	9	2				
60	8	1				

B. Team standing

Cross-country Olympic (XCO)		Cross-country short track – XCC
Position	Women Men And Elite points	Women and Men Elite points
1	80	40
2	75	39
3	72	38
4	70	37
5	68	36
6	66	35
7	64	34
8	62	33
9	60	32
10	58	31
11	56	30
12	54	29
13	52	28
14	50	27
15	48	26

16	46	25
17	44	24
18	43	23
19	42	22
20	41	21
21	40	20
22	39	19
23	38	18
24	37	17
25	36	16
26	35	15
27	34	14
28	33	13
29	32	12
30	31	11
31	30	10
32	29	9
33	28	8
34	27	7
35	26	6
36	25	5
37	24	4
38	23	3
39	22	2
40	21	1
41	20	
42	19	
43	18	
44	17	
45	16	
46	15	
47	14	
48	13	
49	12	
50	11	
51	10	
52	9	
53	8	
54	7	
55	6	
56	5	
57	4	
58	3	
59	2	
60	1	

§ 5

4.10.011

Injury status

If due to injury a rider took part in less than three rounds of the **UCI World Cup** in a season, the national federation or the team may apply **to the UCI** for recognition of injury status. An application must be received **at the UCI** in writing no later than October 30th of the disrupted season.

A rider with injury status shall be integrated in the ranking that is used to determine the start list, with the number of points determined according to following calculation: the average points gained per round in which the rider took part multiplied by the number of rounds of the **UCI World Cup** season during which the rider was absent due to injury.

Such benefit shall be limited to the first round of the **UCI World Cup** in which the rider takes part during the following season.

This applies only for the XCO format start order according to article 4.10.003.

Chapter XI UCI DOWNHILL WORLD CUP

(Chapter reviewed on 1.01.23).

- 4.11.001** Participation
 UCI **Downhill** World Cup events are open to riders corresponding to the following categories and criteria:

Category	One of the below mentioned criteria needs to be fulfilled
DHI - men elite (aged 19 and over) DHI - women elite (aged 19 and over)	<ol style="list-style-type: none"> 1. Having obtained at least 40 UCI points in the UCI DHI individual reference ranking (*). 2. The national federations may enter a maximum of 3 supplementary riders per category. These riders must wear national team clothing. 3. Riders belonging to a UCI ELITE MTB TEAM or a UCI MTB TEAM
DHI - men juniors (aged 17 and 18) DHI – women juniors (aged 17 and 18)	<ol style="list-style-type: none"> 1. Each national federation may enter a maximum of 6 riders per category (wearing national outfit required). 2. The national federation of the organising country may register a supplementary team B of maximum 6 riders (wearing national outfit required). 3. Riders belonging to a UCI ELITE MTB TEAM or a UCI MTB TEAM

(*)The date of such reference rankings is fixed and communicated by the UCI for each event of the UCI ~~mountain-bike~~ World Cup on the UCI website.

Riders registration can be done only by a **UCI ELITE MTB TEAM**, a **UCI MTB TEAM** or a national federation.

- 4.11.002** Number allocation
 Race number allocation will be determined by the UCI appointee. Season long race numbers will be allocated to the top 10 men elite and top 5 women elite from the final standings of previous UCI World Cup season.

- 4.11.003** Riders must display their handlebar numbers during training sessions.

- 4.11.004** The start order for the qualifying round is determined as follows:
- A. men elite, women elite:
1. riders ranked in the top 60 men and the top 15 women of the most recently published UCI World Cup standings (for the first event, as per the final world cup standings of the previous year), starting in reverse order.
 2. as per the most recently published UCI DHI individual ranking.
 3. unclassified riders: **by drawing lots**.

Riders with injury status shall be integrated in the start order in accordance with article 4.11.021.

- B. men juniors, women juniors:
1. riders ranked in the top 10 men juniors and the top 3 women juniors of the most recently published UCI World Cup standings (not applicable for the first UCI world cup round of the season), starting in reverse order.
 2. as per the most recently published UCI DHI individual ranking, starting in reverse order.

3. unclassified riders: **by drawing lots:**

Riders with injury status shall be integrated in the start order in accordance with article 4.11.021.

Riders who submitted a late registration which was approved by the UCI are allocated the next available highest race number, with the exception of the riders ranked in the top 60 men elite, the top 15 women elite, the top 10 men juniors and the top 3 women juniors of the most recent UCI World Cup standings for whom the race number is reserved, **plus season long race numbers that are reserved** and will be called to the start line in the order specified earlier in this article.

4.11.005 A transport system capable of carrying 150 riders per hour up to the start line must be provided at all world cup venues. All loading and unloading of bicycles onto this transport system must be carried out by staff of the organisation.

Training

4.11.006 The organiser must ensure that the following minimum training program is provided.

Three days before the final an on foot downhill course inspection period must be provided for the riders. The course must be fully marked and cordoned off. No bikes are allowed on the course during the on foot downhill course inspection.

Two days before the final a training period will be provided plus a timed training session exclusively for the following riders:

1. Men elite ranked in the top 60 of the last UCI World Cup standings,
2. Women elite ranked in the top 15 of the last UCI World Cup standings,
3. Men junior ranked in the top 10 of the last UCI World Cup standings,
4. Women junior ranked in the top 3 of the last UCI World Cup standings,
5. Plus any protected riders as per article 4.9.031 not included in points 1 to 4 above.

Riders with injury status shall be integrated in the start order in accordance with article 4.11.021.

For the first UCI World Cup round of the season, the timed training session will also be open to men junior ranked in the top 10 and women junior ranked in the top 3 of the final UCI World Cup standing of the previous season irrespective of whether they are currently men elite or 2nd year junior, as well as the previous year's junior UCI World Champions (men and women).

One day before the final a training period will be provided.

A training period that is reserved only for the riders qualified for the finals must be provided, on the day of the final. This training period must last for at least 60 minutes.

4.11.007 Riders must have completed 2 training runs before starting the qualifying round.

4.11.008 Riders who train on the course outside the specified training periods are disqualified from the event.

The transport system closes 15 minutes before the end of the training times. A closing rider needs to be supplied by the organiser to clear the course between training sessions under the instructions of the president of the commissaires' panel.

4.11.009 Two forerunners must be **designated and** be ready to run the course as indicated by the president of the commissaires' panel before the qualifying round and finals. The forerunners' bicycles must be fitted with handlebar numbers bearing the letters A and B.

The closing rider, according to article 4.11.008, must be fitted with the handlebar number bearing the letter C.

Forerunners must be at least aged 17 and a UCI license holder adequately insured.

Competition

4.11.010 The downhill competition must include **at minimum one a** qualifying round and a final.

The top 25 men juniors and top 10 women juniors from the qualifying round qualify for the final.

The top 60 men elite and top 15 women elite from the qualifying round qualify for the semi-final.

The top 30 men elite and top 10 women elite from the semi-finals qualify for the final.

If the final cannot take place due to unforeseen circumstances, the **last** qualifying round **to take place, including semi-final as the case may be,** determines the final result.

4.11.011 The start area is drawn up according article 4.3.009 and a covered warm-up area must be provided close to the start area for the riders. Details on the start area and the start rails are indicated in the world cup organizers guide.

4.11.012 Riders in the qualifying round must start at intervals of no less than 30 seconds. The intervals between the riders can be modified only by the president of the commissaires' panel upon consultation **with the UCI's appointee.**

4.11.013 **In the qualifying, semi-final and final rounds, riders** are awarded UCI World Cup **standing** points as per the scale in article 4.11.020. However, in the last round of the UCI World Cup season, no **standing** points for the qualifying **or semi-final rounds** will be given. The **standing and UCI points** will be awarded to the riders **according to their position in the final only, as per points scale in article 4.11.020. UCI points will be awarded to the qualifying rounds and final.**

No UCI World Cup points are awarded during the juniors qualifying rounds.

4.11.014 Protected riders to the **semi-final** are:

1. riders **with season long race numbers (i.e. ranked in the top 5 women elite and the top 10 men elite of the final UCI World Cup standings of the previous season)**
2. the best ranked riders from the current UCI World Cup standings, that are not included in point 1 above, until a total of 10 women elite and 20 men elite are reached
3. if any riders as described under 1. and 2. above do not confirm participation at an event they will not be replaced.

Protected riders to the final are:

1. **riders ranked in the top 3 women elite and top 5 men elite of the final UCI World Cup standings of the previous season**

2. men and women junior riders ranked in the top 3 of the current UCI World Cup standings. At the first UCI World Cup round of the season there will be no protected junior riders.
3. If a rider is announced as retired, he is not eligible anymore as protected rider. The announcement of the retired status shall be done in writing to the UCI before 31 December of the previous year.

For the first UCI World Cup round of the season, the top 10 women elite and the top 20 men elite of the final UCI World Cup standings of the previous season are “protected” for the semi-final.

They must start in the qualifying round but qualify automatically for the semi-final in any case. If the times of the protected riders are not among the 15 best times for women elite or the 60 best times for men elite, they shall be allowed to ride in the semi-final in addition to the 15 women elite and 60 men elite riders already qualified.

4.11.015 The start order for the semi-final, if applicable, and final will be determined on the basis of the reverse results of the last qualifying round (the fastest rider starting last), except for the protected riders (defined in art. 4.11.014) and the fastest 5 men elite and the fastest 2 women elite non-protected riders, who will start as the last group of riders by order of the last qualifying result, reversed.

4.11.016 Riders in the semi-final, if applicable, and final must start at intervals of no less than one minute. The last 10 riders must start at intervals of at least 2 minutes. The intervals between the riders can be modified only by the president of the commissaires’ panel upon consultation with the UCI’s appointee.

4.11.017 Official ceremony
The official ceremony takes place immediately after each race-involved. Riders arriving later than 5 minutes after they finished their race are fined.

The following riders must attend:

- the first five riders in the elite events;
- the leader of the elite UCI World Cup standings after the event in question;
- the first three riders in the juniors events;
- the leader of the juniors UCI World Cup standings after the event in question;
- the team leading the team standings after the event in question (specified in article 4.11.020);
- the team of the day.

Bicycles cannot be taken onto the podium. However, an area is provided in front of the podium to display the bicycle of the winner during the official ceremony.

4.11.018 UCI World Cup standings
The UCI World Cup standings are drawn up on the basis of the points won by each rider in accordance with the table in article 4.11.020.

Riders tying on points are ranked by the greatest number of 1st places, 2nd places, etc. (total points in the standings of the concerned round) taking account only of places for which points are awarded for the UCI World Cup. If they are still tied, the points scored in the most recent UCI World Cup event are used to separate them.

In the event of a tie on points in the downhill after the qualifying round and the final, the riders’ positions are determined by the result of the final.

4.11.019 A team standing is drawn up for each round of the UCI Downhill World Cup. Only riders registered in a **UCI ELITE MTB TEAM** or a **UCI MTB TEAM** can score points for their team in accordance with the team standing table in article 4.11.020.

For downhill, a mixed team classification is drawn up by summing the 3 highest scored points of each team without making a distinction between men elite, men juniors, women elite and women juniors. Only the results of the finals are taken into account. Teams with only one or two riders scoring points are also included in the team classification. Tied teams will have their relative positions determined by their best placed rider. Should there still be a tie, the order is determined as follows: best placed men elite, best placed women elite, best placed men juniors, best placed women juniors.

After each round of the UCI World Cup, the team standings is drawn up by adding the points won in the team classification per event. Ties are **separated** by the largest number of 1st places, 2nd places, etc. Should there still be a tie, the order is determined by the team classification for the most recent UCI World Cup round.

The riders of the team leading the team standings are given **leaders'** handlebar number plates which must be used during the world cup.

4.11.020 Points scale

A. Downhill men and women elite

N.B. – In accordance with article 4.11.013, in the last round of the UCI World Cup season, no point for the qualifying round and semi-final will be given.

Position	Men elite Qualification points	Men Elite Semi-Final points	Men Elite Final points	Women elite Qualification points	Women Elite Semi- Final points	Women Elite Final points
1	50	200	250	50	150	200
2	40	160	210	40	120	160
3	30	140	180	30	100	130
4	25	125	160	25	90	110
5	22	110	140	20	80	90
6	20	95	125	16	70	70
7	18	90	110	14	60	60
8	17	85	95	12	50	50
9	16	80	80	10	40	40
10	15	75	70	5	30	20
11	14	70	65		25	
12	13	65	60		20	
13	12	60	55		15	
14	11	55	50		10	
15	10	50	45		5	
16	9	45	40			
17	8	44	35			

UCI CYCLING REGULATIONS

18	7	43	30			
19	6	42	25			
20	5	41	20			
21		40	19			
22		39	18			
23		38	17			
24		37	16			
25		36	15			
26		35	14			
27		34	13			
28		33	12			
29		32	11			
30		31	10			
31		30				
32		29				
33		28				
34		27				
35		26				
36		25				
37		24				
38		23				
39		22				
40		21				
41		20				
42		19				
43		18				
44		17				
45		16				
46		15				
47		14				
48		13				
49		12				
50		11				
51		10				
52		9				
53		8				
54		7				
55		6				
56		5				
57		4				
58		3				
59		2				
60		1				

B. Downhill men and women juniors (finals only)

Position	Men juniors points	Women juniors points
1	60	60
2	50	50
3	45	45
4	40	40
5	35	35
6	30	30
7	28	25
8	26	15
9	24	10
10	22	5
11	20	
12	18	
13	16	
14	14	
15	12	
16	10	
17	9	
18	8	
19	7	
20	6	
21	5	
22	4	
23	3	
24	2	
25	1	

C. Team standing

Position	Men Elite points	Women Elite points	Men Juniors points	Women Juniors points
1	40	40	20	6
2	35	30	15	4
3	32	20	10	2
4	30	15	8	
5	28	10	6	
6	26	8	5	
7	24	6	4	
8	23	4	3	
9	22	2	2	
10	21	1	1	
11	20			
12	19			
13	18			
14	17			
15	16			
16	15			
17	14			
18	13			
19	12			
20	11			
21	10			
22	9			
23	8			
24	7			
25	6			
26	5			
27	4			
28	3			
29	2			
30	1			

§ 5
4.11.021

Injury status

If due to injury a rider took part in less than three rounds of the **UCI World Cup** in a season, the national federation or the team may apply for recognition of injury status. An application must be received **at the UCI** in writing no later than October 30th of the disrupted season.

A rider with injury status shall be integrated in the ranking that is used to determine the start list, with the number of points determined according to following calculation: the average points gained per round in which the rider took part multiplied by the number of rounds of the **UCI World Cup** season during which the rider was absent due to injury.

Such benefit shall be limited to the first round of the **UCI World Cup** in which the rider takes part during the following season.

This applies only for the DHI start order as per articles 4.11.004 and 4.11.006.

Chapter XII UCI MARATHON WORLD CUP

(Chapter reviewed on 1.01.23).

Participation

- 4.12.001** UCI Marathon **World Cup** events are open to riders following **these** conditions:
- having an annual licence issued by a national federation;
 - **there is no requirement in terms** of UCI points to participate;
 - unlimited participation for national federations or teams as riders can participate in their **UCI MTB TEAM jersey** or **regional** club jersey

Age category

- 4.12.002** The age category for the UCI Marathon **World Cup** is 19 years **or**. **Holders of elite licences or masters licences may participate.**

There are no separate **races or** results for under 23 **or** masters categories.

- 4.12.003** Top 20 men and women of each round of the UCI Marathon **World Cup** as well as the top **80** of the UCI **XCM individual** ranking obtain a qualification for the UCI Marathon World Championships.

- 4.12.004** UCI Marathon **World Cup** events include cross-country marathon (XCM) events as per article 4.2.004.

- 4.12.005** The **riders** start order is determined as follows:
1. Riders ranked in the top 24 of the most recently published UCI Marathon **World Cup** standing (not applicable for the first UCI Marathon **World Cup** round of the season)
 2. As per the most recently published UCI XCM individual ranking.
 3. As per the most recently published UCI XCO individual ranking.
 4. Unclassified riders: by drawing lots.

Official ceremony

- 4.12.006** **The official ceremony takes place immediately after each race ~~involved~~. Riders arriving later than 5 minutes after they finished their race are fined.**

The following riders must attend:

- the first three riders;
- the leader of the UCI World Cup standings after the event in question;

N.B. - Bicycles cannot be taken onto the podium. However, an area is provided in front of the podium to display the bicycle of the winner during the official ceremony.

UCI World Cup standings

- 4.12.007** The UCI World Cup standings are drawn up on the basis of the points won by each rider in accordance with the table in article 4.12.013.

For the sake of clarity, the UCI Marathon World Cup standings are drawn up by summing the points scored in the UCI Marathon World Cup events.

Riders tied on points are separated by the greatest number of 1st places, 2nd places, etc. (total points in the standings of the concerned UCI Marathon World Cup round) taking into account only the places for which points are awarded for the UCI Marathon

World Cup. If they are still tied, the points scored in the most recent UCI Marathon World Cup event are used to separate them.

4.12.008 Points scale:

Position	UCI Marathon World Cup points	Position	UCI Marathon World Cup points
1	250	31	44
2	200	32	42
3	160	33	40
4	150	34	38
5	140	35	36
6	130	36	34
7	120	37	32
8	110	38	30
9	100	39	29
10	95	40	28
11	90	41	27
12	85	42	26
13	80	43	25
14	78	44	24
15	76	45	23
16	74	46	22
17	72	47	21
18	70	48	20
19	68	49	19
20	66	50	18
21	64	51	17
22	62	52	16
23	60	53	15
24	58	54	14
25	56	55	13
26	54	56	12
27	52	57	11
28	50	58	10
29	48	59	9
30	46	60	8

Chapter XIII UCI ENDURO WORLD CUP

(Chapter introduced on 1.01.23).

- 4.13.001** The UCI Enduro World Cup is made up of events in the race types:
- Enduro
 - Enduro-E
- 4.13.002** UCI Enduro World Cup events must comply with the enduro rules set up in Chapter V.
- UCI Enduro-E World Cup events must comply with the E-Mountain Bike rules set up in Chapter VIII.
- 4.13.003** Participation
 UCI Enduro World Cup (Enduro and Enduro-E) events are open to riders following these conditions:
- Enduro World Series memberships and UCI licenses are mandatory for eligibility and event entry
 - In order to race in the UCI Enduro World Cup, riders must either be on an official UCI MTB ENDURO TEAM or have the minimum required number of Enduro World Series Global Ranking points
- 4.13.004** Age category
 The age category for the UCI Enduro World Cup is 17 years old or over. Holders of elite licences or masters licences may participate.
- 4.13.005** Specific rules for UCI Enduro World Cup are included in a dedicated UCI Enduro World Cup technical guide available on a dedicated website.
- 4.13.006** Specific rules for UCI MTB Enduro-E World Cup are included in a dedicated UCI MTB Enduro-E World Cup technical guide available on a dedicated website

Chapter XIV UCI E-MTB CROSS-COUNTRY WORLD CUP

(Chapter introduced on 1.01.23).

4.14.001 UCI E-MTB Cross-country World Cup events must comply with the E-Mountain Bike rules set up in Chapter VIII.

4.14.002 Participation
UCI E-MTB Cross-country World Cup events are open to riders following these conditions:

- UCI licenced athletes belonging to Elite Teams and Teams affiliated to World E-bike Series, as well as to wildcard applicants.
- Holders of daily licences issued by the national federation of the country of the event

4.14.003 Age category
E-Mountain Bike events are open to all riders aged 19 and over and include Masters categories. No separate results must be submitted for the Under 23, Elite or Masters categories.

4.14.004 Specific rules for UCI E-MTB Cross-country World Cup are included in a dedicated UCI E-MTB Cross-country World Cup technical guide available on a dedicated website.

Chapter XV UCI ELIMINATOR WORLD CUP

(Chapter introduced on 1.01.23).

4.15.001 UCI Eliminator World Cup events must comply with the Cross-country eliminator rules set up in articles 4.2.010 to 4.2.013.

Participation

4.15.002 UCI Eliminator World Cup events are open to riders following these conditions:

- having an annual licence issued by a national federation
- there is no requirement in terms of UCI points to participate
- unlimited participation for national federations or teams

Age category

4.15.003 The age category for the UCI Eliminator World Cup is 17 years old or over. No separate results must be submitted for the juniors, under 23 or elite categories.

4.15.004 Specific rules for UCI Eliminator World Cup are included in a dedicated UCI Eliminator World Cup technical guide available on a dedicated website

Chapter XVI UCI MOUNTAIN BIKE RANKING

(articles numbering reviewed on 1.01.23).

4.16.001 The UCI has created the UCI mountain bike ranking. The UCI is its exclusive owner.

The UCI mountain bike ranking is drawn up over a period of one year, in accordance with the conditions set out below, by adding the points won since the preceding ranking was drawn up, and respecting the provisions of article. 4.11.008. At the same time the remaining points obtained up to the same day of the previous year by each rider in international mountain bike races are deducted. The new ranking comes into force on the day of publication and stands until the publication of the subsequent ranking.

The UCI mountain bike ranking will take into account only one world championships and one continental championships for a defined format. The UCI points allocated for world championships and continental championships remain valid until the date they are organised again in the following year. If there is no continental championships registered on the calendar for a particular season, the validity of the UCI points shall stand for 12 months.

The UCI mountain bike ranking for XCO juniors is drawn up over a period of one year. For juniors only UCI points are allocated for XCO world championships, XCO continental championships, XCO juniors series races, XCO national championships and XCO juniors events. As from January 1st, the XCO juniors riders who change category to under 23 category will keep only the UCI points won during the XCO juniors world championships.

(text modified on 1.11.13; 4.04.14; 1.01.16; 1.01.17; 1.01.18; 1.01.23).

4.16.002 An individual ranking for men and one for women is drawn up for each of the following types of event:

- UCI XCO individual ranking (elite and under 23 combined)
- UCI XCO juniors individual ranking
- UCI XCM individual ranking
- UCI DHI individual ranking
- UCI 4X individual ranking

(text modified on 1.02.12; 1.01.21).

4.16.003 If an under 23 rider rides a cross-country Olympic event as an elite rider when a separate event is being organised for under 23 riders, as per Art. 4.1.004, he is awarded only the points as per the scale applicable to the elite event. UCI points for under 23 riders are only awarded where there is a separate event from that for elite riders.

(text modified on 1.02.12; 1.10.13; 4.04.14; 1.01.16).

4.16.004 Riders who are tied in the individual ranking have their positions decided by their ranking in the most recent event, in the following order:

- 1 world championships
- 2 world cup events
- 3 continental championships
- 4 national championships
- 5 hors class events
- 6 events in class 1
- 7 events in class 2
- 8 events in class 3

(text modified on 1.01.18; 1.01.21; 1.01.22; 1.01.23).

4.16.005 A ranking by nation for men and women is drawn up for cross-country Olympic and marathon. The ranking by nation is calculated by summing the points of three best placed riders from each nation.

The UCI points awarded for the team relay event at the world championships and continental championships are awarded to the nation in the elite ranking and not to the individual riders.

The UCI points awarded for the cross-country stage races are added to the cross-country marathon individual ranking.

A rider's points are awarded to the nation of his nationality, even if he is a licence-holder of the federation of another country.

Tied nations have their relative positions determined by the place of their best rider on the Individual ranking.
(text modified on 1.10.13. 1.01.21).

4.16.005 bis The Olympic Qualification Ranking which determines the qualification quota for the Olympic Games, is calculated for a specific Olympic Qualification Period using the ranking by nation as set in article 4.11.005 above. The Olympic Qualification Period is defined in the Olympic Games qualification system for mountain bike published on the UCI website when available.
(text modified on 1.01.18).

4.16.006 A UCI endurance team ranking is calculated by adding the points of the 3 best placed men and the 3 best placed women of each **UCI ELITE MTB TEAM** and **UCI MTB TEAM** in the UCI XCO individual ranking.

A UCI marathon team ranking is calculated by adding the points of the 3 best placed men and the 3 best placed women of each **UCI ELITE MTB TEAM** and **UCI MTB TEAM** in the UCI XCM individual ranking.

A UCI gravity team ranking is calculated using by adding the point of the 2 best placed DHI men, the best placed DHI woman, of each **UCI ELITE MTB TEAM** and **UCI MTB TEAM** in the concerned UCI individual ranking.

Tied teams have their relative positions determined by the place of their best rider on the individual ranking.
(text modified on 1.07.12; 1.01.17, 1.01.21; **1.01.23**).

4.16.007 The number of points to be awarded is shown in the annexes.

For the cross-country Olympic (XCO) ranking only the types of events that meet the criteria set out in articles 4.2.001, 4.2.002, 4.2.008, 4.2.010, 4.2.011 to 4.2.013 and 4.2.015 are eligible.

For the cross-country marathon (XCM) ranking only the types of events that meet the criteria set out in articles 4.2.004 and the general classification of stage races are eligible. No UCI point is awarded separately for the individual stages forming part of stage races.

The downhill ranking is based purely on individual downhill events including enduro events. All enduro, snow bike and pump track events will be considered as class 3 events.

The 4X ranking is calculated from 4X events.
(text modified on 1.02.12; 1.10.13; 1.01.16; 1.01.19, 1.01.21).

4.16.008 For events in the categories below, only the best results of each rider are taken into account:

- class HC one-day events: the best 5 results
 - class 1 one-day events: the best 5 results
 - class 2 one-day events: the best 5 results
 - class 3 one-day events: the best 5 results
 - stage races (SHC, S1 and S2): the best 3 results regardless the class (based on UCI points)
 - class XCO juniors series one-day events: the best 4 results
 - class XCO juniors one-day events: the best 4 results
- (text modified on 1.10.13; 1.01.16; 1.01.18).

4.16.009 Unless otherwise announced by the UCI, the UCI mountain bike rankings are updated weekly on Tuesday, and also on 31st December.
(text modified on 1.02.12, 1.01.21).

4.16.010 As set out in article 1.2.029, national mountain bike championships of cross-country Olympic (XCO) and cross-country Short Track (XCC) shall be run on the 29th weekend of the year until 2024 and the third weekend of July starting from 2025 (mandatory date). The UCI may grant dispensations for the southern hemisphere or in cases of force majeure.

Concerning the calculation of the UCI rankings, the national championships of cross-country Olympic (XCO) or cross-country short track (XCC) run before or after the mandatory date shall be considered as being run on the mandatory date.

For all other national mountain bike championship formats, the UCI points allocated shall remain valid until the next national championships or for a maximum of 12 months if no national championships are organised.

(article introduced on 1.02.12; 1.01.16; 1.01.22).

Chapter XVII MASTERS WORLD CHAMPIONSHIPS

(articles numbering reviewed on 1.01.23).

- 4.17.001** Only licence holders under articles 1.1.001 to 1.1.028 and 4.1.009 to 4.1.010 may take part in the masters world championships. A race number is only issued on presentation of the licence.
(text modified on 4.04.14)
- 4.17.002** The riders taking part in the masters world championships represent their country, but are permitted to use the equipment of their choice.
- 4.17.003** All details specifically relating to the masters world championships must be obtained directly from the organiser or from the UCI web site.
- 4.17.004** The championships are usually organised in 5 year age groups: 35-39, 40-44, etc. Age groups will be combined when less than 6 riders enter an age group. In case of combined age groups titles for the respective 5 years age groups will be awarded (even when only 1 rider is entered).
(text modified on 4.04.14; 1.01.20)

Chapter XVIII UCI ELITE MTB TEAMS

(Chapter revised on 1.01.23).

§ 1 Identity

- 4.18.001** A **UCI ELITE MTB TEAM** is an entity consisting of:
- minimum 3 riders, maximum 10 riders for cross-country (**endurance**);
 - minimum 2 riders, maximum 10 riders for downhill (**gravity**);
 - **minimum 2 riders, maximum 10 riders for enduro**;
 - minimum 3 riders, maximum 10 riders for mixed teams.

They are employed and/or sponsored by the same entity, for the purpose to take part in mountain bike events on the International UCI calendar.

Temporary replacement riders

UCI ELITE MTB TEAMS can apply to the UCI to replace a rider that is unable to compete at a UCI World Cup on medical grounds. The rider needs to be a UCI registered rider and must compete in the same format and category as the rider they are temporarily replacing. They must race in the same clothing of the **UCI ELITE MTB TEAM** they will be riding for. This can be done outside the transfer period.

In addition, a **UCI ELITE MTB TEAM** will have the opportunity to request to the UCI for 1 rider to be able to race at a single UCI World Cup event within the season in either Elite, Junior or under 23 categories. This can be done outside the transfer period.

- 4.18.001bis** Conditions for application for **UCI ELITE MTB TEAMS**:
- Teams may apply for registration as a **UCI ELITE MTB CROSS-COUNTRY TEAM** if the team is ranked with a total point of 75 in the UCI endurance team ranking calculated as per article 4.18.002.
 - Teams may apply for registration as a **UCI ELITE MTB DOWNHILL TEAM** if the team is ranked with 1 point in the gravity team ranking calculated as per article 4.18.002.
 - Teams may apply for registration as a **UCI ELITE MTB ENDURO TEAM** if the team is ranked with 1 point in the enduro team ranking calculated as per article 4.18.002.

Application

- 4.18.002** A maximum of 15 **UCI ELITE MTB TEAMS** (per format cross-country, downhill and enduro) are recognized, on the basis of the **UCI MTB TEAM** rankings set out as per below:

- For the UCI endurance team ranking, the riders individual UCI points in the first UCI individual ranking of the season calculated as per article 4.16.006 will be used to determine the **UCI ELITE MTB CROSS-COUNTRY TEAM** status.
- For the UCI team ranking, the final individual **DHI UCI** World Cup standings of the previous year and the **DHI UCI** World Championships results by attributing points as per the table below will be used to determine the **UCI ELITE MTB DOWNHILL TEAM** status.

	UCI World Cup final individual standings / UCI World Championships results
--	--

UCI CYCLING REGULATIONS

Position	Men Elite	Women Elite	Men Junior	Women Junior
1	100	100	50	10
2	80	80	40	9
3	70	70	38	8
4	60	60	36	7
5	57	57	34	6
6	55	55	32	5
7	54	54	30	4
8	53	53	28	3
9	52	52	26	2
10	51	51	24	1
11	50	50	22	
12	49	49	20	
13	48	48	18	
14	47	47	14	
15	46	46	12	
16	45	40	10	
17	44	35	9	
18	43	30	8	
19	42	25	7	
20	41	20	6	
21	40	15	5	
22	39	10	4	
23	38	5	3	
24	37	3	2	
25	36	1	1	
26	35			
27	34			
28	33			
29	32			
30	31			
31	30			
32	29			
33	28			
34	27			
35	26			
36	25			
37	24			
38	23			
39	22			
40	21			
41	20			
42	19			
43	18			
44	17			
45	16			

46	15			
47	14			
48	13			
49	12			
50	11			
51	10			
52	9			
53	8			
54	7			
55	6			
56	5			
57	4			
58	3			
59	2			
60	1			

Tied **UCI MTB GRAVITY TEAMS** have their positions determined by the place of their best rider in the final individual world cup standings of the previous year.

- The ranking for **UCI MTB ENDURO TEAMS** will be calculated using the best three riders' results at each UCI Enduro World Cup round in the previous season to determine the **UCI ELITE MTB TEAM** status for enduro.

Three (3) weekends after the **UCI MTB TEAM** registration deadline (as defined in article 4.19.011) the UCI will release the above teams ranking linked to the new team composition.

The top 15 ranked teams in the **UCI MTB TEAM** rankings are offered the opportunity to register as a **UCI ELITE MTB TEAM**. If these teams decline the opportunity, then the invitation is offered to the next team in the **UCI MTB TEAM** ranking. Invitations are only extended to teams ranked in the top 20.

Wild cards

A maximum of five wild card invitations to be granted **UCI ELITE MTB TEAM** status can be issued at the discretion of the UCI during the registration process.

4.18.003 A **UCI ELITE MTB TEAM** comprises of all the riders employed by the same paying agent, the paying agent itself, the sponsors and all the other persons contracted by the paying agent and/or the sponsors for the functioning of the team (team manager, coach, soigneur, mechanic, etc.). It must be designated by a specific name and registered with the UCI as provided in these regulations.

4.18.004 The sponsors are individuals or incorporated bodies who contribute to the funding of the **UCI ELITE MTB TEAM**. Among the sponsors, a maximum of two are designated as the principal partners of the **UCI ELITE MTB TEAM**. If neither of the two principal partners is the paying agent for the team, this paying agent may only be an individual or incorporated body whose sole trading income comes from advertising.

4.18.005 The principal partner(s) and the paying agent commit themselves to the **UCI ELITE MTB TEAM** for a whole number of calendar years.

4.18.006 The name of the **UCI ELITE MTB TEAM** must be that of the company or brand name of the principal partner or that of one of both of the two principal partners.

4.18.007 No two **UCI ELITE MTB TEAMS**, their principal partners or paying agents, may bear the same name. Should application for a new and identical name be simultaneously made by two or more teams, priority is given to the team which has used the name for the longest time.

4.18.008 The nationality of the **UCI ELITE MTB TEAM** must be that of the country where the head office or the domicile of the paying agent is located.

§ 2 Legal and financial status

4.18.009 The paying agent in a **UCI ELITE MTB TEAM** must be a physical person or incorporated body legally entitled to employ personnel.

§ 3 Registration

4.18.010 Each year **UCI ELITE MTB TEAMS** must register for the subsequent year directly with the International Cycling Union.

4.18.011 **UCI ELITE MTB TEAMS** must register their riders at the same time.

4.18.012 **UCI ELITE MTB TEAMS** must submit their application for registration no later than 15 January of the registration year in question. No application received by the UCI after 15 January is considered.

When applying for registration, **UCI ELITE MTB TEAMS** must indicate:

- 1 the exact name of the team;
- 2 address details (including telephone number, email address and fax number) to which all communications to the **UCI ELITE MTB TEAM** can be sent;
- 3 the names and addresses of the principal partners, the paying agent, the manager, the team manager, the assistant team manager, the mechanics and other licence-holders;
- 4 the surnames, first names, addresses, nationalities and dates of birth of the riders, the dates and numbers of their licences and the authority that issued them, or a copy of both sides of the licence;
- 5 a copy of the riders' contracts in accordance with article 4.18.020 must be included.
(text modified on 1.07.12).

4.18.013 Article 4.18.012 also applies to any changes to the riders and other staff for **UCI ELITE MTB TEAMS**.

Such changes are immediately submitted by the **UCI ELITE MTB TEAMS** to the UCI. During the season, no rider already registered with a **UCI ELITE MTB TEAM** or **UCI MTB TEAM** for the current season may join another **UCI ELITE MTB TEAM** or **UCI MTB TEAM** outside the transfer period as in the team benefits document sent at registration confirmation unless approved as a replacement or additional rider (article 4.18.001)

During the season, a rider who is not registered in another team can be added to a **UCI ELITE MTB TEAM** or **UCI MTB TEAM** only during the transfer period as specified in the team benefits document sent at registration confirmation.

4.18.014 Only **UCI ELITE MTB TEAMS** on the list approved by the UCI may receive benefits.

4.18.015 By their annual registration, **UCI ELITE MTB TEAMS** and inter alia their paying agents and sponsors undertake to respect the Constitution and Regulations of the UCI and their respective National Federation and to participate in cycling events in a fair and sporting manner. The paying agent and principal partners are held jointly and severally liable for all the financial commitments of the **UCI ELITE MTB TEAM** to the UCI and the National Federations, including any fines.

4.18.016 The registration of the **UCI ELITE MTB TEAM** with the UCI involves a registration fee that the team must pay by 15 January of the year of registration. The amount is set annually by the UCI. After the publication of the UCI team rankings, as per art 4.18.002, the **UCI ELITE MTB TEAM** have to pay their remaining fee.

4.18.017 When submitting their registration, each **UCI ELITE MTB TEAM** must submit a colour graphic design of their Team race outfit, complete with sponsor logos.

All riders within a team are obliged to wear clothing that has identical major sponsor placement, identical color scheme, layout and identical overall look, although the colours of men and women's outfit can be different. In this case two designs must be submitted.

The rule is not applicable for **UCI ELITE MTB DOWNHILL TEAMS**.

4.18.018 **UCI ELITE MTB TEAMS** have the obligation to participate with minimum 1 rider at all UCI World Cup events. If this is not the case the **UCI ELITE MTB TEAM** status is removed immediately and the team is not able to register as a **UCI ELITE MTB TEAM** for the following season. In this case there is no refund of the registration fees.

§ 4 Contract of Employment

4.18.019 A rider's membership of a **UCI ELITE MTB TEAM** requires a written contract of employment to be concluded which must contain as a minimum the provisions of the standard contract in article 4.18.026.

The contract must also make provision for the payment of indemnities to the rider in the event of sickness and/or accident.

4.18.020 Any clause agreed between the rider and the paying agent that impinges on the rights of riders as provided for in the standard contract or the joint agreements is null and void.

4.18.021 Any contract between a team and a rider must be drawn up in duplicate at least. One scan copy must be forwarded to the UCI with exact financial amounts for salary and bonus payments. The confidentiality of these data is ensured.

4.18.022 On the expiry of the term of the contract, the rider is free to enter the service of another paying agent. No system of transfer fees are permitted.

Before the expiry date of the contract, transfers of riders are only permitted if a global agreement in writing is reached between the three parties concerned: the rider, his current paying agent and the new paying agent, and with the preliminary authorisation of the UCI.

§ 5 Dissolution of a team

- 4.18.023** A team must announce its dissolution or the cessation of its activity or its inability to respect its obligations, at the earliest opportunity. Once this announcement has been made, riders are fully entitled to contract with another Team for the following season or for the period starting at the moment announced for the dissolution, the end of activities or the inability to perform.

§ 6 Penalties

- 4.18.024** Should a team, as a whole, fail or cease to meet all the conditions of the relevant UCI regulations, it may no longer participate in cycling events.

§ 7 Model contract between a rider and a UCI ELITE MTB TEAM

- 4.18.025** The UCI model contract between a rider and a UCI ELITE MTB TEAM can be found in annex 1 to these regulations.

Chapter XIX UCI MTB TEAMS

(Chapter revised on 1.01.23).

§ 1 Identity

4.19.001 A **UCI MTB TEAM** is an entity consisting of:

- minimum 3 riders, maximum 10 riders for cross-country (**endurance**);
- minimum 3 riders, maximum 10 riders for cross-country marathon;
- minimum 2 riders, maximum 10 riders for downhill (**gravity**);
- **minimum 2 riders, maximum 10 riders for enduro teams.**
- minimum 3 riders, maximum 10 riders for mixed teams.

They are employed and/or sponsored by the same entity, for the purpose to take part in mountain bike events on the International UCI calendar.

4.19.001bis **Conditions for application for UCI MTB TEAMS:**

- Teams **may** apply for registration **as a UCI MTB CROSS-COUNTRY TEAM**, only if the team is ranked with a total point of 75 in the endurance team ranking calculated as per article 4.18.002.
- **Teams may apply for registration as a UCI MTB MARATHON TEAM** according to article 4.19.001.
- **Teams may apply for registration as a UCI MTB DOWNHILL TEAM** if the team is ranked with 1 point in the gravity team ranking calculated as per article 4.18.002.
- **Teams may apply for registration as a UCI MTB ENDURO TEAM** according to article 4.19.001.

4.19.002 A **UCI MTB TEAM** comprises all the riders employed by the same paying agent, the paying agent itself, the sponsors and all the other persons contracted by the paying agent and/or the sponsors for the functioning of the team (team manager, coach, soigneur, mechanic, etc.). It must be designated by a specific name and be registered with the UCI as provided in these regulations.

4.19.003 The sponsors are individuals or incorporated bodies who contribute to the funding of the **UCI MTB TEAM**. Among the sponsors, a maximum of two are designated as the principal partners of the **UCI MTB TEAM**. If neither of the two principal partners is the paying agent for the team, this paying agent may only be an individual or incorporated body whose sole trading income comes from advertising.

4.19.004 The principal partner(s) and the paying agent commit themselves to the **UCI MTB TEAM** for a whole number of calendar years.

4.19.005 The name of the **UCI MTB TEAM** must be that of the company or brand name of the principal partner or that of one of both of the two principal partners.

4.19.006 No two **UCI MTB TEAMS**, their principal partners or paying agents, may bear the same name. Should application for a new and identical name be simultaneously made by two or more Teams, priority is given to the Team which has used the name for the longer or longest time.

4.19.007 The nationality of the **UCI MTB TEAM** must be that of the country where the head office or the domicile of the paying agent is located. The national federation of the country of

which the team has the nationality must validate the team registration in the UCI DataRide Team Registration platform. Such a validation recognises the **UCI MTB TEAM** as being of that Federation's nationality and support its registration with the UCI under the terms of these regulations.

(text modified on 1.01.22)

§ 2 Legal and financial status

- 4.19.008** The paying agent in a **UCI MTB TEAM** must be a physical person or incorporated body legally entitled to employ personnel.

§ 3 Registration

- 4.19.009** Each year **UCI MTB TEAMS** must register for the subsequent year with the Union Cycliste Internationale.

- 4.19.010** **UCI MTB TEAMS** must register their riders at the same time.

- 4.19.011** **UCI MTB TEAMS** must submit their application for registration no later than 15 January of the year in question. No application first received by the UCI after 15 January is considered.

When applying for registration, **UCI MTB TEAMS** must indicate:

- 1 the exact name of the team;
- 2 address details (including telephone number, email address and fax number) to which all communications to the **UCI MTB TEAM** can be sent;
- 3 the names and addresses of the principal partners, the paying agent, the manager, the team manager, the assistant team manager, the mechanics and other licence-holders;
- 4 the surnames, first names, addresses, nationalities and dates of birth of the riders, the dates and numbers of their licences and the authority that issued them, or a copy of both sides of the licence;
- 5 a copy of the riders' contracts in accordance with article 4.14.018 must be included.

(text modified on 1.07.12).

- 4.19.012** Article 4.19.011 also applies to any changes to the riders and other staff for **UCI MTB TEAMS**.

Such changes must be immediately submitted by the **UCI MTB TEAMS** to the UCI. During the season, no rider already registered with a **UCI ELITE MTB TEAM** or **UCI MTB TEAM** for the current season may join another **UCI ELITE MTB TEAM** or **UCI MTB TEAM** outside the transfer period as specified in the team registration form.

During the season, a rider can be added to a **UCI ELITE MTB TEAM** or **UCI MTB TEAM** only during the transfer period as specified in the team benefits document sent at registration confirmation

- 4.19.013** Only **UCI MTB TEAMS** on the list approved by the UCI may receive benefits such as those listed in article 4.14.017.

- 4.19.014** By their annual registration, **UCI MTB TEAMS** and inter alia their paying agents and sponsors undertake to respect the constitution and regulations of the UCI and their respective national federation and to participate in cycling events in a fair and sporting manner. The paying agent and principal partners are held jointly and severally liable for all the financial commitments of the **UCI MTB TEAM** to the UCI and the national federations, including any fines.

4.19.015 The registration of the **UCI MTB TEAM** with the UCI involves a registration fee that the team must pay by 15 January of the **registration** year. The amount is set annually by the UCI.

4.19.016 When submitting their registration, each **UCI MTB TEAM** must submit a colour graphic design of their Team jersey, complete with sponsor logos.

All riders within a team are obliged to wear clothing that has identical major sponsor placement, identical color scheme, layout and identical overall look, although the colours of men and women's outfit can be different. In this case two designs must be submitted.

The rule is not applicable for **MTB DOWNHILL TEAMS**.

§ 4 Contract of employment

4.19.017 A rider's membership of a **UCI MTB TEAM** requires a written contract of employment to be concluded which must contain as a minimum the provisions of the standard contract in Article 4.19.024.

The contract must also make provision for the payment of indemnities to the rider in the event of sickness and/or accident.

4.19.018 Any clause agreed between the rider and the paying agent that impinges on the rights of riders as provided for in the standard contract or the joint agreements is null and void.

4.19.019 Any contract between a team and a rider must be drawn up in duplicate at least. One scan copy must be forwarded to the UCI with exact financial amounts for salary and bonus payments. The confidentiality of these data is ensured.

4.19.020 On the expiry of the term of the contract, the rider is free to enter the service of another paying agent. No system of transfer fees are permitted.

Before the expiry date of the contract, transfers of riders are only permitted if a global agreement in writing is reached between the three parties concerned: the rider, his current paying agent and the new paying agent, and with the authorisation of the UCI.

§ 5 Dissolution of a team

4.19.021 A team must announce its dissolution or the cessation of its activity or its inability to respect its obligations, at the earliest opportunity. Once this announcement has been made, riders are fully entitled to contract with another team for the following season or for the period starting at the moment announced for the dissolution, the end of activities or the inability to perform.

§ 6 Penalties

4.19.022 Should a team, as a whole, fail or cease to meet all the conditions of the relevant UCI regulations, it may no longer participate in cycling events.

§ 7 Model contract between a rider and a **UCI MTB TEAM**

- 4.19.023** The UCI model contract between a rider and a **UCI MTB TEAM** can be found in annex 1 to these regulations.

Chapter XX MTB RACE INCIDENTS TABLE

(chapter introduced on 1.01.20; *chapter revised on 1.01.23*).

100.4.01 Table of race incidents in accordance with article 12.4.001

Discipline	Event	
Mountain Bike	Elite World Championships Olympic Games World Cup	Other events
Race incidents		
1. Bicycle		
1.1. Appearance at the start of a race or stage with a bicycle that does not comply with the regulations	Start refused	Start refused
1.2. Use of a bicycle that does not comply with the regulations in a race	Disqualification (DSQ)	Disqualification (DSQ)
1.3. Use or presence of a bicycle that does not comply with article 1.3.010 (cf. art. 12.4.003)	Rider: disqualification (DSQ)	Rider: disqualification (DSQ)
2. Clothing, helmet and accessories		
2.1 Presentation at the start with non-compliant clothing (art. 1.3.033)	Start refused	Start refused
2.2 Use of non-compliant clothing during an event (art. 1.3.033)	Disqualification (DSQ)	Disqualification (DSQ)
2.3 Rider at the start without mandatory helmet	Start refused	Start refused
2.4 Start with damaged or no regular helmet	Start refused	Start refused
2.5 Rider taking off mandatory helmet during the race	Disqualification (DSQ)	Disqualification (DSQ)
2.6 Use of forbidden onboard technology device	<u>Rider:</u> Elimination or disqualification	<u>Rider:</u> Elimination or disqualification

UCI CYCLING REGULATIONS

	<u>Other team member:</u> Exclusion	<u>Other team member:</u> Exclusion
3. Body number, shoulder number, bicycle number or frame number modified or not positioned in accordance with the regulations		
ONE-DAY RACE	Rider: 50 fine	Rider: 30 fine
STAGE RACE	1 st offence: 50 fine 2 nd offence: 200 fine 3 rd offence: elimination	1 st offence: 30 fine 2 nd offence: 50 fine 3 rd offence: elimination
4. Deliberate deviation from the race route, attempting to be placed without having covered the entire race route by bicycle	Rider: 200 fine Rider: 200 fine and elimination	Rider: 100 fine and elimination
5. Unintentional detour from the race route constituting an advantage		
ONE-DAY RACE	Elimination	Elimination
STAGE RACE		Time trial: 20'' penalty Relegation (REL) to last place of the stage
6. Failure to respect the instructions of the race organisation or commissaires	Rider: 30 to 100 fine Other licence holder: 100 to 200 fine	Rider: 20 to 100 fine Other licence holder: 50 to 200 fine
7. Recrossing the finish line in the direction of the race while still wearing a body number and/or transponder (chip)	Rider: 30 fine	Rider: warning
8. Irregular assistance		
8.1 Feeding outside the Feed/Technical Assistance Zone		
ONE-DAY RACE	Disqualification (DSQ) and 100 fine licence holder	Disqualification (DSQ) and 50 fine licence holder

UCI CYCLING REGULATIONS

STAGE RACE		1' penalisation in the stage results rider
8.2 Licence holder running in the Feed/Technical Assistance Zone		
ONE-DAY RACE	1 st offence: warning 2 nd offence: TM pass withdrawal and 50 fine	1 st offence: warning 2 nd offence: TM pass withdrawal
STAGE RACE		1 st offence warning 2 nd offence TM pass withdrawal and 30" penalisation rider
8.3 Spraying water on riders or bicycles 8.4 Irregular mechanic assistance	1 st offence: official warning 2 nd offense 50 fine	1 st offence: official warning 2 nd offense 50 fine
ONE-DAY RACE	Disqualification (DSQ) and 100 fine mechanic	Disqualification (DSQ) and 50 fine mechanic
STAGE RACE		1 st offence 1' penalisation in stage results rider and 50 fine mechanic 2 nd offence disqualification (DSQ) rider and 100 fine mechanic
9. Rider turn back on the course to reach Feed/Technical Assistance Zone	Disqualification (DSQ)	Disqualification (DSQ)
10. Rider failing to respect the rules for the start	100 fine	50 fine
11. Use of a means of communication	Start refused or disqualification (DSQ) (if find during the race)	Start refused or disqualification (DSQ) (if find during the race)
12. Delayed or lapped rider continuing the race in breach of the regulations	Disqualification (DSQ)	Disqualification (DSQ)
13. Rider fails to return to the course as in art 4.1.035	Disqualification (DSQ)	Disqualification (DSQ)
14. Failure to display handlebar number during training	100 fine rider 200 fine team	50 fine rider 100 fine team

UCI CYCLING REGULATIONS

15. Identification frame number modified	100 fine	50 fine
16. Alter the course	Disqualification (DSQ) – accreditation removed	Disqualification (DSQ) – accreditation removed
17. Passing through a level crossing that is closed	Disqualification (DSQ)	Disqualification (DSQ)
18. Irregular sprint		
ONE-DAY RACE	Relegation (REL) to the last place in the rider's group or Disqualification (DSQ) at sole discretion of the commissaires' panel in case of serious cases	Relegation (REL) to the last place in the rider's group or Disqualification (DSQ) at sole discretion of the commissaires' panel in case of serious cases
STAGE RACE		1 st offence Relegation REL and 30" penalisation in the stage results. 2 nd offence Disqualification (DSQ)
19. Training outside training time during the event and when course stated as "closed" on the event schedule		
ONE-DAY RACE	1 st offence: 50 fine 2 nd offence: Start refused	1 st offence: 50 fine 2 nd offence: Start refused
STAGE RACE		1 st offence 30" penalisation in the stage results 2 nd offence 1' penalisation in the stage results
20. Cutting the course – short cut		
ONE-DAY RACE	Disqualification (DSQ) or relegation (REL) depending on the length of the cut	Disqualification (DSQ) or relegation (REL) depending on the length of the cut
STAGE RACE		2'-5' penalisation in the stage results (or a time major to the gained advantage)
21. Failure to wear the race leader's jersey		

UCI CYCLING REGULATIONS

ONE-DAY RACE	1 st offence 250 fine 2 nd offence start refused and 500 fine	1 st offence 100 fine 2 nd offence start refused and 100 fine
STAGE RACE		1 st offence 30''penalisation in stage results 2 nd offence start refused
22. Failing to attend official ceremonies	500 fine	100 fine
23. Non-compliant clothing during podium ceremony	500 fine	100 fine
24. Insult, threats, inappropriate behaviour	Any licence holder 50 to 200 fine	Any licence holder 50 to 200 fine
25. Act of violence 25.1 Among riders		
ONE-DAY RACE	200 fine	100 fine
STAGE RACE		100 fine plus 1' penalisation
25.2 Towards any other person		
ONE-DAY RACE	Rider Disqualification (DSQ) + 200 fine	Rider Disqualification (DSQ) + 100 fine Other licence holder 1000 fine
STAGE RACE		Rider Disqualification (DSQ) + 100 fine Other licence holder 1000 fine
26. SPECIFIC ON DOWN HILL EVENTS 26.1 Rider no completing at least 2 training runs 26.2 Start training run below the start line 26.3 Rider no wearing protections imposed by the national federation	Disqualification (DSQ) Disqualification (DSQ) Start refused	Disqualification (DSQ) Disqualification (DSQ) Start refused
27. SPECIFIC ON ENDURO EVENTS 27.1 Rider without bike mark at the finish 27.2 Deliberate obstruction of the fastest rider	Not applicable	1' penalization 1' penalisation
28. Late entries	UCI World Cup cross-country, cross-country short track, cross-country marathon, downhill and enduro: EUR 300	N/A

(text modified on 1.01.00; 1.01.02; 1.01.03; 5.05.03; 1.01.04; 1.01.05; 1.01.06; 1.01.07; 1.01.09; 1.07.10; 1.10.10; 1.07.11; 1.10.11; 1.10.13; 7.03.14; 16.06.14; 1.01.15; 1.07.15; 1.01.16; 1.01.17; 1.07.17; 1.01.19; 1.01.20; 10.06.21; 1.01.23)

ANNEX 1 - Model contract between a rider and a **UCI MTB TEAM**

Between the undersigned,
(name and address of the paying agent)
paying agent for the **UCI ELITE MTB TEAM** or **UCI MTB TEAM** (name of the team),
affiliated to the (name of the national federation) and whose principal partners are:

1. (name and address) (where applicable, the paying agent itself)
2. (name and address)

hereinafter "the paying agent"

ON ONE PART

and: (name and address of the rider)

born at on (date)
of nationality
holding a licence issued by
hereinafter "the rider"

ON THE OTHER PART

Where as:

- the paying agent employs a team of cyclists who participate as members of the **UCI ELITE MTB TEAM** / **UCI MTB TEAM**.... (team name) under the management of Mr. (name of the general manager or team manager) in mountain bike races governed by the regulations of the International Cycling Union;
- the rider wishes to join the..... (name of the team);
- both parties are acquainted with and declare that they abide wholly by the UCI constitution and regulations, and those of its affiliated national federation.

It is agreed as follows:

ARTICLE 1 - Engagement

The paying agent hereby engages the rider, and the rider agrees to be engaged as a mountain bike rider.

Participation by the rider in events in other disciplines is decided by the parties case by case.

ARTICLE 2 - Duration

The present contract is concluded for a fixed period commencing on.... and expiring on....

ARTICLE 3 - Remuneration / reimbursement of expenses

a) Paid rider

The rider is entitled to an annual gross salary of.... This remuneration may not be lower than the legal minimum wage or, where there is no legal minimum, than the usual salary that is paid or has to be paid to full-time workers employed in the country whose national federation issued the rider's licence or in the country where the team has its head office, whichever is the higher.

If the duration of that contract is to be less than one year, the rider must, over that period, earn at least the full annual salary provided for in the preceding paragraph, less the salary that he earned as a rider with some other employer in the course of the same year.

This provision does not apply if the present contract is extended.

b) Unpaid rider

The rider receives no wages or remuneration but receives expenses as per the scale below for the activities carried out for the team and/or at its request:

(Suggestions, examples ➡)

- (currency and amount) per kilometre travelled;
- reimbursement of air tickets for distances greater than (number) km;
- reimbursement of the cost of a 2-star hotel room for the nights before and after the event if the competition venue is more than (number) km from the rider's home;
- on presentation of receipts, reimbursement for all meals taken during travel up to a maximum price of (currency and total amount) per meal;
- on presentation of invoices, reimbursement for minor mechanical expenses (tyres, brakes, cables, lubrication, adjustments, etc.) to a maximum total amount of (currency and total amount) per year.

ARTICLE 4 - Payment of salary / reimbursement of expenses

a) Paid rider

1. The paying agent must pay the salary referred to in article 3 above in at least four instalments, no later than the last working day of each three-month period.
2. Should the rider be suspended under the terms of the UCI regulations or those of one of its affiliated federations, he is not entitled to the said remuneration referred to in article 3 for the part of the suspension exceeding one month.
3. In the event of failure to make payment of the remuneration referred to in article 3, the rider is, without summoning the employer to make payment, fully entitled to an extra benefit of 5% interest per year.

b) Unpaid rider

1. The team must pay the sums specified in article 3 no later than the last working day of each month as long as it has received the expenses claim from the rider before the 20th of that month.
2. In the event of a failure to make payment of any sum by its due date, the rider has the right, without notice, to the interest and supplements commonly applied in that country.

Any sum due to the rider from the team must be paid by transfer to the rider's bank account no (number) at the (name of the bank) at (branch where the account is held). Only the proof of the execution of the bank transfer is accepted as proof of payment.

ARTICLE 5 - Insurance

In the event of illness or accident affecting the rider's ability to meet his contractual obligations, the rider benefits from the insurance cover specified in the annexes to this contract.

ARTICLE 6 - Primes and prizes

The rider is entitled to primes and prizes won during cycling competitions in which he/she rode for the team, in accordance with the regulations of the UCI and its affiliated federations. Primes and prizes must be paid as promptly as possible, but at latest on the last working day of the month following that in which said primes and prizes were won.

ARTICLE 7 - Miscellaneous obligations

1. The rider may not, for the duration of the present contract, work for any other team or advertise for any other sponsors than those belonging to the (name of team), except in such cases as are provided for in the Regulations of the UCI and of its affiliated federation.
2. The paying agent undertakes to allow the rider to exercise his activity properly by providing the equipment and clothing required and allowing him to take part in an adequate number of cycling events, either as part of a team or individually.
3. The rider may not compete in a race as an individual without the express consent of the paying agent. The paying agent is deemed to have given its agreement if it has not replied

within a period of ten days from the date of the request. In no case may the rider take part in a race within any other structure or a mixed team if the (name of the team) has already entered for that race.

In the event of selection for a national team, the paying agent is required to permit the rider to participate in such races and preparatory programmes as may be determined by the national federation. The paying agent must authorise the national federation, acting on its own behalf, to give to the rider any instructions of a purely sporting nature that it deems necessary in the context of and for the duration of the selection.

In none of the aforementioned cases, the present contract is suspended.

ARTICLE 8 - Transfers

On the expiry of the present contract, the rider is entirely free to sign a new contract with some other employer, subject to the provisions of the UCI regulations.

ARTICLE 9 - End of contract

Without prejudice to the legislation governing the present contract, it may be terminated before expiry, in the following cases and on the following conditions:

1. The rider may terminate the present contract, without notice or liability for damages:
 - (a) if the paying agent is declared bankrupt, insolvent or goes into liquidation.
 - (b) if the paying agent or a principal partner withdraws from the team and the continuity of the team is not guaranteed or else if the team announces its dissolution, the winding up of its activities or its inability to meet its commitments; if the announcement is made for a given date, the rider must perform the contract until that date.
2. The paying agent may terminate the present contract, without notice or liability for damages, in the event of serious misconduct on the part of the rider or of the suspension of the rider under the terms of the UCI Regulations for the remaining duration of the present contract. Serious misconduct is considered to include refusal to ride cycle races, despite being repeatedly called on to do so by the paying agent.
3. Either party is entitled to terminate the present contract, without notice or liability, notably in case the rider is rendered permanently unable to exercise the occupation of professional cyclist.

ARTICLE 10 - Defeasance

Any clause agreed upon between the parties that runs counter to the terms of the model contract between a rider and a team and/or to the provisions of the UCI constitution or regulations and which would in any way restrict the rights of the rider is null and void.

ARTICLE 11 - Arbitration

Any dispute between the parties arising from the present contract must be submitted to arbitration and must not be brought before any court. It must be settled in accordance with the regulations of the UCI through the UCI arbitral board or, failing this, according to the regulations of the national federation to which the rider belongs or, failing this, the legislation governing this contract.

Made in _____ on _____

In as many copies as required by the legislation applicable to the present contract, that is to say,..... plus one copy to be sent to the UCI.

The rider

The paying agent

Legal representative (for juniors riders)

ANNEX 2 - UCI MTB XCO points

	JO OG		CHAMPIONNATS DU MONDE WORLD CHAMPIONSHIPS					COUPE DU MONDE WORLD CUP		CHAMP. CONTINENTAUX CONTINENTAL CHAMP.			
Rang / Place	Elite H	Elite F	Elite	U23*	Junior	XCE	Team Relay***	Elite	U23	Elite	U23*	Junior	Team Relay***
1	300	300	300	200	200	110	200	250	125	150	75	60	100
2	250	250	250	150	150	90	150	200	100	120	55	40	75
3	200	200	200	120	120	80	120	160	80	100	45	30	60
4	180	180	180	100	100	70	100	150	75	90	40	25	50
5	160	160	160	95	95	60	90	140	70	80	35	20	40
6	140	140	140	90	90	50	80	130	65	70	30	18	30
7	130	130	130	85	85	40	75	120	60	60	25	16	25
8	120	120	120	80	80	35	70	110	55	50	20	14	20
9	110	110	110	75	75	30	65	100	50	40	15	12	10
10	100	100	100	70	70	25	60	95	47	38	10	10	5
11	95	95	95	65	65	20	55	90	45	36	8	8	x
12	90	90	90	60	60	15	50	85	42	34	6	6	
13	85	85	85	55	55	10	45	80	40	32	4	4	
14	80	80	80	50	50	5	40	78	39	30	2	2	
15	78	78	78	45	45	3	35	76	38	28	1	1	
16	76	76	76	40	40	1	30	74	37	26	X	x	
17	74	74	74	38	38	x	25	72	36	24			
18	72	72	72	36	36		20	70	35	22			
19	70	70	70	34	34		15	68	34	20			
20	68	68	68	32	32		10	66	33	18			
21	66	66	66	30	30		x	64	32	16			
22	64	64	64	28	28			62	31	14			
23	62	62	62	26	26			60	30	12			
24	60	60	60	24	24			58	28	10			
25	58	58	58	22	22			56	26	8			
26	56	56	56	20	20			54	24	6			
27	54	54	54	18	18			52	22	5			
28	52	52	52	16	16			50	20	4			
29	50	50	50	14	14			48	18	3			
30	45	45	48	13	13			46	16	2			
31	40	40	46	12	12			44	14	x			
32	35	35	44	11	11			42	12				
33	30	30	42	10	10			40	10				
34	25	25	41	9	9			38	9				
35	20	20	40	8	8			36	8				
36	15	15	39	7	7			34	7				
37	10	10	38	6	6			32	6				
38	5	5	37	5	5			30	5				
39	x	x	36	4	4			29	4				
40			35	3	3			28	3				
41			34	2**	2**			27	2**				
42			33					26					
43			32					25					
44			31					24					
45			30					23					
46			29					22					
47			28					21					
48			27					20					
49			26					19					
50			25					18					
51			24					17					
52			23					16					
53			22					15					
54			21					14					
55			20					13					
56			19					12					
57			18					11					
58			17					10					
59			16					9					
60			15					8					
61			5**					3**					

* en cas d'épreuve séparée / in case of split event

** nombre de points pour chaque coureur classé / ** amount of points for each ranked rider

*** les points ne sont pas nominatifs aux coureurs mais à la Nation / the points are not nominatif to the riders but to the Nation

* en cas d'épreuve séparée / *in case of split event*

** nombre de points pour chaque coureur classé / *** amount of points for each ranked rider*

*** les points ne sont pas nominatifs aux coureurs mais à la Nation / *the points are not nominatif to the riders but to the Nation*

ANNEX 2a - UCI MTB XCC points

	CHAMPIONNATS DU MONDE WORLD CHAMPIONSHIPS	CHAMP. CONTINENTAUX CONTINENTAL CHAMP.	CHAMP. NATIONAUX NATIONAL CHAMP.	COUPE DU MONDE WORLD CUP	Classe 3
<i>Rang / Place</i>	Elite	Elite	Elite	Elite	Elite
1	150	70	50	30	10
2	125	65	45	20	6
3	100	60	35	15	4
4	90	55	30	12	2
5	80	50	25	10	1
6	70	45	20	8	x
7	65	40	15	6	
8	60	35	10	4	
9	55	30	5	2	
10	50	25	2	1	
11	45	20	x	x	
12	40	19			
13	39	18			
14	38	17			
15	37	16			
16	36	15			
17	35	14			
18	34	13			
19	33	12			
20	32	11			
21	31	10			
22	30	9			
23	29	8			
24	28	7			
25	27	6			
26	26	5			
27	25	4			
28	24	3			
29	23	2			
30	22	1			
31	21	X			
32	20				
33	15				
34	10				
35	9				
36	8				
37	7				
38	6				
39	5				
40	2				
41	x				

	CHAMPIONNATS DU MONDE WORLD CHAMPIONSHIPS	COUPE DU MONDE MARATHON MARATHON WORLD CUP	CHAMP. CONTINENTAUX CONTINENTAL CHAMP.	CHAMP. NATIONAUX NATIONAL CHAMP.	EPREUVE D'UN JOUR MARATHON ONE DAY RACE MARATHON			EPREUVE PAR ETAPES STAGE RACE		
					Hors Classe	Classe 1	Classe 2	Hors Classe	Classe 1	Classe 2
								General classification	General classification	General classification
Rang / Place	Elite	Elite	Elite	Elite	Elite	Elite	Elite	Elite	Elite	Elite
1	300	250	150	100	100	60	30	200	150	80
2	250	200	120	90	80	40	20	180	120	70
3	200	160	100	70	60	30	15	160	100	60
4	180	150	90	60	50	25	12	140	80	55
5	160	140	80	50	40	20	10	130	75	50
6	140	130	70	40	35	18	8	120	65	45
7	130	120	60	30	30	16	6	110	60	40
8	120	110	50	20	27	14	4	100	55	35
9	110	100	40	10	24	12	2	90	50	30
10	100	95	38	5	22	10	1	80	45	25
11	95	90	36	x	20	8	x	70	40	20
12	90	85	34		18	6		65	35	19
13	85	80	32		16	4		60	30	18
14	80	78	30		14	2		55	28	17
15	78	76	28		12	1		50	26	16
16	76	74	26		10	x		45	24	15
17	74	72	24		9			40	22	14
18	72	70	22		8			38	20	13
19	70	68	20		7			36	18	12
20	68	66	18		6			34	15	10
21	66	64	16		5			32	10	8
22	64	62	14		4			28	9	6
23	62	60	12		3			26	8	4
24	60	58	10		2			24	7	2
25	58	56	8		1			22	6	1
26	56	54	6		x			20	5	x
27	54	52	5					18	4	
28	52	50	4					16	3	
29	50	48	3					14	2	
30	48	46	2					12	1	
31	46	44	x					10	X	
32	44	42						9	X	
33	42	40						8		
34	41	38						7		
35	40	36						6		
36	39	34						5		
37	38	32						4		
38	37	30						3		
39	36	29						2		
40	35	28						1		
41	34	27						x		
42	33	26								
43	32	25								
44	31	24								
45	30	23								
46	29	22								
47	28	21								
48	27	20								
49	26	19								
50	25	18								
51	24	17								
52	23	16								
53	22	15								
54	21	14								
55	20	13								
56	19	12								
57	18	11								
58	17	10								
59	16	9								
60	15	8								
61	5**	x								
** nombre de points pour chaque coureur classé / ** amount of points for each ranked rider										
*** les points ne sont pas remisifs aux coureurs mais à la Nation / the points are not remisifs to the riders but to the Nation										

ANNEX 3 - UCI MTB DHI points

Rang / Place	CHAMPIONNATS DU MONDE WORLD CHAMPIONSHIPS		COUPE DU MONDE WORLD CUP							
	Elite	Junior	Manche Qualifications Hommes Elite Qualifying Round Men Elite **	Manche Qualifications Femmes Elite Qualifying Round Women Elite**	Finale Hommes Elite Final Men Elite	Finale Femmes Elite Final Women Elite	Final event of the World Cup season Finale Hommes Elite Final Men Elite	Final event of the World Cup season Finale Femmes Elite Final Women Elite	Finale Men Juniors Final Hommes Junior	Finale Women Juniors Final Femmes Juniors
1	300	80	50	50	200	200	250	250	60	60
2	250	60	40	40	160	160	200	200	50	50
3	200	40	30	30	140	140	170	170	45	45
4	180	30	25	25	125	125	150	150	40	40
5	160	25	22	20	110	110	132	130	35	35
6	140	20	20	16	95	95	115	111	30	30
7	130	18	18	14	90	80	108	94	28	25
8	120	16	17	12	85	70	102	82	26	15
9	110	14	16	10	80	60	96	70	24	10
10	100	12	15	5	75	55	90	60	22	5
11	95	10	14	x	70	50	84	50	20	
12	90	9	13		65	45	78	45	18	
13	85	8	12		60	40	72	40	16	
14	80	7	11		55	35	66	35	14	
15	78	6	10		50	30	60	30	12	
16	76	5	9		45	25	54	25	10	
17	74	4	8		44	20	52	20	9	
18	72	3	7		43	15	50	15	8	
19	70	2	6		42	10	48	10	7	
20	68	1	5		41	5	46	5	6	
21	66	x	x		40	x	40		5	
22	64				39		39		4	
23	62				38		38		3	
24	60				37		37		2	
25	58				36		36		1	
26	56				35		35		x	
27	54				34		34			
28	52				33		33			
29	50				32		32			
30	48				31		31			
31	46				30		30			
32	44				29		29			
33	42				28		28			
34	41				27		27			
35	40				26		26			
36	39				25		25			
37	38				24		24			
38	37				23		23			
39	36				22		22			
40	35				21		21			
41	34				20		20			
42	33				19		19			
43	32				18		18			
44	31				17		17			
45	30				16		16			
46	29				15		15			
47	28				14		14			
48	27				13		13			
49	26				12		12			
50	25				11		11			
51	24				10		10			
52	23				9		9			
53	22				8		8			
54	21				7		7			
55	20				6		6			
56	19				5		5			
57	18				4		4			
58	17				3		3			
59	16				2		2			
60	15				1		1			
61	5*									
* nombre de points pour chaque coureur classé / * amount of points for each ranked rider										
** For the final round, no world cup points will be awarded for the qualifying round, those world cup points will be given to the final instead.										

* nombre de points pour chaque coureur classé / * amount of points for each ranked rider

ANNEX 4- UCI MTB 4X points

CHAMP. CONT. CONT. CHAMP.		CHAMP. NAT. NAT. CHAMP.	EPREUVE D'UN JOUR ONE DAY RACE			
			Hors Classe	Classe 1	Classe 2	Classe 3
Rang / Place	Elite	Elite	Elite	Elite	Elite	Elite
1	200	110	90	60	30	10
2	150	90	70	40	20	6
3	120	70	60	30	15	4
4	100	60	50	25	12	2
5	95	50	40	20	10	x
6	90	40	35	18	8	
7	85	30	30	16	6	
8	80	20	27	14	4	
9	75	10	24	12	x	
10	70	5	22	10		
11	65	x	20	8		
12	60		18	6		
13	55		16	4		
14	50		14	3		
15	45		12	2		
16	40		10	1		
17	38		9	x		
18	36		8			
19	34		7			
20	32		6			
21	30		5			
22	28		4			
23	26		3			
24	24		2			
25	22		x			
26	20					
27	18					
28	16					
29	14					
30	13					
31	12					
32	11					
33	x					
34						
35						
36						
37						
38						
39						
40						
41						
42						
43						
44						
45						
46						
47						
48						
49						
50						
51						

ANNEX 5 – XCE SCHEDULE (32 riders, 4 per heat)

1/8 FINALS

QR	Bib	Heat 1	Rank
1.	1		
16.	16		
17.	17		
32.	32		

1/4 FINALS

	Bib	Heat 9	Rank
Heat 1 > 1.			
Heat 1 > 2.			
Heat 2 > 1.			
Heat 2 > 2.			

1/2 FINALS

	Bib	Semi Final 1	Rank
Heat 9 > 1.			
Heat 9 > 2.			
Heat 10 > 1.			
Heat 10 > 2.			

QR	Bib	Heat 2	Rank
8.	8		
9.	9		
24.	24		
25.	25		

QR	Bib	Heat 3	Rank
4.	4		
13.	13		
20.	20		
29.	29		

	Bib	Semi Final 2	Rank
Heat 11 > 1.			
Heat 11 > 2.			
Heat 12 > 1.			
Heat 12 > 2.			

QR	Bib	Heat 4	Rank
5.	5		
12.	12		
21.	21		
28.	28		

	Bib	Heat 10	Rank
Heat 3 > 1.			
Heat 3 > 2.			
Heat 4 > 1.			
Heat 4 > 2.			

QR	Bib	Heat 5	Rank
2.	2		
15.	15		
18.	18		
31.	31		

QR	Bib	Heat 6	Rank
7.	7		
10.	10		
23.	23		
26.	26		

	Bib	Heat 11	Rank
Heat 5 > 1.			
Heat 5 > 2.			
Heat 6 > 1.			
Heat 6 > 2.			

FINALS

	Bib	Small Final	Rank
Semi Final 1 > 3.			
Semi Final 1 > 4.			
Semi Final 2 > 3.			
Semi Final 2 > 4.			

QR	Bib	Heat 7	Rank
3.	3		
14.	14		
19.	19		
30.	30		

	Bib	Big Final	Rank
Semi Final 1 > 1.			
Semi Final 1 > 2.			
Semi Final 2 > 1.			
Semi Final 2 > 2.			

QR	Bib	Heat 8	Rank
6.	6		
11.	11		
22.	22		
27.	27		

	Bib	Heat 12	Rank
Heat 7 > 1.			
Heat 7 > 2.			
Heat 8 > 1.			
Heat 8 > 2.			

Notes:

- If fewer than 24 riders are ranked in the qualifying round (QR), the first round will be the ¼ finals : Heat 1 > Bib 1-8-9-16, Heat 2 > 4-5-12-13, Heat 3 > 2-7-10-15, Heat 4 > 3-6-11-14.
- The competition shall not be held if fewer than 12 riders are entered for the qualifying round.