



**PARA-CYCLING ROAD  
WORLD CUP**

**ADELAIDE | AUSTRALIA**

# Event Staff

## UCI

**UCI ParaCycling Coord.**  
**UCI Para Classification Coord.**  
**UCI Photographer**

Todd Fraser  
 Marie Moser  
 Jean-Baptiste Benavant

**UCI Technical Delegate**  
**UCI Timing and Results**

Roberto Rancilio  
 Sylvain Richard

## AUSCYCLING

**Exec GM - Sport**  
**State Ops Director- SA**  
**Event Lead- SA**

Kipp Kaufmann  
 Jake Thomas  
 Max Hardy

**Head of Road Events**  
**Competition Director**  
**Race Doctor**

Jeff Corbett  
 Kimberley Conte  
 Bridget Sawyer

## Classifiers

**PI Classifier**  
**PI Classifier**  
**VI Classifier**

Joan Hacken  
 Kristy Walker  
 Richard Rawson

**PI Classifier**  
**PI Classifier**  
**VI Classifier**

Stephen Burke  
 Erik Moen  
 Renee Edgar

## Race Officials

**UCI Commissaire**  
**UCI Commissaire**  
**UCI Commissaire**  
**Tech Commissaire**  
**National Commissaire**  
**National Commissaire**  
**National Commissaire**  
**National Commissaire**

Phil Pollard  
 Anthony Torr  
 Zach Prendergast  
 Jeremy Christmas  
 Simon Forrest  
 Rachel Goud  
 Susan Mitchell  
 Howard Bartlett

**UCI Commissaire**  
**UCI Commissaire**  
**Doping Control Officer (DCO)**  
**National Commissaire**  
**National Commissaire**  
**National Commissaire**  
**National Commissaire**

Josee Bedard  
 Louise Jones  
 Rob Ingall  
 Andrew Falconer  
 Anina Gallagher  
 Tracey Johnson  
 Karen O'Callaghan

# Key Meetings and Dates

January 11 -17, 2024

<b>Date</b>	<b>Item</b>	<b>Time</b>	<b>Location</b>
Thursday, Jan. 11	PI Classification	10:00am - 5:00pm	Adelaide Superdrome 50 Anna Meares Way, Gepps Cross
Friday, Jan. 12	PI Classification	10:00am - 5:00pm	Adelaide Superdrome 50 Anna Meares Way, Gepps Cross
	VI Classification	10:00am - 4:00pm	Royal Society for the Blind 212 Pirie St., Adelaide
Saturday, Jan. 13	PI Classification	10:00am - 1:00pm	Adelaide Superdrome 50 Anna Meares Way, Gepps Cross
	Relay Confirmation of Starters	1:00pm	Hilton Hotel 233 Victoria Square, Adelaide
	Relay Managers Meeting	2:00pm	Hilton Hotel 233 Victoria Square, Adelaide
Sunday, Jan. 14	Time Trial and Road Race Confirmation of Starters	12:00pm	Rydgges Pit Lane Hotel 543 Dukes Hwy, Tailem Bend @ The Bend Motorsports Park
	PI Classification	4:00pm - 8:00pm	The Bend Motorsports Park 543 Dukes Hwy, Tailem Bend Anti-Doping Suite
	Time Trial and Road Race Managers Meeting	5:00pm	Rydgges Pit Lane Hotel 543 Dukes Hwy, Tailem Bend @ The Bend Motorsports Park
	Open Track Training	6:00pm - 8:00pm	The Bend Motorsports Park 543 Dukes Hwy, Tailem Bend

**Competition Programme / Programme des Compétitions**

**Saturday 13 January / Samedi 13 janvier**

17:35	M/W H1-5	Team Relay	1.35 x 9 laps	12.2 km	M/W H1-5	Contre-la-Montre Individuel	1.35 km x 9 tours	12.2 km
18:15	18:20	<i>Award Ceremonies</i>			<i>Cérémonies Protocolaires</i>			

**Monday 15 January / Lundi 15 janvier**

9:00	MB	Individual Time Trial	7.80 km x 3 laps	23.4 km	MB	Contre-la-Montre Individuel	7.80 km x 3 tours	23.4 km
	MC5	Individual Time Trial	7.80 km x 3 laps	23.4 km	MC5	Contre-la-Montre Individuel	7.80 km x 3 tours	23.4 km
	MC4	Individual Time Trial	7.80 km x 3 laps	23.4 km	MC4	Contre-la-Montre Individuel	7.80 km x 3 tours	23.4 km
	WB	Individual Time Trial	7.80 km x 2 laps	15.6 km	WB	Contre-la-Montre Individuel	7.80 km x 2 tours	15.6 km
	WC5	Individual Time Trial	7.80 km x 2 laps	15.6 km	WC5	Contre-la-Montre Individuel	7.80 km x 2 tours	15.6 km
	WC4	Individual Time Trial	7.80 km x 2 laps	15.6 km	WC4	Contre-la-Montre Individuel	7.80 km x 2 tours	15.6 km

10:30	MC3	Individual Time Trial	7.80 km x 2 laps	15.6 km	MC3	Contre-la-Montre Individuel	7.80 km x 2 tours	15.6 km
	MC2	Individual Time Trial	7.80 km x 2 laps	15.6 km	MC2	Contre-la-Montre Individuel	7.80 km x 2 tours	15.6 km
	MC1	Individual Time Trial	7.80 km x 2 laps	15.6 km	MC1	Contre-la-Montre Individuel	7.80 km x 2 tours	15.6 km
	WC3	Individual Time Trial	7.80 km x 2 laps	15.6 km	WC3	Contre-la-Montre Individuel	7.80 km x 2 tours	15.6 km
	WC2	Individual Time Trial	7.80 km x 2 laps	15.6 km	WC2	Contre-la-Montre Individuel	7.80 km x 2 tours	15.6 km
	WC1	Individual Time Trial	7.80 km x 2 laps	15.6 km	WC1	Contre-la-Montre Individuel	7.80 km x 2 tours	15.6 km

12:15	13:15	<i>Award Ceremonies</i>			<i>Cérémonies Protocolaires</i>			
-------	-------	-------------------------	--	--	---------------------------------	--	--	--

15:00	MH3	Individual Time Trial	7.80 km x 2 laps	15.6 km	MH3	Contre-la-Montre Individuel	7.80 km x 2 tours	15.6 km
	MH4	Individual Time Trial	7.80 km x 2 laps	15.6 km	MH4	Contre-la-Montre Individuel	7.80 km x 2 tours	15.6 km
	MH5	Individual Time Trial	7.80 km x 2 laps	15.6 km	MH5	Contre-la-Montre Individuel	7.80 km x 2 tours	15.6 km
	WH5	Individual Time Trial	7.80 km x 2 laps	15.6 km	WH5	Contre-la-Montre Individuel	7.80 km x 2 tours	15.6 km
	WH4	Individual Time Trial	7.80 km x 2 laps	15.6 km	WH4	Contre-la-Montre Individuel	7.80 km x 2 tours	15.6 km
	WH3	Individual Time Trial	7.80 km x 2 laps	15.6 km	WH3	Contre-la-Montre Individuel	7.80 km x 2 tours	15.6 km

16:15	MT2	Individual Time Trial	7.80 km x 2 laps	15.6 km	MT2	Contre-la-Montre Individuel	7.80 km x 2 tours	15.6 km
	MT1	Individual Time Trial	7.80 km x 2 laps	15.6 km	MT1	Contre-la-Montre Individuel	7.80 km x 2 tours	15.6 km
	WT2	Individual Time Trial	7.80 km x 2 laps	15.6 km	WT2	Contre-la-Montre Individuel	7.80 km x 2 tours	15.6 km
	WT1	Individual Time Trial	7.80 km x 2 laps	15.6 km	WT1	Contre-la-Montre Individuel	7.80 km x 2 tours	15.6 km
	WH2	Individual Time Trial	7.80 km x 1 lap	7.8 km	WH2	Contre-la-Montre Individuel	7.80 km x 1 tour	7.8 km
	WH1	Individual Time Trial	7.80 km x 1 lap	7.8 km	WH1	Contre-la-Montre Individuel	7.80 km x 1 tour	7.8 km
	MH2	Individual Time Trial	7.80 km x 2 laps	15.6 km	MH2	Contre-la-Montre Individuel	7.80 km x 2 tours	15.6 km
	MH1	Individual Time Trial	7.80 km x 2 laps	15.6 km	MH1	Contre-la-Montre Individuel	7.80 km x 2 tours	15.6 km

18:15	19:25	<i>Award Ceremonies</i>			<i>Cérémonies Protocolaires</i>			
-------	-------	-------------------------	--	--	---------------------------------	--	--	--

**Tuesday 16 January / Mardi 16 janvier**

9:00	MC5	Individual Road Race	7.80 km x 9 laps	70.2 km	MC5	Course en Ligne Individuelle	7.80 km x 9 tours	70.2 km
9:02	MC4	Individual Road Race	7.80 km x 9 laps	70.2 km	MC4	Course en Ligne Individuelle	7.80 km x 9 tours	70.2 km
11:00	MC3	Individual Road Race	7.80 km x 7 laps	54.6 km	MC3	Course en Ligne Individuelle	7.80 km x 7 tours	54.6 km
11:02	MC2	Individual Road Race	7.80 km x 7 laps	54.6 km	MC2	Course en Ligne Individuelle	7.80 km x 7 tours	54.6 km
11:04	MC1	Individual Road Race	7.80 km x 7 laps	54.6 km	MC1	Course en Ligne Individuelle	7.80 km x 7 tours	54.6 km
15:00	MB	Individual Road Race	7.80 km x 11 laps	85.8 km	MB	Course en Ligne Individuelle	7.80 km x 5 tours	85.8 km
15:02	WB	Individual Road Race	7.80 km x 9 laps	70.2 km	WB	Course en Ligne Individuelle	7.80 km x 9 tours	70.2 km
17:15	WC5	Individual Road Race	7.80 km x 7 laps	54.6 km	WC5	Course en Ligne Individuelle	7.80 km x 7 tours	54.6 km
17:15	WC4	Individual Road Race	7.80 km x 7 laps	54.6 km	WC4	Course en Ligne Individuelle	7.80 km x 7 tours	54.6 km
17:17	WC3	Individual Road Race	7.80 km x 6 laps	46.8 km	WC3	Course en Ligne Individuelle	7.80 km x 6 tours	46.8 km
17:17	WC2	Individual Road Race	7.80 km x 6 laps	46.8 km	WC2	Course en Ligne Individuelle	7.80 km x 6 tours	46.8 km
17:17	WC1	Individual Road Race	7.80 km x 6 laps	46.8 km	WC1	Course en Ligne Individuelle	7.80 km x 6 tours	46.8 km
19:00	19:35	<i>Award Ceremonies</i>			<i>Cérémonies Protocolaires</i>			

**Wednesday 17 January / Mercredi 17 janvier**

9:00	MT2	Individual Road Race	7.80 km x 3 laps	23.4 km	MT2	Course en Ligne Individuelle	7.80 km x 3 tours	23.4 km
9:00	MT1	Individual Road Race	7.80 km x 3 laps	23.4 km	MT1	Course en Ligne Individuelle	7.80 km x 3 tours	23.4 km
9:02	WT2	Individual Road Race	7.80 km x 3 laps	23.4 km	WT2	Course en Ligne Individuelle	7.80 km x 3 tours	23.4 km
9:02	WT1	Individual Road Race	7.80 km x 3 laps	23.4 km	WT1	Course en Ligne Individuelle	7.80 km x 3 tours	23.4 km
10:30	MH3	Individual Road Race	7.80 km x 7 laps	54.6 km	MH3	Course en Ligne Individuelle	7.80 km x 7 tours	54.6 km
12:15	12:40	<i>Award Ceremonies</i>			<i>Cérémonies Protocolaires</i>			
15:00	MH4	Individual Road Race	7.80 km x 7 laps	54.6 km	MH4	Course en Ligne Individuelle	7.80 km x 7 tours	54.6 km
15:02	MH5	Individual Road Race	7.80 km x 7 laps	54.6 km	MH5	Course en Ligne Individuelle	7.80 km x 7 tours	54.6 km
17:00	MH2	Individual Road Race	7.80 km x 5 laps	39.0 km	MH2	Course en Ligne Individuelle	7.80 km x 5 tours	39.0 km
17:00	MH1	Individual Road Race	7.80 km x 5 laps	39.0 km	MH1	Course en Ligne Individuelle	7.80 km x 5 tours	39.0 km
17:02	WH4	Individual Road Race	7.80 km x 5 laps	39.0 km	WH4	Course en Ligne Individuelle	7.80 km x 5 tours	39.0 km
17:02	WH5	Individual Road Race	7.80 km x 5 laps	39.0 km	WH5	Course en Ligne Individuelle	7.80 km x 5 tours	39.0 km
17:02	WH3	Individual Road Race	7.80 km x 5 laps	39.0 km	WH3	Course en Ligne Individuelle	7.80 km x 5 tours	39.0 km
17:02	WH2	Individual Road Race	7.80 km x 5 laps	39.0 km	WH2	Course en Ligne Individuelle	7.80 km x 5 tours	39.0 km
17:02	WH1	Individual Road Race	7.80 km x 5 laps	39.0 km	WH1	Course en Ligne Individuelle	7.80 km x 5 tours	39.0 km
18:30	19:15	<i>Award Ceremonies</i>			<i>Cérémonies Protocolaires</i>			

The Team Relay will take place in the Adelaide CBD in conjunction with Down Under Classic criterium, part of the Santos Tour Down Under.

Course



Venue and Exchange Zone

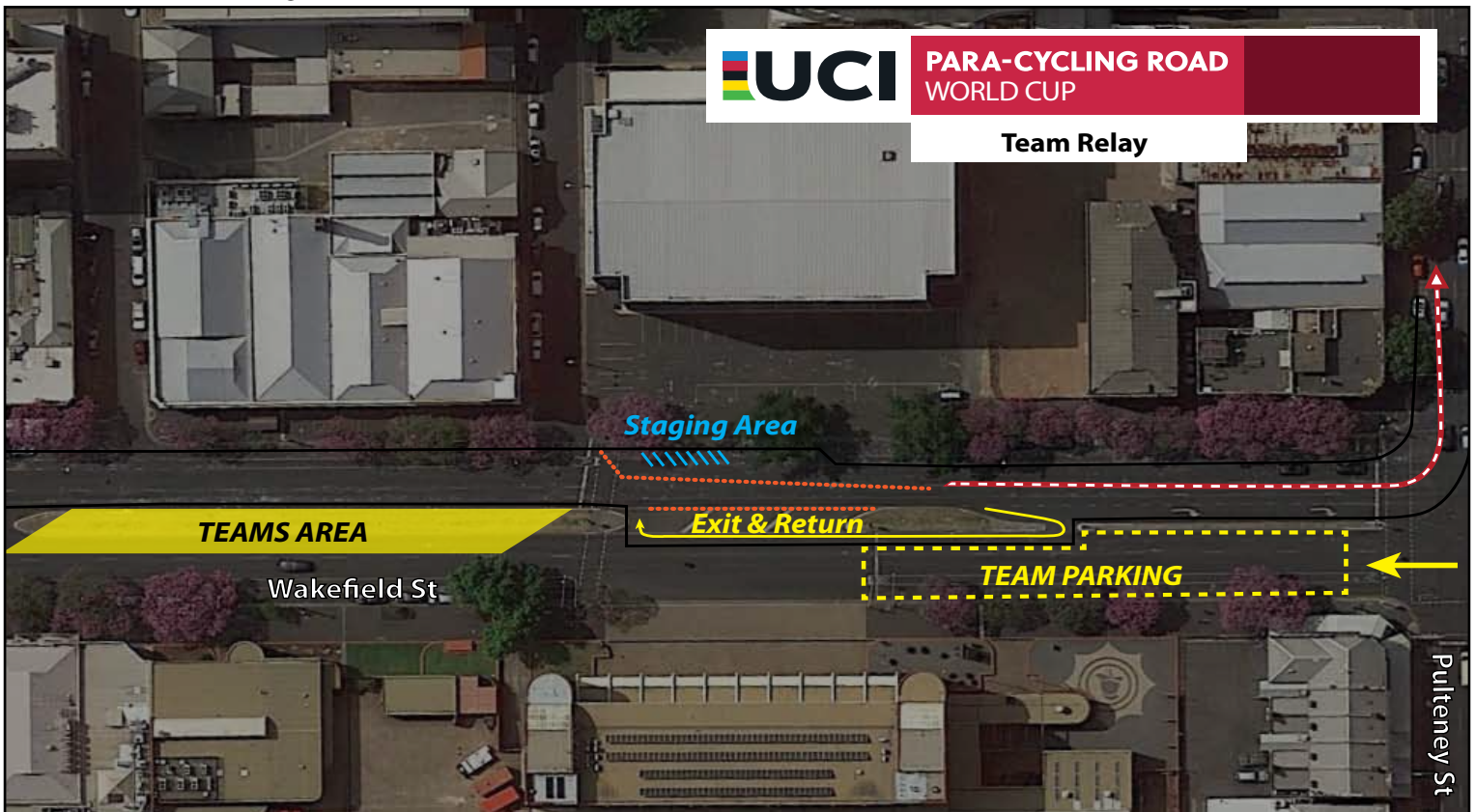

Race Notes

- Parking is limited in size and access. Please bring as few vehicles as possible and only access parking from the corner of Wakefield St and Pulteney St. Vehicles must have windshield accreditations in order to access Team Parking. These will be available at Confirmation of Starters and Managers Meeting
- Teams Area is available for teams to set up tents and equipment. Please avoid taking over parking spaces for this purpose.

The Bend Motorsport Park will host both the Time Trail and Road Race events of the Adelaide Para Cycling Road World Cup. Both races will utilize the 7.7km GT circuit, the longest motorsports circuit in the southern hemisphere.

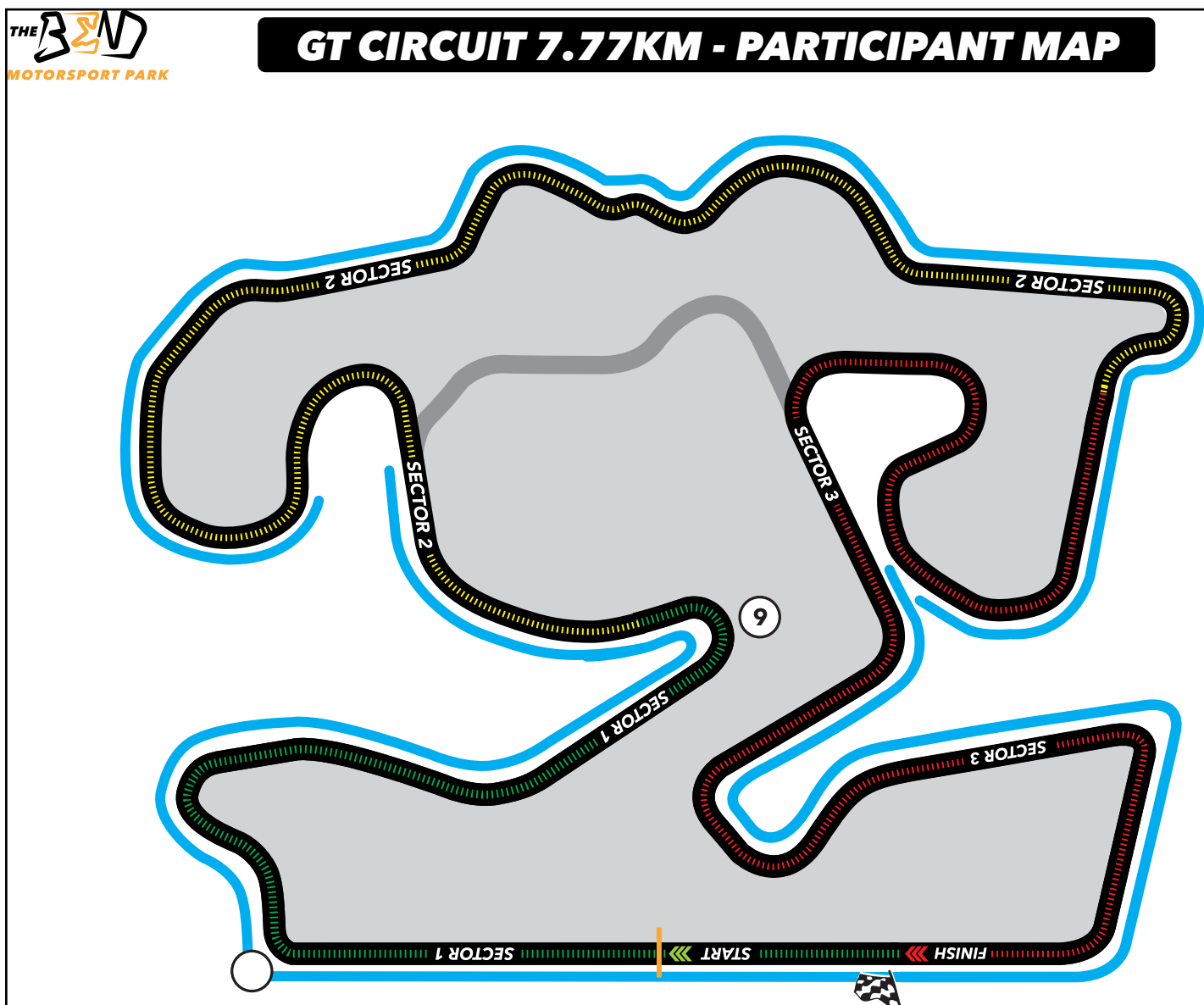

The Bend Motorsports Park is located in Taillem Bend, approx. 105 km from the center of Adelaide.

Physical address: 543 Dukes Hwy. Taillem Bend, SA 5260

**Race Office**

The race permanence for the time trial and road race competition from Sunday January 14 until the end of competition on Wednesday January 17. will be held in the Pit Lane at The Bend Motorsport Park (see venue map). It will be open from 1 hour before training or racing on each day until the end of competition for that day as per the schedule.

**Accreditations**

The Accreditation Centre will be in the Race Office at The Bend Motorsports Park. The Accreditation Centre will be operational from 1 hour prior to race start until the end of the final presentation each day, starting on Sunday 14th January 2024. All team accreditations will need to be collected from the Accreditation Centre. During PI Classification and the Teams Relay, accreditations will be available to pick up at those locations, as well as during the Relay Confirmation of Starters,

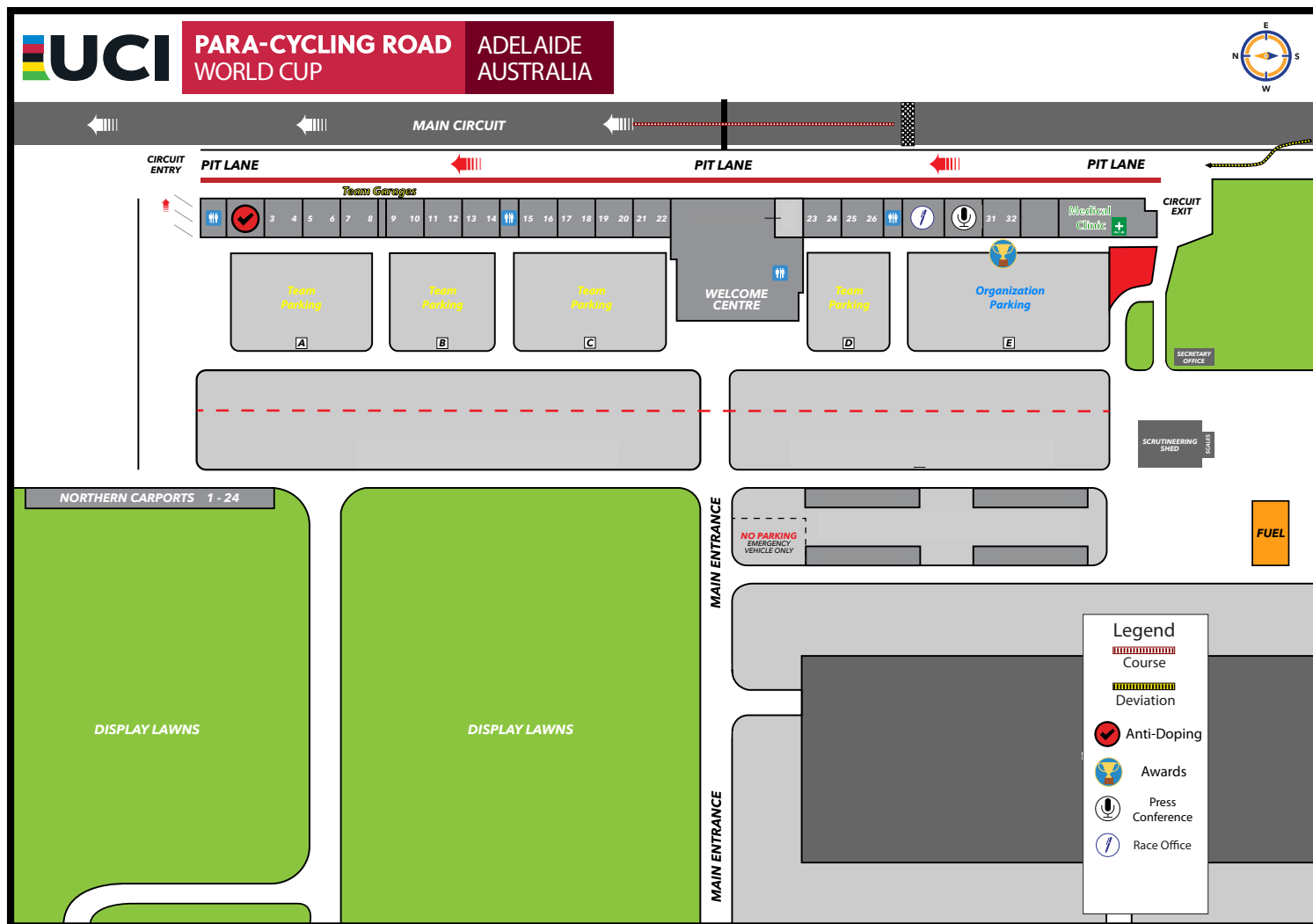

### Venue Notes - The Bend

- Teams will be assigned a garage space along Pit Lane as space permits. Large teams may receive a whole garage, while small teams may be asked to share. Garages are equipped with power (standard Australian 240v outlet with AS/NZS 3112 plug).
- Please consult the garage schedule. The team garages will lock automatically each night and not unlock until morning.
- Teams may park directly behind their assigned garage space. They may also use Pit Lane to access garage, but should use caution as Pit Lane will serve as the Deviation route for official and team support vehicles
- The track surface at The Bend should only be utilized during open training time (Sunday) and while racing. Warming up can be done in the parking lot and access roads that surround The Bend.

### Garage Schedule - The Bend

Sunday, Jan. 14 - 3:00pm, garages assigned and open / 9:00pm, garages locked for night  
 Monday, Jan. 15 - 7:00am, garages unlocked / 9:00pm, garages locked for night  
 Tuesday, Jan. 16 - 7:00am, garages unlocked / 9:00pm, garages locked for night  
 Wednesday, Jan. 17 - 7:00am, garages unlocked / 9:00pm, garages locked for night, team must be packed out





PARA-CYCLING ROAD  
WORLD CUP

ADELAIDE  
AUSTRALIA

### Time Trial

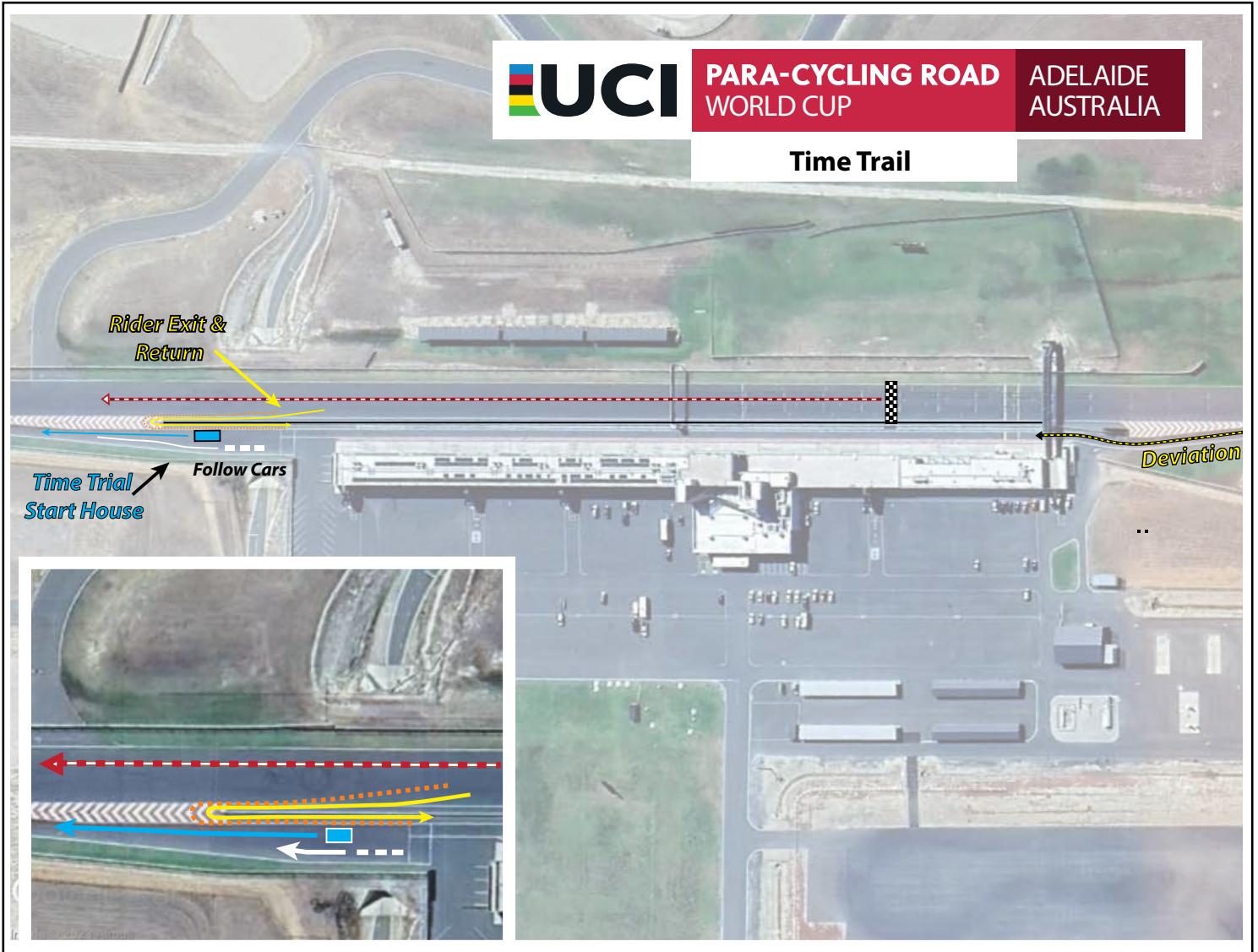

### Race Notes

- Riders may not use the track for warm up. The parking lot and private roads surrounding The Bend are available for warm up.
- TT start house and follow vehicle line up will be at the north end of Pit Lane. Vehicles should use caution in this area.
- Follow vehicles must take the Deviation route off the track when their rider is finishing.
- After finishing assigned number of laps and crossing the finish, riders must move left and slowly take the exit chute back onto Pit Lane. Support staff may meet riders at end of exit chute, not on track.

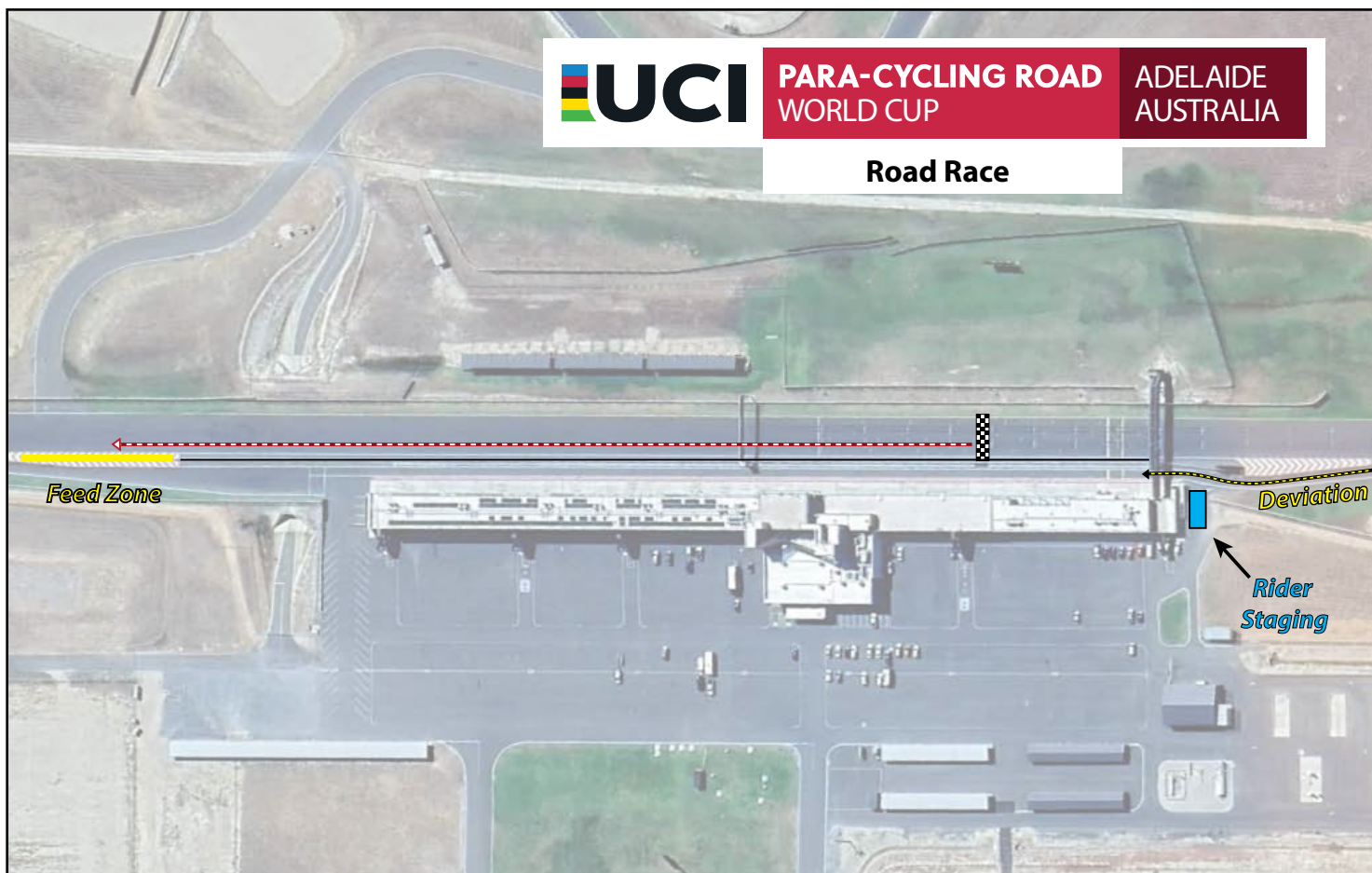

### Race Notes

- Riders may not use the track for warm up. The parking lot and private roads surrounding The Bend are available for warm up.
- Riders should stage at the south end of Pit Lane prior to their start and will be called on track and to the Start/Finish when it is safe.
- The Feed Zone / Green Zone is at the north end of Pit Lane, where the wall ends and painted surface begins.
- No team vehicles should be on track during road races without permission from commissaires.

# General & Travel Information



Adelaide is bursting with culture, flavours, events and entertainment. Taste the world-famous wine regions only minutes from the city or indulge in award-winning restaurants in the heart of Adelaide. Join the party at our immersive festivals and events or spend the night exploring Adelaide attractions and a thriving restaurant and bar scene. Adelaide is a gateway to some of Australia's best wine country and is home to Australia's official best restaurant, hotel, wine, gin and beach, Adelaide punches well above its weight when it comes to dishing up the best but don't take our word for it, start planning with our guide to the top 10 things to do in Adelaide.



Website: <https://auscycling.org.au/page/pararoad-adelaide>

Organisers contact:

Name: AusCycling

Email: [events@auscycling.org.au](mailto:events@auscycling.org.au)

Address: 5/459 Collins Street, Melbourne, 3000



Climate and Conditions at event time.

Adelaide has a Mediterranean climate (Köppen climate classification Csa), with mild wet winters and hot dry summers.

The following are the details for January weather in Adelaide from the Australian Bureau of Meteorology.

For more detailed information see: [http://www.bom.gov.au/climate/averages/tables/cw\\_023090.shtml](http://www.bom.gov.au/climate/averages/tables/cw_023090.shtml)

We recommend downloading the BOM weather app from the App Store.

Statistics	Jan
<b>Temperature</b>	
Mean maximum temperature (°C)	29.6
Mean minimum temperature (°C)	17.3
<b>Rainfall</b>	
Mean rainfall (mm)	20.1
Decile 5 (median) rainfall (mm)	19.8
Mean number of days of rain ≥ 1 mm	2.9
<b>Other daily elements</b>	
Mean daily sunshine (hours)	10.5
Mean number of clear days	11.7
Mean number of cloudy days	7.4
<b>9 am conditions</b>	
Mean 9am temperature (°C)	21.6
Mean 9am relative humidity (%)	53
Mean 9am wind speed (km/h)	10.0
9am wind speed vs direction plot	
<b>3 pm conditions</b>	
Mean 3pm temperature (°C)	27.6
Mean 3pm relative humidity (%)	36
Mean 3pm wind speed (km/h)	16.6
3pm wind speed vs direction plot	



### Transportation from/to the Airports

There are various options available from the Adelaide Airport. For more information visit: <https://www.adelaideairport.com.au/parking-transport/transport-options/>

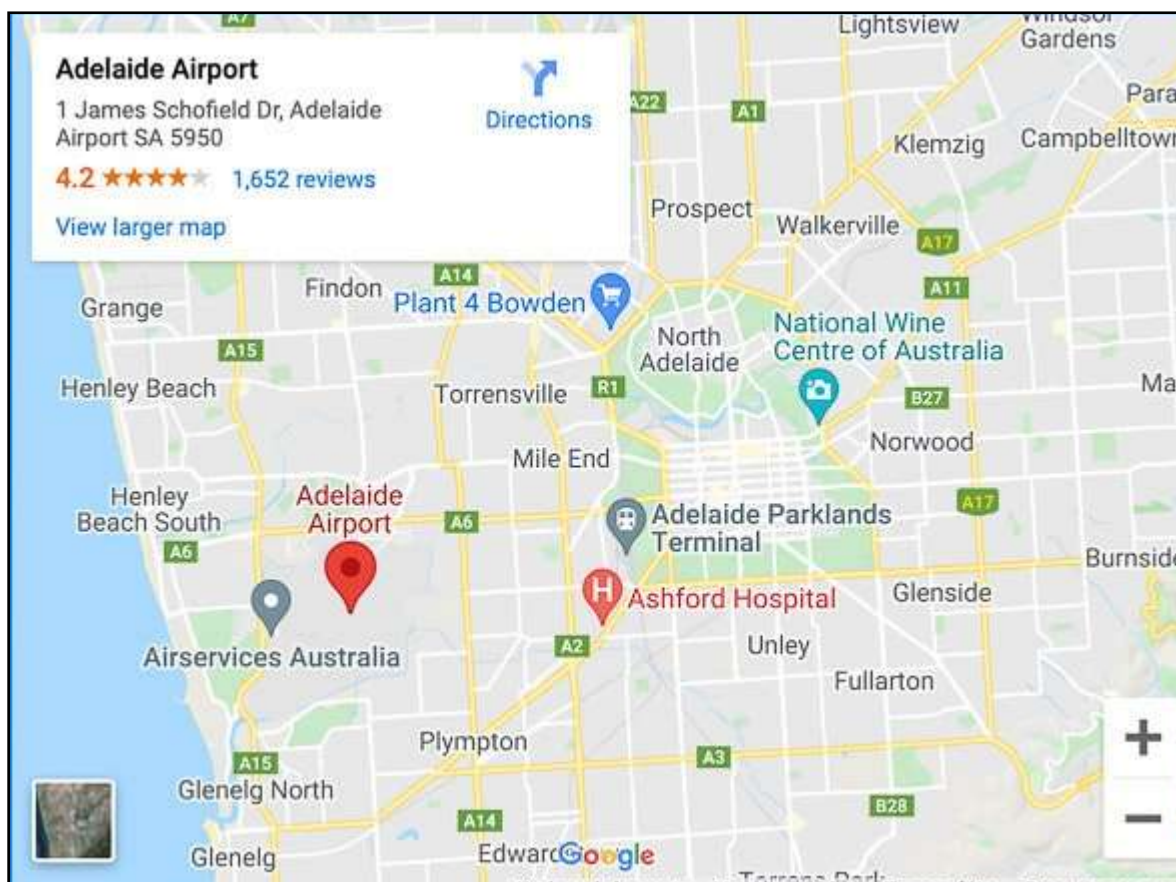

### Other Locations

#### Adelaide Superdrome (PI Classification)

The PI Classifications will take place at the Adelaide Superdrome, 50 Anna Meares Way, Gepps Cross, SA 5094. Parking will be set aside in the Northern carpark for attendees of the Classification sessions.

#### Adelaide Central Business District (Team Relay)

The Team Relay will take place in the centre of Adelaide as part of the Tour Down Under from Victoria Square. Please note there will be limited parking available at this venue.

Further location details can be found at: <https://tourdownunder.com.au/race/mens/stages/classic>

### Adelaide to The Bend (Time Trial and Road Race)

The Bend Motorsport Park takes approximately 1 hour and 15 minutes to reach from Adelaide. The closest accommodation and services are available in Murray Bridge.



### Accommodation

Please be aware that Road Races and Time Trials are being held at The Bend Motorsport Park at Taillem Bend, approximately 1hr 15min by car from Adelaide.

UCI Staff and Officials as well as event staff will be accommodated at the two hotels listed below only from the 14th of January to the 18th of January, and prior to that during classification and the Teams Relay will be based in Adelaide.

#### Recommended Hotels:

Rydges Pit Lane (The Bend Motorsport Park)

Address: 543 Dukes Hwy, Taillem Bend SA 5260

Phone: (08) 8165 5730

Website: <https://www.rydges.com/accommodation/adelaide-sa/rydges-pit-lane-hotel/>

Bridgeport Hotel

Address: 2 Bridge St, Murray Bridge SA 5253

Phone: (08) 8532 2002

Website: <https://bridgeporthotel.com.au/>

## Visas

For visa purposes, athletes, coaches, judges, officials and support people are considered to be amateur if they:

- are competing, training or participating without remuneration (or not receiving prize money that is equivalent to a salary or income); and/or
  - does not derive an income from their activity or where the activity is not the person's usual occupation
- An amateur sports person or team participating in an amateur sporting event or series of events may be eligible to apply for the following visa options:

- Visitor (subclass 600) Tourist stream visa. For more information see: <https://immi.homeaffairs.gov.au/visas/getting-a-visa/visa-listing/visitor-600/tourist-stream-overseas>
- Electronic Travel Authority – ETA (subclass 601). For eligible passport holders and more information see: <https://immi.homeaffairs.gov.au/visas/getting-a-visa/visa-listing/electronic-travel-authority-601>
- eVisitor (subclass 651) Tourist Stream) visa. For eligible passport holders and more information see: <https://immi.homeaffairs.gov.au/visas/getting-a-visa/visa-listing/evisitor-651>

Please note: Visa applicants claiming to be an amateur athlete or competitor will be required to provide evidence or supporting documents with their visa application. This may include evidence of their primary source of employment or income, such as a letter from their employer stating their occupation, how long they have been employed, and that they have been given a leave of absence. Students may provide a letter from their educational institution or provider.

Support persons, including a coach, manager, medical professional, official, or referee, who are supporting an amateur sports person or team on a genuine unpaid volunteer basis may be eligible for the following visa options:

- Visitor (subclass 600) Tourist stream visa. For more information see: <https://immi.homeaffairs.gov.au/visas/getting-a-visa/visa-listing/visitor-600/tourist-stream-overseas>
- Electronic Travel Authority – ETA (subclass 601). For more information see: <https://immi.homeaffairs.gov.au/visas/getting-a-visa/visa-listing/electronic-travel-authority-601>
- eVisitor (subclass 651) Tourist stream visa. For more information see: <https://immi.homeaffairs.gov.au/visas/getting-a-visa/visa-listing/evisitor-651>

Please note: Support persons claiming to be supporting an amateur sports person or team on a genuine unpaid volunteer basis will be required to provide evidence or supporting documents with their visa application. This may include a signed letter or statement from the sports federation or team management stating this.

Participation at an event by a coach, manager, medical professional, official, or referee, where the activity is the person's usual occupation may be eligible to apply for the following visa options:

- Temporary Work (subclass 400) Short Stay Specialist visa. For more information see: <https://immi.homeaffairs.gov.au/visas/getting-a-visa/visa-listing/temporary-work-400>
- Temporary Activity (subclass 408) Invited participant visa. For more information see: <https://immi.homeaffairs.gov.au/visas/getting-a-visa/visa-listing/temporary-activity-408/invited-for-other-social-and-cultural-activity>

Please note that a letter of support from an Australian organisation is a legislative requirement for the Temporary Activity (subclass 408) Invited participant visa.

An amateur sports person, team, support staff or official invited to participate in an event, or series of events, by an Australian organisation may be eligible to apply for a:

- Temporary Activity (subclass 408) Invited participant visa. For more information see: <https://immi.homeaffairs.gov.au/visas/getting-a-visa/visa-listing/temporary-activity-408/invited-for-other-social-and-cultural-activity>  
Please note that a the letter of support from an Australian organisation is a legislative requirement for the Temporary Activity (subclass 408) Invited participant visa.

Journalists or other media personnel travelling to Australia to cover an event, at the invitation of an Australian organisation, and where the production or broadcast is intended for Australian audiences may be eligible to apply for a:

- Temporary Activity (subclass 408) Entertainment visa. For more information see: <https://immi.homeaffairs.gov.au/visas/getting-a-visa/visa-listing/temporary-activity-408/entertainment-activities>  
Journalists or other media personnel travelling to Australia to cover an event, where the production/broadcast is not intended for Australian audiences may be eligible to apply for a:
- Temporary Work (subclass 400) Short Stay Specialist visa. For more information see: <https://immi.homeaffairs.gov.au/visas/getting-a-visa/visa-listing/temporary-work-400>

**NB: These are the visa options available presently but the Department reserves the right to change regulations. IECN assistance will NOT guarantee a visa grant. Visa applicants must demonstrate that they meet all the legislative requirements for an Australian visa.**

Visas for minors/persons under 18 years of age:

The Department of Home Affairs must be satisfied when assessing visa applications for minors (applicants under the age of 18 at time of visa application) of parental consent from all responsible parent(s) or guardian(s) to the grant of an Australian visa. Form 1229 - Consent to grant an Australian visa to a child under the age of 18 years, will be required to be submitted as part of the application for a visa as evidence of this consent. Minors who are travelling without their parent and/or guardian may need to provide additional documentation with their visa application, even if they are travelling with other family members. For further information please see <https://immi.homeaffairs.gov.au/form-listing/forms/1229.pdf>

Biometrics:

Visa applicants outside of Australia will need to provide biometrics when they apply for a visa that is part of the Australian biometrics program, or where they are from a country, or located in a country at time of application that is part of the Australian biometrics program.

For information regarding Australia's biometric program including visas and countries that are part of the program, please see: <https://immi.homeaffairs.gov.au/help-support/meeting-our-requirements/biometrics>

Visa Application Process and Processing Times:

Visa applications are assessed on a case-by-case basis, and actual processing times can vary due to individual circumstances including:

- whether the applicant has lodged a complete application, including all necessary supporting documents and paid associated visa application charges
- how promptly the applicant responds to any requests for additional information
- how long it takes to perform required checks on the supporting information provided
- how long it takes to receive information from external agencies, particularly in relation to health, character, and national security requirements
- when the application is lodged taking the current global visa processing times into account

Processing times are impacted each month by cases that are complex, changes to volume of applications and changes to Ministerial Directions. More information about visa processing times please see: <https://immi.homeaffairs.gov.au/visas/getting-a-visa/visa-processing-times/overview>. For this reason, we would advise that visa applications be lodged at least 4 to 6 weeks prior to a person's intended date of travel.