

# CERAMIC & DIAMOND WATCHES

---

## A. DISPLAYS AND BUTTONS

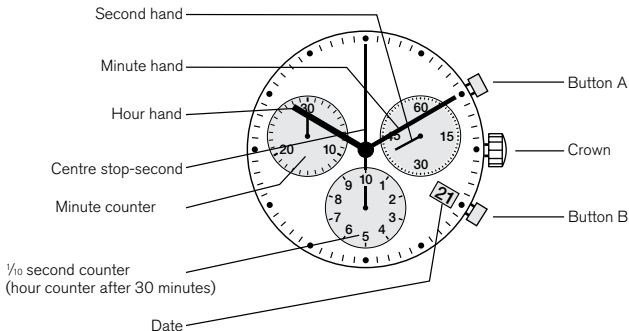

Dial positions and layout of the face might vary depending on the watch model.

## CROWN

These watches have a screw lock down crown. In order to pull the crown out for various adjustments the crown must first be unscrewed by unwinding in a counter clockwise direction. When adjustments have been finalised and the crown is returned to position I as denoted in the diagrams the crown must then be pushed down and screwed back into place to lock down.



michael hill

## B. USING THE CHRONOGRAPH

(Start / Stop / Reset)

Example:

- 1 Start: Press button A.
- 2 Stop: To stop the timing, press button A once more and read the 3 chronograph counters: 4min/38sec /7/10 sec
- 3 Zero positioning: Press button B.

(The 3 chronograph hands will be reset to their zero positions – ie: the 12 o'clock position).



## C. CHRONOGRAPH: ACCUMULATED TIMING

Example:

- 1 Start: (start timing)
- 2 Stop: (e.g. 15 min 5 sec following 1.)
- 3 Restart: (timing is resumed)
- 4 \*Stop: (e.g. 13 min 5 sec following 3.)  
= 28 min 10 sec

(The accumulated measured time is shown)

- 5 Reset:

The 3 chronograph hands are returned to their zero positions.

Please note:

\*Following 4, the accumulation of the timing can be continued by pressing button A

(Restart / Stop, Restart / Stop, ...)

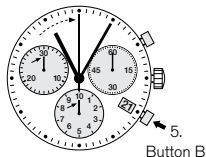
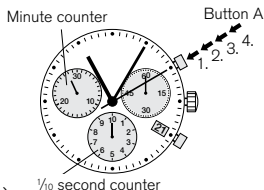

## D. CHRONOGRAPH: INTERMEDIATE OR INTERVAL TIMING

Example:

- 1 Start: (start timing)
- 2 Display interval: e.g. 10 minutes 10 seconds  
(timing continues in the background)
- 3 Making up the measured time:  
(the 3 chronograph hands are quickly advanced to the ongoing measured time).
- 4 Stop: (Final time is displayed)

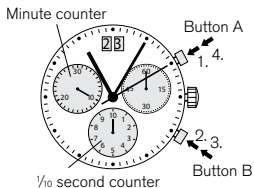

michael hill.

**5 Reset:**

The 3 chronograph hands are returned to their zero position

Please note:

\*Following 3, further intervals or intermediates can be displayed by pressing push-button B  
(display interval /make up measured time, ...)

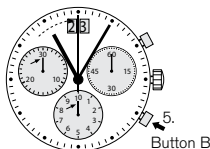

## E. ADJUSTING THE CHRONOGRAPH HANDS TO ZERO POSITION (12 O'CLOCK)

Example:

One or several chronograph hands are not in their correct zero positions and have to be adjusted (e.g. following a battery change).

- 1 Pull out the crown to position III (all 3 chronograph hands are in their correct or incorrect zero position).
- 2 Keep push-buttons A and B depressed simultaneously for at least 2 seconds (the centre stop-second rotates by 360° — corrective mode is activated).  
Adjusting the centre stop second

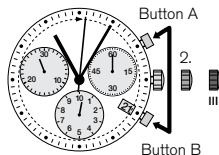
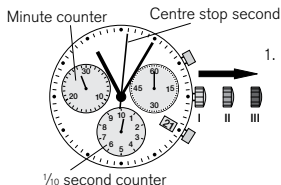

michael hill.

## CERAMIC & DIAMOND WATCHES

Single step ➡ A 1 x short

Continuous ➡ A long

Adjusting the next hand B ➡

Adjusting the  $\frac{1}{10}$  second counter hand (position 6h)

Single step ➡ A 1 x short

Continuous ➡ A long

Adjusting the next hand B ➡

Adjusting the minute counter hand and  
(position 9h)

Single step ➡ A 1 x short

Continuous ➡ A long

③ Returning the crown to position I

Termination of the chronograph hands  
adjustment (can be carried out at any time).

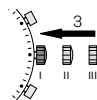

michael hill.

## F. SETTING THE TIME

- 1 Pull out the crown to position III (the watch stops).
- 2 Turn the crown until you reach the correct time 8:45.
- 3 \*Push the crown back into position I.

Please note:

\*In order to set the time to the exact second, 1. must be pulled out when the second hand is in position «60». Once the hour and minute hands have been set, 3. must be pushed back into position I at the exact second.

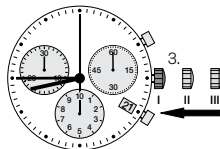
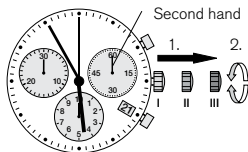

## G. SETTING THE DATE (QUICK MODE)

- 1 Pull out the crown to position II (the watch continues to run).
- 2 Turn the crown until the correct date 01 appears.
- 3 Push the crown back into position I.

Please note:

The date can be changed during the date changing phase between 9:00 PM and 12:00 PM; please note that the date must be set to the date of the following day as in this case the automatic date changing does not occur at midnight.

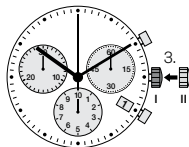
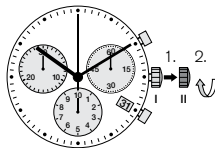

michael hill.

## H. SETTING THE DATE/TIME

Example:

- Date / time on the watch: 17 / 1:25 AM
- Present date / time: 04/ 8:30 PM

- 1 Pull out the crown to position II (the watch continues to run).
- 2 Turn the crown until yesterday's date appears 03.
- 3 \*Pull out the crown to position III (the watch stops).
- 4 Turn the crown until the correct date 04 appears.
- 5 \*\*Continue to turn the crown until the correct time 8:30 PM appears.
- 6 Push the crown back into position I.

Please note:

\*\*To set your watch to the exact second, please refer to the chapter entitled «setting the time».

\*\*Please observe the AM/PM clock rhythm.

