

Lake Eola Pocket Park

Orlando, Florida

Client:
City of Orlando
John Perrone, Project Manager
tel. 407.246.3260
John.Perrone@orlando.gov

Total Cost:
\$750,000

Nature of Work:

Located at the northeast corner of the intersection of Central Boulevard and Rosalind Avenue, the new Lake Eola Pocket Park offers residents and visitors a beautiful, comfortable space while preserving the charm and health of Downtown Orlando. Awarded under our Continuing Architectural Services Contract with the City of Orlando, Borrelli + Partners developed the landscape and irrigation design for the new park. The project also includes hardscape construction, new stormwater drainage, new lighting, new irrigation system, site grading, site furniture, and additional streetscape elements.

The establishment of Eola Pocket Park marks a significant milestone in the ongoing efforts of the Orlando Land Trust to improve and protect parks, playgrounds, and green spaces. Raising \$3.25 million, this non-profit organization aimed to acquire property at the heart of the city, to prevent further development. The land was then donated to the City of Orlando, setting the stage for the creation of Eola Pocket Park. This initiative represents a broader commitment to preserving green spaces and elevating the quality of life for local residents.

Borrelli + Partners played a pivotal role in shaping the park's design, ensuring that it seamlessly integrates into the urban location while offering a serene retreat from the city's hustle and bustle. The contemporary grey tones of the pavers blend effortlessly with the vibrant hues of the park's mural and the greenery of the palm trees, creating a visually captivating landscape. In essence, Eola Pocket Park stands as a testament to collaborative efforts aimed at fostering sustainable urban development and enriching the lives of those who call Orlando home.

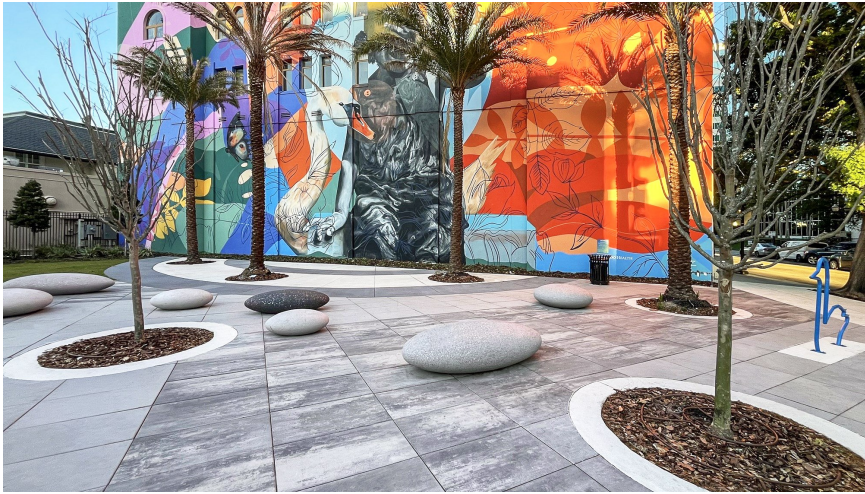

BORRELLI + PARTNERS
ARCHITECTURE PLANNING LANDSCAPE INTERIORS