

## Order Form – TT and Symes

### Custom Liner *Uneo Unique* 6Y400, 6Y402 & 6Y404

### Custom Liner *Skeo Unique* 6Y700, 6Y702 & 6Y704

Complete and send order to: [order@ottobock.se](mailto:order@ottobock.se)

Contact	Customer number	Date
---------	-----------------	------

#### Customer

Company	
Street	
Postal code	City
Email	
Order	

#### Shipping address (if different from customer address)

Company	
Street	
Postal code	City
Email	
Patient ID	
Order ID (iCC)	

**Important**  
If the order form is not filled in completely, production can only start after clarification of open points and this results in a corresponding extension of the delivery time. In the case of replacement orders, wall thickness tolerances of ± 1mm may occur.

#### Amputation information

Left                      Right  
 Transtibial              Symes              Other .....

#### Measurements

Extend dimensions as needed. Mark all problem areas on the scan, graphic or plaster.

#### Product selection

Uneo Unique (Polyurethane) (6Y4)

Skeo Unique (Silicone) (6Y7)

#### Product Type

New Liner (...00)

Replacement Liner (...02) (Serial No.: .....

Alteration Liner (...03) (Serial No.: .....

#### Locking Mechanism

Yes\* (L):      Pin      DVS (Select Partial Textile Cover)  
 No (C)

\*Locking Liners must have exterior textile selected

#### Exterior Textil Cover

Uncovered (W)

Partial Cover (F) (Standard: bonding up to 10 cm above MP)

Partial Cover Height: ..... mm

Full Textile Cover (T)

Textile Color:      Anthracite (7)      Grey (1)      Tan (0)

For liners with textile cover, the wall thickness increases by 1 mm.

#### Wall Thickness

Tapered\*

Uniform:      4 mm      5 mm      6 mm

\* Uneo Unique: 6 mm from MPT to 3 mm proximal  
 \* Skeo Unique: 4.5 mm from MPT to 2.5 mm proximal  
 Manufacturing tolerance is +/-1 mm.

#### Distal Cushion

Standard 13 mm

7 mm      9 mm      11 mm      15 mm

17 mm      19 mm      21 mm

For liners with distal connection, the distal wall thickness increases by 10 mm.

#### Additives

With Skinguard - antibacterial additive (G)

Otto Bock Scandinavia AB  
 Postal: Box 4041, 169 04 Solna, Visiting: Barks väg 7, Solna · Sweden T+ 46 11 280689 · [info@ottobock.se](mailto:info@ottobock.se) · [www.ottobock.se](http://www.ottobock.se)

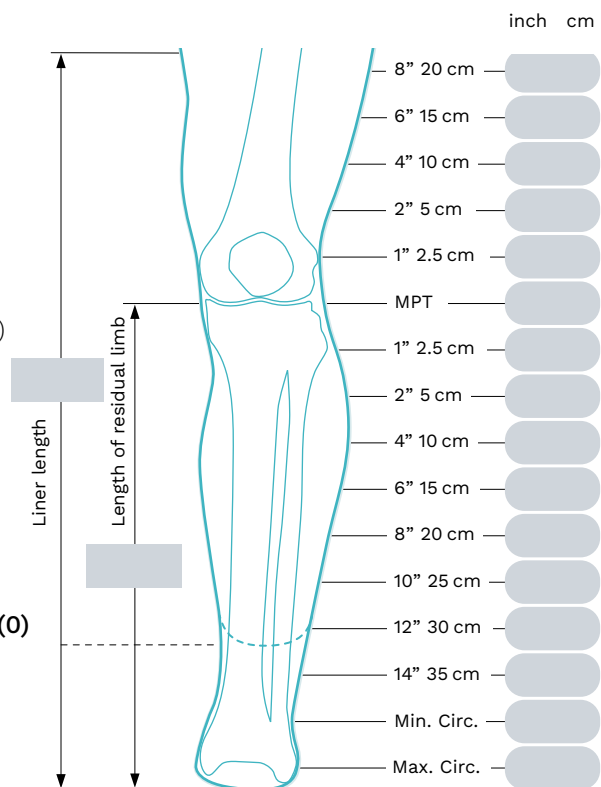

For limbs > 4"/ 10 cm in length the cast or scan should be taken in ≤10° flexion and at least 8"/ 20 cm above MPT. For limbs < 4"/ 10 cm in length take cast in 20° for best results.

Ottobock maintains all rights, title and ownership to the custom liner mold and will keep the mold on file for 2 years from the last order date.

## Casting for *Skeo Unique* and *Uneo Unique Liner*.

1. Complete all required sections of the Order Form, including limb circumferences.
2. Apply parting agent to the limb, stopping 25 cm (10") above MPT.

**Normal Skin:** Wrap the limb with plastic wrap or cover with lubricant.

**Skin with Invagination or Scarring:** Invaginations or deepscarring that do not close when cupped by hand are rare; only 1 – 2 % of all patients. If you encounter one of these cases, fill the invagination/scar with plaster bandage wrap. Apply petroleum jelly to the remainder of the limb.

Avoid getting petroleum jelly on the bandage wrap. Make a note on the Order Form to alert Ottobock of the invagination/scar.

3. Pull a thin casting sock over the limb to a height of 25 cm (10") above MPT.

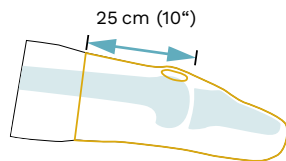

4. Mark the MPT on the casting sock with an indelible pencil. This mark is used by the Ottobock technician when manufacturing the custom liner.

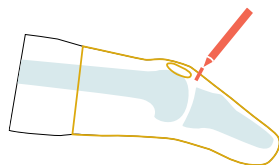

5. Mark a spot on the thigh 23 cm (9") above the MPT mark as a reference for the top of the cast. Have the patient hold their limb at 10° of flexion.

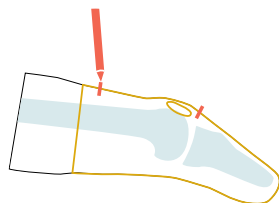

6. Cast the limb with plaster bandage starting proximally at the mark.

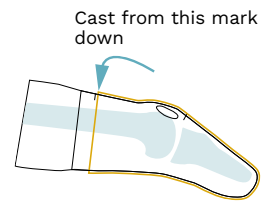

7. Apply 4 layers of nylon or a casting sock over the cast.

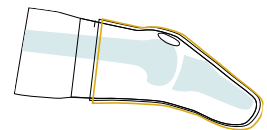

8. Apply casting bag. Extend it up to the thigh to form a seal.

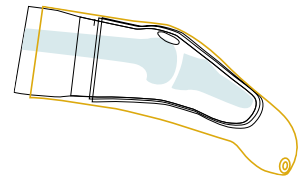

9. If necessary, lightly support any distal, redundant soft tissue that gravity has caused to drop so that it remains in line with the rest of the lower limb until the plaster has set. The reason to support the soft tissue is to avoid producing a liner that tends to hold soft tissue off center.

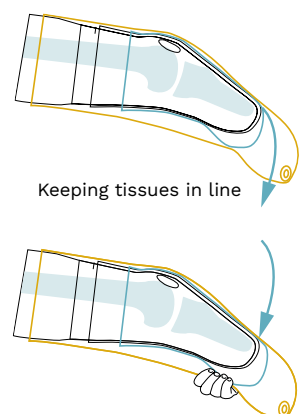

10. Place the knee at 10° of flexion and turn on the casting pump. Maintain vacuum until the cast has set.

**Note:** For limbs less than 4" long, a 20° knee flexion gives best results.

11. Write the patient ID on the cast and ship with completed order form to Ottobock.