

CELL Alpha

Ceiling Mount Assembly
& Installation



Socket
+ Security Screw



Cosmetic Plate



Bracket

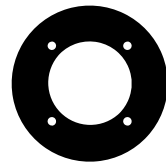

Leveling Plate
(Optional)

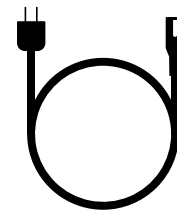

Power Cord

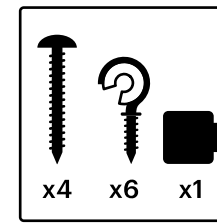

Hardware Box

Note: Adjust the height of Cell Alpha by adding extension tubes to a maximum of 4. The Ceiling Mount can be installed in any ceiling pitch or beam up to 90°.

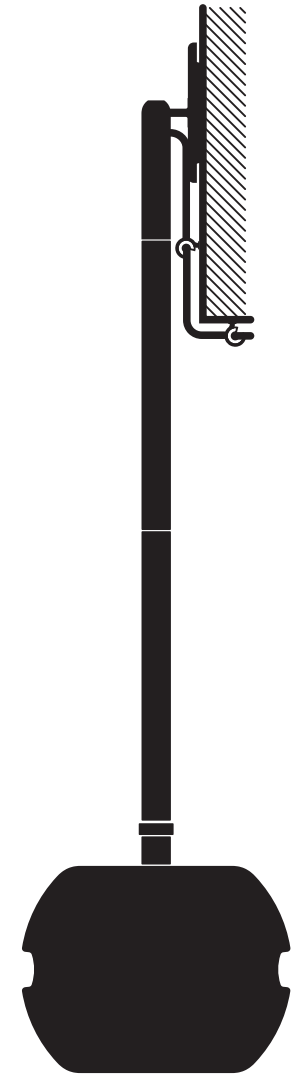
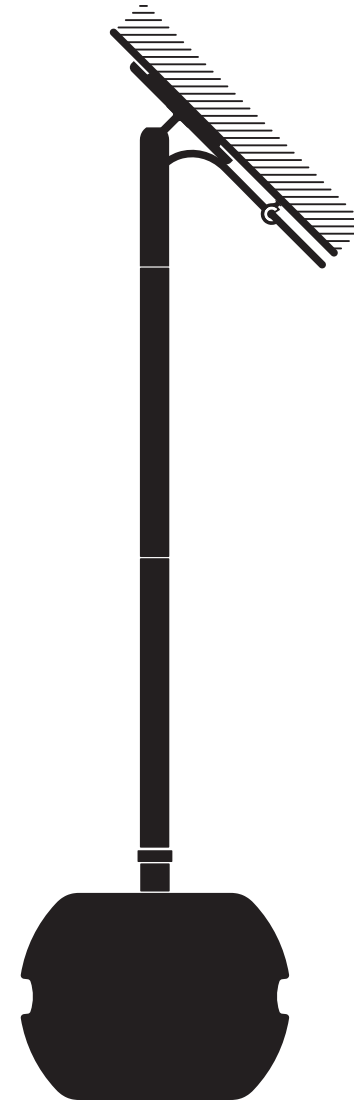
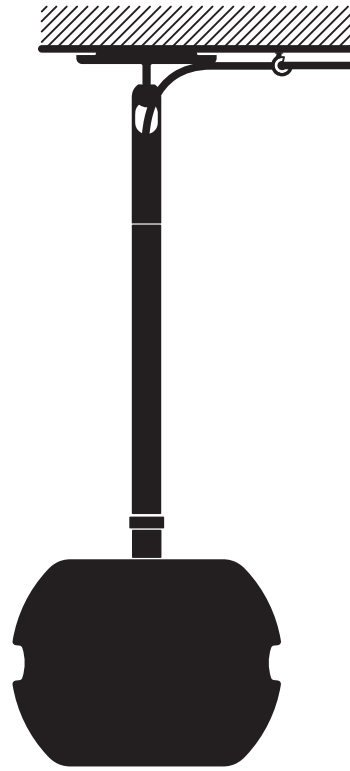
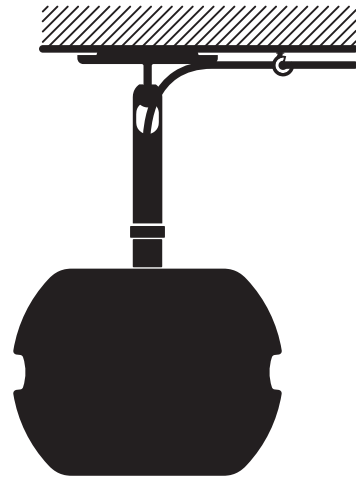

⚠ If you have just unboxed a new Cell Alpha, please keep the protective wrap on Cell Alpha during assembly and use the shipping cradle to stabilize.

1 Pass the Power Cord through the Socket and optional extension tubes.

! Install the Ferrite near the end of the Power Cord where it connects to the Cell for optimal performance.

Note: If you have purchased extension tubes connect them together with the Socket.

To purchase extension tubes please go to:
syngspace.com/shop

2 Plug the Power Cord into the Cell.

3 Screw the Socket (+ extension tubes) onto the Cell

! Ensure Cell, extension tubes and Socket are securely hand tightened.

4 Place aside your Cell + Socket assembly and proceed with step 5.

Important! Locate ceiling joists where you plan to install the ceiling mount. The Bracket must be installed with provided Screws into ceiling joists, wooden beams or planked wood. For concrete or other materials please ask a specialist.

Ensure that the Power Cord will reach a power outlet.

5 Use the Cardboard Template to mark the Screws location.



Use a minimum of 2 screws when installing to a ceiling joist.

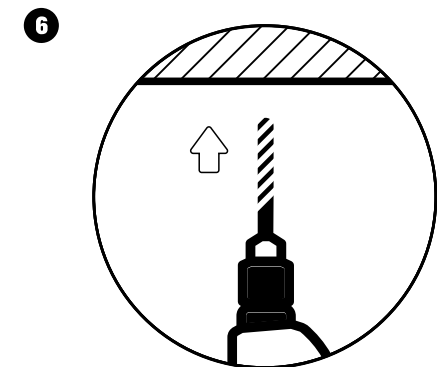
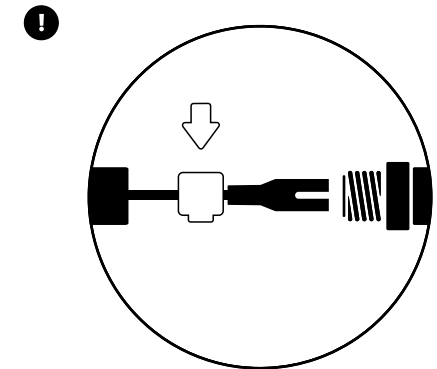
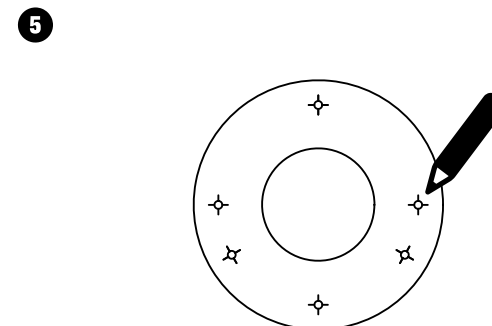
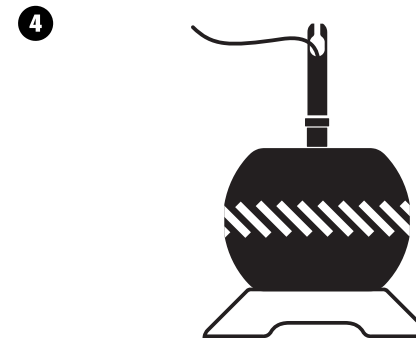
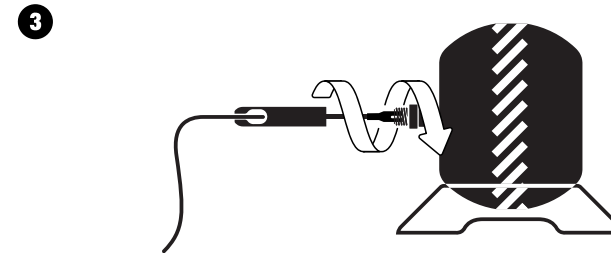
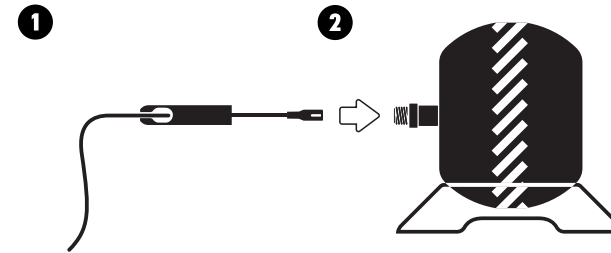

6 Drill pilot holes of 1/8" (3mm) diameter.

7 Install the Bracket using the Screws.

Screws must be installed securely.

8 Install the Cosmetic Plate.

Align the 3 locking features in the Cosmetic Plate with the slots on the Bracket. Rotate the Cosmetic Plate 30° clockwise until you feel a "click" and the locking features are secured into place.

9 Hang the Cell + Socket assembly from the Bracket.

Hold the Cell + Socket assembly with both hands.

Align the opening of the Socket with the ball joint of the Bracket.

Hook the ball joint fully into the Socket opening. Slowly release the Cell after the ball joint and Socket are hooked, making sure that the connection is properly installed.

* Make sure Power Cord is clear of ball joint and Socket.

10 Install the Security Screw into the threaded hole of the Socket.

Make sure the Security Screw is fully tightened.

11 Now you can remove the Protective Wrap.

12 Use the hooks and grommets provided to route the Power Cord along your ceiling.

Plug the Power Cord into the wall socket and follow Cell setup instructions in Syng Space.

⚠ Warning: Mounting the Bracket in a manner not in accordance with the provided instructions voids warranty and safety guarantees.

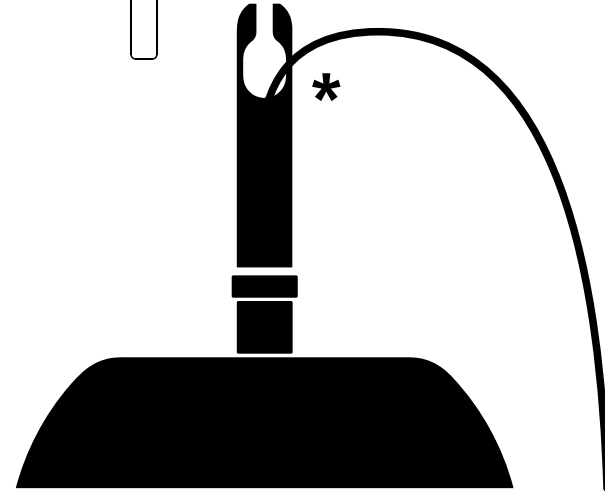
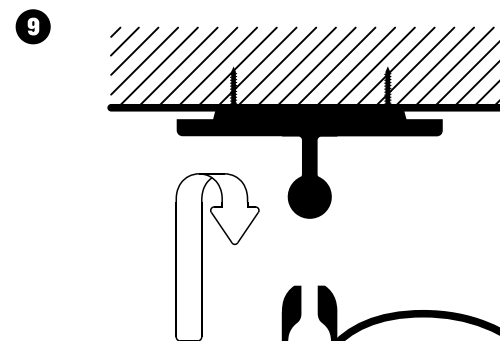
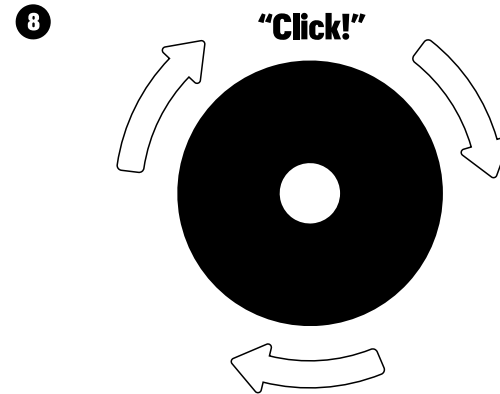
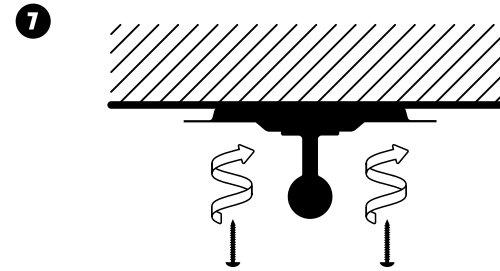

Note: Use the Leveling Plate included when installing the Bracket on an uneven surface.

Please contact customer support if you have any questions.

support@syngspace.com

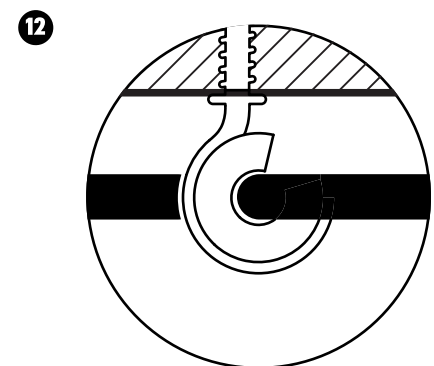
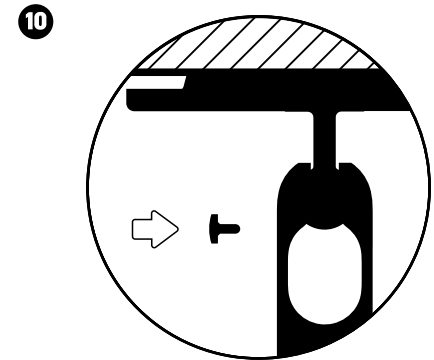

Extension Tube Assembly

