

CELL Alpha

Table Stand Assembly

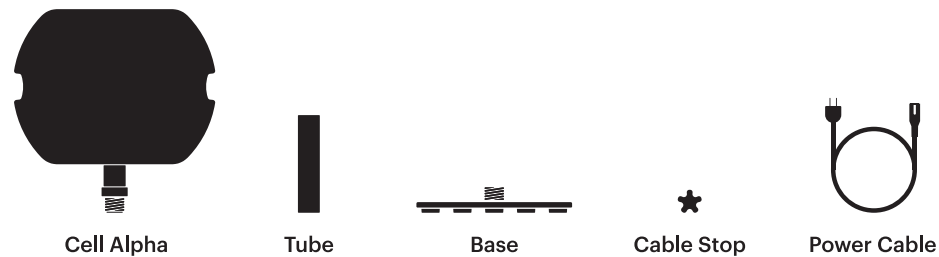

⚠ Keep the protective wrap on Cell Alpha during assembly and stabilize in shipping cradle.

Garder l'emballage de protection sur le Cell Alpha pendant l'assemblage et le stabiliser dans le support d'expédition.

1 Pass the power cable (+ optional Syng Link) through the base, then through the tube

Passer le câble d'alimentation (+ le lien Syng optionnel) à travers la base, puis à travers le tube

2 Plug the cable(s) into Cell Alpha

Brancher le ou les câbles dans le Cell Alpha

3 Screw the tube onto Cell Alpha

Visser le tube sur le Cell Alpha

4 Screw on the base

Visser sur la base

5 Insert the cable stop to secure the cable(s)

Introduire la butée de câble pour fixer le ou les câble(s)

6 Stand Cell Alpha up, remove the protective wrap and connect to power

Mettre le Cell Alpha en position verticale, retirer l'emballage de protection et le brancher

7 Download the Syng Space app to complete setup

Télécharger l'appli Syng Space pour terminer la configuration

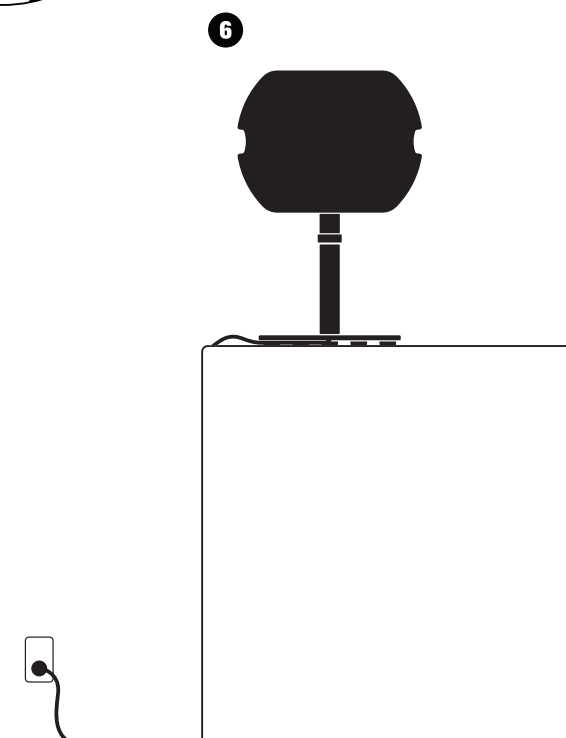
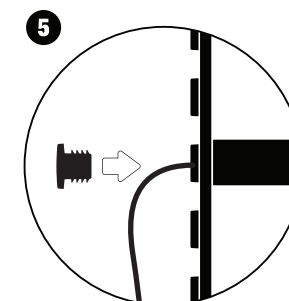
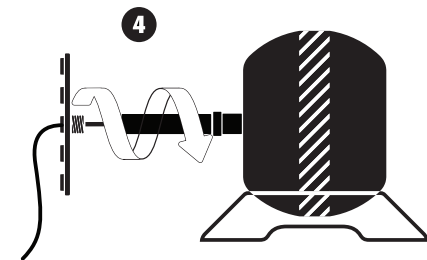
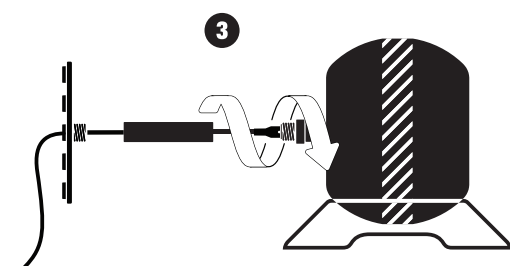
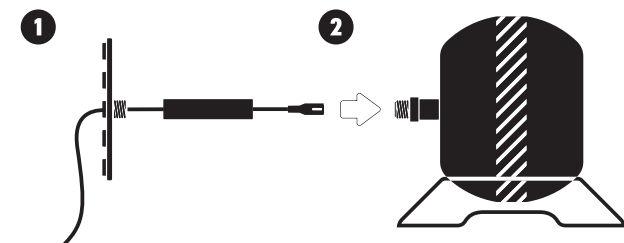

We're here for you.
syngspace.com/support
support@syngspace.com