

SMART HOME MONITORING



# Smart Door Lock

Manufacturer's Installation Guide

# Package Contents

1. Quick Start Guide
2. Installation Instructions
3. Door Marker
4. Touchpad (Outside Escutcheon)
5. Latch (Inside Escutcheon)
6. Inside Mounting Plate
7. Battery Cover
8. 4 AA Alkaline Batteries
9. Deadbolt
10. Strike Plate
11. Screw Pack
  - › 2 Through Bolts
  - › 4 Bolt & Strike Mounting Screws
  - › 3 Latch Mounting Screws
12. Keys

## Tools Required:

1. #2 Phillips screwdriver
2. Flathead screwdriver

# Door Lock Compatibility Check

**Note:** Do not remove any elements from the door except door lock deadbolt.

1. Door should have two holes one for deadbolt and one for the handle. Mortise doors and all in one handle locks are not compatible.

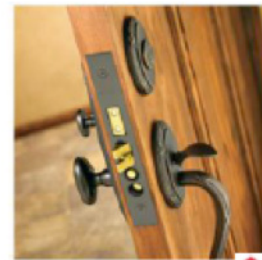

2. Ensure there is enough clearance space above and below bore holes so that installation of lock is not obstructed. Look for chain locks, glass windows or any other possible obstruction within 2" above and below bore holes and 1" on either side.

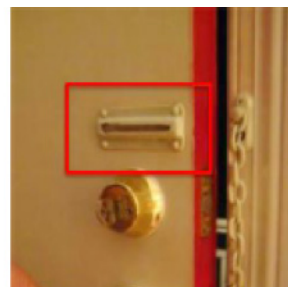

- Check door thickness. Standard door sizes between 1 3/4" to 2 1/4" are fully compatible. Doors inbetween 1 3/8" to 1 1/4" require use of thin door gasket on the inside components.

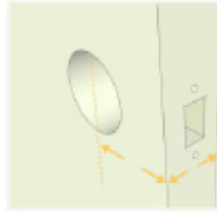

- Check for proper alignment of door by ensuring door unlock and locks smoothly with existing set-up.

#### Compatibility Summary:

Indicator	Compatible	Requires Modification	Not Compatible
# of Holes on Door	The door has 2 holes, one for a deadbolt and the other is a passage knob or lever. Verify 2 individual latches.	There is only 1 hole on the door (additional hole required)	Mortise lock installed on the door.
Additional Hardware (above)	There is no additional hardware above the existing deadbolt	There is hardware above the existing deadbolt but it can be removed or modified	There is hardware above the existing deadbolt, it cannot be modified or removed and would interfere with installation
Additional Hardware (below)	There is sufficient space between the deadbolt and the hardware below – at least 2" below the deadbolt	There is other hardware in very close proximity to where the deadbolt would be installed and can be removed	The hardware below the deadbolt will interfere with installation and it cannot be removed
Door Thickness	1-3/4"---- 2-1/4" No additional parts required  1-3/8"----1-3/4" Thin door gasket kit required		Less than 1-3/8" or greater than 2-1/4"
Ease of Locking	The door closes and locks easily with existing hardware without excess force		The door is extremely difficult to close and lock with existing hardware
Rogers SHM Door Lock Compatible?	Yes	Yes	No
Rogers SHM Door Lock Installation Service Available?	Yes	No	No

# Preparing Door Lock for Installation

The lock is packed representative of how it will install on the door. Before installing the lock on the door:

## 1. Inside Latch Side

- › Loosen the screw (Phillips #2) holding the battery cover.
- › Slide the battery cover up and out (note the two tabs at bottom of battery cover). (Fig. 1A).
- › Remove the inside mounting plate (with gasket) from back (door side) of the inside latch (Fig. 1B).

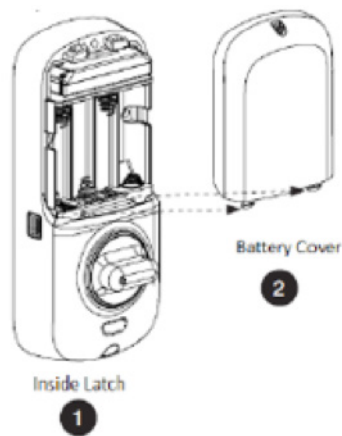
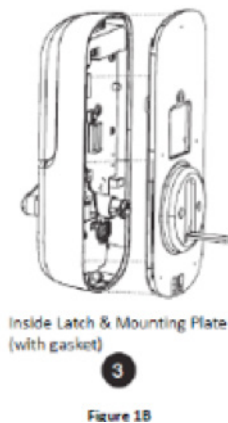

Figure 1A



## 2. Inside Mounting Plate

Ensure that gasket on inside Mounting Plate is properly fitted. Note the positioning of the gasket's five rubber nubs (Fig. 2).

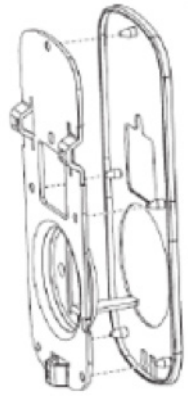
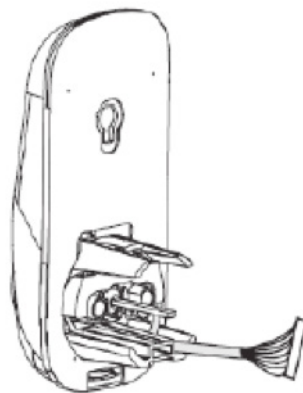

Figure 2

## 3. Outside Touchscreen Side (with gasket)

Remains assembled (Fig. 3).



Outside Touchscreen

Figure 3

# Choosing Latch Type

There are two latch options:

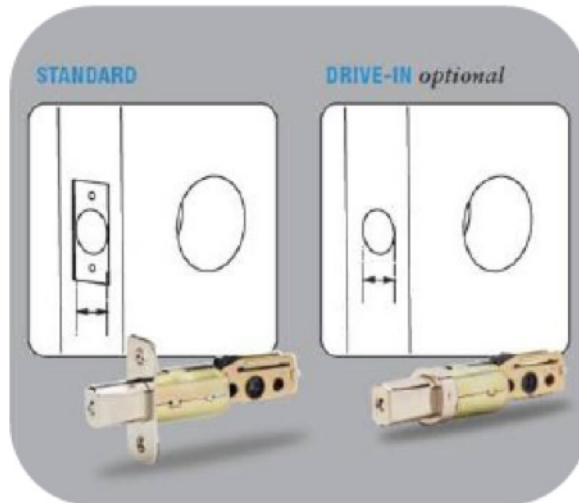

- › For doors with a pre-existing notch for the faceplate, the standard Yale deadbolt can be used.
  - › For doors with only the deadbolt bore hole, use the drive-in latch.
1. When inserting the deadbolt into the door make sure it is inserted with the up arrow pointed upwards.
  2. Install deadbolt in door. Note: the deadbolt must be in a retracted (unlocked) position when installing the lockset. For the standard Yale deadbolt, secure bolt to door with two (2) M4 x 25.4mm [8-32 x 1"] screws supplied.
  3. Install strike on the door frame, making sure to allow for the bolt to be centred in the strike. Secure strike to frame with two (2) M4 x 25.4mm [8-32 x 1"] screws supplied.

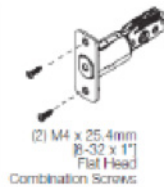

# Installation

1. Install Outside Touchscreen side of the lock first (Fig. 1A). Route wire harness through bore hole under bolt (Fig. 1B). Ensure tongue slides through black deadbolt hole (Fig. 1B arrow pointed).

**Note:** Wire harness goes under bolt (Fig. 1B).

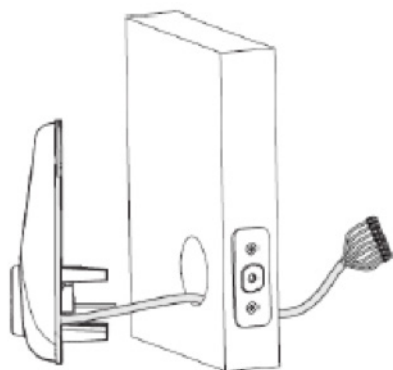

Figure 1A

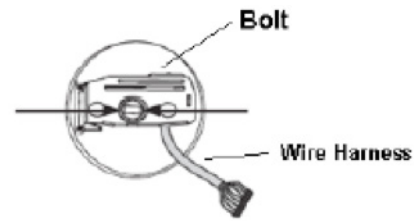

Figure 1B

2. Holding the Outside Touchscreen side of the lock flush to the door, position the inside mounting plate by first routing the wire harness through the mounting plate's 1/2" hole (Fig. 2) then inserting mounting plate "Tongue" into groove at the bottom of the touchscreen part of the lock.

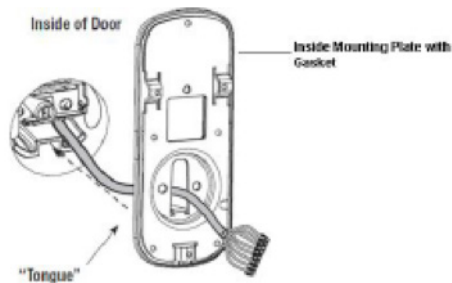
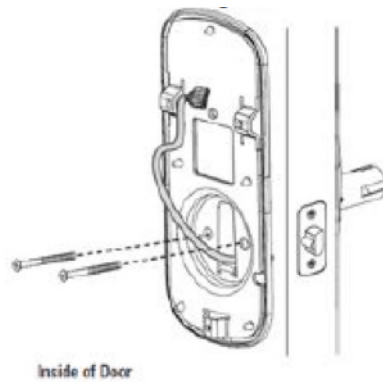

Figure 2



3. Secure both assemblies using (2) M6 x 59.5mm pan head machine screws (Fig. 3), making sure that outside of the lock is vertically aligned. Do not over tighten.



**Figure 3**

4. Attach cable assembly connector to the inside part of the lock PC board by lining up notches on top of cable connector to slots on PCB connector (Fig. 4).

Connector should be pressed in firmly until completely seated.

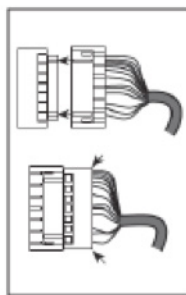

**Figure 4**

5. Using care position and bend cable to ensure that the cable lies against the back recessed area of the latch side of the lock.

Hook the cable under the cable hook (Note: label on circuit board) to prevent binding when installing the latch side of the lock over the mounting plate (Fig. 5).

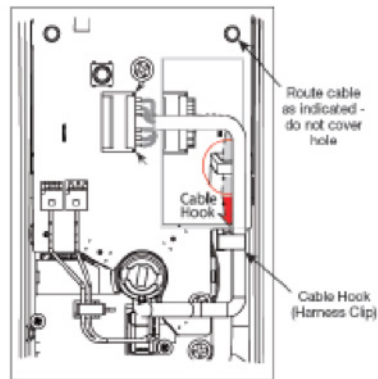

**Figure 5**

6. Install the Inside Latch side of the lock on the inside mounting plate. Note: the horizontal orientation of the tailpiece as you insert the latch side; the latch should be vertical (Fig. 6).

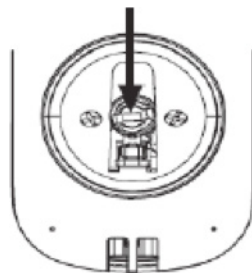
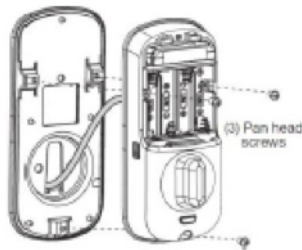

**Figure 6**

7. Install and secure using (3) M4 x 8mm [8-32 x 5/16"] pan head screws through the latch part of the lock into the mounting plate.

**Important:** Before installing the batteries, test the mechanical operation of the lock by operating the latch. The movement of the bolt should be smooth and unobstructed.

**Note:** The bolt must be in a retracted (unlocked) position prior to installing the batteries.



8. Insert four (4) AA alkaline batteries. Install battery cover and tighten Phillips head screw.

Upon powering. The lock will flash and beep several times and respond with the vocal prompt: "Welcome to Yale Real Living."

**Note:** Open Door before initial activation of Door Lock.

Activate Door Lock to adjust for proper handling.



# Installation Checklist

		Description	Check
Physical checks	Door closes fully	Verify that the door can close fully	
	Lock and unlock smoothly using latch	Ensure the door lock unlocks and locks smoothly using the latch when door is closed	
	Lock and unlock smoothly using touchscreen	Ensure the door lock unlocks and locks smoothly using touchscreen when door is closed	
	Ensure Key works	Verify both keys that come with the door lock can operate the lock. Lock the door lock using the key and pull out the key. Unlock the door lock using the key and pull out the key. Refer to section 4.4 of the Yale Touchscreen Deadbolt Troubleshooting Guide if the key is stuck.	
Connectivity checks	Door lock icon is on touchpad	Verify door lock icon is on touchpad and can be controlled through door lock widget	
	Door lock on Subscriber portal and mobile app	Verify customer can log on to subscriber portal and their mobile app and control the door lock	