



Ready to get
connected?

Business WiFi Hub 6

Your set up guide



TalkTalk^o
Business

Before you get started

We want you to get online quickly, so here's your simple, fluff-free guide to setting up your Business Wi-Fi Hub 6.

To start, unplug any broadband equipment including your existing router. Everything you need to get the best broadband connection is in this box.

If you have any questions after reading this guide, visit our help page. It's got expert guidance and tips to make everything easy.

talktalk.business/insights/wi-fi-hub

Here's what's in the box



Business Wi-Fi Hub 6



Power adapter



Micro-filter

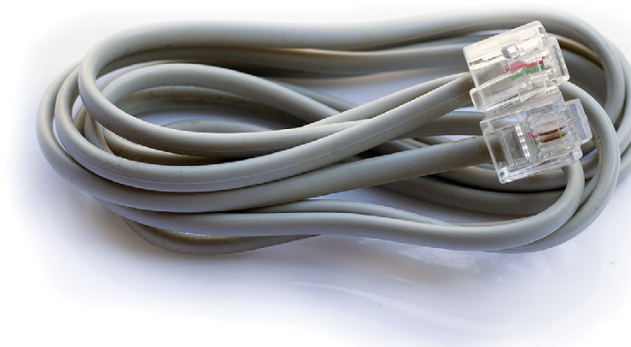

Broadband cable



Ethernet cable

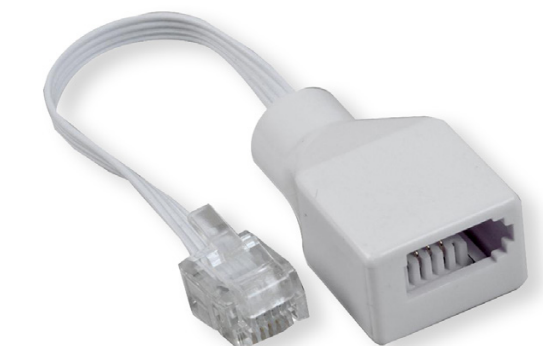

Phone line converter

Get to know your Business Wi-Fi Hub 6

Take your Business Wi-Fi Hub 6 out of the box and take a moment to get to know where everything is. It'll come in handy later.

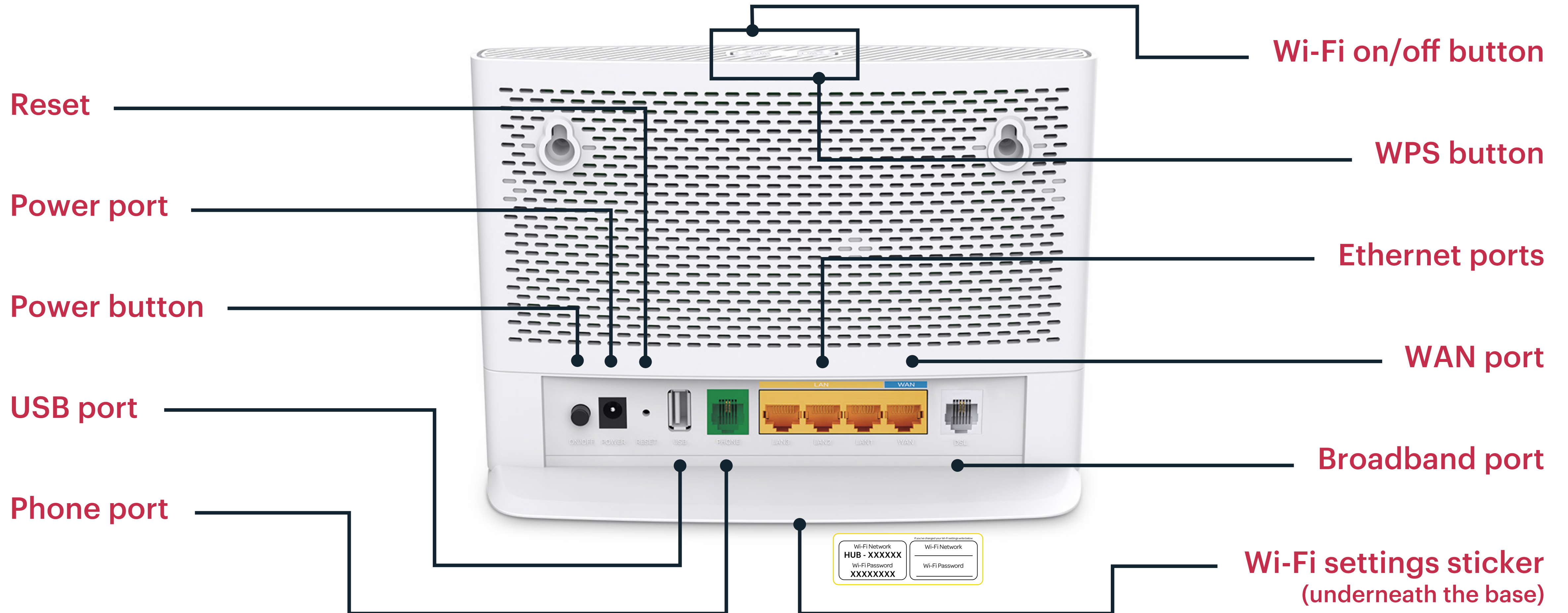

Determining your data and voice services

To find out what broadband service you have, and to determine if you have an add-on voice line service, please check your contract.

Depending on your broadband service, follow the setup instructions for either Business Broadband, Business Fibre or Business Full Fibre.

Landline users should continue to plug their phone into the wall socket*. Alternatively, if you have a digital phoneline, please plug your phone into the specified socket on your TalkTalk Business Wi-Fi Hub 6 as illustrated in the setup instructions.

*Note: if you have ordered a standalone landline, please ensure you plug your phone into the appropriate service.

talktalk.business/insights/wi-fi-hub



Business Broadband

Getting Started and plugging in - Follow steps 1-5 to get connected

Start here if you have a master phone socket.

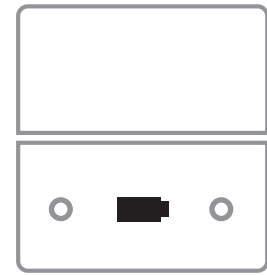

You need to use a micro-filter for every phone socket in your office with any phone or broadband equipment plugged into it.

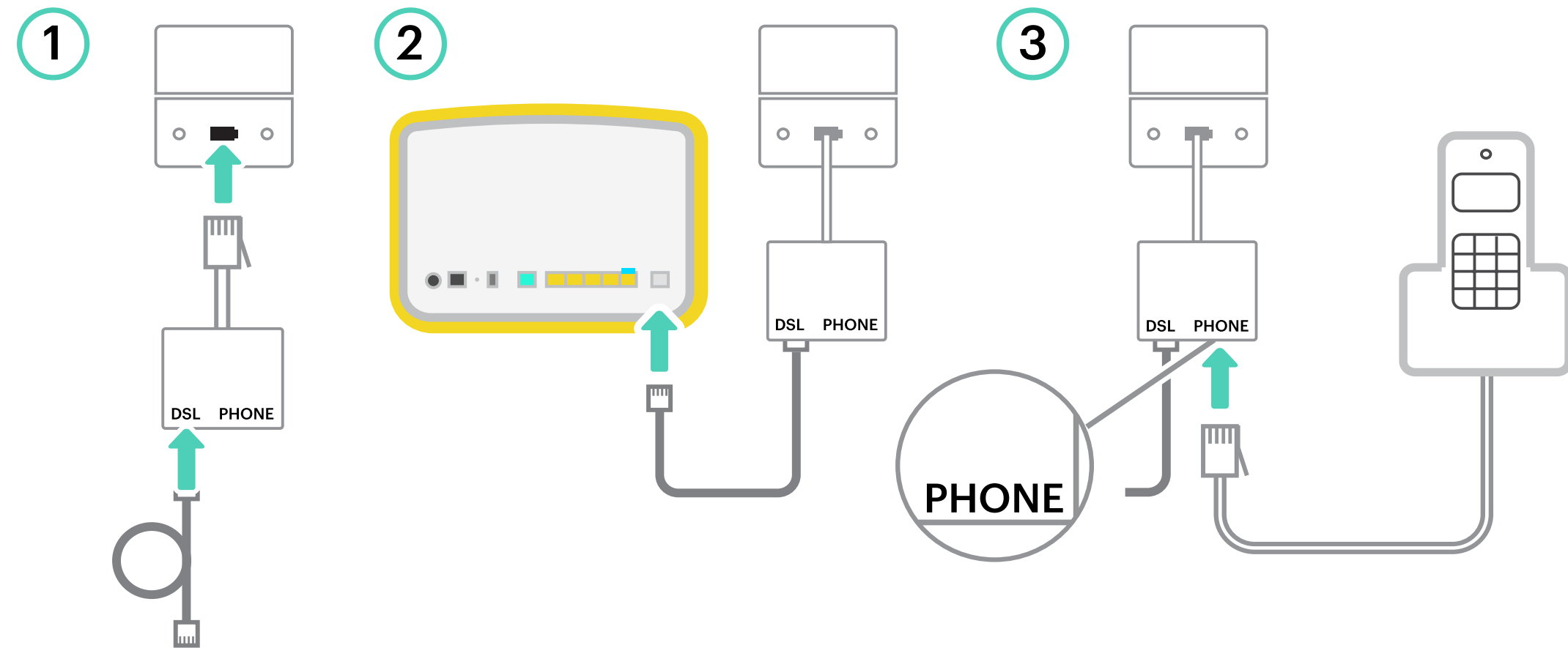

or

Start here if you have a pre-filtered phone socket.

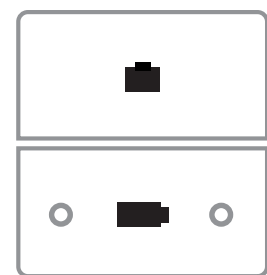

You need to use a micro-filter for every phone socket in your office with phone or broadband equipment plugged into it.

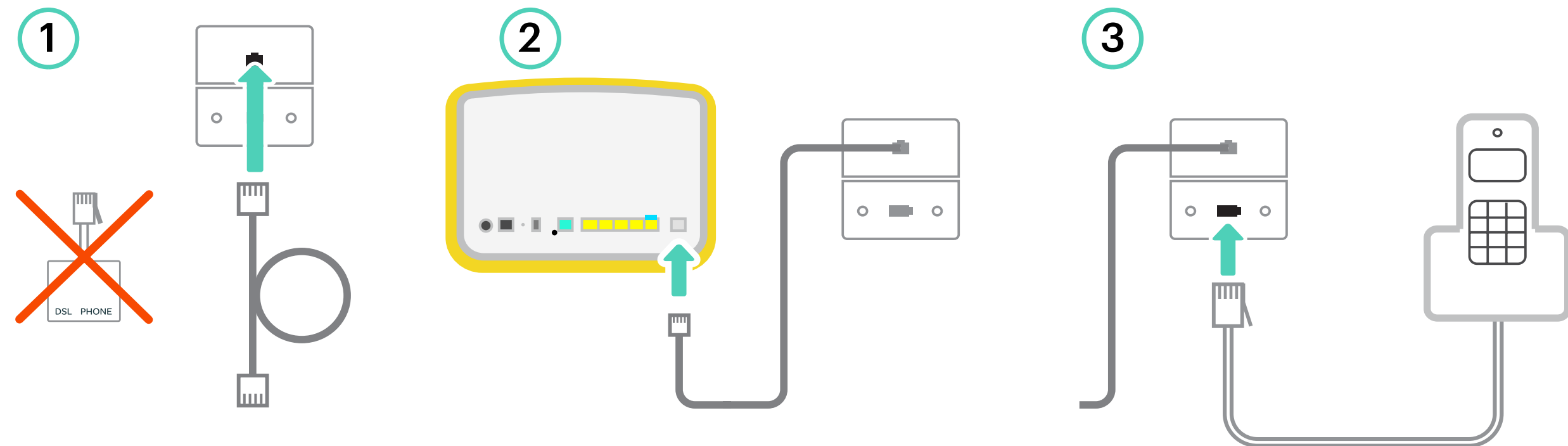

N.B. Do not plug your broadband cable into the phone socket.

Business Fibre

Getting Started and plugging in - Follow steps 1-5 to get connected

Start here if you have a master phone socket.

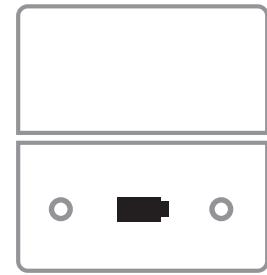

You need to use a micro-filter for every phone socket in your office with any phone or broadband equipment plugged into it.

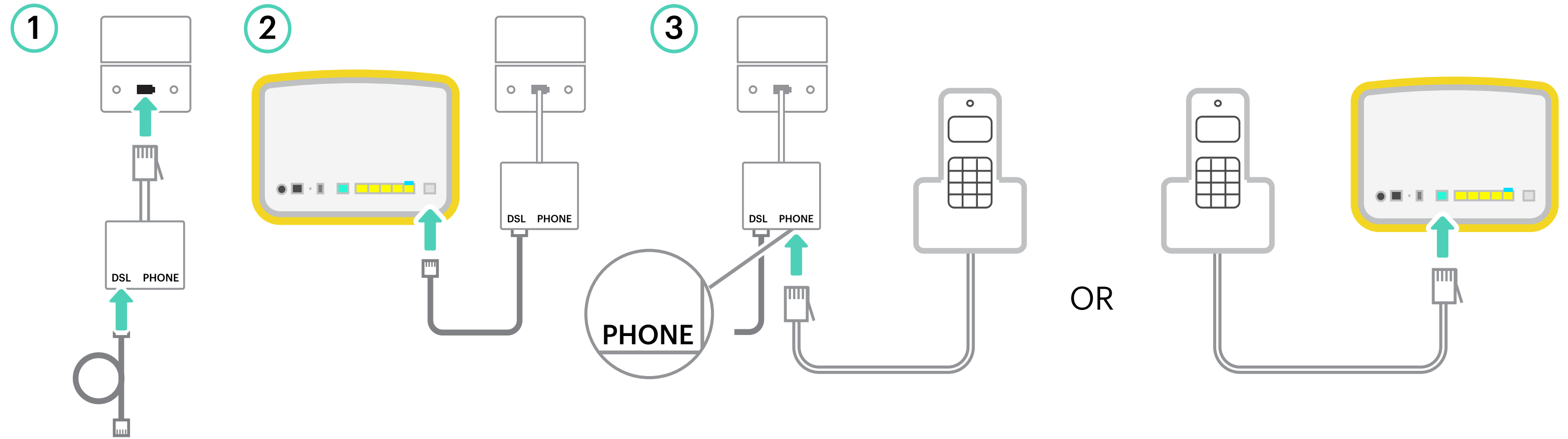

or

Start here if you have a pre-filtered phone socket.

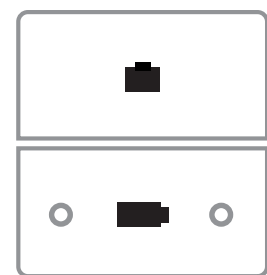

You need to use a micro-filter for every phone socket in your office with phone or broadband equipment plugged into it.

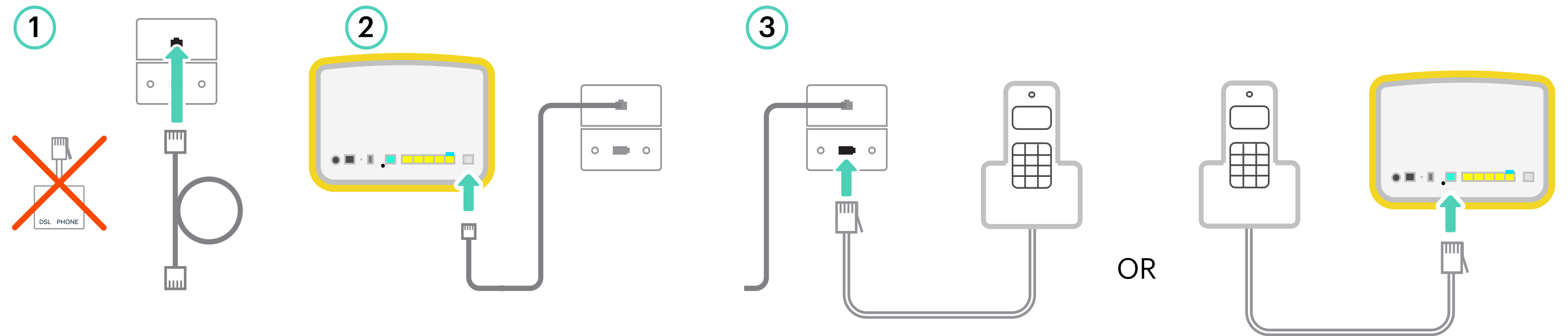

N.B. Do not plug your broadband cable into the phone socket.

Business Full Fibre

Getting Started and plugging in - Follow steps 1-5 to get connected

or

Start here if you have Full Fibre.

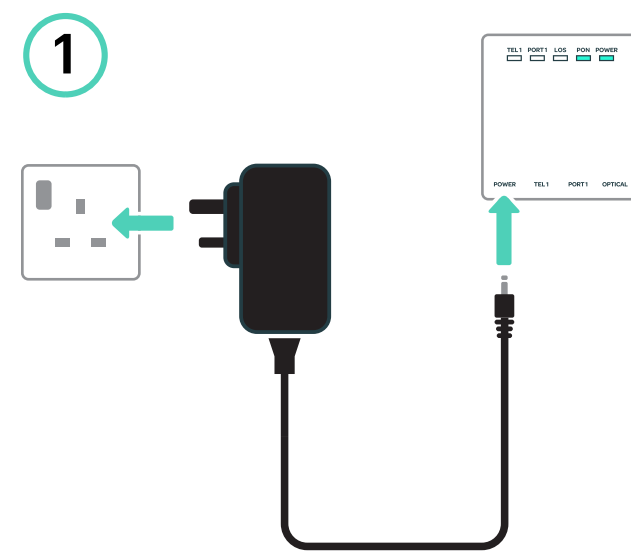
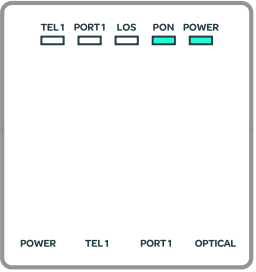

Ensure the Network Terminating Equipment (NTE) is powered on. The NTE may be white or black.

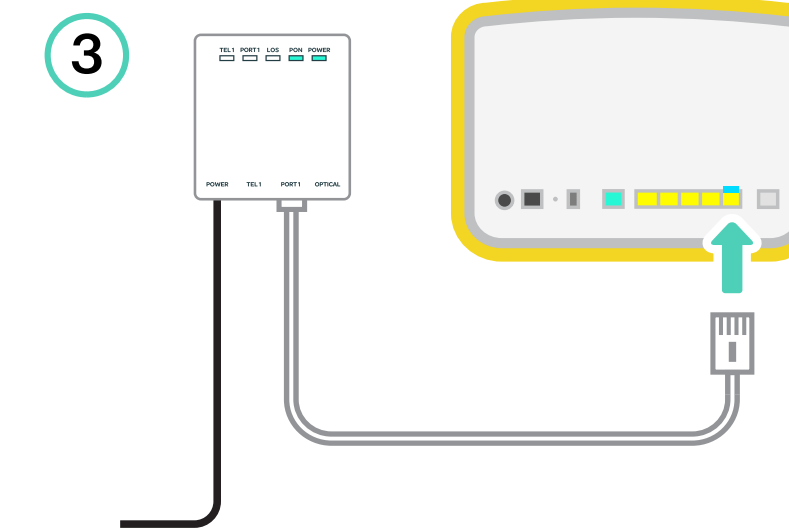
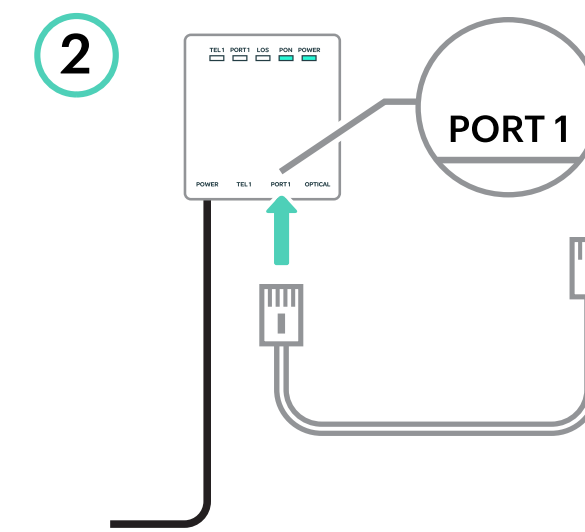

Use the ethernet cable to plug into the WAN port on the Hub.

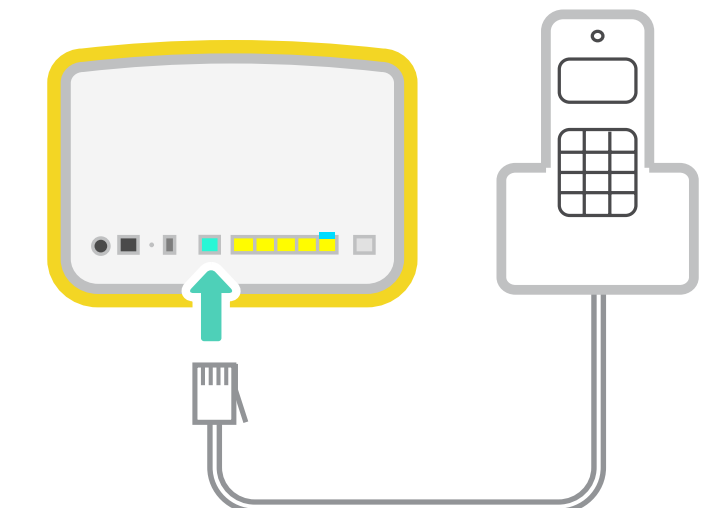

DIGITAL PHONE LINE

If you have a digital phone line, plug your phone into the phone port on the Hub.

Switching on

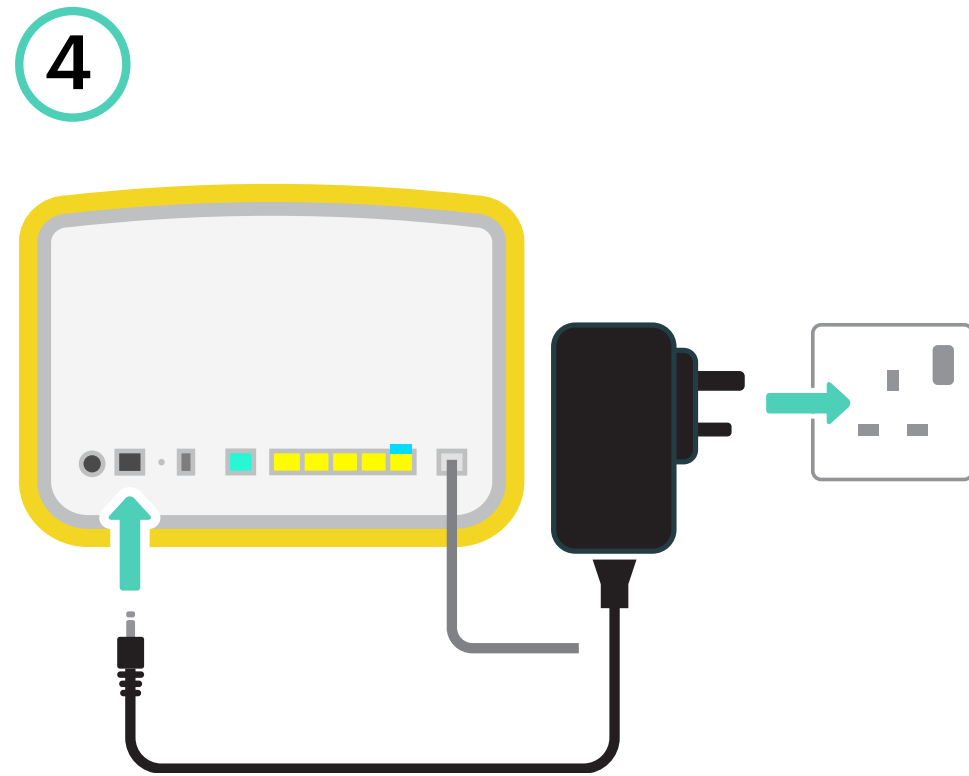

4 Push the power button on the back. A LED light on the front tells you it's on (see status light guide below).

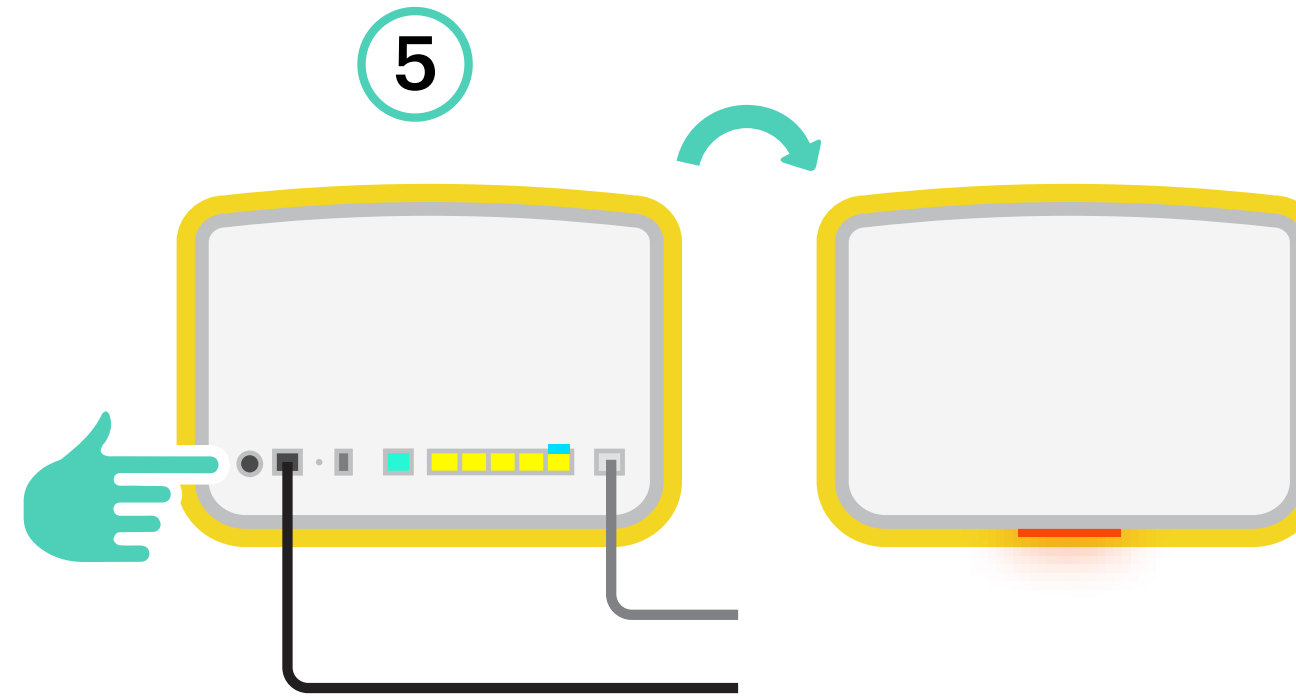

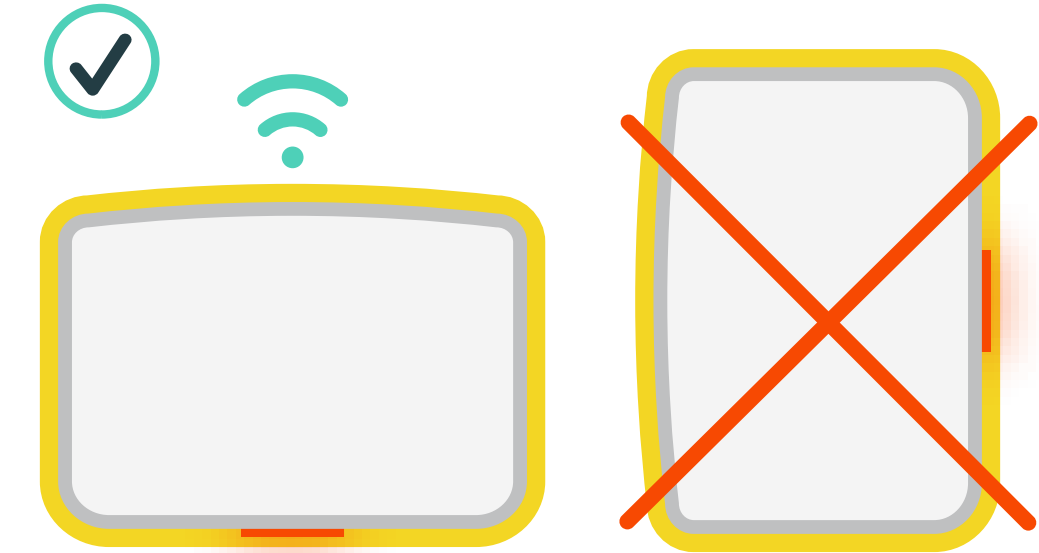

5 Insert the power cable into the Business Wi-Fi Hub 6 and the plug into the wall. Turn on the switch.

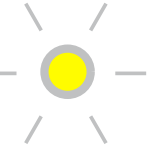
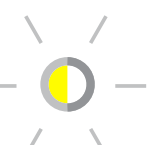

Keep your Business Wi-Fi Hub 6 upright and facing into the room for the best signal.

Status light guide

-  Blinking amber: your Business Wi-Fi Hub 6 is starting up
-  Blinking amber and white: connecting to the internet
-  Solid white: you're connected to the internet

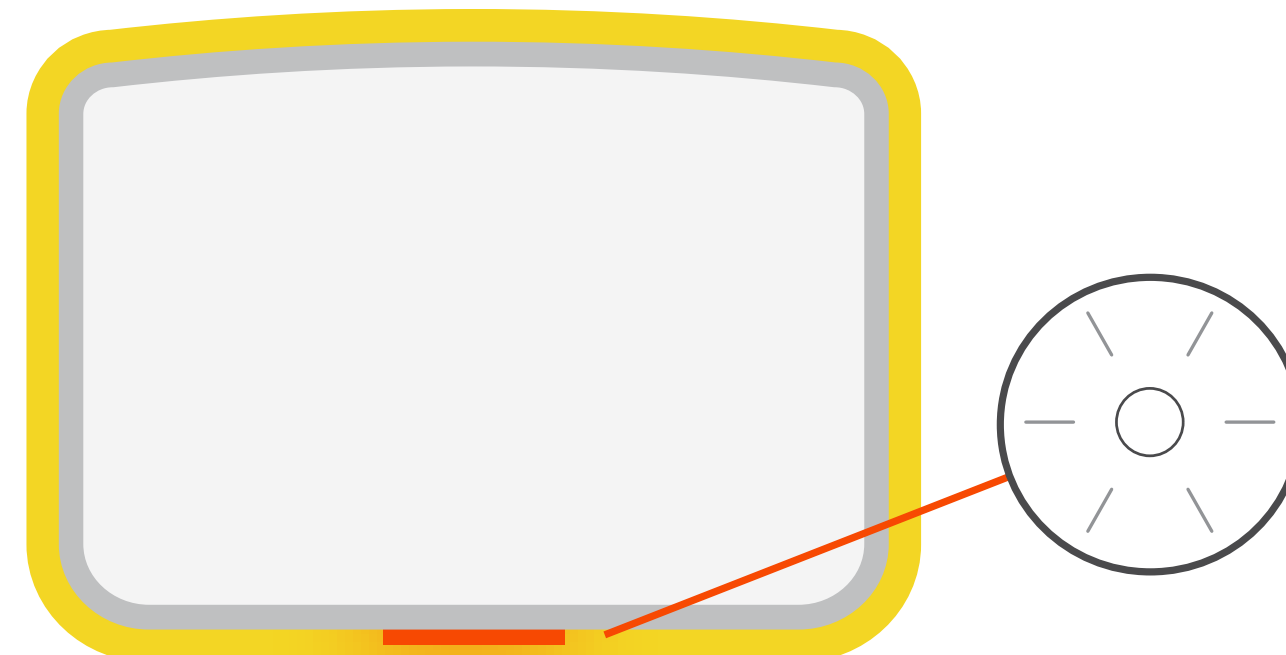

Remember

The first time your Business Wi-Fi Hub 6 is set up, it might take a few minutes as the device needs to download the latest updates which will be indicated by a flashing amber LED light. If the solid white light never comes on, visit talktalk.business/insights/wi-fi-hub

Connect your devices

Wireless connection

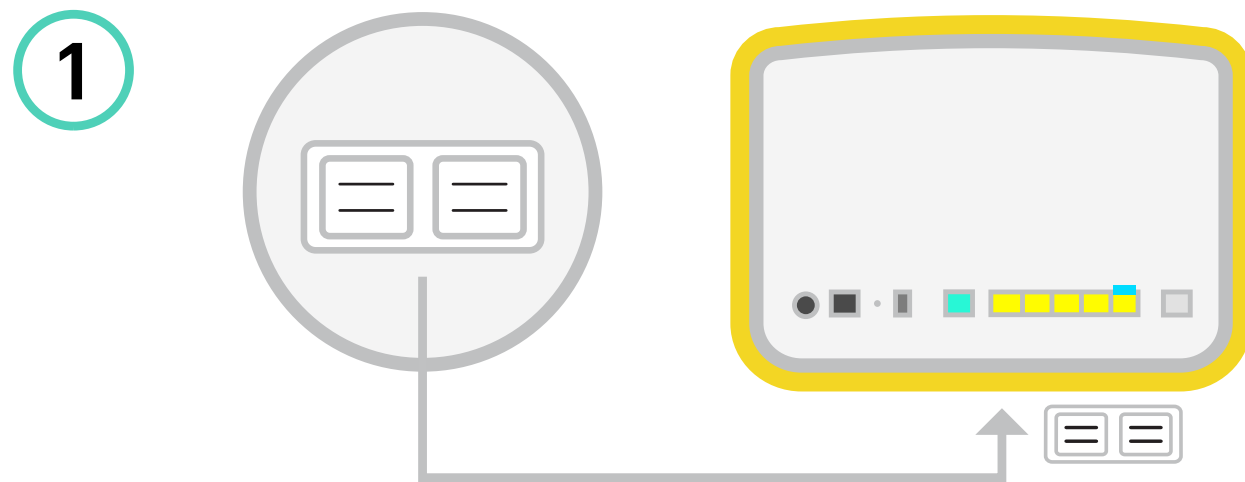

Have your **Wi-Fi settings sticker** handy, you will find it underneath, on base of the unit.

- 2 How you connect varies from device to device (check the manufacturer's instructions). But generally you:
- Go to settings and turn on Wi-Fi.
- Click on your Wi-Fi network name (you'll find it on your Wi-Fi settings sticker).
- Enter the password from your Wi-Fi settings sticker (use CAPITALS).
- Click on 'join' or 'connect'.

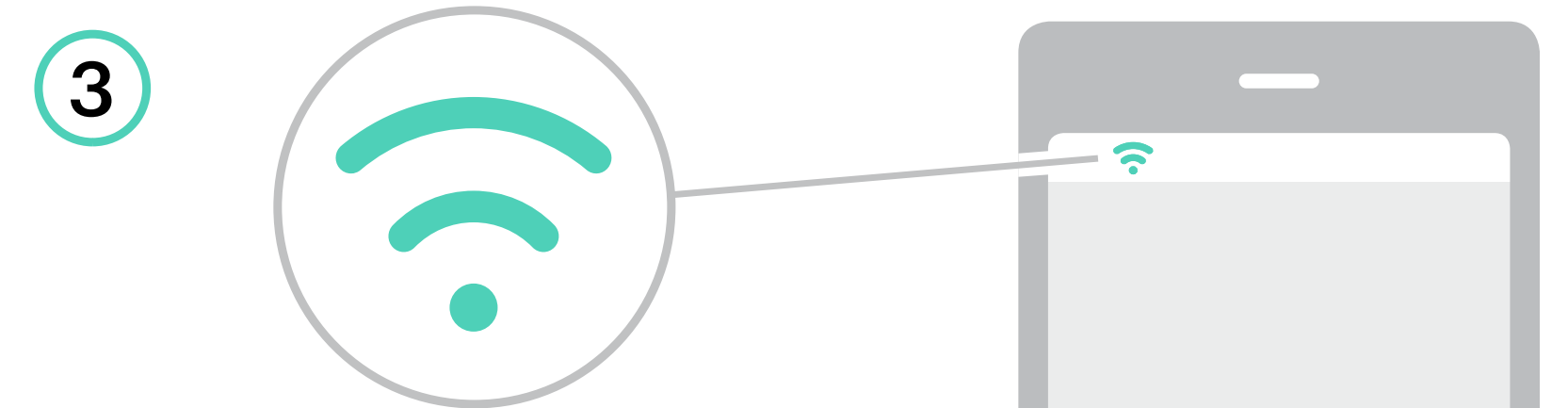

If you see this symbol on your device, you've made the connection.

If not, check your manufacturer's instructions for your device. Phones, tablets and computers can all vary.

Wired connection

Connect the ethernet cable to your device. Plug the other end into any of the yellow ports at the back of the Business Wi-Fi Hub 6. If you have a Full Fibre connection you may have to obtain additional ethernet cables to connect other devices.

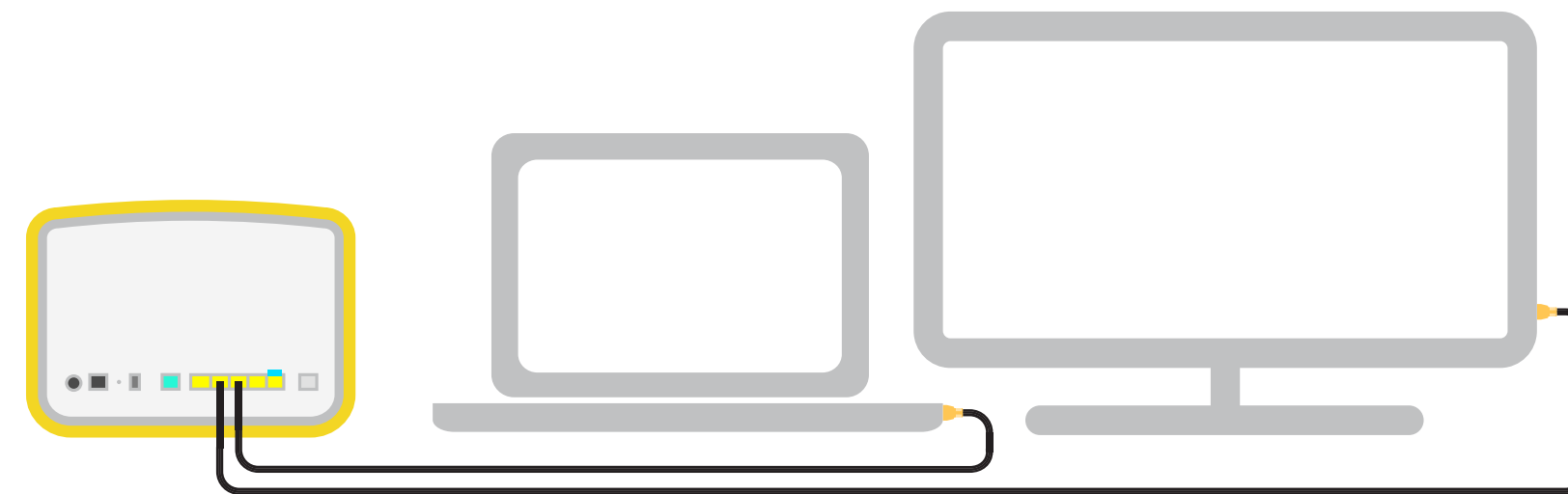

More help online

Want to connect with WPS, change your Wi-Fi network name and password and test your broadband speed? Everything you need to know is at talktalk.business/insights/wi-fi-hub

Top 4 tips to boost your Wi-Fi



Get the best connection

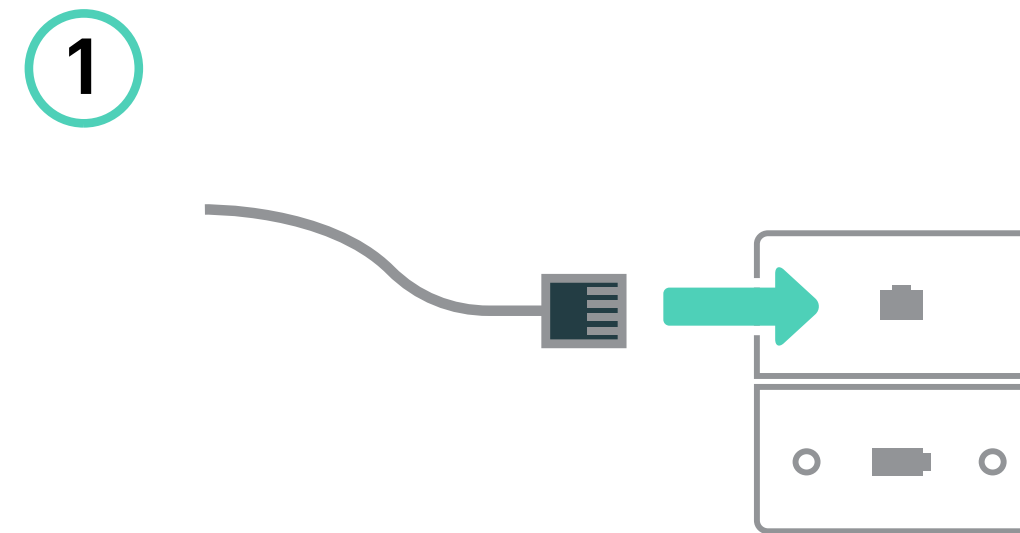

1 If using Copper/ Part-Fibre, plug your Business Wi-Fi Hub 6 into your master phone socket for best performance. It is usually close to the front door.

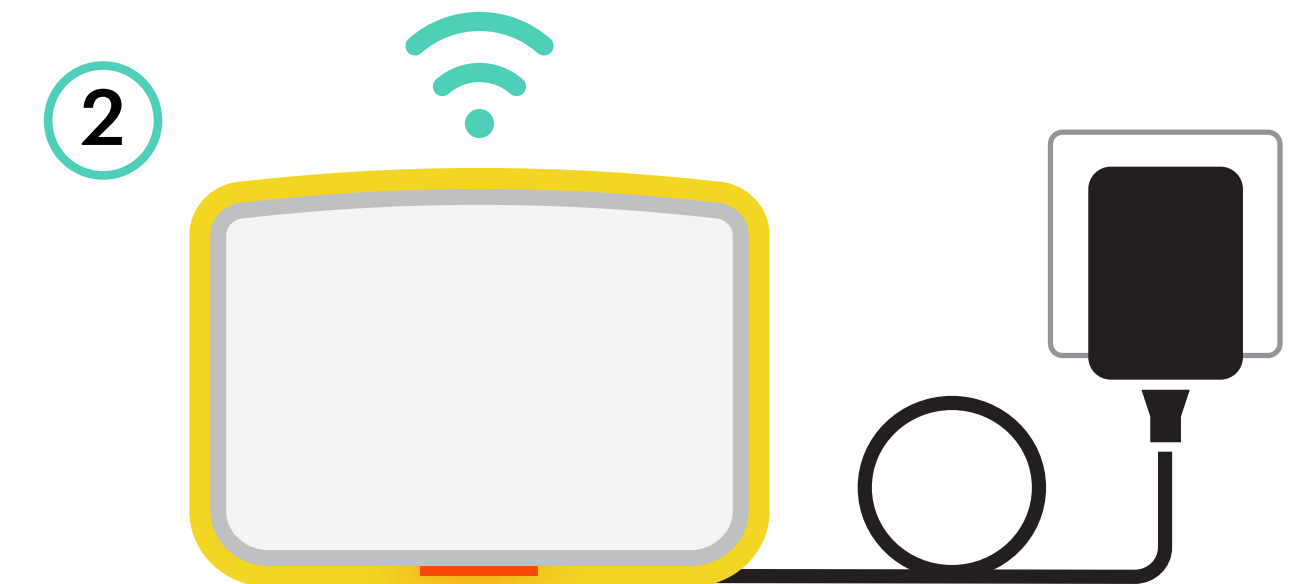

2 Leave your Business Wi-Fi Hub 6 on all the time. Turning it on and off will slow down your connection.

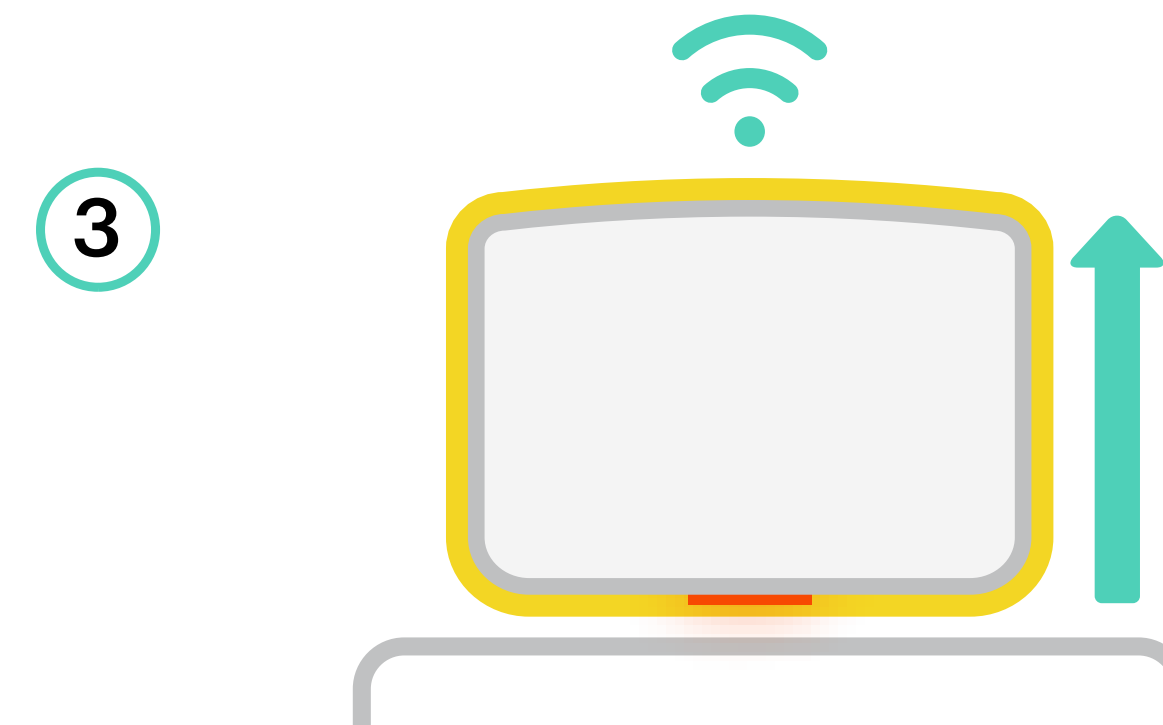

3 Keep your Business Wi-Fi Hub 6 upright and up high. Not on the floor.

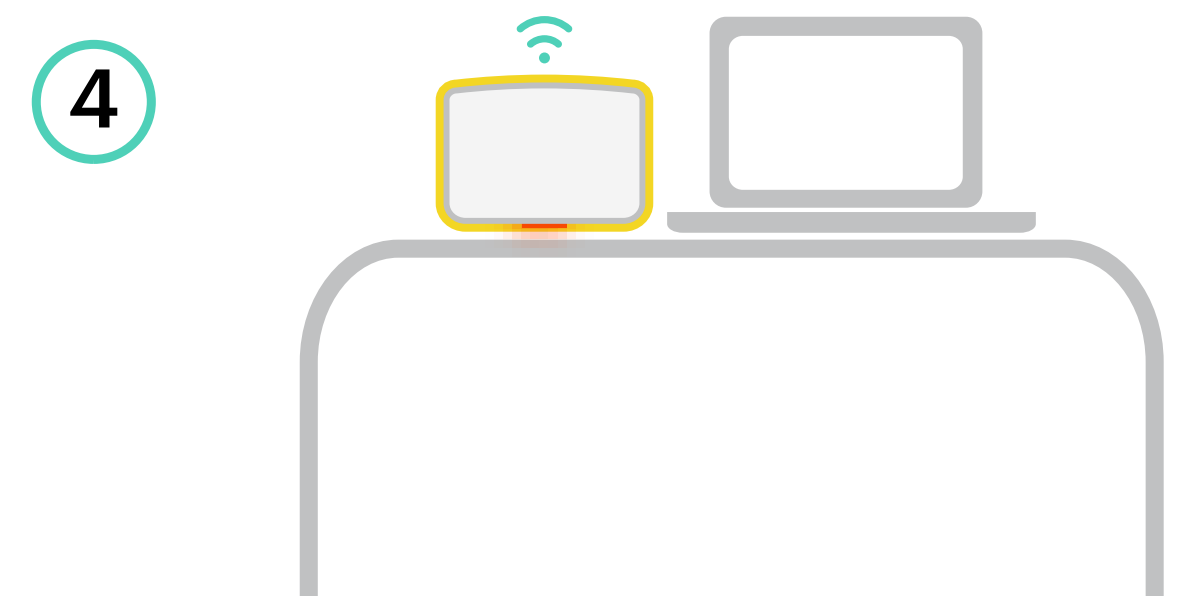

4 Try not to tuck your Wi-Fi Hub 6 underneath desks, behind furniture or other signal-blocking obstacles.

Setting up Guest Wi-Fi

To share your Wi-Fi securely and seamlessly with your visitors, set up instructions can be found in the FAQ section here: talktalk.business/insights/wi-fi-hub

TTBDHUB300924

We're always
on hand to help

talktalk.business/insights/wi-fi-hub

TalkTalk^o
Business