

# Soccer goal and Basket Configuration F8

EP-SKS-PCFB-F8



## CHARACTERISTICS

Soccer and basketball goal.  
The basketball hoop is installed at 8' [2.43m].  
Please take into consideration the slopes of the field for an optimal use of the product.

## MATERIALS

**Posts and grids:** galvanized steel, powder-coated.  
**Basketball backboard:** white powder-coated aluminum with orange galvanized steel ring and white nylon net.

## ANCHORS TYPE

Black sleeves installed with mechanical anchors on pre-cast concrete pyramid bases (not supplied).

## PLAY VALUE

Maximizes play space.  
Ball and basketball fences are available in a variety of configurations to accommodate yards of all sizes. Cages can be installed directly on asphalt, synthetic or natural grass.  
Open-work mesh allows easy monitoring of play areas. The bright colors of the posts and fencing add sparkle to the yard.

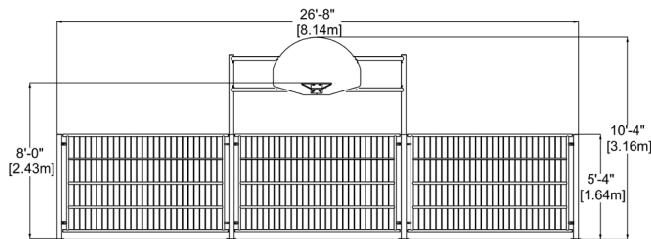
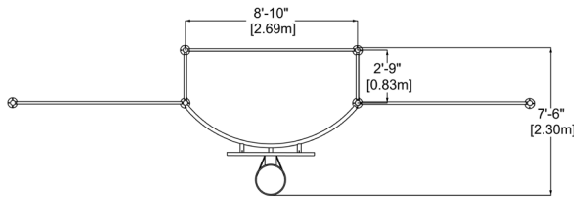

## INSTALLATION DETAILS

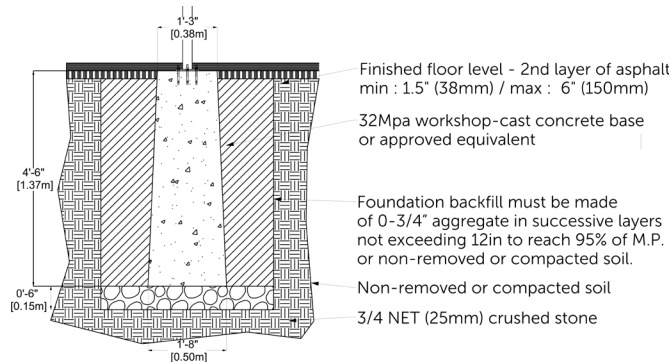

The base should be approximately level with the first layer of asphalt.  
All bases of the same product must be at the SAME LEVEL.

## AVAILABLE COLORS - POSTS

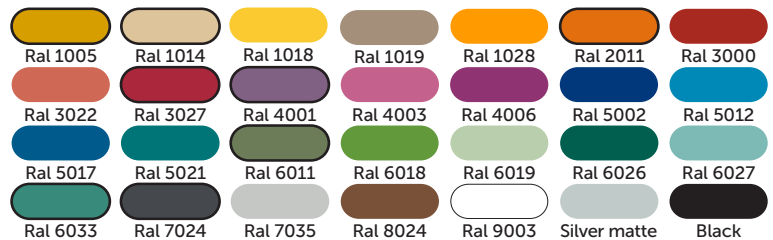

## AVAILABLE COLORS - BASKETBALL BACKBOARD



## AVAILABLE COLORS - BASKETBALL HOOP



# Soccer goal and Basket Configuration F8+

EP-SKS-PCFB-F8+



## CHARACTERISTICS

Soccer and basketball goal.  
The basketball hoop is installed at 8' [2.43m].  
Please take into consideration the slopes of the field for an optimal use of the product.

## MATERIALS

**Posts and grids:** galvanized steel, powder-coated.  
**Basketball backboard:** white powder-coated aluminum with orange galvanized steel ring and white nylon net.

## ANCHORS TYPE

Black sleeves installed with mechanical anchors on pre-cast concrete pyramid bases (not supplied).

## PLAY VALUE

Maximizes play space.  
Ball and basketball fences are available in a variety of configurations to accommodate yards of all sizes. Cages can be installed directly on asphalt, synthetic or natural grass.  
Open-work mesh allows easy monitoring of play areas. The bright colors of the posts and fencing add sparkle to the yard.

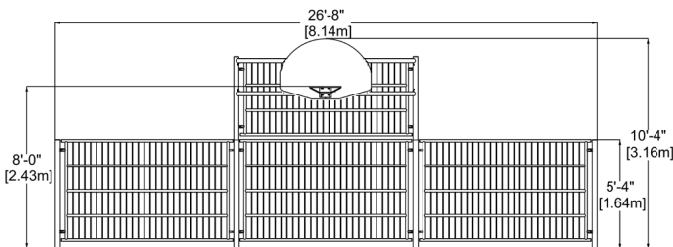
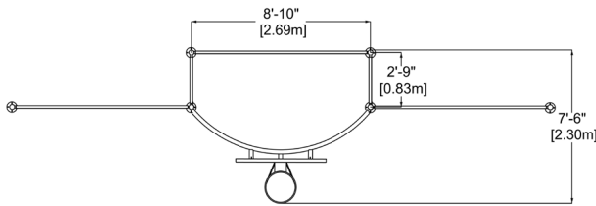

## INSTALLATION DETAILS

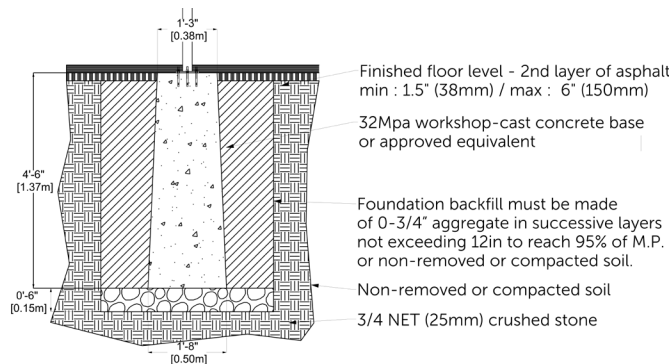

The base should be approximately level with the first layer of asphalt.  
All bases of the same product must be at the SAME LEVEL.

## AVAILABLE COLORS - POSTS

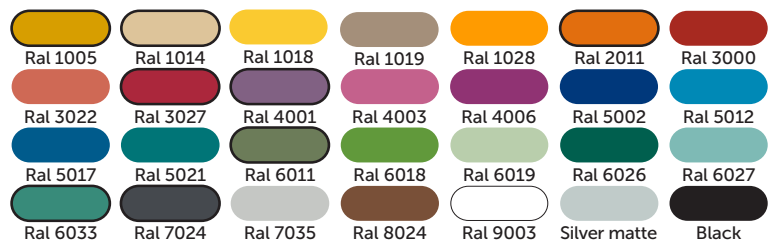

## AVAILABLE COLORS - BASKETBALL BACKBOARD



## AVAILABLE COLORS - BASKETBALL HOOP

