



5.0G

4.0G

DESIGN OFFICES

NÜRNBERG

CITY

MEETING & CONFERENCE

4. OBERGESCHOSS

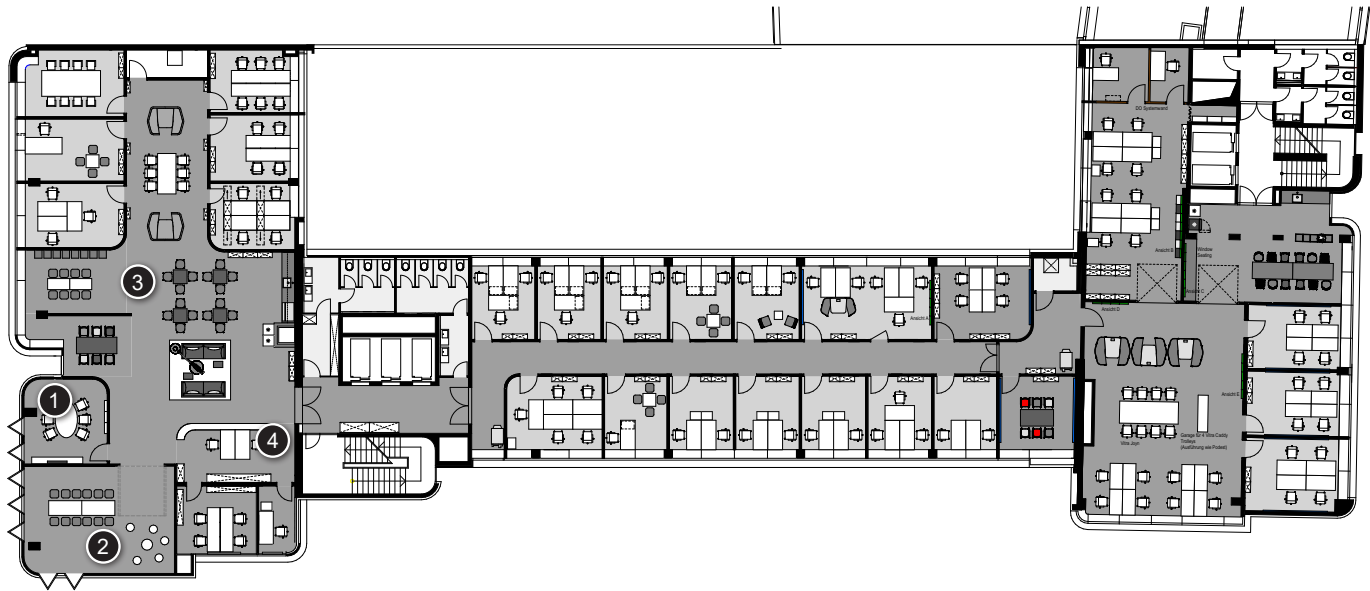







4. OBERGESCHOSS

- 1 Fireside Room
- 2 Meet & Move Room I
- 3 DO Lounge
- 4 Empfang

BESTUHLUNGSPLAN

- 1 Fireside Room
- 2 Meet & Move Room I
- 3 DO Lounge

4. OG

m ²	L x B x H in Meter	 New Work	 U-Form	 Parlament	 Theater	 Block	 Stuhlkreis	 Bankett
21	4.6 x 4.5 x 3.3					6		
50	8.2 x 5.8 x 3.3					12		
		Communitytable, Bistro- und Loungemöblierung						



DESIGN OFFICES

NÜRNBERG

CITY

MEETING & CONFERENCE

5. OBERGESCHOSS

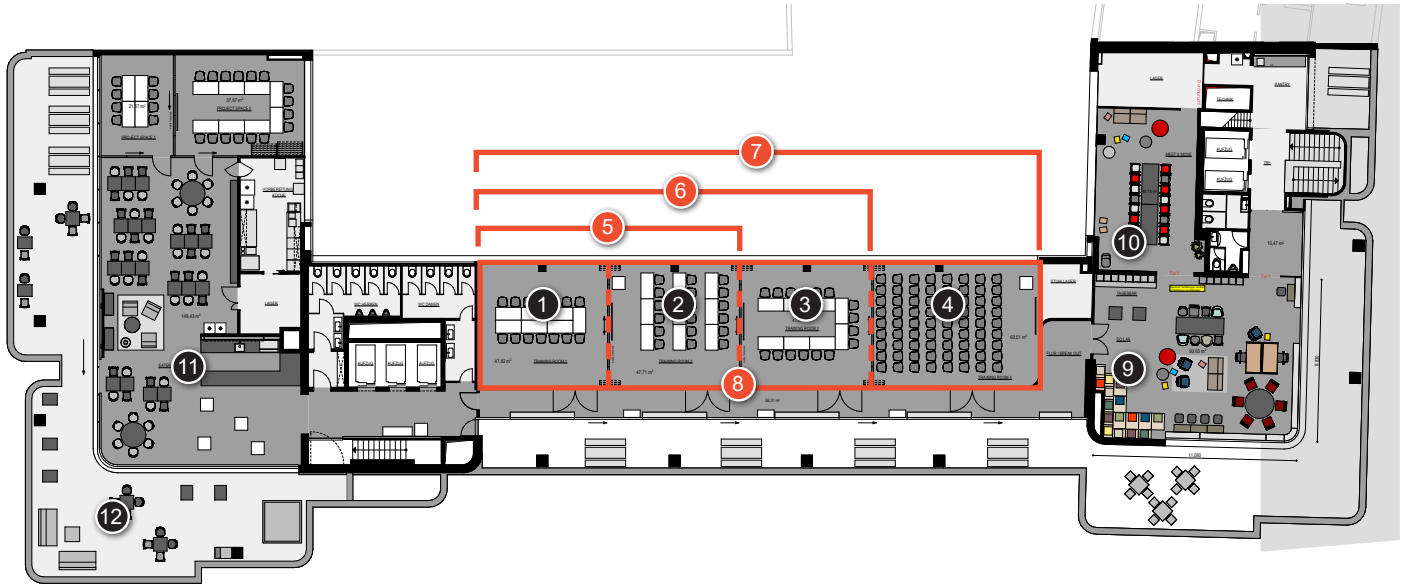







5. OBERGESCHOSS

- | | | | |
|---------------------|-------------------------|------------------------|------------------------|
| 1 Training Room I | 4 Training Room IV | 7 Training Room I – IV | 10 Meet & Move Room II |
| 2 Training Room II | 5 Training Room I + II | 8 Arena | 11 Eatery |
| 3 Training Room III | 6 Training Room I – III | 9 Work Lab | 12 Terrasse |

BESTUHLUNGSPLAN

5. OG

m ²	L x B x H in Meter	 New Work	 U-Form	 Parlament	 Theater	 Block	 Stuhlkreis	 Bankett	
1 Training Room I	48	6.7 x 7.2 x 4.0	30	16	18	40	14	20	
2 Training Room II	48	6,7 x 7,2 x 4,0	30	16	18	40	14	20	
3 Training Room III	48	6,7 x 7,2 x 4,0	30	16	18	40	14	20	
4 Training Room IV	61	6,7 x 9,0 x 4,0	40	20	24	60	18	26	
5 Training Room I + II	96	13,4 x 7,2 x 4,0	60	32	42	90	32	40	48
6 Training Room I – III	144	20.1 x 7.2 x 4.0	90	48	66	140	52		72
7 Training Room I – IV	205	27,0 x 7,2 x 4,0	120		90	180	76		90
8 Arena	269	31,0 x 8,7 x 3,3			90	216			
9 Work Lab	104	11,0 x 9,0 x 4,0		16	26	40	16	28	
10 Meet & Move Room II	49	8.9 x 5.5 x 4.0					12		
11 Eatery	142	L:10.9/7.4 X		32	48	80			
12 Terrasse	170		Außergewöhnliche Outdoor-Möblierung						