

DESIGN OFFICES



co.lab

Conference & Event Price List

As a pioneer for new work, Design Offices, as commissioned by Deutsche Bahn, manages 1,400 m² for dynamic working. The innovative room concepts provide variable furnishings for a range of scenarios, writeable walls and comprehensive toolboxes with presentation materials. The Design Offices Berlin DB co.lab not only enables the realization of future-oriented, creative methods, but also classic formats in contemporary look.

What's more, the DB co.lab offers the perfect setting for event formats - whether as networking event with talks, staff party, or after work party. Here, you will find the most exciting room options.

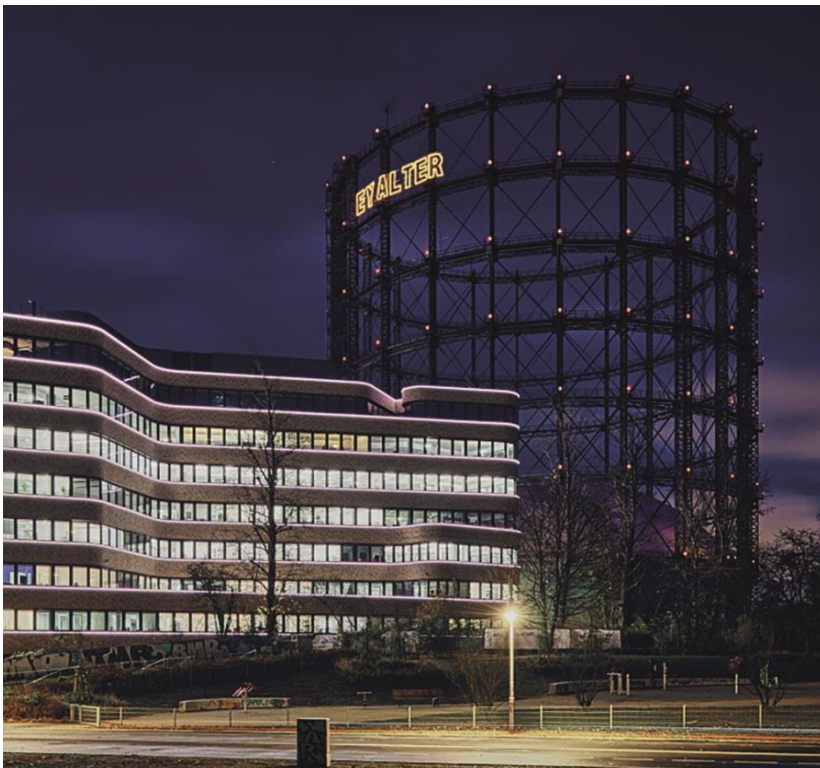

We are your consultants for dynamic event formats in new work style!

You know the target for your event - we have the means for the perfect realization!

Whether design thinking, scrum or classic training formats, in the Meet & Move Room or the unique Work Lab, you'll find the just the right setting.

Conference Rooms and Event Areas

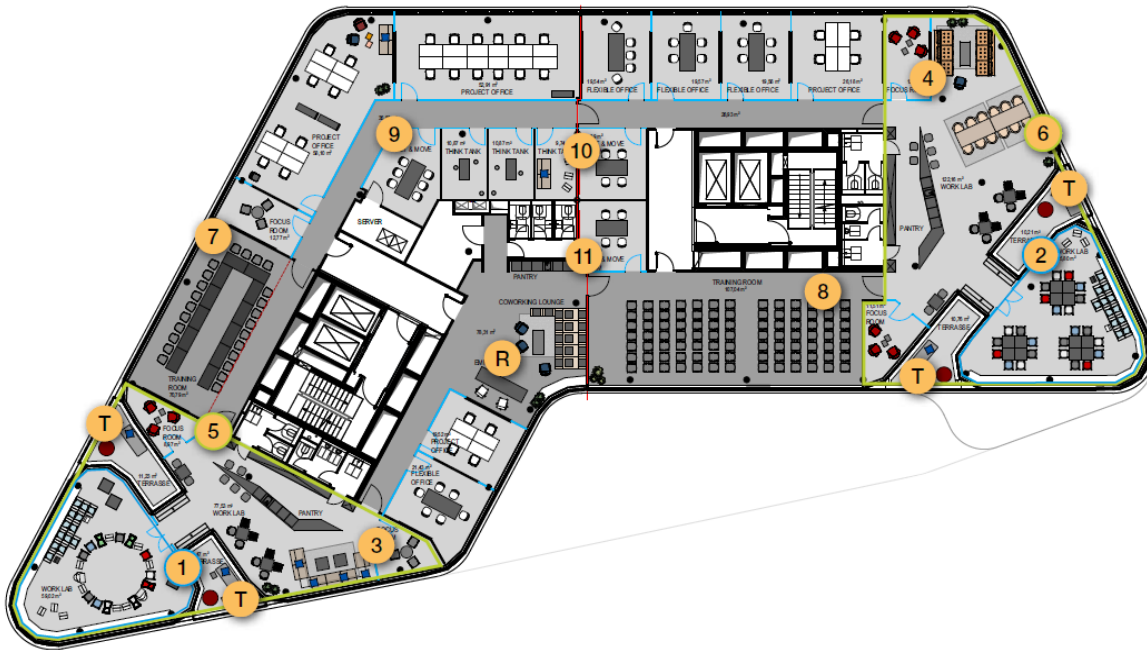

7th Floor

Conference room		Area	Pax	Room rental for a full day* in €
		m ²		gross
Work Lab S I	1	59 m ²	40	850,—
Work Lab S II	2	56 m ²	42	800,—
Focus Room I	3	10 m ²	3	350,—
Focus Room II	4	13 m ²	3	350,—
Work Lab L I	5	155 m ²	70	1.250,—
Work Lab L II	6	202 m ²	80	1.750,—

* until 6pm

All rooms at the Design Offices can also be booked for evening events, or for several days at a time.

All prices are gross and include the currently applicable statutory VAT at 19%. The GTC of Design Offices apply.

Basic Equipment & Services

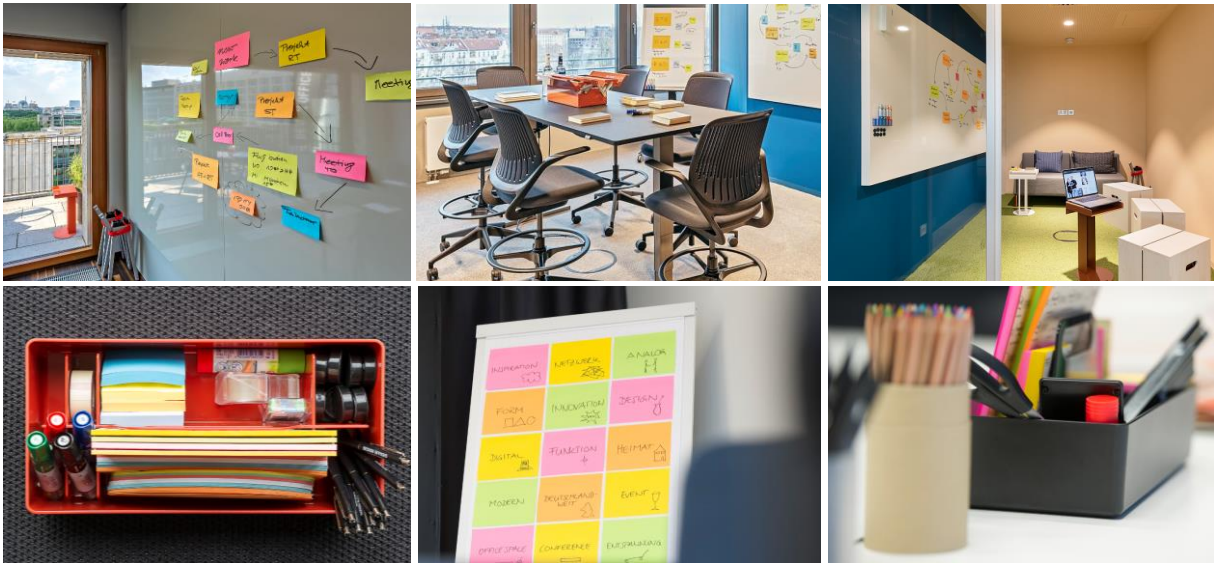

Included in the room rental / conference flat rates:

- High-speed WLAN
- Adapter for Apple devices
- Flat screen (55 Inch) with HDMI and VGA connection or projector / projection screen (depending on room)
- Writable walls/pin boards/flip charts (depending on room setup)
- Technology trolley with facilitator's basic presentation equipment (toolbox)

Coworking Lounge for the reception of your guests

Data line: dedicated bandwidth on request

Additional Equipment | Technology

	gross / item
Projector (included in Training Room)	70,00 €
Additional flip chart (including 10 sheets, pens)	30,00 €
Flip chart block	12,00 €
Facilitator's presentation kit	30,00 €
Other technology possible on request	

Other Services

	gross / item
Manager (on-site event support)	65,00 € *
Coordinator (on-site event support)	35,00 € *
Concierge service	on request

All prices are gross and include the currently applicable statutory VAT at 19%. The GTC of Design Offices apply.

Conference Flat Rates

With a conference flat rate (at least 20 persons), you can book a complete package, allowing you to easily estimate the cost of your event and leaving us to take care of every tiny detail.

The room set-up*, including the basic equipment, is included in every flat rate.

	Standard	Premium	All-In
	Full day	Full day	Full day
Room rental* incl. technology	✓	✓	✓
Welcome coffee			✓
Mid-morning break	✓	✓	✓
Buffet lunch	✓	✓	✓
Afternoon break	✓	✓	✓
Soft drinks in the room, 0.33 l	✓✓		
Soft drinks with lunch, 0.33 l	✓		
Flat rate for drinks Premium **		✓	
Flat rate for drinks All-In ***			✓
Fruit bowl			✓
Snack box			✓
Prices for full day			
(gross)	74,00 €	84,00 €	94,00 €

Conference flat rate "Standard"

gross

Includes coffee breaks (mid-morning and afternoon) with filter coffee, tea, a range of different snacks and a buffet lunch, 2 softdrinks in the room, 1 softdrink with lunch

Full day flat rate "Standard" (up to 8 hours, until 6 pm): per person 74,00 €

Conference flat rate "Premium"

Includes coffee breaks (mid-morning and afternoon) with filter coffee, tea, a range of different snacks, a buffet lunch, flat rate for drinks Premium

Full day flat rate "Premium" (up to 8 hours, until 6 pm): per person 84,00 €

Conference flat rate "All-In"

Includes coffee breaks (mid-morning and afternoon) with filter coffee, tea, a range of different snacks, a buffet lunch, flat rate for drinks All-In, fruit bowl, snack box

Full day flat rate "All-In" (up to 8 hours, until 6 pm): per person 94,00 €

Spice up your breaks, or conclude the evening with fine finger food!

For your coffee breaks and lunch we offer a selection of tasty snacks and desserts, and for the evening a wide range of finger food.

We are happy to provide a detailed offering tailored to meet your catering preferences

* Adequate space is provided for the size of the group. A larger space is available at an additional cost.

** Flat rate for drinks Premium incl. softdrinks, mineralwater, filter coffee, tea

*** Flat rate for drinks All-In incl. softdrinks, mineralwater, energy drinks, coffee specialties, tea

All prices are gross and include the currently applicable statutory VAT at 19%. The GTC of Design Offices apply.

Drinks & Powersnacks



Food an beverage flat rate		gross	
Standard	lunch with 1 softdrink, 2 softdrinks in the room	per person	49,00 €
Premium	2 coffee breaks with snacks, buffet lunch, flat rate for drinks (incl. softdrinks, water, filter coffee, tea)	per person	59,00 €

Drinks:

Beer	different sorts	0,33 l	3,90 €
fritz-kola		0,33 l	3,30 €
fritz-spritz	organic rhubarb spritzer, organic apple juice spritzer		
fritz-limo	apple-cherry-elderberry lemon, orange		
Water Aqua Monaco	still and sparkling	0,33 l	2,60 €
Water Aqua Monaco	still and sparkling	0,75 l	6,00 €

Hot Drinks

Café Creme / Espresso			2,90 €
Cappuccino			3,30 €
Latte Macchiato			3,70 €
Pot of filter coffee		0,85 l	17,00 €
samova teas			2,50 €

Wine/Sparkling Wine – Weingut Marx:

Cabernet Dorsa (red), dry	0,75 l	23,80 €
Pinot Grigio (white), dry	0,75 l	20,00 €
Riesling "S" Sonnenmorgen, dry	0,75 l	23,80 €
Riesling Sparkling Wine, classic bottle fermentation, dry	0,75 l	24,90 €
Marx Secco, dry	0,75 l	20,30 €

We can recommend other wines on request.

Powersnacks:

We offer you and your guests a wide range of Powersnacks.

You can choose from fine cereal bars, nut mixes, chocolate bars and chips.

We are happy to provide a detailed offering tailored to meet your catering preferences

All prices are gross and include the currently applicable statutory VAT at 19%. The GTC of Design Offices apply.