

Standortportfolio

# München Nove

**DESIGN OFFICES**



# EG 00

## Meetings & Conference

- 1 Training Room I
- 2 Training Room II
- 3 Training Room III
- 4 Meet & Move Room
- 5 Training Room V
- 6 Fireside Room
- 7 DO.Lounge
- 8 Empfang



 Zusammgestellt durch flexible Wände



# EG 00

Meetings & Conference



		m <sup>2</sup>	L x B x H in Metern	New Work	U-Form	Parlament	Theater	Block	Stuhlkreis	Bankett
1	Training Room I	56	5,7 x 9,9 x 3,2	30	18	24	40	16	20	
2	Training Room II	56	5,7 x 9,9 x 3,2	30	18	24	40	16	20	
3	Training Room III	112	11,5 x 9,9 x 3,2	70	26	60	110	24	40	
4	Meet & Move Room	47	4,9 x 9,6 x 3,2					12		
5	Training Room V	55	5,7 x 9,6 x 3,2	30	16	18	40	16	20	
6	Fireside Room	20	4,0 x 5,0 x 3,2					6		
7	DO.Lounge	243		Community Table, Arbeitsbereiche, Lounge-Möblierung für 100 Personen						
8	Empfang									

# OG 06

## Meetings & Conference

 Zusammgestellt durch flexible Wände

-  Training Room VI
-  Training Room VII
-  Training Room VIII
-  Training Room IX (VII + VIII)
-  Training Room X (VI + VII)
-  Training Room XI (VI, VII, VIII)
-  Rooftop Lounge + Terrasse
-  Dachterrasse

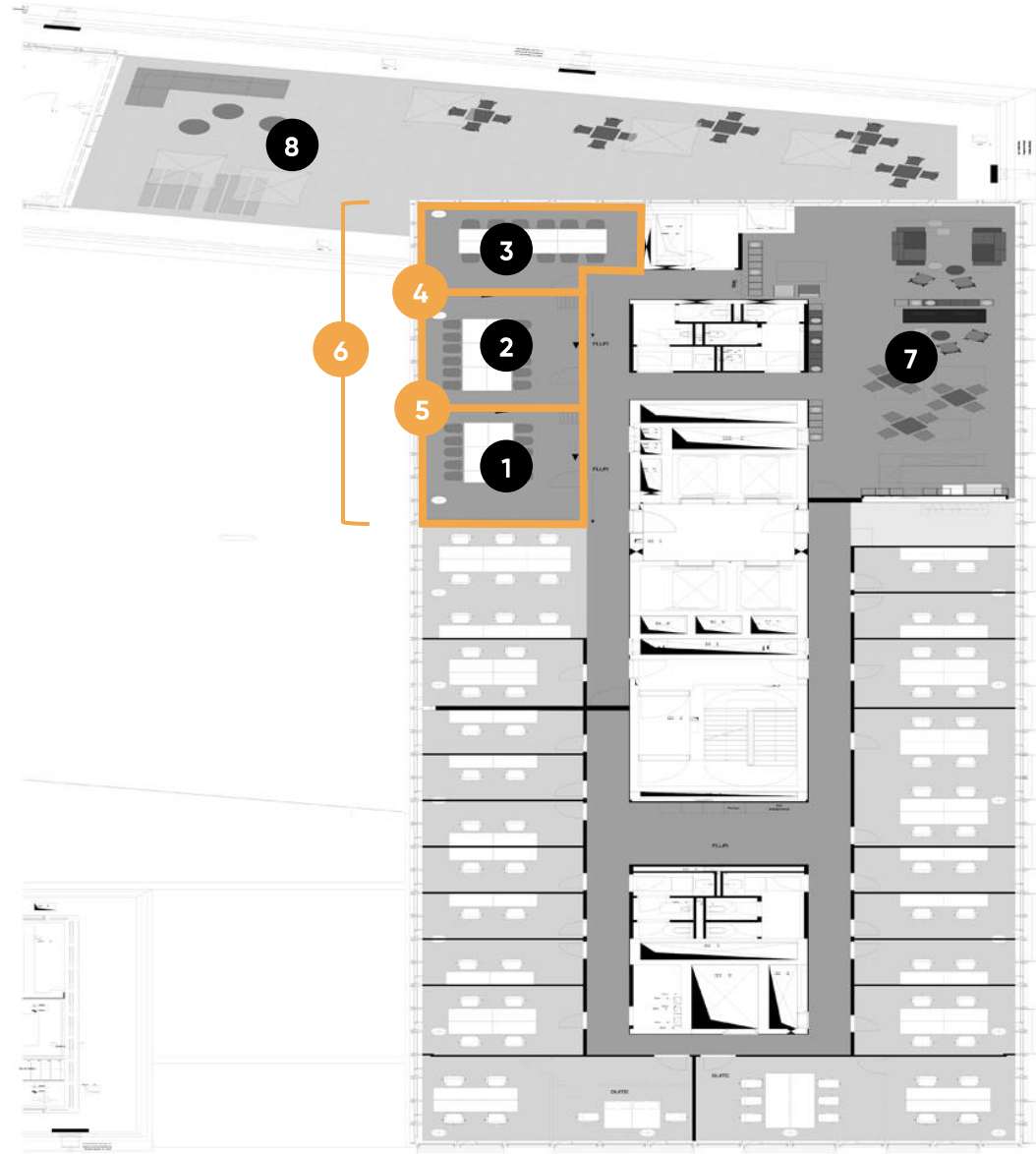

# OG 06

## Meetings & Conference



		m <sup>2</sup>	L x B x H in Metern	New Work	U-Form	Parlament	Theater	Block	Stuhlkreis	Bankett
1	Training Room VI	30	6,6 x 4,6 x 2,9			10	16	10	10	
2	Training Room VII	30	6,6 x 4,6 x 2,9			10	16	10	10	30
3	Training Room VIII	29	5,0 x 6,2 x 2,9			10	16	10	10	
4	Training Room IX (VII + VIII)	59	13,2 x 4,6 x 2,9	40		24	30	18	20	
5	Training Room X (VI + VII)	61	11,7 x 4,6 x 2,9	40		24	30	18	20	
6	Training Room XI (VI, VII, VIII)	90	18,5 x 4,6 x 2,9	60		26	90	24	30	
7	Rooftop Lounge + Terrasse	107	17,0 x 6,0   7,7 x 2,9	Lounge- und Bistromöblierung für 100 Personen						
8	Dachterrasse									