



DESIGN OFFICES

MUNICH

NOVE

MEETING & CONFERENCE

GROUND FLOOR

6TH FL

GF

GROUND FLOOR

- ① Training Room I
- ② Training Room II
- ③ Training Room III
- ④ Meet & Move Room
- ⑤ Training Room V
- ⑥ Fireside Room
- ⑦ DO Lounge
- ⑧ Reception

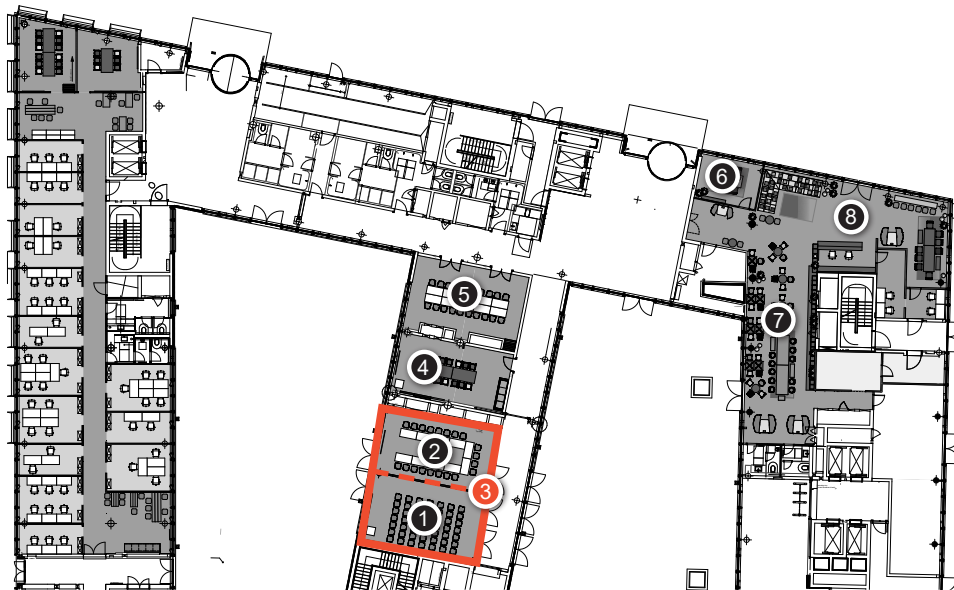







DESIGN OFFICES

MÜNCHEN
NOVE

SEATING PLAN

- 1 Training Room I
- 2 Training Room II
- 3 Training Room III
- 4 Meet & Move Room
- 5 Training Room V
- 6 Fireside Room
- 7 DO Lounge

GF

m²	L x W x H in Meter	 New Work	 U-Shape	 Parliament	 Theater	 Block	 Circle	 Banquet
56	5.7 x 9.9 x 3.2	35	18	24	40	16	20	
56	5.7 x 9.9 x 3.2	35	18	24	40	16	20	
112	11.5 x 9.9 x 3.2	70	26	60	120	24	40	
47	4.9 x 9.6 x 3.2					14		
55	5.7 x 9.6 x 3.2	35	16	18	40	16	20	
20	4.0 x 5.0 x 3.2					6		
243		Community table, work areas, lounge furniture for 100 people						



DESIGN OFFICES

MUNICH

NOVE

MEETING & CONFERENCE

6TH FLOOR

6TH FL

GF

6TH FLOOR

- ① Training Room VI
- ② Training Room VII
- ③ Training Room VIII
- ④ Training Room IX
- ⑤ Training Room X
- ⑥ Training Room XI
- ⑦ Rooftop Lounge
- ⑧ Rooftop

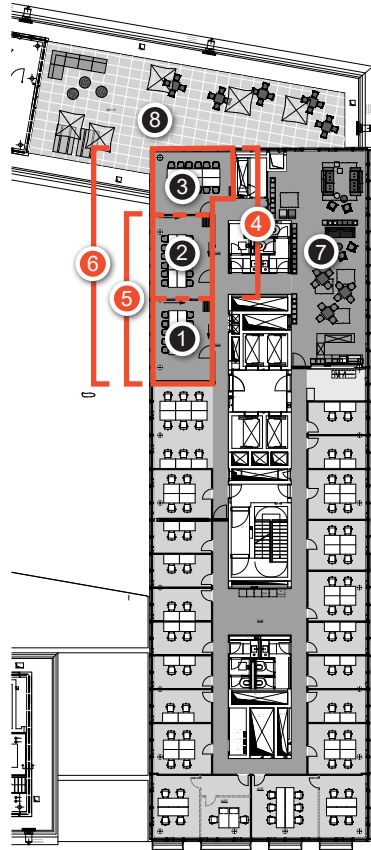







MÜNCHEN
NOVE

SEATING PLAN

- 1 Training Room VI
- 2 Training Room VII
- 3 Training Room VIII
- 4 Training Room IX
- 5 Training Room X
- 6 Training Room XI
- 7 Rooftop Lounge + Terrace

6TH FL

m²	L x W x H in Meter	 New Work	 U-Shape	 Parliament	 Theater	 Block	 Circle	 Banquet
30	6.6 x 4.6 x 2.9			10	16	10	10	
30	6.6 x 4.6 x 2.9			10	16	10	10	
29	5.0 x 6.2 x 2.9			10	16	10	10	
59	11.7 x 4.6 x 2.9	40		24	30	18	20	
61	13.2 x 4.6 x 2.9	40		24	30	18	20	
90	18.5 x 4.6 x 2.9	60		26	90	28	30	
107	17.0 x 6.0 7.7 x 2.9	Lounge and bistro furniture for 100 people						