

Location portfolio

Frankfurt **Wiesen- hüttenplatz**

DESIGN OFFICES

Ground floor

 With flexible walls

Meeting & Conference Spaces

- 1** Training Room I
- 2** Training Room II
- 3** Training Room III
- 4** Training Room IV
- 5** Training Room I + II
- 6** Training Room II + III
- 7** Training Room III + IV
- 8** Training Room I + II (XL)
- 9** Training Room I – III (XL)
- 10** Training Room I – III
- 11** Training Room II – IV
- 12** Training Room I – IV
- 13** Arena
- 14** Arena (XL)
- 15** DO Café
- 16** DO.Lounge

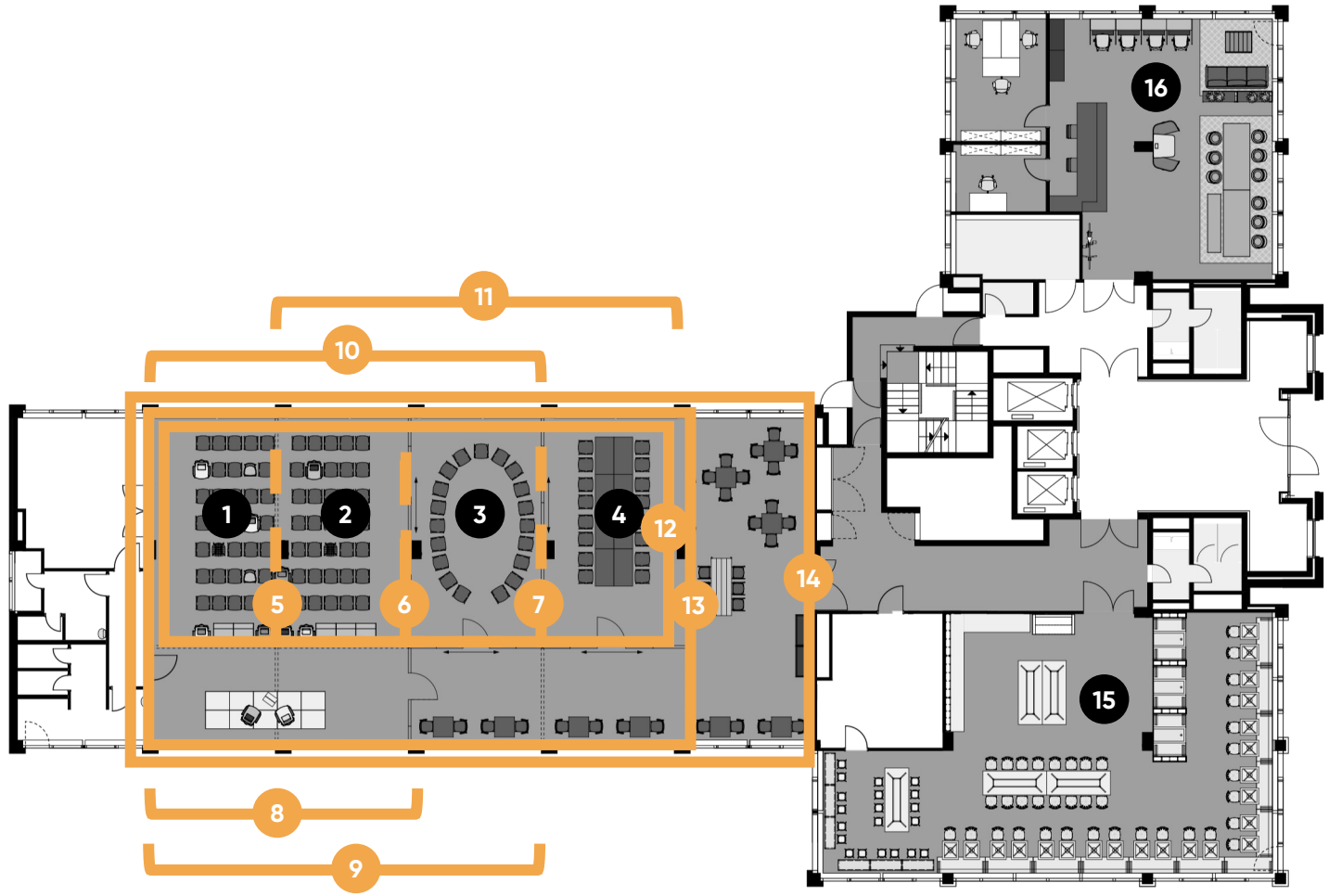

Ground floor

Meeting & Conference Spaces



		m ²	L x W x H in metres	New Work	U-Form	Parliamentary	Theater	Block	Circle	Banquet
1	Training Room I	42	8.6 x 4.6 x 3.6	25	14	12	30	16	20	
2	Training Room II	42	8.6 x 4.6 x 3.6	25	14	12	30	16	20	
3	Training Room III	42	8.6 x 4.6 x 3.6	25	14	12	30	16	20	
4	Training Room IV	42	8.6 x 4.6 x 3.6	25	14	12	30	16	20	
5	Training Room I + II	84	8.6 x 9.6 x 3.6	50		26	60		30	32
6	Training Room II + III	84	8.6 x 9.6 x 3.6	50		26	60		30	32
7	Training Room III + IV	84	8.6 x 9.6 x 3.6	50		26	60		30	32
8	Training Room I + II (XL)	120	12.1 x 9.6 x 3.6	100	25	38	94	25	38	48
9	Training Room I – III (XL)	180	12.1 x 14.6 x 3.6	130	30	72	154	30	46	
10	Training Room I – III	126	8.6 x 14.6 x 3.6	100		38	90			48
11	Training Room II – IV	126	8.6 x 14.6 x 3.6	100		38	90			48
12	Training Room I – IV	170	8.6 x 20.2 x 3.6	180		82	182			88
13	Arena	240	12.1 x 20.2 x 3.6	180		96	160	52		104
14	Arena (XL)	300	12.1 x 24.8 x 3.6	180		118	199			104
15	DO Café	182	14.0 x 24.8 x 3.6	Restaurant/office furniture for 60 people						
16	DO.Lounge			Community table, bistro and lounge furniture						

6th floor

Meeting & conference spaces

 With flexible walls

- 1** Meet & Move Room S
- 2** 2 x Meet & Move Room S
- 3** Meet & Move Room M
- 4** Meet & Move Room S + M
- 5** Meet & Move Room L
- 6** 2 x Meet & Move Room M
- 7** Arena II
- 8** Co-Working Space
- 9** Work Lab
- 10** Rooftop Terrace
- 11** Rooftop Lounge
- 12** Rooftop Lounge + Terrace

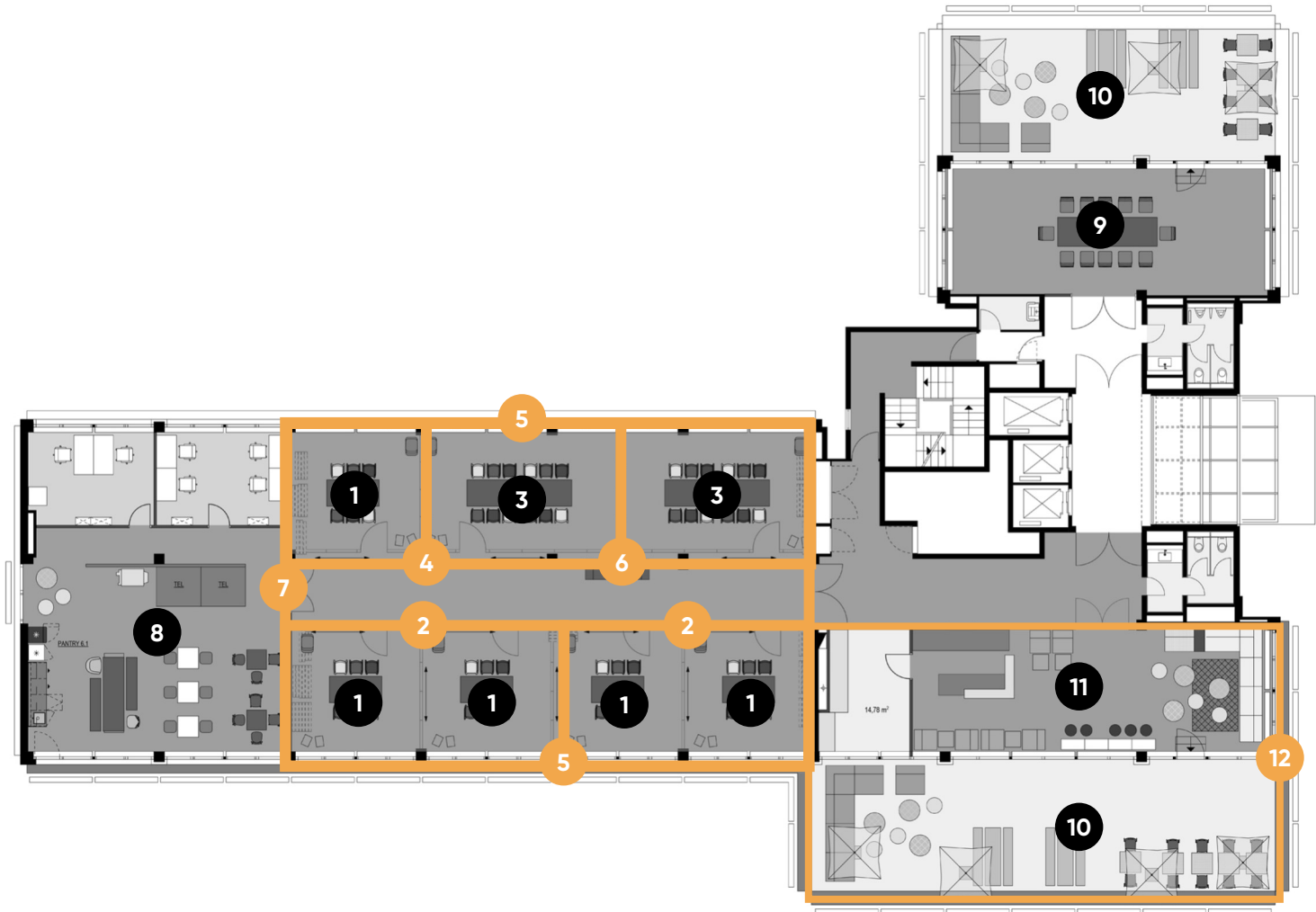

6th floor

Meeting & conference spaces



		m ²	L x W x H in metres	New Work	U-shaped	Parliamentary	Theatre	Block	Circle	Banquet
1	Meet & Move Room S	23	4.6 x 4.9 x 3.6					8		
2	2 x Meet & Move Room S	46	4.6 x 10.0 x 3.6					20		
3	Meet & Move Room M	33	4.6 x 7.4 x 3.6					12		
4	Meet & Move Room S + M	55	4.6 x 12.0 x 3.6					28		
5	Meet & Move Room L	92	4.6 x 19.9 x 3.6					40		
6	2 x Meet & Move Room M	66	4.6 x 14.4 x 3.6					28		
7	Arena II	241	12.1 x 19.9 x 3.6			96	198			
8	Co-Working Space	85	8.5 x 10.0 x 3.6	Lounge furniture for 20 people						
9	Work Lab	62	12.0 x 5.0 x 3.6	40	20	20	40	20	20	
10	Rooftop Terrace	64	5.0 x 12.7 x 3.6	Lounge and bistro furniture						
11	Rooftop Lounge	65	4.6 x 13.9 x 3.6	Lounge and bistro furniture for 90 people						
12	Rooftop Lounge + Terrace	88	5.0 x 17.7 x 3.6	Lounge and bistro furniture						