



Standortportfolio

# Frankfurt **Wiesen- hüttenplatz**

**DESIGN OFFICES**

# OG 06

## Meeting & conference spaces

 Mit flexiblen Wänden

- 1** Meet & Move Room S
- 2** 2 x Meet & Move Room S
- 3** Meet & Move Room M
- 4** Meet & Move Room S + M
- 5** Meet & Move Room L
- 6** 2 x Meet & Move Room M
- 7** Arena II
- 8** Coworking Space
- 9** Work Lab
- 10** Rooftop Terrace
- 11** Rooftop Lounge
- 12** Rooftop Lounge + Terrace

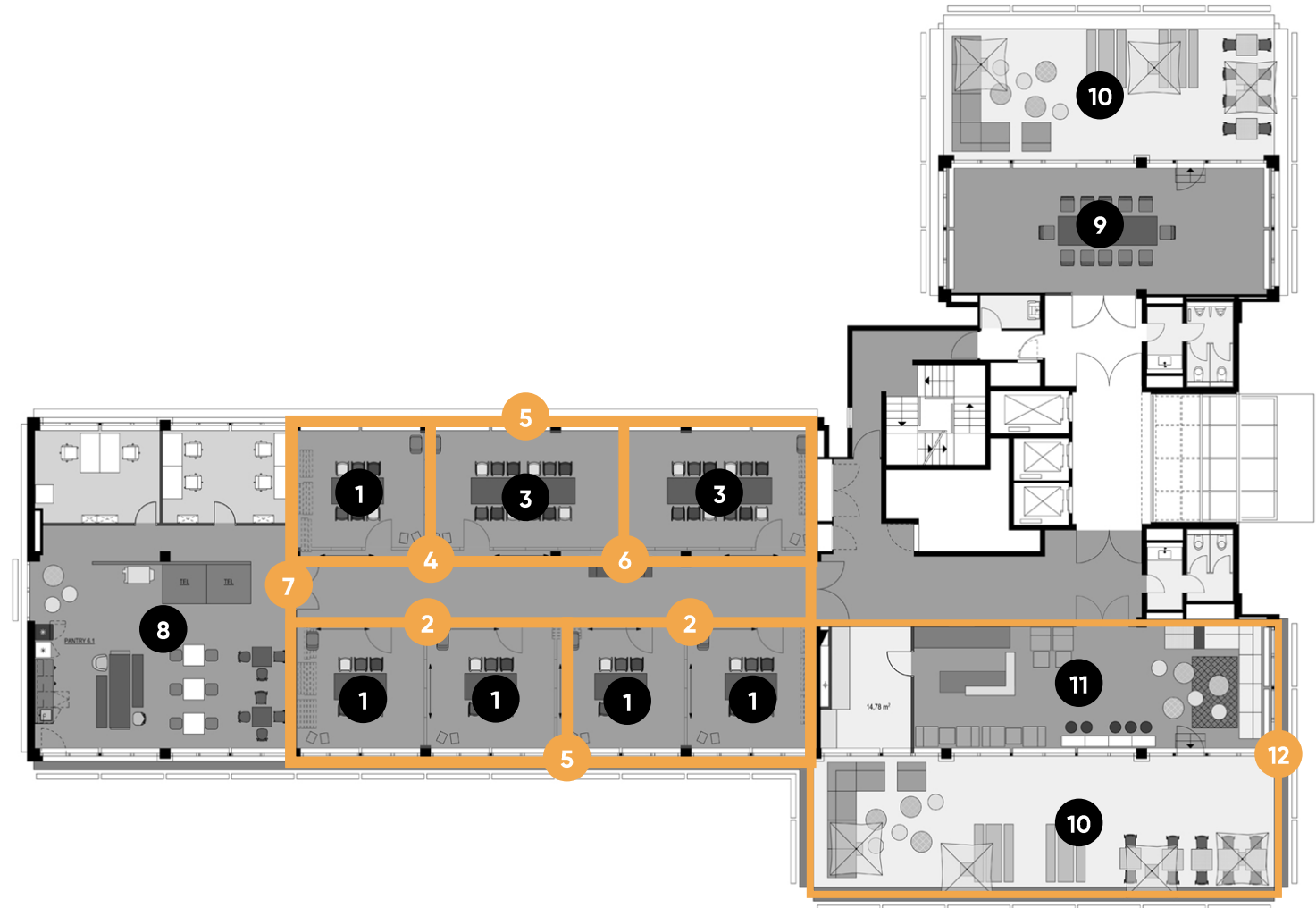

# OG 06

## Meeting & conference spaces



|    |                          | m <sup>2</sup> | L x W x H in metres | New Work                                    | U-Form | Parlament | Theater | Block | Stuhlkreis | Bankett |
|----|--------------------------|----------------|---------------------|---|--------|-----------|---------|-------|------------|---------|
| 1  | Meet & Move Room S       | 23             | 4.6 x 4.9 x 3.6     |   |        |           |         | 8     |            |         |
| 2  | 2 x Meet & Move Room S   | 46             | 4.6 x 10.0 x 3.6    |   |        |           |         | 20    |            |         |
| 3  | Meet & Move Room M       | 33             | 4.6 x 7.4 x 3.6     |   |        |           |         | 12    |            |         |
| 4  | Meet & Move Room S + M   | 55             | 4.6 x 12.0 x 3.6    |   |        |           |         | 28    |            |         |
| 5  | Meet & Move Room L       | 92             | 4.6 x 19.9 x 3.6    |   |        |           |         | 40    |            |         |
| 6  | 2 x Meet & Move Room M   | 66             | 4.6 x 14.4 x 3.6    |   |        |           |         | 28    |            |         |
| 7  | Arena II                 | 241            | 12.1 x 19.9 x 3.6   |   |        | 96        | 198     |       |            |         |
| 8  | Coworking Space          | 85             | 8.5 x 10.0 x 3.6    | Loungemöbel für 20 Pers.                    |        |           |         |       |            |         |
| 9  | Work Lab                 | 62             | 12.0 x 5.0 x 3.6    | 40  | 20     | 20        | 40      | 20    | 20         |         |
| 10 | Rooftop Terrace          | 64             | 5.0 x 12.7 x 3.6    | Bistro- und Lounge-Möbelierung              |        |           |         |       |            |         |
| 11 | Rooftop Lounge           | 65             | 4.6 x 13.9 x 3.6    | Bistro- und Lounge-Möbelierung für 90 Pers. |        |           |         |       |            |         |
| 12 | Rooftop Lounge + Terrace | 88             | 5.0 x 17.7 x 3.6    | Bistro- und Lounge-Möbelierung              |        |           |         |       |            |         |