



DESIGN OFFICES

— MÜNCHEN —

CAMPUS KÖNIGSPLATZ

MEETING &  
CONFERENCE

— ERDGESCHOSS —

## ERDGESCHOSS

- 1** Event Terrasse
- 2** Arena
- 3** Fireside Room I
- 4** Fireside Room II
- 5** Fireside Room III
- 6** Meet & Move Room I
- 7** Meet & Move Room II
- 8** Meet & Move Room III
- 9** Training Room I
- 10** Training Room II
- 11** Training Room III
- 12** Eatery
- 13** Worklab

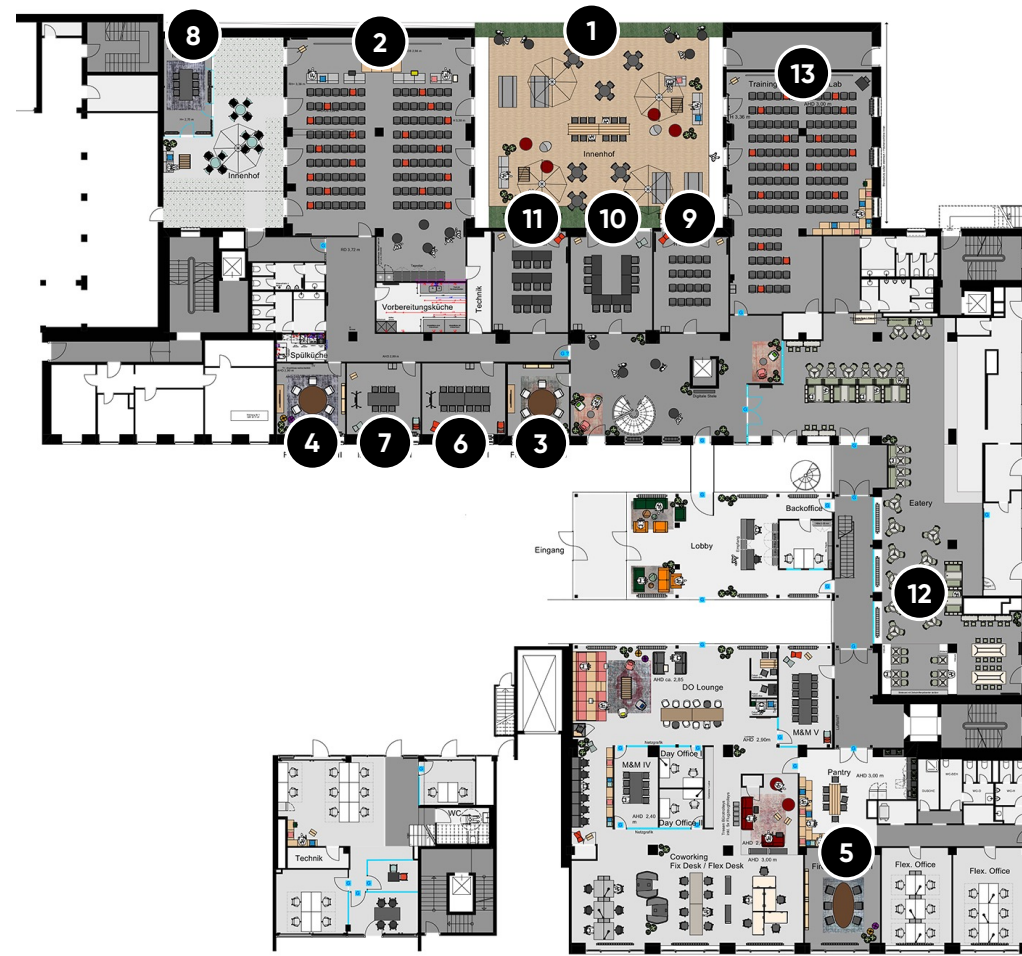

## DESIGN OFFICES







### MÜNCHEN

# CAMPUS KÖNIGSPLATZ

## BESTUHLUNGSPLAN

1. Event Terrasse
2. Arena
3. Fireside Room I
4. Fireside Room II
5. Fireside Room III
6. Meet & Move Room I
7. Meet & Move Room II
8. Meet & Move Room III
9. Training Room I
10. Training Room II
11. Training Room III
12. Eatery
13. Worklab

# EG

m <sup>2</sup>	L x B x H in Meter	 New Work	 U-Form	 Parlament	 Theater	 Block	 Stuhlkreis	 Bankett
260	13 x 10,64	150						100
201	17,25 x 13,04 x	180	40	120	199		50	100
25	5 x 4,85 x 3,38					6		
27	5 x 5,23 x 3,38					6		
38	6,23 x 5,23 x 3,38					8		
23	5 x 4,35 x 3,38					12		
38	7,13 x 5,30 x 3,35					6		
40	7,13 x 5,70 x 3,35					6		
38	7,13 x 5,30 x 3,35	25	18	16	35	16	20	
155	17 x 9,90 x 3,36	25	18	16	35	16	20	
38	7,13 x 5,34 x 3,90	25	18	16	35	16	20	
155	17 x 9,90 x 3,91	130	36	80	150		40	60



DESIGN OFFICES

— MÜNCHEN —

CAMPUS KÖNIGSPLATZ

MEETING &  
CONFERENCE

1. OBERGESCHOSS

### 1. OBERGESCHOSS

- 1 Meet & Move Room VI
- 2 Meet & Move Room VII

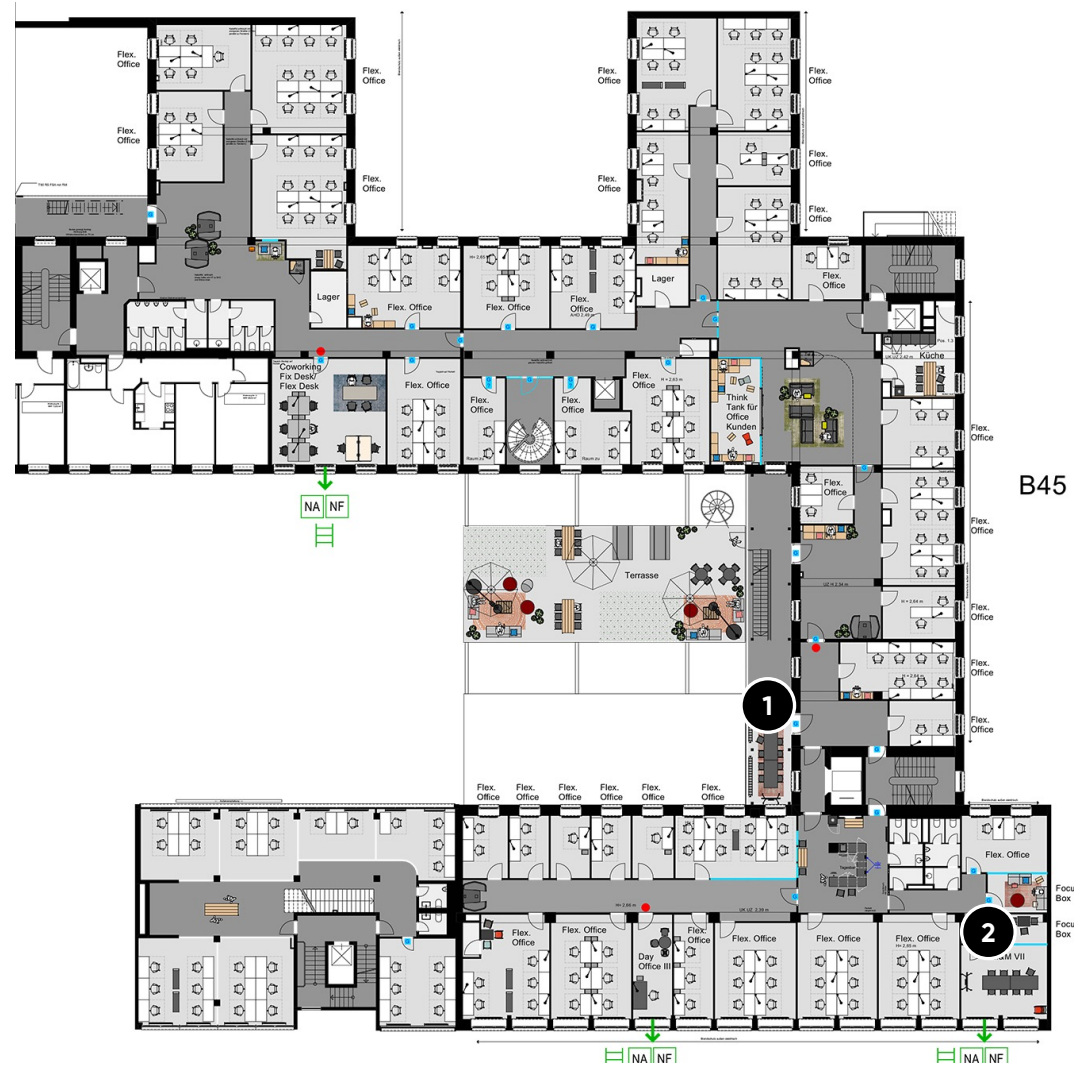

DESIGN OFFICES







MÜNCHEN

CAMPUS KÖNIGSPLATZ

BESTUHLUNGSPLAN

1. Meet & Move Room VI
2. Meet & Move Room VII

# 1. OG

m <sup>2</sup>	L x B x H in Meter	 New Work	 U-Form	 Parlament	 Theater	 Block	 Stuhlkreis	 Bankett
13,3	3,1 x 3,98 x					8		
27	4,79 x 5,57 x 2,65					8		