







Design Offices Leipzig Post		Etage	Fläche	Größe	Höhe	 U-Form	 Parlament	 Theater	 Block	 Stuhlkreis	 Bankett
1	Training Room I	1.OG	45 m ²	8,4x5,1 m	-	18	18	42	16	24	-
2	Training Room II	1.OG	38 m ²	6,9x5,4 m	-	14	12	28	12	20	-
	Training Room I+II	1.OG	82 m ²	15,3x5,3 m	-	38	42	84	36	49	-
3	Training Room III	1.OG	32 m ²	6,1x5,4 m	-	10	12	32	12	20	-
4	Training Room IV	1.OG	20 m ²	6,1x3,5 m	-	6	6	14	8	16	-
5	Training Room V	1.OG	30 m ²	6,1x5,6 m	-	10	12	20	12	20	-
	Training Room III+IV	1.OG	52 m ²	6,1x8,9 m	-	18	24	55	20	24	-
	Training Room IV+V	1.OG	50 m ²	6,1x9,1 m	-	18	24	56	20	24	-
	Training Room III-V	1.OG	82 m ²	6,1x14,5 m	-	34	42	97	32	48	-
6	Arena	1.OG	320 m ²	-	-	-	-	-	-	-	-
7	Work Lab I	1.OG	48 m ²	8,8x5,3 m	-	New Work Bestuhlung bis 35 Personen					
8	Meet & Move Room I	1.OG	14 m ²	3,7x3,6 m	-	Besprechungstisch für 6 Personen					
9	Meet & Move Room II	1.OG	14 m ²	3,7x3,6 m	-	Besprechungstisch für 6 Personen					
10	Fireside Room I	1.OG	14 m ²	3,7x3,6 m	-	Besprechungstisch für 6 Personen					
11	Fireside Room II	1.OG	14 m ²	3,7x3,6 m	-	Besprechungstisch für 6 Personen					
12	Work Lab II	1.OG	122 m ²	12,7x11 m	-	New Work Bestuhlung bis 60 Personen					
13	Eatery	EG	420 m ²	-	-	-					
14	DO Lounge	EG	100 m ²	-	-	-					
T	Terrasse I, II	EG	je 110 m ²	-	-	-					



EG

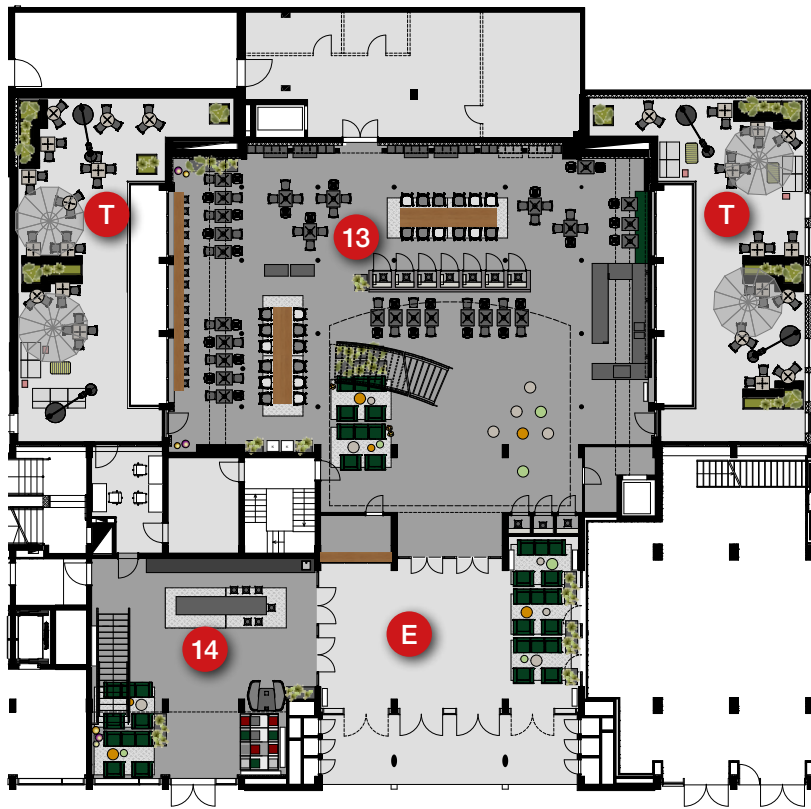
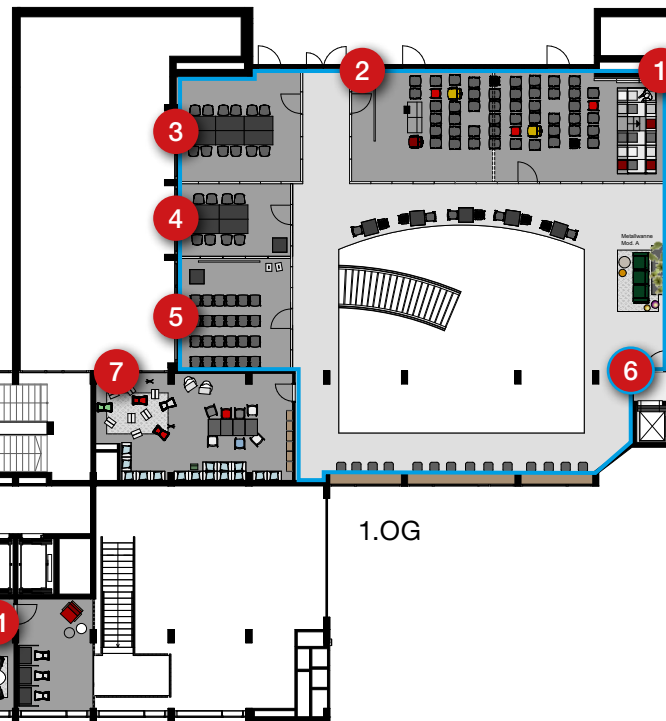

1.OG

- 1 Training Room I
- 2 Training Room II
- 3 Training Room III
- 4 Training Room IV
- 5 Training Room V
- 6 Arena
- 7 Work Lab I
- 8 Meet & Move Room I
- 9 Meet & Move Room II
- 10 Fireside Room I
- 11 Fireside Room II
- 12 Work Lab II
- 13 Eatery
- 14 DO Lounge
- E Empfang
- T Terrasse