

Standortportfolio

Köln Schanzen- straße

DESIGN OFFICES



EG 00

Meetings & Conference

 Zusammengestellt durch flexible Wände

- 1** Training Room I
- 2** Meet & Move Room
- 3** Fireside Room I
- 4** Fireside Room II
- 5** Eatery
- 6** Work Lab
- 7** Training Room II
- 8** Training Room III
- 9** Training Room II + III
- 10** Empfang
- 11** Innenhof

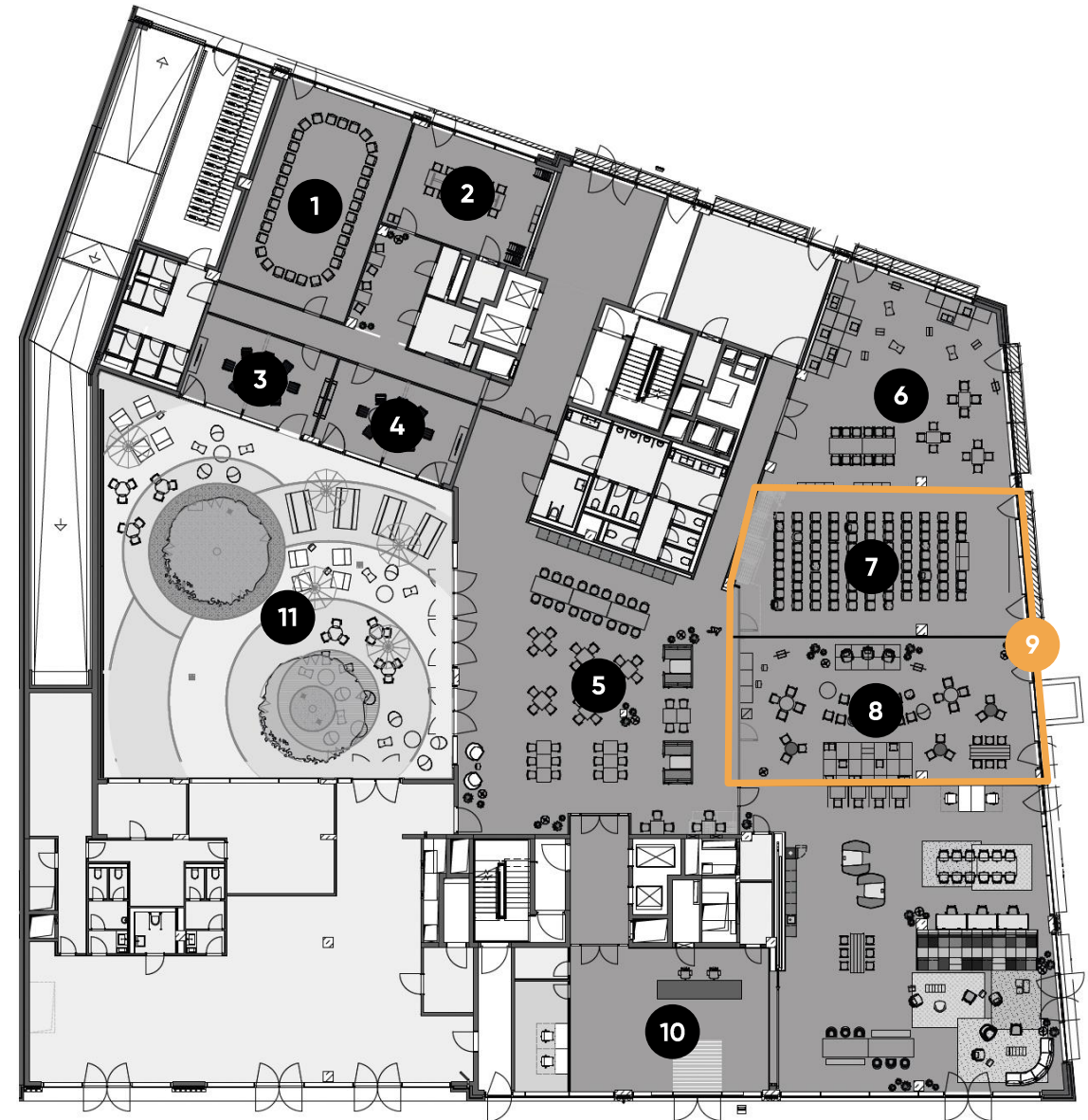

EG 00

Meetings & Conference



| | | m ² | L x B x H in Metern | New Work | U-Form | Parlament | Theater | Block | Stuhlkreis | Bankett |
|----|------------------------|----------------|------------------------|-------------------------------------|--------|-----------|---------|-------|------------|---------|
| 1 | Training Room I | 86 | | 35 | 20 | 40 | 60 | 20 | 20 | |
| 2 | Meet & Move Room | 47 | | | | | | 12 | | |
| 3 | Fireside Room I | 36 | | | | | | 8 | | |
| 4 | Fireside Room II | 37 | | | | | | 8 | | |
| 5 | Eatery | | | | | | | | | |
| 6 | Work Lab | 127 | | 50 | 30 | 40 | 65 | 20 | 20 | |
| 7 | Training Room II | 122 | | 40 | 20 | 36 | 65 | 30 | 20 | |
| 8 | Training Room III | 128 | | 40 | 20 | 36 | 65 | 30 | 20 | |
| 9 | Training Room II + III | 250 | | 140 | | 80 | 200+ | | | |
| 10 | Empfang | | | Außergewöhnliche Outdoor-Möblierung | | | | | | |
| 11 | Innenhof | 86 | | 35 | 20 | 40 | 60 | 20 | 20 | |